



AllenCo

CA. LIC. #704111

May 10, 2016

Los Angeles Regional Water Quality Control Board
320 w. Fourth St. suite 200
Los Angeles, CA. 90013
ATTN Joshua Cwikla

2016 MAY 12 AM 9:40
CALIFORNIA REGIONAL WATER
QUALITY CONTROL BOARD
LOS ANGELES REGION

CLAIM NO. 7015 0640 0006 6057 9550

C.E. Allencompany inc. DBA Allenco

RC Lease is located at 801 E. Patterson St.

Signal Hill, CA. 90755, AT THE RC Lease. Wells RC 3 and RC 9

Latitude 33.18117438

Longitude 118.18235643

Questions 1. Thru 9.

1. The sump was located in the middle of the Tank farm. The Tank farm has two five hundred bbl tanks, one 350 bbl wash tank and one 250 bbl wash tank. The sump has been abandon. It was 6'x6'x6' concrete box, cleaned out to bottom. It was back filled with clean soil, compacted and the final 4" filled with neat Cement, to the top of the sump. See photo.
2. Cleaned the sump to bottom, backfilled it with clean soil and cemented the top 4" with neat Cement.
3. Approx. 1 bbl. Rain water. The RC Lease was purchased in November 2006 from Cockril Oil Company. The only water ever encountered by AllenCo was rain water. It was never used by us.
4. Rain water was removed from the sump using a Vacuum Truck. The water was placed into the RC # 9 WASH TANK. It was then processed into the Clean Brine Tank, then shipped to Oil Operators. Approx 1 bbl..
5. There were no solids in the Sump. However it was cleaned to bottom.
6. Within a half Mile there are no commercial water wells. The Long Beach Water Department is located at 1800 E. Wardlow rd. Long Beach, CA. 90807 The Historical Sump is 3,664.0 feet from that well.



AllenCo

CA. LIC. #704111

2016 MAY 12 AM 9:40
CALIFORNIA REGIONAL WATER
QUALITY CONTROL BOARD
LOS ANGELES REGION

- 7. N/A
- 8. N/A
- 9. N/A

I Tim Parker certify under penalty of law that I have personally examined and am familiar with the information submitted in this document and all attachments and that, based on my inquiry of those individuals immediately responsible for obtaining the information, I believe that the information is true, accurate and complete. I am aware that there are significant penalties for submitting false information, including the possibly of fine and imprisonment.

Sincerely

Tim Parker
Vice President

AllenCo

CE Allenco company sump record

A	B	C	D	E		F	G	H	I	J	K	L		M	N	O
AllenCo CE Allenco	Signal Hill	LA County	Sump 6'x6'x6'	Latitude	Longitude	Volume	Jan 18, 2016	Active	Totals ann. FL Discharged	Fluids	Material	When filled date	Type	Solid Waste	Compositic	
Allenco	SH	L.A.	6'x6'x6' sump	lat 33.18117438	lon 118.18117443	1	2016	?	approx zero BBLs	rain water	n/a	jan, 18 2016	n/a dirt	no	n/a	



Long Beach Water Dept
1800 E. Wardlow
Long Beach, CA 90807

Distance from CE Allen Co
Inc. RC Lease Well to City
Water Well is 3,664.0 feet

Allen Co RC Lease
983 E. Patterson St
Signal Hill, CA 90755

NORTH

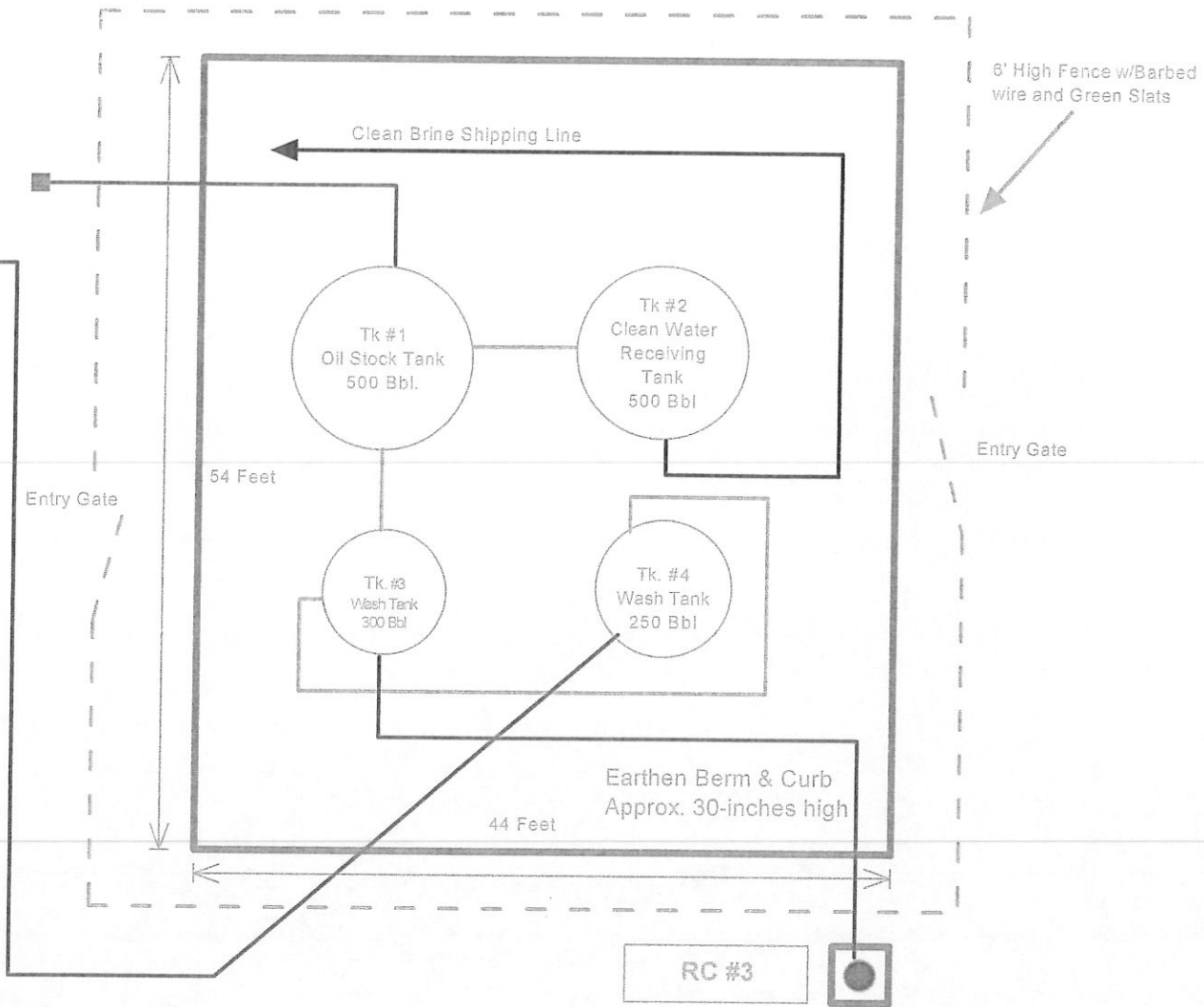

C. E. Allen Company - "RC" Lease

Drawing Not to Scale

COLOR LEGEND	
Green	= Flowlines
Blue	= Wastewater Lines
Red	= Wellhead
Dk. Green	= Oil Shipping
Orange	= Secondary Containment

SPCC Facility Layout

Project Designer:	
Project Contact:	
Tim Parker - Gen Mgr.	
Project #	WO#
Date:	Rev. Date:
November 2012	





Google earth



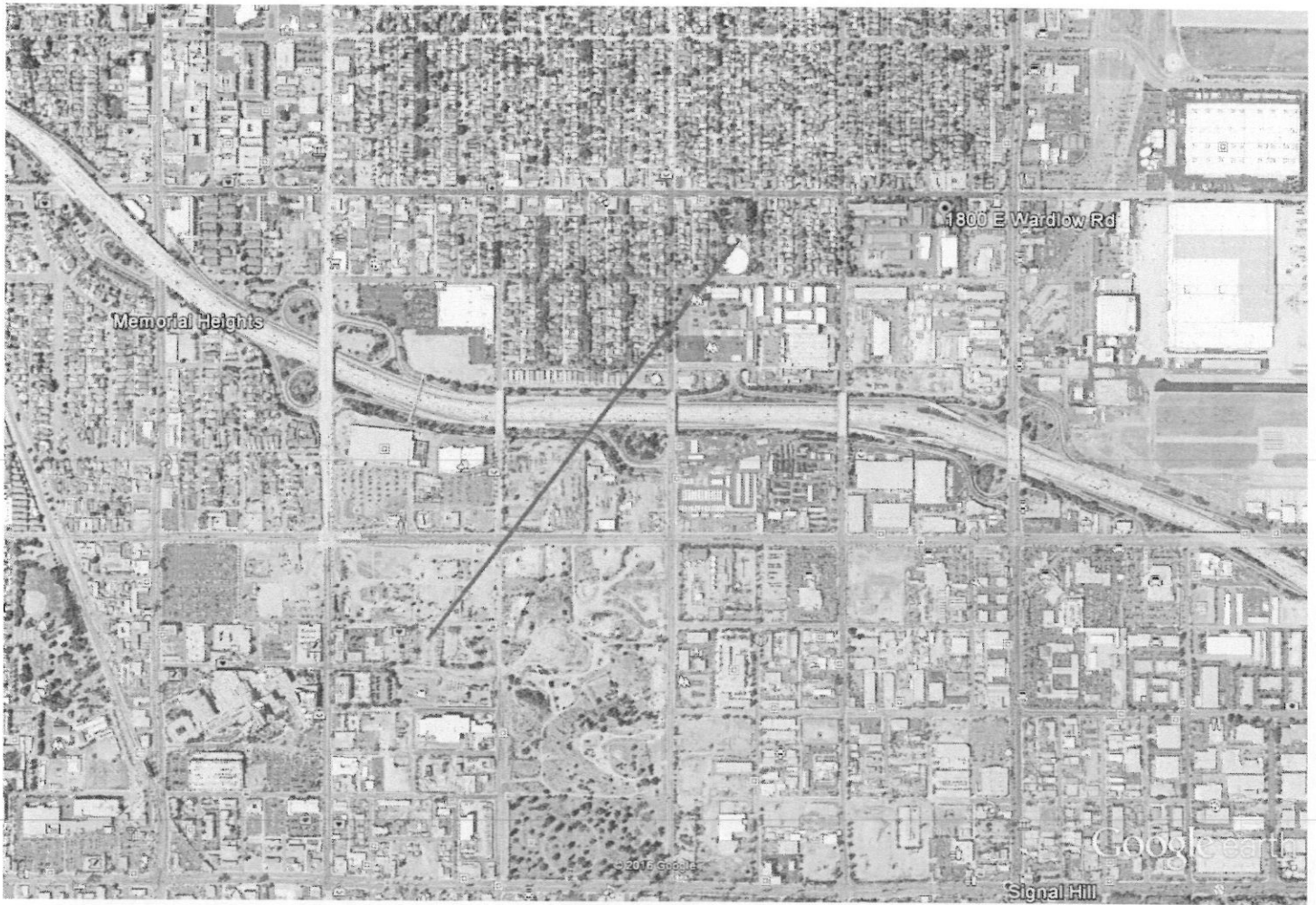

Google earth

feet
km

