

DeltaKeeper Incident Report Form

1. Incident Name Avena Drain - Van Allen Incident# 4/7/98
2. Investigator (DeltaKeeper and/or other) R. Pfeilen D. Wagner K. Morgan R. Kirk

GENERAL

3. Type of Report (Check one): Initial Followup
4. Report / Update Received: Date 4/7/98; Time 10:40; By DK
5. How Received: Phone ; Radio ; Mail ; Patrol ; Other
6. Type of Incident (Check One): Oil ; Dredging/Dumping ; Sewage ; Hazardous Material ; Air ; Illegal Fill ; Fish/Wildlife ; Multiple Causes ; Commercial Shipping ; Other
(Describe): Dairy discharge

7. Agencies Contacted (and Contact Names): Louis Pratt CURWQCB

LOCATION

8. General Location (Give name of river, slough, island, etc.) Avena Drain at VanAllen Rd

9. City or Landmark: Escalon

10. Precise Location (i.e. Latitude and longitude) Van Allen Rd - Ditch from Revisser dairy field runoff into ditches along Van Allen Rd. flows into Avena Drain.

DETAILS OF INCIDENT

(over for specifics)

11. Readings taken on Van Allen at Avena Drain 795 EC - dk brn color - ditch from N flowing into it had reading at confluence of 1433 EC for ditch water only - followed ditch N to determine source of water - saw water running off field in two locations - standing water on field was source for runoff. Reading and sample taken at lower discharge point 3/85 EC. Sludge was so thick it clogged equipment.

RESOLUTION

12. _____

DeltaKeeper Dairy Monitoring Project

Date: 4/7/98

Sampling Team: 1) D. Wagner 2) K. Morgan 3) R. Pfeifer

Site	Time	Temp	SpC	CND/EC	pH	water color	sample
JACKSTONE A-1	9:40	13.1	1694	130.7	7.2	expresso	y/n
Vander schaff A-Murphy	10:05	11.9	843	630	6.9	1+ muddy	y/n
A Murphy West side corner pipe	10:12	12.2	919	700	7.1	med. brn	y/n
Ditch A-Carralton	10:25	13.0	420.8	325.7	7-1	1+ muddy brn	y/n
R. Kirk A-Carralton	10:30	14.5	1006	805	6.4	dk muddy	y/n

Site	Time	Temp	SpC	CND/EC	pH	water color	sample
South A-Robinson	10:35	14.8	1497	1245	6.1	dk brn	y/n
A. Robinson	10:37	14.9	1028	829	6.4	dk brown	y/n
A. Robinson	10:40	17.3	4933	420.2	7.2		y/n
Flow N-ditch A-Van Allen	10:45	15.9	1735	1433	5.0	greenish pea soup	y/n
Drain A-Van Allen	10:45	16.5	949	795	5.6	dk brown	y/n

Site	Time	Temp	SpC	CND/EC	pH	water color	sample
Van Allen A-Ditch above discharge		17.4	170.1	145.6	5.1	1+ muddy	y/n
Van Allen A-Ditch at discharge	11:00	13.7	3399	3185	5.1	dk thick brown	y/n
L-Steingull	12:30	16.4	305.0	249.2			y/n
							y/n
							y/n

916-255-3110

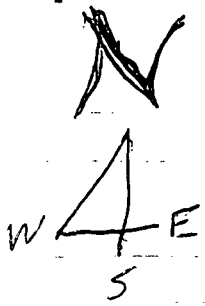

Sample taken

$\frac{170}{145}$

photos 25, 1, 2, 3

Field run-off

$\frac{3399}{3185}$

photos 23, 24

Van Allen

De Visser?
Farm fields

Farm
Ditch

Sample taken

Aven Drain

$\frac{1735}{1433}$ photos 20, 21

949
795 Sample reading taken

Aven Drain

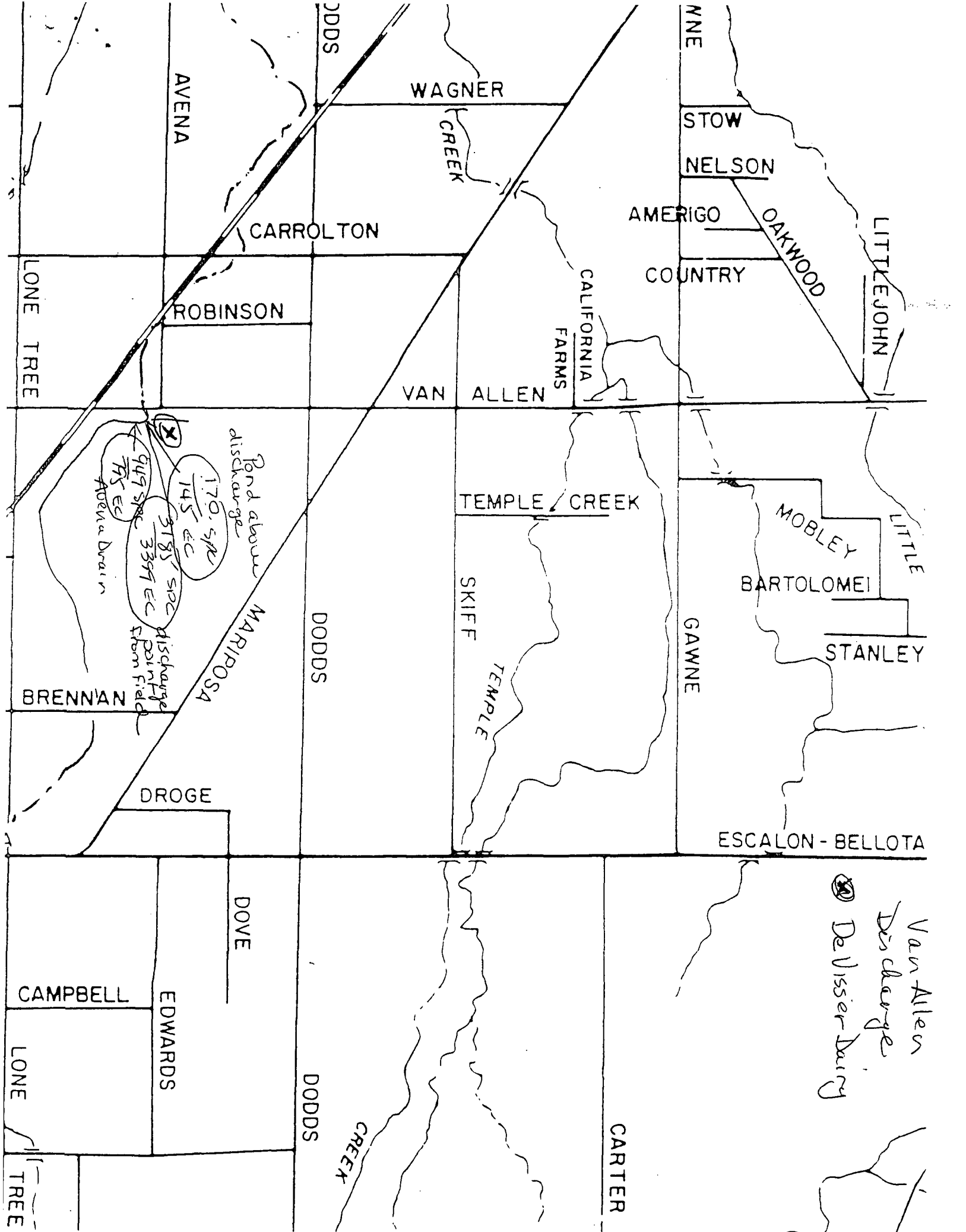

Van Allen
 Discharge
 De Visser Dairy

Sampling Site
Van Allen Rd.
Escalon

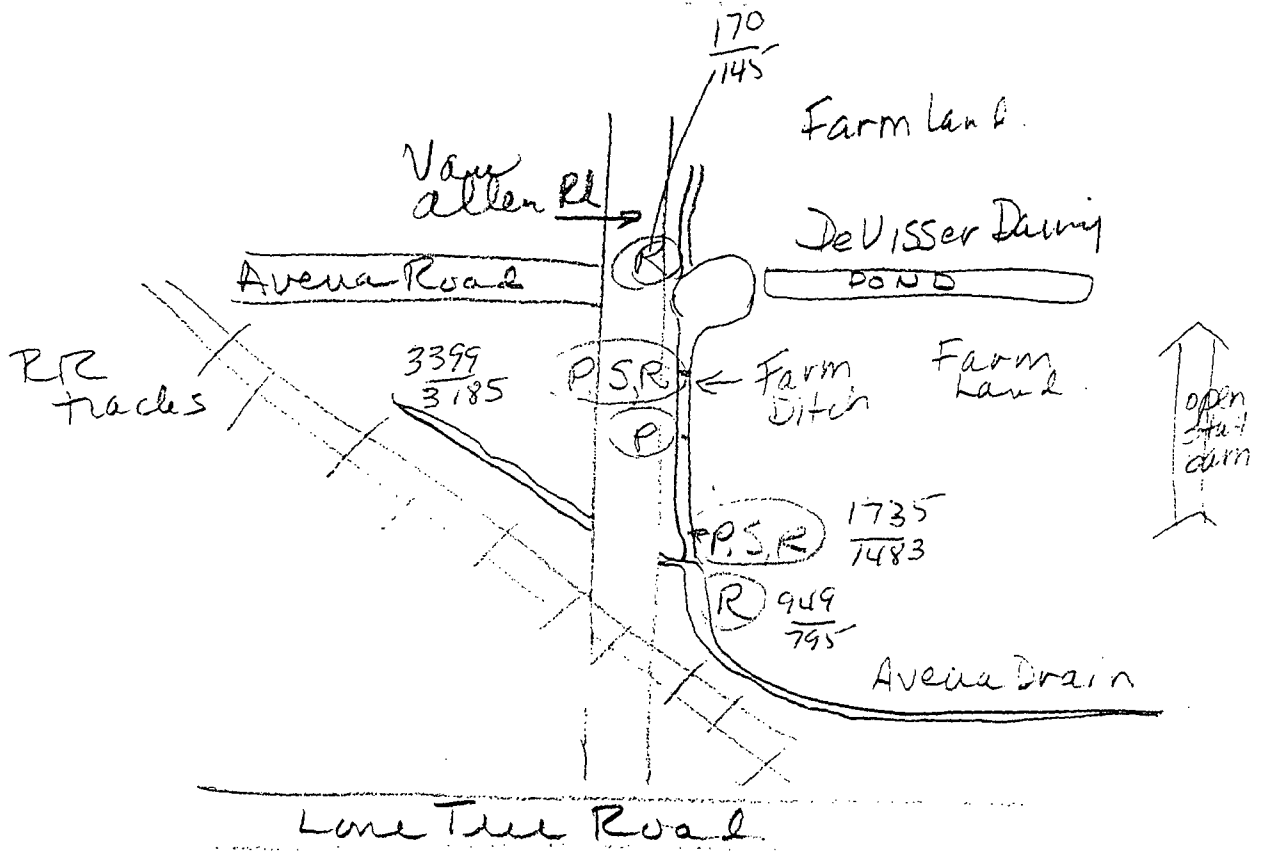
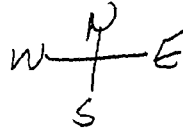

P - positive
S - sample
R - ready

DeltaKeeper Incident Report Form

1. Incident Name Avena Robinson Incident# 4/7/98
2. Investigator (DeltaKeeper and/or other) R. Pfeifer, J. Wagner, K. Morgan,
R. Kern

GENERAL

3. Type of Report (Check one): Initial Followup
4. Report / Update Recieved: Date 4/7/98; Time 10:35; By D/K
5. How Recieved: Phone ; Radio ; Mail ; Patrol ; Other
6. Type of Incident (Check One): Oil ; Dredging/Dumping ; Sewage ; Hazardous Material ;
Air ; Illegal Fill ; Fish/Wildlife ; Multiple Causes ; Commercial Shipping ; Other
(Describe): dairy discharge

7. Agencies Contacted (and Contact Names): Louis Pratt CURWQCB

LOCATION

8. General Location (Give name of river, slough, island, etc.) Avena Drain at Robinson Rd
9. City or Landmark: Escalon
10. Precise Location (i.e. Latitude and longitude) Avena Rd. at Robinson Rd. on south side of Avena Rd.

DETAILS OF INCIDENT

(over for specifics)
11. Discovered corral run-off trickling in to Avena Drain. 1245EC
Reached the pond, the water going into Avena Drain 1245EC and
4202EC
the Avena Drain 829 EC into which corral water was flowing.

RESOLUTION

12. _____

DeltaKeeper Dairy Monitoring Project

Date 4/7/98

Sampling Team: 1) D. Wagner 2) K. Morgan 3) R. Pfeiffer

Site	Time	Temp	SpC	CND/EC	pH	water color
JACKSTONE A-1	9:40	13.1	1694	307	7.2	expresso
Vander schaff A-Murphy	10:05	11.9	843	630	6.9	it muddy
A Murphy West side corner pipe	10:12	12.2	919	700	7.1	med. brn
Ditch A-Carrolton	10:25	13.0	420.8	325.7	7.1	lt. muddy brn
R. Kirk A-Carrolton	10:30	14.5	1006	805	6.4	dk muddy

sample y/n sample y/n sample y/n sample y/n sample y/n

Site	Time	Temp	SpC	CND/EC	pH	water color
Photos # 6, 7, 8 A-Robinson	10:35	14.8	1497	1245	6.1	dk brn
Photos 9, 10 (see map) A-Robinson	10:37	14.9	1028	829	6.4	dk brown
Photos 11, 12 A-Robinson	10:40	17.3	4933	4202	7.2	
Flow A-VanAllen	10:45	15.9	1735	1433	5.0	greenish pea soup
Drain A-VanAllen	10:45	16.5	949	795	5.6	dk brown

sample y/n sample y/n sample y/n sample y/n sample y/n

Site	Time	Temp	SpC	CND/EC	pH	water color
Van Allen A-Ditch above discharge		17.4	170.1	1456	5.1	lt muddy
Van Allen Ditch at discharge	11:00	13.7	3399	3185	5.1	dk choco brown
L-Steingaul	12:30	15.4	305.0	249.2		

sample y/n sample y/n sample y/n sample y/n sample y/n

516-255-3110

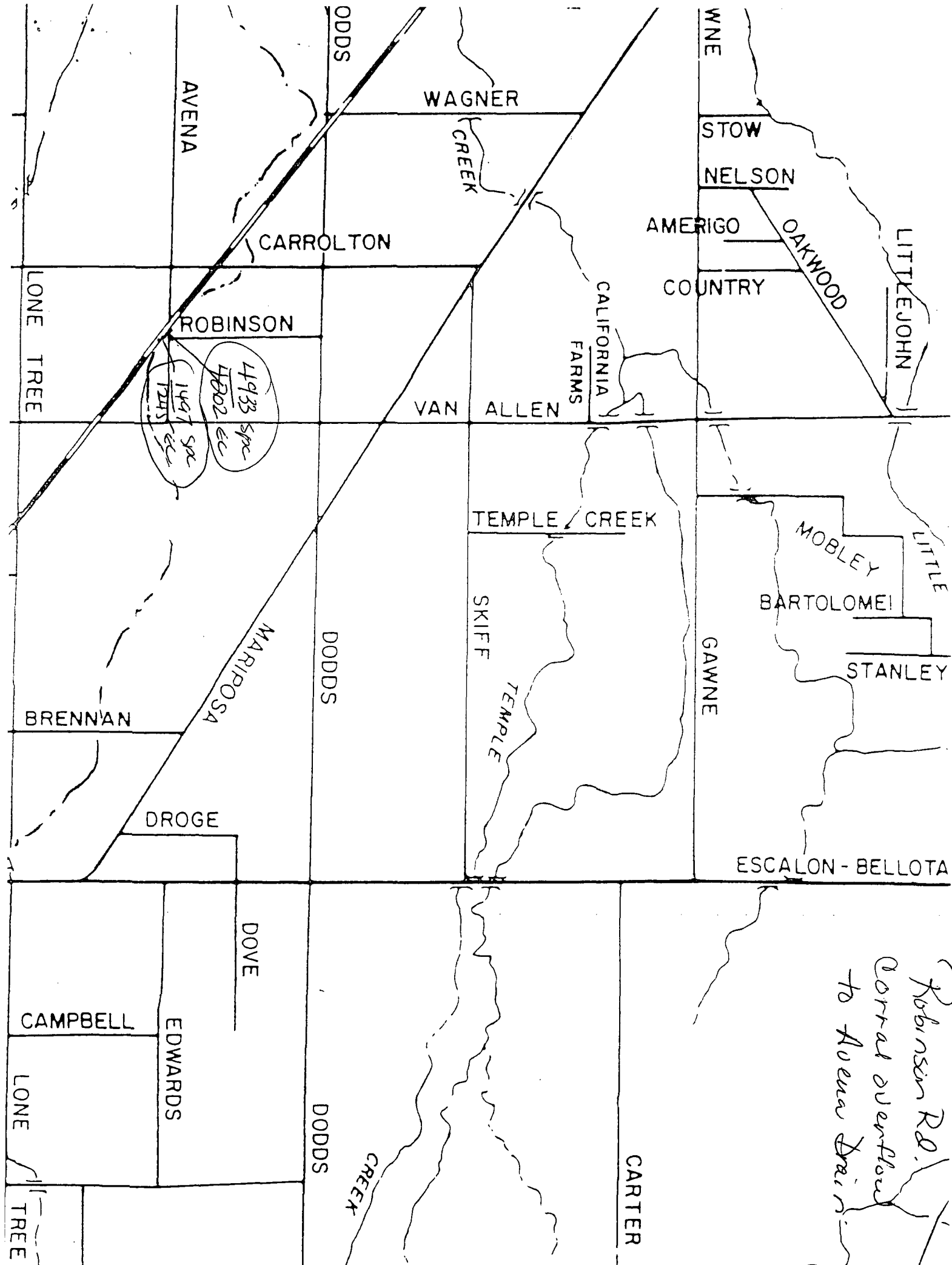

4933 Spr
4802 Ec
1497 Spr
1245 Ec

Robinson Rd.
Corner overlaid
to Avena Drain

Sampling Site
 Avena Rd.
 at Robinson
 Escalon

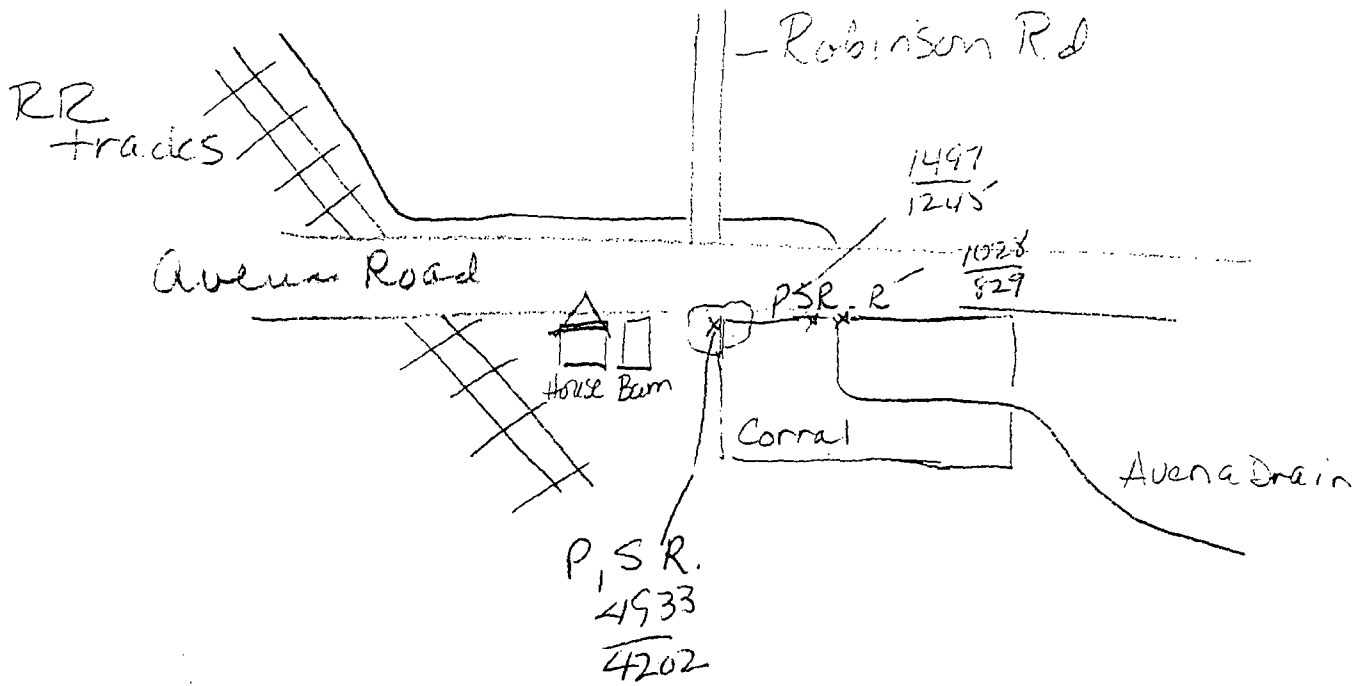

P - picture
 S - sample
 R - reading

DeltaKeeper Incident Report Form

1. Incident Name Avena-Murphy (Van der Schaaf) Incident# 4/7/98
2. Investigator (DeltaKeeper and/or other) R Pfeiler, D Wagner, K. Morgan
R. Kil

GENERAL

3. Type of Report (Check one): Initial Followup
4. Report / Update Received: Date 4/7/98; Time 9:40; By DK
5. How Received: Phone ; Radio ; Mail ; Patrol ; Other
6. Type of Incident (Check One): Oil ; Dredging/Dumping ; Sewage ; Hazardous Material ;
Air ; Illegal Fill ; Fish/Wildlife ; Multiple Causes ; Commercial Shipping ; Other Dairy discharge
(Describe): _____

7. Agencies Contacted (and Contact Names): Louis Pratt CURWCB

LOCATION

8. General Location (Give name of river, slough, island, etc.) Avena Drain between
Jack Tone Rd and Murphy Rd

9. City or Landmark: Escalon

10. Precise Location (i.e. Latitude and longitude) _____

DETAILS OF INCIDENT

(over for specifics)

11. Read 1307 EC at Jack Tone followed it to Murphy Rd.
Read eastside of drain at 630 EC. Van der Schaaf Dairy is the
only dairy between Murphy and Jack Tone Rd. on west side.
Roads are higher on drain past the Van der Schaaf dairy
at 630 east of dairy, EC 700 at east side of Murphy on south corner
goes along south side, private property reaches Jack Tone at EC 1307

RESOLUTION

12. _____

DeltaKeeper Dairy Monitoring Project

Date: 4/7/98

Sampling Team: 1) D. Wagner 2) K. Morgan 3) R. Pfeiffer

Site	Time	Temp	SpC	CND/EC	pH	water color
JACKSTONE A-1	9:40	13.1	1694	130.7	7.2	expresso
Vander schaff A-Murphy	10:05	11.9	843	630	6.9	1+ muddy
A Murphy West side corner pipe	10:12	12.2	919	700	7.1	med. brn
Ditch A-Carralton	10:25	13.0	420.8	325.7	7-1	1+ muddy brn
R. Kirk A-Carralton	10:30	14.5	1006	805	6.4	dk muddy

sample y/n

Photos # 6, 7, 8 52ep
 Photos 9, 10, 11 (see map)
 Photos 11, 12 Flow

Site	Time	Temp	SpC	CND/EC	pH	water color
A-Robinson	10:35	14.8	1497	1245	6.1	dk brn
A-Robinson	10:37	14.9	1028	829	6.4	dk brown
A-Robinson	10:40	17.3	4933	420.2	7.2	
A-VanAllen	10:45	15.9	1735	1433	5.0	greenish pla soup
A-VanAllen	10:45	16.5	949	795	5.6	dk brown

water color dk brn dk brown greenish pla soup dk brown

sample y/n

Site	Time	Temp	SpC	CND/EC	pH	water color
Van Allen A-Ditch above discharge		17.4	170.1	145.6	5.1	1+ muddy
Van Allen Ditch at discharge	11:00	13.7	3399 155	3185	5.1	dk brown
L-Stenzel	12:30	15.4	305.0	249.2		

water color dk muddy dk brown dk brown dk brown

sample y/n

916-255-3110

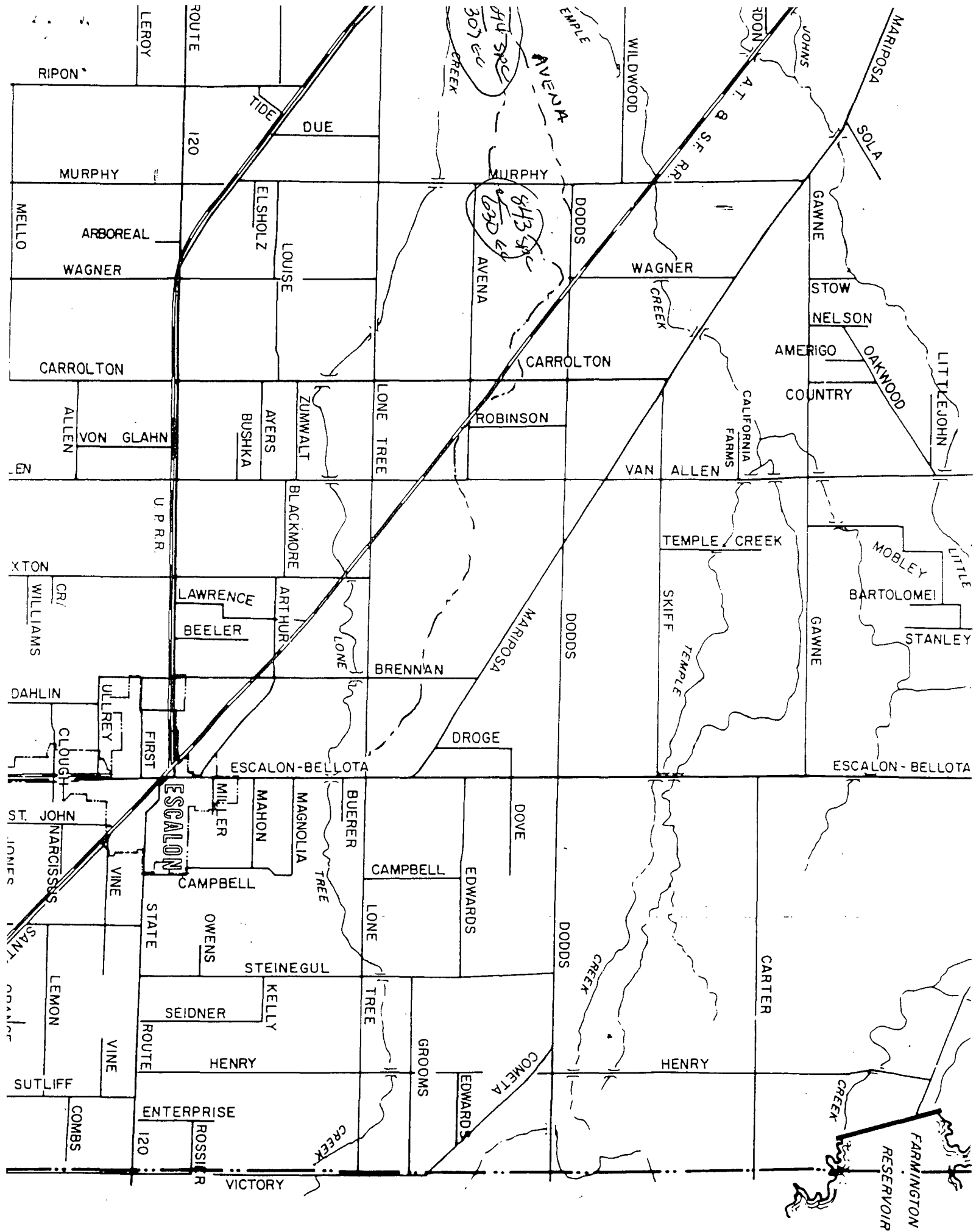

RIPON

LERROY

ROUTE

120

TIDE

DUE

MURPHY

MELLO

ARBOREAL

WAGNER

ELSHOLZ

LOUISE

MURPHY

DODDS

WAGNER

CREEK

GAWNE

STOW

NELSON

CARROLTON

CARROLTON

AMERIGO

COUNTRY

OAKWOOD

LITTLEJOHN

ROBINSON

VON GLAHN

BUSHKA

AYERS

ZUMWALT

LONE TREE

VAN ALLEN

CALIFORNIA FARMS

U.P.R.R.

XTON

CR/
WILLIAMS

LAWRENCE

BEELER

ARTHUR

LONE

BRENNAN

DROGE

DODDS

TEMPLE CREEK

SKIFF

TEMPLE

MOBLEY

BARTOLOMEI

STANLEY

LITTLE

DAHLIN

CLOUGH

ULREY

FIRST

ESCALON-BELLOTA

ESCALON-BELLOTA

ST. JOHN

NARCISSESS

SANTY

LEMON

SUTLIFF

COMBS

ENTERPRISE

ROSSI

VICTORY

ESCALON

MILLER

MAHON

MAGNOLIA

BUERER

CAMPBELL

EDWARDS

DOVE

EDWARDS

CAMPBELL

EDWARDS

DOVE

EDWARDS

DOVE

EDWARDS

DOVE

EDWARDS

DOVE

EDWARDS

DOVE

EDWARDS

DOVE

EDWARDS

DOVE

EDWARDS

DOVE

EDWARDS

DOVE

EDWARDS

STATE

OWENS

STEINEGUL

CAMPBELL

EDWARDS

DOVE

EDWARDS

DOVE

EDWARDS

DOVE

EDWARDS

DOVE

EDWARDS

DOVE

EDWARDS

DOVE

EDWARDS

DOVE

EDWARDS

DOVE

EDWARDS

DOVE

EDWARDS

DOVE

EDWARDS

DOVE

EDWARDS

DOVE

ROUTE

SEIDNER

KELLY

HENRY

STEINEGUL

CAMPBELL

EDWARDS

DOVE

EDWARDS

DOVE

EDWARDS

DOVE

EDWARDS

DOVE

EDWARDS

DOVE

EDWARDS

DOVE

EDWARDS

DOVE

EDWARDS

DOVE

EDWARDS

DOVE

EDWARDS

DOVE

EDWARDS

DOVE

ROUTE

SEIDNER

KELLY

HENRY

STEINEGUL

CAMPBELL

EDWARDS

DOVE

EDWARDS

DOVE

EDWARDS

DOVE

EDWARDS

DOVE

EDWARDS

DOVE

EDWARDS

DOVE

EDWARDS

DOVE

EDWARDS

DOVE

EDWARDS

DOVE

EDWARDS

DOVE

EDWARDS

DOVE

ROUTE

SEIDNER

KELLY

HENRY

STEINEGUL

CAMPBELL

EDWARDS

DOVE

EDWARDS

DOVE

EDWARDS

DOVE

EDWARDS

DOVE

EDWARDS

DOVE

EDWARDS

DOVE

EDWARDS

DOVE

EDWARDS

DOVE

EDWARDS

DOVE

EDWARDS

DOVE

EDWARDS

DOVE

ROUTE

SEIDNER

KELLY

HENRY

STEINEGUL

CAMPBELL

EDWARDS

DOVE

EDWARDS

DOVE

EDWARDS

DOVE

EDWARDS

DOVE

EDWARDS

DOVE

EDWARDS

DOVE

EDWARDS

DOVE

EDWARDS

DOVE

EDWARDS

DOVE

EDWARDS

DOVE

EDWARDS

DOVE

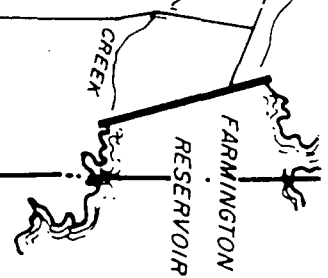

N

W E
5

R
843
630

Avenida Dran

Photo #9

Vander Schaaf Dainy

Murphy Rd

Avenida Dran

Jackline
1694
1307

919
700

Photo #10

Sampling Site

Murphy Rd.

Escalon

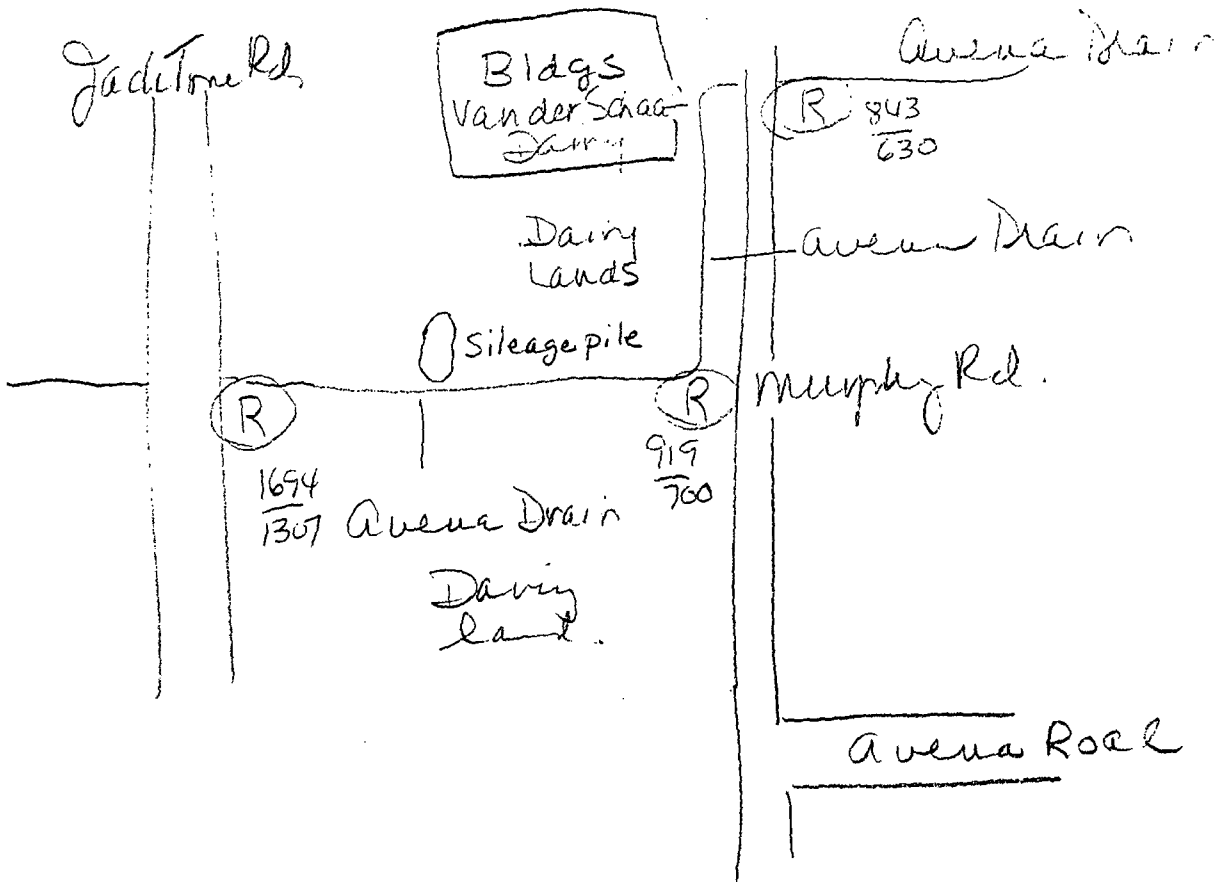
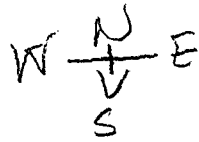

P - picture
 S - sample
 R - ready

DeltaKeeper Incident Report Form

1. Incident Name Avena Drain Incident# 4-5-98
2. Investigator (DeltaKeeper and/or other) Roy Pfeifer, Martin Olney

GENERAL

3. Type of Report (Check one): Initial Followup
4. Report / Update Received: Date 4/5/98; Time 14:30; By R. Pfeifer
5. How Received: Phone ; Radio ; Mail ; Patrol ; Other
6. Type of Incident (Check One): Oil ; Dredging/Dumping ; Sewage ; Hazardous Material ;
Air ; Illegal Fill ; Fish/Wildlife ; Multiple Causes ; Commercial Shipping ; Other Dairy waste
(Describe): discharge to Avena Drain

7. Agencies Contacted (and Contact Names): _____

LOCATION

8. General Location (Give name of river, slough, island, etc.) Avena Drain between JackTone Rd. and Brennan Rd.

9. City or Landmark: Escalon

10. Precise Location (i.e. Latitude and longitude) _____

DETAILS OF INCIDENT

(over for specifics)

11. Discovered high EC readings at JackTone 1297EC
pursued upstream and found high reading at Murphy Rd
1722 EC - high readings found upstream at Carralton 1735 EC
and 1749 EC at South side Avena Rd/Robinson. Readings
dropped to 1238 at Van Allen Rd. and 332 EC at Brennan Rd.
indicating multiple dairies adding to drain between
Brennan and Murphy Rd. No point source could be determined

RESOLUTION

12. _____

DeltaKeeper Incident Report Form

1. Incident Name Avena Drain - Robinson Rd Incident# 3/25/98
2. Investigator (DeltaKeeper and/or other) D. Wagner, R. Pfeifer, R. Kirk

GENERAL

3. Type of Report (Check one): Initial Followup
4. Report / Update Received: Date 3/25/98; Time 10:47; By above investigators.
5. How Received: Phone ; Radio ; Mail ; Patrol ; Other
6. Type of Incident (Check One): Oil ; Dredging/Dumping ; Sewage ; Hazardous Material ;
Air ; Illegal Fill ; Fish/Wildlife ; Multiple Causes ; Commercial Shipping ; Other
(Describe): Dirty Discharge

7. Agencies Contacted (and Contact Names): Louis Pratt, DFG, OES

LOCATION

8. General Location (Give name of river, slough, island, etc.) Avena Rd at Robinson
Avena Drain south side of Avena Rd

9. City or
Landmark: N. of Escaton

10. Precise Location (i.e. Latitude and
longitude) _____

DETAILS OF INCIDENT

(over for specifics)

11. Read 3705 spc coming from flooded corral flowing
3210 EC into Avena Drain.

RESOLUTION

12. Farmer pulled up in truck (Bill) asked how the water was -
was told of the high reading from his corral - he got out
a shovel and piled up some earth into a small berm to
prevent flow from going into Avena Drain - said he was going
to talk to Louis Pratt re: all the work he needed to do.

Escalon

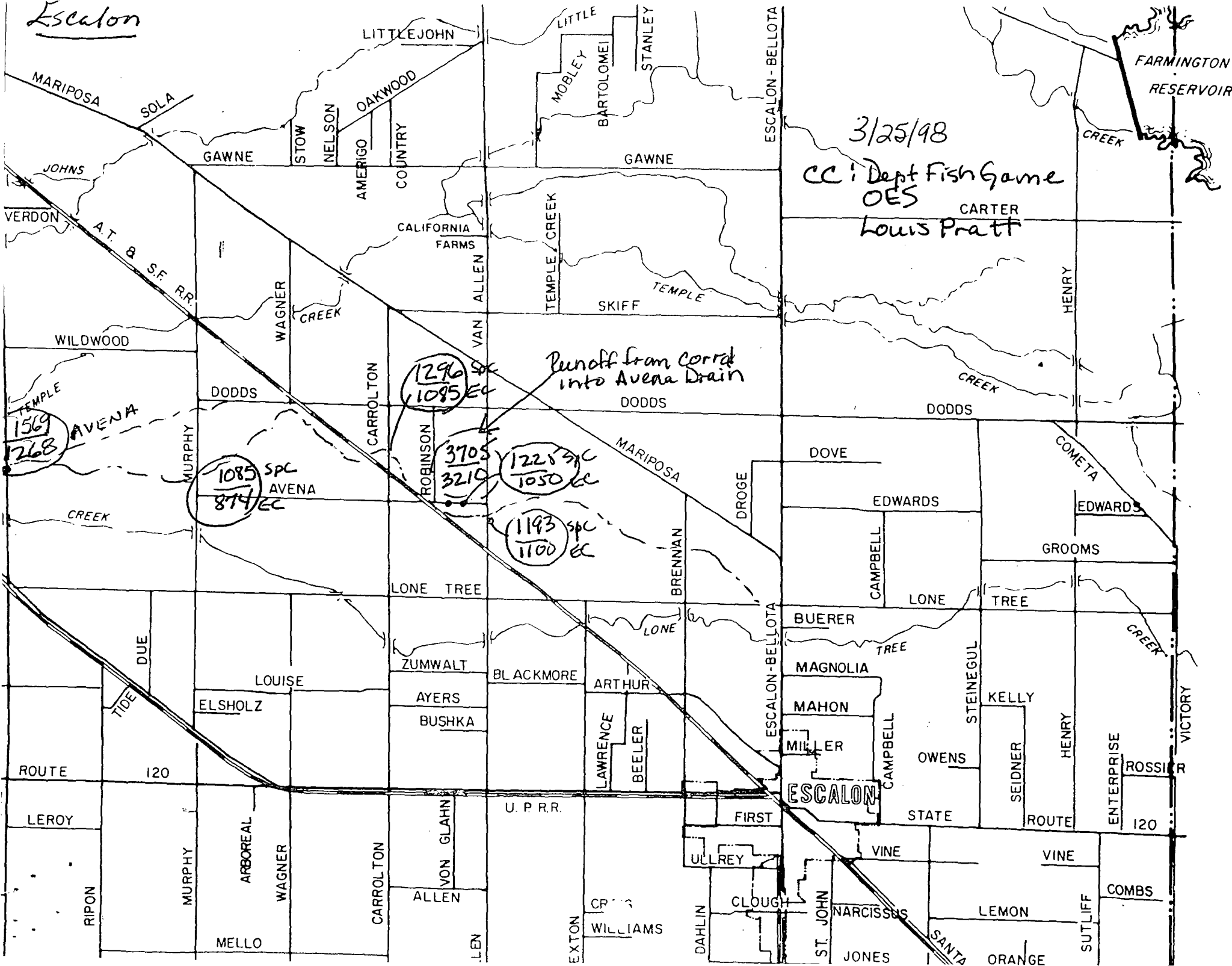

3/25/98

CC: Dept Fish Game
OES
Louis Pratt

Penoff from Corral
into Avena Drain

1296 SPC
11095 EC

1569
1268

1085 SPC
AVENA
874 EC

3705 SPC
3210 EC

1225 SPC
1050 EC

1193 SPC
1100 EC

FARMINGTON
RESERVOIR

CREEK

CARTER

Louis Pratt

SKIFF

TEMPLE CREEK

CREEK

MARIPOSA

DOVE

EDWARDS

EDWARDS

GROOMS

LONE TREE

LONE

BUERER

LONE

TREE

MAGNOLIA

STEINEGUL

KELLY

MAHON

MILLER

OWENS

SEIDNER

HENRY

ESCALON

ENTERPRISE

ROSSI

ROUTE 120

U. P. R. R.

FIRST

STATE

ROUTE

120

LEROY

MURPHY

ARBOREAL

WAGNER

CARROLLTON

VON GLAHN

ALLEN

LEN

EXTON

WILLIAMS

DAHLIN

CLOUGH

ST. JOHN

NARCISSUS

JONES

SANTA

LEMON

ORANGE

SUTLIFF

COMBS

VICTORY

Murphy Rd

Vander Schaaf daery

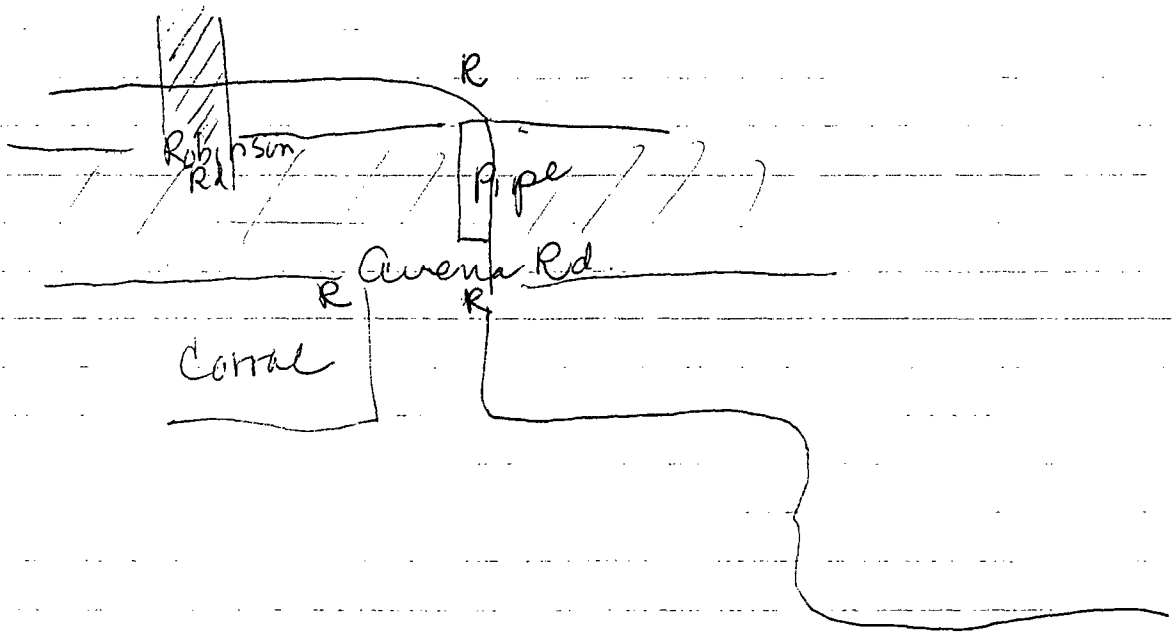
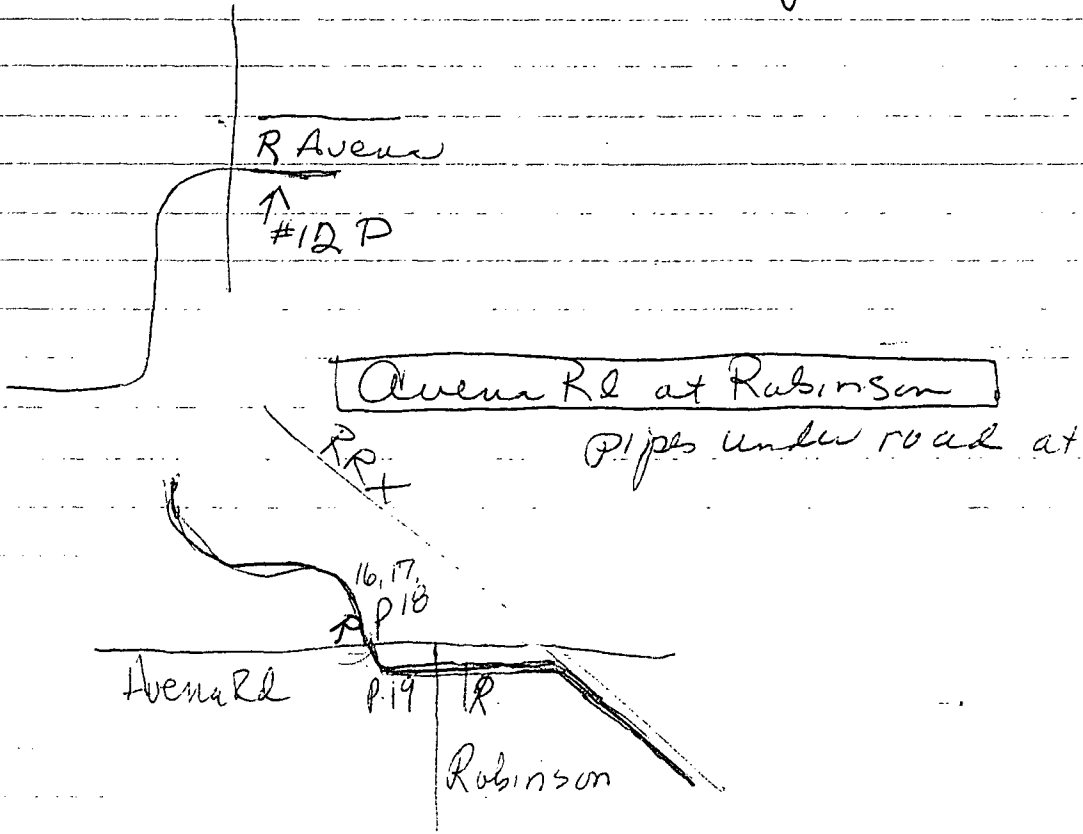

DeltaKeeper Incident Report Form

1. Incident Name Avena Drain / Jack Tone Incident# 3/18/98
 2. Investigator (DeltaKeeper and/or other) _____

GENERAL

3. Type of Report (Check one): Initial Followup _____
 4. Report / Update Received: Date _____; Time _____; By _____
 5. How Received: Phone _____; Radio _____; Mail _____; Patrol _____; Other _____
 6. Type of Incident (Check One): Oil _____; Dredging/Dumping _____; Sewage _____; Hazardous Material _____;
 Air _____; Illegal Fill _____; Fish/Wildlife _____; Multiple Causes _____; Commercial Shipping _____; Other Dam Discharge
 (Describe): High Readings (E.C.)

7. Agencies Contacted (and Contact Names): _____

LOCATION

8. General Location (Give name of river, slough, island, etc.) A-1 Avena Drain Jack Tone, A-2 Avena Drain - Murphy Rd, A-3
 9. City or Landmark: Escalon Area
 10. Precise Location (i.e. Latitude and longitude) _____

DETAILS OF INCIDENT

11. A-1 (over for specifics)

	<u>A-2 (upstream)</u>	<u>A2a Carleton</u>	<u>A2b Robinson</u>
EC - 1805	EC - 1089	EC - 1617	EC - 1603
SPC - 2463	SPC - 1411	SPC - 1666	SPC - 1721
PH - 8.7	PH - 6.2	PH - 7.0	PH - 6.8
Temp - 12.0°C	Temp - 13.0	Temp - 23.4	Temp - 21.3
Sample Taken	Sample Taken	Farmer has installed a drain control gate	

12. A-3 S.EAST A-3 WEST ~~RESOLUTION~~ Details cont'd

		<u>N. EAST</u>	<u>A-4</u>
EC - 2981	EC - 2876	EC - 3137	EC - 2406
SPC - 2934	SPC - 2917	SPC - 3392	SPC - 3236
PH - 7.5	PH - 7.3	PH - 7.5	PH - 6.2
Temp - 25.6	Temp - 24.2	Temp - 20.8	TEMP - 11.9
		Sample Taken	SAMPLE TAKEN

DeltaKeeper Dairy Monitoring Project

D 3-18-98

Sampling Team: 1) D. Wagner 2) R. Kirk 3) K. Morgan

Site	Time	Temp	SpC	CND/EC	pH	water color	sample	note
<u>T-1</u>	<u>9:55</u>	<u>13.2°</u>	<u>291</u>	<u>228</u>	<u>8.9</u>	<u>Slimy Brown</u>	<u>y/n</u>	<u>note: 21-25 photos.</u>
<u>A-1</u>	<u>10:10</u>	<u>12.0°</u>	<u>12463</u>	<u>1805</u>	<u>8.7</u>	<u>Slimy green + Brown</u>	<u>y/n</u>	<u>photos #1,2,3</u>
<u>L-1</u>	<u>10:20</u>	<u>13.8</u>	<u>992</u>	<u>785</u>	<u>6.6</u>	<u>Slimy Brown</u>	<u>y/n</u>	
<u>L-2</u>	<u>10:35</u>	<u>16.8</u>	<u>595</u>	<u>497</u>	<u>7.5</u>	<u>Cappacino</u>	<u>y/n</u>	
<u>A-2</u>	<u>10:40</u>	<u>13.0</u>	<u>1411</u>	<u>1089</u>	<u>6.2</u>	<u>Brown + Green Slim</u>	<u>y/n</u>	<u>note: photos #4,5</u>

water color Slimy Brown water color Slimy green + Brown water color Slimy Brown water color Cappacino water color Brown + Green Slim

Site	Time	Temp	SpC	CND/EC	pH	water color	sample	note
<u>A-2 West</u>	<u>10:44</u>	<u>14.2</u>	<u>1318</u>	<u>1046</u>	<u>5.0</u>	<u>Bin + Grn</u>	<u>y/n</u>	<u>photo #6</u>
<u>A2-a</u>	<u>11:00</u>	<u>23.4</u>	<u>11666</u>	<u>1617</u>	<u>7.0</u>	<u>LGHT. COFFEE</u>	<u>y/n</u>	<u>photos #7,8,9,10</u>
<u>A2-b</u>	<u>11:12</u>	<u>21.3</u>	<u>1721</u>	<u>1603</u>	<u>6.8</u>	<u>Thick Choc. Brown</u>	<u>y/n</u>	
<u>A-3 WEST</u>	<u>11:17</u>	<u>24.2</u>	<u>2917</u>	<u>2876</u>	<u>7.3</u>	<u>Thick Choc. Foamy</u>	<u>y/n</u>	
<u>A-3 EAST</u>	<u>11:20</u>	<u>23.6</u>	<u>2934</u>	<u>2981</u>	<u>7.5</u>	<u>Coffee/foam</u>	<u>y/n</u>	

water color Bin + Grn water color LGHT. COFFEE water color Thick Choc. Brown water color Thick Choc. Foamy water color Coffee/foam

Site	Time	Temp	SpC	CND/EC	pH	water color	sample	note
<u>Van Allen Ditch EAST SIDE</u>	<u>11:23</u>	<u>20.8</u>	<u>3392</u>	<u>3131</u>	<u>7.5</u>	<u>Milk Choc. / solids</u>	<u>y/n</u>	<u>photos #11,12,13,14,15,16,17,18,19 (20-22) down road</u>
<u>Brennan Rd. A-4</u>	<u>11:45</u>	<u>11.9</u>	<u>3236</u>	<u>2406</u>	<u>6.2</u>	<u>Thick COFFEE</u>	<u>y/n</u>	<u>photos #23,24,25</u>
_____	_____	_____	_____	_____	_____	_____	_____	_____
_____	_____	_____	_____	_____	_____	_____	_____	_____
_____	_____	_____	_____	_____	_____	_____	_____	_____

water color Milk Choc. / solids water color Thick COFFEE water color _____ water color _____ water color _____

VAN DER SCHAAF

DeltaKeeper

3536 Rainier Ave., Stockton, CA 95204
(209) 464-5090, Fax (209) 464-5174

MEMORANDUM

To: Office of Emergency Services
From: Robin Kirk, Project Director, DeltaKeeper
Date: March 18, 1998
Subject: High EC readings in Escalon dairy area

DeltaKeeper, a volunteer water quality monitoring group, has been monitoring Temple, Avena and Lone Tree Creek in the Escalon area east of Jack Tone Road on a regular basis. High EC readings over 1200 are being reported to Fish and Game, Louis Pratt at the Regional Board and OES. We hereby submit the attached readings and map for your action.

Please call us with any questions you may have.

Robin Kirk
464-6368

Van Allen Rd. Incident

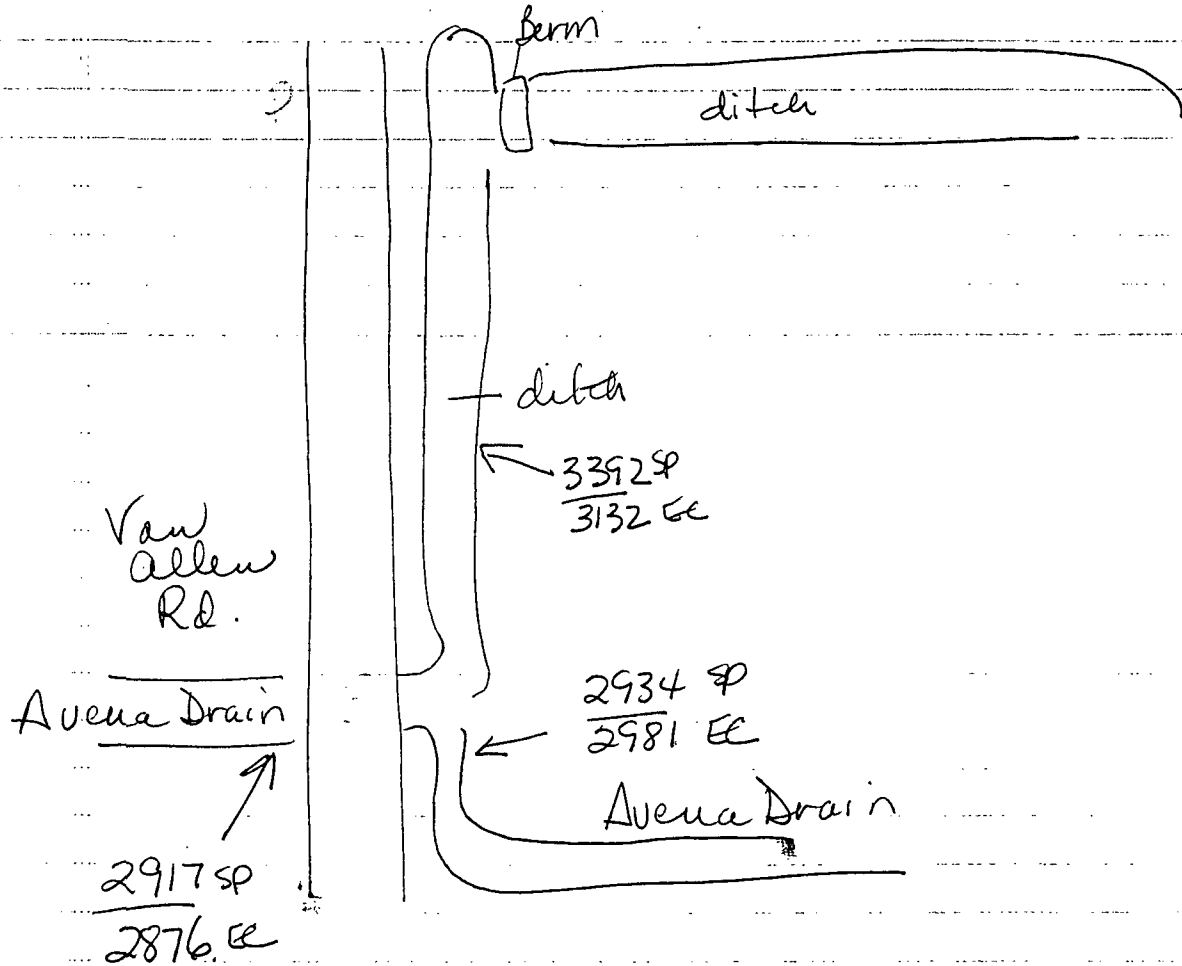

Murphy Rd. Incident

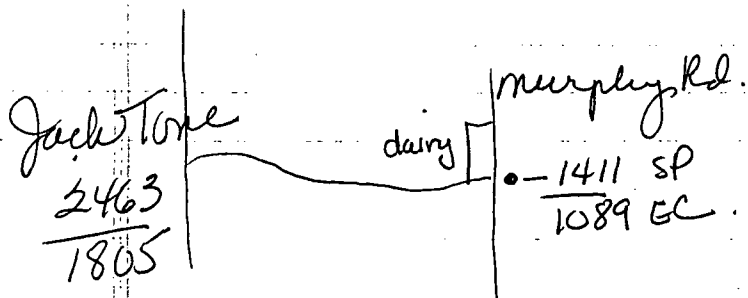

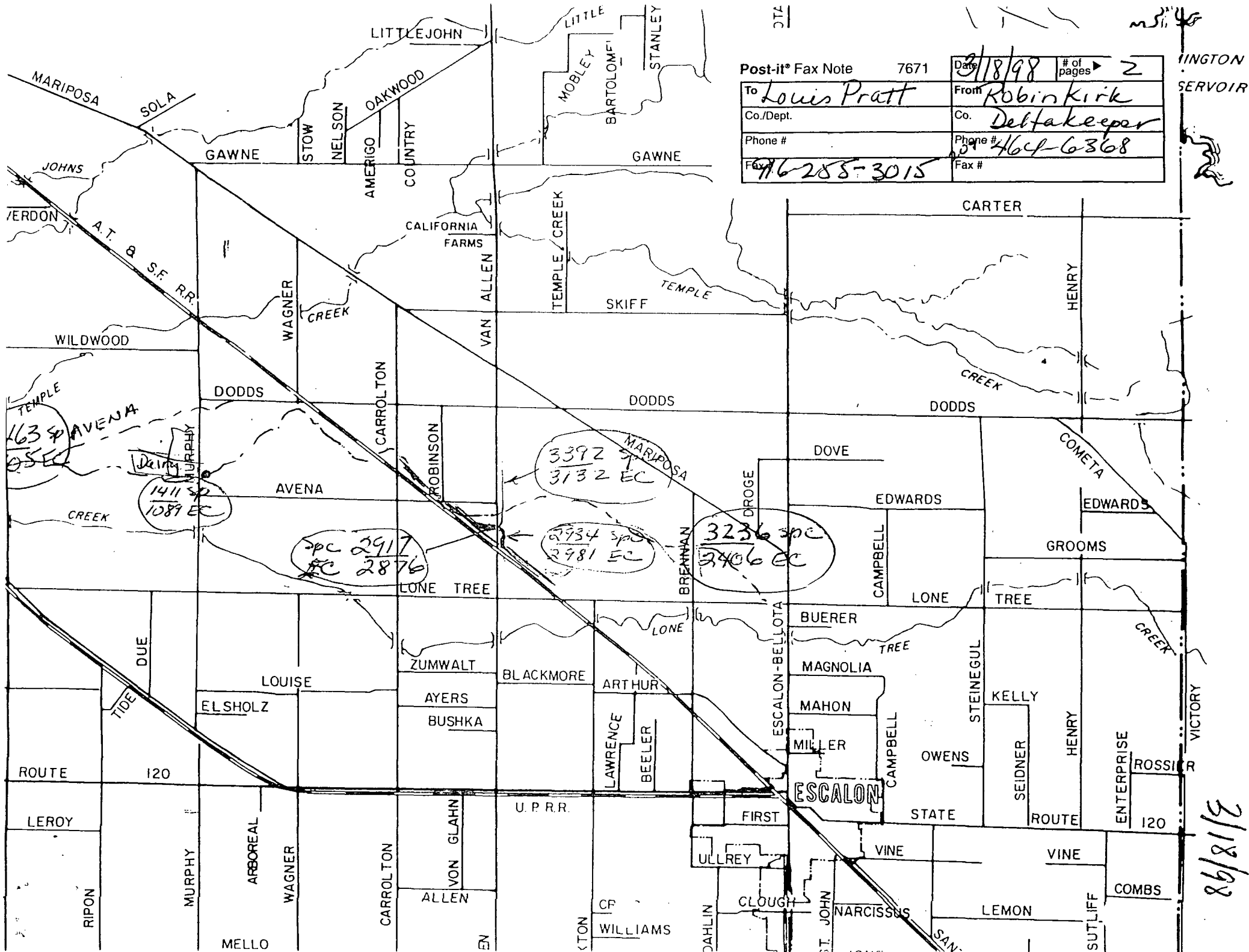

Post-it® Fax Note 7671

Date	3/18/98	# of pages	2
To	Louis Pratt	From	Robin Kirk
Co./Dept.		Co.	Deltakeeper
Phone #		Phone #	464-6368
Fax #	76-285-3015	Fax #	

INGTON
SERVOIR

3/18/98

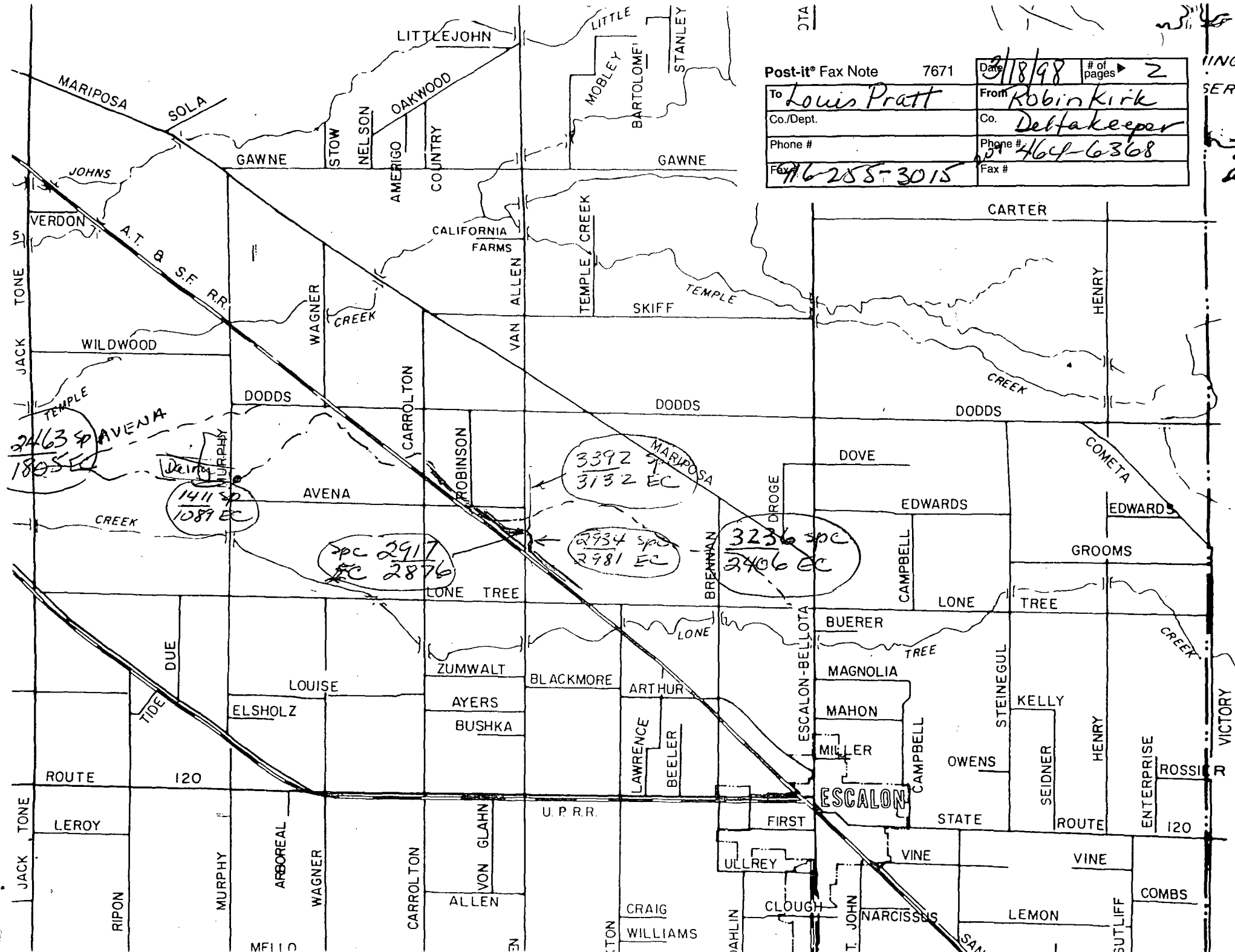

Post-it® Fax Note 7671

Date	3/18/98	# of pages	2
To	Louis Pratt	From	Robin Kirk
Co./Dept.		Co.	Debtkeeper
Phone #		Phone #	464-6368
Fax #	76288-3015	Fax #	

INGFOI
SERVOI

DeltaKeeper Incident Report Form

1. Incident Name: A-2 Avena Drain - Carrollton Rd. Incident# Dairy 2 #
2. Date: 3/4/98 Day of Week: Wednesday Time: 11:08
3. Investigator (DeltaKeeper and/or Other) D. Wagner, R. Pfeifer, R. Kirk

GENERAL

4. Type of Report (Check One): Initial Followup
5. Report /Update Received: Date: 3/4/98, Time: 11:08, By: R. Kirk
6. How Received: Phone , Radio , Mail , Patrol , Other Dairy Investigation
7. Type of Incident (Check One): Oil , Dredging/Dumping , Sewage , Hazardous Material , Air ,
Illegal Fill , Fish/Wildlife , Multiple Causes , Commercial Shipping , Other Dairy discharge
(Describe) _____
8. Agencies Contacted (and Contact Names) Regional Water Quality Control Board -
Louis Pratt, dairy investigator

LOCATION

9. General Location (Name of River, Slough, Island, etc.) Avena Drain
10. City or Landmark: Escalon
11. Precise Location (i.e. Lat. & Long.) Avena drain, north of RRX, Carrollton Rd.

CONTACT INFORMATION

12. Information about Person Contacting Us:
a. Person's Role (Circle One): Reporter, Investigator, Agency, Witness, Info. Source, Sample Analyst,
WQ Monitor, Photographer, Other _____
Name: DeltaKeeper - volunteers
Address: _____
Phone Number (s): _____
O.K. to Use Contact's Name as Case is Developed? Yes , No .
13. How did Contact Hear of Us? routine monitoring

DETAILS OF INCIDENT

14. How was the Incident Discovered? High readings at A-1 on Jackstone traced up the Avena
Drain to a discharge point 25 yds north of Avena Drain - farmer discharging
from field directly into ditch flowing into Avena Drain.
15. Incident Occurred/Began: Date: 3/4/98, Time: 11:08
16. Description of Material: dark brown discharge water in Avena Drain
17. Quantity: _____
18. Area Affected: Avena Drain
19. Resources at Risk: _____
20. Other Witnesses/Potential Corroborating Evidence: D. Wagner, R. Pfeifer
21. Weather: Sunny, clear; Marine Conditions: N/A
Tides: N/A

SOURCE

22. Suspected Source; Primary: pasture drainage
Secondary: _____
23. Cause: deliberate discharge to the ditch through PVC pipe about 10" diam

EVIDENCE

24. Photo/Video Taken: Yes , No ; Requested: Yes , No ; Number (s): _____; Available: Yes , No
25. Samples Taken: Yes , No ; Requested: Yes , No ; Number (s): _____
26. Analyzed: Yes , No ; Lab Name: DeltaKeeper Lab. - AR Ammonia over 50 mg/L.
27. Environmental Permit: Yes , No ; Agency and Permit Number: _____
27. Conditions of Permit: _____

(Over for Details and Resolution)

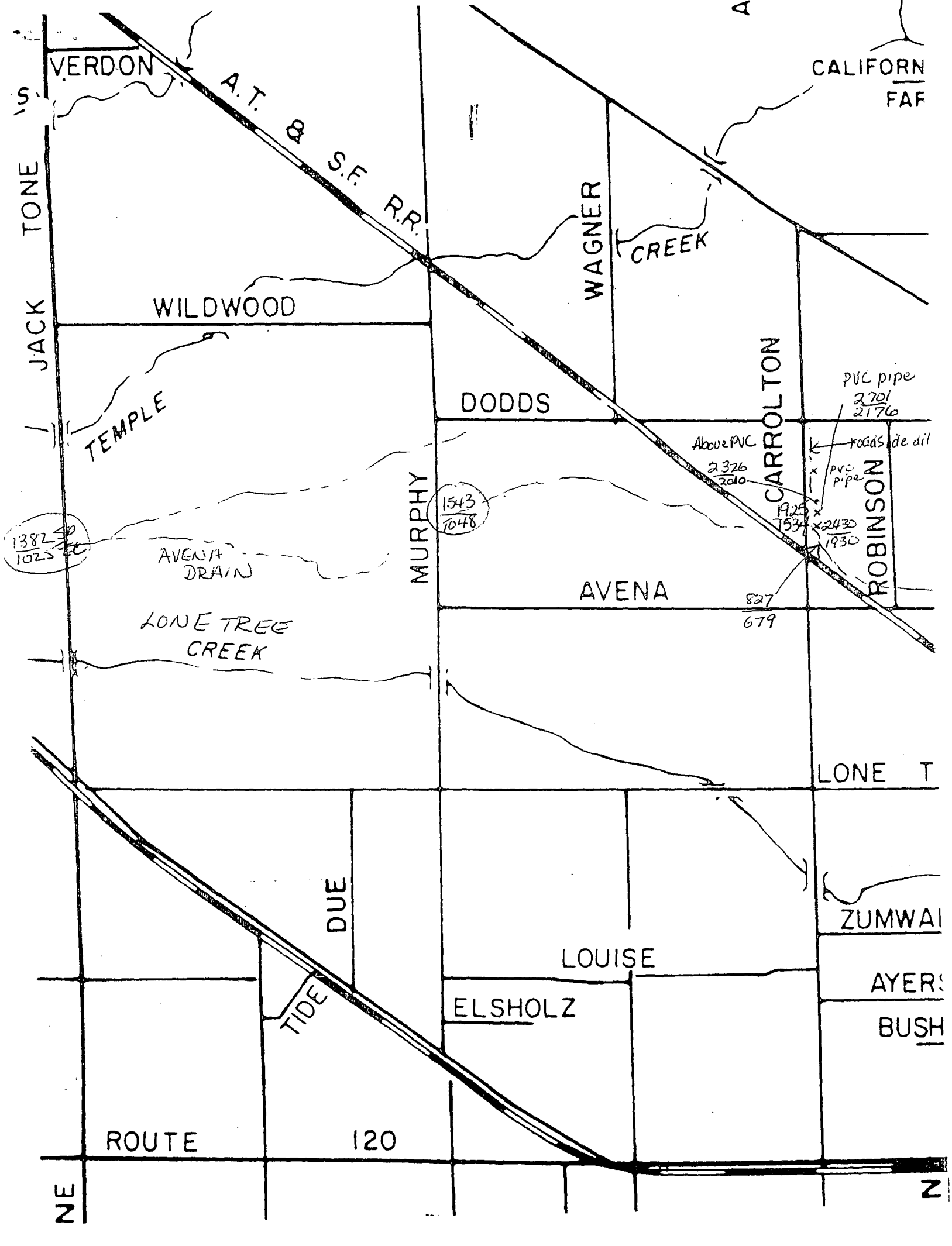

VERDON
TONE
JACK
NE

CALIFORNIA
FAF

A.T. & S.F. R.R.

WILDWOOD

WAGNER
CREEK

TEMPLE

DODDS

CARROLLTON

PVC pipe
2701
2176

roads de dil

Above PVC
2326
2010

PVC pipe
1925
1534 x 2430
1930

1382
1025

1543
1048

MURPHY

AVENA
DRAIN

AVENA

827
679

ROBINSON

LONE TREE
CREEK

LONE T

DUE

ZUMWAI

LOUISE

AYERS

TIDE

ELSHOLZ

BUSH

ROUTE

120

Z

DeltaKeeper Dairy Monitoring Project

12475 Van Allen Rd
12556 (Bastardink)
12637 "

Da 3/4/98

Sampling Team: 1) D. Wagner 2) R. Pfeifer 3) R. Kirk

Site <u>T-1</u>	Site <u>A-1</u>	Site <u>L-1</u>	Site <u>L-2</u>	Site <u>(Avena Drain) A-1A</u> <i>Murphy Rd.</i>
Time <u>10:17</u>	Time <u>10:32</u>	Time <u>10:37</u>	Time <u>10:49</u>	Time <u>10:56</u>
Temp <u>13.2 c</u>	Temp <u>10.2</u>	Temp <u>11.9</u>	Temp <u>11.4</u>	Temp <u>8.4</u>
SpC <u>503</u>	SpC <u>1384</u>	SpC <u>284.3</u>	SpC <u>277</u>	SpC <u>1543</u>
CND/EC <u>205</u>	CND/EC <u>1025</u>	CND/EC <u>210.6</u>	CND/EC <u>205</u>	CND/EC <u>1048</u>
pH <u>7.5</u>	pH <u>7.7</u>	pH <u>—</u>	pH <u>7.5</u>	pH <u>7.3</u>
water color <u>lt. muddy</u>	water color <u>dk brown</u>	water color <u>trans brn.</u>	water color <u>trans. brn.</u>	water color <u>dk muddy brown</u>

sample <u>y/n</u>	sample <u>y/n</u>	sample <u>y/n</u>	sample <u>y/n</u>	sample <u>y/n</u>
(Avena Drain) <u>A-2</u>	<u>Photos #19, 20</u> <u>A2-A</u>	(Avena Drain) <u>RR A2-</u>	<u>(X)</u> <u>East side opp A2-A</u> <u>flow from north</u>	<u>Photos #21, 22</u> <u>A-2A</u> <u>(Avena Drain)</u> <u>Next to Field Drain</u> <u>(white PVC pipe) Down</u> <u>FLW</u>
Time <u>11:08</u>	Time <u>11:23</u>	Time <u>—</u>	Time <u>—</u>	Time <u>—</u>
Temp <u>13.4</u>	Temp <u>15.9</u>	Temp <u>10.6</u>	Temp <u>14.7</u>	Temp <u>15.0</u>
SpC <u>1894</u> <u>1234</u>	SpC <u>837</u>	SpC <u>827</u>	SpC <u>2430</u>	SpC <u>2709</u>
CND/EC <u>1320</u> <u>1534</u>	CND/EC <u>691</u>	CND/EC <u>679</u>	CND/EC <u>1930</u>	CND/EC <u>2176</u>
pH <u>—</u>	pH <u>7.5</u>	pH <u>—</u>	pH <u>—</u>	pH <u>—</u>
water color <u>muddy dk brn.</u>	water color <u>muddy brn.</u>	water color <u>—</u>	water color <u>mid field</u>	water color <u>Syrupy dark</u>
sample <u>(y/n)</u>	sample <u>y/n</u>	sample <u>y/n</u>	sample <u>y/n</u>	sample <u>y/n</u>
<u>Photos #23, 24</u>	<u>Photos #25, 1, 2</u>		<u>Photos #7, 8, 9</u>	<u>(Photos 10, 11, 12)</u>

ABOVE Flow

Site <u>—</u>	Site <u>—</u>	Site <u>—</u>	Site <u>—</u>	Site <u>—</u>
Time <u>1315</u>	Time <u>—</u>	Time <u>—</u>	Time <u>—</u>	Time <u>—</u>
Temp <u>17.8</u>	Temp <u>—</u>	Temp <u>—</u>	Temp <u>—</u>	Temp <u>—</u>
SpC <u>2326</u>	SpC <u>—</u>	SpC <u>—</u>	SpC <u>—</u>	SpC <u>—</u>
CND/EC <u>2610</u>	CND/EC <u>—</u>	CND/EC <u>—</u>	CND/EC <u>—</u>	CND/EC <u>—</u>
pH <u>—</u>	pH <u>—</u>	pH <u>—</u>	pH <u>—</u>	pH <u>—</u>
water color <u>—</u>	water color <u>—</u>	water color <u>—</u>	water color <u>—</u>	water color <u>—</u>
sample <u>y/n</u>	sample <u>y/n</u>	sample <u>y/n</u>	sample <u>y/n</u>	sample <u>y/n</u>
<u>Photos #10, 11, 12</u>				