

BROWN'S SUPPLY, INC.

219 Wye Road
Bishop, Ca 93514
Phone (760) 872-6911
Fax (760) 872-1373

April 25, 2008

Cindi Mitton
1440 Civic Drive,
Suite 200
Victorville, Ca 92392

5/19

CRWQCB REG 6	
Rec'd	MAY 1 - 2008
CM	
File	

RE : KEOUGH'S HOT SPRINGS, BISHOP

On March 15th, 2008 we received a request for additional technical data pertaining to the issue of raising the temperatures in the discharge pools known as "Hot Ditch." We have; since our last letter to your office; implemented our proposed plan in order to test its viability. Enclosed you will find a data sheet showing the readings that we have recorded thus far. As well as a map (not to scale) plotting where the readings have been taking. Hopefully this will help you in understanding the data more. In addition we ask for a further review of our request for the grandfathering of our facility into the basin plan.

In review of the changes we have made I will include them as follows. Prior to the changes our facility always used two pumps to get the water from the ground level up into our spay bar which we use for water cooling and on the spray bar we had nearly 200 spay nozzles working during spay bar operation. We now use only one pump to propel the water to the spray bar and have lowered the amount of spay nozzles to 108. This process means that we use nearly 250 Gpm less water than we did prior to this change. Thus changing the ratio of out flow to unused water to create a higher temperature after mixing.

We hope that this report is satisfactory to your needs and helps us to further resolve this issue. With the changes that we have made "Hot Ditch" has become ever more popular, so one may assume that the water temperatures are more satisfactory to those using the discharge pools. We hope that our attempts have met the demands of all the parties involved. We would like to continue to monitor the changes that we have made for a minimum of 3 more months, in order to see if there is anything further that we can add or change to this plan. We feel at that time we could make a better decision together to see if this is enough or if we need to go further in our brainstorming for a solution.

Thank you for all input that you have had and any help that you have given in this matter.

Sincerely,



Gail Slee
Secretary

DATE	TIME	POOL, OUT FLOW	UNUSED	FLUME	PROP. LINE	AMBIENT	NOTES
10/10/07	2:16 PM	91.5	122.5	107	103	80	108 NOZZLES OPEN ON SPRAY BAR 6 OPEN TO HIGH FLOW
10/11/07	1:15 PM	88.5	120.5	103.5	100.5	73	SAME AS ABOVE / SLIGHT BREEZE
10/19/07	1:25 PM	91	122	105.5	102	80	108 NOZZLES OPEN 8 OPEN TO HIGH FLOW
10/20/08	12:48 PM	87	116	98.5	95.5	65	S.A.A. SLIGHT WIND/ FREE FLOW OPEN TO 3
11/21/08	10:30 AM	85	113	97.5	95	48	S.A.A. FREE FLOW 3/ POOL TEMP. 90
3/17/08	2:17 PM	85.5	115.5	99	93.5	64	S.A.A. / WINDY
3/18/08	2:22 PM	88/TRICKLE	121	112	102	68	POOL FILLING LITTLE OR NO OUT FLOW FROM THE POOL. 2 PUMPS RUNNING FREE FLOW OPEN TO 6
3/19/08	3:45 PM	88.5	121	104	98.5	72	108 NOZZELS 8 ON HIGH FRRE FLOW ON 1 POOL TEMP 90
3/24/08	10:00 AM	88.5	120.5	105	97	70	S.A.A.
4/1/08	4:17 PM	92 LOW FLOW	123	111.5	101.5	71	POOL FILLING DRAIN CLOSE LITTLE OUT FLOW
4/3/08	1:45 PM	89.5	120.5	105	98	63	WINDY FREE FLOW ON 1 POOL TEMP 90
4/4/08	2:35 PM	87.5	119.5	105.5	99.5	70	FREE FLOW ON 1 POOL TEMP 89
4/7/08	7:20 PM	88	120	105.5	99	72	S.A.A.
4/24/08	7:33 PM	86.5	119	108.5	98.5	60	POOL CLOSED FOR 1 1/2 HOUR. NO SPRAY BAR DISCHARGE IS ONLY OVER FLOW VISUAL. ESTIMATE IS ABOUT HALF THE USUAL. OUT FLOW VOLUME

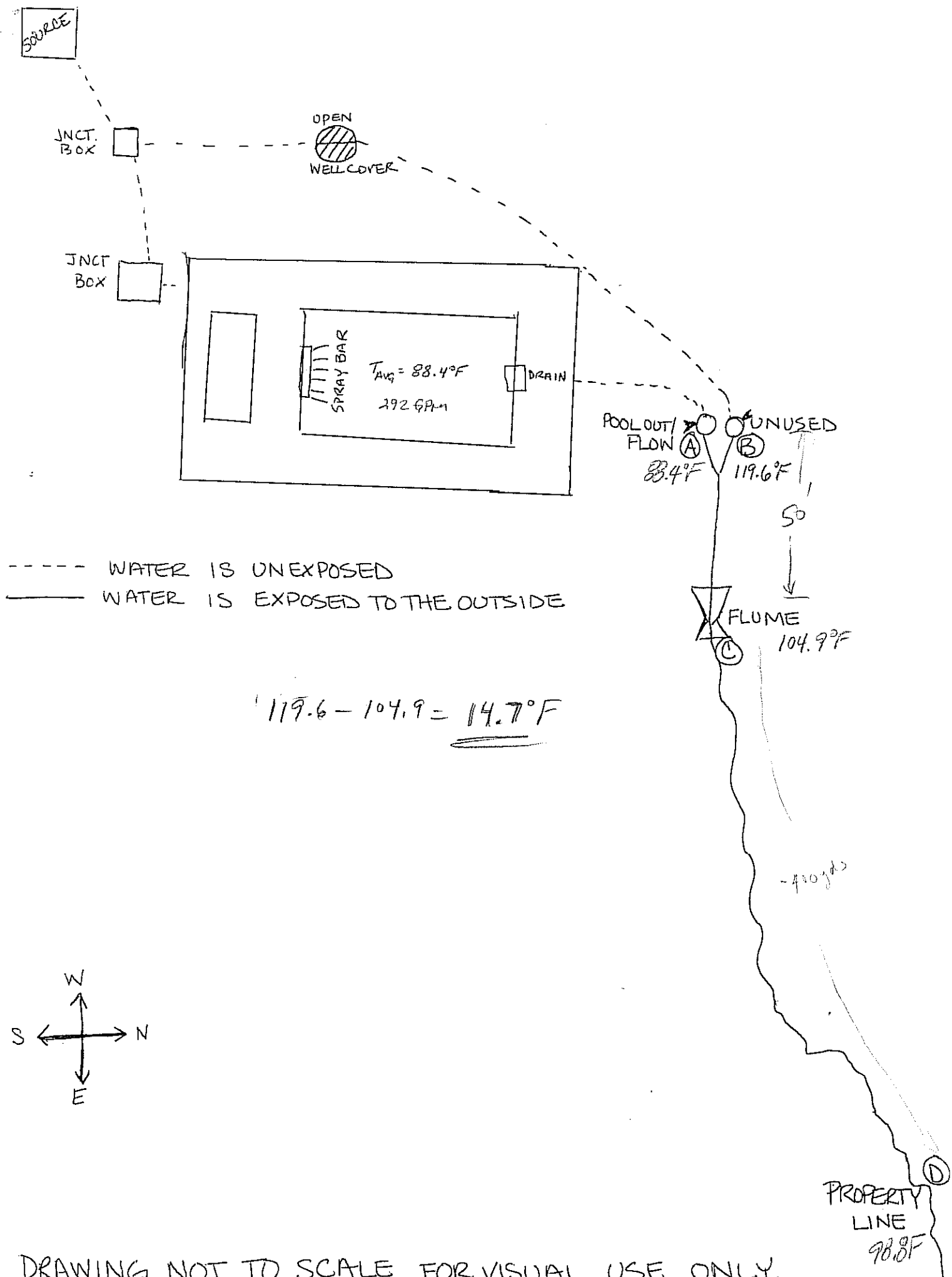

DRAWING NOT TO SCALE FOR VISUAL USE ONLY.



Linda S. Adams
Secretary for
Environmental Protection

California Regional Water Quality Control Board Lahontan Region

Victorville Office
14440 Civic Drive, Suite 200, Victorville, California 92392
(760) 241-6583 • Fax (760) 241-7308
<http://www.waterboards.ca.gov/lahontan>



Arnold Schwarzenegger
Governor

October 23, 2008

File: General - Keough's Resort

Robin Fisher
Brown's Supply, Inc.
219 Wye Road
Bishop, CA 93514

RESPONSE TO TECHNICAL REPORT IMPLEMENTATION, KEOUGH'S RESORT, BISHOP, INYO COUNTY

This is a follow-up to changes implemented at the Keough's Resort. The Resort has made changes in its pool operation with the purpose to increase temperatures in Keough's Hot Ditch. You provided a report dated April 25, 2008 including measures you were taking to decrease the affect on the temperature downstream in Hot Ditch from mixing of the cooler pool water. Your report indicates that the changes implemented have resulted in higher temperatures overall in Hot Ditch and you indicate you plan to continue to monitor temperatures resulting from the changes in operation. This letter requests you provide a report of the data collected to date for the pool operation and requests additional monitoring information.

Pool Operation

Your letter describes the changes made to minimize the cooling effect that the flow through pool water has on the mother springs by-pass water. The mother springs by-pass water is piped around the pool facilities. The pool flow and by-pass water are combined to form Keough's Hot Ditch. Keough's Hot Spring and the resort are located on land owned by the Los Angeles Department of Water and Power and is operated and maintained by a private party, the Brown family.

Prior to the changes, your facility used two pumps to get water from the ground level up into the spray bar, where approximately 200 spray nozzles were operated to cool the main pool. After the changes, you now use one pump to deliver the water to the spray bar and have lowered the amount of spray nozzles to 108. This means that you use nearly 250 gallons per minute less water than you did prior to the change. This changes the ratio of pool out flow to unused water, and creates a higher temperature in the mixed flow stream to Keough's Hot Ditch.

General Comments

You have requested we consider that the resort pools pre-date the Basin Plan and you have consistently operated the facility over the last several decades. Additionally, Keough's Hot Ditch was formed by flows created by development of the mother springs when the resort was first built. While we understand that a resort pool operation was

California Environmental Protection Agency

Recycled Paper



Thank you for your attention to this important matter. We appreciate working with you and the steps you have taken to address these issues. Please provide a progress and monitoring report by **February 20, 2009**, including the above information.

Sincerely,

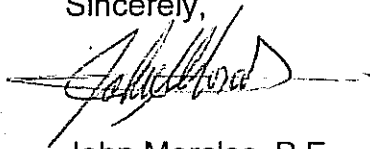

John Morales, P.E.
Water Resources Control Engineer

Attachment: Facility Map

cc: Teri Cawelti, Executive Director, Owens Valley Indian Water Commission
Marvin Moskowitz, Health Director, Inyo County Environmental Health Services
Clarence Martin, Los Angeles Department of Water and Power

JM/keoughs 9-08.doc

