

Jenks Laice 8-67

(253)

1992

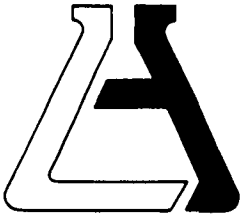

# ASSOCIATED LABORATORIES

806 North Batavia - Orange, California 92668 - 714/771-6900

FAX 714/538-1209

### CLIENT

California Regional Water  
Quality Control Board  
Attn: Nancy Martin  
2010 Iowa Ave. Suite 100  
Riverside, CA 92507

(1079) LAB NO. G36383-01  
REPORTED 09/14/92

### SAMPLE

Wastewater - H.S.

### RECEIVED

08/21/92

### IDENTIFICATION

Jenks lake #1 - Water Quality Assessment  
Date Collected 08/20/92 @ 1125 Hrs.  
As Submitted

### BASED ON SAMPLE

### STANDARD MINERAL ANALYSIS

<u>Constituent</u>	<u>Method</u>	<u>Results</u>
Alkalinity	SM 403	33 mg/l
Ammonia	EPA 350.2	ND <0.1 mg/l
Bicarbonates	SM 403	40 mg/l
Boron	SM 200.7	0.05 mg/l
Calcium	EPA 200.7	6.3 mg/l
Carbonates	SM 403	ND <1 mg/l
Chloride	A1000	1.5 mg/l
Electrical Conductivity	EPA 120.1	78 $\mu$ mhos/cm
Fluoride	EPA 200.7	0.19 mg/l
Iron	EPA 200.7	ND <0.007 mg/l
Magnesium	EPA 200.7	1.9 mg/l
Nitrate Nitrogen	B1011	ND <0.05 mg/l
pH	EPA 150.1	7.88
Potassium	EPA 200.7	0.7 mg/l
Sodium	EPA 200.7	6.0 mg/l
Sulfate	A1000	3.8 mg/l
Total Anions	Calculated	0.78 meq/l
Total Cations	Calcutated	0.75 meq/l
Total Dissolved Solids	EPA 160.1	62 mg/l
Total Hardness	Calculation	24 mg/l
Total Phosphate	EPA 365.2	ND <0.01 mg/l

Continued on Page 2



TESTING & CONSULTING  
Chemical •  
Microbiological •  
Environmental •

The reports of the Associated Laboratories are confidential property of our clients and may not be reproduced or used for publication in part or in full without our written permission. This is for the mutual protection of the public, our clients, and ourselves.

Client : California Regional Water  
Quality Control Board  
Lab No.: G36383-01

**COMBINED NUTRIENT ANALYSIS**

<u>Constituent</u>	<u>Method</u>	<u>Results</u>
Ammonia Nitrogen	EPA 350.2	ND <0.1 mg/l
Kjeldahl Nitrogen	EPA 351.3	0.8 mg/l
Nitrate Nitrogen	B1011	ND <0.02 mg/l
Nitrite Nitrogen	B1011	ND <0.03 mg/l
Organic Nitrogen	Calculation	0.8 mg/l
Total Nitrogen	Calculation	0.8 mg/l
Orthophosphate Phosphorus	EPA 365.2	0.01 mg/l
Total Phosphorus	EPA 365.2	ND <0.01 mg/l

<u>Constituent</u>	<u>Method</u>	<u>Results</u>
MBAS	EPA 425.1	ND <0.05 mg/l
Total Suspended Solids	EPA 160.2	4 mg/l
Total Coliform		5,000 MPN/100mls
Fecal Coliform		2,400 MPN/100mls
Fecal Strep.		2 MPN/100mls

**PESTICIDES & PCBs EPA 608**

All Compounds Were None Detected. See Attached List.

**PURGEABLE ORGANICS EPA 601**

All Compounds Were None Detected. See Attached List.

**PURGEABLE AROMATICS EPA 602**

All Compounds Were None Detected. See Attached List.

ASSOCIATED LABORATORIES: by:

*Robert A. Webber (RB)*  
Robert A. Webber  
Vice President

RAW/jaw  
Revised: 09/21/92  
By: RAW/klh



WQA  
FIELD FORM

DATE: 8/20/92

AIR TEMP: ~ 75° F

SAMPLER(S): HMS, MMS, DJB

WATER BODY: Jenkins Lake

SAMPLE LOCATION

#1: Far end of Lake (1125)

#2: Middle of lake (next to swimming area) (1135)

#3: end closest to entrance (1135)

#4: \_\_\_\_\_

H<sub>2</sub>O TEMP: #1 22.7

pH: #1 8.31

EC: #1 60 (200)

#2 23.0

#2 8.56

#2 70 (20)

#3 23.5

#3 8.35

#3 60 (25)

#4 \_\_\_\_\_

#4 \_\_\_\_\_

#4 \_\_\_\_\_

LAB ANALYSIS: M. aeruginosa

M. aeruginosa

Total Coliform

FSC

60/100

Fecal Coliform

M.B.P.S

0/0

Fecal Strept

COMMENTS: \_\_\_\_\_  
\_\_\_\_\_  
\_\_\_\_\_

## PURPOSE

The purpose of sampling Jenks Lake was to evaluate the existing water quality conditions of the lake. Sampling was performed to evaluate whether the Basin Plan Objectives and ISWP objectives are being met and if this lake is able to fully support the designated MUN and other beneficial uses (AGR,GWR,REC-1,REC-2,COLD,WILD). The Regional Board does not have previous data on this lake for comparison of these results.

## DISCUSSION

Upon evaluating the data only one constituent is not in compliance with Basin Plan Objectives. At all 3 sites the Total Coliform was not in compliance with the objective of 100/100 ml. At the farthest end of the lake the coliform levels are extremely high at 5000 MPN. The station next to the swimming area was the lowest with 280 MPN and the station closest to the entrance had 1600 MPN. The high coliforms may be due to the heavy recreational use which was going on throughout the lake. All organics and pesticides measured (601/602,608) were in compliance with Inland Surface Water Plan.

Overall, the water quality of the lake is in good condition. The lake could be sampled at a time of year when the recreational use was lower to see if the coliform levels drop with use.

Jenks Lake  
8/20/92

Constituent	Method	Results			MUN
		#1	#2	#3	BP Obj.
Alkalinity	SM 403	33	33	32	
Ammonia	EPA 350.2	ND	ND	ND	
Bicarbonates	SM403	40	40	39	
Boron	SM 200.7	0.05	ND	ND	0.75
Calcium	EPA 200.7	6.3	6.5	6.5	
Carbonates	SM 403	ND	ND	ND	
Chloride	A1000	1.5	1.5	1.5	10
EC	EPA 120.1	78	79	80	
Flouride	EPA 200.7	0.19	0.2	0.19	1
Iron	EPA 200.7	ND	ND	ND	0.3
Magnesium	EPA 200.7	1.9	2	2	
Nitrate-N	B1011	ND	ND	ND	
pH	EPA 150.1	7.88	8.14	8.05	
Potassium	EPA 200.7	0.7	0.7	0.8	
Sodium	EPA 200.7	6	6.1	6.2	30
Sulfate	A1000	3.8	4.2	4.1	20
Tl. Anions	Calc.	0.78	0.79	0.77	
Tl. Cations	Calc.	0.75	0.77	0.78	
TDS	EPA 160.1	62	66	58	200
Tl. Hardness	Calc.	24	24	24	100
Tl. Phosphate	EPA 365.2	ND	0.03	ND	
Ammonia-N	EPA 350.2	ND	ND	ND	0.025
Kjeldahl-N	EPA 351.3	0.8	1	1	
Nitrate-N	B1011	ND	ND	ND	10
Nitrite-N	B1011	ND	ND	ND	
Organic-N	Calc.	0.8	1	1	
Tl. Nitrogen	EPA 350.2	0.8	1	1	
Ortho-phos	EPA 365.2	0.01	0.01	0.01	
Tl. Phos	EPA 365.2	ND	0.03	ND	
MBAS	EPA 425.1	ND	ND	ND	0.5
Tl. Coliform		5000	280	1600	100
Fec. Coliform		2400	90	1600	
Fecal Strep		2	<2	<2	
TSS		4	0.03	11	
608,601/602		ND	ND	ND	
Temp.		22.7	23	23.5	
pH		8.31	8.56	8.35	
EC		60	70	60	



\* Get more labels  
\* Don't Forget Eau

Jenks Lake (3 samples)

8/20/92

Minerals / TSS / MBAS - 3

Nutrients - 3+3

CO<sub>2</sub> / CO<sub>2</sub> - 6

CO<sub>2</sub> - 3

Total Coli / Fecal Coli / Fecal Strep - 6

Plunge Creek (4 samples)

MBAS / Minerals - 4

7+7. Nutrients - 4+4

Fecal Coli / Total Coli / Fecal Strep / Enterococcus -  $\frac{8}{14}$

- Jenks Lake #1 (1125) 75°

EC 60

Temp (26) 22.7

pH 8.31

JL #3 1155

J.L. #2 1135

pH 8.35

EC 70

temp 23.5 (25)

pH 8.56

EC 60

Temp 23 (26)



DETAIL

SAN BERNARDINO

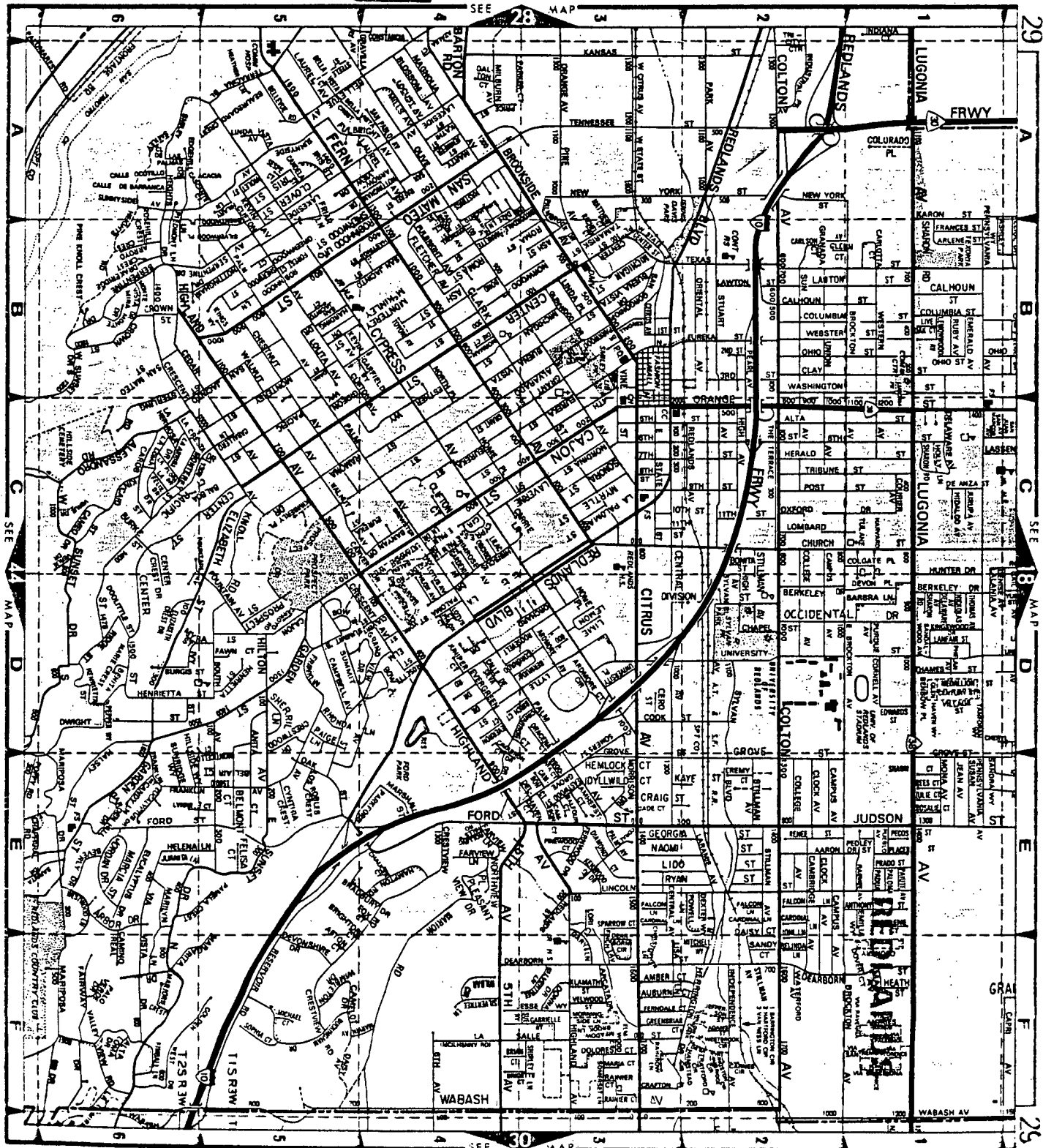

SEE MAP 28

29

A

B

C

D

E

25

SEE MAP 30

PRIVILEGE © 1987 BY Thomas Best Maps

COPYRIGHT © 1987 BY Thomas Best Maps

SEE MAP 28

30

WABASH

WABASH

WARREN ST  
COPYRIGHT © 1987 BY Thomas Bros Maps

30  
COPYRIGHT © 1987 BY Thomas Bros Maps

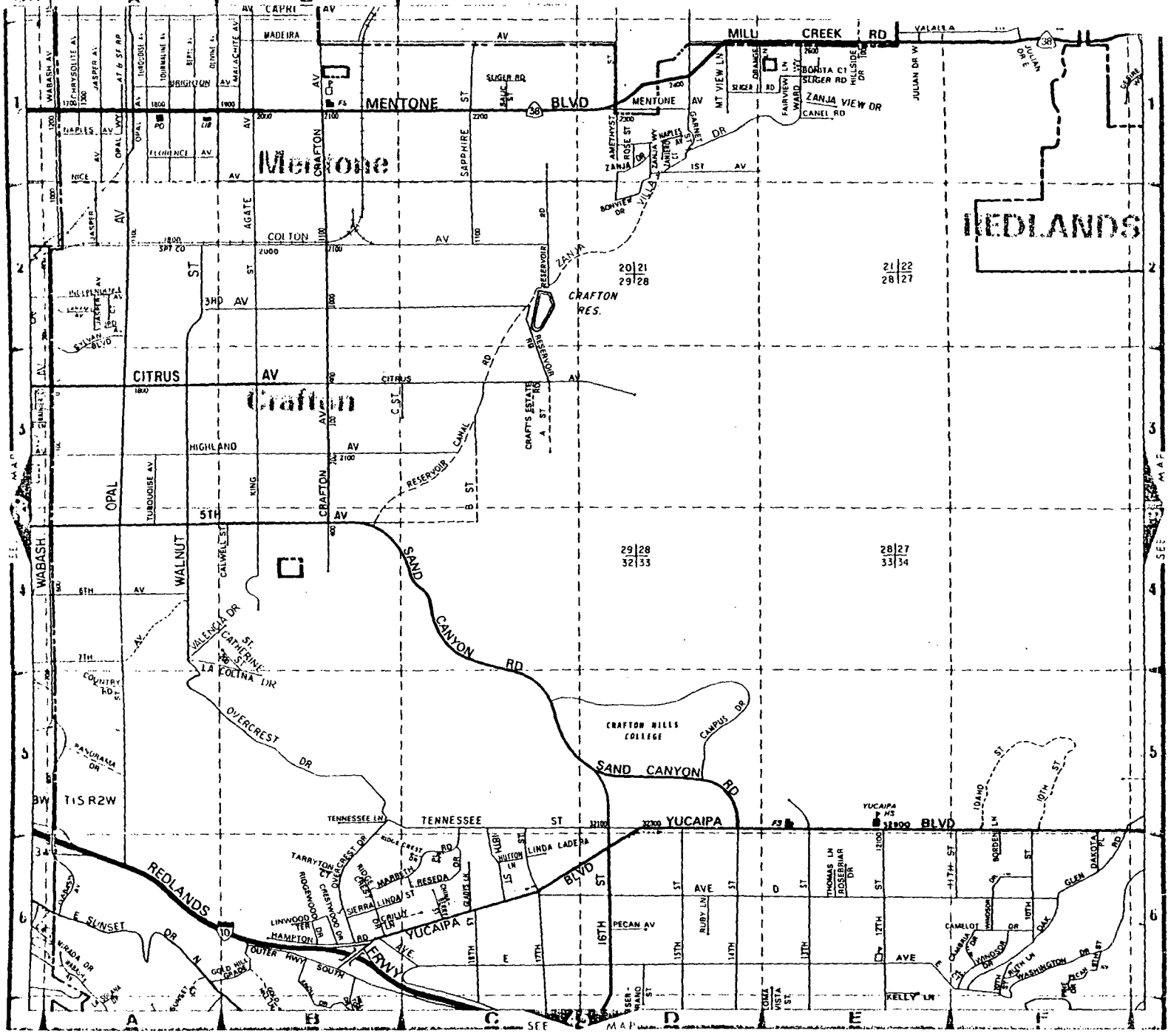

SEE

SEE

SEE

SEE

SEE

SEE

SEE

SEE

SEE

SEE

SEE

HIGHLANDS

22 23  
27 26

23 24  
26 25

27 26  
34 36

26 25  
35 36

YUCAIPA REGIONAL PARK  
FLAGHILL ROAD SIDE REST

OAK GLEN RD

MOUSLEY MUSEUM OF NATURAL HISTORY

YUCAIPA

BLVD

YUCAIPA

TIS  
T2S

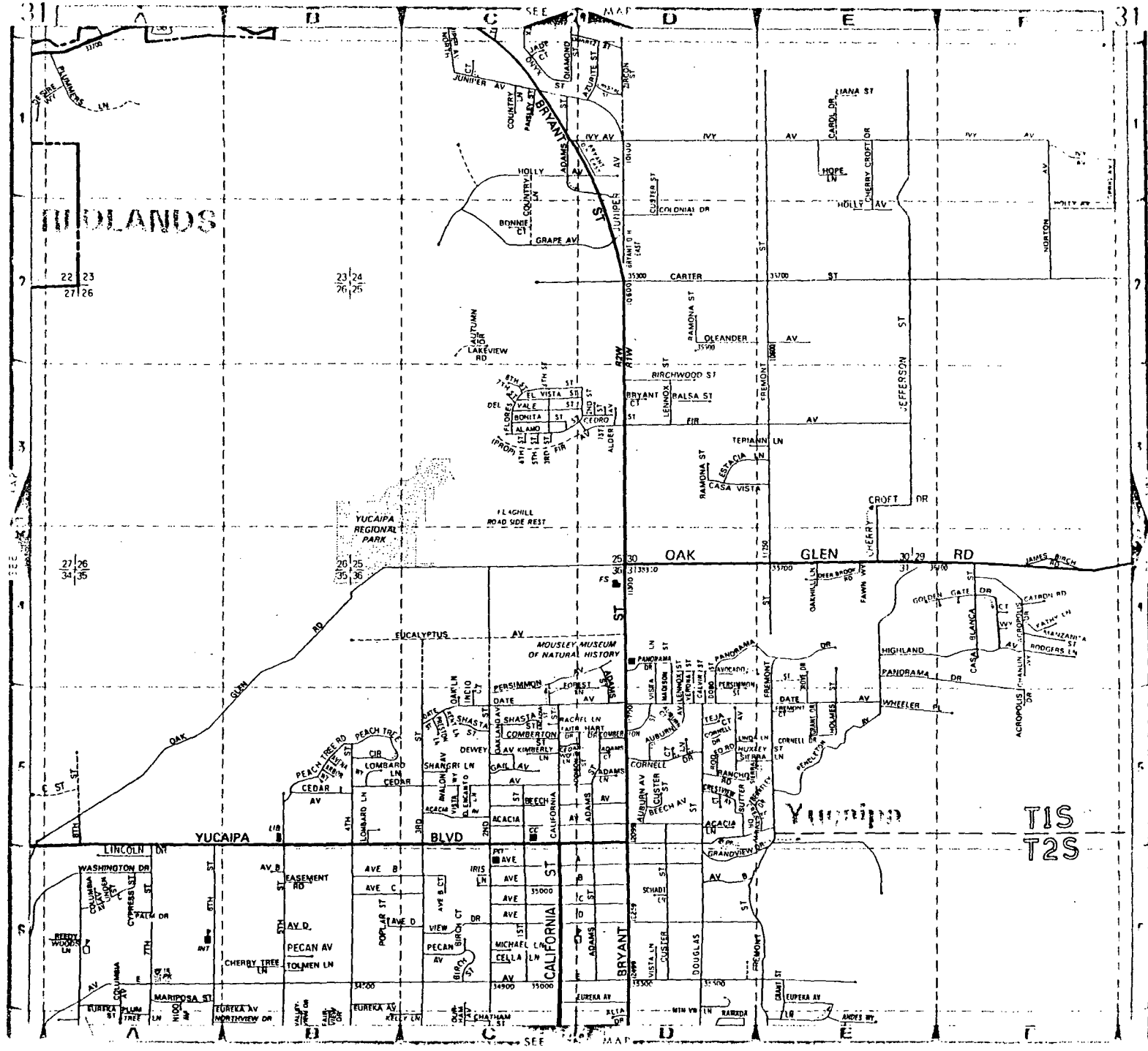

COPYRIGHT © 1987 BY Thomas Don Map

COPYRIGHT © 1987 BY Thomas Don Map

COPYRIGHT © 1987 BY *Thomas Bros. Maps* — Z

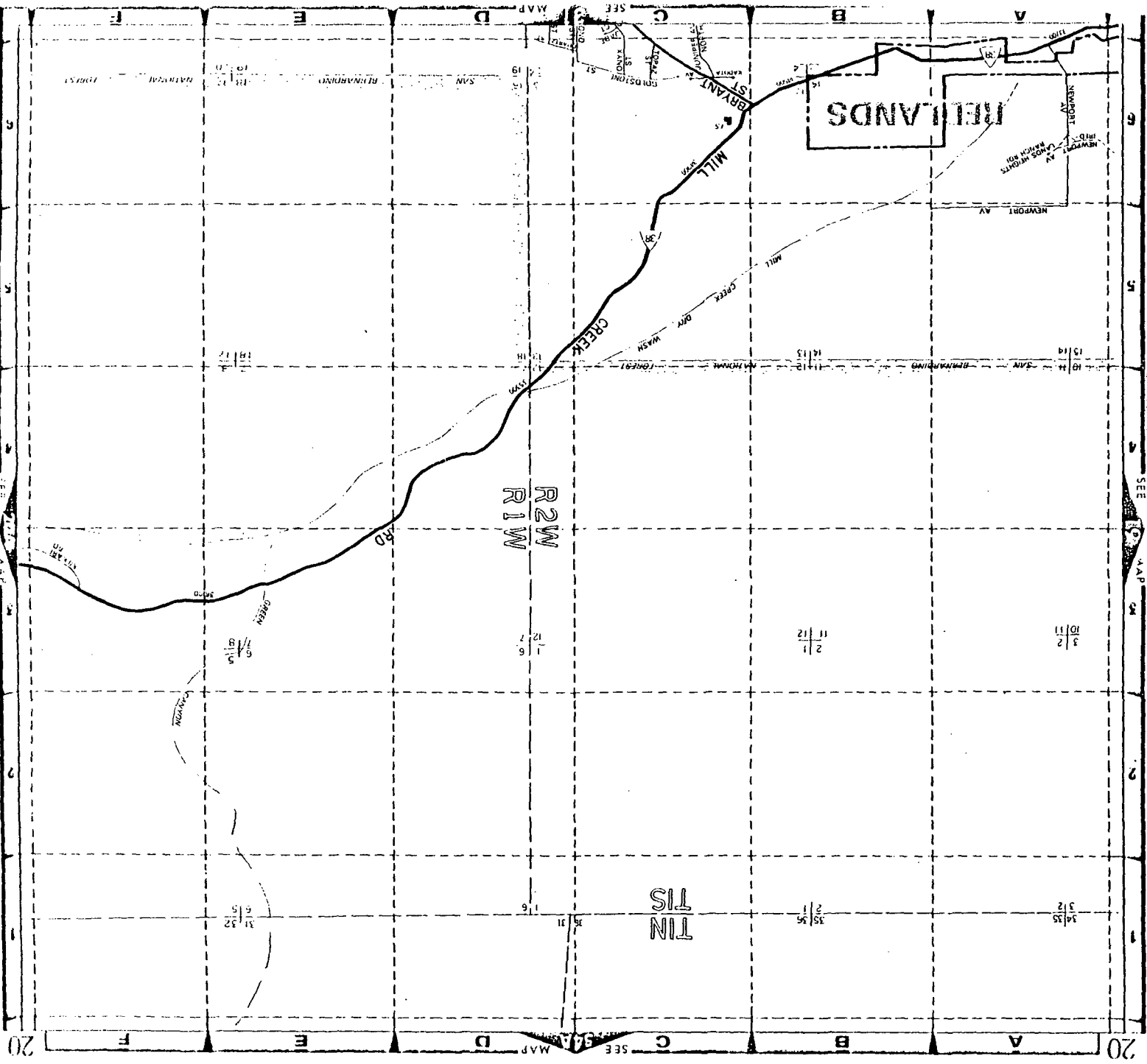

20

20





LABORATORY	ASSOCIATED	PROJECT MANAGER	HOPE SMYTHE
FUNCTION	PLANNING	PHONE NUMBER	782-4493
PROJECT NAME	WATER QUALITY ASSESSMENT		
		SAMPLERS: (Signature)	<i>Michelle Shaughey</i>

SAMPLE NUMBER	LOCATION DESCRIPTION	DATE	TIME	SAMPLE TYPE			SOLID	NO. OF CNTNRS	TESTS REQUIRED
				WATER		AIR			
				Comp.	Grab.				
1	Jenks Lake #1	8/20/92	1125		✓			8	Minerals, TSS, MBAS, Nutrients, 601/602, 603, Total Coli, Fecal Coli, Fecal strep
2	Jenks Lake #2	8/20/92	1135		✓			8	"
3	Jenks Lake #3	8/20/92	1155		✓			8	"

Collected by: (Signature)	<i>Michelle Shaughey</i>		Received by: (Signature)		Date/Time	
Collected by: (Signature)			Received by: (Signature)		Date/Time	
Collected by: (Signature)			Received by Mobile Laboratory for field analysis: (Signature)		Date/Time	
Collected by: (Signature)	Date/Time	Received for Laboratory by:			Date/Time	
Method of Shipment:						
Special Instructions:						TASK CODE

ESTIMATED COST  
\$ 1405.50

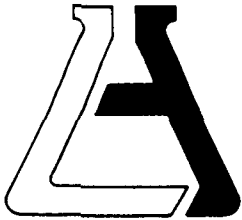

# ASSOCIATED LABORATORIES

806 North Batavia - Orange, California 92668 - 714/771-6900

FAX 714/538-1209

## CLIENT

California Regional Water  
Quality Control Board  
Attn: Nancy Martin  
2010 Iowa Ave. Suite 100  
Riverside, CA 92507

(1079) LAB NO. G36383-02  
REPORTED 09/14/92

## SAMPLE

Wastewater - H.S.

## RECEIVED

08/21/92

## IDENTIFICATION

Jenks Lake #2 - Water Quality Assessment  
Date Collected 08/20/92 @ 1135 Hrs.  
As Submitted

## BASED ON SAMPLE

### STANDARD MINERAL ANALYSIS

<u>Constituent</u>	<u>Method</u>	<u>Results</u>
Alkalinity	SM 403	33 mg/l
Ammonia	EPA 350.2	ND <0.1 mg/l
Bicarbonates	SM 403	40 mg/l
Boron	SM 200.7	ND <0.01 mg/l
Calcium	EPA 200.7	6.5 mg/l
Carbonates	SM 403	ND <1 mg/l
Chloride	A1000	1.5 mg/l
Electrical Conductivity	EPA 120.1	79 $\mu$ mhos/cm
Fluoride	EPA 200.7	0.20 mg/l
Iron	EPA 200.7	ND <0.007 mg/l
Magnesium	EPA 200.7	2.0 mg/l
Nitrate Nitrogen	B1011	ND <0.05 mg/l
pH	EPA 150.1	8.14
Potassium	EPA 200.7	0.7 mg/l
Sodium	EPA 200.7	6.1 mg/l
Sulfate	A1000	4.2 mg/l
Total Anions	Calculated	0.79 meq/l
Total Cations	Calculated	0.77 meq/l
Total Dissolved Solids	EPA 160.1	66 mg/l
Total Hardness	Calculation	24 mg/l
Total Phosphate	EPA 365.2	0.03 mg/l

Continued on Page 2

SAWPA DES



001004938

TESTING & CONSULTING

Chemical •  
Microbiological •  
Environmental •

The reports of the Associated Laboratories are confidential property of our clients and may not be reproduced or used for publication in part or in full without our written permission. This is for the mutual protection of the public, our clients, and ourselves.

Client : California Regional Water  
Quality Control Board  
Lab No.: G36383-02

**COMBINED NUTRIENT ANALYSIS**

<u>Constituent</u>	<u>Method</u>	<u>Results</u>
Ammonia Nitrogen	EPA 350.2	ND <0.1 mg/l
Kjeldahl Nitrogen	EPA 351.3	1.0 mg/l
Nitrate Nitrogen	B1011	ND <0.02 mg/l
Nitrite Nitrogen	B1011	ND <0.03 mg/l
Organic Nitrogen	Calculation	1.0 mg/l
Total Nitrogen	Calculation	1.0 mg/l
Orthophosphate Phosphorus	EPA 365.2	0.01 mg/l
Total Phosphorus	EPA 365.2	0.03 mg/l

<u>Constituent</u>	<u>Method</u>	<u>Results</u>
MBAS	EPA 425.1	ND <0.05 mg/l
Total Suspended Solids	EPA 160.2	0.03 mg/l
Total Coliform		280 MPN/100mls
Fecal Coliform		90 MPN/100mls
Fecal Strep.		<2 MPN/100mls

**PESTICIDES & PCBs EPA 608**

All Compounds Were None Detected. See Attached List.

**PURGEABLE ORGANICS EPA 601**

All Compounds Were None Detected. See Attached List.

**PURGEABLE AROMATICS EPA 602**

All Compounds Were None Detected. See Attached List.

ASSOCIATED LABORATORIES: by:

*Robert A. Webber (RB)*  
Robert A. Webber  
Vice President

RAW/jaw  
Revised: 09/21/92  
By: RAW/klh





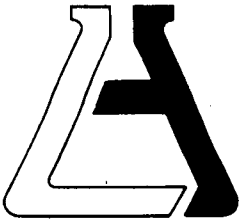

**ASSOCIATED LABORATORIES**

806 North Batavia - Orange, California 92668 - 714/771-6900

FAX 714/538-1209

CLIENT

California Regional Water  
Quality Control Board  
Attn: Nancy Martin  
2010 Iowa Ave. Suite 100  
Riverside, CA 92507

(1079)

LAB NO.

G36383-03

REPORTED

09/14/92

SAMPLE

Wastewater - H.S.

RECEIVED

08/20/92

IDENTIFICATION

Jenks Lake #3 - Water Quality Assessment

Date Collected 08/20/92 @ 1155 Hrs.

As Submitted

BASED ON SAMPLE

**STANDARD MINERAL ANALYSIS**

<u>Constituent</u>	<u>Method</u>	<u>Results</u>
Alkalinity	SM 403	32 mg/l
Ammonia	EPA 350.2	ND <0.1 mg/l
Bicarbonates	SM 403	39 mg/l
Boron	SM 200.7	ND <0.01 mg/l
Calcium	EPA 200.7	6.5 mg/l
Carbonates	SM 403	ND <1 mg/l
Chloride	A1000	1.5 mg/l
Electrical Conductivity	EPA 120.1	80 $\mu$ mhos/cm
Fluoride	EPA 200.7	0.19 mg/l
Iron	EPA 200.7	ND <0.007 mg/l
Magnesium	EPA 200.7	2.0 mg/l
Nitrate Nitrogen	B1011	ND <0.05 mg/l
pH	EPA 150.1	8.05
Potassium	EPA 200.7	0.8 mg/l
Sodium	EPA 200.7	6.2 mg/l
Sulfate	A1000	4.1 mg/l
Total Anions	Calculated	0.77 meq/l
Total Cations	Calculated	0.78 meq/l
Total Dissolved Solids	EPA 160.1	58 mg/l
Total Hardness	Calculation	24 mg/l
Total Phosphate	EPA 365.2	ND <0.01 mg/l

Continued on Page 2

SAWPA DES



001004940

TESTING & CONSULTING

Chemical •

Microbiological •

Environmental •

The reports of the Associated Laboratories are confidential property of our clients and may not be reproduced or used for publication in part or in full without our written permission. This is for the mutual protection of the public, our clients, and ourselves.

Client : California Regional Water  
Quality Control Board  
Lab No.: G36383-03

**COMBINED NUTRIENT ANALYSIS**

<u>Constituent</u>	<u>Method</u>	<u>Results</u>
Ammonia Nitrogen	EPA 350.2	ND <0.1 mg/l
Kjeldahl Nitrogen	EPA 351.3	1.0 mg/l
Nitrate Nitrogen	B1011	ND <0.02 mg/l
Nitrite Nitrogen	B1011	ND <0.03 mg/l
Organic Nitrogen	Calculation	1.0 mg/l
Total Nitrogen	Calculation	1.0 mg/l
Orthophosphate Phosphorus	EPA 365.2	0.01 mg/l
Total Phosphorus	EPA 365.2	ND <0.01 mg/l

<u>Constituent</u>	<u>Method</u>	<u>Results</u>
MBAS	EPA 425.1	ND <0.05 mg/l
Total Suspended Solids	EPA 160.2	11 mg/l
Total Coliform		1,600 MPN/100mls
Fecal Coliform		1,600 MPN/100mls
Fecal Strep.		<2 MPN/100mls

**PESTICIDES & PCBs EPA 608**

All Compounds Were None Detected. See Attached List.

**PURGEABLE ORGANICS EPA 601**

All Compounds Were None Detected. See Attached List.

**PURGEABLE AROMATICS EPA 602**

All Compounds Were None Detected. See Attached List.

ASSOCIATED LABORATORIES: by:

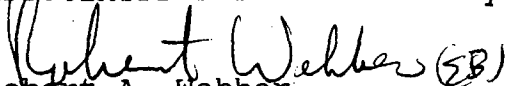
  
Robert A. Webber  
Vice President

RAW/jaw  
Revised: 09/21/92  
By: RAW/klh

SAWPA DES



001004941



Client : California Regional Water  
Quality Control Board  
Lab No.: G36383

PURGEABLE ORGANICS - EPA METHOD 601

LIMITS OF DETECTION  
( $\mu\text{g/l}$ )

Chloromethane	ND <0.001
Bromomethane	ND <0.001
Dichlorodifluoromethane	ND <0.001
Vinyl chloride	ND <0.001
Chloroethane	ND <0.001
Methylene chloride	ND <0.001
Trichlorofluoromethane	ND <0.001
1,1-Dichloroethene	ND <0.001
1,1-Dichloroethane	ND <0.001
trans-1,2-Dichloroethene	ND <0.001
Chloroform	ND <0.001
1,2-Dichloroethane	ND <0.001
1,1,1-Trichloroethane	ND <0.001
Carbon tetrachloride	ND <0.001
Bromodichloromethane	ND <0.001
1,2-Dichloropropane	ND <0.001
trans-1,3-Dichloropropene	ND <0.001
Trichloroethene	ND <0.001
Dibromochloromethane	ND <0.001
1,1,2-Trichloroethane	ND <0.001
cis-1,3-Dichloropropene	ND <0.001
2-Chloroethylvinyl ether	ND <0.001
Bromoform	ND <0.001
1,1,2,2-Tetrachloroethane	ND <0.001
Tetrachloroethene	ND <0.001
Chlorobenzene	ND <0.001
1,3-Dichlorobenzene	ND <0.001
1,2-Dichlorobenzene	ND <0.001
1,4-Dichlorobenzene	ND <0.001

EPA METHOD 602

LIMITS OF DETECTION

Benzene	ND <0.001
Chlorobenzene	ND <0.001
1,2-Dichlorobenzene	ND <0.001
1,3-Dichlorobenzene	ND <0.001
1,4-Dichlorobenzene	ND <0.001
Ethylbenzene	ND <0.001
Toluene	ND <0.001
Total Xylenes	ND <0.001

SAWPA DES  
  
001004942



Client : California Regional Water  
Quality Control Board  
Lab No.: G36383

LIMITS OF DETECTION  
(micrograms/liter)

EPA METHOD 608

Aldrin	0.01
c - BHC	0.01
Chlordane	0.1
DDD	0.04
DDE	0.02
DDT	0.04
Dieldrin	0.02
Endrin	0.02
Toxaphene	0.1
Heptachlor	0.01
Heptachlor Epoxide	0.01
Methoxychlor	0.1
PCB 1232	0.1
PCB 1242	0.1
PCB 1254	0.1
PCB 1260	0.1
PCB 1016	0.1
PCB 1221	0.1
PCB 1248	0.1
b - BHC	0.02
a - BHC	0.01
d - BHC	0.02
Endosulfan I	0.05
Endosulfan II	0.1
Endosulfan Sulfate	0.1

SAWPA DES



001004943

