

**STATE OF CALIFORNIA
REGIONAL WATER QUALITY CONTROL BOARD
CENTRAL COAST REGION**

SUPPLEMENTAL SHEET FOR REGULAR MEETING OF MAY 12-13, 2010

Prepared on May 3, 2010

ITEM NUMBER: 15

**SUBJECT: Consideration of Closure for San Paso Truck and Auto,
81 Wellsona Road, Paso Robles**

DISCUSSION

This supplemental sheet transmits Figure 1 (Vicinity Map) of the above-referenced item. The map was inadvertently left out of the initial mailing. This sheet also amends the attachments section of the staff report as follows in *italics*:

Attachments

Attachment 1: State Water Board September 2007 Case Review
Attachment 2: State Water Board December 2008 Case Review
Attachment 3: State Water Board April 2010 Case Review
Attachment 4: March 2010 Letter from Gerard Martorano
Attachment 5: March 17, 2010 Central Coast Water Board staff response to March 2010 letter
Attachment 6: Stantec's April 13, 2010 Evaluation of Remedial Progress
Figure 1: Vicinity Map

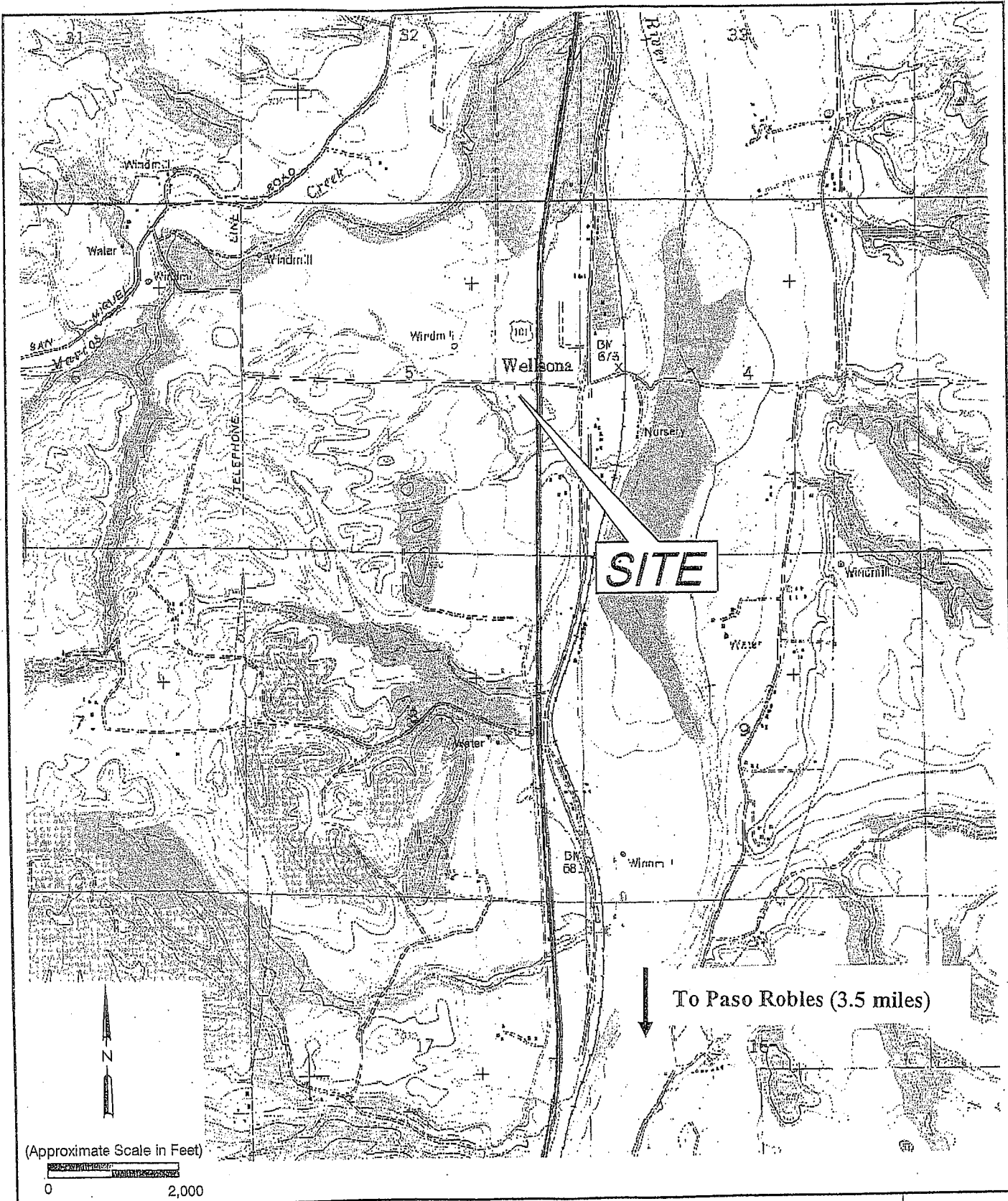

(Approximate Scale in Feet)
 0 2,000

FOR: SAN PASO TRUCK AND AUTO 81 WELLSONA RD PASO ROBLES, CA		VICINITY MAP		FIGURE: 1	
JOB NUMBER: 10CT_06222.00	DRAWN BY: SCS	CHECKED BY: SL	APPROVED BY: SL	DATE: 10/6/2008	