



Central Valley Regional Water Quality Control Board

CLEAN WATER ACT SECTION 401 WATER QUALITY CERTIFICATION AND ORDER

| | |
|--|------------------------------|
| Effective Date: 12 June 2019 | Reg. Meas. ID: 430503 |
| Expiration Date: 12 June 2024 | Place ID: 858920 |
| Program Type: Fill/Excavation | WDID: 5A45CR00575 |
| Project Type: Residential | NWP: 3 & 13 |
| Project: Lakey Emergency Home Stabilization and Foundation Repair Project (Project) | |
| Applicant: Martin Lakey | |
| Applicant Contact: Martin Lakey P.O. Box 682 Fall River Mills, CA 96028 Phone: (530) 945-3513 Email: martinlakey@icloud.com | |
| Applicant's Agent: Kristine Cloward VESTRA Resources 5300 Aviation Drive Redding, CA 96002 Phone: (530) 223-2585 Email: kcloward@vestra.com | |
| Water Board Staff: Dani Berchtold Sanitary Engineering Associate 364 Knollcrest Drive, Suite 205 Redding, CA 96002 Phone: (530) 224-4783 Email: Dannas.Berchtold@waterboards.ca.gov | |
| Water Board Contact Person: If you have any questions, please call Central Valley Regional Water Quality Control Board (Central Valley Water Board) Staff listed above or (530) 224-4845 and ask to speak with the Water Quality Certification Unit Supervisor. | |

Table of Contents

I. Order 3

II. Public Notice 3

III. Project Purpose..... 3

IV. Project Description 3

V. Project Location..... 4

VI. Project Impact and Receiving Waters Information 4

VII. Description of Direct Impacts to Waters of the State..... 5

VIII. Description of Indirect Impacts to Waters of the State – Not applicable 5

IX. Avoidance and Minimization – Not applicable..... 5

X. Compensatory Mitigation 5

XI. California Environmental Quality Act (CEQA) 5

XII. Petitions for Reconsideration..... 5

XIII. Fees Received 6

XIV. Conditions 6

XV. Water Quality Certification 15

- Attachment A** Project Map
- Attachment B** Receiving Waters, Impact, and Mitigation Information
- Attachment C** CEQA Findings of Facts
- Attachment D** Report and Notification Requirements
- Attachment E** Signatory Requirements
- Attachment F** Certification Deviation Procedures

I. Order

This Clean Water Act (CWA) section 401 Water Quality Certification action and Order (Order) is issued at the request of Martin Lakey (hereinafter Permittee) for the Project. This Order is for the purpose described in the application submitted by the Permittee. The application was received on 23 April 2019. The application was deemed complete on 15 May 2019.

II. Public Notice

The Central Valley Water Board provided public notice of the application pursuant to California Code of Regulations, title 23, section 3858 from 26 April 2019 to 17 May 2019. The Central Valley Water Board did not receive any comments during the comment period.

III. Project Purpose

The purpose of the project is to stabilize the portion of the Lakey residence overhanging Fall River and replace the damaged foundation of the residence. Erosion underneath the foundation of the home resulted in the failure of the home foundation during the week of December 10, 2018. The remaining portion of the home was held up only by a few thin steel piles. Without immediate stabilization, the portion of the home overhanging the river was in danger of collapsing into Fall River.

IV. Project Description

Immediate actions required to stabilize the home included the installation of two 16-inch-diameter steel piles underneath the home and the placement of a 41-foot steel beam across the piles to return the overhanging portion of the home to the correct elevation. The work was completed using an excavator with a pile driver attachment. To access the work area on the downstream (western) side of the home, quarter-ton rock slope protection (RSP) was placed to provide a working pad for the excavator.

Quarter-ton (18-24") RSP was placed using the thumb of an excavator operated on the bank of Fall River. Approximately 39 cubic yards of RSP was placed below the ordinary high-water mark (OHWM) along 32 linear feet of Fall River for equipment access. The area of RSP below the OHWM of Fall River is currently approximately 0.006 acres. To install the pipe piles underneath the residence, a hollow pipe casing was installed first, and the water was pumped from the casing using a hose and pump. The water was pumped to the field across the driveway from the home where it could infiltrate into the soil of the field. The steel pipe piles were driven into the hollow casings using an excavator with a pile driver attachment. The 41-foot steel crossbeam was placed on top of the piles using an excavator.

The placement of RSP in the river occurred over one working day and the placement of the piles and the beam occurred over five days including equipment staging and preparation. In-water work for these activities occurred for three workdays. The emergency phase of the work was completed on 9 January 2019.

Now that the home is stabilized, the foundation underneath the home needs to be replaced so that it does not collapse into Fall River. To replace the foundation, the contractor will need to dewater the area immediately adjacent to the foundation. A cofferdam will be constructed from approximately 7.3 cubic yards of sand bags and visqueen underneath the cantilevered portion of the home. The area within the cofferdam will be dewatered using a pump. A screened intake hose will be placed within the cofferdam area and the pump will be operated on the bank of the river. The water will be pumped into a field across the residence driveway so that the water does not flow back into Fall River.

After the area is dewatered, the existing foundation will be removed using a mini excavator. The excavator will be operated on the bank of Fall River on the downstream side of the home. If the mini excavator must be operated within the dewatered area, it will be operated on mats to minimize soil disturbance. After removal of the failed foundation, the underlying bank will need to be excavated to competent material (estimated to be approximately 3 feet in depth). The limits of excavation will be approximately one foot beyond the existing foundation line. Approximately 0.75 cubic yards of bank material will be excavated outside of the limits of the existing foundation and within the current OHWM of the river. Excavation will be followed by forming the foundation in the same lines as the original foundation, and pouring structural concrete up to an elevation (approximately 6 feet) from which treated wood sills and wedges can be placed to support the floor joists of the home in their original line and elevation. The concrete forms will be removed, and the excavated area will be backfilled with 0.75 cubic yards of clean washed 1-½ to ¾-inch rock.

The dewatered area will be rewatered by siphoning water from Fall River into the dewatered area. When there is equal pressure on either side of the sand bag cofferdam, the sand bags will be removed. The foundation repair activities are estimated to take 5 to 10 working days.

The area impacted by the cofferdam, dewatering, and excavation and backfill below the OHWM of Fall River is approximately 0.003 acres and all impacts in this area will be temporary. All foundation removal and replacement is above the OHWM of Fall River which is located at the foundation line of the home.

After completion of the foundation repairs, approximately 7 cubic yards of excess rock that was placed into Fall River below the OHWM for equipment access will be redistributed along the bank upstream of the current rock area for additional bank protection. The rock will be redistributed so the final area of rock fill in Fall River will be approximately 39 feet long and 5 feet wide (195 square feet or 0.003 acres). See PD-1 on Figure 2 for the final proposed RSP fill area. The volume of rock beneath the OHWM of the river will be less than 39 cubic yards. The rock will be moved using an excavator operated on the bank of Fall River. Rock removed from the river will be removed using clean scoops, avoiding excavation of native bank material.

V. Project Location

Address: 42079 River Bank Road, Fall River Mills, CA

County: Shasta

Nearest City: Fall River Mills

Section 2, Township 37 North, Range 4 East, MDB&M.

Latitude: 41.073975° and Longitude: -121.482628°

A map showing the Project location is found in Attachment A of this Order.

VI. Project Impact and Receiving Waters Information

The Project is located within the jurisdiction of the Central Valley Water Board. Receiving waters and groundwater potentially impacted by this Project are protected in accordance with the Water Quality Control Plan for the Sacramento River and San Joaquin River Basins, Fifth Edition, May 2018 (Basin Plan). The plan for the region and other plans and policies may be accessed online at: http://www.waterboards.ca.gov/plans_policies/. The Basin Plan includes water quality standards, which consist of existing and potential beneficial uses of waters of the

state, water quality objectives to protect those uses, and the state and federal antidegradation policies.

It is the policy of the State of California that every human being has the right to safe, clean, affordable, and accessible water adequate for human consumption, cooking, and sanitary purposes. This Order promotes that policy by requiring discharges to meet maximum contaminant levels designed to protect human health and ensure that water is safe for domestic use.

Project impact and receiving waters information can be found in Attachment B. Table 1 of Attachment B shows the receiving waters and beneficial uses of waters of the state impacted by the Project. Individual impact location and quantity is shown in Table 2 of Attachment B.

VII. Description of Direct Impacts to Waters of the State

Total Project fill/excavation quantities for all impacts are summarized in Table 1. Permanent impacts are categorized as those resulting in a physical loss in area and also those degrading ecological condition.

| Table 1: Total Project Fill/Excavation Quantity | | | | | | | | | |
|---|-------------------------------|-----------------|-----------------|-----------------------|-------|----|-------------------------------------|----|----|
| Aquatic Resource Type | Temporary Impact ¹ | | | Permanent Impact | | | | | |
| | | | | Physical Loss of Area | | | Degradation of Ecological Condition | | |
| | Acres | CY ² | LF ² | Acres | CY | LF | Acres | CY | LF |
| Stream Channel | 0.006 | | 68 | 0.003 | 39.75 | 39 | | | |

VIII. Description of Indirect Impacts to Waters of the State – Not applicable

IX. Avoidance and Minimization – Not applicable

X. Compensatory Mitigation

No compensatory mitigation was required for permanent impacts due to the scope and nature of the impacts and the waterbody affected. To the extent feasible, the Permittee is required to restore and stabilize the area following disturbance.

XI. California Environmental Quality Act (CEQA)

On 6 June 2019 the Central Valley Water Board signed a Notice of Exemption granting exemption for California Code of Regulations, Title 14, section(s) 15302 (Replacement or Reconstruction) and 15304 (Minor Alterations to Land). .. Pursuant to CEQA, the Central Valley Water Board has made Findings of Facts (Findings) which support the issuance of this Order and are included in Attachment C.

XII. Petitions for Reconsideration

Any person aggrieved by this action may petition the State Water Resources Control Board to reconsider this Order in accordance with California Code of Regulations, Title 23, section 3867. A petition for reconsideration must be submitted in writing and received within 30 calendar days of the issuance of this Order.

¹ Includes only temporary direct impacts to waters of the state and does not include upland areas of temporary disturbance which could result in a discharge to waters of the state.

² Cubic Yards (CY); Linear Feet (LF)

XIII. Fees Received

An application fee of \$1,638.00 was received on 23 April 2019. The fee amount was determined as required by California Code of Regulations, Title 23, sections 3833(b)(3) and 2200(a)(3), and was calculated as Category E - Low Impact Discharges (fee code 87) with the dredge and fill fee calculator.

XIV. Conditions

The Central Valley Water Board has independently reviewed the record of the Project to analyze impacts to water quality and designated beneficial uses within the watershed of the Project. In accordance with this Order, the Permittee may proceed with the Project under the following terms and conditions:

A. Authorization

Impacts to waters of the state shall not exceed quantities shown in Table 1.

B. Reporting and Notification Requirements

The following section details the reporting and notification types and timing of submittals. Requirements for the content of these reporting and notification types are detailed in Attachment D, including specifications for photo and map documentation during the Project. Written reports and notifications must be submitted using the Reporting and Notification Cover Sheet located in Attachment D, which must be signed by the Permittee or an authorized representative.

The Permittee must submit all notifications, submissions, materials, data, correspondence, and reports in a searchable Portable Document Format (PDF). Documents less than 50 MB must be emailed to: centralvalleyredding@waterboards.ca.gov.

In the subject line of the email, include the Central Valley Water Board Contact, Project name, and WDID. Documents that are 50 MB or larger must be transferred to a disk and mailed to the Central Valley Water Board Contact.

1. Project Reporting

Monthly Reporting – Not applicable

Annual Reporting: The Permittee shall submit an Annual Report each year on the 1st day of the month one year after the effective date of the Order. Annual reporting shall continue until a Notice of Project Complete Letter is issued to the Permittee.

2. Project Status Notifications

- a. Commencement of Construction:** The Permittee shall submit a Commencement of Construction Report at least seven (7) days prior to start of initial ground disturbance activities.
- b. Request for Notice of Completion of Discharges Letter:** The Permittee shall submit a Request for Notice of Completion of Discharges Letter following completion of active Project construction activities, including any required restoration and permittee-responsible mitigation. This request shall be submitted to the Central Valley Water Board staff within thirty (30) days following completion of all Project construction activities. Upon acceptance of the request, Central Valley

Water Board staff shall issue a Notice of Completion of Discharges Letter to the Permittee which will end the active discharge period and associated annual fees.

- c. Request for Notice of Project Complete Letter:** The Permittee shall submit a Request for Notice of Project Complete Letter when construction and/or any post-construction monitoring is complete,³ and no further Project activities will occur. This request shall be submitted to Central Valley Water Board staff within thirty (30) days following completion of all Project activities. Upon approval of the request, the Central Valley Water Board staff shall issue a Notice of Project Complete Letter to the Permittee which will end the post discharge monitoring period and associated annual fees.

- 3. Conditional Notifications and Reports:** The following notifications and reports are required as appropriate.

a. Accidental Discharges of Hazardous Materials⁴

Following an accidental discharge of a reportable quantity of a hazardous material, sewage, or an unknown material, the following applies (Water Code, Section 13271):

- i. As soon as (A) Permittee has knowledge of the discharge or noncompliance, (B) notification is possible, and (C) notification can be provided without substantially impeding cleanup or other emergency measures then:
 - first call – 911 (to notify local response agency)
 - then call – Office of Emergency Services (OES) State Warning Center at:(800) 852-7550 or (916) 845-8911
 - Lastly follow the required OES procedures as set forth in:
http://www.caloes.ca.gov/FireRescueSite/Documents/CalOES-Spill_Booklet_Feb2014_FINAL_BW_Acc.pdf
- ii. Following notification to OES, the Permittee shall notify Central Valley Water Board, as soon as practicable (ideally within 24 hours). Notification may be delivered via written notice, email, or other verifiable means.
- iii. Within five (5) working days of notification to the Central Valley Water Board, the Permittee must submit an Accidental Discharge of Hazardous Material Report.

- b. Violation of Compliance with Water Quality Standards:** The Permittee shall notify the Central Valley Water Board of any event causing a violation of compliance with water quality standards. Notification may be delivered via written notice, email, or other verifiable means.

³ Completion of post-construction monitoring shall be determined by Central Valley Water Board staff and shall be contingent on successful attainment of restoration and mitigation performance criteria.

⁴ "Hazardous material" means any material that, because of its quantity, concentration, or physical or chemical characteristics, poses a significant present or potential hazard to human health and safety or to the environment if released into the workplace or the environment. "Hazardous materials" include, but are not limited to, hazardous substances, hazardous waste, and any material that a handler or the administering agency has a reasonable basis for believing that it would be injurious to the health and safety of persons or harmful to the environment if released into the workplace or the environment. (Health & Safety Code, Section 25501.)

- i. This notification must be followed within three (3) working days by submission of a Violation of Compliance with Water Quality Standards Report.
- c. In-Water Work and Diversions:**
 - i. The Permittee shall notify the Central Valley Water Board at least forty-eight (48) hours prior to initiating work in water or stream diversions. Notification may be delivered via written notice, email, or other verifiable means.
 - ii. Within three (3) working days following completion of work in water or stream diversions, an In-Water Work/Diversions Water Quality Monitoring Report must be submitted to Central Valley Water Board staff.
- d. Modifications to Project:** Project modifications may require an amendment of this Order. The Permittee shall give advance notice to Central Valley Water Board staff if Project implementation as described in the application materials is altered in any way or by the imposition of subsequent permit conditions by any local, state or federal regulatory authority by submitting a Modifications to Project Report. The Permittee shall inform Central Valley Water Board staff of any Project modifications that will interfere with the Permittee's compliance with this Order. Notification may be made in accordance with conditions in the certification deviation section of this Order.
- e. Transfer of Property Ownership:** This Order is not transferable in its entirety or in part to any person or organization except after notice to the Central Valley Water Board in accordance with the following terms:
 - i. The Permittee must notify the Central Valley Water Board of any change in ownership or interest in ownership of the Project area by submitting a Transfer of Property Ownership Report. The Permittee and purchaser must sign and date the notification and provide such notification to the Central Valley Water Board at least 10 days prior to the transfer of ownership. The purchaser must also submit a written request to the Central Valley Water Board to be named as the permittee in a revised order.
 - ii. Until such time as this Order has been modified to name the purchaser as the permittee, the Permittee shall continue to be responsible for all requirements set forth in this Order.
- f. Transfer of Long-Term BMP Maintenance:** If maintenance responsibility for post-construction BMPs is legally transferred, the Permittee must submit to the Central Valley Water Board a copy of such documentation and must provide the transferee with a copy of a long-term BMP maintenance plan that complies with manufacturer or designer specifications. The Permittee must provide such notification to the Central Valley Water Board with a Transfer of Long-Term BMP Maintenance Report at least 10 days prior to the transfer of BMP maintenance responsibility.

C. Water Quality Monitoring

1. **General:** Continuous visual surface water monitoring shall be conducted during active construction periods to detect accidental discharge of construction related pollutants

(e.g. oil and grease, turbidity plume, or uncured concrete). The Permittee shall perform surface water sampling⁵:

- a. when performing any in-water work;
 - b. during the entire duration of temporary surface water diversions;
 - c. in the event that the Project activities result in any materials reaching surface waters; or
 - d. when any activities result in the creation of a visible plume in surface waters.
- 2. Accidental Discharges/Noncompliance:** Upon occurrence of an accidental discharge of hazardous materials or a violation of compliance with a water quality standard, Central Valley Water Board staff may require water quality monitoring based on the discharge constituents and/or related water quality objectives and beneficial uses.
- 3. In-Water Work or Diversions:** During planned in-water work or during the entire duration of temporary water diversions, any discharge(s) to waters of the state shall conform to the following water quality standards:
- a. Waters shall not contain oils, greases, waxes, or other materials in concentrations that cause nuisance, result in a visible film or coating on the surface of the water or on objects in the water, or otherwise adversely affect beneficial uses.
 - b. Activities shall not cause turbidity increases in surface water to exceed:
 - i. where natural turbidity is less than 1 Nephelometric Turbidity Units (NTUs), controllable factors shall not cause downstream turbidity to exceed 2 NTU;
 - ii. where natural turbidity is between 1 and 5 NTUs, increases shall not exceed 1 NTU;
 - iii. where natural turbidity is between 5 and 50 NTUs, increases shall not exceed 20 percent;
 - iv. where natural turbidity is between 50 and 100 NTUs, increases shall not exceed 10 NTUs;
 - v. where natural turbidity is greater than 100 NTUs, increases shall not exceed 10 percent.

In determining compliance with the above limits, appropriate averaging periods may be applied provided that beneficial uses will be fully protected. Averaging periods may only be used with prior permission of the Central Valley Water Board Executive Officer.

Sampling during in-water work or during the entire duration of temporary water diversions shall be conducted in accordance with Table 2 sampling parameters.⁶ The

⁵ Sampling is not required in a wetland where the entire wetland is being permanently filled, provided there is no outflow connecting the wetland to surface waters.

⁶ Pollutants shall be analyzed using the analytical methods described in 40 Code of Federal Regulations Part 136; where no methods are specified for a given pollutant, the method shall be approved by Central Valley Water Board staff. Grab samples shall be taken between the surface and mid-depth and not be collected at the same time each day to get a complete representation of variations in the receiving water. A hand-held field meter may be used, provided the meter utilizes a U.S. EPA-approved algorithm/method and is calibrated and maintained in accordance
(footnote continued on next page)

sampling requirements in Table 2 shall be conducted upstream out of the influence of the Project, and approximately 300 feet downstream of the work area.

The sampling frequency may be modified for certain projects with written approval from Central Valley Water Board staff. An In-Water Work and Diversion Water Quality Monitoring Report, as described in Attachment D, shall be submitted within two weeks on initiation of in-water construction, and the remaining In-Water Work and Diversion Water Quality Monitoring shall be submitted with the Request for Notice of Completion of Discharges letter. In reporting the data, the Permittee shall arrange the data in tabular form so that the sampling locations, date, constituents, and concentrations are readily discernible. The data shall be summarized in such a manner to illustrate clearly whether the Project complies with Order requirements. The report shall include surface water sampling results, visual observations, and identification of the turbidity increase in the receiving water applicable to the natural turbidity conditions specified in the turbidity criteria in XIV.C.3.b.

4. **If no sampling is required, the Permittee shall submit a written statement stating, “No sampling was required” within two weeks on initiation of in-water construction, and every two weeks thereafter.**

| Table 2: Sample Type and Frequency Requirements | | | |
|--|---------------------|--------------------|---|
| Parameter | Unit of Measurement | Type of Sample | Minimum Frequency |
| Turbidity | NTU | Grab | Every 4 hours |
| Visible construction related pollutants ⁷ | Observation | Visual Inspections | Continuous throughout the construction period |

5. **Post-Construction:** Visually inspect the Project site during the rainy season for one year to ensure excessive erosion, stream instability, or other water quality pollution is not occurring in or downstream of the Project site. If water quality pollution is occurring, contact the Central Valley Water Board staff member overseeing the Project within three (3) working days. The Central Valley Water Board may require the submission of a Violation of Compliance with Water Quality Standards Report. Additional permits may be required to carry out any necessary site remediation.

D. Standard

1. This Order is subject to modification or revocation upon administrative or judicial review, including review and amendment pursuant to Water Code section 13330, and California Code of Regulations, Title 23, Chapter 28, article 6 commencing with sections 3867-3869, inclusive. Additionally, the Central Valley Water Board reserves the right to suspend, cancel, or modify and reissue this Order, after providing notice to the Permittee, if the Central Valley Water Board determines that: the Project fails to comply with any of the conditions of this Order; or, when necessary to implement any

with the manufacturer’s instructions. A calibration and maintenance log for each meter used for monitoring shall be maintained onsite.

⁷ Visible construction-related pollutants include oil, grease, foam, fuel, petroleum products, and construction-related, excavated, organic or earthen materials.

new or revised water quality standards and implementation plans adopted or approved pursuant to the Porter-Cologne Water Quality Control Act (Water Code, section 13000 et seq.) or federal Clean Water Act section 303 (33 U.S.C. section 1313). For purposes of Clean Water Act section 401(d), the condition constitutes a limitation necessary to assure compliance with water quality standards and appropriate requirements of state law.

2. This Order is conditioned upon total payment of any fee required under Title 23 of the California Code of Regulations and owed by the Permittee.
3. In the event of any violation or threatened violation of the conditions of this Order, the violation or threatened violation shall be subject to any remedies, penalties, process, or sanctions as provided for under state and federal law. For purposes of Clean Water Act, section 401(d), the applicability of any state law authorizing remedies, penalties, processes, or sanctions for the violation or threatened violation constitutes a limitation necessary to assure compliance with the water quality standards and other pertinent requirements incorporated into this Order.

E. General Compliance

1. Failure to comply with any condition of this Order shall constitute a violation of the Porter-Cologne Water Quality Control Act and the Clean Water Act. The Permittee and/or discharger may then be subject to administrative and/or civil liability pursuant to Water Code section 13385.
2. Permitted actions must not cause a violation of any applicable water quality standards, including impairment of designated beneficial uses for receiving waters as adopted in the Basin Plans by any applicable Central Valley Water Board or any applicable State Water Board (collectively Water Boards) water quality control plan or policy. The source of any such discharge must be eliminated as soon as practicable.
3. In response to a suspected violation of any condition of this Order, the Central Valley Water Board may require the holder of this Order to furnish, under penalty of perjury, any technical or monitoring reports the Water Boards deem appropriate, provided that the burden, including costs, of the reports shall bear a reasonable relationship to the need for the reports and the benefits to be obtained from the reports. The additional monitoring requirements ensure that permitted discharges and activities comport with any applicable effluent limitations, water quality standards, and/or other appropriate requirement of state law.
4. The Permittee must, at all times, fully comply with engineering plans, specifications, and technical reports submitted to support this Order; and all subsequent submittals required as part of this Order. The conditions within this Order and Attachments supersede conflicting provisions within Permittee submittals.
5. This Order and all of its conditions contained herein continue to have full force and effect regardless of the expiration or revocation of any federal license or permit issued for the Project. For purposes of Clean Water Act, section 401(d), this condition constitutes a limitation necessary to assure compliance with the water quality standards and other pertinent requirements of state law.

F. Administrative

1. Signatory requirements for all document submittals required by this Order are presented in Attachment E of this Order.
2. This Order does not authorize any act which results in the taking of a threatened, endangered or candidate species or any act, which is now prohibited, or becomes prohibited in the future, under either the California Endangered Species Act (Fish & Wildlife Code, sections 2050-2097) or the federal Endangered Species Act (16 U.S.C. sections 1531-1544). If a "take" will result from any act authorized under this Order held by the Permittee, the Permittee must obtain authorization for the take prior to any construction or operation of the portion of the Project that may result in a take. The Permittee is responsible for meeting all requirements of the applicable endangered species act for the Project authorized under this Order.
3. The Permittee shall grant Central Valley Water Board staff, or an authorized representative (including an authorized contractor acting as a Water Board representative), upon presentation of credentials and other documents as may be required by law, permission to:
 - a. Enter upon the Project or compensatory mitigation site(s) premises where a regulated facility or activity is located or conducted, or where records are kept.
 - b. Have access to and copy any records that are kept and are relevant to the Project or the requirements of this Order.
 - c. Inspect any facilities, equipment (including monitoring and control equipment), practices, or operations regulated or required under this Order.
 - d. Sample or monitor for the purposes of assuring Order compliance.
4. A copy of this Order shall be provided to any consultants, contractors, and subcontractors working on the Project. Copies of this Order shall remain at the Project site for the duration of this Order. The Permittee shall be responsible for work conducted by its consultants, contractors, and any subcontractors.
5. A copy of this Order must be available at the Project site(s) during construction for review by site personnel and agencies. All personnel performing work on the Project shall be familiar with the content of this Order and its posted location at the Project site.

G. Construction

1. **Dewatering**
 - a. For any temporary dam or other artificial obstruction being constructed, maintained, or placed in operation, sufficient water shall at all times be allowed to pass downstream, to maintain beneficial uses of waters of the state below the dam. Construction, dewatering, and removal of temporary cofferdams shall not violate section XIV.C.3.
 - b. The temporary dam or other artificial obstruction shall only be built from clean materials such as sandbags, gravel bags, water dams, or clean/washed gravel which will cause little or no siltation.
 - c. If water is present, the area must be dewatered prior to start of work.

- d. This Order does not allow permanent water diversion of flow from the receiving water. This Order is invalid if any water is permanently diverted as a part of the project.

2. Directional Drilling – Not applicable

3. Dredging – Not applicable

4. Fugitive Dust – Not applicable

5. Good Site Management “Housekeeping”

- a. Refueling of equipment within the floodplain or within 300 feet of the waterway is prohibited. If critical equipment must be refueled within 300 feet of the waterway, spill prevention and countermeasures must be implemented to avoid spills. Refueling areas shall be provided with secondary containment including drip pans and/or placement of absorbent material. No hazardous materials, pesticides, fuels, lubricants, oils, hydraulic fluids, or other construction-related potentially hazardous substances should be stored within a floodplain or within 300 feet of a waterway. The Permittee must perform frequent inspections of construction equipment prior to utilizing it near surface waters to ensure leaks from the equipment are not occurring and are not a threat to water quality.
- b. All materials resulting from the Project shall be removed from the site and disposed of properly.

6. Hazardous Materials

- a. The discharge of petroleum products, any construction materials, hazardous materials, pesticides, fuels, lubricants, oils, hydraulic fluids, raw cement, concrete or the washing thereof, asphalt, paint, coating material, drilling fluids, or other substances potentially hazardous to fish and wildlife resulting from or disturbed by project-related activities is prohibited and shall be prevented from contaminating the soil and/or entering waters of the state. In the event of a prohibited discharge, the Permittee shall comply with notification requirements in sections XIV.B.3.a and XIV.B.3.b.
- b. Wet concrete will be placed into stream channel habitat after the area has been completely dewatered.
- c. Concrete must be completely cured before coming into contact with waters of the United States and waters of the state. Surface water that contacts wet concrete must be pumped out and disposed of at an appropriate off-site commercial facility, which is authorized to accept concrete wastes.

7. Invasive Species and Soil Borne Pathogens

Prior to arrival at the project site and prior to leaving the project site, construction equipment that may contain invasive plants and/or seeds shall be cleaned to reduce the spread of noxious weeds.

8. Roads – Not applicable

9. Sediment Control

- a. Except for activities permitted by the United States Army Corps of Engineers under Section 404 of the Clean Water Act and/or Section 10 of the Rivers and Harbors

Act, soil, silt, or other organic materials shall not be placed where such materials could pass into surface water or surface water drainage courses.

- b. Silt fencing, straw wattles, or other effective management practices must be used along the construction zone to minimize soil or sediment along the embankments from migrating into the waters of the state through the entire duration of the Project.
- c. The use of netting material (e.g., monofilament-based erosion blankets) that could trap aquatic dependent wildlife is prohibited within the Project area.

10. Special Status Species

Shasta crayfish, rough sculpin

11. Stabilization/Erosion Control

- a. All areas disturbed by Project activities shall be protected from washout and erosion.
- b. Hydroseeding shall be performed with California native seed mix.

12. Storm Water

- a. During the construction phase, the Permittee must employ strategies to minimize erosion and the introduction of pollutants into storm water runoff. These strategies must include the following:
 - i. An effective combination of erosion and sediment control Best Management Practices (BMPs) must be implemented and adequately working prior to the rainy season and during all phases of construction.

H. Site Specific – Not applicable

I. Total Maximum Daily Load (TMDL) – Not applicable

J. Mitigation for Temporary Impacts

- 1. The Permittee shall restore all areas of temporary impacts, including Project site upland areas, which could result in a discharge to waters of the state to pre-construction contours and conditions upon completion of construction activities.

K. Compensatory Mitigation for Permanent Impacts⁸ - Not applicable

L. Ecological Restoration and Enhancement – Not applicable.

M. Certification Deviation

- 1. Minor modifications of Project locations or predicted impacts may be necessary as a result of unforeseen field conditions, necessary engineering re-design, construction concerns, or similar reasons. Some of these prospective Project modifications may have impacts on water quality. Some modifications of Project locations or predicted impacts may qualify as Certification Deviations as set forth in Attachment F. For purposes of this Certification, a "Certification Deviation" is a Project locational or impact modification that does not require an immediate amendment of the Order,

⁸ Compensatory Mitigation is for permanent physical loss and permanent ecological degradation of a water of the state.

because the Central Valley Water Board has determined that any potential water quality impacts that may result from the change are sufficiently addressed by the Order conditions and the CEQA Findings. After the termination of construction, this Order will be formally amended to reflect all authorized Certification Deviations and any resulting adjustments to the amount of water resource impacts and required compensatory mitigation amounts.

- 2. A Project modification shall not be granted a Certification Deviation if it warrants or necessitates changes that are not addressed by the Order conditions such that the Project no longer qualifies for a categorical exemption. In this case a supplemental environmental review and different Order will be required.

XV. Water Quality Certification

I hereby issue the Order for the Lakey Emergency Home Stabilization and Foundation Repair Project, WDID No. 5A45CR00575, certifying that as long as all of the conditions listed in this Order are met, any discharge from the referenced Project will comply with the applicable provisions of Clean Water Act sections 301 (Effluent Limitations), 302 (Water Quality Related Effluent Limitations), 303 (Water Quality Standards and Implementation Plans), 306 (National Standards of Performance), and 307 (Toxic and Pretreatment Effluent Standards).

Except insofar as may be modified by any preceding conditions, all Order actions are contingent on: (a) the discharge being limited and all proposed mitigation being completed in strict compliance with the conditions of this Order and the attachments to this Order; and, (b) compliance with all applicable requirements of Statewide Water Quality Control Plans and Policies, the Regional Water Boards' Water Quality Control Plans and Policies.

Patrick Puuppa, Executive Officer
Central Valley Regional Water Quality Control Board

6/12/2019
Date

- Attachment A** Project Map
- Attachment B** Receiving Waters, Impact, and Mitigation Information
- Attachment C** CEQA Findings of Facts
- Attachment D** Report and Notification Requirements
- Attachment E** Signatory Requirements
- Attachment F** Certification Deviation Procedures

(This page intentionally left blank)

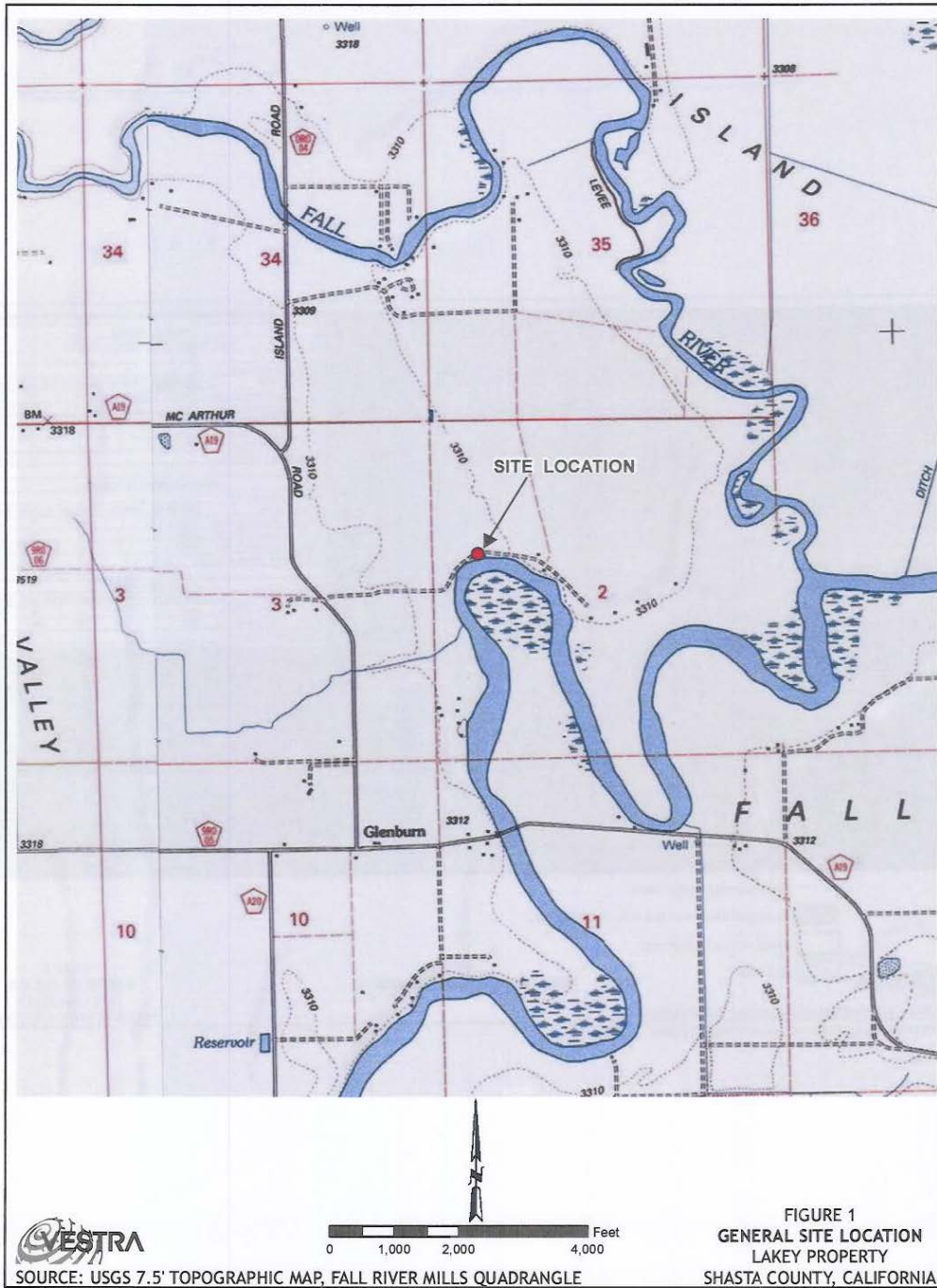

(This page intentionally left blank)

Receiving Waters

The following table shows the receiving waters associated with each impact site.

| Table 1: Receiving Water(s) Information | | | | | | | |
|--|----------------|--------------------------------|------------------------------|------------------|---|------------------------|-------------------------|
| Site ID | Waterbody Name | Impacted Aquatic Resource Type | Water Board Hydrologic Units | Receiving Waters | Receiving Waters Beneficial Uses | 303d Listing Pollutant | CRAM AA ID ⁹ |
| Lakey Residence | Fall River | Stream | 526.41 | Fall River | MUN, AGR, POW, REC-1, REC-2, WARM, COLD, WILD | Sediment, Siltation | (N/A) |

⁹ California Rapid Assessment Method (CRAM) score of impacted sites provided by the Permittee.

Individual Direct Impact Locations

The following table shows individual impact locations.

| Table 2: Individual Direct Impact Information | | | | | | | | | | | |
|--|------------|--------------|--------------------------------------|--------------------------|------------------------|--------|-------------|-------------|-----------------|-------------|-------------|
| Site ID | Latitude | Longitude | Indirect Impact Requiring Mitigation | | Direct Impact Duration | Dredge | | | Fill/Excavation | | |
| | | | Yes | No | | Acres | Cubic Yards | Linear Feet | Acres | Cubic Yards | Linear Feet |
| Lakey Residence | 41.073975° | -121.482628° | <input type="checkbox"/> | <input type="checkbox"/> | Temporary | 0.006 | | 68 | | | |
| | | | | | Permanent | 0.003 | 39.75 | 39 | | | |

(This page intentionally left blank)

FINDINGS FOR CEQA EXEMPT PROJECTS

The Central Valley Water Board has determined that the Project is exempt from review under CEQA pursuant to California Code of Regulations, Title 14, section 15061.

Specifically, the issuance of this Order and the activities described herein meet the exemption criteria under California Code of Regulations, Title 14, section(s) 15302 (Replacement or Reconstruction) and 15304 (Minor Alterations to Land). The project consists of the replacement of an existing structure (home foundation) where the new structure will be located on the same site as the structure replaced and will have the same purpose and capacity. The rock slope protection placement constitutes a minor alteration in the condition of land, water, and/or vegetation which does not involve the removal of healthy mature trees.

The Central Valley Water Board filed a Notice of Exemption with the State Clearinghouse on 6 June 2019 (California Code of Regulations., Title 14, section 15062.)

(This page intentionally left blank)

Copies of this Form

In order to identify your project, it is necessary to include a copy of the Project specific Cover Sheet below with your report: please retain for your records. If you need to obtain a copy of the Cover Sheet you may download a copy of this Order as follows:

1. https://www.waterboards.ca.gov/centralvalley/board_decisions/adopted_orders/401_wqcerts/
2. Find your Order based on the County, Permittee, WDID No., and/or Project Name.

Report Submittal Instructions

1. Check the box on the Report and Notification Cover Sheet next to the report or notification you are submitting.
 - **Part A (Annual Report):** This report will be submitted annually from the anniversary of Project effective date until a Notice of Project Complete Letter is issued.
 - **Part B (Project Status Notifications):** Used to notify the Central Valley Water Board of the status of the Project schedule that may affect Project billing.
 - **Part C (Conditional Notifications and Reports):** Required on a case by case basis for accidental discharges of hazardous materials, violation of compliance with water quality standards, notification of in-water work, or other reports.
2. Sign the Report and Notification Cover Sheet and attach all information requested for the Report Type.
3. **Electronic Report Submittal Instructions:**
 - Submit signed Report and Notification Cover Sheet and required information via email to: centralvalleyredding@waterboards.ca.gov and cc: Dannas.Berchtold@waterboards.ca.gov
 - Include in the subject line of the email:
Subject: ATTN: Dannas Berchtold; Reg. Measure ID: 430503_Report

Definition of Reporting Terms

1. **Active Discharge Period:** The active discharge period begins with the effective date of this Order and ends on the date that the Permittee receives a Notice of Completion of Discharges Letter or, if no post-construction monitoring is required, a Notice of Project Complete Letter. The Active Discharge Period includes all elements of the Project including site construction and restoration, and any Permittee responsible compensatory mitigation construction.
2. **Request for Notice of Completion of Discharges Letter:** This request by the Permittee to the Central Valley Water Board staff pertains to projects that have post construction monitoring requirements, e.g. if site restoration was required to be monitored for 5 years following construction. Central Valley Water Board staff will review the request and send a Completion of Discharges Letter to

the Permittee upon approval. This letter will initiate the post-discharge monitoring period and a change in fees from the annual active discharge fee to the annual post-discharge monitoring fee.

3. **Request for Notice of Project Complete Letter:** This request by the Permittee to the Central Valley Water Board staff pertains to projects that either have completed post-construction monitoring and achieved performance standards or have no post-construction monitoring requirements, and no further Project activities are planned. Central Valley Water Board staff will review the request and send a Project Complete Letter to the Permittee upon approval. Termination of annual invoicing of fees will correspond with the date of this letter.
4. **Post-Discharge Monitoring Period:** The post-discharge monitoring period begins on the date of the Notice of Completion of Discharges Letter and ends on the date of the Notice of Project Complete Letter issued by the Central Valley Water Board staff. The Post-Discharge Monitoring Period includes continued water quality monitoring or compensatory mitigation monitoring.
5. **Effective Date:** Date of Order issuance.

Map/Photo Documentation Information

When submitting maps or photos, please use the following formats.

1. **Map Format Information:**

Preferred map formats of at least 1:24000 (1" = 2000') detail (listed in order of preference):

- **GIS shapefiles:** The shapefiles must depict the boundaries of all project areas and extent of aquatic resources impacted. Each shape should be attributed with the extent/type of aquatic resources impacted. Features and boundaries should be accurate to within 33 feet (10 meters). Identify datum/projection used and if possible, provide map with a North American Datum of 1983 (NAD83) in the California Teale Albers projection in feet.
- **Google KML files** saved from Google Maps: My Maps or Google Earth Pro. Maps must show the boundaries of all project areas and extent/type of aquatic resources impacted. Include URL(s) of maps. If this format is used include a spreadsheet with the object ID and attributed with the extent/type of aquatic resources impacted.
- **Other electronic format** (CAD or illustration format) that provides a context for location (inclusion of landmarks, known structures, geographic coordinates, or USGS DRG or DOQQ). Maps must show the boundaries of all project areas and extent/type of aquatic resources impacted. If this format is used include a spreadsheet with the object ID and attributed with the extent/type of aquatic resources impacted.
- Aquatic resource maps marked on paper **USGS 7.5 minute topographic maps** or **Digital Orthophoto Quarter Quads (DOQQ)** printouts. Maps must show the boundaries of all project areas and extent/type of aquatic resources impacted. If this format is used include a spreadsheet with the object ID and attributed with the extent/type of aquatic resources impacted.

2. **Photo-Documentation:** Include a unique identifier, date stamp, written description of photo details, and latitude/longitude (in decimal degrees) or map indicating location of photo. Successive photos should be taken from the same vantage point to compare pre/post construction conditions.

REPORT AND NOTIFICATION COVER SHEET

| | | | |
|-------------------------------|--|------------------|--------|
| Project: | Lakey Emergency Home Stabilization and Foundation Repair Project | | |
| Permittee: | Martin Lakey | | |
| Reg. Meas. ID: | 430503 | Place ID: | 858920 |
| Order Effective Date: | 12 June 2019 | | |
| Order Expiration Date: | 12 June 2024 | | |

Report Type Submitted

| Part A – Project Reporting | |
|--|--|
| Report Type 1 | <input type="checkbox"/> Monthly Report – Not applicable |
| Report Type 2 | <input type="checkbox"/> Annual Report |
| Part B - Project Status Notifications | |
| Report Type 3 | <input type="checkbox"/> Commencement of Construction |
| Report Type 4 | <input type="checkbox"/> Request for Notice of Completion of Discharges Letter |
| Report Type 5 | <input type="checkbox"/> Request for Notice of Project Complete Letter |
| Part C - Conditional Notifications and Reports | |
| Report Type 6 | <input type="checkbox"/> Accidental Discharge of Hazardous Material Report |
| Report Type 7 | <input type="checkbox"/> Violation of Compliance with Water Quality Standards Report |
| Report Type 8 | <input type="checkbox"/> In-Water Work/Diversions Water Quality Monitoring Report |
| Report Type 9 | <input type="checkbox"/> Modifications to Project Report |
| Report Type 10 | <input type="checkbox"/> Transfer of Property Ownership Report |
| Report Type 11 | <input type="checkbox"/> Transfer of Long-Term BMP Maintenance Report |
| Report Type 12 | <input type="checkbox"/> Other Report Type |

"I certify under penalty of law that I have personally examined and am familiar with the information submitted in this document and all attachments and that, based on my inquiry of those individuals immediately responsible for obtaining the information, I believe that the information is true, accurate, and complete. I am aware that there are significant penalties for submitting false information, including the possibility of fine and imprisonment."

Print Name ¹

Affiliation and Job Title

Signature

Date

¹STATEMENT OF AUTHORIZATION (include if authorization has changed since application was submitted)

I hereby authorize _____ to act in my behalf as my representative in the submittal of this report, and to furnish upon request, supplemental information in support of this submittal.

Permittee's Signature

Date

***This Report and Notification Cover Sheet must be signed by the Permittee or a duly authorized representative and included with all written submittals.**

Part A – Project Reporting

| | |
|------------------------|--|
| Report Type 1 | Monthly Report – Not applicable |
| Report Purpose | Notifies Central Valley Water Board staff of the Project status and environmental compliance activities on a monthly basis. |
| When to Submit | On the 1st day of each month until a Notice of Project Complete Letter is issued to the Permittee. |
| Report Contents | <ol style="list-style-type: none"> 1. Construction Summary Describe Project progress and schedule including initial ground disturbance, site clearing and grubbing, road construction, site construction, and the implementation status of construction storm water Best Management Practices (BMPs¹⁰). If construction has not started, provide estimated start date. 2. Event Summary Describe distinct Project activities and occurrences, including environmental monitoring, surveys, and inspections. 3. Photo Summary Provide photos of Project activities. For each photo, include a unique site identifier, date stamp, written description of photo details, and latitude/longitude (in decimal degrees) or map indicating location of photo. Successive photos should be taken from the same vantage point to compare pre/post construction conditions. 4. Compliance Summary <ol style="list-style-type: none"> a) List name and organization of environmental surveyors, monitors, and inspectors involved with monitoring environmental compliance for the reporting period. b) List associated monitoring reports for the reporting period. c) Summarize observed incidences of non-compliance, compliance issues, minor problems, or occurrences. d) Describe each observed incidence in detail. List monitor name and organization, date, location, type of incident, corrective action taken (if any), status, and resolution. |

¹⁰ Best Management Practices (BMPs) is a term used to describe a type of water pollution or environmental control.

| | |
|-----------------------------------|---|
| Report Type 2 | Annual Report |
| Report Purpose | Notify the Central Valley Water Board staff of Project status during both the active discharge and post-discharge monitoring periods. |
| When to Submit | Annual reports shall be submitted each year on the 1st day of July. Annual reports shall continue until a Notice of Project Complete Letter is issued to the Permittee. |
| Report Contents | <p>The contents of the annual report shall include the topics indicated below for each project period. Report contents are outlined in Annual Report Topics below.</p> <p><u>During the Active Discharge Period</u></p> <ul style="list-style-type: none"> • Topic 1: Construction Summary • Topic 2: Mitigation for Temporary Impacts Status • Topic 3: Compensatory Mitigation for Permanent Impacts Status <p><u>During the Post-Discharge Monitoring Period</u></p> <ul style="list-style-type: none"> • Topic 2: Mitigation for Temporary Impacts Status • Topic 3: Compensatory Mitigation for Permanent Impacts Status |
| Annual Report Topics (1-3) | |
| Annual Report Topic 1 | Construction Summary |
| When to Submit | With the annual report during the Active Discharge Period. |
| Report Contents | <ol style="list-style-type: none"> 1. Project progress and schedule including initial ground disturbance, site clearing and grubbing, road construction, site construction, and the implementation status of construction storm water best management practices (BMPs). If construction has not started, provide estimated start date and reasons for delay. 2. Map showing general Project progress. 3. If applicable: <ol style="list-style-type: none"> a. Summary of Conditional Notification and Report Types 6 and 7 (Part C below). b. Summary of Certification Deviations. See Certification Deviation Attachment for further information. |
| Annual Report Topic 2 | Mitigation for Temporary Impacts Status |
| When to Submit | With the annual report during both the Active Discharge Period and Post-Discharge Monitoring Period. |
| Report Contents | <ol style="list-style-type: none"> 1. Planned date of initiation and map showing locations of mitigation for temporary impacts to waters of the state and all upland areas of temporary disturbance which could result in a discharge to waters of the state. 2. If mitigation for temporary impacts has already commenced, provide a map and information concerning attainment of performance standards contained in the restoration plan. |
| Annual Report Topic 3 | Compensatory Mitigation for Permanent Impacts Status |

| | |
|------------------------|---|
| When to Submit | With the annual report during both the Active Discharge Period and Post-Discharge Monitoring Period. |
| Report Contents | <p>*If not applicable report N/A.</p> <p>Part A. Permittee Responsible</p> <ol style="list-style-type: none">1. Planned date of initiation of compensatory mitigation site installation.2. If installation is in progress, a map of what has been completed to date.3. If the compensatory mitigation site has been installed, provide a final map and information concerning attainment of performance standards contained in the compensatory mitigation plan. <p>Part B. Mitigation Bank or In-Lieu Fee</p> <ol style="list-style-type: none">1. Status or proof of purchase of credit types and quantities.2. Include the name of bank/ILF Program and contact information.3. If ILF, location of project and type if known. |

Part B – Project Status Notifications

| | |
|------------------------|---|
| Report Type 3 | Commencement of Construction |
| Report Purpose | Notify Central Valley Water Board staff prior to the start of construction. |
| When to Submit | Must be received at least seven (7) days prior to start of initial ground disturbance activities. |
| Report Contents | <ol style="list-style-type: none"> 1. Date of commencement of construction. 2. Anticipated date when discharges to waters of the state will occur. 3. Project schedule milestones including a schedule for onsite compensatory mitigation, if applicable. 4. Construction Storm Water General Permit WDID No. 5. Proof of purchase of compensatory mitigation for permanent impacts from the mitigation bank or in-lieu fee program. |

| | |
|------------------------|---|
| Report Type 4 | Request for Notice of Completion of Discharges Letter |
| Report Purpose | Notify Central Valley Water Board staff that post-construction monitoring is required and that active Project construction, including any mitigation and permittee responsible compensatory mitigation, is complete. |
| When to Submit | Must be received by Central Valley Water Board staff within thirty (30) days following completion of all Project construction activities. |
| Report Contents | <ol style="list-style-type: none"> 1. Status of storm water Notice of Termination(s), if applicable. 2. Status of post-construction storm water BMP installation. 3. Pre- and post-photo documentation of all Project activity sites where the discharge of dredge and/or fill/excavation was authorized. 4. Summary of Certification Deviation discharge quantities compared to initial authorized impacts to waters of the state, if applicable. 5. An updated monitoring schedule for mitigation for temporary impacts to waters of the state and permittee responsible compensatory mitigation during the post-discharge monitoring period, if applicable. |

| | |
|------------------------|---|
| Report Type 5 | Request for Notice of Project Complete Letter |
| Report Purpose | Notify Central Valley Water Board staff that construction and/or any post-construction monitoring is complete, or is not required, and no further Project activity is planned. |
| When to Submit | Must be received by Central Valley Water Board staff within thirty (30) days following completion of all Project activities. |
| Report Contents | <p>Part A: Mitigation for Temporary Impacts</p> <ol style="list-style-type: none"> 1. A report establishing that the performance standards outlined in the restoration plan have been met for Project site upland areas of temporary disturbance which could result in a discharge to waters of the state. 2. A report establishing that the performance standards outlined in the restoration plan have been met for restored areas of temporary impacts to |

| | |
|--|--|
| | <p>waters of the state. Pre- and post-photo documentation of all restoration sites.</p> <p>Part B: Permittee Responsible Compensatory Mitigation</p> <ol style="list-style-type: none">1. A report establishing that the performance standards outlined in the compensatory mitigation plan have been met.2. Status on the implementation of the long-term maintenance and management plan and funding of endowment.3. Pre- and post-photo documentation of all compensatory mitigation sites.4. Final maps of all compensatory mitigation areas (including buffers). <p>Part C: Post-Construction Storm Water BMPs</p> <ol style="list-style-type: none">1. Date of storm water Notice of Termination(s), if applicable.2. Report status and functionality of all post-construction BMPs. |
|--|--|

Part C – Conditional Notifications and Reports

| | |
|------------------------|---|
| Report Type 6 | Accidental Discharge of Hazardous Material Report |
| Report Purpose | Notifies Central Valley Water Board staff that an accidental discharge of hazardous material has occurred. |
| When to Submit | Within five (5) working days following the date of an accidental discharge. Continue reporting as required by Central Valley Water Board staff. |
| Report Contents | <ol style="list-style-type: none"> 1. The report shall include the OES Incident/Assessment Form, a full description and map of the accidental discharge incident (i.e. location, time and date, source, discharge constituent and quantity, aerial extent, and photo documentation). If applicable, the OES Written Follow-Up Report may be substituted. 2. If applicable, any required sampling data, a full description of the sampling methods including frequency/dates and times of sampling, equipment, locations of sampling sites. 3. Locations and construction specifications of any barriers, including silt curtains or diverting structures, and any associated trenching or anchoring. |

| | |
|------------------------|---|
| Report Type 7 | Violation of Compliance with Water Quality Standards Report |
| Report Purpose | Notifies Central Valley Water Board staff that a violation of compliance with water quality standards has occurred. |
| When to Submit | The Permittee shall report any event that causes a violation of water quality standards within three (3) working days of the noncompliance event notification to Central Valley Water Board staff. |
| Report Contents | The report shall include: the cause; the location shown on a map; and the period of the noncompliance including exact dates and times. If the noncompliance has not been corrected, include: the anticipated time it is expected to continue; the steps taken or planned to reduce, eliminate, and prevent reoccurrence of the noncompliance; and any monitoring results if required by Central Valley Water Board staff. |

| | |
|------------------------|---|
| Report Type 8 | In-Water Work and Diversions Water Quality Monitoring Report |
| Report Purpose | Notifies Central Valley Water Board staff of the start and completion of in-water work. Reports the sampling results during in-water work and during the entire duration of temporary surface water diversions. |
| When to Submit | Seven (7) days prior to the start of in-water work. Within three (3) working days following the completion of in-water work. Surface water monitoring reports to be submitted two (2) weeks on initiation of in-water construction and during entire duration of temporary surface water diversions. Continue reporting in accordance with the approved water quality monitoring plan or as indicated in XIV.C.3. |
| Report Contents | As required by the approved water quality monitoring plan or as indicated in XIV.C.3. |

| | |
|------------------------|--|
| Report Type 9 | Modifications to Project Report |
| Report Purpose | Notifies Central Valley Water Board staff if the Project, as described in the application materials, is altered in any way or by the imposition of subsequent permit conditions by any local, state or federal regulatory authority. |
| When to Submit | If Project implementation as described in the application materials is altered in any way or by the imposition of subsequent permit conditions by any local, state or federal regulatory authority. |
| Report Contents | A description and location of any alterations to Project implementation. Identification of any Project modifications that will interfere with the Permittee's compliance with the Order. |

| | |
|------------------------|---|
| Report Type 10 | Transfer of Property Ownership Report |
| Report Purpose | Notifies Central Valley Water Board staff of change in ownership of the Project or Permittee-responsible mitigation area. |
| When to Submit | At least 10 working days prior to the transfer of ownership. |
| Report Contents | <ol style="list-style-type: none"> 1. A statement that the Permittee has provided the purchaser with a copy of this Order and that the purchaser understands and accepts: <ol style="list-style-type: none"> a. the Order's requirements and the obligation to implement them or be subject to administrative and/or civil liability for failure to do so; and b. responsibility for compliance with any long-term BMP¹¹ maintenance plan requirements in this Order. 2. A statement that the Permittee has informed the purchaser to submit a written request to the Central Valley Water Board to be named as the permittee in a revised order. |

| | |
|------------------------|--|
| Report Type 11 | Transfer of Long-Term BMP Maintenance Report |
| Report Purpose | Notifies Central Valley Water Board staff of transfer of long-term BMP maintenance responsibility. |
| When to Submit | At least 10 working days prior to the transfer of BMP maintenance responsibility. |
| Report Contents | A copy of the legal document transferring maintenance responsibility of post-construction BMPs. |

¹¹ Best Management Practices (BMPs) is a term used to describe a type of water pollution or environmental control.

(This page intentionally left blank)

SIGNATORY REQUIREMENTS

*All Documents Submitted In Compliance With This Order
Shall Meet The Following Signatory Requirements:*

1. All applications, reports, or information submitted to the Central Valley Water Quality Control Board (Central Valley Water Board) must be signed and certified as follows:
 - a) For a corporation, by a responsible corporate officer of at least the level of vice-president.
 - b) For a partnership or sole proprietorship, by a general partner or proprietor, respectively.
 - c) For a municipality, or a state, federal, or other public agency, by either a principal executive officer or ranking elected official.
2. A duly authorized representative of a person designated in items 1.a through 1.c above may sign documents if:
 - a) The authorization is made in writing by a person described in items 1.a through 1.c above.
 - b) The authorization specifies either an individual or position having responsibility for the overall operation of the regulated activity.
 - c) The written authorization is submitted to the Central Valley Water Board Staff Contact prior to submitting any documents listed in item 1 above.
3. Any person signing a document under this section shall make the following certification:

"I certify under penalty of law that I have personally examined and am familiar with the information submitted in this document and all attachments and that, based on my inquiry of those individuals immediately responsible for obtaining the information, I believe that the information is true, accurate, and complete. I am aware that there are significant penalties for submitting false information, including the possibility of fine and imprisonment."

(This page intentionally left blank)

Certification Deviation Procedures

Introduction

These procedures are put into place to preclude the need for Order amendments for minor changes in the Project routing or location. Minor changes or modifications in project activities are often required by the Permittee following start of construction. These deviations may potentially increase or decrease impacts to waters of the state. In such cases, a Certification Deviation, as defined in Section XIV.M of the Order, may be requested by the Permittee as set forth below:

Process Steps

Who may apply: The Permittee or the Permittee's duly authorized representative or agent (hereinafter, "Permittee") for this Order.

How to apply: By letter or email to the 401 staff designated as the contact for this Order.

Certification Deviation Request: The Permittee will request verification from the Central Valley Water Board staff that the project change qualifies as a Certification Deviation, as opposed to requiring an amendment to the Order. The request should:

1. Describe the Project change or modification:
 - a. Proposed activity description and purpose;
 - b. Why the proposed activity is considered minor in terms of impacts to waters of the state;
 - c. How the Project activity is currently addressed in the Order; and,
 - d. Why a Certification Deviation is necessary for the Project.
2. Describe location (latitude/longitude coordinates), the date(s) it will occur, as well as associated impact information (i.e., temporary or permanent, federal or non-federal jurisdiction, water body name/type, estimated impact area, etc.) and minimization measures to be implemented.
3. Provide all updated environmental survey information for the new impact area.
4. Provide a map that includes the activity boundaries with photos of the site.
5. Provide verification of any mitigation needed according to the Order conditions.
6. Provide any other information required by Central Valley Water Board staff to determine whether the Project change or modification necessitates additional environmental review. (California Code of Regulations, Title 14, sections 15061, 15162-15164.)

Post-Discharge Certification Deviation Reporting:

1. Within 30 calendar days of completing the approved Certification Deviation activity, the Permittee will provide a post-discharge activity report that includes the following information:
 - a. Activity description and purpose;
 - b. Activity location, start date, and completion date;
 - c. Erosion control and pollution prevention measures applied;
 - d. The net change in impact area by water body type(s) in acres, linear feet and cubic yards;
 - e. Mitigation plan, if applicable; and,
 - f. Map of activity location and boundaries; post-construction photos.

Annual Summary Deviation Report:

1. Until a Notice of Completion of Discharges Letter or Notice of Project Complete Letter is issued, include in the Annual Project Report (see Construction Notification and Reporting attachment) a compilation of all Certification Deviation activities through the reporting period with the following information:
 - a. Site name(s).
 - b. Date(s) of Certification Deviation approval.
 - c. Location(s) of authorized activities.
 - d. Impact area(s) by water body type prior to activity in acres, linear feet and cubic yards, as originally authorized in the Order.
 - e. Actual impact area(s) by water body type in, acres, linear feet and cubic yards, due to Certification Deviation activity(ies).
 - f. The net change in impact area by water body type(s) in acres, linear feet and cubic yards;
 - g. Mitigation to be provided (approved mitigation ratio and amount).