



Central Valley Regional Water Quality Control Board

CLEAN WATER ACT SECTION 401 WATER QUALITY CERTIFICATION AND ORDER

Effective Date:	13 December 2023	Reg. Meas. ID:	454215
Expiration Date:	12 December 2028	Place ID:	890195
Program Type:	Fill/Excavation	WDID No.:	5B05CR00116
Project Type:	Channel Construction and Maintenance	USACE No.:	SPK-2022-00678 NWP 14
Project:	State Route (SR) 120 Tuolumne Drainage System (SR 26) Project (Project)		
Applicant:	California Department of Transportation		
Applicant Contact:	Allen Lao California Department of Transportation 1976 East Dr. Martin Luther King Jr. Blvd Stockton, CA 95205 Phone: (209) 986-5570 Email: allen.lao@dot.ca.gov		
Applicant's Agent:	Nicole Kith California Department of Transportation 1976 East Dr. Martin Luther King Jr. Blvd Stockton, CA 95205 Phone: (209) 693-3738 Email: nicole.kith@dot.ca.gov		
Water Board Staff:	Olivia Ilsley Environmental Scientist 11020 Sun Center Drive, Suite 200 Rancho Cordova, CA 95670 Phone: (916) 464-4673 Email: Olivia.Ilsley@waterboards.ca.gov		

Water Board Contact Person: If you have any questions, please call Regional Water Quality Control Board, Central Valley Region (Central Valley Water Board) Staff listed above or (916) 464-3291 and ask to speak with the Water Quality Certification Unit Supervisor.

MARK BRADFORD, CHAIR | PATRICK PULUPA, ESQ., EXECUTIVE OFFICER

Table of Contents

I. Order	3
II. Public Notice.....	3
III. Project Purpose	3
IV. Project Description	3
V. Project Location.....	3
VI. Project Impact and Receiving Waters Information.....	4
VII. Description of Direct Impacts to Waters of the State	4
VIII. Description of Indirect Impacts to Waters of the State.....	5
IX. Avoidance and Minimization	5
X. Compensatory Mitigation	5
XI. California Environmental Quality Act (CEQA).....	5
XII. Petitions for Reconsideration.....	5
XIII. Fees Received.....	6
XIV. Conditions	6
XV. Water Quality Certification.....	21
Attachment A – Project Maps	A-1
Attachment B – Receiving Waters, Impacts and Mitigation Information	B-1
Attachment C – CEQA Findings of Fact	C-1
Attachment D – Reports and Notification Requirements	D-1
Attachment E – Signatory Requirements.....	E-1
Attachment F – Certification Deviation Procedures	F-1
Attachment G - Compliance with Code of Federal Regulations, Title 40, Section 121.7, Subdivision (d).....	G-1

I. Order

This Clean Water Act (CWA) section 401 Water Quality Certification action and Order (Order) is issued at the request of California Department of Transportation (hereinafter Permittee) for the Project. This Order is for the purpose described in the application and supplemental information submitted by the Permittee. The application was received on 18 October 2023. The application was deemed complete on 27 November 2023.

II. Public Notice

The Central Valley Water Board provided public notice of the application pursuant to California Code of Regulations, title 23, section 3858 from 20 October 2023 to 10 November 2023. The Central Valley Water Board did not receive any comments during the comment period.

III. Project Purpose

The purpose of the project is to improve drainage on the state highway system in Tuolumne and Calaveras counties by rehabilitating old and failing culverts along SR 120, SR 108, SR 12, and SR 26.

IV. Project Description

The project consists of replacing approximately 40 existing cross drainage culverts that primarily convey surface waters and stream flows across or away from the highway right of way and provide protection against flooding that occurs regularly during storm events. Replaced culverts will be replaced in kind with reinforced concrete pipe culverts and sized to meet current hydraulics requirements. When possible, culverts will be replaced and enlarged by at least six inches in diameter.

When culvert replacement is not an option, cure-in-place liners will be installed in existing culverts if lining does not degrade the hydraulic capacity. Additional treatments include installation of box culverts and raising existing culverts to improve water flow.

If culverts are in good condition and replacement is not required, inlet/outlet treatments and installation of erosion controls may still be needed. Culverts may also be flushed to clean out sedimentation. Inlet/outlet end treatments can include installation of flared end systems (FES), installation of headwalls, extension of culvert ends, and placement of rock slope protection (RSP) to prevent erosion.

V. Project Location

County: Calaveras

Nearest City: Rancho Calaveras

Section 9, Township 03 N, Range 10 E, MDB&M.

Start: Latitude: 38°7'29.29" and Longitude: -120°52'33.12"

End: Latitude: 38°24'56.15" and Longitude: -120°33'2.50"

A Map showing the Project location is found in Attachment A of this Order.

VI. Project Impact and Receiving Waters Information

The Project is located within the jurisdiction of the Central Valley Water Board. Receiving waters and groundwater potentially impacted by this Project are protected in accordance with the Water Quality Control Plan for the Sacramento River and San Joaquin River Basins, Fifth Edition, February 2019 (Basin Plan). The plan for the region and other plans and policies may be accessed at the [State Water Resources Control Board's Plans and Policies Web page](http://www.waterboards.ca.gov/plans_policies/) (http://www.waterboards.ca.gov/plans_policies/). The Basin Plan includes water quality standards, which consist of existing and potential beneficial uses of waters of the state, water quality objectives to protect those uses, and the state and federal antidegradation policies.

It is the policy of the State of California that every human being has the right to safe, clean, affordable, and accessible water adequate for human consumption, cooking, and sanitary purposes. This Order promotes that policy by requiring discharges to meet maximum contaminant levels designed to protect human health and ensure that water is safe for domestic use.

Project impact and receiving waters information can be found in Attachment B. Table 1 of Attachment B shows the receiving waters and beneficial uses of waters of the state impacted by the Project. Individual impact location and quantity is shown in Table 2 of Attachment B.

VII. Description of Direct Impacts to Waters of the State

Total Project fill/excavation quantities for all impacts are summarized in Tables 1 and 2. Permanent impacts are categorized as those resulting in physical loss in area.

Table 1: Total Project Fill/Excavation Quantity for Temporary Impacts¹

Aquatic Resources Type	Acres	Cubic Yards	Linear Feet
Stream Channel	0.015	24	389
Wetland	0.001	2	

¹ Includes only temporary direct impacts to waters of the state and does not include area of temporary disturbance which could result in a discharge to waters of the state. Temporary impacts, by definition, are restored to pre-project conditions and therefore do not include a physical loss of area or degradation of ecological condition.

Table 2: Total Project Fill/Excavation Quantity for Permanent Physical Loss of Area Impacts

Aquatic Resources Type	Acres	Cubic Yards	Linear Feet
Stream Channel	0.009	5	204
Wetland	0.0004	0.65	

VIII. Description of Indirect Impacts to Waters of the State

The Central Valley Water Board recognizes the potential for indirect impacts to waters of the state associated with the Project. With the implementation of Best Management Practices (BMPs) and Avoidance and Minimization Measures (AMMs), no indirect impacts are anticipated to occur as a result of the proposed Project.

IX. Avoidance and Minimization

To minimize the potential effects of construction on water quality and resources, the Permittee shall implement all measures required as described in the Order. According to the Permittee, the following measures will be in place during construction activities to avoid, reduce, and minimize impacts to waters of the state:

The project proponent will implement the following Best Management Practices (BMPs) and Avoidance and Minimization Measures (AMMs), which were developed pursuant to the California Environmental Quality Act (CEQA) Mitigated Negative Declaration (MND) that was prepared for the Project.

X. Compensatory Mitigation

The Permittee has agreed to provide compensatory mitigation for direct impacts, described in section VII for permanent impacts.

XI. California Environmental Quality Act (CEQA)

On 10 June 2022, the California Department of Transportation, as lead agency, adopted an Initial Study/Mitigated Negative Declaration (IS/MND) (State Clearinghouse (SCH) No. 2022060223) for the Project and filed a Notice of Determination (NOD) at the SCH on 16 December 2022. Pursuant to CEQA, the Central Valley Water Board has made Findings of Facts (Findings) which support the issuance of this Order and are included in Attachment C.

XII. Petitions for Reconsideration

Any person aggrieved by this action may petition the State Water Board to reconsider this Order in accordance with California Code of Regulations, title 23, section 3867. A petition for reconsideration must be submitted in writing and received within 30 calendar days of the issuance of this Order.

XIII. Fees Received

An application fee of \$2,734.00 was received on 24 October 2023. The fee amount was determined as required by California Code of Regulations, title 23, sections 3833(b)(3) and 2200(a)(3) and was calculated as Category E - Low Impact Discharges (fee code 87) with the dredge and fill fee calculator.

XIV. Conditions

The Central Valley Water Board has independently reviewed the record of the Project to analyze impacts to water quality and designated beneficial uses within the watersheds of the Project. In accordance with this Order, the Permittee may proceed with the Project under the following terms and conditions:

A. Authorization

Impacts to waters of the state shall not exceed quantities shown in Tables 1 and 2.

B. Reporting and Notification Requirements

The following section details the reporting and notification types and timing of submittals. Requirements for the content of these reporting and notification types are detailed in Attachment D, including specifications for photo and map documentation during the Project. Written reports and notifications must be submitted using the Reporting and Notification Cover Sheet located in Attachment D, which must be signed by the Permittee or an authorized representative.

The Permittee must submit all notifications, submissions, materials, data, correspondence, and reports in a searchable Portable Document Format (PDF). Documents less than 50 MB must be emailed to:
centralvalleysacramento@waterboards.ca.gov.

In the subject line of the email, include the Central Valley Water Board Contact, Project Name, and WDID No. Documents that are 50 MB or larger must be transferred to a disk and mailed to the Central Valley Water Board Contact.

1. Project Reporting

- a. Monthly Reporting:** The Permittee must submit a Monthly Report to the Central Valley Water Board on the 1st day of each month beginning the month after the submittal of the Commencement of Construction Notification. Monthly reporting shall continue until the Central Valley Water Board issues a Notice of Project Complete Letter to the Permittee.
- b. Annual Reporting – Not Applicable**

2. Project Status Notifications

- a. **Commencement of Construction:** The Permittee shall submit a Commencement of Construction Report at least seven (7) days prior to start of initial ground disturbance activities and corresponding Waste Discharge Identification Number (WDID No.) issued under the NPDES General Permit for Storm Water Discharges Associated with Construction and Land Disturbance Activities (Order No. 2009-0009-DWQ; NPDES No. CAS000002).
- b. **Request for Notice of Completion of Discharges Letter:** The Permittee shall submit a Request for Notice of Completion of Discharges Letter following completion of active Project construction activities, including any required restoration and permittee-responsible mitigation. This request shall be submitted to the Central Valley Water Board staff within thirty (30) days following completion of all Project construction activities. Upon acceptance of the request, Central Valley Water Board staff shall issue a Notice of Completion of Discharges Letter to the Permittee which will end the active discharge period.
- c. **Request for Notice of Project Complete Letter:** The Permittee shall submit a Request for Notice of Project Complete Letter when construction and/or any post-construction monitoring is complete, and no further Project activities will occur. Completion of post-construction monitoring shall be determined by Central Valley Water Board staff and shall be contingent on successful attainment of restoration and mitigation performance criteria. This request shall be submitted to Central Valley Water Board staff within thirty (30) days following completion of all Project activities. Upon approval of the request, the Central Valley Water Board staff shall issue a Notice of Project Complete Letter to the Permittee which will end the post discharge monitoring period.

3. Conditional Notifications and Reports:

The following notifications and reports are required as appropriate.

a. Accidental Discharges of Hazardous Materials²:

² "Hazardous material" means any material that, because of its quantity, concentration, or physical or chemical characteristics, poses a significant present or potential hazard to human health and safety or to the environment if released into the workplace or the environment. "Hazardous materials" include, but are not limited to, hazardous substances, hazardous waste, and any material that a handler or the administering agency has a reasonable basis for believing that it would be injurious to the health and safety of persons or harmful to the environment if released into the workplace or the environment. (Health & Safety Code, Section 25501.)

Following an accidental discharge of a reportable quantity of a hazardous material, sewage, or an unknown material, the following applies (Water Code, Section 13271):

- i. As soon as (A) Permittee has knowledge of the discharge or noncompliance, (B) notification is possible, and (C) notification can be provided without substantially impeding cleanup or other emergency measures then:
 - first call – 911 (to notify local response agency)
 - then call – Office of Emergency Services (OES) State Warning Center at:(800) 852-7550 or (916) 845-8911
 - Lastly, follow the required OES, procedures as set forth in the [Office of Emergency Services' Accidental Discharge Notification Web page](http://www.caloes.ca.gov/FireRescueSite/Documents/CalOES-Spill_Booklet_Feb2014_FINAL_BW_Acc.pdf) (http://www.caloes.ca.gov/FireRescueSite/Documents/CalOES-Spill_Booklet_Feb2014_FINAL_BW_Acc.pdf).
- ii. Following notification to OES, the Permittee shall notify Central Valley Water Board, as soon as practicable (ideally within 24 hours). Notification may be delivered via written notice, email, or other verifiable means.
- iii. Within five (5) working days of notification to the Central Valley Water Board, the Permittee must submit an Accidental Discharge of Hazardous Material Report.

b. Violation of Compliance with Water Quality Standards:

The Permittee shall notify the Central Valley Water Board of any event causing a violation of compliance with water quality standards. Notification may be delivered via written notice, email, or other verifiable means.

- i. This notification must be followed within three (3) working days by submission of a Violation of Compliance with Water Quality Standards Report.

c. In-Water Work and Diversions:

- i. The Permittee shall notify the Central Valley Water Board at least forty-eight (48) hours prior to initiating work in water or stream diversions. Notification may be delivered via written notice, email, or other verifiable means.
- ii. Within three (3) working days following completion of work in water or stream diversions, an In-Water Work/Diversions Water Quality Monitoring Report must be submitted to Central Valley Water Board staff.

d. Modifications to Project:

Project modifications may require an amendment of this Order. The Permittee shall give advance notice to Central Valley Water Board staff if Project implementation as described in the application materials is altered in any way or by the imposition of subsequent permit conditions by any local, state or federal regulatory authority by submitting a Modifications to Project Report. The Permittee shall inform Central Valley Water Board staff of any Project modifications that will interfere with the Permittee's compliance with this Order. Notification may be made in accordance with conditions in the certification deviation section of this Order.

e. Transfer of Property Ownership:

This Order is not transferable in its entirety or in part to any person or organization except after notice to the Central Valley Water Board in accordance with the following terms:

- i. The Permittee must notify the Central Valley Water Board of any change in ownership or interest in ownership of the Project area by submitting a Transfer of Property Ownership Report. The Permittee and purchaser must sign and date the notification and provide such notification to the Central Valley Water Board at least 10 days prior to the transfer of ownership. The purchaser must also submit a written request to the Central Valley Water Board to be named as the permittee in a revised order.
- ii. Until such time as this Order has been modified to name the purchaser as the permittee, the Permittee shall continue to be responsible for all requirements set forth in this Order.

f. Transfer of Long-Term BMP Maintenance:

If maintenance responsibility for post-construction BMPs is legally transferred, the Permittee must submit to the Central Valley Water Board a copy of such documentation and must provide the transferee with a copy of a long-term BMP maintenance plan that complies with manufacturer or designer specifications. The Permittee must provide such notification to the Central Valley Water Board with a Transfer of Long-Term BMP Maintenance Report at least 10 days prior to the transfer of BMP maintenance responsibility.

C. Water Quality Monitoring

1. General:

If surface water is present continuous visual surface water monitoring shall be conducted during active construction periods to detect accidental discharge of construction related pollutants (e.g. oil and grease, turbidity plume, or uncured concrete). Sampling is not required in a wetland where the entire

wetland is being permanently filled, provided there is no outflow connecting the wetland to surface waters. The Permittee shall perform surface water sampling:

- a. when performing any in-water work;
- b. during the entire duration of temporary surface water diversions;
- c. in the event that the Project activities result in any materials reaching surface waters; or
- d. when any activities result in the creation of a visible plume in surface waters.

2. Accidental Discharges/Noncompliance:

Upon occurrence of an accidental discharge of hazardous materials or a violation of compliance with a water quality standard, Central Valley Water Board staff may require water quality monitoring based on the discharge constituents and/or related water quality objectives and beneficial uses.

3. In-Water Work or Diversions:

During planned in-water work, dewatering activities, or during the installation of removal of temporary water diversions, any discharge(s) to waters of the state shall conform to the following water quality standards:

- a. Waters shall not contain oils, greases, waxes, or other materials in concentrations that cause nuisance, result in a visible film or coating on the surface of the water or on objects in the water, or otherwise adversely affect beneficial uses.
- b. Activities shall not cause turbidity increases in surface water to exceed:
 - i. where natural turbidity is less than 1 Nephelometric Turbidity Units (NTUs), controllable factors shall not cause downstream turbidity to exceed 2 NTU;
 - ii. where natural turbidity is between 1 and 5 NTUs, increases shall not exceed 1 NTU;
 - iii. where natural turbidity is between 5 and 50 NTUs, increases shall not exceed 20 percent;
 - iv. where natural turbidity is between 50 and 100 NTUs, increases shall not exceed 10 NTUs;
 - v. where natural turbidity is greater than 100 NTUs, increases shall not exceed 10 percent.

In determining compliance with the above limits, appropriate averaging periods may be applied provided that beneficial uses will be fully

protected. Averaging periods may only be used with prior permission of the Central Valley Water Board Executive Officer.

Sampling during in-water work or during the entire duration of temporary water diversions shall be conducted in accordance with Table 3 sampling parameters.³ The sampling requirements in Table 3 shall be conducted upstream out of the influence of the Project, and approximately 300 feet downstream of the work area.

The sampling frequency and/or monitoring locations may be modified for certain projects with written approval from Central Valley Water Board staff. An In-Water Work and Diversion Water Quality Monitoring Report, as described in Attachment D, shall be submitted within two weeks on initiation of in-water construction, and every two weeks thereafter. In reporting the data, the Permittee shall arrange the data in tabular form so that the sampling locations, date, constituents, and concentrations are readily discernible. The data shall be summarized in such a manner to illustrate clearly whether the Project complies with Order requirements. The report shall include surface water sampling results, visual observations, and identification of the turbidity increase in the receiving water applicable to the natural turbidity conditions specified in the turbidity criteria in XIV.C.3.

If no sampling is required, the Permittee shall submit a written statement stating, "No sampling was required" within two weeks on initiation of in-water construction, and every two weeks thereafter.

Table 3: Sample Type and Frequency Requirements

Parameter	Unit of Measurement	Type of Sample	Minimum Frequency
Turbidity	NTU	Grab	Every 4 hours
Visible construction related pollutants ⁴	Observations	Visual Inspections	Continuous throughout the construction period

³ Pollutants shall be analyzed using the analytical methods described in 40 Code of Federal Regulations Part 136; where no methods are specified for a given pollutant, the method shall be approved by Central Valley Water Board staff. Grab samples shall be taken between the surface and mid-depth and not be collected at the same time each day to get a complete representation of variations in the receiving water. A hand-held field meter may be used, provided the meter utilizes a U.S. EPA-approved algorithm/method and is calibrated and maintained in accordance with the manufacturer's instructions. A calibration and maintenance log for each meter used for monitoring shall be maintained onsite.

⁴ Visible construction-related pollutants include oil, grease, foam, fuel, petroleum products, and construction-related, excavated, organic or earthen materials.

4. Post-Construction:

Visually inspect the Project site during the rainy season for one year following completion of active Project construction activities to ensure excessive erosion, stream instability, or other water quality pollution is not occurring in or downstream of the Project site. If water quality pollution is occurring, contact the Central Valley Water Board staff member overseeing the Project within three (3) working days. The Central Valley Water Board may require the submission of a Violation of Compliance with Water Quality Standards Report. Additional permits may be required to carry out any necessary site remediation.

D. Standard

1. This Order is subject to modification or revocation upon administrative or judicial review, including review and amendment pursuant to Water Code section 13330, and California Code of Regulations, title 23, Chapter 28, article 6 commencing with sections 3867-3869, inclusive. Additionally, the Central Valley Water Board reserves the right to suspend, cancel, or modify and reissue this Order, after providing notice to the Permittee, if the Central Valley Water Board determines that: the Project fails to comply with any of the conditions of this Order; or, when necessary to implement any new or revised water quality standards and implementation plans adopted or approved pursuant to the Porter-Cologne Water Quality Control Act (Water Code, section 13000 et seq.) or federal Clean Water Act section 303 (33 U.S.C. section 1313). For purposes of Clean Water Act section 401(d), the condition constitutes a limitation necessary to assure compliance with water quality standards and appropriate requirements of state law.
2. This Order is not intended and shall not be construed to apply to any activity involving a hydroelectric facility requiring a Federal Energy Regulatory Commission (FERC) license or an amendment to a FERC license, unless the pertinent certification application was filed pursuant to subsection 3855(b) of chapter 28, title 23 of the California Code of Regulations, and that application specifically identified that a FERC license or amendment to a FERC license for a hydroelectric facility was being sought.
3. This Order is conditioned upon total payment of any fee required under title 23 of the California Code of Regulations and owed by the Permittee.
4. In the event of any violation or threatened violation of the conditions of this Order, the violation or threatened violation shall be subject to any remedies, penalties, process, or sanctions as provided for under state and federal law. For purposes of Clean Water Act, section 401(d), the applicability of any state law authorizing remedies, penalties, processes, or sanctions for the violation or threatened violation constitutes a limitation necessary to assure

compliance with the water quality standards and other pertinent requirements incorporated into this Order.

E. General Compliance

1. Failure to comply with any condition of this Order shall constitute a violation of the Porter-Cologne Water Quality Control Act and the Clean Water Act. The Permittee and/or discharger may then be subject to administrative and/or civil liability pursuant to Water Code section 13385.
2. Permitted actions must not cause a violation of any applicable water quality standards, including impairment of designated beneficial uses for receiving waters as adopted in the Basin Plans by any applicable Regional Water Board or any applicable State Water Board (collectively Water Boards) water quality control plan or policy. The source of any such discharge must be eliminated as soon as practicable.
3. In response to a suspected violation of any condition of this Order, the Central Valley Water Board may require the holder of this Order to furnish, under penalty of perjury, any technical or monitoring reports the Water Boards deem appropriate, provided that the burden, including costs, of the reports shall bear a reasonable relationship to the need for the reports and the benefits to be obtained from the reports. The additional monitoring requirements ensure that permitted discharges and activities comport with any applicable effluent limitations, water quality standards, and/or other appropriate requirement of state law.
4. The Permittee must, at all times, fully comply with engineering plans, specifications, and technical reports submitted to support this Order; and all subsequent submittals required as part of this Order. The conditions within this Order and Attachments supersede conflicting provisions within Permittee submittals.
5. This Order and all of its conditions contained herein continue to have full force and effect regardless of the expiration or revocation of any federal license or permit issued for the Project. For purposes of Clean Water Act, section 401(d), this condition constitutes a limitation necessary to assure compliance with the water quality standards and other pertinent requirements of state law.
6. The Permittee shall adhere to all requirements in the mitigation monitoring and reporting program (MMRP), which is incorporated herein by reference and any additional measures as outlined in Attachment C, CEQA Findings of Fact.
7. **Construction General Permit Requirement:** The Permittee shall obtain coverage under the National Pollutant Discharge Elimination System (NPDES) General Permit for Storm Water Discharges Associated with

Construction and Land Disturbance Activities (Order No. 2009-0009-DWQ; NPDES No. CAS000002), as amended, for discharges to surface waters comprised of storm water associated with construction activity, including, but not limited to, demolition, clearing, grading, excavation, and other land disturbance activities of one or more acres, or where projects disturb less than one acre but are part of a larger common plan of development that in total disturbs one or more acres.

The California Department of Transportation shall comply with their General NPDES Permit Order No 2012-0011-DWQ (NPDES No. CAS 000003) issued by the State Water Resources Control Board.

F. Administrative

1. Signatory requirements for all document submittals required by this Order are presented in Attachment E of this Order.
2. This Order does not authorize any act which results in the taking of a threatened, endangered or candidate species or any act, which is now prohibited, or becomes prohibited in the future, under either the California Endangered Species Act (Fish & Wildlife Code, sections 2050-2097) or the federal Endangered Species Act (16 U.S.C. sections 1531-1544). If a "take" will result from any act authorized under this Order held by the Permittee, the Permittee must comply with the California Endangered Species Act and federal Endangered Species Act prior to any construction or operation of the portion of the Project that may result in a take. The Permittee is responsible for meeting all requirements of the applicable endangered species act for the Project authorized under this Order.
3. The Permittee shall grant Central Valley Water Board staff, or an authorized representative (including an authorized contractor acting as a Water Board representative), upon presentation of credentials and other documents as may be required by law, permission to:
 - a. Enter upon the Project or compensatory mitigation site(s) premises where a regulated facility or activity is located or conducted, or where records are kept.
 - b. Have access to and copy any records that are kept and are relevant to the Project or the requirements of this Order.
 - c. Inspect any facilities, equipment (including monitoring and control equipment), practices, or operations regulated or required under this Order.
 - d. Sample or monitor for the purposes of assuring Order compliance.
4. A copy of this Order shall be provided to any consultants, contractors, and subcontractors working on the Project. Copies of this Order shall remain at the Project site for the duration of this Order. The Permittee shall be

responsible for work conducted by its consultants, contractors, and any subcontractors.

5. A copy of this Order must be available at the Project site(s) during construction for review by site personnel and agencies. All personnel performing work on the Project shall be familiar with the content of this Order and its posted location at the Project site.
6. **Lake or Streambed Alteration Agreement:** The Permittee shall submit a signed copy of the California Department of Fish and Wildlife's Lake or Streambed Alteration Agreement to the Central Valley Water Board immediately upon execution and prior to any discharge to waters of the state.

G. Construction

5. Dewatering

- a. If water is present, the area must be dewatered prior to start of work.
- b. No dewatering will occur within the Project area.
- c. This Order does not allow permanent water diversion of flow from the receiving water. This Order is invalid if any water is permanently diverted as a part of the project.
- d. The Permittee shall work with the Central Valley Water Board to obtain coverage under an NPDES permit for dewatering activities that result in discharges into surface water. The Permittee shall work with the Central Valley Water Board to obtain coverage under Waste Discharge Requirements (WDRs) for dewatering activities that result in discharges to land.

6. Directional Drilling- Not Applicable

7. Dredging- Not Applicable

8. Fugitive Dust

Dust abatement activities can cause discharges of sediment to streams and uplands through application of water or other fluids. Dust abatement chemicals added to water can be hazardous to wildlife and, if allowed to enter streams, detrimental to water quality. Therefore, dust abatement activities shall be conducted so that sediment or dust abatement chemicals are not discharged into waters of the state. Dust abatement products or additives that are known to be detrimental to water quality or wildlife shall not be used, unless specific management needs are documented, and product-specific application plans are approved by Central Valley Water Board staff.

9. Good Site Management “Housekeeping”

- a. The Permittee shall develop and maintain onsite a project-specific Spill Prevention, Containment and Cleanup Plan outlining the practices to prevent, minimize, and/or clean up potential spills during construction of the Project. The Plan must detail the Project elements, construction equipment types and location, access and staging and construction sequence. The Plan must be made available to the Central Valley Water Board staff upon request.
- b. Refueling of equipment within the floodplain or within 300 feet of the waterway is prohibited. If critical equipment must be refueled within 300 feet of the waterway, spill prevention and countermeasures must be implemented to avoid spills. Refueling areas shall be provided with secondary containment including drip pans and/or placement of absorbent material. No hazardous materials, pesticides, fuels, lubricants, oils, hydraulic fluids, or other construction-related potentially hazardous substances should be stored within a floodplain or within 300 feet of a waterway. The Permittee must perform frequent inspections of construction equipment prior to utilizing it near surface waters to ensure leaks from the equipment are not occurring and are not a threat to water quality.
- c. All materials resulting from the Project shall be removed from the site and disposed of properly.

10. Hazardous Materials

- a. The discharge of petroleum products, any construction materials, hazardous materials, pesticides, fuels, lubricants, oils, hydraulic fluids, raw cement, concrete or the washing thereof, asphalt, paint, coating material, drilling fluids, or other substances potentially hazardous to fish and wildlife resulting from or disturbed by project-related activities is prohibited and shall be prevented from contaminating the soil and/or entering waters of the state. In the event of a prohibited discharge, the Permittee shall comply with notification requirements in sections XIV.B.3.a, and XIV.B.3.b.
- b. No wet concrete will be placed into wetland and stream channel habitat.

11. Invasive Species and Soil Borne Pathogens

Prior to arrival at the project site and prior to leaving the project site, construction equipment that may contain invasive plants and/or seeds shall be cleaned to reduce the spread of noxious weeds.

12. Post-Construction Storm Water Management- Not Applicable

13. Roads

- a. The number of access routes, number and size of staging areas, and the total area of the activity must be limited to the minimum necessary to achieve the project goal. Routes and work area boundaries must be clearly demarcated.
- b. Bridges, culverts, dip crossings, or other structures must be installed so that water and in-stream sediment flow is not impeded. Appropriate design criteria, practices and materials must be used in areas where access roads intersect waters of the state.
- c. Temporary materials placed in any water of the state must be removed as soon as construction is completed at that location, and all temporary roads must be removed or re-contoured and restored according to approved re-vegetation and restoration plans.
- d. Any structure, including but not limited to, culverts, pipes, piers, and coffer dams, placed within a stream where fish (as defined in California Fish and Game Code section 45) exist or may exist, must be designed, constructed, and maintained such that it does not constitute a barrier to upstream or downstream movement of aquatic life, or cause an avoidance reaction by fish due to impedance of their upstream or downstream movement. This includes, but is not limited to, maintaining the supply of water and maintaining flows at an appropriate depth, temperature, and velocity to facilitate upstream and downstream fish migration. If any structure results in a long-term reduction in fish movement, the discharger shall be responsible for restoration of conditions as necessary (as determined by the Water Board) to secure passage of fish across the structure.
- e. A method of containment must be used below any temporary bridge, trestle, boardwalk, and/or other stream crossing structure to prevent any debris or spills from falling into the waters of the state. Containment must be maintained and kept clean for the life of the temporary stream crossing structure.

14. Sediment Control

- a. Except for activities permitted by the United States Army Corps of Engineers under Section 404 of the Clean Water Act and/or Section 10 of the Rivers and Harbors Act, soil, silt, or other organic materials shall not be placed where such materials could pass into surface water or surface water drainage courses.
- b. Silt fencing, straw wattles, or other effective management practices must be used along the construction zone to minimize soil or sediment along

the embankments from migrating into the waters of the state through the entire duration of the Project.

- c. The use of netting material (e.g., monofilament-based erosion blankets) that could trap aquatic dependent wildlife is prohibited within the Project area.

15. Special Status Species

The following special status species are documented to occur within or near the Project area: vernal pool fairy shrimp, vernal pool tadpole shrimp, California tiger salamander, California red-legged frog, Sierra Nevada yellow-legged frog, western spadefoot toad, northern goshawk, great gray owl, California spotted owl, western red bat, Sierra Nevada snowshoe hare, and Sierra Nevada red fox.

16. Stabilization/Erosion Control

- a. All areas disturbed by Project activities shall be protected from washout and erosion.
- b. Hydroseeding shall be performed with California native seed mix.

17. Storm Water

- a. During the construction phase, the Permittee must employ strategies to minimize erosion and the introduction of pollutants into storm water runoff. These strategies must include the following:
 - i. An effective combination of erosion and sediment control Best Management Practices (BMPs) must be implemented and adequately working prior to the rainy season and during all phases of construction.

H. Site Specific- Not Applicable

I. Total Maximum Daily Load (TMDL)

The Sacramento-San Joaquin Delta Methylmercury Total Maximum Daily Loads (TMDL) is an action plan to restore clean water that has been contaminated by mercury and has experienced or has the potential to produce methylmercury within waters of the state. Section 303(d) of the federal Clean Water Act requires that states identify water bodies -- bays, rivers, streams, creeks, and coastal areas -- that do not meet water quality standards, and the pollutants that impair them. TMDLs examine specific water quality problems, identify sources of pollutants, and specify actions that create solutions. They are adopted by the Regional Water Board as amendments to our Region's Basin Plan. A copy of the Sacramento-San Joaquin Delta Methylmercury TMDL is located on the Central Valley Water Board website at: [Sacramento-San Joaquin Delta Methylmercury TMDL - TMDL Projects | Central Valley Regional Water Quality Control Board \(ca.gov\)](http://www.cvwrb.org/Sacramento-San_Joaquin_Delta_Methylmercury_TMDL_-_TMDL_Projects_|_Central_Valley_Regional_Water_Quality_Control_Board_(ca.gov))

(https://www.waterboards.ca.gov/rwqcb5/water_issues/tmdl/central_valley_projects/delta_hg/).

J. Mitigation for Temporary Impacts

1. The Permittee shall restore all areas of temporary impacts, including Project site upland areas, which could result in a discharge to waters of the state to pre-construction contours and conditions upon completion of construction activities.
2. The Central Valley Water Board may extend the monitoring period beyond requirements of the restoration plan upon a determination by Executive Officer that the performance standards have not been met or are not likely to be met within the monitoring period.
3. If restoration of temporary impacts to waters of the state is not completed within 90 days of the impacts, compensatory mitigation may be required to offset temporal loss of waters of the state.

K. Compensatory Mitigation for Permanent Impacts:

1. Compensatory Mitigation Plan

- a. The Permittee has submitted an approved draft compensatory mitigation plan as part of a complete application. The Permittee shall provide a final compensatory mitigation plan for written acceptance by Central Valley Water Board staff. Impacts to waters of the state are not authorized and shall not occur until a compensatory mitigation plan has been approved by Central Valley Water Board staff. Upon acceptance by Central Valley Water Board staff, the Permittee shall implement the approved plan.
- b. The final compensatory mitigation plan shall include all plan elements as outlined in 40 CFR section 230.94(c).
- c. Permittees fulfilling their compensatory mitigation obligations by securing credits from an approved mitigation bank or in-lieu fee program, need only include the items described in 40 CFR section 230.94(c)(5)-(6), and the name of the specific mitigation bank or in-lieu fee program to be used.

Table 4: Total Required Project Compensatory Mitigation Quantity for Permanent Physical Loss of Area

Aquatic Resource Type	Mitigation Type	Units	Est.	Re-est.	Reh.	Enh.	Pres.	Unknown
Stream Channel	In-Lieu Fee Credits	Acres	0.009					
Wetland	In-Lieu Fee Credits	Acres	0.0004					

L. Certification Deviation

1. Minor modifications of Project locations or predicted impacts may be necessary as a result of unforeseen field conditions, necessary engineering re-design, construction concerns, or similar reasons. Some of these prospective Project modifications may have impacts on water quality. Some modifications of Project locations or predicted impacts may qualify as Certification Deviations as set forth in Attachment F. For purposes of this Certification, a “Certification Deviation” is a Project locational or impact modification that does not require an immediate amendment of the Order, because the Central Valley Water Board has determined that any potential water quality impacts that may result from the change are sufficiently addressed by the Order conditions and the CEQA Findings. After the termination of construction, this Order will be formally amended to reflect all authorized Certification Deviations and any resulting adjustments to the amount of water resource impacts and required compensatory mitigation amounts.

2. A Project modification shall not be granted a Certification Deviation if it warrants or necessitates changes that are not addressed by the Order conditions or the CEQA environmental document such that the Project impacts are not addressed in the Project’s environmental document or the conditions of this Order. In this case a supplemental environmental review and different Order will be required.

XV. Water Quality Certification

I hereby issue the Order for the State Route 120 Tuolumne Drainage System (SR 26) Project, WDID # 5B05CR00116, certifying that as long as all of the conditions listed in this Order are met, any discharge from the referenced Project will comply with the applicable provisions of Clean Water Act sections 301 (Effluent Limitations), 302 (Water Quality Related Effluent Limitations), 303 (Water Quality Standards and Implementation Plans), 306 (National Standards of Performance), and 307 (Toxic and Pretreatment Effluent Standards). The Central Valley Water Board, as lead agency, hereby adopts an initial study/mitigated negative declaration (IS/MND) (State Clearinghouse (SCH) No. 2022060223) and approves the mitigation monitoring and reporting program (MMRP) Initial Study/Mitigated Negative Declaration March 2022 for the Project.

Except insofar as may be modified by any preceding conditions, all Order actions are contingent on: (a) the discharge being limited and all proposed mitigation being completed in strict compliance with the conditions of this Order and the attachments to this Order; and, (b) compliance with all applicable requirements of Statewide Water Quality Control Plans and Policies, the Regional Water Boards' Water Quality Control Plans and Policies.

Original Signed by Anne Walters for:

Patrick Pulupa, Executive Officer
Central Valley Regional Water Quality Control Board

- Attachment A:** Project Map
- Attachment B:** Receiving Waters, Impacts, and Mitigation Information
- Attachment C:** CEQA Findings of Facts
- Attachment D:** Report and Notification Requirements
- Attachment E:** Signatory Requirements
- Attachment F:** Certification Deviation Procedures
- Attachment G:** Compliance with Code of Federal Regulations

(This page intentionally left blank)

Attachment A – Project Maps

Figure 1: Location Map

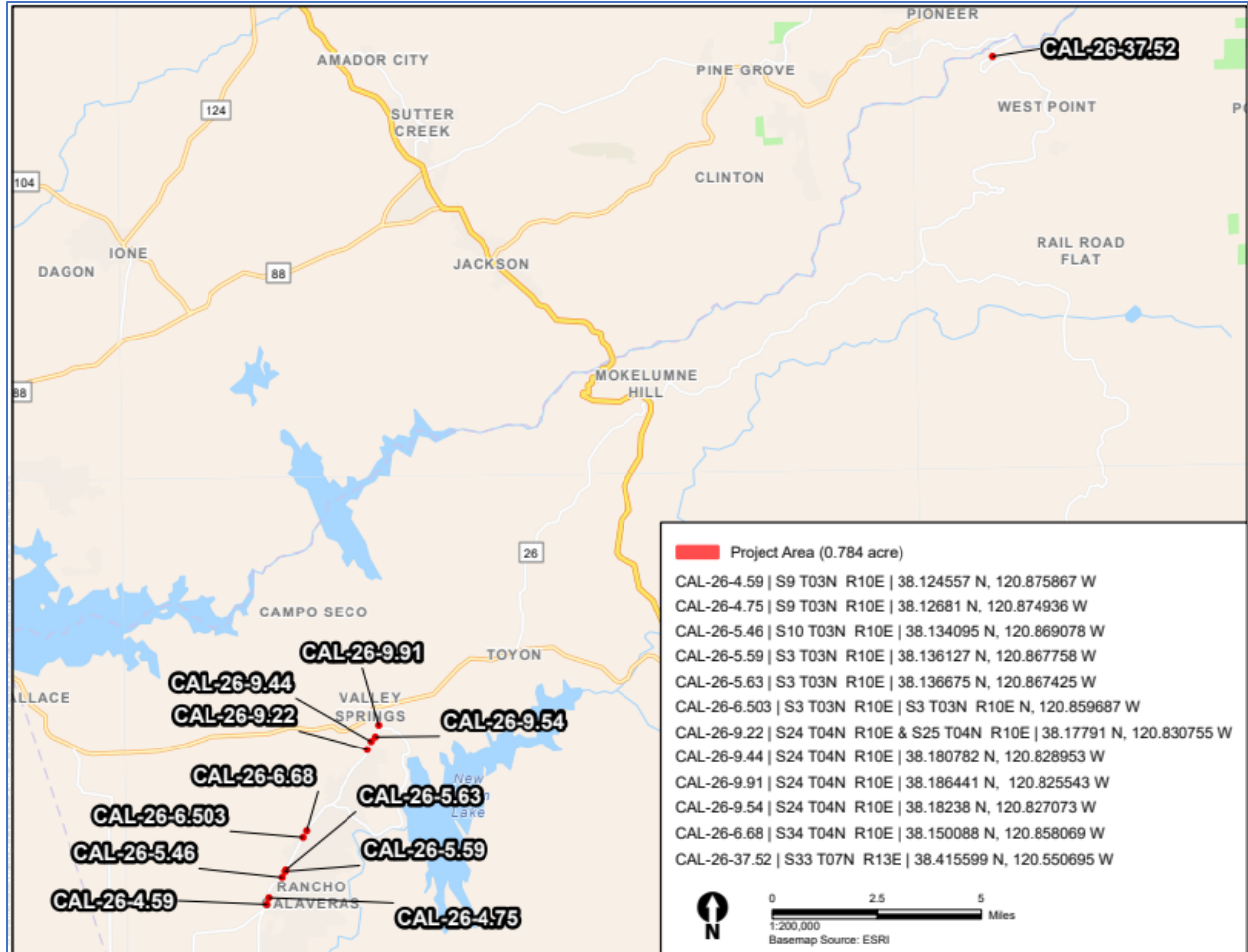

(This page intentionally left blank)

Attachment B – Receiving Waters, Impacts and Mitigation Information

The following table shows the receiving waters associated with each impact site.

Table 1: Receiving Water(s) Information

Non-Federal Waters	Impact Site ID	Waterbody Name	Impacted Aquatic Resources Type	Water Board Hydrologic Units	Receiving Waters	Receiving Waters Beneficial Uses	303d Listing Pollutant
No	Impact site	Downstream water bodies include Indian Creek and Cosgrove Creek	Stream channel, wetland	531.30	Lower Calaveras	COLD, IND, MUN, PROC, REC2, WARM, WILD, AGR-IRR, AGR-STK, REC1-RAFT, MIGR-COLD, MIGR-WARM, SPWN-COLD, SPWN-WARM	

Individual Direct Impact Locations

The following tables show individual impacts.

Table 2: Individual Temporary Fill/Excavation Impact Information

Impact Site ID	Latitude	Longitude	Indirect Impact Requiring Mitigation?	Acres	Cubic Yards	Linear Feet
Impact Site	Start: 38°7'29.29" End: 38°24'56.15"	Start: -120°52'33.12" End: -120°33'2.50"	No	0.016	26	389

Table 3: Individual Permanent Fill/Excavation Impact Information

Impact Site ID	Latitude	Longitude	Indirect Impact Requiring Mitigation?	Acres	Cubic Yards	Linear Feet
Impact Site	Start: 38° 7' 29.29" End: 38° 24' 56.15"	Start:-120° 52' 33.12" End: -120° 33' 2.50"	No	0.0094	5.65	204

Compensatory Mitigation Information

The following table(s) show individual compensatory mitigation information and locations.

In-Lieu Fee Compensatory Mitigation Information

Table 4: In-Lieu Fee Program

In-Lieu Fee Program Name:	The National Fish and Wildlife Foundation's Sacramento District California In-Lieu Fee Program
Website:	Sacramento District California In-Lieu Fee Program NFWF (https://www.nfwf.org/mitigating-impacts/sacramento-district-california-lieu-fee-program)
In-Lieu Fee Program Contact Name:	TBD
Phone:	TBD
Email:	TBD
In-Lieu Fee Program Location - County:	Tuolumne or Calaveras
Latitude:	TBD
Longitude:	TBD

Table 5: Mitigation Type Information

Aquatic Resource Credit Type	Acres	Linear Feet	Number of Credits Purchased
Stream Channel	0.009	204	0.009
Wetland	0.0004		0.0004

(This page is intentionally left blank)

Attachment C – CEQA Findings of Fact

A. Environmental Review

On 10 June 2022, the California Department of Transportation, as lead agency, adopted an Initial Study/Mitigated Negative Declaration (IS/MND) (State Clearinghouse (SCH) No. 2022060223) for the Project and filed a Notice of Determination (NOD) at the SCH on 16 December 2022. The Central Valley Water Board is a responsible agency under CEQA (Public Resources Code, section 21069) and in making its determinations and findings, must presume that California Department of Transportation's adopted environmental document comports with the requirements of CEQA and is valid. (Public Resources Code, section 21167.3.) The Central Valley Water Board has reviewed and considered the environmental document and finds that the environmental document prepared by California Department of Transportation addresses the Project's water resource impacts. (California Code of Regulations, title 14, section 15096, subd. (f).) The environmental document includes the mitigation monitoring and reporting program (MMRP) developed by California Department of Transportation for all mitigation measures that have been adopted for the Project to reduce potential significant impacts. (Public Resources Code, section 21081.6, subd. (a)(1); California Code of Regulations, title 14, section 15074, subd. (d).)

B. Incorporation by Reference

Pursuant to CEQA, these Findings of Facts (Findings) support the issuance of this Order based on the Project IS/MND, the application for this Order, and other supplemental documentation.

All CEQA project impacts, including those discussed in subsection C below, are analyzed in detail in the Project Final IS/MND which is incorporated herein by reference. The Project IS/MND is available at: [State Route 120 Tuolumne Drainage System \(10-1F250\) \(ca.gov\)](https://ceqanet.opr.ca.gov/2022060223) (https://ceqanet.opr.ca.gov/2022060223).

Requirements under the purview of the Central Valley Water Board in the MMRP are incorporated herein by reference.

The Permittee's application for this Order, including all supplemental information provided, are incorporated herein by reference.

C. Findings

The IS/MND describes the potential significant environmental effects to water resources that were mitigated in the IS/MND. Having considered the whole of the record, the Central Valley Water Board makes the following findings:

Mitigation measures have been required in the Project which avoid or mitigate to a less than significant level the potentially significant environmental effect as described in the IS/MND.

a.i. Potential Significant Impact:

- Have a substantial adverse effect, either directly or through habitat modifications, on any species identified as a candidate, sensitive, or special-status species in local or regional plans, policies, or regulations, or by the California Department of Fish and Wildlife, U.S. Fish and Wildlife Service, or National Oceanic Atmospheric Administration Fisheries.
- Have a substantial adverse effect on any riparian habitat or other sensitive natural community identified in local or regional plans, policies, regulations or by the California Department of Fish and Wildlife or U.S. Fish and Wildlife Service.
- Have a substantial adverse effect on state or federally protected wetlands (including, but not limited to, marsh, vernal pool, coastal, etc.) through direct removal, filling, hydrological interruption, or other means.

a.ii. Facts in Support of Finding:

BIO-1: Conduct Worker Environmental Awareness Training for construction personnel.

BIO-2: Install fencing and/or flagging to protect sensitive biological resources.

BIO-3: Retain an agency-approved biologist to conduct periodic monitoring during construction in sensitive habitats.

BIO-4: Restrict in-stream work to low-flow period.

BIO-5: Dewater the construction site and provide a clean water diversion through the project work limits to maintain flows.

BIO-6: Protect water quality and prevent erosion and sedimentation in aquatic habitat.

Construction Best Management Practices that are consistent with the most recent Caltrans manuals, including the Construction Site Best Management Practices manual, the Stormwater Pollution Prevention Plan manual, and the Water Pollution Control Program manual, will be developed for the project and will be implemented throughout the course of construction to avoid or reduce adverse effects to water quality. Construction Best Management Practices associated with an erosion control plan will be prepared for avoiding the discharge of pollutants from vehicle/equipment cleaning into aquatic and other sensitive habitats. Caltrans personnel and the contractor will perform routine inspections of the construction areas to verify that Construction Best Management Practices are being properly implemented, maintained, and operating as designed. A water quality inspector will inspect sites before and after a rain event to ensure that Stormwater Best Management Practices are adequate.

BIO-7: Recontour and revegetate disturbed areas.

To control erosion and restore habitat value, all areas within the work areas that are disturbed during construction will be recontoured if necessary and stabilized as soon as possible following the completion of construction. Roadside areas will be revegetated with a Caltrans-approved, appropriate weed-free and non-invasive plant seed mixture.

BIO-8: Compensate for permanent impacts to Waters of the U.S. and State.

To compensate for the permanent loss of up to 0.005 acre of Waters of the U.S. and Waters of the State associated with culvert rehabilitation activities, Caltrans will purchase the appropriate aquatic resource credits at an approved mitigation bank or contribute to an agency-approved in-lieu fee program to ensure no net loss of functions and values of aquatic resources. The compensation ratio will be a minimum of a 1 to 1 ratio (1 acre of aquatic resource habitat credit for every 1 acre of impact), to ensure no net loss of habitat functions and values.

BIO-9: Avoid and minimize potential disturbance of woody vegetation.

Caltrans will avoid and minimize potential disturbance of woody vegetation in riparian and oak woodland communities by implementing the following measures:

- The need for tree removal will be reduced, to the most feasible extent, by adjusting guardrail locations within the preestablished permanent impact area to avoid trees and their root systems.
- The potential for long-term loss of woody vegetation will be minimized by trimming vegetation rather than removing entire trees or shrubs in areas where complete removal is not required. Trees or shrubs that need to be trimmed will be cut at least 1 foot above ground level to leave the root systems intact and allow for more rapid regeneration. Cutting will be limited to the minimum area necessary within the construction zone. To protect nesting birds, Caltrans will not allow pruning or removal of woody vegetation between February 1 and September 30 without preconstruction surveys. An arborist will be retained to monitor any necessary pruning or root cutting of retained trees, as necessary.
- The areas that undergo vegetative pruning and tree removal will be inspected immediately before construction, immediately after construction, and 1 year after construction to determine the amount of existing vegetative cover, cover that has been removed, and cover that resprouts. After 1 year, if these areas have not resprouted sufficiently to return the cover to the pre-project level, Caltrans will replant the areas with appropriate native species to reestablish the cover to the pre-project condition.

BIO-10: Compensate for loss of riparian habitat.

Caltrans will compensate for construction-related effects and loss of riparian habitat at a minimum 1-to-1 ratio (1 acre or 1-inch diameter at breast height of mitigation for every 1 acre or 1-inch diameter at breast height of riparian habitat removed). Final compensation ratios will be based on site specific information and determined through coordination with the appropriate agencies during the permitting process. Caltrans will implement onsite and, if necessary, offsite restoration measures and/or purchase mitigation bank credits to compensate for temporary and permanent losses of riparian habitat. Onsite restoration will be used to the maximum extent practicable. If onsite or offsite restoration/enhancement is not feasible, Caltrans will purchase mitigation bank credits at a locally approved bank if one is available.

BIO-11: Conduct preconstruction special-status plant surveys and minimize impacts on special-status plants.

Before project activities, Caltrans will retain a qualified botanist to conduct blooming-period surveys for the presence of special-status plants identified as potentially occurring in the Biological Study Area, as listed in Table 3-2 of the Natural Environment Study. Botanical surveys should occur within 1 year of construction and will include both spring and summer surveys to capture the blooming period of all special-status plants with suitable habitat present in the project footprints.

If special-status plants are documented within the project area during botanical surveys, individual plants or groups of plants will be flagged and location data collected using the Global Positioning System so that these areas can be added to the final construction drawings. To the extent feasible, Caltrans will install exclusion fencing or flagging, consistent with BIO-2: Install Fencing and/or Flagging to Protect Sensitive Biological Resources, around known areas of special-status plants to avoid direct impacts (i.e., removal or crushing).

If impacts on special-status plants cannot be avoided, based on California Fish and Game Code Section 1913(c) requirements for public agency activities where endangered or rare plants are known to be present, Caltrans will provide a courtesy notification to the California Department of Fish and Wildlife as soon as possible and no less than 10 days in advance of ground-disturbing activities to allow the California Department of Fish and Wildlife an opportunity to salvage the affected special-status plants.

BIO-12: Avoid potential indirect impacts on habitat for vernal pool branchiopods and other vernal pool species.

The following avoidance and minimization efforts will be implemented before and during construction to protect habitat for the vernal pool fairy shrimp, vernal pool tadpole shrimp, and other vernal pool species outside the area of proposed ground disturbance.

BIO-13: Retain a qualified biologist to conduct preconstruction surveys for California tiger salamander, California red-legged frog, and western spadefoot toad.

Qualified biologist(s) will conduct visual encounter preconstruction surveys of each site no more than 14 days before the start of ground-disturbing activities (including vegetation removal and equipment staging) within suitable habitat for the California tiger salamander, California red-legged frog, and western spadefoot toad at culvert locations along State Route 12 (CAL-12- 2.44, CAL-12- 2.80, CAL12-9.65), along State Route 26 (CAL-26-9.91, CAL26-9.54, CAL-26- 9.44, CAL-26-9.22, CAL-26-6.95, CAL-26-6.68, CAL-26- 5.86, CAL-26-5.63, CAL-26-5.59, CAL-26-5.46, CAL-26-5.24, CAL-26-4.75, and CAL-26-4.59), and State Route 120 (TUU-120-3.39 and TUO-120-14.14). The surveys will pay particular attention to detecting any burrows, crevices, and other cover sites that could be used as refugia by the species.

If any burrows are discovered, they will be flagged or otherwise marked and avoided. Any sightings of California tiger salamanders, California red-legged frogs, or western spadefoot toads will be immediately reported to Caltrans, and construction will not start at that location until the species has moved out of the work area of its own accord and the appropriate agencies are consulted on the need for additional protection measures.

BIO-14: Install exclusion fencing between the work area and suitable habitat for California tiger salamander, California red-legged frog, and western spadefoot toad.

To prevent California tiger salamanders, California red-legged frogs, and western spadefoot toads from entering the active work area during construction at culvert locations along State Route 12 (CAL-12-2.44, CAL-12- 2.80, CAL12-9.65), along State Route 26 (CAL-26-9.91, CAL-26-9.54, CAL26-9.44, CAL-26-9.22, CAL-26- 6.95, CAL-26-6.68, CAL-26-5.86, CAL-26- 5.63, CAL-26-5.59, CAL-26-5.46, CAL-26-5.24, CAL-26-4.75, and CAL-26- 4.59), and State Route 120 (TUU-120- 3.39 and TUO-120-14.14), Exclusion fencing will not be installed when the work area abuts developed residential or commercial areas (e.g., along the east side of State Route 26). Exclusion fencing will be at least 3 feet tall, and the lower 6 inches of the fence will be buried in the ground to prevent animals from crawling under. The remaining 2.5 feet will be left above ground to serve as a barrier for animals moving on the ground surface. Exclusion fencing will be pulled tight at each support to prevent folds or snags. Exclusion fencing will be installed and maintained in good condition during all construction activities. Such fencing will be inspected and maintained daily until the completion of the work at the site.

BIO-15: Check for animals under construction equipment and vehicles prior to moving.

Before being moved, vehicles and equipment will be checked for any California tiger salamanders, California red-legged frogs, or other sensitive wildlife

sheltering underneath them. If an animal is seen, the vehicles and/or equipment will not be moved until the individual has left the area of its own accord.

BIO-16: Install escape ramps in holes or trenches measuring more than 6 feet deep.

To prevent the inadvertent entrapment of California tiger salamanders, California red-legged frogs, or other animals during construction, any excavations, steep-walled holes, or trenches measuring more than 6 inches deep will be covered at the close of each working day using plywood or similar materials (without openings) or will be provided with one or more escape ramps built out of earth fill or wooden planks in the event that the holes/trenches cannot be fully covered. All holes or trenches will be checked daily for trapped wildlife; they will also be thoroughly inspected before being filled. If at any time a trapped animal is discovered, the qualified biologist(s) will install escape ramps or other appropriate structures (if not already in place) to enable the individual the opportunity to escape on its own.

BIO-17: Limit the use of artificial lighting.

The use of temporary, artificial lighting onsite will be limited except when necessary for construction or driver and pedestrian safety. Any artificial lighting used during construction will be confined to areas within the construction footprint and directed away from surrounding habitats.

BIO-18: Properly dispose of food-related trash and remove from project site daily.

All food-related trash items, such as wrappers, cans, bottles, and food scraps generated by project-related activities and personnel, will be disposed of in closed containers and removed daily from the project site to reduce the potential for attracting predator species.

BIO-19: Prohibit pets and firearms from being brought to the project site.

To eliminate the potential for disturbance, injury to, or death of, any species resulting from the presence of pets and firearms, neither (with the exception of firearms carried by authorized law enforcement officials) will be allowed on the project site.

BIO-20: Retain a qualified biologist to conduct preconstruction surveys for Sierra Nevada yellow-legged frog and monitor ground-disturbing activities in suitable habitat.

Qualified biologist(s) will conduct visual encounter preconstruction surveys for Sierra Nevada yellow-legged frogs no more than 14 days before the start of ground-disturbing activities (including vegetation removal and equipment staging) within suitable habitat for the species at culvert locations TUO-108- 63.49 and TUO-108-64.00. The surveys will pay particular attention to detecting crevices and cover sites under rocks and vegetation that could be used as refugia by the

species. Any sightings of Sierra Nevada yellow-legged frogs will be immediately reported to Caltrans, and construction will start at that location until the species has moved out of the work area of its own accord and the appropriate agencies are consulted on the need for additional protection measures. Consistent with Measure BIO-3: Retain an Agency-Approved Biologist To Conduct Periodic Monitoring During Construction in Sensitive Habitats, a qualified biologist will monitor all ground-disturbing activities at locations TUO-108-63.49 and TUO-108-64.00 to ensure that protection measures are properly implemented and that Sierra Nevada yellow-legged frogs are not harmed by construction activities.

BIO-21: Install exclusion fencing between the work area and suitable habitat for Sierra Nevada yellow-legged frog.

To prevent Sierra Nevada yellow-legged frogs from entering the active work area during construction at culvert locations TUO-108-63.49 and TUO-108-64.00, Caltrans will install wildlife exclusion fencing between the designated work limits and Deadman Creek. Exclusion fencing will be at least 3 feet tall, and the lower 6 inches of the fence will be buried in the ground to prevent animals from crawling under. The remaining 2.5 feet will be left above ground to serve as a barrier for animals moving on the ground surface. The exclusion fencing will be pulled tight at each support to prevent folds or snags. Fencing will be installed and maintained in good condition during all construction activities. Such fencing will be inspected and maintained daily until the completion of the work at the site.

BIO-22: Conduct preconstruction surveys for nesting migratory birds and raptors, including special-status species, and establish protective buffers.

Caltrans will retain a qualified wildlife biologist to conduct nesting bird surveys if construction occurs between February 1 and September 30. These nesting bird surveys will include a minimum of two separate surveys to look for active nests of migratory birds, including raptors. Surveys will include a search of all trees and shrubs and ruderal areas that provide suitable nesting habitat for birds within 100 feet of construction disturbance. In addition, a 0.5-mile area from the Biological Study Area will be surveyed for nesting raptors to identify raptors that might be affected by construction disturbances, particularly special-status raptors (i.e., northern goshawk, great gray owl, and California spotted owl). The biologists conducting the surveys should have experience with all special-status birds that could potentially nest within the survey area.

In areas where access is not permitted, the surveyors will use binoculars and spotting scopes to inspect any potential nest trees, particularly large trees and snags. Surveys should occur during the height of the breeding season (March 1 to June 1), with one survey occurring within 1 week before the start of construction. As deemed necessary by Caltrans, additional surveys may be conducted during the appropriate period to document special-status raptors. These surveys will include vocalization playback calls according to established survey protocols for the great gray owl (Beck and Winter 2000), northern

goshawk (U.S. Forest Service 2002), and California spotted owl (U.S. Fish and Wildlife Service 2012). The need for these types of surveys will be determined by the Caltrans biologist in coordination with the California Department of Fish and Wildlife during the spring and/or summer before the start of construction to inform project construction personnel of the potential for these species to be present in or near culvert locations. Full protocol surveys may not be warranted, and focused surveys may include a variation on the full protocol surveys. Positive detections may necessitate additional nest search surveys as determined by Caltrans.

If no special-status raptor species or active nests are detected during these surveys, no additional measures will be required. If an active nest is found in the survey area, a no-disturbance buffer will be established to avoid disturbance or destruction of the nest site until the end of the breeding season (September 30) or after a qualified wildlife biologist determines that the young have fledged and moved out of the construction area (this date varies by species). The extent of these buffers will be determined by the Caltrans designated biologist in coordination with any applicable agencies and will depend on the level of noise or construction disturbance taking place, line-of-sight between the nest and the disturbance, ambient levels of noise and other non-project disturbances, and other topographical or artificial barriers. Suitable buffer distances may vary between species; however, a minimum of 50 feet for songbirds and 300 feet for raptors is typical.

BIO-23: Retain a qualified biologist to conduct a preconstruction mammal survey and monitor ground-disturbing activities in suitable habitat.

Qualified biologist(s) will conduct visual encounter preconstruction surveys to identify special-status mammal nests or dens within the Biological Study Area no more than 14 days before the start of ground-disturbing activities (including vegetation removal and equipment staging) within suitable habitat for the Sierra Nevada snowshoe hare at culvert locations TUO-108-28.46 and TUO-108-35.60 and within suitable habitat for the Sierra Nevada red fox at culvert locations TUO-108-63.49 and TUO-108-64.00. For surveys in inaccessible areas, the biologist will use binoculars to scan any suitable denning substrate for potential individuals, nests, and/or dens.

If an active special-status mammal nest and/or den is identified within the Biological Study Area, a no-disturbance buffer will be established around the nest and/or den to avoid disturbance of the nesting and/or denning mammal until a qualified biologist determines that the young have dispersed. The extent of these buffers will be determined by the Caltrans biologist in coordination with applicable wildlife agencies and will depend on the species identified, level of noise or construction disturbance, line-of-sight between the nest and/or den and the disturbance, ambient levels of noise and other disturbances, and other topographical or artificial barriers.

If any mammal species are seen in the active construction area, the individual(s) will be allowed to move out of harm's way of its own accord. Observations of the Sierra Nevada snowshoe hare or the Sierra Nevada red fox within or near the work area will be immediately reported to Caltrans. Consistent with Measure BIO-3: Retain an Agency-Approved Biologist To Conduct Periodic Monitoring During Construction in Sensitive Habitats, a qualified biologist will monitor all ground-disturbing activities at locations Tuo-108-28.46, Tuo-108-35.60, Tuo-108-63.49, and Tuo-108-64.00 to ensure that protection measures are properly implemented and that the Sierra Nevada snowshoe hare and the Sierra Nevada red fox are not harmed by construction activities.

BIO-24: Avoid and minimize the spread of invasive plant species during project construction.

Caltrans will be responsible for avoiding and minimizing the introduction of new invasive plants and the spread of invasive plants previously documented in the Biological Study Area. The following Best Management Practices will be written into the construction specifications and implemented during project construction.

- Retain all excavated soil material onsite or dispose of excess soil in a permitted offsite location to prevent the spread of invasive plants to uninfested areas next to the project footprint.
- Use a weed-free source for project materials (e.g., straw wattles for erosion control that are weed-free or contain less than 1 percent weed seed).
- Prevent invasive plant contamination of project materials during transport and when stockpiling (e.g., by covering soil stockpiles with a heavy-duty, contractor-grade tarpaulin).
- Use sterile grass seed and native plant stock during revegetation.
- Restore temporarily disturbed areas to pre-project conditions or better. Revegetate or mulch disturbed soils within 30 days of completing ground disturbing activities to reduce the likelihood of invasive plant establishment.

D. Determination

The Central Valley Water Board has determined that the Project, when implemented in accordance with the MMRP and the conditions in this Order, will not result in any significant adverse water resource impacts. (California Code of Regulations, title 14, section 15096, subd (h).)

(This page intentionally left blank)

Attachment D – Reports and Notification Requirements

I. Copies of this form

In order to identify your project, it is necessary to include a copy of the Project specific Cover Sheet below with your report; please retain for your records. If you need to obtain a copy of the Cover Sheet, you may download a copy of this Order as follows:

- A. [Central Valley Regional Water Quality Control Board's Adopted Orders Web page](https://www.waterboards.ca.gov/centralvalley/board_decisions/adopted_orders/401_wqcerts/)
(https://www.waterboards.ca.gov/centralvalley/board_decisions/adopted_orders/401_wqcerts/)
- B. Find your Order based on the County, Permittee, WDID No., and/or Project Name.

II. Report Submittal Instructions

- A. Check the box on the Report and Notification Cover Sheet next to the report or notification you are submitting. **(See your Order for specific reports required for your Project)**
 - **Part A (Monthly):** These reports will be submitted monthly until a Notice of Project Complete Letter is issued.
 - **Part B (Project Status Notifications):** Used to notify the Central Valley Water Board of the status of the Project schedule that may affect Project billing.
 - **Part C (Conditional Notifications and Reports):** Required on a case-by-case basis for accidental discharges of hazardous materials, violation of compliance with water quality standards, notification of in-water work, or other reports.
- B. Sign the Report and Notification Cover Sheet and attach all information requested for the Report Type.
- C. Electronic Report Submittal Instructions:
 - Submit signed Report and Notification Cover Sheet and required information via email to: centralvalleysacramento@waterboards.ca.gov and cc: Olivia.Ilsley@waterboards.ca.gov.
 - Include in the subject line of the email:
ATTN: Olivia Ilsley; Project Name; and WDID No. 5B05CR00116.

III. Definition of Reporting Terms

A. Active Discharge Period:

The active discharge period begins with the effective date of this Order and ends on the date that the Permittee receives a Notice of Completion of Discharges Letter or, if no post-construction monitoring is required, a Notice of Project Complete Letter. The Active Discharge Period includes all elements of the Project including site construction and restoration, and any Permittee responsible compensatory mitigation construction.

B. Request for Notice of Completion of Discharges Letter:

This request by the Permittee to the Central Valley Water Board staff pertains to projects that have post construction monitoring requirements, e.g. if site restoration was required to be monitored for 5 years following construction. Central Valley Water Board staff will review the request and send a Completion of Discharges Letter to the Permittee upon approval. This letter will initiate the post-discharge monitoring period.

C. Request for Notice of Project Complete Letter:

This request by the Permittee to the Central Valley Water Board staff pertains to projects that either have completed post-construction monitoring and achieved performance standards or have no post-construction monitoring requirements, and no further Project activities are planned. Central Valley Water Board staff will review the request and send a Project Complete Letter to the Permittee upon approval. Termination of annual invoicing of fees will correspond with the date of this letter.

D. Post-Discharge Monitoring Period:

The post-discharge monitoring period begins on the date of the Notice of Completion of Discharges Letter and ends on the date of the Notice of Project Complete Letter issued by the Central Valley Water Board staff. The Post-Discharge Monitoring Period includes continued water quality monitoring or compensatory mitigation monitoring.

E. Effective Date:

13 December 2023

IV. Map/Photo Documentation Information

When submitting maps or photos, please use the following formats.

A. Map Format Information:

Preferred map formats of at least 1:24000 (1" = 2000') detail (listed in order of preference):

- **GIS shapefiles:** The shapefiles must depict the boundaries of all project areas and extent of aquatic resources impacted. Each shape should be attributed with the extent/type of aquatic resources impacted. Features and boundaries should be accurate to within 33 feet (10 meters). Identify datum/projection used and if possible, provide map with a North American Datum of 1983 (NAD83) in the California Teale Albers projection in feet.
- **Google KML files** saved from Google Maps: My Maps or Google Earth Pro. Maps must show the boundaries of all project areas and extent/type of aquatic resources impacted. Include URL(s) of maps. If this format is used include a spreadsheet with the object ID and attributed with the extent/type of aquatic resources impacted.
- **Other electronic format** (CAD or illustration format) that provides a context for location (inclusion of landmarks, known structures, geographic coordinates, or USGS DRG or DOQQ). Maps must show the boundaries of all project areas and extent/type of aquatic resources impacted. If this format is used include a spreadsheet with the object ID and attributed with the extent/type of aquatic resources impacted.
- Aquatic resource maps marked on paper **USGS 7.5-minute topographic maps** or **Digital Orthophoto Quarter Quads (DOQQ)** printouts. Maps must show the boundaries of all project areas and extent/type of aquatic resources impacted. If this format is used include a spreadsheet with the object ID and attributed with the extent/type of aquatic resources impacted.

B. Photo-Documentation:

Include a unique identifier, date stamp, written description of photo details, and latitude/longitude (in decimal degrees) or map indicating location of photo. Successive photos should be taken from the same vantage point to compare pre/post construction conditions.

V. Report and Notification Cover Sheet

Project: State Route 120 Tuolumne Drainage System (SR 26)
Project

Permittee: California Department of Transportation

WDID: 5B05CR00116

Reg. Meas. ID: 454215

Place ID: 890195

Order Effective Date: 13 December 2023

Order Expiration Date: 12 December 2028

VI. Report Type Submitted

A. Part A – Project Reporting

- Report Type 1 Monthly Report
- Report Type 2 Annual Report- Not Applicable

B. Part B – Project Status Notifications

- Report Type 3 Commencement of Construction
- Report Type 4 Request for Notice of Completion of Discharges Letter
- Report Type 5 Request for Notice of Project Complete Letter

C. Part C – Conditional Notifications and Reports

- Report Type 6 Accidental Discharge of Hazardous Material Report
- Report Type 7 Violation of Compliance with Water Quality Standards Report
- Report Type 8 In-Water Work/Diversions Water Quality Monitoring Report
- Report Type 9 Modifications to Project Report
- Report Type 10 Transfer of Property Ownership Report
- Report Type 11 Transfer of Long-Term BMP Maintenance Report

"I certify under penalty of law that I have personally examined and am familiar with the information submitted in this document and all attachments and that, based on my inquiry of those individuals immediately responsible for obtaining the information, I believe that the information is true, accurate, and complete. I am aware that there are significant penalties for submitting false information, including the possibility of fine and imprisonment."

Print Name¹

Affiliation and Job Title

Signature

Date

¹STATEMENT OF AUTHORIZATION (include if authorization has changed since application was submitted)

I hereby authorize _____ to act in my behalf as my representative in the submittal of this report, and to furnish upon request, supplemental information in support of this submittal.

Permittee's Signature

Date

***This Report and Notification Cover Sheet must be signed by the Permittee or a duly authorized representative and included with all written submittals.**

A. Part A – Project Reporting

1. Report Type 1 - Monthly Report

- a. Report Purpose** - Notifies Central Valley Water Board staff of the Project status and environmental compliance activities on a monthly basis.
- b. When to Submit** - On the 1st day of each month after the submittal of the Commencement of Construction Notification until a Notice of Project Complete Letter is issued to the Permittee.
- c. Report Contents** -
 - i. Construction Summary**

Describe Project progress and schedule including initial ground disturbance, site clearing and grubbing, road construction, site construction, and the implementation status of construction storm water Best Management Practices (BMPs). Best Management Practices (BMPs) is a term used to describe a type of water pollution or environmental control. If construction has not started, provide estimated start date.
 - ii. Event Summary**

Describe distinct Project activities and occurrences, including environmental monitoring, surveys, and inspections.
 - iii. Photo Summary**

Provide photos of Project activities. For each photo, include a unique site identifier, date stamp, written description of photo details, and latitude/longitude (in decimal degrees) or map indicating location of photo. Successive photos should be taken from the same vantage point to compare pre/post construction conditions.
 - iv. Compliance Summary**
 - List name and organization of environmental surveyors, monitors, and inspectors involved with monitoring environmental compliance for the reporting period.
 - List associated monitoring reports for the reporting period.
 - Summarize observed incidences of non-compliance, compliance issues, minor problems, or occurrences.
 - Describe each observed incidence in detail. List monitor name and organization, date, location, type of incident, corrective action taken (if any), status, and resolution.

2. Report Type 2 - Annual Report- Not Applicable

B. Part B – Project Status Notifications

1. Report Type 3 - Commencement of Construction

- a. Report Purpose** - Notify Central Valley Water Board staff prior to the start of construction.
- b. When to Submit** - Must be received at least seven (7) days prior to start of initial ground disturbance activities.
- c. Report Contents** -
 - i. Date of commencement of construction.
 - ii. Anticipated date when discharges to waters of the state will occur.
 - iii. Project schedule milestones including a schedule for onsite compensatory mitigation, if applicable.
 - iv. Construction Storm Water General Permit WDID No.
 - v. Proof of purchase of compensatory mitigation for permanent impacts from the mitigation bank or in-lieu fee program.

2. Report Type 4 - Request for Notice of Completion of Discharges Letter

- a. Report Purpose** - Notify Central Valley Water Board staff that post-construction monitoring is required and that active Project construction, including any mitigation and permittee responsible compensatory mitigation, is complete.
- b. When to Submit** - Must be received by Central Valley Water Board staff within thirty (30) days following completion of all Project construction activities.
- c. Report Contents** -
 - i. Status of storm water Notice of Termination(s), if applicable.
 - ii. Status of post-construction storm water BMP installation.
 - iii. Pre- and post-photo documentation of all Project activity sites where the discharge of dredge and/or fill/excavation was authorized.
 - iv. Summary of Certification Deviation discharge quantities compared to initial authorized impacts to waters of the state, if applicable.
 - v. An updated monitoring schedule for mitigation for temporary impacts to waters of the state and permittee responsible compensatory mitigation during the post-discharge monitoring period, if applicable.

3. Report Type 5 - Request for Notice of Project Complete Letter

- a. Report Purpose** - Notify Central Valley Water Board staff that construction and/or any post-construction monitoring is complete, or is not required, and no further Project activity is planned.
- b. When to Submit** - Must be received by Central Valley Water Board staff within thirty (30) days following completion of all Project activities.
- c. Report Contents** -
 - i. Part A: Mitigation for Temporary Impacts
 - 1) A report establishing that the performance standards outlined in the restoration plan have been met for Project site upland areas of temporary disturbance which could result in a discharge to waters of the state.
 - 2) A report establishing that the performance standards outlined in the restoration plan have been met for restored areas of temporary impacts to waters of the state. Pre- and post-photo documentation of all restoration sites.
 - ii. Part B: Permittee Responsible Compensatory Mitigation
 - 1) A report establishing that the performance standards outlined in the compensatory mitigation plan have been met.
 - 2) Status on the implementation of the long-term maintenance and management plan and funding of endowment.
 - 3) Pre- and post-photo documentation of all compensatory mitigation sites.
 - 4) Final maps of all compensatory mitigation areas (including buffers).
 - iii. Part C: Post-Construction Storm Water BMPs
 - 1) Date of storm water Notice of Termination(s), if applicable.
 - 2) Report status and functionality of all post-construction BMPs.
 - 3) Dates and report of visual post-construction inspection during the rainy season as indicated in XIV.C.4.

C. Part C – Conditional Notifications and Reports

1. Report Type 6 - Accidental Discharge of Hazardous Material Report

- a. Report Purpose** - Notifies Central Valley Water Board staff that an accidental discharge of hazardous material has occurred.
- b. When to Submit** - Within five (5) working days of notification to the Central Valley Water Board of an accidental discharge. Continue reporting as required by Central Valley Water Board staff.

c. Report Contents -

- i. The report shall include the OES Incident/Assessment Form, a full description and map of the accidental discharge incident (i.e. location, time and date, source, discharge constituent and quantity, aerial extent, and photo documentation). If applicable, the OES Written Follow-Up Report may be substituted.
- ii. If applicable, any required sampling data, a full description of the sampling methods including frequency/dates and times of sampling, equipment, locations of sampling sites.
- iii. Locations and construction specifications of any barriers, including silt curtains or diverting structures, and any associated trenching or anchoring.

2. Report Type 7 - Violation of Compliance with Water Quality Standards Report

- a. **Report Purpose** - Notifies Central Valley Water Board staff that a violation of compliance with water quality standards has occurred.
- b. **When to Submit** - The Permittee shall report any event that causes a violation of water quality standards within three (3) working days of the noncompliance event notification to Central Valley Water Board staff.
- c. **Report Contents** - The report shall include: the cause; the location shown on a map; and the period of the noncompliance including exact dates and times. If the noncompliance has not been corrected, include: the anticipated time it is expected to continue; the steps taken or planned to reduce, eliminate, and prevent reoccurrence of the noncompliance; and any monitoring results if required by Central Valley Water Board staff.

3. Report Type 8 - In-Water Work and Diversions Water Quality Monitoring Report

- a. **Report Purpose** - Notifies Central Valley Water Board staff of the start and completion of in-water work. Reports the sampling results during in-water work and during the entire duration of temporary surface water diversions.
- b. **When to Submit** – At least forty-eight (48) hours prior to the start of in-water work. Within three (3) working days following the completion of in-water work. Surface water monitoring reports to be submitted two (2) weeks on initiation of in-water construction and during entire duration of temporary surface water diversions. Continue reporting in accordance with the approved water quality monitoring plan or as indicated in XIV.C.3.
- c. **Report Contents** - As required by the approved water quality monitoring plan or as indicated in XIV.C.3.

4. Report Type 9 - Modifications to Project Report

- a. Report Purpose** - Notifies Central Valley Water Board staff if the Project, as described in the application materials, is altered in any way or by the imposition of subsequent permit conditions by any local, state or federal regulatory authority.
- b. When to Submit** - If Project implementation as described in the application materials is altered in any way or by the imposition of subsequent permit conditions by any local, state or federal regulatory authority.
- c. Report Contents** - A description and location of any alterations to Project implementation. Identification of any Project modifications that will interfere with the Permittee's compliance with the Order.

5. Report Type 10 - Transfer of Property Ownership Report

- a. Report Purpose** - Notifies Central Valley Water Board staff of change in ownership of the Project or Permittee-responsible mitigation area.
- b. When to Submit** - At least 10 working days prior to the transfer of ownership.
- c. Report Contents** -
 - i. A statement that the Permittee has provided the purchaser with a copy of this Order and that the purchaser understands and accepts:
 - 1) the Order's requirements and the obligation to implement them or be subject to administrative and/or civil liability for failure to do so; and
 - 2) responsibility for compliance with any long-term BMP maintenance plan requirements in this Order. Best Management Practices (BMPs) is a term used to describe a type of water pollution or environmental control.
 - ii. A statement that the Permittee has informed the purchaser to submit a written request to the Central Valley Water Board to be named as the permittee in a revised order.

6. Report Type 11 - Transfer of Long-Term BMP Maintenance Report

- a. Report Purpose** - Notifies Central Valley Water Board staff of transfer of long-term BMP maintenance responsibility.
- b. When to Submit** - At least 10 working days prior to the transfer of BMP maintenance responsibility.

- c. **Report Contents** - A copy of the legal document transferring maintenance responsibility of post-construction BMPs.

(This page intentionally left blank)

Attachment E – Signatory Requirements

All documents submitted in compliance with this Order shall meet the following signatory requirements:

- A.** All applications, reports, or information submitted to the Central Valley Water Quality Control Board (Central Valley Water Board) must be signed and certified as follows:
 - 1.** For a corporation, by a responsible corporate officer of at least the level of vice-president.
 - 2.** For a partnership or sole proprietorship, by a general partner or proprietor, respectively.
 - 3.** For a municipality, or a state, federal, or other public agency, by either a principal executive officer or ranking elected official.

- B.** A duly authorized representative of a person designated in items 1.a through 1.c above may sign documents if:
 - 1.** The authorization is made in writing by a person described in items 1.a through 1.c above.
 - 2.** The authorization specifies either an individual or position having responsibility for the overall operation of the regulated activity.
 - 3.** The written authorization is submitted to the Central Valley Water Board Staff Contact prior to submitting any documents listed in item 1 above.

- C.** Any person signing a document under this section shall make the following certification:

“I certify under penalty of law that I have personally examined and am familiar with the information submitted in this document and all attachments and that, based on my inquiry of those individuals immediately responsible for obtaining the information, I believe that the information is true, accurate, and complete. I am aware that there are significant penalties for submitting false information, including the possibility of fine and imprisonment.”

(This page intentionally left blank)

Attachment F – Certification Deviation Procedures

I. Introduction

These procedures are put into place to preclude the need for Order amendments for minor changes in the Project routing or location. Minor changes or modifications in project activities are often required by the Permittee following start of construction. These deviations may potentially increase or decrease impacts to waters of the state. In such cases, a Certification Deviation, as defined in Section XIV.L of the Order, may be requested by the Permittee as set forth below:

II. Process Steps

A. Who may apply:

The Permittee or the Permittee's duly authorized representative or agent (hereinafter, "Permittee") for this Order.

B. How to apply:

By letter or email to the Water Quality Certification staff designated as the contact for this Order.

C. Certification Deviation Request:

The Permittee will request verification from the Central Valley Water Board staff that the project change qualifies as a Certification Deviation, as opposed to requiring an amendment to the Order. The request should:

1. Describe the Project change or modification:
 - a. Proposed activity description and purpose;
 - b. Why the proposed activity is considered minor in terms of impacts to waters of the state;
 - c. How the Project activity is currently addressed in the Order; and,
 - d. Why a Certification Deviation is necessary for the Project.
2. Describe location (latitude/longitude coordinates), the date(s) it will occur, as well as associated impact information (i.e., temporary or permanent, federal or non-federal jurisdiction, water body name/type, estimated impact area, etc.) and minimization measures to be implemented.
3. Provide all updated environmental survey information for the new impact area.
4. Provide a map that includes the activity boundaries with photos of the site.
5. Provide verification of any mitigation needed according to the Order conditions.

6. Provide any other information required by Central Valley Water Board staff to determine whether the Project change or modification necessitates additional environmental review. (California Code of Regulations, Title 14, sections 15061, 15162-15164.)

D. Post-Discharge Certification Deviation Reporting:

1. Within 30 calendar days of completing the approved Certification Deviation activity, the Permittee will provide a post-discharge activity report that includes the following information:
 - a. Activity description and purpose;
 - b. Activity location, start date, and completion date;
 - c. Erosion control and pollution prevention measures applied;
 - d. The net change in impact area by water body type(s) in acres, linear feet and cubic yards;
 - e. Mitigation plan, if applicable; and,
 - f. Map of activity location and boundaries; post-construction photos.

E. Annual Summary Deviation Report:

1. Until a Notice of Completion of Discharges Letter or Notice of Project Complete Letter is issued, include in the Annual Project Report (see Construction Notification and Reporting attachment) a compilation of all Certification Deviation activities through the reporting period with the following information:
 - a. Site name(s);
 - b. Date(s) of Certification Deviation approval;
 - c. Location(s) of authorized activities;
 - d. Impact area(s) by water body type prior to activity in acres, linear feet and cubic yards, as originally authorized in the Order;
 - e. Actual impact area(s) by water body type in, acres, linear feet and cubic yards, due to Certification Deviation activity(ies);
 - f. The net change in impact area by water body type(s) in acres, linear feet and cubic yards; and
 - g. Mitigation to be provided (approved mitigation ratio and amount).

(This page is intentionally left blank)

**Attachment G - Compliance with Code of Federal Regulations,
Title 40, Section 121.7, Subdivision (d)**

The purpose of this Attachment is to comply with Code of Federal Regulations, title 40, section 121.7, subdivision (d), which requires all certification conditions to provide an explanation of why the condition is necessary to assure that any discharge authorized under the certification will comply with water quality requirements and a citation to federal, state, or tribal law that authorizes the condition. This Attachment uses the same organizational structure as Section XIV of the Order, and the statements below correspond with the conditions set forth in Section XIV. The other Order Sections are not “conditions” as used in Code of Federal Regulations, title 40, section 121.7.

I. General Justification for Section XIV Conditions

Pursuant to Clean Water Act section 401 and California Code of Regulations, title 23, section 3859, subdivision (a), the Central Valley Water Board, when issuing water quality certifications, may set forth conditions to ensure compliance with applicable water quality standards and other appropriate requirements of state law. Under California Water Code section 13160, the State Water Resources Control Board is authorized to issue water quality certifications under the Clean Water Act and has delegated this authority to the executive officers of the regional water quality controls boards for projects within the executive officer’s region of jurisdiction. (California Code of Regulations, title 23, section 3838.)

The conditions within the Order are generally required pursuant to the Central Valley Water Board’s Water Quality Control Plan for the Sacramento River and San Joaquin River Basins, Fifth Edition, February 2019 (Basin Plan), which was adopted and is periodically revised pursuant to Water Code section 13240. The Basin Plan includes water quality standards, which consist of existing and potential beneficial uses of waters of the state, water quality objectives to protect those uses, and the state and federal antidegradation policies. For instance, the Basin Plan includes water quality objectives for chemical constituents, oil and grease, pH, sediment, suspended material, toxicity and turbidity, which ensure protection of beneficial uses.

The State Water Board’s Antidegradation Policy, “Statement of Policy with Respect to Maintaining High Quality Waters in California,” Resolution No. 68-16, requires that the quality of existing high-quality water be maintained unless any change will be consistent with the maximum benefit to the people of the state, will not unreasonably affect present or anticipated future beneficial uses of such water, and will not result in water quality less than that prescribed in water quality control plans or policies. The Antidegradation Policy further requires best practicable treatment or control of the discharge necessary to assure that pollution or nuisance will not occur and the highest water quality consistent with maximum benefit to the people of the state will be maintained. The Basin Plan incorporates this Policy. The state Antidegradation

Policy incorporates the federal Antidegradation Policy (40 C.F.R. section 131.12 (a)(1)), which requires "[e]xisting instream water uses and the level of water quality necessary to protect the existing uses shall be maintained and protected."

The State Wetland Definition and Procedures for Discharges of Dredged or Fill Material to Waters of the State (Dredge or Fill Procedures), adopted pursuant to Water Code sections 13140 and 13170, authorize approval of dredge or fill projects only if the demonstrations set forth in Section IV.B.1 of the Dredge or Fill Procedures have been satisfied.

California Code of Regulations, title 23, sections 3830 et seq. set forth state regulations pertaining to water quality certifications. In particular, section 3856 sets forth information that must be included in water quality certification requests, and section 3860 sets forth standard conditions that shall be included in all water quality certification actions.

Finally, Water Code sections 13267 and 13383 authorize the regional and state boards to establish monitoring and reporting requirements for persons discharging or proposing to discharge waste.

II. Specific Justification for Section XIV Conditions

A. Authorization

Authorization under the Order is granted based on the application submitted. The Permittee is required to detail the scope of project impacts in a complete application pursuant to California Code of Regulations, title 23, section 3856, subdivision (h). Pursuant to Water Code section 13260, subdivision (c), each person discharging waste, or proposing to discharge waste shall file a report of waste discharge relative to any material change or proposed change in the character, location, or volume of the discharge. Pursuant to Water Code section 13264, subdivision (a), the Permittee is prohibited from initiating the discharge of new wastes, or making material changes to the character, volume, and timing of waste discharges authorized herein without filing a report required by Water Code section 13260 or its equivalent for certification actions under California Code of Regulations, title 23, section 3856.

B. Reporting and Notification Requirements

1. Project Reporting

2. Project Status Notifications

The reporting and notification conditions under Sections B.1 and B.2 are required to provide the Central Valley Water Board necessary project information and oversight to ensure project discharges are complying with applicable Basin Plan requirements. These monitoring and reporting requirements are consistent with the Central Valley Water Board's authority to

investigate the quality of any waters of the state and require necessary monitoring and reporting pursuant to Water Code sections 13267 and 13383. Water Code section 13267 authorizes the regional boards to require any person who has discharged, discharges, or is suspected of having discharged or discharging, or who proposes to discharge waste to provide technical or monitoring program reports required by the regional board. Water Code section 13383 authorizes the regional boards to establish monitoring, inspection, entry, reporting, and other recordkeeping requirements, as authorized by Water Code section 13160, for any person who discharges, or proposes to discharge, to navigable waters.

3. Conditional Notifications and Reports

a. Accidental Discharges of Hazardous Materials

Conditions under Section B.3.a related to notification and reporting requirements in the event of an accidental discharge of hazardous materials are required pursuant to section 13271 of the Water Code, which requires immediate notification of the Office of Emergency Services of the discharge in accordance with the spill reporting provision of the state toxic disaster contingency plan adopted pursuant to Article 3.7 (commencing with Section 8574.16) of Chapter 7 of Division 1 of Title 2 of the Government Code. "Hazardous materials" is defined under Health and Safety Code section 25501. These reports related to accidental discharges ensure that corrective actions, if any, that are necessary to minimize the impact or clean up such discharges can be taken as soon as possible.

b. Violation of Compliance with Water Quality Standards

c. In-Water work and Diversions

Conditions under Section B.3.b and B.3.c related to monitoring and reporting on water quality standard compliance and in-water work and diversions are required to provide the Central Valley Water Board necessary project information and oversight to ensure project discharges are complying with applicable water quality objectives under the Basin Plan. These monitoring and reporting requirements are consistent with the Central Valley Water Board's authority to investigate the quality of any waters of the state and require necessary monitoring and reporting pursuant to Water Code sections 13267 and 13383. Water Code section 13267 authorizes the regional boards to require any person who has discharged, discharges, or is suspected of having discharged or discharging, or who proposes to discharge waste to provide technical or monitoring program reports required by the regional board. Water Code section 13383 authorizes the regional boards to establish monitoring, inspection, entry, reporting, and other recordkeeping requirements, as

authorized by Water Code section 13160, for any person who discharges, or proposes to discharge, to navigable waters.

d. Modifications to Project

Authorization under this Order is granted based on the application and supporting information submitted. Conditions under Section B.3.d are necessary to ensure that if there are modifications to the project, that the Order requirements remain applicable. The Permittee is required to detail the scope of project impacts in a complete application pursuant to California Code of Regulations, title 23, section 3856, subdivision (h). Pursuant to Water Code section 13260, subdivision (c), each person discharging waste, or proposing to discharge waste shall file a report of waste discharge relative to any material change or proposed change in the character, location, or volume of the discharge. Pursuant to Water Code section 13264, subdivision (a), the Permittee is prohibited from initiating the discharge of new wastes, or making material changes to the character, volume, and timing of waste discharges authorized herein without filing a report required by Water Code section 13260 or its equivalent for certification actions under California Code of Regulations, title 23, section 3856.

e. Transfer of Property Ownership

f. Transfer of Long-Term BMP Maintenance

Authorization under this Order is granted based on the application information submitted, including identification of the legally responsible party. Conditions under Sections B.3.e and B.3.f are necessary to confirm whether the new owner wishes to assume legal responsibility for compliance with this Order. If not, the original discharger remains responsible for compliance with this Order. Pursuant to Water Code section 13260, subdivision (c), each person discharging waste, or proposing to discharge waste shall file a report of waste discharge relative to any material change or proposed change in the character, location, or volume of the discharge. Pursuant to Water Code section 13264, subdivision (a), the Permittee is prohibited from initiating the discharge of new wastes, or making material changes to the character, volume, and timing of waste discharges authorized herein without filing a report required by Water Code section 13260 or its equivalent for certification actions under California Code of Regulations, title 23, section 3856.

C. Water Quality Monitoring

Conditions under Section C related to water quality monitoring are required to confirm that best management practices required under this Order are sufficient to protect beneficial uses and to comply with water quality objectives to protect

those uses under the Basin Plan. Applicable water quality objectives and beneficial uses are identified in the Order. These monitoring requirements are consistent with the Central Valley Water Board's authority to investigate the quality of any waters of the state and require necessary monitoring and reporting pursuant to Water Code sections 13267 and 13383. Water Code section 13267 authorizes the regional boards to require any person who has discharged, discharges, or is suspected of having discharged or discharging, or who proposes to discharge waste to provide technical or monitoring program reports required by the regional board. Water Code section 13383 authorizes the regional boards to establish monitoring, inspection, entry, reporting, and other recordkeeping requirements, as authorized by Water Code section 13160, for any person who discharges, or proposes to discharge, to navigable waters.

D. Standard

1. This Order is subject to modification or revocation

This is a standard condition that "shall be included as conditions of all water quality certification actions" pursuant to California Code of Regulations, title 23, section 3860(a). This condition places the permittee on notice that the certification action may be modified or revoked following administrative or judicial review.

2. This Order is not intended and shall not be construed to apply to any activity involving a hydroelectric facility

This is a standard condition that "shall be included as conditions of all water quality certification actions" pursuant to California Code of Regulations, title 23, section 3860(b). This condition clarifies the scope of the certification's application.

3. This Order is conditioned upon total payment of any fee

This is a standard condition that "shall be included as conditions of all water quality certification actions" pursuant to California Code of Regulations, title 23, section 3860(c). This fee requirement condition is also required pursuant to California Code of Regulations, section 3833(b).

E. General Compliance

1. Failure to comply with any condition of this Order

The condition under Section E.1 places the Permittee on notice of any violations of Order requirements. Pursuant to Water Code section 13385, subdivision (a)(2), a person who violates any water quality certification issued pursuant to Water Code section 13160 shall be liable civilly.

2. Permitted actions must not cause a violation of any applicable water quality standards

Conditions under Section E.2 related to compliance with water quality objectives and designated beneficial uses are required pursuant to the Central Valley Water Board's Basin Plan. The Basin Plan's water quality standards consist of existing and potential beneficial uses of waters of the state, water quality objectives to protect those uses, and the state and federal antidegradation policies. The Antidegradation Policy requires that the quality of existing high-quality water be maintained unless any change will be consistent with the maximum benefit to the people of the state, will not unreasonably affect present or anticipated future beneficial uses of such water, and will not result in water quality less than that prescribed in water quality control plans or policies. The Antidegradation Policy further requires best practicable treatment or control of the discharge necessary to assure that pollution or nuisance will not occur and the highest water quality consistent with maximum benefit to the people of the state will be maintained. Applicable beneficial uses and water quality objectives to protect those uses include the Chemical Constituents (Basin Plan, Section 3.1.3), Oil and Grease (Basin Plan, Section 3.1.10), pH (Basin Plan, Section 3.1.11), Sediment (Basin Plan, 3.1.15), Suspended Material (3.1.17), Toxicity (Basin Plan, 3.1.20), and Turbidity (Basin Plan, Section 3.1.21) water quality objectives.

3. In response to a suspected violation of any condition of this Order, the Central Valley Water Board may require

Conditions under Section E.3 related to monitoring and reporting are required to provide the Central Valley Water Board necessary project information and oversight to ensure project discharges are complying with applicable Basin Plan requirements. These monitoring and reporting requirements are consistent with the Central Valley Water Board's authority to investigate the quality of any waters of the state and require necessary monitoring and reporting pursuant to Water Code sections 13267 and 13383. Water Code section 13267 authorizes the regional boards to require any person who has discharged, discharges, or is suspected of having discharged or discharging, or who proposes to discharge waste to provide technical or monitoring program reports required by the regional board. Technical supports submitted pursuant to Water Code section 13267 are required to be submitted under penalty of perjury. Water Code section 13383 authorizes the regional boards to establish monitoring, inspection, entry, reporting, and other recordkeeping requirements, as authorized by Water Code section 13160, for any person who discharges, or proposes to discharge, to navigable waters.

4. The Permittee must, at all times, fully comply with engineering plans, specifications, and technical reports

Authorization under the Order is granted based on the application and supporting information submitted. The Permittee is required to detail the project description in a complete application pursuant to California Code of Regulations, title 23, section 3856, subdivision (h). Pursuant to Water Code section 13260, subdivision (c), each person discharging waste, or proposing to discharge waste shall file a report of waste discharge relative to any material change or proposed change in the character, location, or volume of the discharge. Pursuant to Water Code section 13264, subdivision (a), the Permittee is prohibited from initiating the discharge of new wastes, or making material changes to the character, volume, and timing of waste discharges authorized herein without filing a report required by Water Code section 13260 or its equivalent for certification actions under California Code of Regulations, title 23, section 3856. Finally, compliance with conditions of the Order ensures that the Project will comply with all water quality standards and other appropriate requirements as detailed herein. (California Code of Regulations, title 23, section 3859, subdivision (a).)

5. This Order and all of its conditions herein continue to have full force and effect

This condition ensures continued compliance with applicable water quality standards and other appropriate requirements of state law. Notwithstanding any determinations by the U.S. Army Corps or other federal agency pursuant to 40 C.F.R. section 121.9, the Permittee must comply with the entirety of this certification because, pursuant to State Water Board Water Quality Order No. 2003-0017-DWQ, this Order also serves as Waste Discharge Requirements pursuant to the Porter-Cologne Water Quality Control Act.

6. The Permittee shall adhere to all requirements in the mitigation monitoring and reporting program

This condition ensures mitigation measures required to lessen the significance of impacts to water quality identified pursuant to California Environmental Quality Act review are implemented and enforceable. Pursuant to California Code of Regulations, title 14, section 15097, subdivision (a), a public agency shall adopt a program for monitoring and reporting on mitigation measures imposed to mitigate or avoid significant environmental effects to ensure implementation.

7. Construction General Permit Requirement

Permittees are required to obtain coverage under National Pollutant Discharge Elimination System (NPDES) General Permit for Storm Water Discharges Associated with Construction and Land Disturbance Activities

(Order No. 2009-0009-DWQ; NPDES No. CAS000002), as amended, for discharges to surface waters comprised of storm water associated with construction activity, including, but not limited to, demolition, clearing, grading, excavation, and other land disturbance activities of one or more acres, or where projects disturb less than one acre but are part of a larger common plan of development that in total disturbs one or more acres. This is required pursuant to Clean Water Act sections 301 and 402 which prohibit certain discharges of storm water containing pollutants except in compliance with an NPDES permit. (33 U.S.C. section 1311, and 1342(p); 40 C.F.R. parts 122, 123, and 124.)

F. Administrative

1. Signatory requirements for all document submittals

The condition for signatory requirements is required pursuant to Water Code section 13267, which requires any person discharging waste that could affect the quality of waters to provide to the Central Valley Water Board, under penalty of perjury, any technical or monitoring program reports as required by the Central Valley Water Board. The signatory requirements are consistent with 40 C.F.R. section 122.22.

2. This Order does not authorize any act which results in the taking of a threatened, endangered, or candidate species

Pursuant to the California Endangered Species Act (Fish & Wildlife Code, sections 2050 et seq.) and federal Endangered Species Act (16 U.S.C. sections 1531 et seq.), the Order does not authorize any act which results in the taking of a threatened, endangered, or candidate species. In the event a Permittee requires authorization from the state or federal authorities, California Code of Regulations, title 23, section 3856(e), requires that copies be provided to the Central Valley Water Board of "any final and signed federal, state, and local licenses, permits, and agreements (or copies of the draft documents, if not finalized) that will be required for any construction, operation, maintenance, or other actions associated with the activity. If no final or draft document is available, a list of all remaining agency regulatory approvals being sought shall be included."

3. The Permittee shall grant Central Valley Water Board staff

The condition related to site access requirements is authorized pursuant to the Central Valley Water Board's authority to investigate the quality of any waters of the state within its region under Water Code section 13267 and 13383. Water Code section 13267, subdivision (c) provides that "the regional board may inspect the facilities of any person to ascertain whether the purposes of this division are being met and waste discharge requirements are being complied with." Water Code section 13383 authorizes the regional

boards to establish monitoring, inspection, entry, reporting, and other recordkeeping requirements, as authorized by Water Code section 13160, for any person who discharges, or proposes to discharge, to navigable waters.

4. A copy of this Order shall be provided to any consultants, contractors, and subcontractors

This Condition ensures any agent of the Permittee is aware of Order requirements. Such conditions within the Order are necessary to ensure that all activities will comply with applicable water quality standards and other appropriate requirements (33 U.S.C. section 1341; California Code of Regulations, title 23, section 3859, subdivision (a)) and cannot be adhered to if the Permittees' agents are unaware of applicable requirements. These conditions are necessary to ensure compliance with applicable water quality objectives and protection of beneficial uses found in the Basin Plan, adopted pursuant to Water Code section 13240, and detailed in the Order.

5. A copy of this Order must be available at the Project site(s) during construction . . .

This Condition ensures any agent of the Permittee is aware of Order requirements. Such conditions within the Order are necessary to ensure that all activities will comply with applicable water quality standards and other appropriate requirements (33 U.S.C. section 1341; California Code of Regulations, title 23, section 3859, subdivision (a)) and cannot be adhered to if the Permittees' agents are unaware of applicable requirements. These conditions are necessary to ensure compliance with applicable water quality objectives and protection of beneficial uses found in the Basin Plan, adopted pursuant to Water Code section 13240, and detailed in the Order.

6. Lake or Streambed Alteration Agreement

This condition is required pursuant to California Code of Regulations, title 23, section 3856, subdivision (e), which requires that copies be provided to the Central Valley Water Board of "any final and signed federal, state, and local licenses, permits, and agreements (or copies of the draft documents, if not finalized) that will be required for any construction, operation, maintenance, or other actions associated with the activity. If no final or draft document is available, a list of all remaining agency regulatory approvals being sought shall be included."

G. Construction

- 1. Dewatering- Not Applicable**
- 2. Directional Drilling- Not Applicable**
- 3. Dredging- Not Applicable**

4. Fugitive Dust

This condition is required to assure that the discharge from the Project will comply with water quality objectives established for surface waters, including for chemical constituents and toxicity. (Basin Plan, Sections 3.1.3 & 3.1.20.) Chemicals used in dust abatement activities can result in a discharge of chemical additives and treated waters to surface waters of the state. Therefore, dust abatement activities shall be conducted so that sediment or dust abatement chemicals are not discharged into waters of the state and do not adversely affect beneficial uses. (Basin Plan, Section 2.1; Dredge or Fill Procedures, Section IV.B.1.)

5. Good Site Management “Housekeeping”

Conditions related to site management require best practices to prevent, minimize, and/or clean up potential construction spills, including from construction equipment. For instance, fuels and lubricants associated with the use of mechanized equipment have the potential to result in toxic discharges to waters of the state in violation of water quality standards, including the toxicity and floating material water quality objectives. (Basin Plan, Sections 3.1.7 & 3.1.20.) This condition is also required pursuant to Water Code section 13264, which prohibits any discharge that is not specifically authorized in this Order. Among other requirements, Section IV.B.1 of the Dredge or Fill Procedures requires that Project impacts will not cause or contribute to a degradation of waters; or violate water quality standards.

6. Hazardous Materials

Conditions related to toxic and hazardous materials are necessary to assure that discharges comply with applicable water quality objectives under the Basin Plan, adopted under section 13240 of the Water Code, including the narrative toxicity and chemical constituents water quality objectives. (Basin Plan, Sections 3.1.3, 3.1.20.) Further, conditions related to concrete/cement are required pursuant to the Basin Plan’s pH water quality objective. (Basin Plan, Section 3.1.11.)

7. Invasive Species and Soil Borne Pathogens

Conditions related to invasive species and soil borne pathogens are required to ensure that discharges will not violate any water quality objectives under the Basin Plan, adopted under Water Code section 13240 of the Water Code. Invasive species and soil borne pathogens adversely affect beneficial uses designated in the Basin Plan, such as rare, threatened, or endangered species; wildlife habitat; and preservation of biological habitats of special significance. (See Basin Plan, Section 2.1.) Among other requirements, Section IV.B.1 of the Dredge or Fill Procedures requires that Project impacts will not contribute to a net loss of the overall abundance, diversity, and

condition of aquatic resources; cause or contribute to a degradation of waters; or violate water quality standards.

8. Post-Construction Storm Water Management- Not Applicable

9. Roads

These conditions are required to assure that discharges will comply with water quality standards within the Basin Plan. Specifically, activities associated with road maintenance have the potential to exceed water quality objectives for oil and grease, pH, sediment, settleable materials, temperature, and turbidity. (Basin Plan, Sections 3.1.10, 3.1.11, 3.1.15, 3.1.16, 3.1.19, 3.1.21.) Further, these conditions are required to assure that they do not result in adverse impacts related to hydromodification or create barriers to fish passage and spawning activities. Among other requirements, Section IV.B.1 of the Dredge or Fill Procedures requires that Project impacts will not contribute to a net loss of the overall abundance, diversity, and condition of aquatic resources; cause or contribute to a degradation of waters; or violate water quality standards.

10. Sediment Control

Conditions related to erosion and sediment control design requirements are required to sustain fluvial geomorphic equilibrium. Improperly designed and installed BMPs result in excess sediment, which impairs surface waters, adversely affect beneficial uses, and results in exceedance of water quality objectives in the Basin Plan, including for sediment and turbidity. (Basin Plan, Sections 3.1.15 & 3.1.21.) Among other requirements, Section IV.B.1 of the Dredge or Fill Procedures requires that Project impacts will not contribute to a net loss of the overall abundance, diversity, and condition of aquatic resources; cause or contribute to a degradation of waters; or violate water quality standards.

11. Special Status Species

See F.2 above.

12. Stabilization/Erosion Control

Conditions related to erosion and sediment control design requirements are required to sustain fluvial geomorphic equilibrium. Improperly designed and installed BMPs result in excess sediment, which impairs surface waters, adversely affect beneficial uses, and results in exceedance of water quality objectives in the Basin Plan, including for sediment. (Basin Plan, Section 3.1.15.) Among other requirements, Section IV.B.1 of the Dredge or Fill Procedures requires that Project impacts will not contribute to a net loss of the overall abundance, diversity, and condition of aquatic resources; cause or contribute to a degradation of waters; or violate water quality standards.

13. Storm Water

Post-rain erosion and sedimentation problems can contribute to significant degradation of the waters of the state; therefore, it is necessary to take corrective action to eliminate such discharges in order to avoid or minimize such degradation. Implementation of control measures and best management practices described in the condition will assure compliance with water quality objectives including chemical constituents, floating material, sediment, turbidity, temperature, suspended material, and settleable material within the Basin Plan. (Basin Plan, Sections 3.1.1, 3.1.7, 3.1.15, 3.1.16, 3.1.17, 3.1.19, 3.1.21.) Among other requirements, Section IV.B.1 of the Dredge or Fill Procedures requires that Project impacts will not cause or contribute to a degradation of waters or violate water quality standards.

H. Site Specific- Not Applicable

I. Total Maximum Daily Load (TMDL) - Not Applicable

Total Maximum Daily Loads (TMDLs) are action plans to restore clean water. Section 303(d) of the federal Clean Water Act requires that states identify water bodies -- bays, rivers, streams, creeks, and coastal areas -- that do not meet water quality standards, and the pollutants that impair them. TMDLs examine water quality problems, identify sources of pollutants, and specify actions that create solutions. They are adopted by the Regional Water Board as amendments to our Region's Basin Plan. Among other requirements, Section IV.B.1 of the Dredge or Fill Procedures requires that Project impacts will not cause or contribute to a degradation of waters or violate water quality standards.

J. Mitigation for Temporary Impacts

The conditions under Section J require restoration of temporary impacts to waters of the state. Conditions in this section related to restoration and/or mitigation of temporary impacts are consistent with the Dredge or Fill Procedures, which requires "in all cases where temporary impacts are proposed, a draft restoration plan that outlines design, implementation, assessment, and maintenance for restoring areas of temporary impacts to pre-project conditions." (Dredge or Fill Procedures section IV. A.2(d) & B.4.) Technical reporting and monitoring requirements under this condition are consistent with the Central Valley Water Board's authority to investigate the quality of any waters of the state and require necessary reporting and monitoring pursuant to Water Code sections 13267 and 13383.

K. Compensatory Mitigation for Permanent Impacts

Mitigation Bank Development/In-Lieu Fee Project Development

The conditions under Section K regarding compensatory mitigation for permanent impacts ensure permanent physical loss and permanent ecological degradation of waters of the state are adequately mitigated. These conditions are necessary to ensure compliance with state and federal anti-degradation policies and are consistent with Section IV.B.1.a of the Dredge or Fill Procedures, which requires that the Water Boards will approve a project only after it has been determined that a sequence of actions has been taken to first avoid, then to minimize, and lastly compensate for adverse impacts that cannot be practicably avoided or minimized. (See also California Code of Regulations, section 3856, subdivision (h) [requiring submittal of proposed mitigation and description of steps taken to avoid, minimize, or compensate].) These compensatory mitigation conditions are also consistent with Executive Order W-59-93 commonly referred to as California's "No Net Loss" Policy for wetlands. The objective of the No Net Loss Policy is to ensure no overall net loss of and a long term net gain in the quantity, quality, and permanence of wetland acreage and values in California. Further, compensatory mitigation requirements must comply with subpart J of the Supplemental State Guidelines. Conditions related to financial assurances are also required to ensure that compensatory mitigation will be provided. (Dredge or Fill Procedures, section IV.B.5.f.)

L. Certification Deviation

- 1. Minor modifications of Project locations or predicted impacts**
- 2. A Project modification shall not be granted a Certification Deviation if it warrants or necessitates**

Authorization under the Order is granted based on the application and supporting information submitted. Among other requirements, the Permittee is required to detail the project description in a complete application pursuant to California Code of Regulations, title 23, section 3856, subdivision (h). Pursuant to Water Code section 13260, subdivision (c), each person discharging waste, or proposing to discharge waste shall file a report of waste discharge relative to any material change or proposed change in the character, location, or volume of the discharge. Pursuant to Water Code section 13264, subdivision (a), the Permittee is prohibited from initiating the discharge of new wastes, or making material changes to the character, volume, and timing of waste discharges authorized herein without filing a report required by Water Code section 13260 or its equivalent for certification actions under California Code of Regulations, title 23, section 3856. Project deviations may require additional or different Order conditions as authorized by law to ensure compliance with applicable water quality standards and other appropriate requirements (33 U.S.C. section 1341; California Code of Regulations, title 23, section 3859, subdivision (a)) and may result in impacts to water quality that require additional environmental review (California Code of Regulations, title 14, sections 15062-15063).