

Marshall, James@Waterboards

From: Tony Pirondini <Tony.Pirondini@cityofvacaville.com>
Sent: Monday, March 24, 2014 1:35 PM
To: Harder, Kathleen@Waterboards
Cc: Royce Cunningham; Steve Sawyer
Subject: RE: City of Vacaville NPDES permit renewal
Attachments: EWWTP and RSW Map 0314 Draft Permit.JPG

Hi Kathy

Thank you for sending out the tentative NPDES permit and associated documents.

I would like to bring to your attention a few items that should be corrected to avoid confusion to those reviewing the tentative permit:

- (1) The Attachment B Map: Shows RSW-001 at the wrong location. It should be located on Old Alamo Creek at Leisure Town Road, per MRP Table E-1. Attached is an updated EWWTP And RSWs map for reference.
- (2) Table E-3 (on page E-5) Footnote 13 should be relabeled Footnote 12, to match the table.
- (3) Table E-5 (on page E-9) requires clarification: States in VIII.A.1. "The Discharger shall monitor the Old Alamo Creek at RSW-001 and RSW-002 as follows:". However, Table E-5 should apply to RSW-001, -002, -003 and -004.

Also, I am still working on an updated WWTP schematic that does not show the old North Plant treatment train. I should have it to you within the next week.

Tony Pirondini
City of Vacaville
Interim Water Quality Manager
(707) 469-6439
(707) 980-1541 mobile

From: Harder, Kathleen@Waterboards [<mailto:Kathleen.Harder@waterboards.ca.gov>]
Sent: Friday, March 21, 2014 2:46 PM
To: Tony Pirondini
Cc: eofficer@cvcwa.org; Richard McHenry (rmchenry1403@aol.com); ismith@mwdh2o.com; Kozelka, Peter@epa.gov; deltakeep@aol.com
Subject: City of Vacaville NPDES permit renewal

Tony

Attached is the tentative NPDES permit renewal and associated documents for the City of Vacaville, Easterly Wastewater Treatment Plant, Solano County. Written comments regarding the proposed rescission are due to our office by 5:00 pm on 21 April 2014. The proposed permit renewal is noticed for the 5/6 June 2014 Central Valley Water Board meeting. A Notice of Public Hearing is attached. Please publish and post the notice as instructed in the cover letter.

If you have any questions, please feel free to contact me.

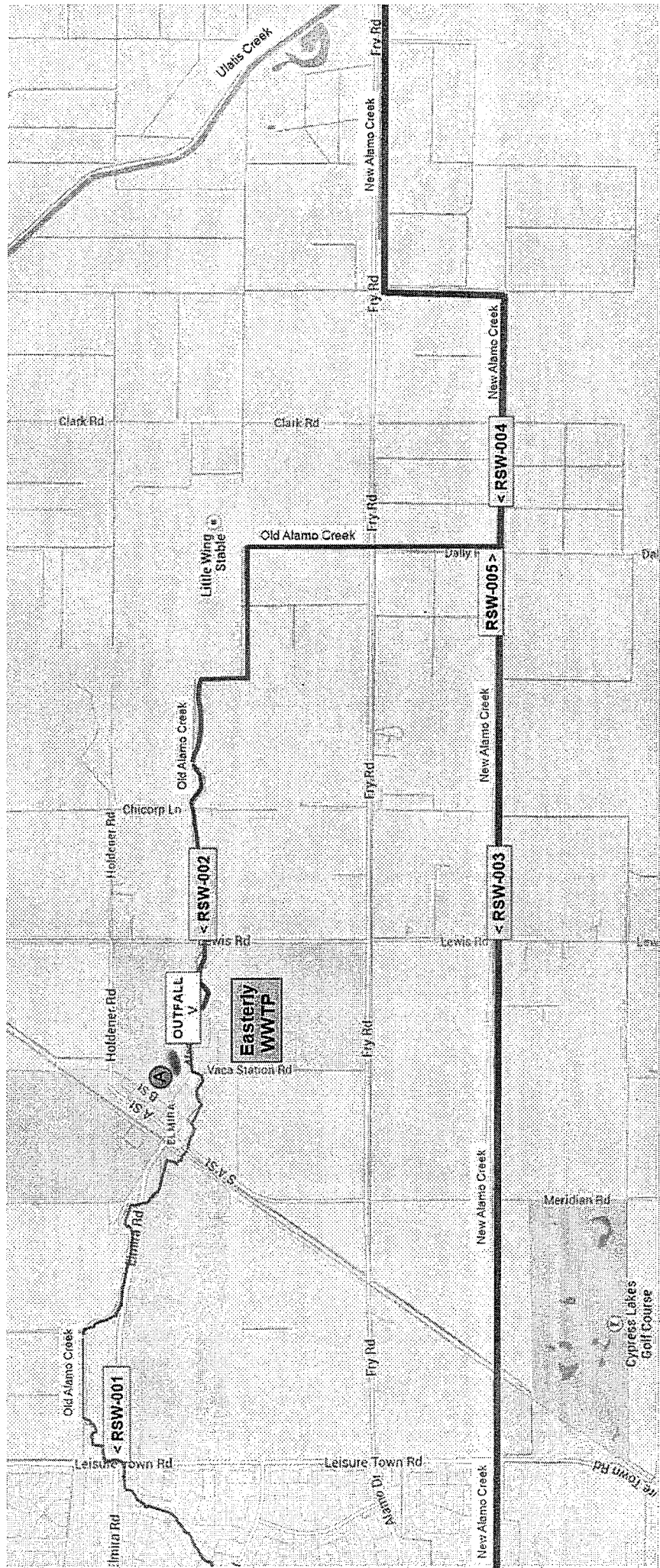

Ulatis Creek

Fry Rd

New Alamo Creek

Clark Rd

Clark Rd

Fry Rd

New Alamo Creek

< RSW-004

Old Alamo Creek

Little Wing Stable

RSW-005

Old Alamo Creek

Chicorp Ln

< RSW-002

New Alamo Creek

< RSW-003

Holdener Rd

OUTFALL

Easterly WWTP

Vaca Station Rd

Fry Rd

IS 9
IS Y
EL Mira

IS Y S

New Alamo Creek

Meridian Rd

Cypress Lakes Golf Course

Old Alamo Creek

< RSW-001

Leisure Town Rd

Leisure Town Rd

Fry Rd

New Alamo Creek

Imita Rd

Alamo Rd

Le Town Rd