

CALIFORNIA REGIONAL WATER QUALITY CONTROL BOARD
COLORADO RIVER BASIN REGION

ORDER NO. 76-38

WASTE DISCHARGE REQUIREMENTS
FOR
WESTERN FARM SERVICE
North of Imperial - Imperial County

The California Regional Water Quality Control Board, Colorado River Basin Region, finds that:

1. Western Farm Service (hereinafter also referred to as the discharger), P. O. Box 1868, El Centro, CA 92243, submitted a Report of Waste Discharge dated February 3, 1976.
2. Western Farm Service proposes to discharge a maximum of 1,500 gallons-per-day of wastewater containing plant fertilizers into an earthen basin located in the SW $\frac{1}{4}$, Section 6, T15S, R14E, SBB&M. The wastewater will consist of the following:
 - a. Wastewater from a fertilizer equipment wash-pad.
 - b. Wastewater from a weighing-scale sump into which occasional accidental spillage of fertilizers are rinsed.
3. The Water Quality Control Plan for the West Colorado River Basin Region (7A) was adopted by the Board on April 10, 1975, and this Order implements the objectives stated in the Plan.
4. Groundwaters in the vicinity of the discharge are saline and not beneficially used. The beneficial uses to be protected of nearby surface waters, particularly the Imperial Valley Drains, are:
 - a. Limited public fishing activity.
 - b. Transport of dissolved solids to Salton Sea for soil salinity control in Imperial Valley.
 - c. Freshwater habitat for fish and wildlife.
 - d. Freshwater replenishment for Salton Sea.

Rescinded
7/13/83

5. The discharger reports that:
 - a. There are no tile lines in the vicinity of the discharge.
 - b. There will be no mixing or formulation of fertilizers or other agricultural chemicals at this facility.
 - c. Pre-packaged pesticides will be temporarily stored at this facility but containers will not be opened prior to distribution.
6. The Board has notified the discharger and interested agencies and persons of its intent to prescribe waste discharge requirements for the proposed discharge.
7. The Board in a public meeting heard and considered all comments pertaining to the discharge.

IT IS HEREBY ORDERED, Western Farm Service shall comply with the following:

A. Discharge Specifications and Prohibitions

1. Neither the treatment nor the discharge of wastes shall cause a pollution or a nuisance.
2. Waste materials of pesticide origin shall not be discharged at this location.
3. The discharge of wastewater containing fertilizers shall be confined to the wastewater basin as described in Finding No. 2 (above).
4. There shall be no surface flow of wastewater away from the basin, or from the equipment wash-pad or weigh-scale sump draining to said basin.
5. A minimum freeboard depth of two (2) feet shall be maintained at all times in the basin.
6. Adequate measures shall be taken to assure that flood or surface drainage waters do not erode or otherwise render portions of the wastewater containment facilities inoperable.

7. Residues removed from the wastewater basin shall be discharged only at a location approved by the Regional Board to receive such waste.
8. There shall be no discharge of wastes to any surface waters, including open drainage channels, tile drains, or canals.
9. The discharger shall remove or relocate any wastes which are discharged contrary to the requirements contained in this Order.

B. Provisions

1. At least 15 days prior to any discharge to the wastewater basin, the discharger shall submit to the Regional Board a report stating that said basin and attendant facilities were constructed in compliance with the requirements of this Order.
2. Prior to any modifications in this facility which could result in material change in the quality or quantity of wastewater discharged, or any material change in location of discharge, the discharger shall report thereon to the Board.
3. Upon request from this Board's Executive Officer, the discharger shall furnish technical and/or monitoring reports on the treatment and discharge of waste.
4. In the event of any change in operation, or in control or ownership of land or waste disposal facilities owned or controlled by the discharger, the discharger shall:
 - a. Notify this Board of such change; and
 - B. Notify the succeeding owner or operator by letter of the existence of this Order; a copy of which shall be filed with this Board.

I, Arthur Swajian, Executive Officer, do hereby certify the foregoing is a full, true, and correct copy of an Order adopted by the California Regional Water Quality Control Board, Colorado River Basin Region, on June 10, 1976.

Arthur Swajian

Executive Officer

CALIFORNIA REGIONAL WATER QUALITY CONTROL BOARD - 7

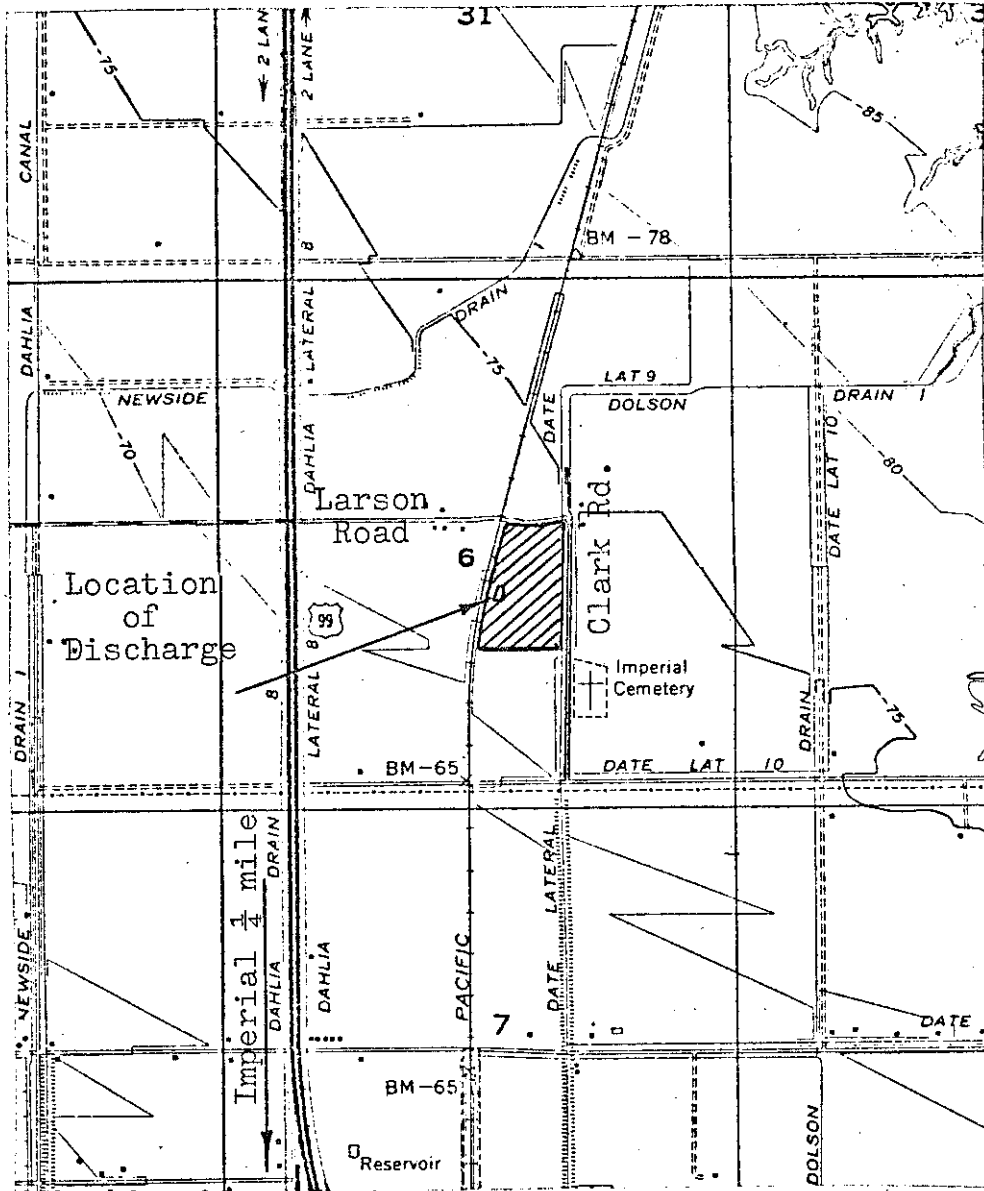

SITE MAP

WESTERN FARM SERVICE
North of Imperial - Imperial County
SW $\frac{1}{4}$, Section 6, T15S, R14E, SBB&M
Brawley 7.5' Topographic Map
El Centro 7.5' Topographic Map

Order No. 76-38