

CALIFORNIA REGIONAL WATER QUALITY CONTROL BOARD
COLORADO RIVER BASIN REGION

ORDER NO. 77-24

WASTE DISCHARGE REQUIREMENTS
FOR
PARK MOABI MARINA
Southeast of Needles - San Bernardino County

The California Regional Water Quality Control Board, Colorado River Basin Region, finds that:

1. San Bernardino County Regional Parks Department (hereinafter also referred to as the discharger) 825 E. 3rd St., San Bernardino, CA 92415, submitted a Report of Waste Discharge dated December 1, 1976.
2. The discharger is discharging an average of 5,000 gallons-per-day of domestic sewage from a park having 100 mobile home spaces and about 100 campground spaces. The wastewater is discharged through a pump-station into a raw sewage lagoon treatment system consisting of three (3) oxidation basins. The discharge site is located in the S $\frac{1}{2}$ of Section 6, T7N, R24E, SBB&M.
3. The discharger proposes to discharge a total of 600 gallons-per-day of handwashing wastewater from seven restrooms which are to be constructed at least 300 feet from the Colorado River. This washwater from each restroom would be discharged into a 150 gallon grease trap and then flow through a distribution box into a 400 square foot leach field. The leach fields are to be 800 feet apart, extending for over a mile along the river and more than one half mile north of the trailer park. Toilet wastewater from each restroom would be discharged through a self-contained-fluid-flush recirculating unit into a sealed 1,000 gallon tank. The wastewater is to be regularly pumped from each tank and discharged into the disposal system described in Finding No. 2 (above).
4. The discharge of this sewage treatment system has been subject to waste discharge requirements adopted in Board Resolution No. 69-9.
5. The Water Quality Control Plan for the East Colorado River Basin was adopted by the Board on April 10, 1975 and this Order implements the objectives stated in the Plan.

*Superseded
by 83-73*

6. The beneficial uses of the groundwater in the Piute Hydro-logic Unit are:
 - a. Municipal supply
 - b. Industrial supply
 - c. Agricultural supply.
7. The Board has notified the discharger and interested persons and agencies of its intent to prescribe waste discharge requirements for this discharge.
8. The Board in a public meeting heard and considered all comments pertaining to the discharge.

IT IS HEREBY ORDERED, the discharger shall comply with the following:

A. Discharge Specifications

1. Neither the treatment nor the discharge of wastewater shall cause a pollution or a nuisance.
2. No wastewater other than domestic sewage shall be discharged at these locations.
3. A minimum depth of freeboard of at least two feet shall be maintained in the earthen basins.
4. Treated or untreated sludge, or similar solid waste materials, shall be disposed in such manner that these materials shall not enter the Colorado River or any channel which will drain to the River.
5. Adequate measures shall be taken to assure that unauthorized persons and animal pets are effectively excluded from contact with the discharge.
6. Adequate measures shall be taken to assure that flood or surface drainage waters do not erode or otherwise render portions of the discharge facilities inoperable.
7. There shall be no surface flow of wastewater away from the discharge facilities.
8. There shall be no discharge, by-pass, or flow of treated or untreated sewage to the Colorado River, or to any channel which drains to said River.
9. Disposal by ponding shall be conducted in such a manner that there shall be no stranded or exposed sewage solids.

10. Facilities shall be available to handle wastewater in the event of commercial power failure.
11. There shall be no discharge of wastewater within 200 feet laterally from the regulated high-water line of the Colorado River or within 200 feet of any domestic water well.

B. Provisions

1. Prior to any modifications in this facility which could result in material change in the quality or quantity of wastewater discharged, or any material change in location of discharge; the discharger shall report thereon to the Board.
2. Upon request from this Board's Executive Officer, the discharger shall furnish technical and/or monitoring reports on the treatment and discharge of wastes.
3. In the event of any change in operations, or in control or ownership of land and/or waste disposal facilities owned or controlled by the discharger, the discharger shall:
 - a. Notify this Board of such change; and
 - b. Notify the succeeding owner or operator by letter of the existence of this Order, a copy of which shall be filed with this Board.
4. This Order supersedes Board Resolution No. 69-9.

I, Arthur Swajian, Executive Officer, do hereby certify the foregoing is a full, true, and correct copy of an Order adopted by the California Regional Water Quality Control Board, Colorado River Basin Region, on May 18, 1977.

Arthur Swajian

Executive Officer

CALIFORNIA REGIONAL WATER QUALITY CONTROL BOARD - 7

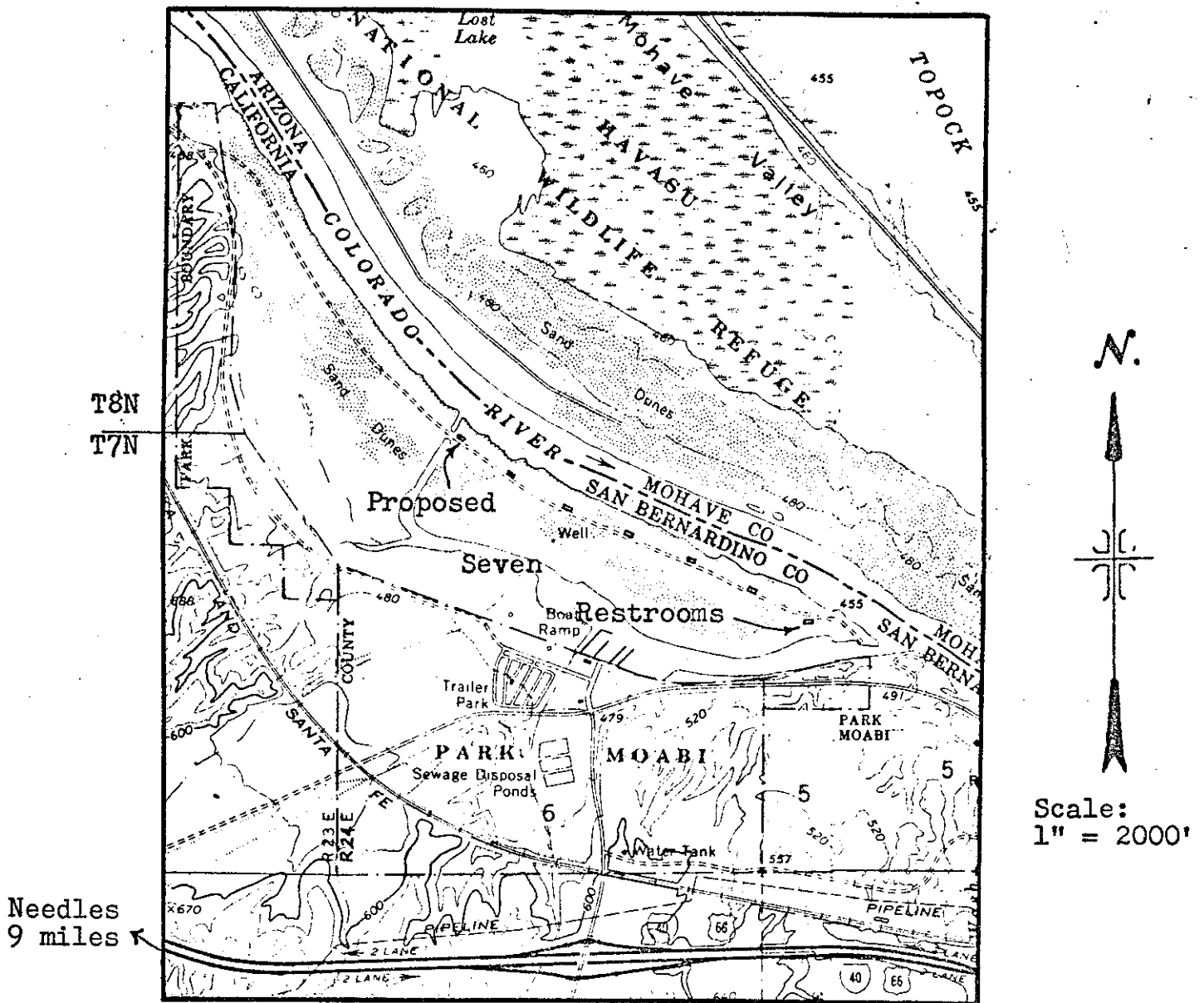

SITE MAP

PARK MOABI MARINA
Southeast of Needles - San Bernardino County
S₂, Section 6, T7N, R24E, SBB&M

Order No. 77-24