

CALIFORNIA REGIONAL WATER QUALITY CONTROL BOARD
COLORADO RIVER BASIN REGION

ORDER NO. 77-3

WASTE DISCHARGE REQUIREMENTS
FOR
BURNT MOUNTAIN APARTMENTS
Yucca Valley - San Bernardino County

The California Regional Water Quality Control Board, Colorado River Basin Region, finds that:

1. Jack Baptiste (hereinafter also referred to as the discharger); 6225 Van Nuys Blvd., Van Nuys, California, 91401, submitted a report of waste discharge dated October 26, 1976.
2. The discharger proposes to discharge an average of 3,300 gallons-per-day of domestic sewage from a 12-unit apartment complex by means of a septic tank/leach line system located in the SW $\frac{1}{4}$, NW $\frac{1}{4}$, SE $\frac{1}{4}$, of Section 1, T1S, R5E, SBB&M.
3. The discharger has reserved an area of sufficient size for 100% replacement of the sewage disposal system. This area is designated on Attachment "A" incorporated herein and made part of this Order.
4. The Water Quality Control Plan for the West Colorado River Basin was adopted by the Board on April 10, 1975, and this Order implements the objectives stated in the Plan.
5. The beneficial uses of the groundwaters of the Joshua Tree Hydrologic Unit are:
 - a. Municipal supply
 - b. Industrial supply
6. The Board has notified the discharger and interested agencies and persons of its intent to prescribe waste discharge requirements for the proposed discharge.
7. The Board in a public meeting heard and considered all comments pertaining to the proposed discharge.

*Received
9/22/82
82-36*

IT IS HEREBY ORDERED, the discharger shall comply with the following:

A. Discharge Specifications

1. Neither the treatment nor the discharge of wastewater shall cause a pollution or a nuisance.
2. No wastewater other than domestic sewage shall be discharged at this location.
3. Sewage effluent discharged subsurface shall be retained underground with no materials of sewage origin evident on the ground surface.
4. There shall be no discharge of sewage within 200 feet of any water supply well.
5. Adequate protective works shall be provided to assure that flood or surface drainage waters do not erode or otherwise render portions of the treatment and discharge facilities inoperable.
6. Septic tank cleanings shall be discharged only by a duly authorized service.

B. Provisions

1. As represented in Finding No. 3, above, said sewage disposal site shall at all times be retained servient to this apartment project, for the purpose of providing additional subsurface sewage disposal capacity, until such time as this apartment complex is connected to a municipal sewerage system.
2. Upon request from this Board's Executive Officer, the discharger shall furnish technical and/or monitoring reports on the treatment and discharge of waste.
3. Prior to any modifications in this facility which could result in material change in the quality or quantity of wastewater discharged, or any material change in location of discharge, the discharger shall report in writing to the Regional Board.
4. Prior to any proposed change in operation, or in control or ownership of the land upon which the discharge facilities are located, the discharger shall report in writing to the Regional Board.

5. Prior to any future sale of this apartment project, the dis-charger shall:

- a. Specify as a condition of sale that said sewage disposal site, as designated in Attachment "A", must remain servient to the apartment project, for the purpose of providing additional subsurface sewage disposal capacity, until such time as this apartment complex is connected to a municipal sewerage system.
- b. Notify the succeeding owner, in writing, of the existence of this Order, and forward a copy of said correspondence to the Regional Board.

I, Arthur Swajian, Executive Officer, do hereby certify the foregoing is a full, true, and correct copy of an Order adopted by the California Regional Water Quality Control Board, Colorado River Basin Region, on January 26, 1977.

Arthur Swajian
Executive Officer

CALIFORNIA REGIONAL WATER QUALITY CONTROL BOARD - 7

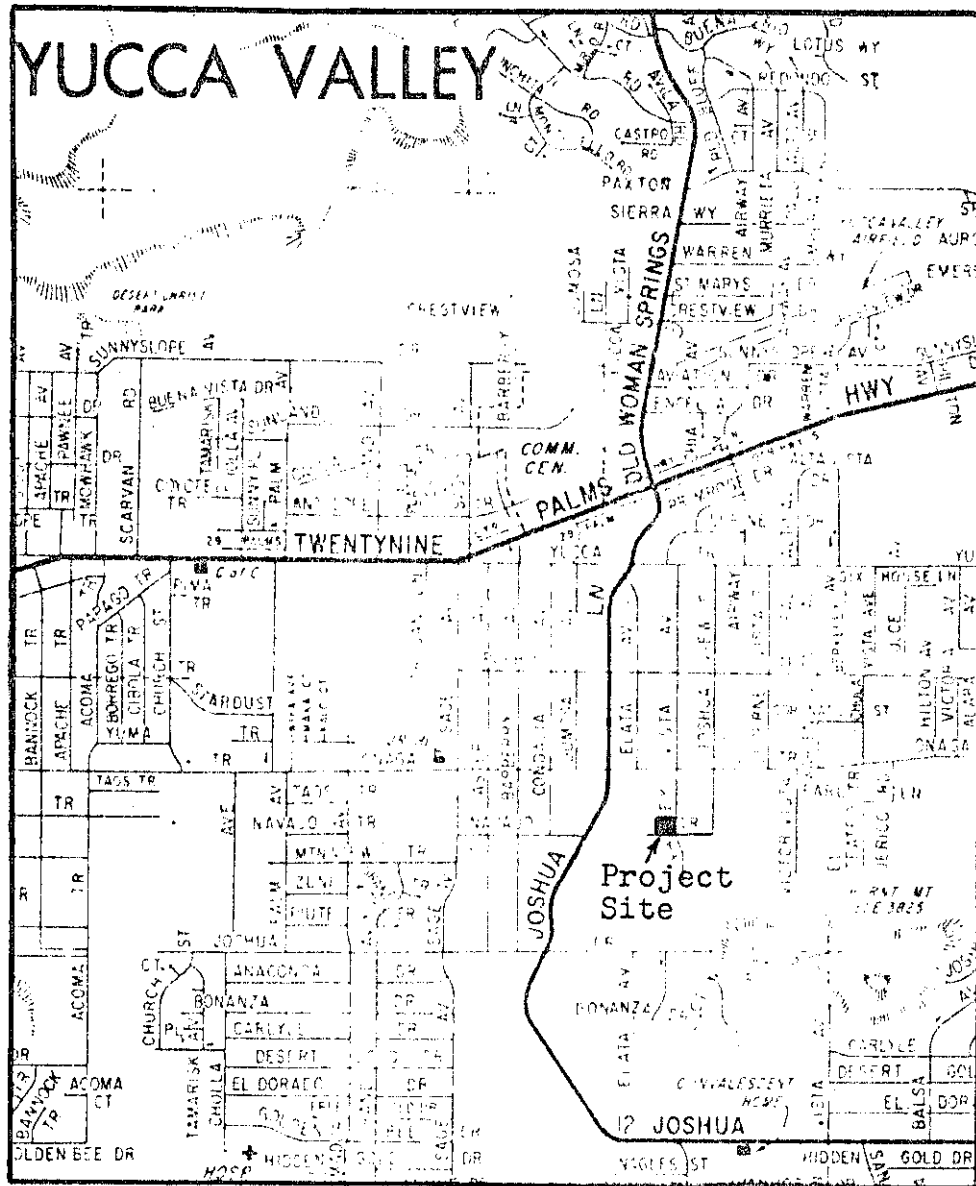

SITE MAP
FOR
BURNT MOUNTAIN APARTMENTS
Yucca Valley - San Bernardino County
SW $\frac{1}{4}$, NW $\frac{1}{4}$, SE $\frac{1}{4}$ of Section 1, T1S, R5E, SBB&M
U.S.G.S. Joshua Tree 15 min. Topographic Map

Order No. 77-3

CALIFORNIA REGIONAL WATER QUALITY CONTROL BOARD - 7

ATTACHMENT A

ORDER NO. 77-3

BURNT MOUNTAIN APARTMENTS
Yucca Valley - San Bernardino County

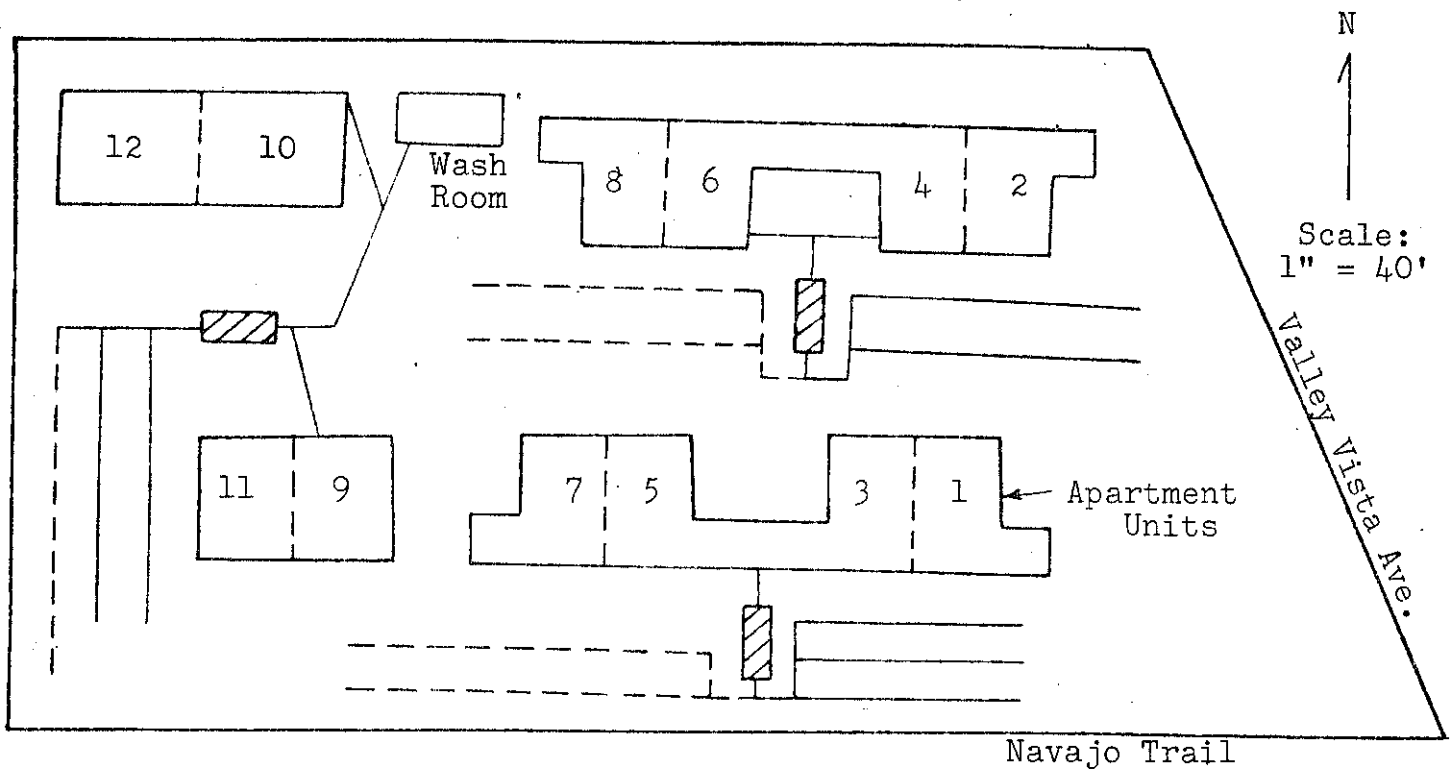

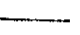
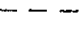
-  Proposed Septic Tank
-  Proposed Leach Line
-  100% Back-up Area for Leach Line