

CALIFORNIA REGIONAL WATER QUALITY CONTROL BOARD
COLORADO RIVER BASIN REGION

ORDER NO. 77-6
NPDES NO. CA0104701

WASTE DISCHARGE REQUIREMENTS
FOR
COACHELLA VALLEY COUNTY WATER DISTRICT
IRRIGATION ACTIVITIES WITH POINT RETURN FLOWS
Riverside County

The California Regional Water Quality Control Board, Colorado River Basin Region, finds that:

1. Coachella Valley County Water District, (hereinafter also referred to as the discharger), P. O. Box 1058, Coachella, California 92236, submitted an NPDES Application for Permit to Discharge dated August 30, 1976. Said application is assigned Application No. CA0104701.
2. The discharger reports that:
 - a. Irrigation return flows are discharged through 36 major drains to Coachella Valley Stormwater Channel, and said channel discharges to Salton Sea.
 - b. Irrigation return flows are discharged through 19 major drains direct to Salton Sea.
 - c. The estimated number of irrigated acres are:
 1. Surface method of irrigation - 52,000 acres
 2. Sprinkler method of irrigation - 2,000 acres
 3. Drip method of irrigation - 1,000 acres
 - d. The estimated volume of irrigation return flow to the surface waters set forth in Findings 2a and 2b (above) is 150,000 acre-feet/year.
3. The Water Quality Control Plan for the West Colorado River Basin (7A) was adopted by the Regional Board on April 10, 1975. This Order implements the objectives stated in said Plan.

Expired 2-28-79

4. The beneficial uses of water in irrigation drains discharging into Salton Sea are:
 - a. Transport of dissolved solids to Salton Sea for soil salinity control.
 - b. Freshwater habitat for fish and wildlife.
 - c. Freshwater replenishment for Salton Sea.
5. The beneficial uses of Salton Sea are:
 - a. Water contact recreation.
 - b. Non-water contact recreation.
 - c. Water and vegetative habitat for the maintenance of wildlife.
6. The discharge has been subject to requirements adopted in Order No. 75-11; (NPDES No. CA 0104701).
7. The Board has notified the discharger and interested agencies and persons of its intent to prescribe waste discharge requirements for the proposed discharge and has provided them with an opportunity for a public hearing and an opportunity to submit their written views and recommendations.
8. The Board in a public meeting heard and considered all comments pertaining to the discharge.
9. This Order shall serve as a National Pollutant Discharge Elimination System Permit pursuant to Section 402 of the Federal Water Pollution Control Act, or amendments thereto, and shall take effect at the end of ten days from date of adoption of this Order provided the Regional Administrator has no objections.

IT IS HEREBY ORDERED, Coachella Valley County Water District, in order to meet the provisions contained in Division 7 of the California Water Code and regulations adopted thereunder, and the provisions of the Federal Water Pollution Control Act and regulations and guidelines adopted thereunder, shall comply with the following:

A. Provisions

1. The locations of sampling stations for monitoring are as follows:
 - a. Coachella Valley Stormwater Channel downstream from discharge of Lincoln Street Drain.
 - b. Avenue 76 Drain and Stormwater Channel near Salton Sea.
 - c. Hayes Street Drain.

The monitoring stations shall be located as near Salton Sea as vehicle access allows but shall be upstream of mixing of drain water with water in Salton Sea.

2. This Order includes the attached "Monitoring and Reporting Program No. 77-6" and future revisions thereto, as specified by the Executive Officer.
3. This Order includes Items No. 1 and 5 of the attached "Reporting Requirements".
4. This Order includes Items No. 1, 4, 8, and 9 of the attached "Standard Provisions".
5. This Order includes the attached "General Monitoring and Reporting Provisions".
6. This Order expires February 28, 1979. The discharger must file a report of waste discharge in accordance with Title 23, Chapter 3, Subchapter 9 of the California Administrative Code, not later than 180 days in advance of such expiration date as application for issuance of new waste discharge requirements.
7. This Order supersedes Order No. 75-11 (NPDES No. CA0104701).

I, Arthur Swajian, Executive Officer, do hereby certify the foregoing is a full, true, and correct copy of an Order adopted by the California Regional Water Quality Control Board, Colorado River Basin Region, on

January 26, 1977.

Arthur Swajian
Executive Officer

CALIFORNIA REGIONAL WATER QUALITY CONTROL BOARD
COLORADO RIVER BASIN REGION

MONITORING AND REPORTING PROGRAM NO. 77-6
FOR
COACHELLA VALLEY COUNTY WATER DISTRICT
IRRIGATION ACTIVITIES WITH POINT RETURN FLOWS
Riverside County

IRRIGATION RETURN FLOW MONITORING

Irrigation return waters shall be monitored at the locations described in Provision A.1 for the following constituents:

<u>Constituents</u>	<u>Unit</u>	<u>Type of Sample</u>	<u>Sampling Frequency</u>
Electrical Conductivity	Micromhos/cm	Grab	Monthly
Total Dissolved Solids	mg/l	Grab	Quarterly
Flow	acre-feet	Estimate	Estimated Monthly

IRRIGATION SUPPLY MONITORING

Irrigation supply water contained in the "Coachella Canal" at the Intake Screen Structure near North Shore shall be monitored for the following constituents:

<u>Constituents</u>	<u>Unit</u>	<u>Type of Sample</u>	<u>Sampling Frequency</u>
Electrical Conductivity	Micromhos/cm	Grab	Monthly
Total Dissolved Solids	mg/l	Grab	Quarterly

REPORTING

Monthly and Quarterly monitoring reports shall be submitted to the Regional Board by the 15th day of April, July, October, and January of each year.

The discharger shall implement the above monitoring program within 90 days of the effective date of this Order.

Forward monitoring reports to:

Executive Officer
California Regional Water Quality Control Board
Colorado River Basin Region
73-271 Highway 111, Suite 21
Palm Desert, CA 92260

A copy of Discharge Monitoring Report shall also be sent to:

Regional Administrator
Environmental Protection Agency
Region IX Attn: 65/MR
100 California St.
San Francisco, CA 94111

Ordered by:

Arthur Levajian
Executive Officer

January 26, 1977
Date

CALIFORNIA REGIONAL WATER QUALITY CONTROL BOARD - 7

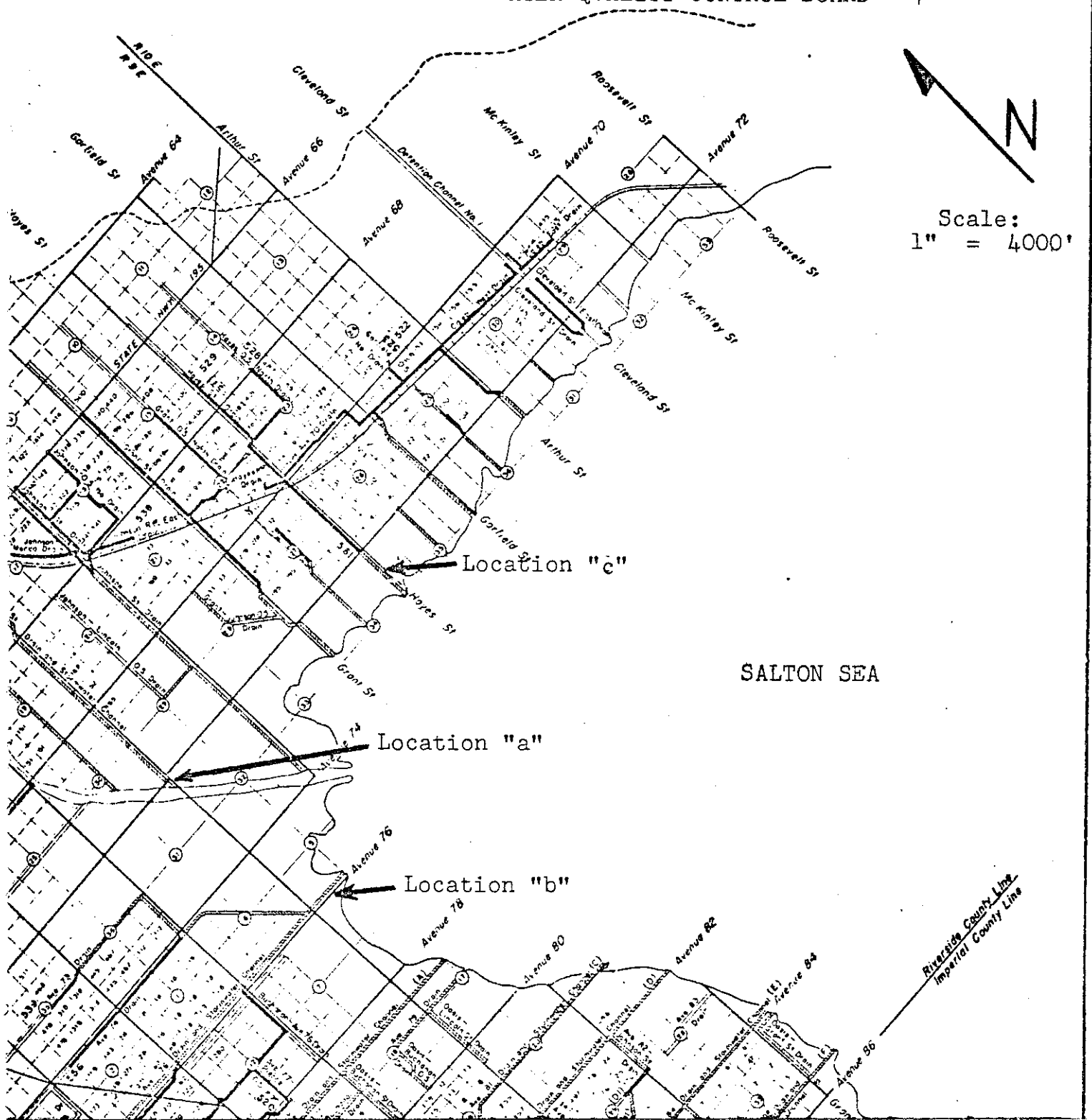

MONITORING LOCATIONS
FOR
COACHELLA VALLEY COUNTY WATER DISTRICT
IRRIGATION ACTIVITIES WITH POINT RETURN FLOWS
Riverside County

Order No. 77-6