

CALIFORNIA REGIONAL WATER QUALITY CONTROL BOARD
COLORADO RIVER BASIN REGION

ORDER NO. 77-69
FOR
COACHELLA SANITARY DISTRICT
Riverside County

The California Regional Water Quality Control Board, Colorado River Basin Region, finds that:

1. Coachella Sanitary District (hereinafter also referred to as the discharger) 1515 Sixth St., Coachella, CA 92236, submitted a Report of Waste Discharge, dated May 25, 1977.
2. The discharger proposes to discharge a present annual average daily flow of 0.4 MGD, and a design average daily flow of 1.5 MGD of reclaimed wastewater. Said wastewater would be beneficially reused in the NE¼, Sec. 16 and NW¼, Sec. 15, T6S, R8E, SBB&M as follows:
 - a. For irrigation of fodder, fiber and seed crops with possible tailwater flow to Coachella Valley Stormwater Channel.
 - b. For irrigation of pasture used by non-milking animals with possible tailwater flow to Coachella Valley Stormwater Channel.
3. The discharger also discharges wastewater into Coachella Valley Stormwater Channel, governed by waste discharge requirements contained in Order No. 74-15 (NPDES NO. CA0104493).
4. A Water Quality Control Plan for the West Colorado River Basin (7A) was adopted by the Board on April 10, 1975. The Basin Plan contains water quality objectives for the Coachella Hydrologic Subunit.

5. The beneficial uses of groundwaters at the location of the proposed waste discharge are:
 - a. Deep groundwaters are used for Municipal supply, Agricultural supply and Industrial supply.
 - b. Shallow groundwaters are influenced by agricultural operations, are saline, and enter irrigation drains and flow to Salton Sea.
6. The beneficial uses of water in Coachella Valley Stormwater Channel are:
 - a. Fish and Wildlife habitation
 - b. Fresh water replenishment for Salton Sea.
7. The Coachella Sanitary District is a subsidiary of the City of Coachella.
8. This municipal wastewater treatment constitutes an ongoing project in accordance with the provision of the California Environmental Quality Act (Public Resources Code Section 21000 et seq.) and the State Guidelines because the governmental approvals on or after April 5, 1973, do not involve a greater degree of responsibility or control over such (activity) than the governmental approvals received prior to that date.
9. The Board in a public meeting heard and considered all comments pertaining to the discharge.

IT IS HEREBY ORDERED, the discharger shall comply with the following:

A. Discharge Specifications and Prohibitions

1. Neither the treatment nor the discharge of wastewater shall create a pollution or a nuisance as defined in the California Water Code.
2. Wastewater used for irrigation of fodder, fiber and seed crops and for irrigation of pasture used by non-milking animals, when resulting tailwaters may enter Coachella Valley Stormwater Channel, shall conform, prior to delivery from the wastewater treatment plant, to Effluent Limitations A.1. through A.9. contained in Order No. 74-15 (NPDES No. CA0104493). Said Effluent Limitations A.1. through A.9. of Order No. 74-15 are hereby made a part of this Order.

3. Wastewater used for irrigation of fodder, fiber and seed crops and for irrigation of pasture used by non-milking animals, when resulting tailwaters will not enter Coachella Valley Stormwater Channel, shall have the quality of at least equivalent to that of primary effluent containing not more than 0.5 milliliter per liter of settleable solids as determined by an approved laboratory method.
4. The reused wastewaters shall not approach closer than 200 feet to any water well.

B. Provisions:

1. The discharger's wastewater treatment plant shall be supervised and operated by persons possessing certificates of appropriate grade pursuant to Chapter 3, Subchapter 14, Title 23, California Administrative Code, and who are otherwise capable of adequately maintaining and operating the wastewater treatment and disposal facilities.
2. The discharger shall comply with "Monitoring and Reporting Program No. 77-69" and "General Provisions for Monitoring and Reporting," and future revisions thereto, as specified by the Executive Officer.

I, Arthur Swajian, Executive Officer, do hereby certify the foregoing is a full, true, and correct copy of an Order adopted by the California Regional Water Quality Control Board, Colorado River Basin Region, on Sept. 21, 1977.

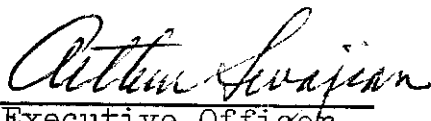
Executive Officer

CALIFORNIA REGIONAL WATER QUALITY CONTROL BOARD
COLORADO RIVER BASIN REGION

MONITORING AND REPORTING PROGRAM NO. 77-69
FOR
COACHELLA SANITARY DISTRICT
Riverside County

Location: NE¼, Sec. 16 and NW¼, Sec. 15, T6S, R8E, SBB&M

Coachella Sanitary District shall report monitoring data to the Regional Board in accordance with the following schedule:

MONITORING

Wastewater used for land irrigation shall be monitored as follows:

1. Wastewater used for irrigation of fodder, fiber and seed crops and for irrigation of pasture, when tailwaters may enter the Coachella Valley Stormwater Channel, shall be monitored for those constituents set forth in Monitoring and Reporting Program No. 74-15 (Revised), hereby made a part of this Monitoring and Reporting Program. Samples shall be obtained at the treatment plant prior to delivery for irrigation.
2. Wastewater used for irrigation of fodder, fiber and seed crops and for irrigation of pasture, when tailwaters will not enter Coachella Valley Stormwater Channel, shall be monitored daily for settleable solids. Samples shall be taken daily at the treatment plant, prior to delivery for irrigation.

REPORTING

- A. Monitoring reports for Item No. 1 (above) shall be submitted in accordance with Monitoring and Reporting Program No. 74-15 (Revised).
- B. Monitoring reports for Item No. 2 (above) shall be submitted to the Regional Board monthly.

The discharger shall implement the above monitoring program immediately upon commencement of wastewater reuse.

Forward monitoring reports to:

California Regional Water Quality Control Board
73-271 Highway 111
Suite 21
Palm Desert, CA 92260

Arturo Sevajian
Executive Officer

September 21, 1977
Date

REGIONAL WATER QUALITY CONTROL BOARD-7

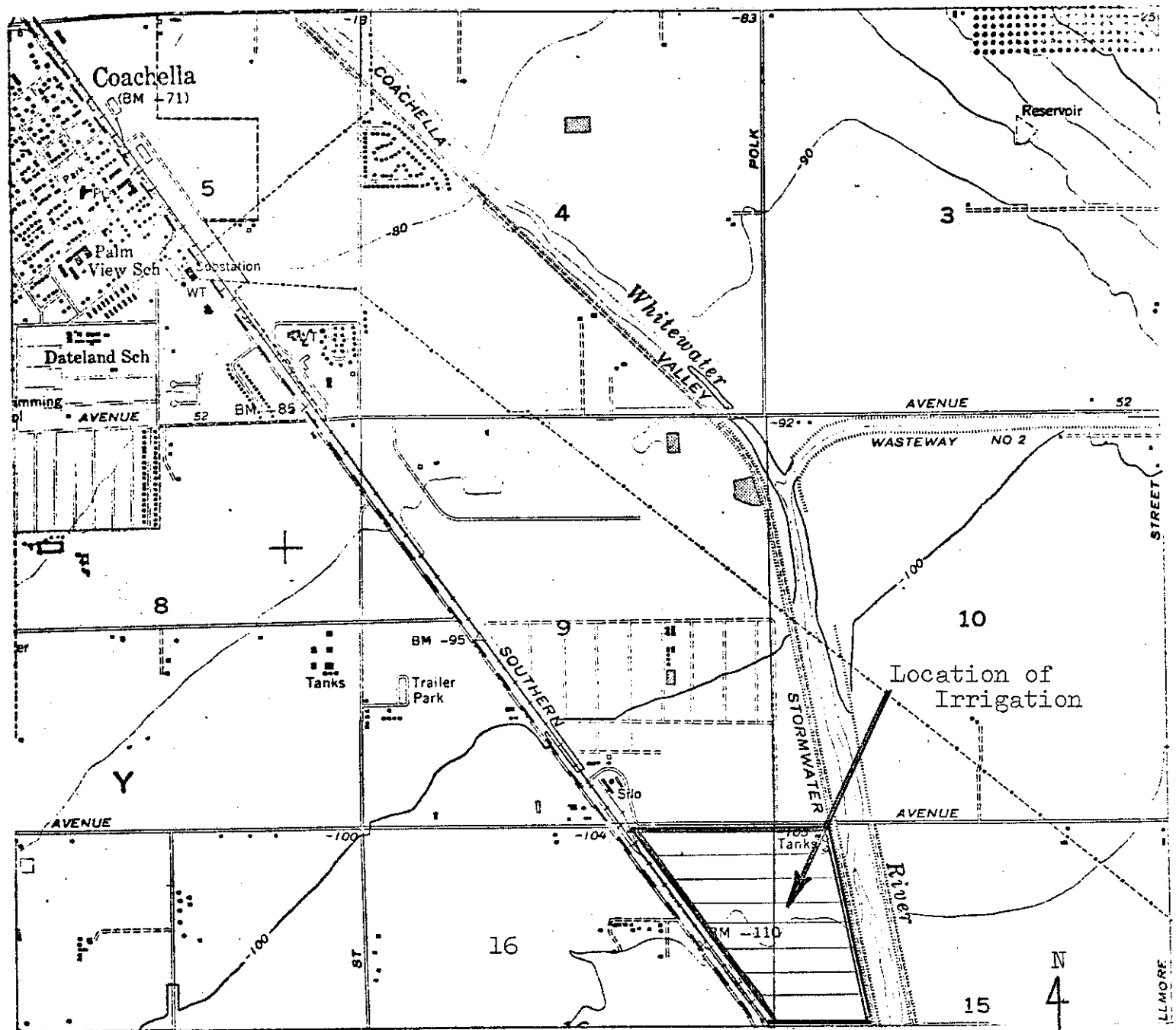

SITE MAP
 COACHELLA SANITARY DISTRICT
 IRRIGATION OF PASTURE AND CROP LAND
 NE¼, SEC. 16 and NW¼, SEC. 15, T6S, R8E, SBB&M
 INDIO 7½' TOPOGRAPHIC MAP

N
 4
 Scale
 1" = 2,000'

Date: July 8, 1977
 Order No. 77-69