

CALIFORNIA REGIONAL WATER QUALITY CONTROL BOARD
COLORADO RIVER BASIN REGION

ORDER NO. 77-70
FOR
CITY OF COACHELLA
Riverside County

The California Regional Water Quality Control Board, Colorado River Basin Region, finds that:

1. City of Coachella (hereinafter also referred to as the discharger) 1515 Sixth St., Coachella CA 92236, submitted a Report of Waste Discharge, dated May 25, 1977.
2. The discharger proposes to discharge a present average daily flow of 0.036 MGD of citrus packing plant wastewater in the N $\frac{1}{2}$, NE $\frac{1}{4}$, Sec. 9, T6S, R8E, SBB&M. Said wastewater will be used for irrigation of pasture used by non-milking animals. There will be no tailwaters flowing to Coachella Valley Stormwater Channel or other open channels.
3. The wastewater originates from two sources:
 - a. Washing of citrus fruit - this wastewater would contain bio-degradable detergents.
 - b. Blowdown water from air conditioners.
4. The packing plant generally operates from October to July of each year.
5. A Water Quality Control Plan for the West Colorado River Basin (7A) was adopted by the Board on April 10, 1975. The Basin Plan contains water quality objectives for the Coachella Hydrologic Subunit.
6. The beneficial uses of groundwaters at the location of the proposed waste discharge are:
 - a. Deep groundwaters are used for Municipal supply, Agricultural supply and Industrial supply.
 - b. Shallow groundwaters are influenced by agricultural operations, are saline, and enter irrigation drains and flow to Salton Sea.

7. This wastewater disposal constitutes an ongoing project in accordance with the provision of the California Environmental Quality Act (Public Resources Code Section 21000 et seq.) and the State Guidelines because the governmental approvals on or after April 5, 1973, do not involve a greater degree of responsibility or control over such (activity) than the governmental approvals received prior to that date.
8. The Board, in a public hearing, heard and considered all comments pertaining to the discharge.

IT IS HEREBY ORDERED, the discharger shall comply with the following:

A. Discharge Specifications and Prohibitions

1. Neither the treatment nor the discharge of wastewater shall create a pollution or a nuisance as defined in the California Water Code.
2. The discharge of wastewater to Coachella Valley Storm Channel or to any irrigation drain is prohibited.
3. The reused wastewater shall not approach closer than 200 feet to any water well.
4. The discharge shall not exceed 0.10 MGD.

B. Provisions

1. Prior to any material change in the quality or quantity of wastewater discharged, or any material change in the location of discharge, the discharger shall report thereon to the Board.
2. Upon request from this Board's Executive Officer, the discharger shall furnish technical and/or monitoring reports on the discharge of wastes.

I, Arthur Swajian, Executive Officer, do hereby certify the foregoing is a full, true, and correct copy of an Order adopted by the California Regional Water Quality Control Board, Colorado River Basin, on September 21, 1977.

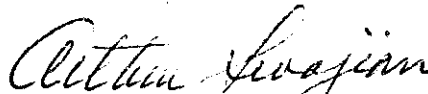

Executive Officer

CALIFORNIA REGIONAL WATER QUALITY CONTROL BOARD-7

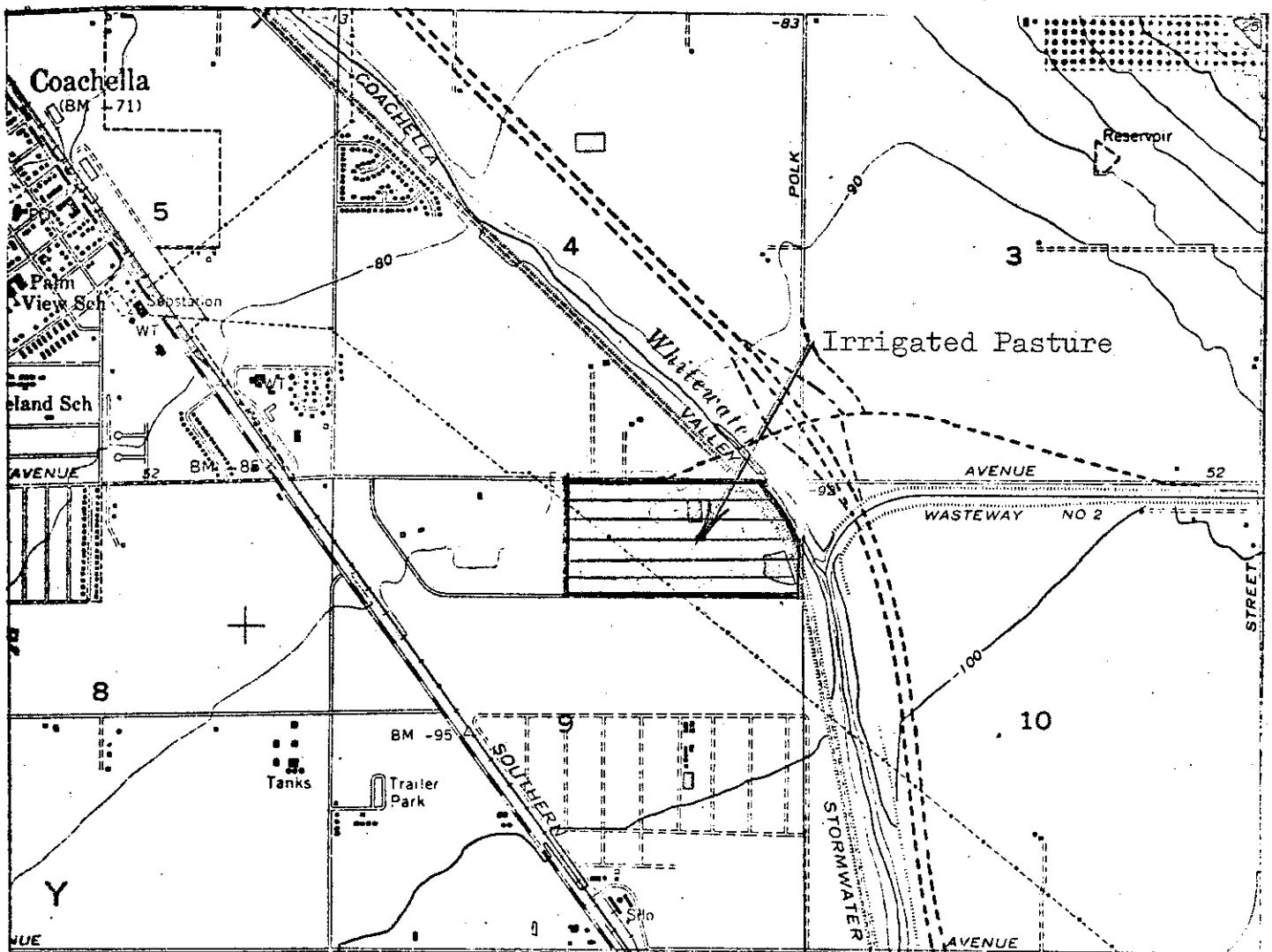

SITE MAP
CITY OF COACHELLA
IRRIGATION OF PASTURE USING
WASTEWATER FROM CITRUS PACKING PLANT
N½, NE¼, SEC. 9, T6S, R8E, SBB&M
INDIO 7½' TOPOGRAPHIC MAP

N
4
Scale
1"=2000'

Date: July 8, 1977
Order No. 77-70