

CALIFORNIA REGIONAL WATER QUALITY CONTROL BOARD
COLORADO RIVER BASIN REGION

ORDER NO. 77-91

WASTE DISCHARGE REQUIREMENTS
FOR
PORTOLA PALMS
Palm Desert - Riverside County

The California Regional Water Quality Control Board, Colorado River Basin Region, finds that:

1. Warren E. Rigdon, (hereinafter also referred to as the discharger), 43-155 Portola Ave., Palm Desert, CA 92260, submitted a Report of Waste Discharge dated September 2, 1977.
2. The discharger is discharging an average of 24,900 gallons-per-day of domestic sewage from a mobile home park having 142 mobile home spaces and a laundry room. The wastewater is discharged into septic tank/seepage pit disposal systems located in the NE $\frac{1}{4}$ of the SE $\frac{1}{4}$ of Section 17, T5S, R6E, SBB&M. Wastewater from the laundry is discharged through a lint trap into a seepage pit.
3. The discharger has reserved areas of sufficient size for 100% replacement of each of the seepage pits. These areas are designated on Attachment "A" incorporated herein and made a part of this Order.
4. The discharge of this mobile home park has been subject to waste discharge requirements adopted in Board Order No. 71-35.
5. The Water Quality Control Plan for the West Colorado River Basin was adopted by the Board on April 10, 1975. The Basin Plan contains water quality objectives for the Coachella Hydrologic Subunit.
6. The beneficial uses of the groundwaters of the Coachella Hydrologic Subunit are:
 - a. Municipal supply
 - b. Industrial supply
 - c. Agricultural supply

Superseded by
87-7
11/2/87

7. The discharger states that wastewater from a swimming pool is periodically discharged into a seepage pit.
8. The Board has notified the discharger and interested agencies and persons of its intent to update waste discharge requirements for the discharge.
9. The Board in a public meeting heard and considered all comments pertaining to the discharge.
10. This mobile home park constitutes an ongoing project in accordance with provisions of the California Environmental Quality Act (Public Resources Code Section 21000 et seq.) and the State Guidelines because the governmental approvals on or after April 5, 1973, do not involve a greater degree of responsibility or control over such activity than the governmental approvals received prior to that date.

IT IS HEREBY ORDERED, the discharger shall comply with the following:

A. Discharge Specifications

1. Neither the treatment nor the discharge of wastewater shall create a pollution or a nuisance as defined in the California Water Code.
2. No wastewater other than domestic sewage and swimming pool wastewater shall be discharged at this location.
3. Sewage effluent discharged subsurface shall be retained underground with no materials of sewage origin evident on the ground surface.
4. There shall be no discharge of wastewater within 200 feet of any water supply well.
5. Adequate measures shall be taken to assure that flood or surface drainage waters do not erode or otherwise render portions of the discharge facilities inoperable.
6. Septic tank cleanings shall be discharged only by a duly authorized service.
7. Swimming pool wastewater shall not be discharged via the sewerage system.

B. Provisions

1. The areas reserved for 100% replacement of the seepage pits, as shown on Attachment "A", shall at all times be retained servient to this mobile home park, for the purpose of providing additional subsurface sewage disposal capacity, until such time as this park is connected to a municipal sewerage system.
2. Prior to any modifications in this facility which could result in material change in the quality or quantity of wastewater discharged, or any material change in location of discharge, the discharger shall report thereon to the Board.
3. Upon request from this Board's Executive Officer, the discharger shall furnish technical and/or monitoring reports on the treatment and discharge of wastes.
4. In the event of any change in operations, or in control or ownership of land and/or waste disposal facilities owned or controlled by the discharger, the discharger shall:
 - a. Notify this Board of such change; and
 - b. Notify the succeeding owner or operator by letter of the existence of this Order, a copy of which shall be filed with this Board.
5. This Order supersedes Board Order No. 71-35.

I, Arthur Swajian, Executive Officer, do hereby certify the foregoing is a full, true, and correct copy of an Order adopted by the California Regional Water Quality Control Board, Colorado River Basin Region, on November 16, 1977.

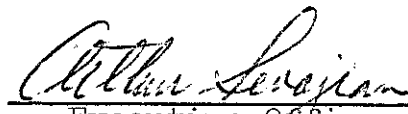
Executive Officer

CALIFORNIA REGIONAL WATER QUALITY CONTROL BOARD - 7

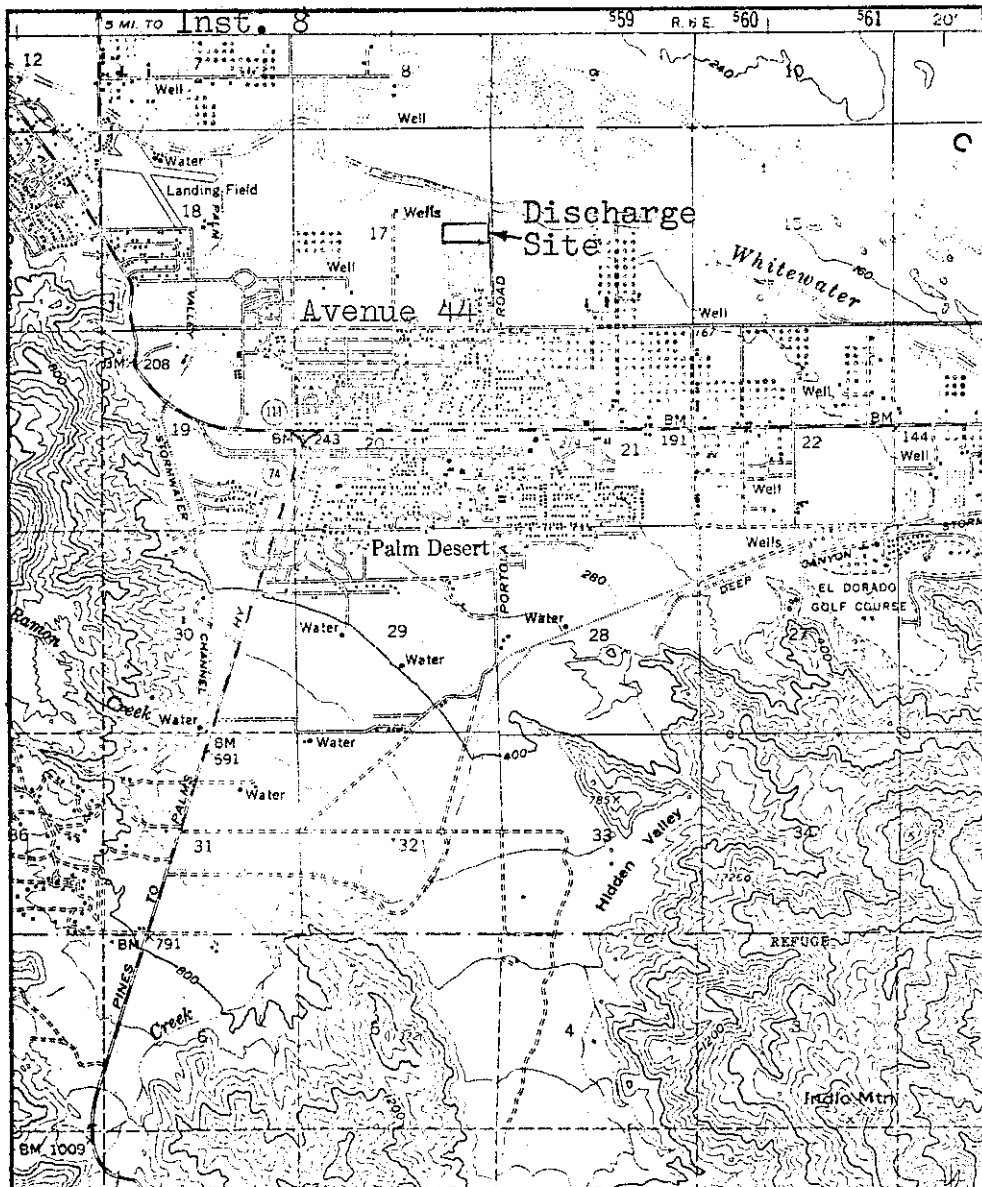

Scale:
1"=1mi.

SITE MAP

PORTOLA PALMS

Palm Desert - Riverside County
 NE $\frac{1}{4}$ of the SE $\frac{1}{4}$ of Section 17, T5S, R6E, SBB&M
 U.S.G.S. Palm Desert 15 min. Topographic Map

Order No. 77-91

CALIFORNIA REGIONAL WATER QUALITY CONTROL BOARD-7

ATTACHMENT "A"

PORTOLA PALMS

Palm Desert - Riverside County

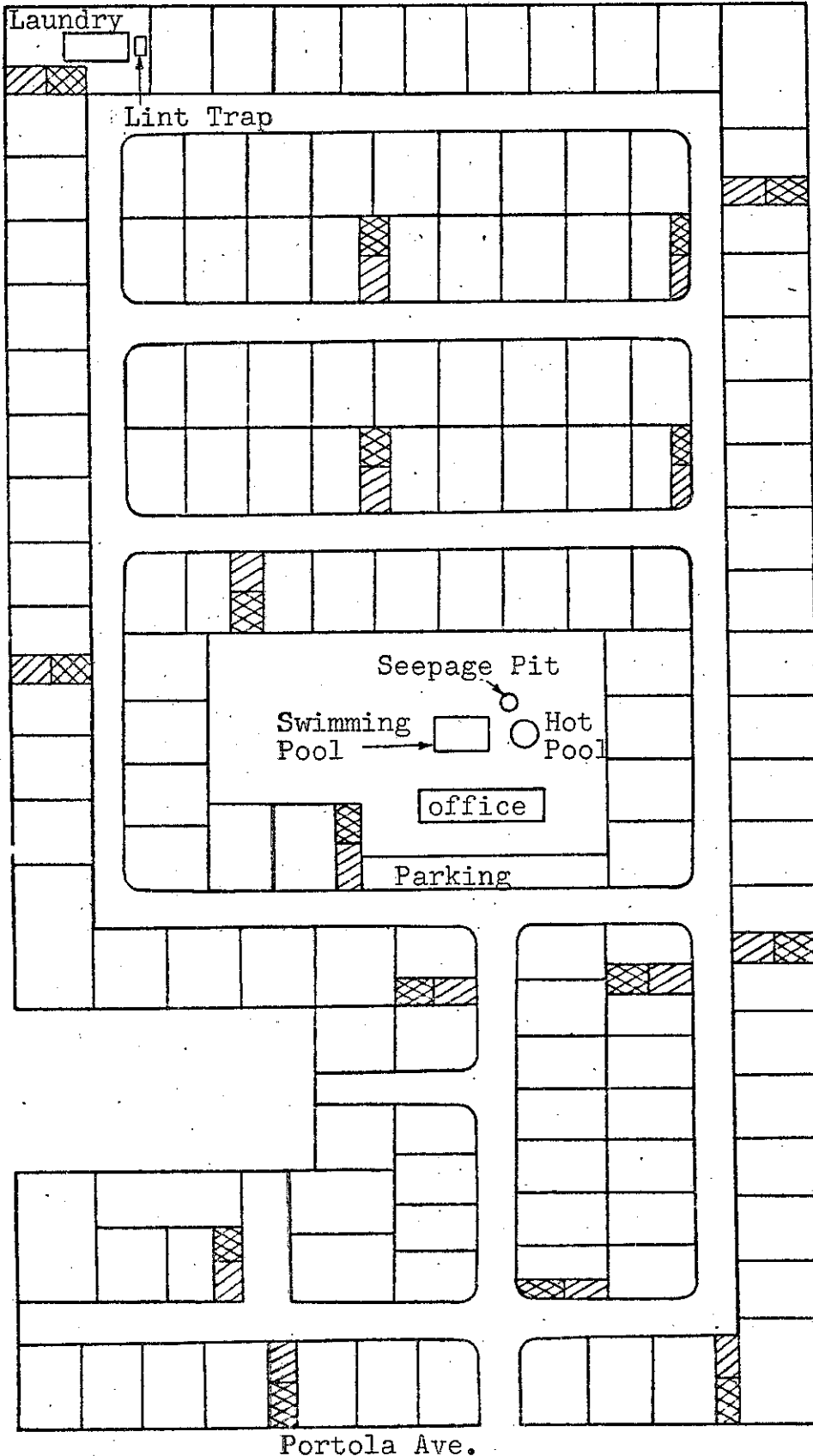

No Scale  N

 Sewage Disposal System

 100% Back-up Area

Septic Tank/Seepage Pits

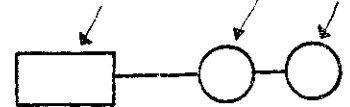

Typical Sewage Disposal System

Order No. 77-91