

CALIFORNIA REGIONAL WATER QUALITY CONTROL BOARD
COLORADO RIVER BASIN REGION

ORDER NO. 79-29

WASTE DISCHARGE REQUIREMENTS
FOR
CARRIAGE PLACE RECREATIONAL VEHICLE PARK
Northwest of Bermuda Dunes - Riverside County

The California Regional Water Quality Control Board, Colorado River Basin Region finds that:

1. John Fowler (hereinafter also referred to as the discharger) P. O. Box 789, Rancho Santa Fe, CA 92067, submitted a Report of Waste Discharge dated November 30, 1978.
2. The discharger proposes to discharge a maximum total of 55,000 gallons-per-day of domestic sewage from a recreational vehicle park designed to have 440 spaces, a laundry room and 2 restrooms. Of this total 140 are existing spaces. The wastewater generated by the expansion is to be disposed of in the same manner as the existing portion of the park, which is by means of septic tanks and seepage pits. The park including the expansion is located in the NW 1/4 of the SE 1/4 of Section 1, T5S, R6E, SBB&M.
3. The discharger is reserving areas of sufficient size for possible future 100 percent replacement of each of the seepage pits.
4. There are no domestic wells within 200 feet of the proposed discharge facilities described in Findings No. 2 and 3 (above).
5. The discharger proposes to discharge swimming pool wastewater into a proposed storm drain system which is to drain to an earthen basin in the park.
6. The Water Quality Control Plan for the West Colorado River Basin was adopted by the Board on April 10, 1975. The Basin Plan contains water quality objectives for Coachella Hydrologic Subunit.
7. The beneficial uses of the groundwaters of the Coachella Hydrologic Subunit are:
 - a. Municipal supply
 - b. Industrial supply
 - c. Agricultural supply

8. The Riverside County Planning Department has prepared Negative Declaration EA No. 10490 (filing date February 6, 1979) for this proposed expansion. The Regional Board has reviewed this Negative Declaration and has determined that this project will not have any significant adverse effects on water quality.
9. The Board has notified the discharger and interested agencies and persons of its intent to prescribe waste discharge requirements for the discharge.
10. The Board in a public meeting heard and considered all comments pertaining to the discharge.

IT IS HEREBY ORDERED, the discharger shall comply with the following:

A. Discharge Specifications

1. Neither the treatment nor the discharge of wastewater shall create a pollution or a nuisance as defined in Division 7 of the California Water Code.
2. No wastewater other than domestic sewage and swimming pool wastewater shall be discharged at this location.
3. Wastewater discharged subsurface shall be retained underground with no surfacing.
4. Adequate measures shall be taken to assure that flood or surface drainage waters do not erode or otherwise render portions of the discharge facilities inoperable.
5. Septic tank cleanings shall be discharged only by a duly authorized service.
6. Swimming pool wastewater shall not be discharged into a sewage disposal system.

B. Provisions

1. Sufficient land area shall be reserved for possible future 100 percent replacement of the seepage pits, until such time as this park is connected to a municipal sewerage system.
2. The subsurface sewerage system should be designed and constructed to facilitate possible connection to the Coachella Valley County Water District's community sewerage system for this area upon completion of construction.

3. Upon request from this Board's Executive Officer, the discharger shall furnish technical and/or monitoring reports on the treatment and discharge of waste.
4. Prior to any modifications in this facility which would result in material change in the quality or quantity of wastewater discharged, or any material change in location of discharge, the discharger shall report in writing to the Regional Board.
5. Prior to any change of ownership of this recreational vehicle park, the discharger shall:
 - a. Specify as a condition of transfer that said sewage disposal areas must remain servient to the park, for the purpose of providing subsurface sewage disposal capacity, until such time as this park is connected to a municipal sewerage system.
 - b. Notify the succeeding owner, in writing, of the existence of this Order, and forward a copy of said correspondence to the Regional Board.

I, Arthur Swajian, Executive Officer, do hereby certify the foregoing is a full, true, and correct copy of an order adopted by the California Regional Water Quality Control Board, Colorado River Basin Region, on March 14, 1979.



Executive Officer

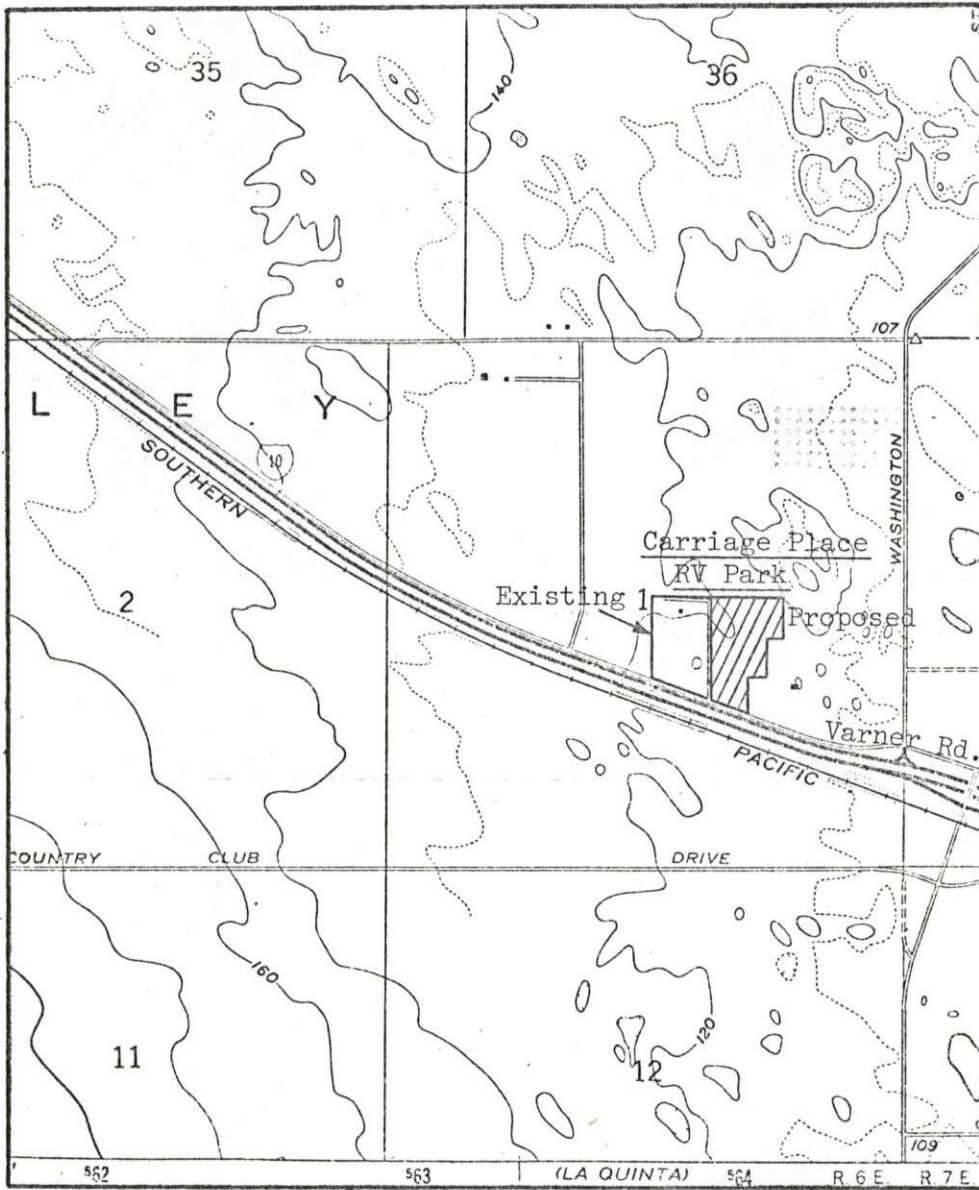

SITE MAP

CARRIAGE PLACE RECREATIONAL VEHICLE PARK
Northwest of Bermuda Dunes - Riverside County
NW 1/4 of the SE 1/4 of Section 1, T5S, R6E, SBB&M
USGS Myoma 7.5 min. Topographic Map

Order No. 79-29

CALIFORNIA REGIONAL WATER QUALITY CONTROL BOARD
COLORADO RIVER BASIN REGION

Transmittal of
REQUIREMENTS AND RECOMMENDATIONS OF
OTHER GOVERNMENTAL AGENCIES

The State Department of Public Health, Hazardous Materials Management Section, requires that disposal facilities of mobile home and recreational vehicle parks be operated in conformance with the following regulation:

There shall be no discharge of chemical toilet wastes which contain a nonbiodegradable toxic chemical substance as specified in Section 60291 of the California Health and Safety Code.