

**CALIFORNIA REGIONAL WATER QUALITY CONTROL BOARD
COLORADO RIVER BASIN REGION**

ORDER NO. 83-83

**WASTE DISCHARGE REQUIREMENTS
FOR
COUNTRY SQUIRE TRAILER PARK
Desert Hot Springs - Riverside County**

The California Regional Water Quality Control Board, Colorado River Basin Region, finds that:

1. Dan and Martha Cretti, (hereinafter also referred to as the discharger), 4131 Church Haven Way, Anaheim, California 92807, verified on June 24, 1983 that the below updated information is accurate.
2. The discharge from this mobile home and recreational vehicle park has been subject to waste discharge requirements adopted in Board Order No. 73-35.
3. The discharger is discharging a maximum of 17,000 gallons-per-day of domestic sewage from a mobile home and recreational vehicle park consisting of 50 mobile home spaces, 14 RV spaces, a laundry room, two restrooms and a recreation room. Wastewater is discharged into septic tank/seepage pit disposal systems located in the NE $\frac{1}{4}$ of the SW $\frac{1}{4}$ of Section 7, T3S, R5E, SBB&M.
4. The discharger is reserving areas of sufficient size for possible future 100 percent replacement of the seepage pits.
5. There are no domestic wells within 200 feet of the discharge facilities described in Findings No. 2 and 3 (above).
6. Wastewater from a swimming pool and a hot pool is periodically discharged onto a park street.
7. The Water Quality Control Plan for the West Colorado River Basin Region was adopted on April 10, 1975. The Basin Plan contains water quality objectives for the Coachella Hydrologic Subunit.
8. The beneficial uses of the ground water of the Coachella Hydrologic Subunit are:
 - a. Municipal supply
 - b. Industrial supply
 - c. Agricultural supply
9. The Board has notified the discharger and interested agencies and persons of its intent to update waste discharge requirements for the discharge.

*replaced
by 85-033
3/13/85*

11-2

10. The Board in a public meeting heard and considered all comments pertaining to the discharge.
11. This mobile home and recreational vehicle park constitutes an ongoing project in accordance with provisions of the California Environmental Quality Act (Public Resources Code Section 21000 et. seq.) and the State Guidelines because the governmental approvals on or after April 5, 1973, do not involve a greater degree of responsibility or control over such activity than the governmental approvals received prior to that date.

IT IS HEREBY ORDERED, the discharger shall comply with the following:

A. Discharge Specifications

1. Neither the treatment nor the discharge of wastewater shall create a pollution or a nuisance as defined in Division 7 of the California Water Code.
2. No wastewater other than domestic sewage and swimming and hot pool wastewater shall be discharged at this location.
3. Wastewater discharged subsurface shall be retained underground with no surfacing.
4. Adequate measures shall be taken to assure that flood or surface drainage waters do not erode or otherwise render portions of the discharge facilities inoperable.
5. Septic tank cleanings shall be discharged only by a duly authorized service.
6. Swimming pool and hot pool wastewater shall not be discharged into a sewage disposal system.

B. Provisions

1. Sufficient land area shall be reserved for possible future 100 percent replacement of the seepage pits, until such time as this park is connected to a municipal sewerage system.
2. Upon request from this Board's Executive Officer, the discharger shall furnish technical and/or monitoring reports on the treatment and discharge of wastes.
3. Prior to any modifications in this facility which would result in material change in the quality or quantity of wastewater discharged, or any material change in location of discharge, the discharger shall report in writing to the Regional Board.
4. Prior to any change of ownership of this mobile home and recreational vehicle park, the discharger shall:

- a. Specify as a condition of transfer that the area specified in Provision B.1 (above) remain servient to the park for the purpose of providing additional subsurface sewage disposal capacity, until such time as this park is connected to a municipal sewerage system.
- b. Transmit a copy of this Order to the succeeding owner or operator, and file a copy of the transmittal letter with this Board.

5. This Order supersedes Board Order No. 73-35.

I, Arthur Swajian, Executive Officer, do hereby certify the foregoing is a full, true and correct copy of an Order adopted by the California Regional Water Quality Control Board, Colorado River Basin Region, on September 21, 1983.



Executive Officer

CALIFORNIA REGIONAL WATER QUALITY CONTROL BOARD - 7

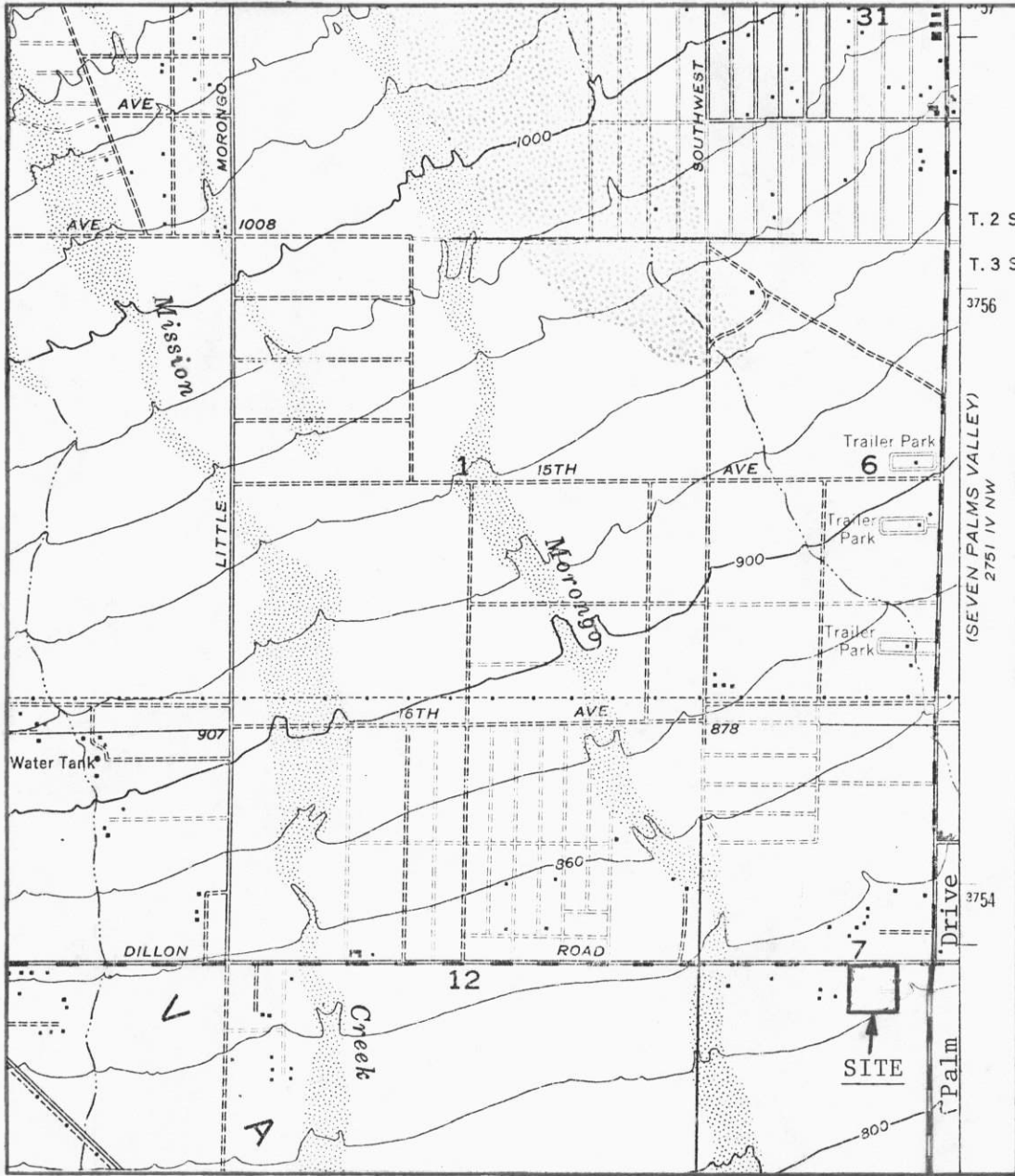

Scale:
1" = 2,000'

SITE MAP
 COUNTRY SQUIRE TRAILER PARK
 South of Desert Hot Springs - Riverside County
 Portion of NE $\frac{1}{4}$, SW $\frac{1}{4}$ of Section 7, T3S, R5E, SBB&M
 USGS Desert Hot Springs 7.5 min. Topographic Map

Order No. 83-83