

CALIFORNIA REGIONAL WATER QUALITY CONTROL BOARD
COLORADO RIVER BASIN REGION

ORDER NO. 84-40

WASTE DISCHARGE REQUIREMENTS
FOR
QUAIL VALLEY RECREATIONAL VEHICLE PARK
Southeast of Desert Hot Springs - Riverside County

The California Regional Water Quality Control Board, Colorado River Basin Region, finds that:

1. Quail Valley Association, Inc. (hereinafter also referred to as the discharger), 70201 Aurora Avenue, Desert Hot Springs, California 92240, submitted a Report of Waste Discharge dated January 27, 1984.
2. The discharger proposes to discharge a maximum of 93,000 gallons-per-day of domestic sewage from a recreational vehicle park designed to have 288 RV spaces, a laundry room and three recreation buildings. Wastewater would be discharged into septic tank/seepage pit disposal systems to be located in the E $\frac{1}{2}$ of the SW $\frac{1}{4}$ of the SW $\frac{1}{4}$ of Section 11, T3S, R5E, SBB&M.
3. The discharger is reserving areas of sufficient size for possible future 100 percent replacement of the seepage pits.
4. There are no domestic wells within 200 feet of the proposed discharge facilities described in Findings No. 2 and 3 (above).
5. Wastewater from a swimming pool and two hot pools would be periodically discharged onto landscape plantings.
6. The Water Quality Control Plan for the West Colorado River Basin was adopted on April 10, 1975. The Basin Plan contains water quality objectives for Coachella Hydrologic Subunit.
7. The beneficial uses of ground water of the Coachella Hydrologic Subunit are:
 - a. Municipal supply
 - b. Industrial supply
 - c. Agricultural supply
8. This proposed park is located in the Miracle Hill Subarea of the Coachella Hydrologic Subunit. Ground water in this area is warm and mineralized, and is used in hot pools and for landscape irrigation.

*Replaced by
94-074*

9. The Board has notified the discharger and interested agencies and persons of its intent to prescribe waste discharge requirements for the proposed discharge.
10. The Board in a public meeting heard and considered all comments pertaining to the proposed discharge.
11. The Riverside County Planning Department has approved Negative Declaration No. EA 18256 (approval date April 19, 1984) for this proposed park. The Regional Board has reviewed this Negative Declaration. The below waste discharge requirements are designed to assure against any significant adverse effects on water quality.

IT IS HEREBY ORDERED, the discharger shall comply with the following:

A. Discharge Specifications

1. Neither the treatment nor the discharge of wastewater shall create a pollution or a nuisance as defined in Division 7 of the California Water Code.
2. No wastewater other than domestic sewage and swimming pool and hot pool wastewater shall be discharged at this location.
3. Wastewater discharged subsurface shall be retained underground with no surfacing.
4. Adequate measures shall be taken to assure that flood or surface drainage waters do not erode or otherwise render portions of the discharge facilities inoperable.
5. Septic tank cleanings shall be discharged only by a duly authorized service.
6. Swimming pool and hot pool wastewater shall not be discharged into a sewage disposal system.

B. Provisions

1. Sufficient land area shall be reserved for possible future 100 percent replacement of the seepage pits, until such time as this park is connected to a municipal sewerage system.
2. Upon request from this Board's Executive Officer, the discharger shall furnish technical and/or monitoring reports on the treatment and discharge of wastes.
3. Prior to any modifications in this facility which would result in material change in the quality or quantity of wastewater discharged, or any material change in location of discharge, the discharger shall report in writing to the Regional Board.

4. Prior to any change of ownership of this recreational vehicle park, the discharger shall:

- a. Specify as a condition of transfer that the area specified in Provision B.1. (above) remain servient to the development for the purpose of providing additional subsurface sewage disposal capacity, until such a time as this development is connected to a municipal sewerage system.
- b. Notify the succeeding owner, in writing, of the existence of this Order, and forward a copy of said correspondence to the Regional Board.

I, Arthur Swajian, Executive Officer, do hereby certify the foregoing is a full, true and correct copy of an Order adopted by the California Regional Water Quality Control Board, Colorado River Basin Region, on May 16, 1984.

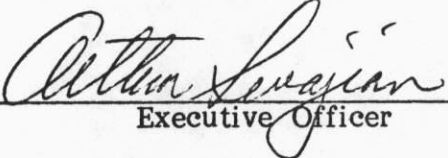
Executive Officer

CALIFORNIA REGIONAL WATER QUALITY CONTROL BOARD - 7

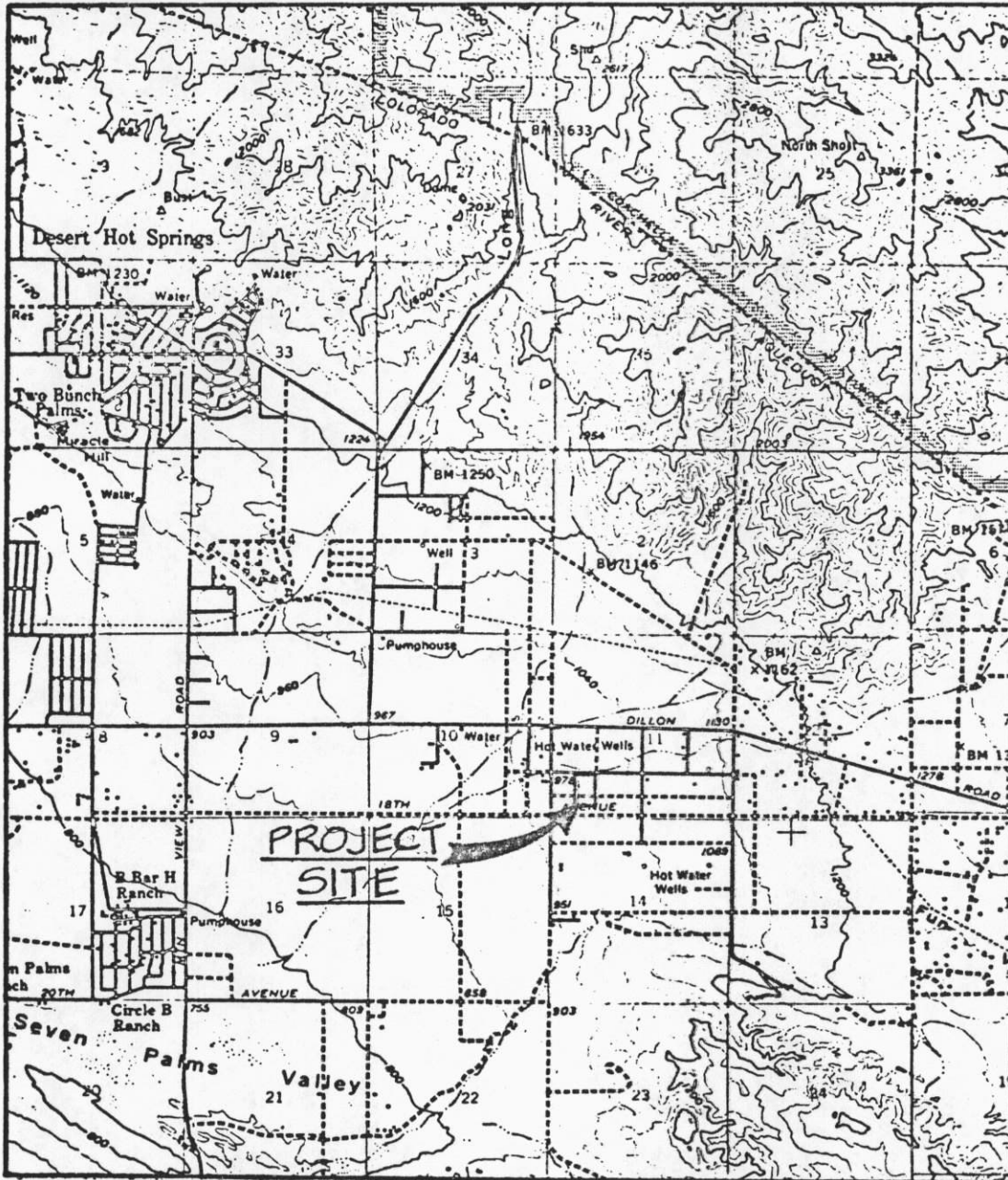

Scale:
1" = 1 mile

SITE MAP

QUAIL VALLEY RECREATIONAL VEHICLE PARK
 Southeast of Desert Hot Springs - Riverside County
 E $\frac{1}{4}$, SW $\frac{1}{4}$, SW $\frac{1}{4}$ of Section 11, T3S, R5E, SBB&M
 USGS Thousand Palms 15 min. Topographic Map

Order No. 84-40