

**CALIFORNIA REGIONAL WATER QUALITY CONTROL BOARD
COLORADO RIVER BASIN REGION**

ORDER NO. 85-102

**WASTE DISCHARGE REQUIREMENTS
FOR
PALM DESERT GREENS ASSOCIATION, INC.
WASTEWATER RECLAMATION
North of Palm Desert - Riverside County**

The California Regional Water Quality Control Board, Colorado River Basin Region, finds that:

1. Palm Desert Greens Association, Inc. 73-750 Country Club Drive, Palm Desert, CA 92260 (hereinafter also referred to as the discharger), submitted a Report of Waste Discharge, dated August 27, 1985, for the proposed irrigation of a golf course and common areas, using reclaimed wastewater provided by Coachella Valley Water District.
2. The maximum irrigation design flow would be 2 mgd, and the average design flow would be 1.2 mgd. The golf course and common areas are located in the Section 5, T5S, R6E, SBB&M.
3. Filtered wastewater would be provided to Palm Desert Greens Association, Inc., by Coachella Valley Water District.
4. The Water Quality Control Plan for the Colorado River Basin Region of California was adopted by the Board on November 14, 1984. The Basin Plan contains water quality objectives for the Coachella Hydrologic Subunit.
5. The beneficial uses of the ground water of the Coachella Hydrologic Subunit are:
 - a. Municipal supply
 - b. Industrial supply
 - c. Agricultural supply
6. The Board has notified the discharger and interested agencies and persons of its intent to prescribe waste discharge requirements for this discharge.
7. The Board in a public meeting heard and considered all comments pertaining to the discharge.
8. The requirements prescribed below establish acceptable levels of constituents of reclaimed water in accordance with Title 22, Division 4, of the California Administrative Code, in order to ensure that the use of reclaimed water for the specified purposes does not impose undue risks to public health.

Superseded
87-19
1/21/87

IT IS HEREBY ORDERED, the discharger shall comply with the following:

A. Discharge Specifications

1. Reclaimed water shall only be used for landscape irrigation of the common areas and golf course described in the findings of this Order. Prior to making use of reclaimed water purveyed by the Coachella Valley Water District (CVWD) for any other purpose or at any other location, the user shall obtain any necessary authorization from CVWD and waste discharge requirements from this Regional Board.
2. Irrigation with reclaimed wastewater shall be under the direct control of the discharger at all times.
3. The discharger shall allow the Regional Board, or an authorized representative upon the presentation of credentials and other documents as may be required by law, to:
 - (a) Enter upon the discharger's premises where a regulated facility or activity is located or conducted, or where records must be kept under the conditions of this Order;
 - (b) Have access to and copy, at reasonable times, any records that must be kept under the conditions of this Order;
 - (c) Inspect at reasonable times any facilities, equipment (including monitoring and control equipment), practices, or operations regulated or required under this Order; and,
 - (d) Sample or monitor at reasonable times, for the purpose of assuring compliance with this Order or as otherwise authorized by the California Water Code, any substances or parameters at any location.
4. An on-site supervisor responsible for operation of the reclaimed wastewater system shall be designated by the user. The supervisor shall be responsible for the installation, operation and maintenance of the irrigation system, enforcing the rules and regulations, prevention of potential hazards and maintenance of the distribution system plans in "as-built" form, and for the distribution of the reclaimed wastewater in accordance with this Order. The name of the on-site supervisor shall be furnished to the Regional Board at least 30 days prior to commencement of use of reclaimed wastewater.
6. The designated supervisor shall report any noncompliance with this Order to the Regional Board. Any information shall be provided orally within 24 hours from the time the on-site supervisor becomes aware of the circumstances. A written submission shall also be provided to the Regional Board within five days of the time the on-site supervisor becomes aware of the circumstances. The written submission shall contain:
 - (a) a description of the noncompliance and its cause;

- (b) the period of noncompliance, including exact dates and times, and if the noncompliance has not been corrected, the anticipated time it is expected to continue; and;
 - (c) steps taken or planned to reduce, eliminate, and prevent recurrence of the noncompliance.
6. The name of the designated on-site supervisor shall be furnished to the Regional Board at the following address:
- Executive Officer
California Regional Water Quality Control Board
Colorado River Basin Region
73-271 Highway 111, Suite 21
Palm Desert, California 92260
- Telephone: (619) 346-7491
7. A freeboard depth of at least two (2) feet shall be maintained in each infiltration basin and/or holding pond.

B. Provisions

1. The treatment and discharge of waste shall not cause a pollution or a nuisance as defined in Sections 13050 (1) and 13050 (m) of the California Water Code.

I, Arthur Swajian, Executive Officer, do hereby certify the foregoing is a full, true, and correct copy of an Order adopted by the California Regional Water Quality Control Board, Colorado River Basin Region, on November 20, 1985.

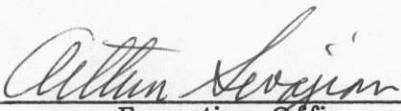
Executive Officer

CALIFORNIA REGIONAL WATER QUALITY CONTROL BOARD - 7

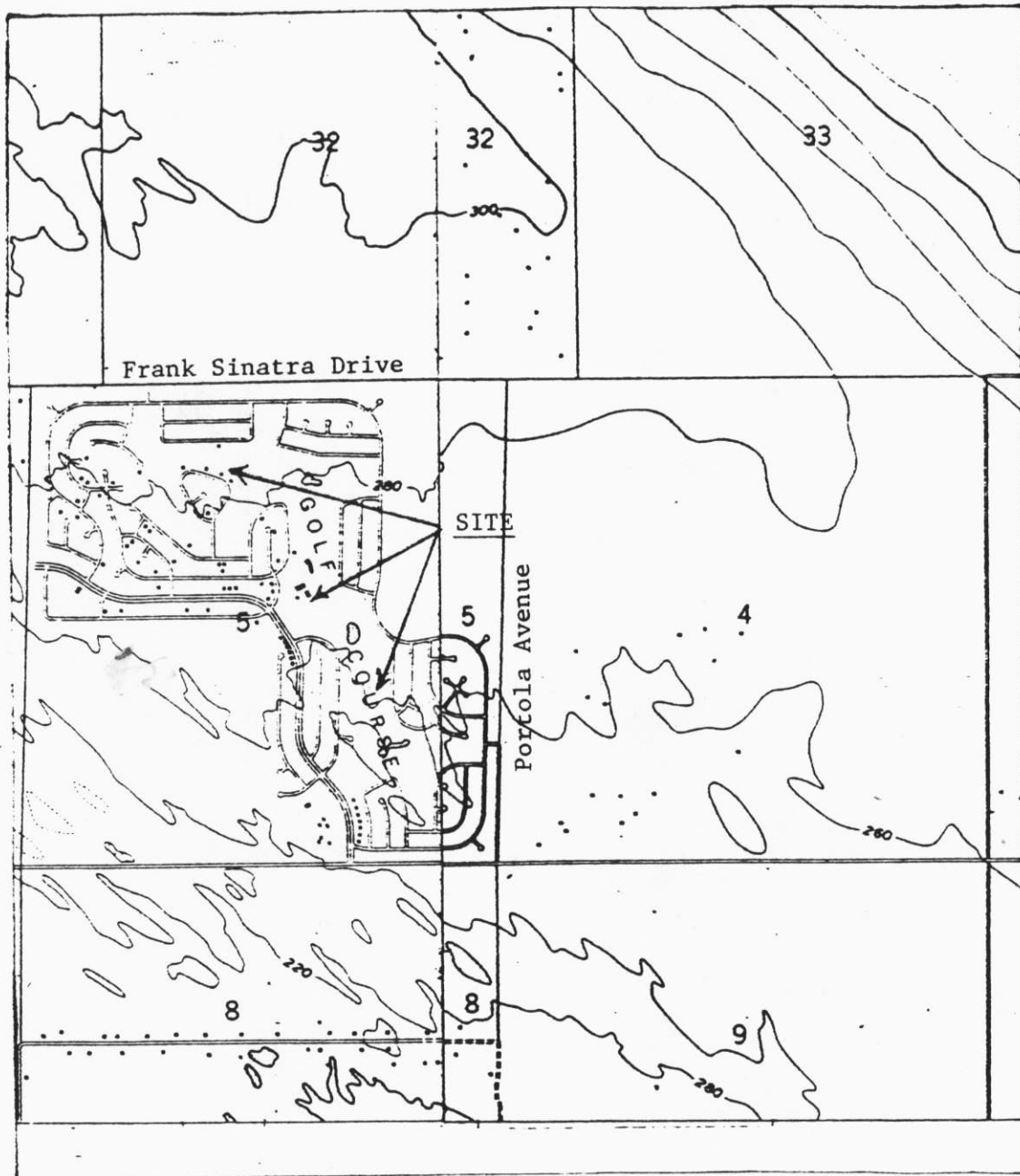

SITE MAP

PALM DESERT GREENS ASSOCIATION, INC.
WASTEWATER RECLAMATION

North of Palm Desert - Riverside County
Section, 5, T5S, R6E, SBB&M