

**CALIFORNIA REGIONAL WATER QUALITY CONTROL BOARD
COLORADO RIVER BASIN REGION**

ORDER NO. 85-106

**WASTE DISCHARGE REQUIREMENTS
FOR
BORREGO VALLEY RV PARK
Borrego Springs - San Diego County**

The California Regional Water Quality Control Board, Colorado River Basin Region, finds that:

1. John M. Matson (hereinafter also referred to as the discharger), 1409 Villa Street, Riverside, California 92507, submitted a complete Report of Waste Discharge on May 23, 1985.
2. The discharger proposes to discharge a design flow of 18,200 gallons-per-day of domestic sewage from a recreational vehicle park designed to have 104 RV spaces, a restaurant, a laundry room, 6 restrooms and 6 shower rooms. The wastewater is to be discharged into septic tank/seepage pit disposal systems located in the N $\frac{1}{2}$ of the NE $\frac{1}{4}$ of the NE $\frac{1}{4}$ of Section 16, T11S, R6E, SBB&M.
3. The discharger is reserving areas of sufficient size for possible future 100 percent replacement of the seepage pits.
4. There are no domestic wells within 200 feet of the proposed discharge facilities described in Findings No. 2 and 3 (above).
5. The discharger informs that wastewater from a swimming pool is to be periodically discharged onto landscape plantings.
6. The Water Quality Control Plan for the Colorado River Basin Region of California was adopted by the Regional Board on November 14, 1984. The Basin Plan contains water quality objectives for Anza-Borrego Hydrologic Unit.
7. The beneficial uses of the groundwater of the Anza-Borrego Hydrologic Unit are:
 - a. Municipal supply
 - b. Industrial supply
 - c. Agricultural supply
8. The Board has notified the discharger and interested agencies and persons of its intent to prescribe waste discharge requirements for the proposed discharge.
9. The Board in a public meeting heard and considered all comments pertaining to the proposed discharge.

*Cancelled
5/12/88*

CALIFORNIA REGIONAL WATER QUALITY CONTROL BOARD
COLORADO RIVER BASIN REGION

ORDER NO. 45-106

WASTE DISCHARGE PERMIT
BORNEGO VALLEY RV PARK
Borrego Springs - San Diego County

The California Regional Water Quality Control Board, Colorado River Basin Region, finds that:

1. John M. Watson (hereinafter also referred to as the discharger), 1409 Villa Street, Riverside, California 92507, submitted a complete report of Waste Discharge on May 23, 1985.
2. The discharger proposes to discharge a design flow of 18,300 gallons-per-day of domestic sewage from a recreational vehicle park designed to have 104 RV spaces, a restaurant, a laundry room, 2 restrooms and 8 shower rooms. The wastewater is to be discharged into septic tank/seepage disposal systems located in the NE 1/4 of the NE 1/4 of section 18, T11S, R8E, S88&M.
3. The discharger is reserving areas of sufficient size for possible future 100 percent replacement of the seepage pits.
4. There are no domestic wells within 200 feet of the proposed discharge facilities described in Findings No. 2 and 3 (above).
5. The discharger informs that wastewater from a swimming pool is to be periodically discharged onto landscape plantings.
6. The Water Quality Control Plan for the Colorado River Basin Region of California was adopted by the Regional Board on November 14, 1984. The Basin Plan contains water quality objectives for Anza-Borrego Hydrologic Unit.
7. The beneficial uses of the groundwater of the Anza-Borrego Hydrologic Unit are:
 - a. Municipal supply
 - b. Industrial supply
 - c. Agricultural supply
8. The Board has notified the discharger and interested agencies and persons of its intent to prescribe waste discharge requirements for the proposed discharge.
9. The Board in a public hearing heard and considered all comments pertaining to the proposed discharge.

10. The San Diego County Planning Department has approved Negative Declaration EA No. 82-11-1 (filing date August 15, 1985) for this proposed recreational vehicle park. The Regional Board has reviewed this Negative Declaration. The below waste discharge requirements are designed to assure against any significant adverse effects on water quality.

IT IS HEREBY ORDERED, the discharger shall comply with the following:

A. Discharge Specifications

1. Neither the treatment nor the discharge of wastewater shall create a pollution or a nuisance as defined in Division 7 of the California Water Code.
2. No wastewater other than domestic sewage and swimming pool wastewater shall be discharged at this location.
3. Wastewater discharged subsurface shall be retained underground with no surfacing.
4. Adequate measures shall be taken to assure that flood or surface drainage waters do not erode or otherwise render portions of the discharge facilities inoperable.
5. Septic tank cleanings shall be discharged only by a duly authorized service.
6. Swimming pool wastewater shall not be discharged into a sewage disposal system.

B. Provisions

1. Sufficient land area shall be reserved for possible future 100 percent replacement of the seepage pits, until such time as this park is connected to a municipal sewerage system.
2. Upon request from this Board's Executive Officer the discharger shall furnish technical and/or monitoring reports on the treatment and discharge of waste.
3. Prior to any modifications in this facility which would result in material change in the quality or quantity of wastewater discharged, or any material change in location of discharge, the discharger shall report in writing to the Regional Board.
4. Prior to any change of ownership of this recreational vehicle park, the discharger shall:
 - a. Specify as a condition of transfer that the area utilized for sewage disposal and replacement thereof as set forth in Provision B.1. (above) remain servient to the development until such time as this park is connected to a municipal sewerage system.

10. The San Diego County Planning Department has approved Negative Declaration EA No. 82-11-1 (dated August 15, 1982) for this proposed recreational vehicle park. The Regional Board has reviewed this Negative Declaration. The below waste management requirements are designed to assure against any significant adverse effects on water quality.

IT IS HEREBY ORDERED, the discharger shall comply with the following:

A. Discharge Specifications

1. Neither the treatment nor the discharge of wastewater shall create a pollution or a nuisance as defined in Division 7 of the California Water Code.
2. No wastewater other than domestic sewage and swimming pool wastewater shall be discharged at this location.
3. Wastewater discharged subsurface shall be retained underground with no surfacing.
4. Adequate measures shall be taken to assure that flood or surface drainage waters do not erode or otherwise render portions of the discharge facilities inoperable.
5. Septic tank cleanings shall be discharged only by a duly authorized service.
6. Swimming pool wastewater shall not be discharged into a sewage disposal system.

B. Provisions

1. Sufficient land area shall be reserved for possible future 100 percent replacement of the seepage pits, until such time as this park is connected to a municipal sewage system.
2. Upon request from this Board's Executive Officer the discharger shall furnish technical and/or monitoring reports on the treatment and discharge of waste.
3. Prior to any modifications in this facility which would result in material change in the quality or quantity of wastewater discharged, or any material change in location of discharge, the discharger shall report in writing to the Regional Board.
4. Prior to any change of ownership of this recreational vehicle park, the discharger shall:
 - a. Specify as a condition of transfer that the area utilized for sewage disposal and replacement thereof as set forth in Provision B.1. (above) remain servient to the development until such time as this park is connected to a municipal sewage system.

- b. Transmit a copy of this Order to the succeeding owner or operator, and file a copy of the transmittal letter with this Board.

I, Arthur Swajian, Executive Officer, do hereby certify the foregoing is a full, true and correct copy of an Order adopted by the California Regional Water Quality Control Board, Colorado River Basin Region, on November 20, 1985.

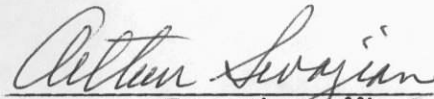
Executive Officer

CALIFORNIA REGIONAL WATER QUALITY CONTROL BOARD -7

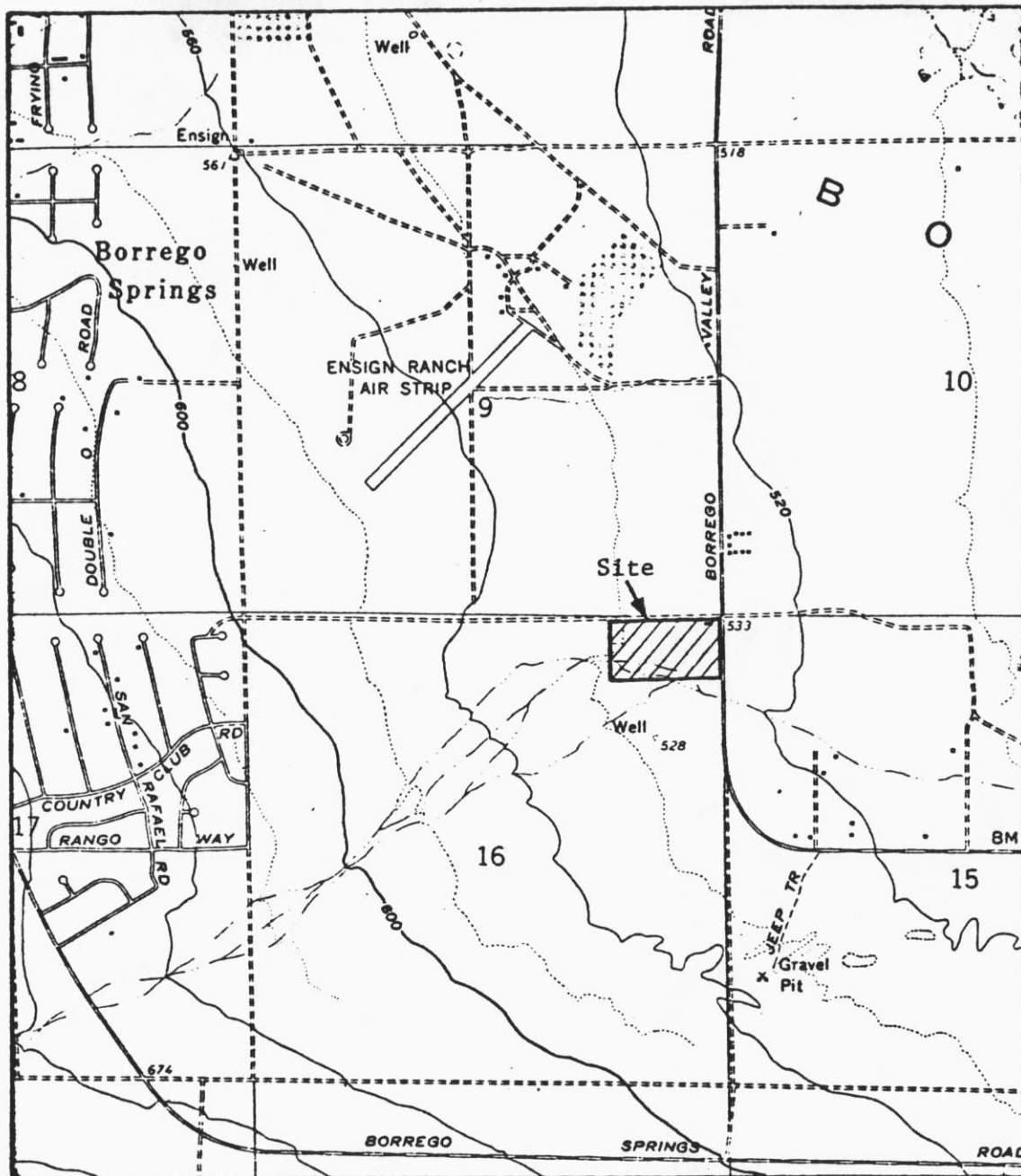

Scale:
1" = 2,000'

SITE MAP

BORREGO VALLEY RV PARK
Borrego Springs - San Diego County
N1/2, NE1/4, NE1/4 of Section 16, T11S, R6E, SBB&M
USGS Borrego Sink 7.5 min. Topographic Map

Order No. 85-106

Scale:
1"=360'

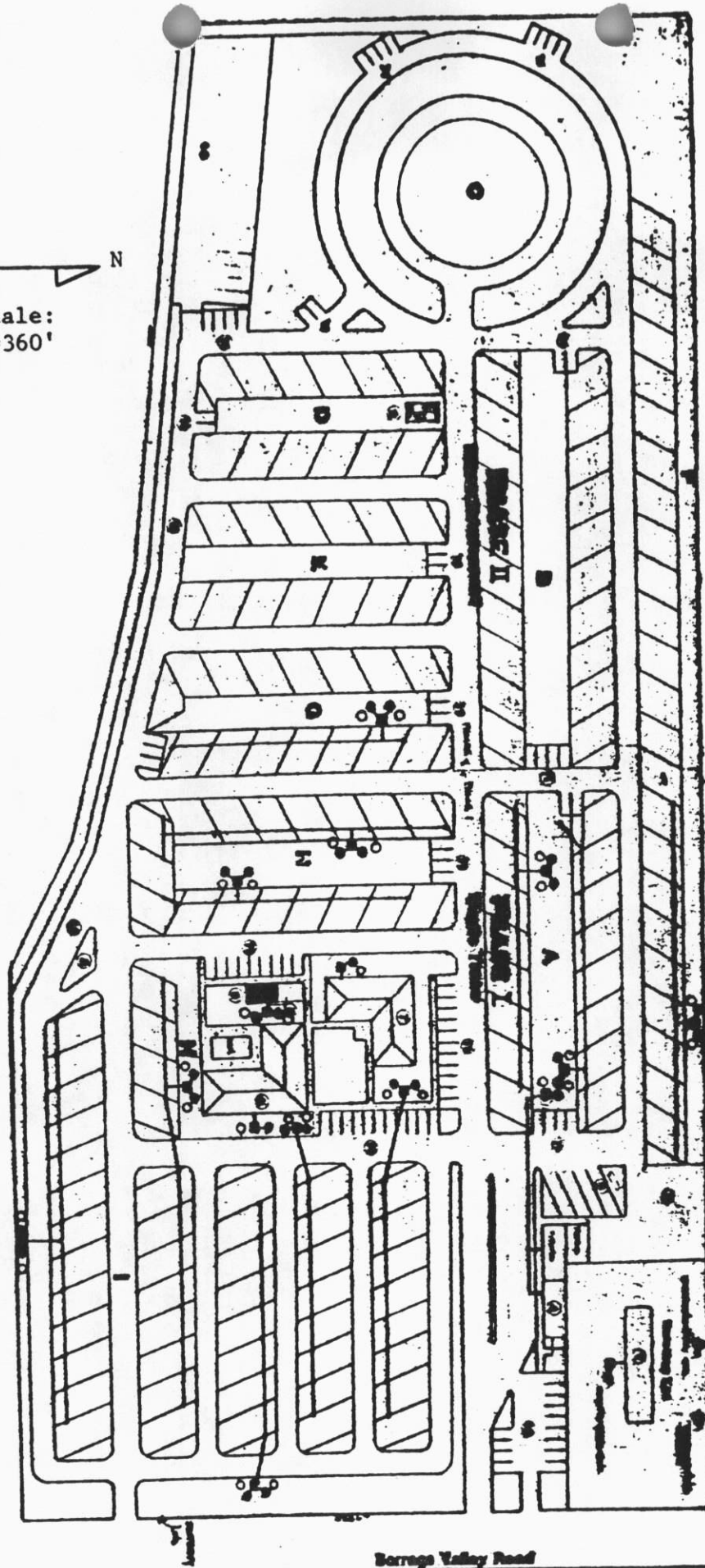

- Septic Tank
- Seepage Pit
- 100% Replacement Seepage Pit

PRELIMINARY SEWAGE DISPOSAL FACILITIES SKETCH
BORREGO VALLEY RV PARK
Borrego Springs - San Diego County