

**CALIFORNIA REGIONAL WATER QUALITY CONTROL BOARD  
COLORADO RIVER BASIN REGION**

ORDER NO. 85-50

**WASTE DISCHARGE REQUIREMENTS  
FOR  
RIVERSIDE COUNTY SERVICE AREA NO. 62  
RIPLEY WASTEWATER TREATMENT FACILITY  
Ripley - Riverside County**

The California Regional Water Quality Control Board, Colorado River Basin Region, finds that:

1. Riverside County Service Area No. 62 (hereinafter also referred to as the discharger), 4080 Lemon Street, 12th floor, Riverside, California, 92501, verified via the plant operator on March 15, 1985, that the information contained in Finding No. 2 (below) is accurate.
2. The discharger is currently discharging a maximum average daily flow of 30,000 gallons-per-day into a sewage treatment facility designed for 150,000 gallons-per-day. Domestic sewage from residences in Ripley is discharged into two (2) mechanically aerated lined basins, which flow into two (2) lined settling basins followed by four percolation basins for final subsurface disposal. The percolation basins have a maximum operating depth of two feet. A tile underdrain system has been installed about eight (8) feet below the bottom of these basins, and any percolated effluent flows to Township Drain. This treatment facility is located in the SE $\frac{1}{4}$  of the SE $\frac{1}{4}$  of Section 34, T7S, R22E, SBB&M.
3. There are no domestic wells within 500 feet of the sewage treatment and disposal facilities described in Finding No. 2 (above).
4. The discharge of this sewage treatment system has been subject to waste discharge requirements adopted in Board Order No. 80-47.
5. The Water Quality Control Plan for the Colorado River Basin Region of California was adopted by the Regional Board on November 14, 1984. The Basin Plan contains water quality objectives for the Colorado Hydrologic Unit.
6. The beneficial uses of the ground waters of the Colorado Hydrologic Unit are:
  - a. Municipal supply
  - b. Industrial supply
  - c. Agricultural supply

However, shallow ground waters in the local area are saline due to crop irrigation, and eventually enter irrigation drains which flow to Colorado River.

*Superseded  
by  
90-063  
09-19-90*

7. The Board has notified the discharger and interested agencies and persons of its intent to update waste discharge requirements for the discharge.
8. The Board in a public meeting heard and considered all comments pertaining to the discharge.
9. The Riverside County Planning Department approved Environmental Impact Report SCH #78062051 (final approval date April 1, 1979) for this proposed facility. The Regional Board reviewed this EIR. The below waste discharge requirements are designed to assure against any significant adverse effects on water quality.

IT IS HEREBY ORDERED, the discharger shall comply with the following:

A. Specifications

1. Neither the treatment nor the discharge of wastewater shall create a pollution or a nuisance as defined in Division 7 of the California Water Code.
2. No wastewater other than domestic sewage shall be discharged at this location.
3. A minimum depth of freeboard of at least two (2) feet shall be maintained in the basins.
4. Treated or untreated sludge, or similar solid waste materials, shall be disposed only at locations approved by the Regional Board.
5. Adequate measures shall be taken to assure that unauthorized persons and animal pets are effectively excluded from contact with the discharge.
6. Adequate measures shall be taken to assure that flood or surface drainage waters do not erode or otherwise render portions of the discharge facilities inoperable.
7. There shall be no surface flow of sewage away from the discharge facilities.
8. Treatment and disposal by ponding shall be conducted in such manner that there shall be no stranded or exposed sewage solids.
9. Facilities shall be available to handle wastewater in the event of commercial power failure.
10. Treatment and discharge of wastewater shall be conducted by technical procedures which will maintain a surface aerobic environment.

11. Infiltration facilities shall be maintained and operated so as to maximize infiltration and minimize the increase in salinity of the wastewater discharge.

B. Provisions

1. Prior to any modifications in this facility which could result in material change in the quality or quantity of wastewater discharged, or any material change in location of discharge, the discharger shall report in writing to the Regional Board.
2. The discharger shall comply with the attached "Monitoring and Reporting Program No. 85-50", and future revisions thereto, as specified by the Executive Officer.
3. In the event of any change in control or ownership of land or waste disposal facilities described herein, the discharger shall:
  - a. Notify this Board of such change; and
  - b. Transmit a copy of this Order to the succeeding owner or operator, and file a copy of the transmittal letter with this Board.
4. This Order supersedes Board Order No. 80-47.

I, Arthur Swajian, Executive Officer, do hereby certify the foregoing is a full, true and correct copy of an Order adopted by the California Regional Water Quality Control Board, Colorado River Basin Region, on May 22, 1985.

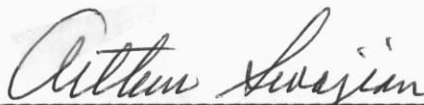
  
\_\_\_\_\_  
Executive Officer

**CALIFORNIA REGIONAL WATER QUALITY CONTROL BOARD  
COLORADO RIVER BASIN REGION**

MONITORING AND REPORTING PROGRAM NO. 87-50 (Revision No. 1)

FOR

CHAMPION MEAT PACKING COMPANY

South of El Centro - Imperial County

Location of Discharge: SE $\frac{1}{4}$ , NW $\frac{1}{4}$  of Section 30, T16S, R14E, SBB&M

EFFLUENT MONITORING

Wastewater contained in the oxidation basins shall be monitored for the following:

<u>Constituent</u>	<u>Unit</u>	<u>Type of Sample</u>	<u>Sampling Frequency</u>
Flow (Total Plant Washwater)	Gallons/day	Flow	Monthly
Basin Freeboard Depth	Feet	Measurement Below Berm	Monthly

WASTEWATER RECLAMATION

Any wastewater used to irrigate pasture land shall be monitored for settleable solids (in ml/l) prior to each discharge and reported monthly. A statement that there has been no discharge onto pasture land in lieu of discharge monitoring shall be noted on the monthly report.

REPORTING

Monthly monitoring reports shall be submitted to the Regional Board on a quarterly basis by January 15, April 15, July 15, and October 15 of each year.

Submit monitoring reports to:

California Regional Water Quality Control Board  
Colorado River Basin Region  
73-271 Highway 111, Suite 21  
Palm Desert, CA 92260

ORDERED BY:

  
Executive Officer

3/4/88  
Date

**CALIFORNIA REGIONAL WATER QUALITY CONTROL BOARD  
COLORADO RIVER BASIN REGION**

**MONITORING AND REPORTING PROGRAM NO. 85-50  
FOR**

**RIVERSIDE COUNTY SERVICE AREA NO. 62  
RIPLEY WASTEWATER TREATMENT FACILITY  
Ripley- Riverside County**

Discharge Location: SE $\frac{1}{4}$ , SE $\frac{1}{4}$  of Section 34, T7S, R22E, SBB&M

**EFFLUENT MONITORING**

Riverside County Service Area No. 62 shall report monitoring data to the Regional Board in accordance with the following:

1. Visual observations of the outlet of the underdrain system shall be made at least twice per week to determine if there is a flow to Township Drain. Observation dates and results shall be recorded. If a flow is noted, the quantity of discharge shall be estimated and recorded.
2. A sample for bacteriological analysis shall be taken at the first observance of flow from the underdrain system. Thereafter, a sample for bacteriological analysis shall be taken at least once per month when there is an observed flow.

**REPORTING**

Monitoring data shall be submitted to the Regional Board monthly - by the 15th day of the following month.

Mail reports to:

California Regional Water Quality Control Board  
Colorado River Basin Region  
73-271 Highway 111, Suite 21  
Palm Desert, CA 92260

ORDERED BY:

  
Executive Officer

May 22, 1985

Date

*Superseded  
by 87-50 (Rev. 1)  
3/4/88*

CALIFORNIA REGIONAL WATER QUALITY CONTROL BOARD -7

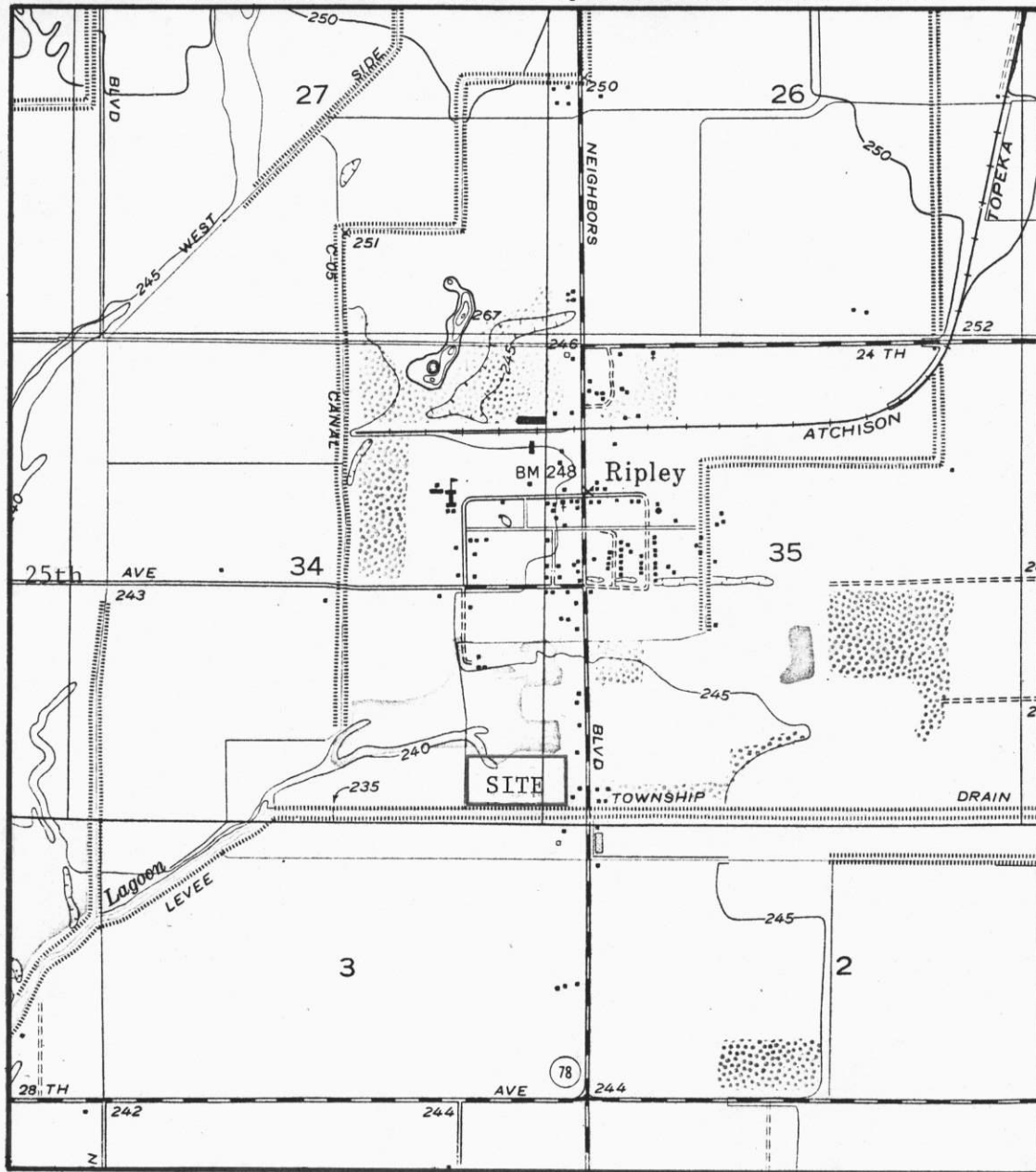

SITE MAP NO. 1

RIVERSIDE COUNTY SERVICE AREA NO. 62  
 RIPLEY WASTEWATER TREATMENT FACILITY  
 Ripley - Riverside County  
 Portion of the SE 1/4, SE 1/4 of Section 34, T7S, R22E, SBB&M  
 USGS Ripley 7.5 min. Topographic Map

Order No. 85-50

