

**CALIFORNIA REGIONAL WATER QUALITY CONTROL BOARD  
COLORADO RIVER BASIN REGION**

ORDER NO. 85-54

**WASTE DISCHARGE REQUIREMENTS  
FOR  
THE SANDS MOBILE COUNTRY CLUB  
Southeast of Desert Hot Springs - Riverside County**

The California Regional Water Quality Control Board, Colorado River Basin Region, finds that:

1. R.C. Roberts (hereinafter also referred to as the discharger), 801 A Street, San Rafael, California, 94901, verified, via the park manager, the below updated information on the discharge of waste on March 28, 1985.
2. The discharger is discharging a maximum of 60,000 gallons-per-day of domestic sewage from a mobile home park having 317 spaces, a laundromat and a clubhouse. The wastewater is discharged into septic tank/seepage pit disposal systems located in the W $\frac{1}{2}$  of the SE $\frac{1}{4}$  of Section 5, T3S, R5E, SBB&M. Laundry wastewater is discharged through a rock filter into a seepage pit.
3. The discharger is reserving areas of sufficient size for possible future 100 percent replacement of the seepage pit.
3. The discharger has been subject to waste discharge requirements contained in Board Order No. 78-22.
5. There are no domestic wells within 200 feet of the discharge facilities described in Findings No. 2 and 3 (above).
6. The discharger informs that wastewater from a swimming pool and two (2) hot pools is discharged onto landscape plantings.
7. The Water Quality Control Plan for the Colorado River Basin Region of California was adopted by the Regional Board on November 14, 1984. The Basin Plan contains water quality objectives for Coachella Hydrologic Subunit.
8. The beneficial uses of ground water of the Coachella Hydrologic Subunit are:
  - a. Municipal supply
  - b. Industrial supply
  - c. Agricultural supply

*rescinded by Bd ord#  
97-121 9/24/97 & replaced  
by 97-50036*

*Change of  
Ownership  
88-77  
5/12/88*

9. The Board has notified the discharger and interested agencies and persons of its intent to update waste discharge requirements for the discharge.
10. The Board in a public meeting heard and considered all comments pertaining to the discharge.
11. These waste discharge requirements govern an existing facility, which the discharger is currently operating, and therefore is exempt from the provisions of the California Environmental Quality Act in accordance with Section 15301 of Title 14, Chapter 3 of the California Administrative Code.

IT IS HEREBY ORDERED, the discharger shall comply with the following:

A. Discharge Specifications

1. Neither the treatment nor the discharge of wastewater shall create a pollution or a nuisance as defined in Division 7 of the California Water Code.
2. No wastewater other than domestic sewage and swimming and hot pool wastewater shall be discharged at this location.
3. Wastewater discharged subsurface shall be retained underground with no surfacing.
4. Adequate measures shall be taken to assure that flood or surface drainage waters do not erode or otherwise render portions of the discharge facilities inoperable.
5. Septic tank cleanings shall be discharged only by a duly authorized service.
6. Swimming pool and hot pool wastewater shall not be discharged into a sewage disposal system.

B. Provisions

1. Sufficient land area shall be reserved for possible future 100 percent replacement of the seepage pits, until such time as this park is connected to a municipal sewerage system.
2. Upon request from this Board's Executive Officer, the discharger shall furnish technical and/or monitoring reports on the treatment and discharge of wastes.
3. Prior to any modifications of this facility which would result in material change in the quality or quantity of wastewater discharged, or any material change in location of discharge, the discharger shall report in writing to the Regional Board.

4. Prior to any change of ownership of this mobile home park, the discharger shall:

- a. Specify as a condition of transfer that the area specified in Provision B.1. (above) remain servient to the park for the purpose of providing additional subsurface sewage disposal capacity, until such time as this park is connected to a municipal sewerage system.
- b. Transmit a copy of this Order to the succeeding owner or operator, and file a copy of the transmittal letter with this Board.

5. This Order supersedes Board Order No. 78-22.

I, Arthur Swajian, Executive Officer, do hereby certify the foregoing is a full, true and correct copy of an Order adopted by the California Regional Water Quality Control Board, Colorado River Basin Region, on May 22, 1985.

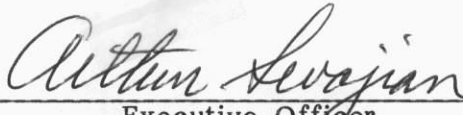
  
Executive Officer

CALIFORNIA REGIONAL WATER QUALITY CONTROL BOARD-7

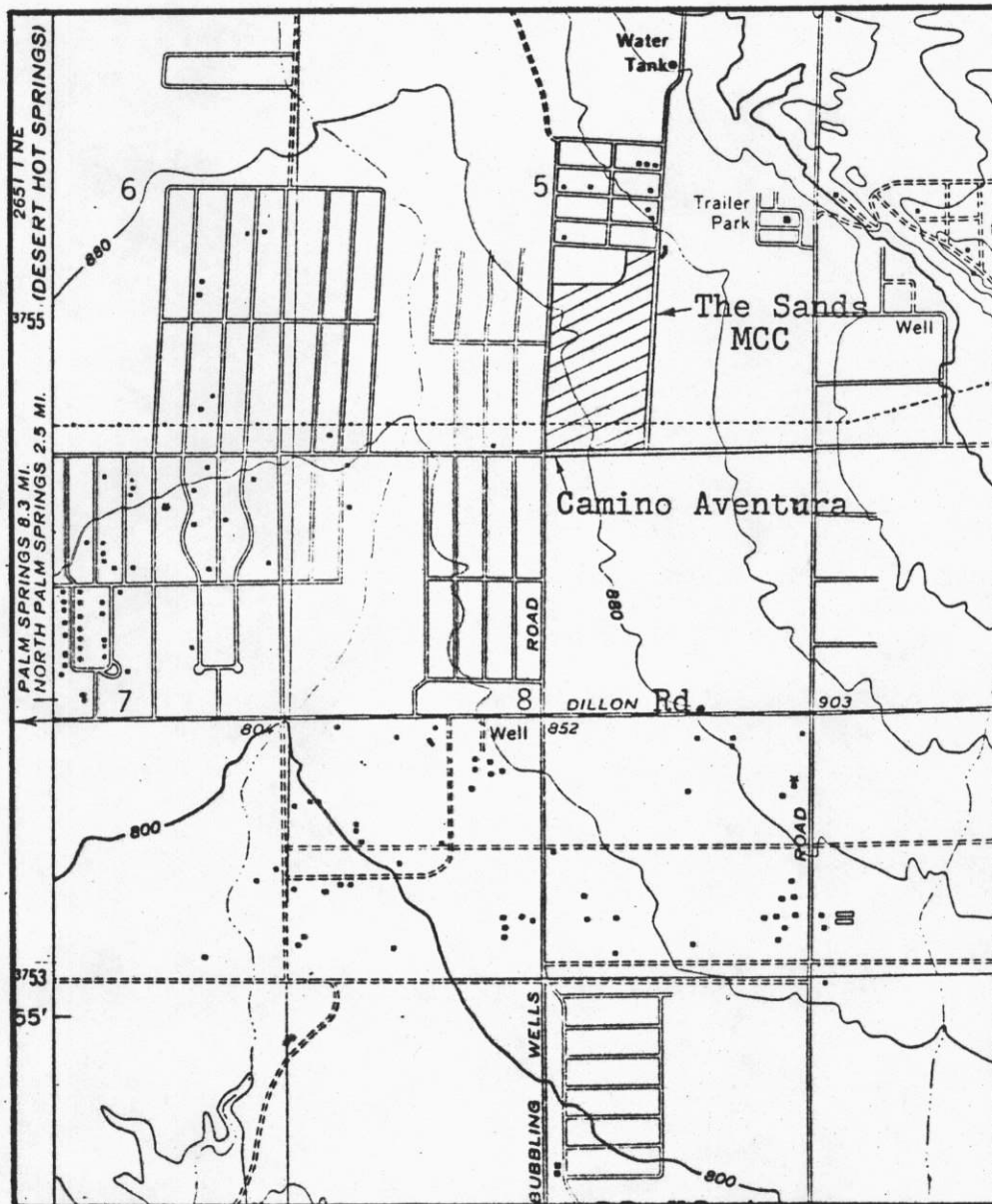

SITE MAP

THE SANDS MOBILE COUNTRY CLUB  
 Southeast of Desert Hot Springs - Riverside County  
 $W\frac{1}{2}$  of the  $SE\frac{1}{4}$  of Section 5, T3S, R5E, SBB&M  
 U.S.G.S. Seven Palms Valley 7.5 min. Topographic Map

Order No. 85-54