

**CALIFORNIA REGIONAL WATER QUALITY CONTROL BOARD
COLORADO RIVER BASIN REGION**

ORDER NO. 85-7

WASTE DISCHARGE REQUIREMENTS
FOR
COACHELLA VALLEY WATER DISTRICT
PALM DESERT COUNTRY CLUB
WATER RECLAMATION PLANT
Riverside County

The California Regional Water Quality Control Board, Colorado River Basin Region, finds that:

1. Coachella Valley Water District (hereinafter also referred to as the discharger), P. O. Box 1058, Coachella, California 92236, submitted updated information on the discharge of wastes from the Palm Desert Country Club Water Reclamation Plant on April 30, 1984.
2. The discharger presently discharges an annual average daily flow of 274,000 gpd and a peak month average daily flow of 312,000 gpd of wastewater from a 0.5 mgd activated sludge wastewater treatment plant to holding basins for storage and infiltration disposal. Since approximately 1966, the discharger and its predecessor have used the treated wastewater to irrigate a portion of the adjacent Palm Desert Country Club golf course; and the discharger desires to continue being allowed this method of discharge. The treatment facility, storage/infiltration basins, and wastewater reuse area are located in the SW $\frac{1}{4}$, Section 13, T5S, R6E, SBB&M.
3. The golf course irrigation has been subject to waste discharge requirements adopted in Resolution No. 68-16. The use of treated wastewater for irrigation was discontinued in June 1983. The discharger may decide to resume irrigation reuse in the future.
4. The Water Quality Control Plan for the Colorado River Basin Region of California was adopted by the Board on November 14, 1984. The Basin Plan contains water quality objectives for the Coachella Hydrologic Subunit.
5. The beneficial uses of the ground water of the Coachella Hydrologic Subunit are:
 - a. Municipal supply
 - b. Industrial supply
 - c. Agricultural supply
6. The Board has notified the discharger and interested agencies and persons of its intent to prescribe updated waste discharge requirements for this discharge.
7. The Board in a public meeting heard and considered all comments pertaining to the discharge.

8. This wastewater treatment and disposal facility constitutes an ongoing project in accordance with provisions of the California Environmental Quality Act (Public Resources Code Section 21000 et. seq.) and the state guidelines because the governmental approvals on or after April 5, 1973, do not involve a greater degree of responsibility or control over such activity than the governmental approvals received prior to that date.

IT IS HEREBY ORDERED, the discharger shall comply with the following:

A. Discharge Specifications

1. Representative samples of wastewater effluent discharged to holding and infiltration basins, or utilized for landscape irrigation, shall not contain constituents in excess of the following limits:

Constituent	Units	30-Day Arithmetic Mean Discharge Rate	7-Day Arithmetic Mean Discharge Rate
20°C BOD ₅	mg/l	30	45
Suspended Solids	mg/l	30	45
Settleable Matter	ml/l	0.3	0.5

2. Reclaimed water used for the irrigation of golf courses, cemeteries, freeway landscapes, and landscapes in other areas where the public has similar access or exposure shall be at all times an adequately disinfected, oxidized wastewater. The wastewater shall be considered adequately disinfected if the median number of coliform organisms in the effluent does not exceed 23 per 100 milliliters, as determined from the bacteriological results of the last 7 days for which analyses have been completed, and the number of coliform organisms does not exceed 240 per 100 milliliters in any two consecutive samples.
3. Reclaimed water shall not be discharged onto, or allowed to flow onto properties of adjacent residences.
4. Sewage sludge shall not be discharged to any natural or artificial channel.
5. A freeboard depth of at least two feet shall be maintained in each infiltration basin and holding pond.

B. Provisions

1. The treatment and discharge of wastes shall not cause a pollution or a nuisance as defined in Sections 13050 (l) and 13050 (m) of the California Water Code.
2. The discharger shall not deliver reclaimed wastewater to any user who, by reason of the user's operating practices, causes nuisances associated with the wastewater or otherwise contributes to the violation of the requirements of this Order.

3. Adequate protective works shall be provided to assure that a flood which would be expected to occur on a frequency of once in a 100-year period would not erode or otherwise render portions of the treatment and discharge facilities inoperable.
4. At least 30 days prior to the resumption of irrigation of the golf course with reclaimed water, the discharger shall monument the private property boundaries adjacent the reuse areas to allow determination of compliance with Discharge Specification A.3. (above).
5. Coachella Valley Water District shall assure that written notification of the use of reclaimed wastewater is provided annually to people who reside adjacent to irrigation reuse areas. The content of the notice and method of delivery shall be approved by the Executive Officer. A sign notifying the public of the use of reclaimed wastewater shall be posted at a conspicuous location on the golf course as approved by the Executive Officer. Notification of the public shall commence at least 30 days prior to resumption of golf course irrigation.
6. The discharger's wastewater treatment plant shall be supervised and operated by persons possessing certificates of appropriate grade pursuant to Chapter 4, Subchapter 14, Title 23, California Administrative Code, and who are otherwise capable of adequately maintaining and operating the wastewater treatment and disposal facilities.
7. Prior to any substantial changes in the quality of wastewater being discharged to this facility, the acceptance of additional commercial or industrial wastes, or modification of treatment methods which would result in material change in the quality or quantity of wastewater discharged, or any material change in the location of the discharge, the discharger shall report thereon to this Board.
8. Facilities shall be available to keep the plant in operation in the event of commercial power failure.
9. The discharger shall comply with "Monitoring and Reporting Program No. 85-7", and future revisions thereto, as specified by the Executive Officer.
10. This Order supersedes Board Resolution No. 68-16.

I, Arthur Swajian, Executive Officer, do hereby certify the foregoing is a full, true, and correct copy of an Order adopted by the California Regional Water Quality Control Board, Colorado River Basin Region, on January 23, 1985.



Executive Officer

**CALIFORNIA REGIONAL WATER QUALITY CONTROL BOARD
COLORADO RIVER BASIN REGION**

MONITORING AND REPORTING PROGRAM NO. 85-7
FOR
COACHELLA VALLEY WATER DISTRICT
PALM DESERT COUNTRY CLUB
WATER RECLAMATION PLANT
Riverside County

Location of Treatment Facility: SW $\frac{1}{4}$, Section 13, T5S, R6E, SBB&M

EFFLUENT MONITORING

Wastewater discharged from the treatment plant shall be monitored for the following:

Constituents	Unit	Type of Sample	Sampling Frequency
20°C BOD ₅	mg/l	24-Hr. Composite	Weekly
Suspended Solids	mg/l	24-Hr. Composite	Weekly
Settleable Matter	ml/l	Grab at Peak Flow	Weekly
Chlorine Residual	mg/l	Grab at Peak Flow	Daily ¹
Flow (Total Plant Effluent)	MGD	Flow Measurement	Daily ²

Wastewater contained in the first holding basin shall be monitored for the following:

Total Dissolved Solids	mg/l	Grab	Quarterly
------------------------	------	------	-----------

-
1. Required only when wastewater is to be utilized for golf course irrigation.
 2. Reported for each day with average monthly flow calculated.

WATER RECLAMATION

Wastewater delivered for golf course irrigation shall be monitored for coliform organisms. Samples shall be taken when wastewater flow and characteristics are most demanding on the treatment facilities and disinfection procedures. The sample may be taken at any point in the treatment process.

<u>Item</u>	<u>Unit</u>	<u>Type of Sample</u>	<u>Sampling Frequency</u>
Coliform Organisms	MPN/100 ml	Grab	Daily ³

SEWAGE SLUDGE

Coachella Valley Water District shall report quarterly on the quantity, method and location of sewage sludge discharged.

REPORTING

Monitoring data shall be submitted to the Regional Board as follows:

Quarterly reports - by January 15, April 15, July 15 and October 15 of each year.

Daily and Weekly data - reported monthly by the 15th day of the following month.

The discharger shall implement the above monitoring program within 30 days of the effective date of this Order.

Forward monitoring reports to:

California Regional Water Quality Control Board
Colorado River Basin Region
73-271 Highway 111, Suite 21
Palm Desert, CA 92260

ORDERED BY:

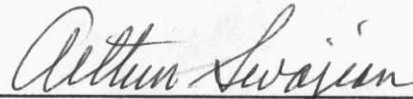

Executive Officer

January 23, 1985

Date

3. Report individual test results and the medians of the last seven (7) analyses.

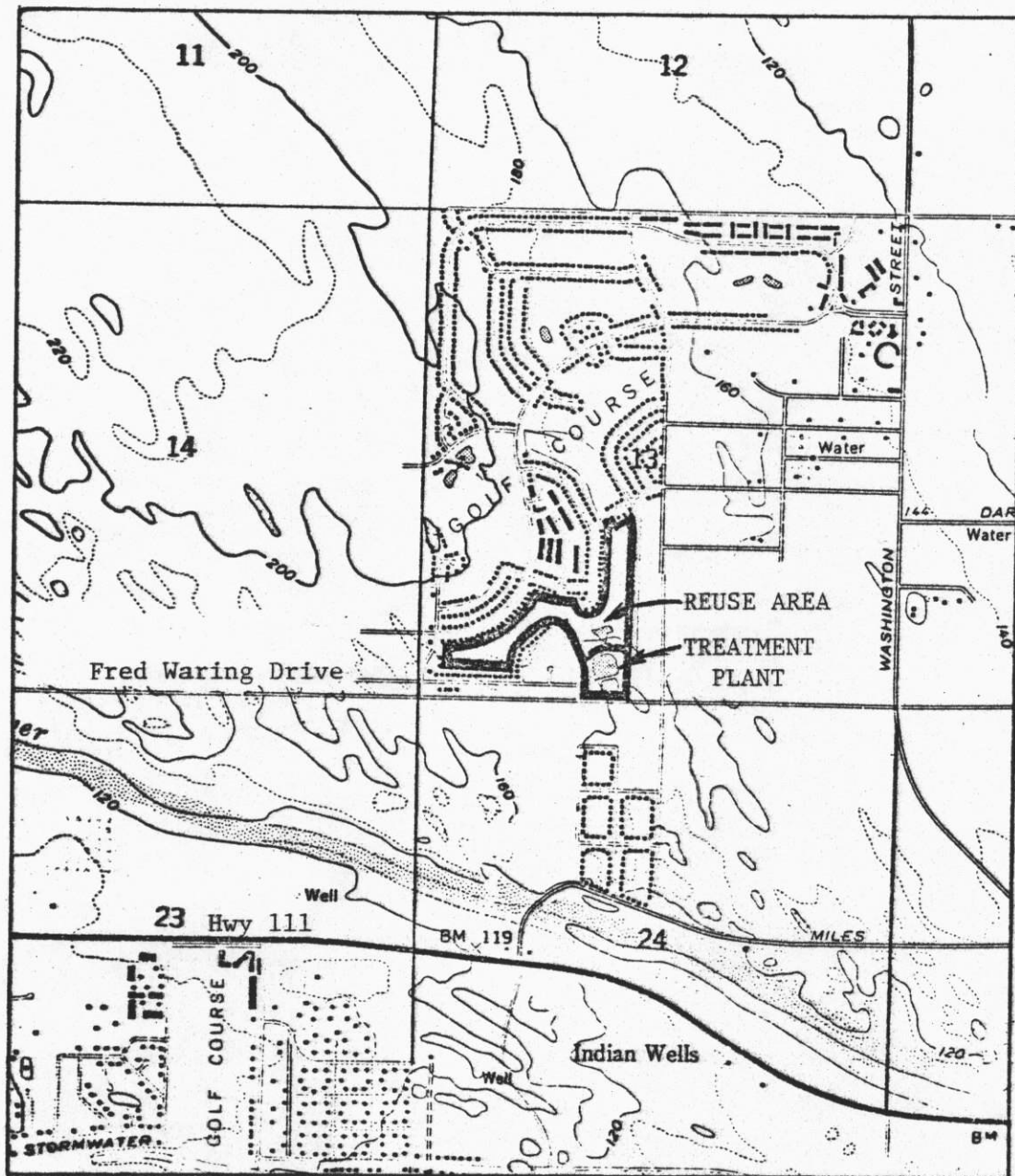
CALIFORNIA REGIONAL WATER QUALITY CONTROL BOARD - 7



SITE MAP

COACHELLA VALLEY WATER DISTRICT
 PALM DESERT COUNTRY CLUB
 WATER RECLAMATION PLANT
 Riverside County
 SW $\frac{1}{4}$, Section 13, T5S, R6E, SBB&M
 USGS La Quinta 7.5 min. Topographic Map

Order No. 85-7