

**CALIFORNIA REGIONAL WATER QUALITY CONTROL BOARD
COLORADO RIVER BASIN REGION**

ORDER NO. 85-73

**WASTE DISCHARGE REQUIREMENTS
FOR
QUAIL SPRINGS APARTMENTS
Joshua Tree - San Bernardino County**

The California Regional Water Quality Control Board, Colorado River Basin Region, finds that:

1. Selby Construction (hereinafter also referred to as the discharger), 4670 Nebo Drive, Suite A, La Mesa, California, 92041, submitted a Report of Waste Discharge, dated April 25, 1985.
2. The discharger proposes to discharge a maximum of 20,000 gallons-per-day of domestic sewage from an apartment complex designed to have a total of 75 apartments, two (2) laundry rooms and a recreation building. Wastewater would be discharged into septic tank/seepage pit disposal systems, to be located in the NW $\frac{1}{4}$ of the SE $\frac{1}{4}$ of Section 25, T1N, R6E, SBB&M.
3. The discharger is reserving areas of sufficient size for possible future 100 percent replacement of the seepage pits.
4. There are no domestic wells within 200 feet of the proposed discharge facilities described in Findings No. 2 and 3 (above).
5. Wastewater from a swimming pool and a hot pool would be periodically discharged onto landscape plantings.
6. The Water Quality Control Plan for the Colorado River Basin Region of California was adopted by the Regional Board on November 14, 1984. The Basin Plan contains water quality objectives for the Joshua Tree Hydrologic Unit.
7. The beneficial uses of ground water of the Joshua Tree Hydrologic Unit are:
 - a. Municipal supply
 - b. Industrial supply
8. The Board has notified the discharger and interested agencies and persons of its intent to prescribe waste discharge requirements for the proposed discharge.
9. The Board in a public meeting heard and considered all comments pertaining to the proposed discharge.

*rescinded by
Bd ord # 97-121 9/24/97
& replaced by
97-50020*

10. The San Bernardino County Planning Department has approved Negative Declaration No. DO 621-062 (approval date November 5, 1984) for this proposed complex. The Regional Board has reviewed this Negative Declaration. The below waste discharge requirements are designed to assure against any significant adverse effects on water quality.

IT IS HEREBY ORDERED, the discharger shall comply with the following:

A. Discharge Specifications

1. Neither the treatment nor the discharge of wastewater shall create a pollution or a nuisance as defined in Division 7 of the California Water Code.
2. No wastewater other than domestic sewage and swimming pool and hot pool wastewater shall be discharged at this location.
3. Wastewater discharged subsurface shall be retained underground with no surfacing.
4. Adequate measures shall be taken to assure that flood or surface drainage waters do not erode or otherwise render portions of the discharge facilities inoperable.
5. Septic tank cleanings shall be discharged only by a duly authorized service.
6. Swimming pool and hot pool wastewater shall not be discharged into a sewage disposal system.

B. Provisions

1. Sufficient land area shall be reserved for possible future 100 percent replacement of the seepage pits, until such time as this complex is connected to a municipal sewerage system.
2. Upon request from this Board's Executive Officer, the discharger shall furnish technical and/or monitoring reports on the treatment and discharge of wastes.
3. Prior to any modifications in this facility which would result in material change in the quality or quantity of wastewater discharged, or any material change in location of discharge, the discharger shall report in writing to the Regional Board.
4. Prior to any change of ownership of this apartment complex, the discharger shall:

- a. Specify as a condition of transfer that the area specified in Provision B.1 (above) remain servient to the development for the purpose of providing additional subsurface sewage disposal capacity, until such time as this complex is connected to a municipal sewerage system.
- b. Transmit a copy of this Order to the succeeding owner or operator, and file a copy of the transmittal letter with this Board.

I, Arthur Swajian, Executive Officer, do hereby certify the foregoing is a full, true and correct copy of an Order adopted by the California Regional Water Quality Control Board, Colorado River Basin Region, on August 7, 1985.

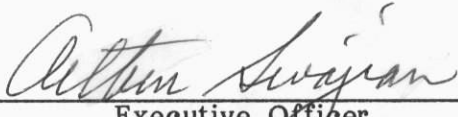

Executive Officer

**CALIFORNIA REGIONAL WATER QUALITY CONTROL BOARD
COLORADO RIVER BASIN REGION**

**MONITORING AND REPORTING PROGRAM NO. 85-73
FOR
QUAIL SPRINGS APARTMENTS
Joshua Tree - San Bernardino County**

Location: Portion of the NW $\frac{1}{4}$ of the SE $\frac{1}{4}$ of Section 25, T1N, R6E, SBB&M

MONITORING

This discharger shall submit an annual status report on the following:

1. Number of apartments and laundry rooms presently connected to the sewerage system.
2. List any proposed changes in the sewage disposal facilities during the upcoming year.

REPORTING

1. Annual reports are to be submitted by January 15th of each year to:

California Regional Water Quality Control Board
Colorado River Basin Region
73-271 Highway 111, Suite 21
Palm Desert, CA 92260

2. Report immediately any surfacing of wastewater or other failures of the system by telephone and follow-up by letter.

Ordered By:

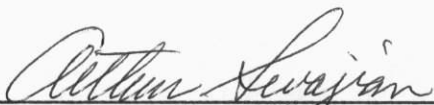
Executive Officer

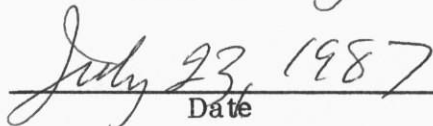
Date

CALIFORNIA REGIONAL WATER QUALITY CONTROL BOARD -7

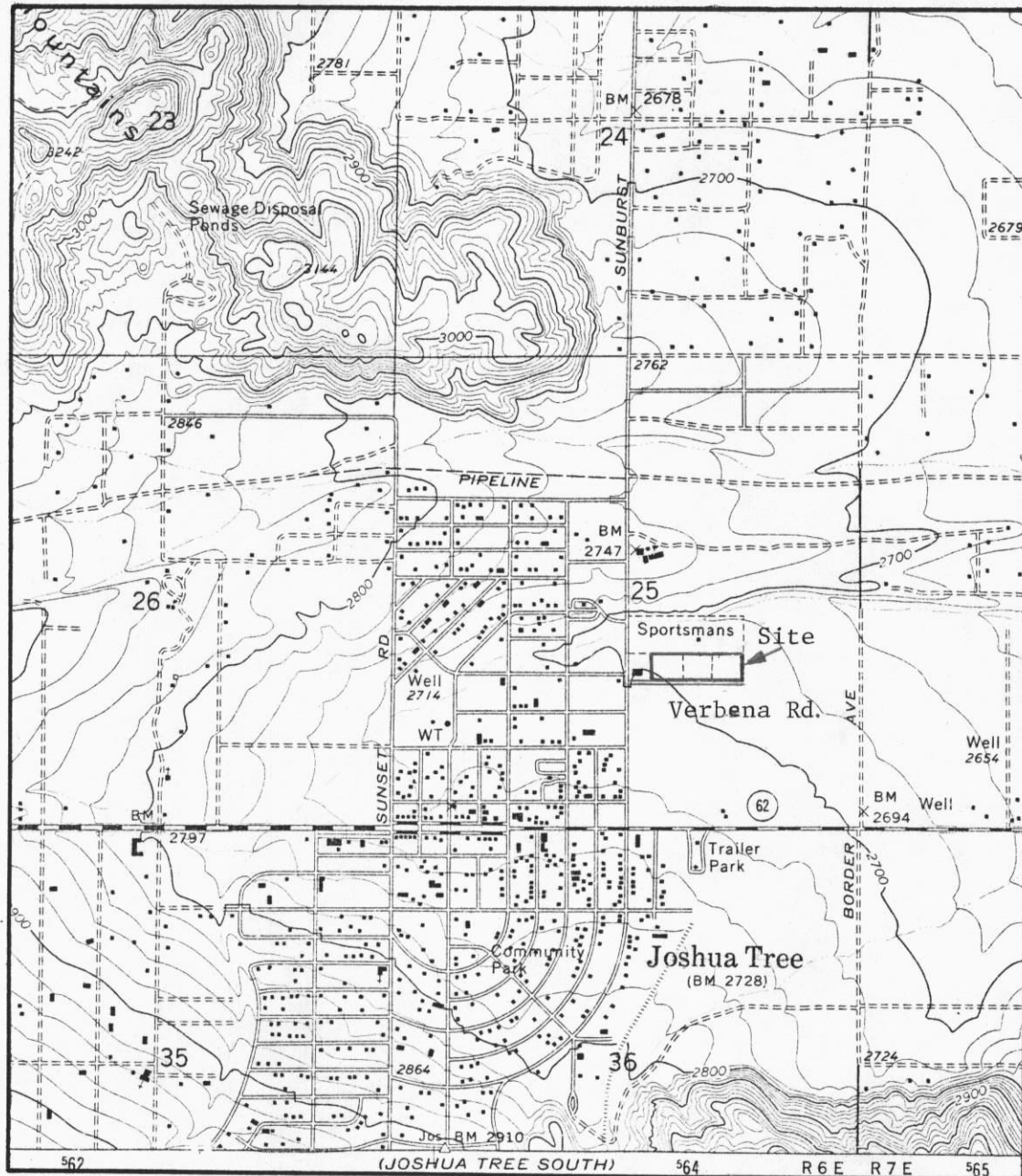

Scale:
1"=2,000'

SITE MAP

QUAIL SPRINGS VILLAGE APARTMENTS
Joshua Tree - San Bernardino County
Portion of the NW $\frac{1}{4}$, SE $\frac{1}{4}$ of Section 25, T1N, R6E, SBB&M
USGS Joshua Tree North 7.5 min. Topographic Map

Order No. 85-73

CALIFORNIA REGIONAL WATER QUALITY CONTROL BOARD - 7

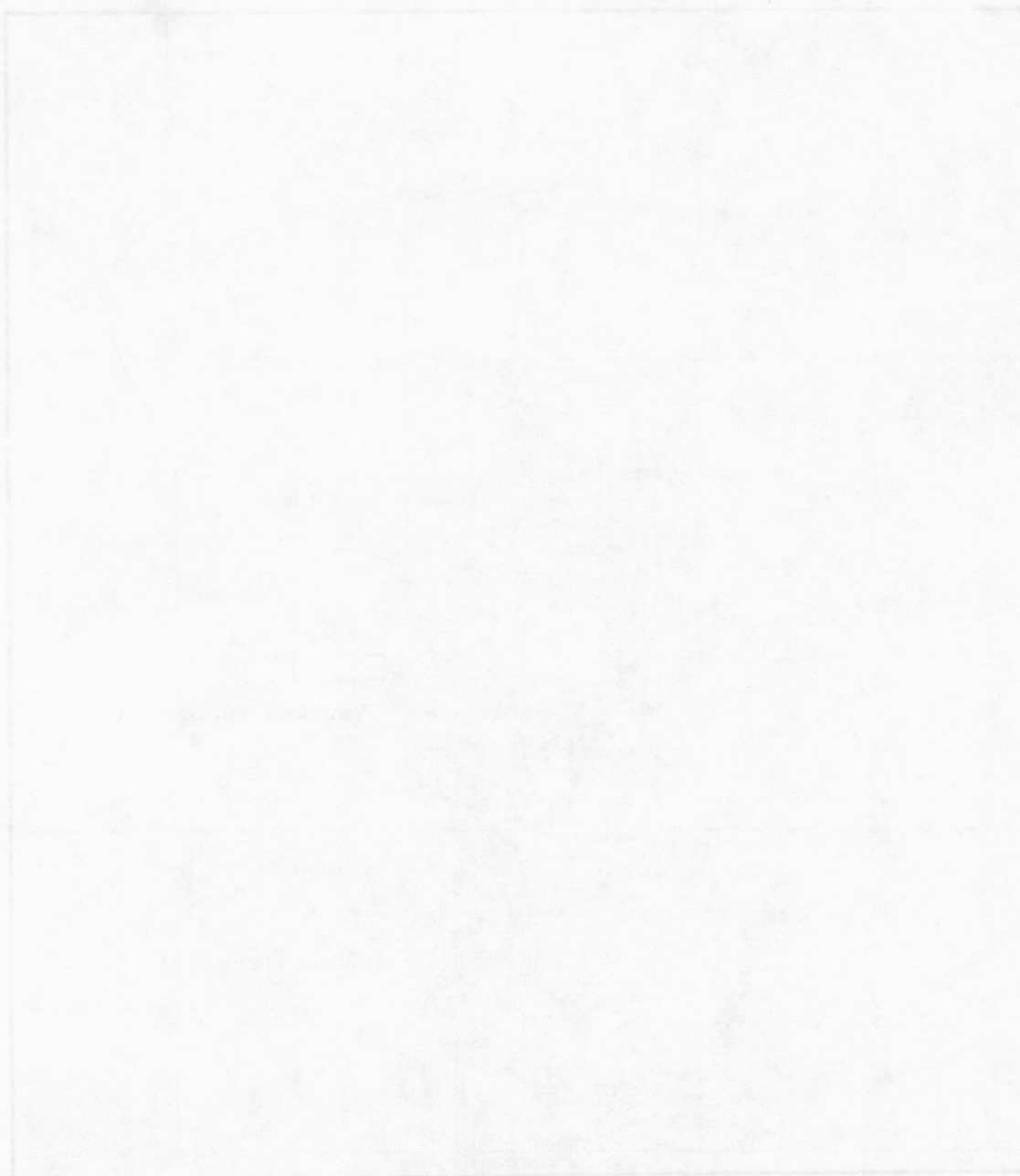

SITE MAP

QUANT SPRINGS VILLAGE APARTMENT
 Joshua Tree - San Bernardino County
 Portion of the N44, S24 of Section 35, T14, R08, S08W
 USGS Joshua Tree North 7.5 min. Topographic Map