

**CALIFORNIA REGIONAL WATER QUALITY CONTROL BOARD
COLORADO RIVER BASIN REGION**

ORDER NO. 85-85

**WASTE DISCHARGE REQUIREMENTS
FOR
THOUSAND TRAILS RECREATIONAL VEHICLE PARK
Northwest of Bermuda Dunes - Riverside County**

The California Regional Water Quality Control Board, Colorado River Basin Region, finds that:

1. Thousand Trails Inc., (hereinafter also referred to as the discharger), 7825 Engineer Road, Suite 201, San Diego, California, 92111, submitted updated information on the discharge of waste from this park, dated June 17, 1985.
2. The discharger is discharging a maximum of 21,000 gallons-per-day of domestic sewage from a recreational vehicle park having 140 RV spaces, 2 (two) restrooms, a recreation building and a laundry room. The wastewater is discharged into septic tank/seepage pit disposal systems situated throughout the park, which is located in the NW $\frac{1}{4}$ of the SE $\frac{1}{4}$ of Section 1, T5S, R6E, SBB&M.
3. The discharger is reserving areas of sufficient size for possible future 100 percent replacement of the seepage pits.
4. The discharge has been subject to waste discharge requirements contained in Board Order No. 79-29. All phases constructed since the facilities designated in Order No. 79-29 were installed, have been connected to the Coachella Valley Water District sewer line next to the park.
5. There are no domestic wells within 200 feet of the discharge facilities described in Findings No. 2 and 3 (above).
6. The Water Quality Control Plan for the Colorado River Basin Region of California was adopted by the Regional Board on November 14, 1984. The Basin Plan contains water quality objectives for Coachella Hydrologic Subunit.
7. The beneficial uses of ground water of the Coachella Hydrologic Subunit are:
 - a. Municipal supply
 - b. Industrial supply
 - c. Agricultural supply
8. The Board has notified the discharger and interested agencies and persons of its intent to update waste discharge requirements for the discharge.

01-16-91
Rescinded
per Board
order # 91-011

9. The Board in a public meeting heard and considered all comments pertaining to the discharge.
10. These waste discharge requirements govern an existing facility, which the discharger is currently operating, and therefore is exempt from the provisions of the California Environmental Quality Act in accordance with Section 15301 of Title 14, Chapter 3 of the California Administrative Code.

IT IS HEREBY ORDERED, the discharger shall comply with the following:

A. Discharge Specifications

1. Neither the treatment nor the discharge of wastewater shall create a pollution or a nuisance as defined in Division 7 of the California Water Code.
2. No wastewater other than domestic sewage and swimming and hot pool wastewater shall be discharged at this location.
3. Wastewater discharged subsurface shall be retained underground with no surfacing.
4. Adequate measures shall be taken to assure that flood or surface drainage waters do not erode or otherwise render portions of the discharge facilities inoperable.
5. Septic tank cleanings shall be discharged only by a duly authorized service.
6. Swimming pool and hot pool wastewater shall not be discharged into a sewage disposal system.

B. Provisions

1. Sufficient land area shall be reserved for possible future 100 percent replacement of the seepage pits, until such time as this park is connected to a municipal sewerage system.
2. Upon request from this Board's Executive Officer, the discharger shall furnish technical and/or monitoring reports on the treatment and discharge of waste.
3. Prior to any modifications of this facility which would result in material change in the quality or quantity of wastewater discharged, or any material change in location of discharge, the discharger shall report in writing to the Regional Board.
4. Prior to any change of ownership of this recreational vehicle park, the discharger shall:
 - a. Specify as a condition of transfer that the area specified in Provision B.1 (above) remain servient to the park for the purpose

9. The Board in a public meeting heard and considered all comments pertaining to the discharge.

10. These waste discharge requirements govern an existing facility, which the discharger is currently operating, and therefore is exempt from the provisions of the California Environmental Quality Act in accordance with Section 15301 of Title 14, Chapter 3 of the California Administrative Code.

IT IS HEREBY ORDERED, the discharger shall comply with the following:

A. Discharge Specifications

1. Neither the treatment nor the discharge of wastewater shall create a pollution or a nuisance as defined in Division 7 of the California Water Code.

2. No wastewater other than domestic sewage and swimming and hot pool wastewater shall be discharged at this location.

3. Wastewater discharged subsurface shall be retained underground with no surfacing.

4. Adequate measures shall be taken to assure that flood or surface drainage waters do not erode or otherwise render portions of the discharge facilities inoperable.

5. Septic tank cleanings shall be discharged only by a duly authorized service.

6. Swimming pool and hot pool wastewater shall not be discharged into a sewage disposal system.

B. Provisions

1. Sufficient land area shall be reserved for possible future 100 percent replacement of the seepage pits, until such time as this park is connected to a municipal sewerage system.

2. Upon request from this Board's Executive Officer, the discharger shall furnish technical and/or monitoring reports on the treatment and discharge of waste.

3. Prior to any modifications of this facility which would result in material change in the quality or quantity of wastewater discharged, or any material change in location of discharge, the discharger shall report in writing to the Regional Board.

4. Prior to any change of ownership of this recreational vehicle park, the discharger shall:

a. Specify as a condition of transfer that the area specified in Provision B.1 (above) remain servient to the park for the purpose

of providing additional subsurface sewage disposal capacity, until such time as this park is connected to a municipal sewerage system.

- b. Transmit a copy of this Order to the succeeding owner or operator, and file a copy of the transmittal letter with this Board.

5. This Order supersedes Board Order No. 79-29.

I, Arthur Swajian, Executive Officer, do hereby certify the foregoing is a full, true and correct copy of an Order adopted by the California Regional Water Quality Control Board, Colorado River Basin Region on October 2, 1985.

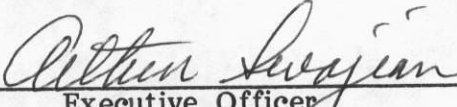
Executive Officer

**CALIFORNIA REGIONAL WATER QUALITY CONTROL BOARD
COLORADO RIVER BASIN REGION**

**MONITORING AND REPORTING PROGRAM NO. 85-85
FOR
THOUSAND TRAILS RECREATIONAL VEHICLE PARK
Northeast of Bermuda Dunes - Riverside County**

Location: Portion of the NW $\frac{1}{4}$ of the SE $\frac{1}{4}$ of Section 1, T5S, R6E, SBB&M

MONITORING

This discharger shall submit an annual status report on the following:

1. Number of spaces presently connected to the sewerage system.
2. List any proposed changes in the sewage disposal facilities during the upcoming year.

REPORTING

1. Annual reports are to be submitted by January 15th of each year to:

California Regional Water Quality Control Board
Colorado River Basin Region
73-271 Highway 111, Suite 21
Palm Desert, CA 92260

2. Immediate reporting of any surfacing of wastewater or other failures of the system by telephone and follow-up by letter.

Ordered By:

Arthur Levajian
Executive Officer

July 15, 1987
Date

CALIFORNIA REGIONAL WATER QUALITY CONTROL BOARD -7

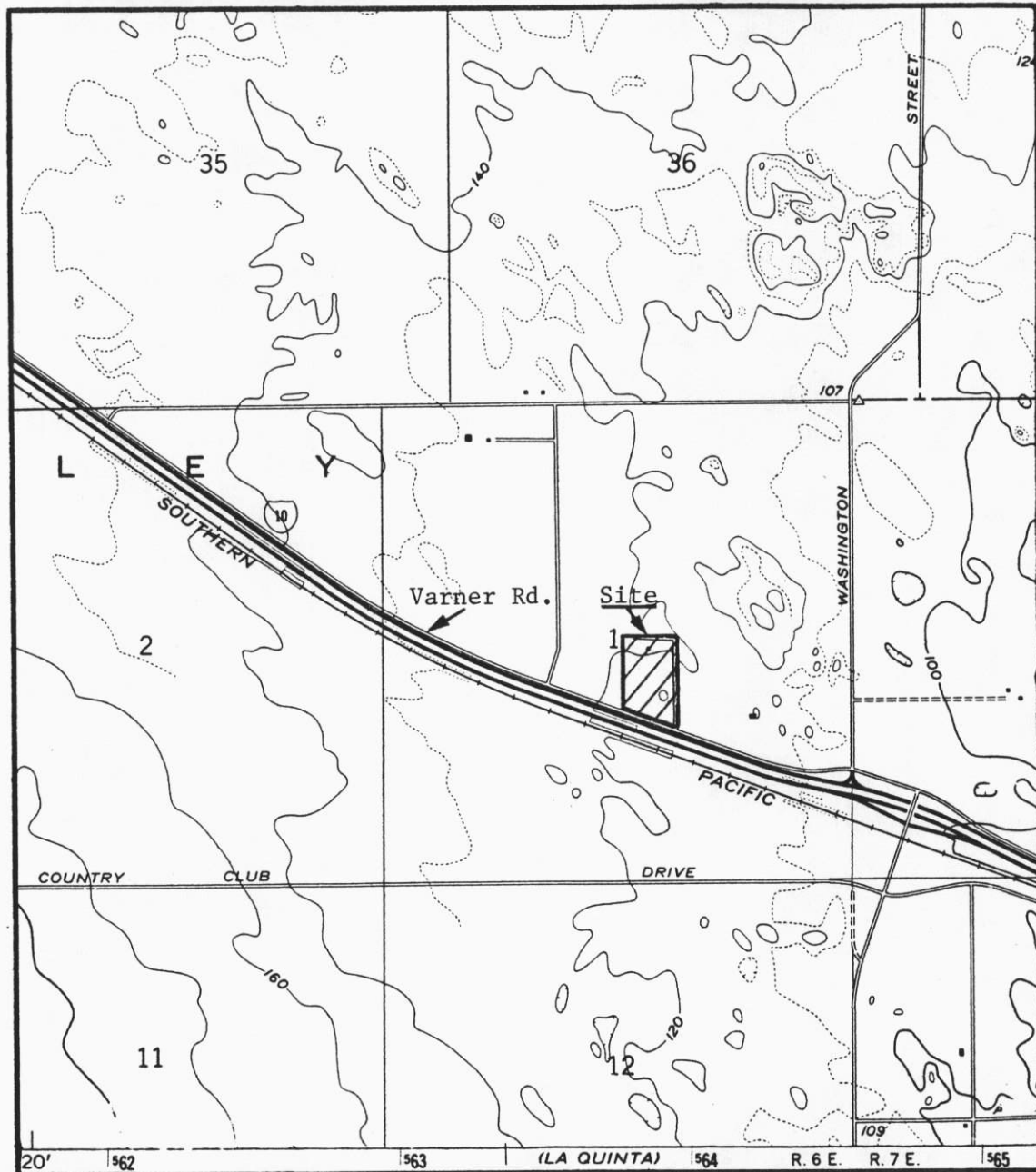

Scale:
1"=2,000'

SITE MAP

THOUSAND TRAILS RECREATIONAL VEHICLE PARK
 Northwest of Bermuda Dunes - Riverside County
 Portion of the NW $\frac{1}{4}$, SE $\frac{1}{4}$ of Section 1, T5S, R6E, SBB&M
 USGS Myoma 7.5 min. Topographic Map

Order No. 85-85

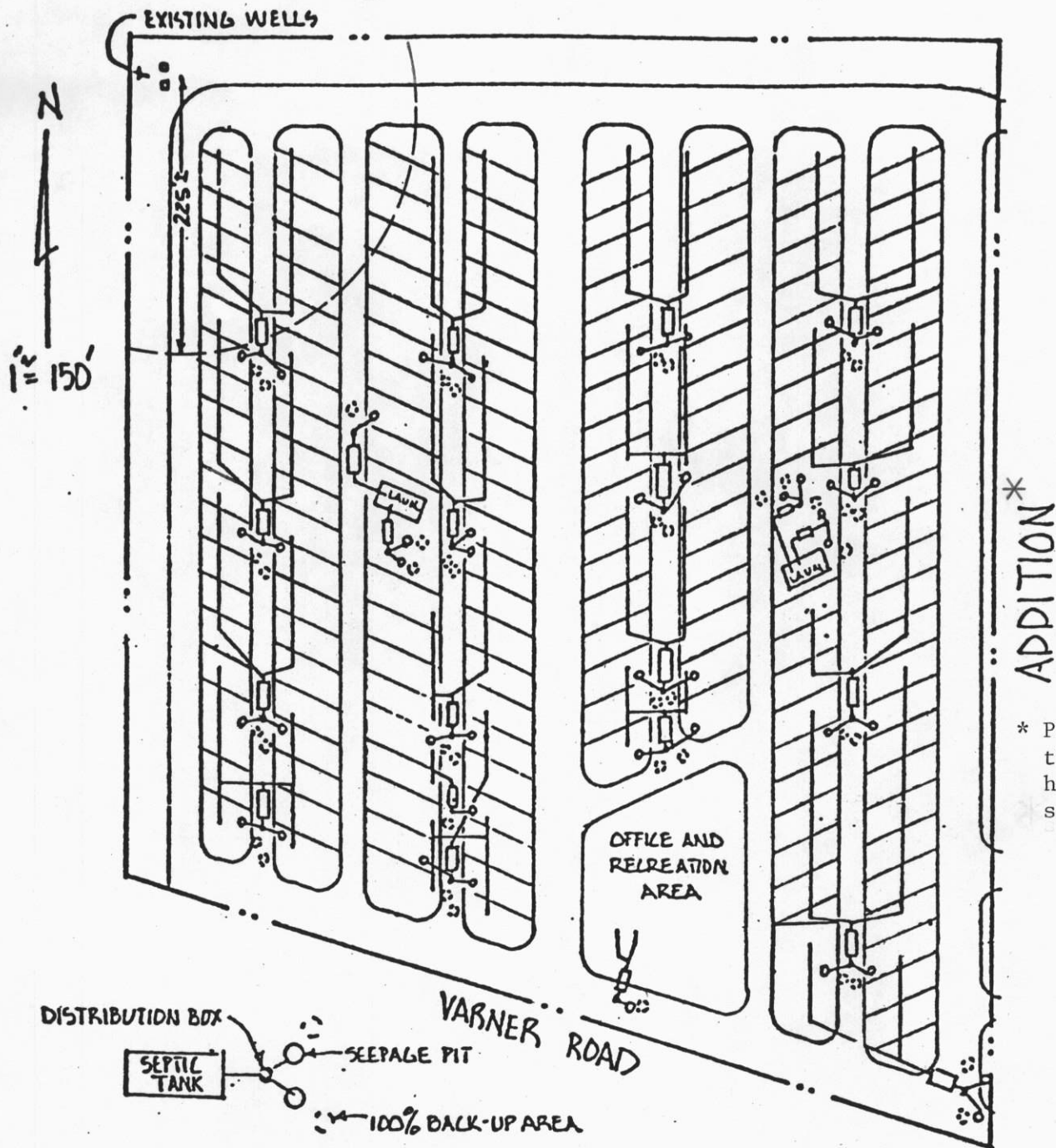

* Please note:
the addition
has been
sewered

TYPICAL SYSTEM

NOTE! LOCATIONS SHOWN HEREON ARE APPROXIMATE. SYSTEM DESIGN AND LOCATION TAKEN FROM CONSTRUCTION PLANS OF INDIO TRAVEL AIR PARK, DATED JULY 12, 1971.

SEWAGE DISPOSAL FACILITIES SKETCH

THOUSAND TRAILS RECREATIONAL VEHICLE PARK
Northwest of Bermuda Dunes - Riverside County