

**CALIFORNIA REGIONAL WATER QUALITY CONTROL BOARD  
COLORADO RIVER BASIN REGION**

**ORDER NO. 87-4**

**WASTE DISCHARGE REQUIREMENTS  
FOR  
MESA RANCH MOBILEHOME PARK  
Blythe - Riverside County**

The California Regional Water Quality Control Board, Colorado River Basin Region, finds that:

1. Mesa Ranch, Inc. (hereinafter also referred to as the discharger), P.O. Box 488, Ripley, California, 92272, submitted a letter dated August 4, 1986, verifying that the below information is still accurate.
2. The discharger is discharging a maximum of 8,000 gallons-per-day of domestic sewage from a mobile home park having 40 mobile home spaces and a laundry room. An additional 57 mobile home spaces are proposed, which would produce a total maximum discharge of 19,000 gallons-per-day. Wastewater is discharged into septic tank/seepage pit disposal systems located in the NW $\frac{1}{4}$  of Section 12, T6S, R22E, SBB&M.
3. The discharger is reserving areas of sufficient size for possible future 100 percent replacement of the seepage pits.
4. There are no domestic wells within 200 feet of the discharge facilities described in Findings No. 2 and 3 (above).
5. The discharger states that wastewater from a swimming pool and a hot pool is periodically discharged onto landscape plantings.
6. The discharge from this mobile home park has been subject to waste discharge requirements adopted in Board Order No. 81-45.
7. The Water Quality Control Plan for the Colorado River Basin Region of California was adopted by the Regional Board on November 14, 1984.
8. The Basin Plan delineates the location of discharge to be in the Colorado Hydrologic Unit, which has the following beneficial uses of ground water:
  - a. Municipal supply
  - b. Industrial supply
  - c. Agricultural supply
9. The Board has notified the discharger and interested agencies and persons of its intent to update waste discharge requirements for the discharge.

6-25-97  
Rescinded #97-075 &  
placed under general order  
#97-500.

10. The Board in a public meeting heard and considered all comments pertaining to the discharge.
11. The Riverside County Planning Department has approved Negative Declaration EA No. 14938 (filing date June 25, 1981) for the proposed expansion. The Regional Board has reviewed this Negative Declaration. The below waste discharge requirements are designed to assure against any significant adverse effects on water quality.

IT IS HEREBY ORDERED, the discharger shall comply with the following:

1. Neither the treatment nor the discharge of wastewater shall create a pollution or a nuisance as defined in Division 7 of the California Water Code.
2. No wastewater other than domestic sewage and swimming pool wastewater shall be discharged at this location.
3. Wastewater discharged subsurface shall be retained underground with no surfacing.
4. Adequate measures shall be taken to assure that flood or surface drainage waters do not erode or otherwise render portions of the discharge facilities inoperable.
5. Septic tank cleanings shall be discharged only by a duly authorized service.
6. Swimming pool wastewater shall not be discharged into a sewage disposal system.

B. Provisions

1. Sufficient land area shall be reserved for possible future 100 percent replacement of the seepage pits, until such time as this park is connected to a municipal sewerage system.
2. The discharger shall comply with the attached "Monitoring and Reporting Program No. 87-4", and future revisions thereto, as specified by the Executive Officer.
3. Prior to any modification in this facility which would result in material change in the quality or quantity of wastewater discharged, or any material change in location of discharge, the discharger shall report in writing to the Regional Board.
4. Prior to any change of ownership of this mobile home park, the discharger shall:

- a. Specify as a condition of transfer that the area specified in Provision B.1 (above) remain servient to the park for the purpose of providing additional subsurface sewage disposal capacity, until such time as this park is connected to a municipal sewerage system.
- b. Transmit a copy of this Order to the succeeding owner or operator, and file a copy of the transmittal letter with this Board.

5. This Order supersedes Order No. 81-45.

I, Arthur Swajian, Executive Officer, do hereby certify the foregoing is a full, true and correct copy of an Order adopted by the California Regional Water Quality Control Board, Colorado River Basin Region, on January 21, 1987.

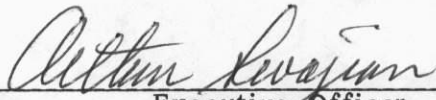
  
\_\_\_\_\_  
Executive Officer

**CALIFORNIA REGIONAL WATER QUALITY CONTROL BOARD  
COLORADO RIVER BASIN REGION**

**MONITORING AND REPORTING PROGRAM NO. 87-4  
FOR  
MESA RANCH MOBILE HOME PARK  
Blythe - Riverside County**

Location: Portion of the NW $\frac{1}{4}$  of Section 12, T6S, R22E, SBB&M

**MONITORING**

The discharger shall submit an annual status report on the following:

1. Number of spaces presently connected to the sewerage system.
2. List any proposed changes in the sewage disposal facilities during the upcoming year.
3. Explain any surfacing of wastewater or other failures of the system over the past year.

**REPORTING**

Annual reports are to be submitted by January 15th of each year to

California Regional Water Quality Control Board  
Colorado River Basin Region  
73-271 Highway 111, Suite 21  
Palm Desert, CA 92260

ORDERED BY:

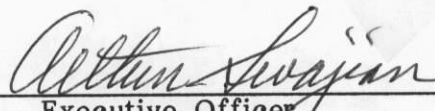
  
Executive Officer

January 21, 1987

Date

CALIFORNIA REGIONAL WATER QUALITY CONTROL BOARD -7

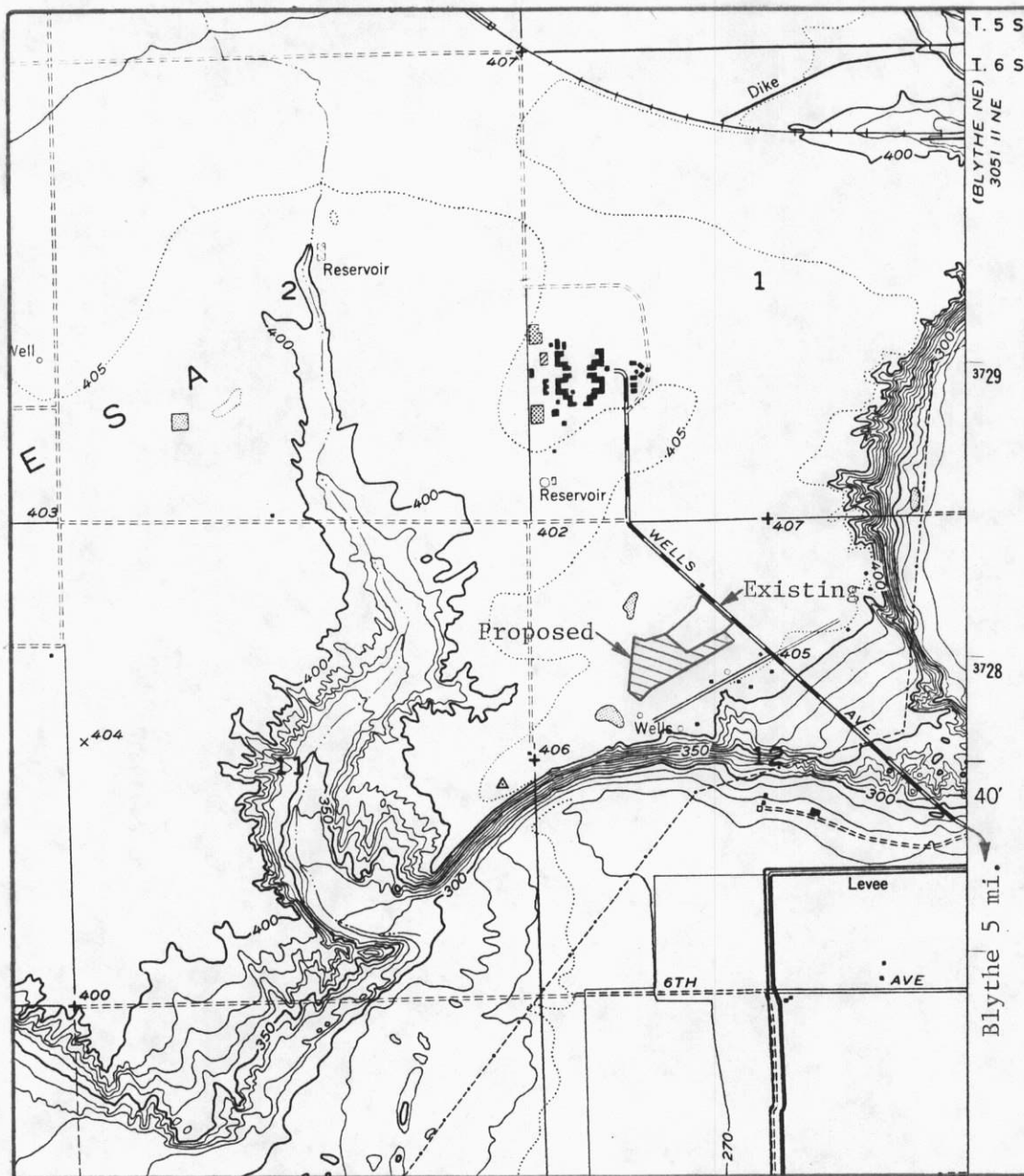

SITE MAP

MESA RANCH MOBILE HOME PARK  
 Northwest of Blythe - Riverside County  
 NW $\frac{1}{4}$  of Section 12, T6S, R22E, SBB&M  
 USGS McCoy Wash 7.5 min. Topographic Map



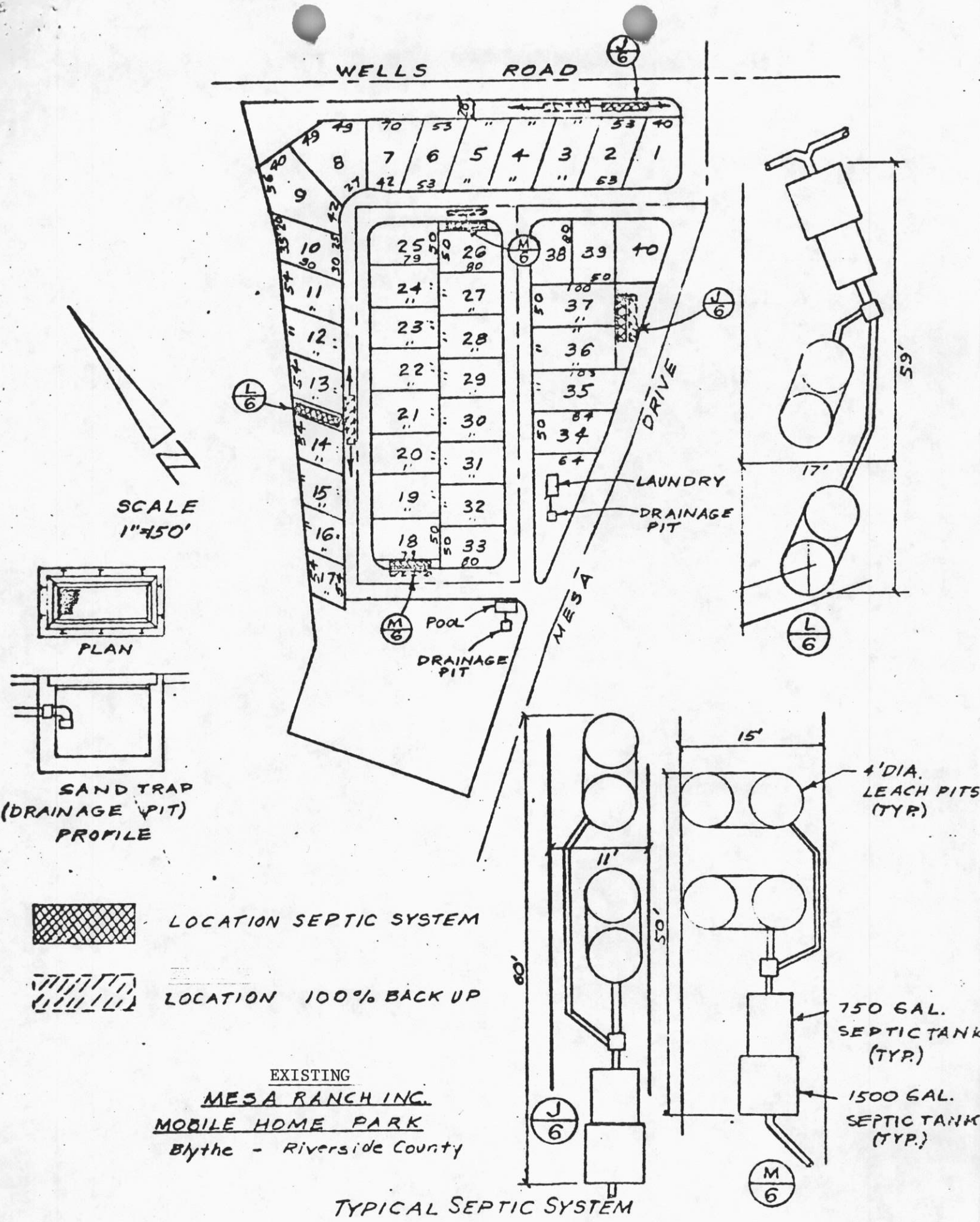

SKETCH NO. 1 EXISTING SEWAGE DISPOSAL FACILITIES

