

**CALIFORNIA REGIONAL WATER QUALITY CONTROL BOARD  
COLORADO RIVER BASIN REGION**

ORDER NO. 87-41

**WASTE DISCHARGE REQUIREMENTS  
FOR  
BOB'S PLAYA RIVIERA  
Northeast Shore of Salton Sea - Imperial County**

The California Regional Water Quality Control Board, Colorado River Basin Region, finds that:

1. Bob Granillo, (hereinafter also referred to as the discharger), 10-565 Highway 111, North Shore, California, 92254, verified on March 10, 1987 the below updated information on the discharge of wastes.
2. The discharger is discharging a maximum of about 3,600 gallons-per-day of domestic sewage from a travel trailer park consisting of 20 travel trailer spaces, two restrooms, a house and a laundry room into a septic tank/leach field disposal system. An additional 160 travel trailer spaces are to be constructed in phases, which could produce a total discharge of 30,000 gallons-per-day. The wastewater is to be discharged into a wet well and pumped to oxidation basins located about 175 feet west of Highway 111 in the N $\frac{1}{2}$  of the NW $\frac{1}{4}$  of Section 4, T9S, R11E, SBB&M. Upon installation of the basins, the existing septic tank/leach field system would be abandoned.
3. The discharge from this travel trailer park has been subject to waste discharge requirements adopted in Board Order No. 81-59.
4. The Water Quality Control Plan for the Colorado River Basin Region of California was adopted by the Regional Board on November 14, 1984.
5. Shallow ground waters at the discharge location are saline and are not beneficially used.
6. The Board has notified the discharger and interested agencies and persons of its intent to update waste discharge requirements for the discharge.
7. The Board in a public meeting heard and considered all comments pertaining to the discharge.
8. The Imperial County Planning Department has certified Negative Declaration EA 77-6-78 (filing date April 26, 1978) for the proposed expansion of this park. The Regional Board has reviewed this Negative Declaration. The below waste discharge requirements are designed to assure against any significant adverse effects on water quality.

IT IS HEREBY ORDERED, the discharger shall comply with the following:

A. Discharge Specifications

1. Neither the treatment nor the discharge of wastewater shall create a pollution or a nuisance as defined in Division 7 of the California Water Code.
2. No wastewater other than domestic sewage shall be discharged into the sewage disposal systems described in Finding No. 2 (above).
3. A minimum depth of freeboard of at least two feet shall be maintained in the basins.
4. Treated or untreated sludge or similar solid waste materials, shall be discharged only at locations approved by the Regional Board.
5. Adequate measures shall be taken to assure that unauthorized persons and animal pets are effectively excluded from contact with the discharge.
6. Adequate measures shall be taken to assure that flood or surface drainage waters do not erode or otherwise render portions of the discharge facilities inoperable.
7. There shall be no surface flow of wastewater away from the discharge facilities.
8. There shall be no discharge, bypass, or flow of treated or untreated sewage to the Salton Sea or to any channel which drains thereto.
9. Disposal by ponding shall be conducted in such manner that there shall be no stranded or exposed sewage solids.
10. Treatment and discharge of wastewater shall be conducted by technical procedures which will maintain a surface aerobic environment; and the surface wastewater shall contain a dissolved oxygen concentration of not less than 2 mg/l.
11. Standby facilities shall be provided in the event of pump and/or commercial power failure.

B. Provisions

1. Prior to any modifications in this facility which could result in material change in the quality or quantity of wastewater discharged, or any material change in location of discharge, the discharger shall report in writing to the Regional Board.
2. The discharger shall comply with "Monitoring and Reporting Program No. 87-41", and future revisions thereto, as specified by the Executive Officer.

3. In the event of any change in control or ownership of land or waste discharge facilities owned or controlled by the discharger, the discharger shall:

a. Notify the Board of such change; and

b. Transmit a copy of this Order to the succeeding owner or operator and file a copy of the transmittal letter with this Board.

4. This Order supersedes Board Order No. 81-59.

I, Arthur Swajian, Executive Officer, do hereby certify the foregoing is a full, true and correct copy of an Order adopted by the California Regional Water Quality Control Board, Colorado River Basin Region, on May 20, 1987.

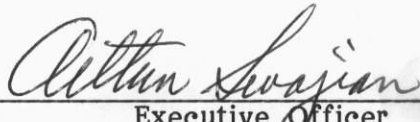
  
\_\_\_\_\_  
Executive Officer

**CALIFORNIA REGIONAL WATER QUALITY CONTROL BOARD  
COLORADO RIVER BASIN REGION**

**MONITORING AND REPORTING PROGRAM NO. 87-41  
FOR  
BOB'S PLAYA RIVIERA  
Northeast Shore of Salton Sea - Imperial County**

Location of Discharge: Portion of N $\frac{1}{2}$  of the NW $\frac{1}{4}$  of Section 4, T9S, R11E, SBB&M

**MONITORING**

The discharger shall submit the following information in an annual status report:

1. Estimate of average daily flow (gpd) of sewage discharged to basin(s).
2. Number of spaces (or residences) presently connected to the sewerage system.
3. List of any proposed changes during the coming year.
4. Explain any problems in the sewerage system during the preceding year.

**REPORTING**

Monitoring reports shall be submitted to the Regional Board annually by January 15th of each year.

Submit monitoring reports to:

California Regional Water Quality Control Board  
Colorado River Basin Region  
73-271 Highway 111, Suite 21  
Palm Desert, CA 92260

ORDERED BY:

  
Executive Officer

May 20, 1987

Date

CALIFORNIA REGIONAL WATER QUALITY CONTROL BOARD -7

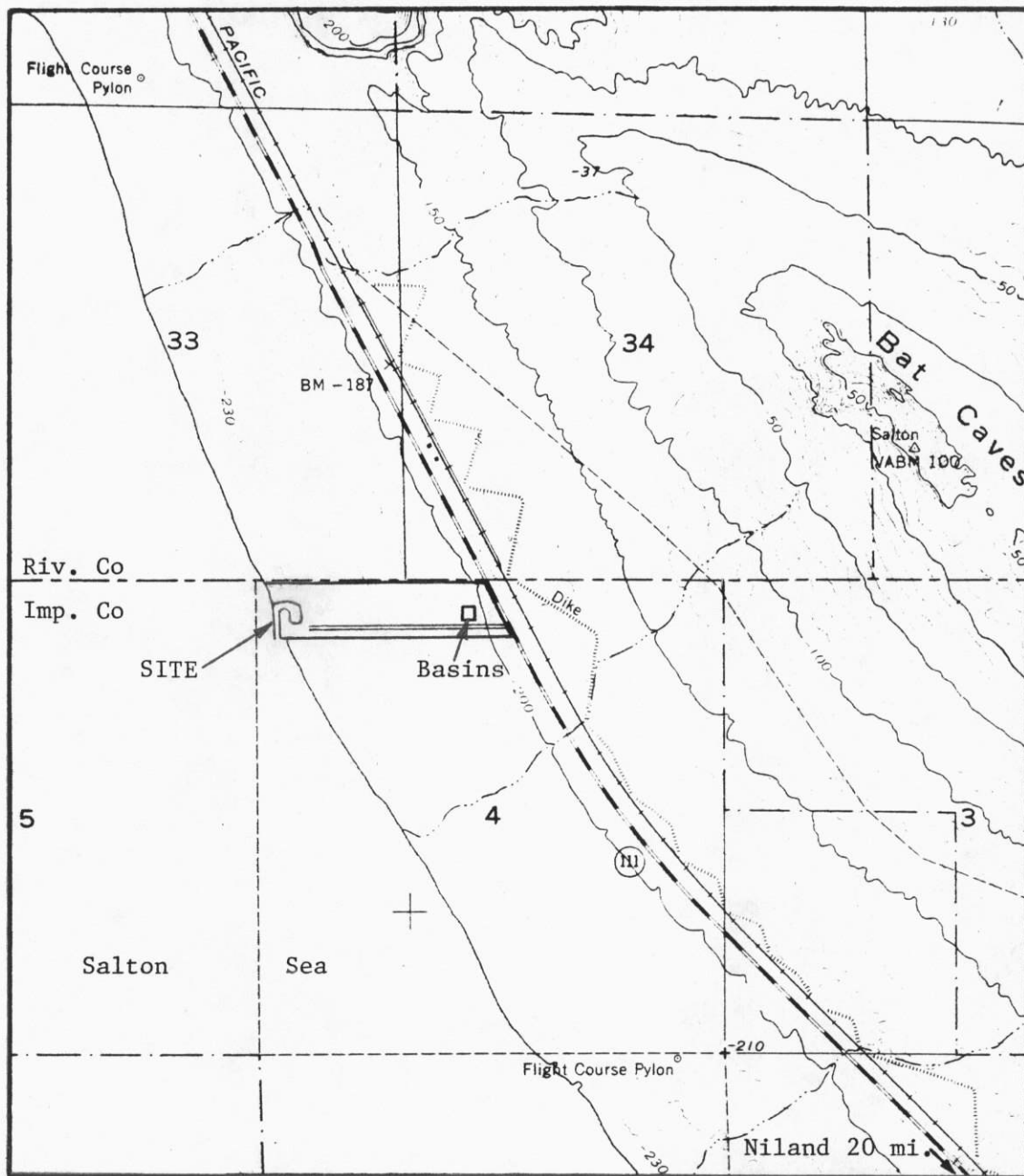

Scale:  
1=2,000'

SITE MAP

BOB'S PLAYA RIVIERA  
Northeast Shore of Salton Sea - Imperial County  
N $\frac{1}{2}$  of the NW $\frac{1}{4}$  of Section 4, T9S, R11E, SBB&M  
USGS Durmid 7.5 min. Topographic Map

Order No. 87-41

Hwy. 111

N  No Scale

Proposed 160 Travel  
Trailer Spaces (to be  
constructed in phases)

Sewage Gravity Flow west to concrete wet well and  
force pump to oxidation basins.

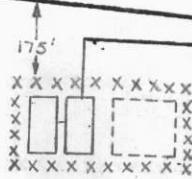

Blowup of Oxidation Basins

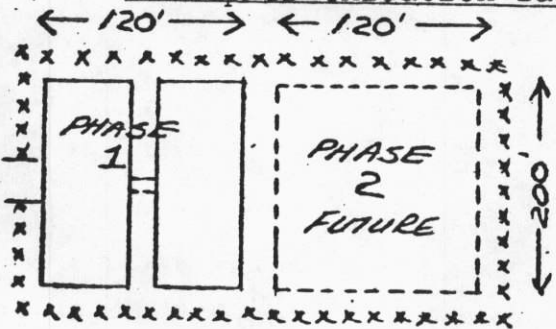

Existing  
20 Spaces

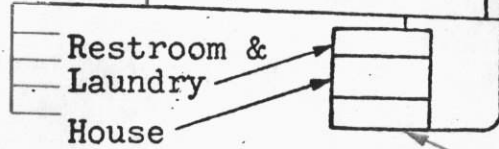

Restroom &  
Laundry  
House

Store

Wet Well  
and Pumps

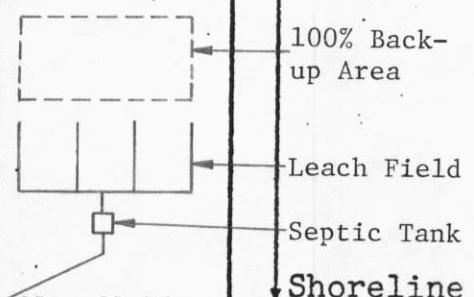

1800'

100% Back-  
up Area

Leach Field

Septic Tank

Shoreline

Marina

Sea Wall

Salton  
Sea

PRELIMINARY SEWAGE DISPOSAL FACILITIES SKETCH

BOB'S PLAYA RIVIERA

Northeast Shore of Salton Sea - Imperial County