

CALIFORNIA REGIONAL WATER QUALITY CONTROL BOARD  
COLORADO RIVER BASIN REGION

ORDER NO. 91-037

WASTE DISCHARGE REQUIREMENTS  
FOR  
CITY OF COACHELLA  
Riverside County

The California Regional Water Quality Control Board, Colorado River Basin Region, finds that:

1. City of Coachella (hereinafter also referred to as the discharger), 1515 Sixth Street, Coachella, California, 92236, verified the below updated information, on April 21, 1991.
2. The discharger is discharging a peak month average daily flow of 89,000 gallons of vegetable and fruit packing plant wastewater to pasture used by non-milking animals under Order No. 86-008. The wastewater originates from washing of citrus fruit, asparagus and dates, and also, from refrigeration and air conditioning.
3. The discharger proposes to increase the peak month flow to 175,000 gallons-per-day.
4. Thirty acres of land are available for irrigation. Any excess flows not required for irrigation would be routed to the City's sewage treatment plant. The location of irrigated land is in the N $\frac{1}{2}$ , N $\frac{1}{2}$ , Section 9, T6S, R8E, SBB&M.
5. The Water Quality Control Plan for the Colorado River Basin Region of California designates the beneficial uses of ground and surface waters in this Region.
6. The beneficial uses of ground waters in the Coachella Hydrologic Subunit are:
  - a. Municipal supply (MUN)
  - b. Industrial supply (IND)
  - c. Agricultural supply (AGR)
7. The Board has notified the discharger and all known interested agencies and persons of its intent to update waste discharge requirements for this discharge.
8. The Board in a public meeting heard and considered all comments pertaining to this discharge.

SUPERSEDED BY  
BOARD ORDER NO. R7-2002-0099

9. The City of Coachella approved Negative Declaration No. SCH #85102109 (approval date October 14, 1985) for the proposed expansion of the industrial park. The Regional Board has reviewed this Negative Declaration. The below waste discharge requirements are designed to assure against any significant adverse effects on water quality.

IT IS HEREBY ORDERED, the discharger shall comply with the following:

A. Discharge Specifications

1. The treatment or disposal of wastes at this facility shall not cause pollution or nuisance as defined in Sections 13050(l) and 13050(m) of Division 7 of the California Water Code.
2. Wastewater discharged to land shall be substantially free of settleable and floatable materials.
3. There shall be no surface flow of wastewater away from the designated disposal area.
4. The discharger of wastewater into any drainage channel is prohibited, and any tailwaters resulting from application to land as described in Findings No. 2, 3, and 4 (above) shall not enter Coachella Valley Stormwater Channel nor any other drainage channel.
5. Sewage and sewage effluent shall not be contained in the wastewaters discharged to land under this Order.
6. There shall be no discharge of any wastewater containing pesticides at this location, except that which is incidental to the washing of picked crops.
7. Not less than thirty acres of land shall be reserved for discharge by irrigation under this Order.

B. Provisions

1. Prior to any modifications in this facility which would result in material change in the quality or quantity of wastewater treated or discharged, or any material change in the location of discharge, the discharger shall report all pertinent information in writing to the Regional Board; and obtain revised requirements before any modifications are implemented.

IT IS FURTHER ORDERED that Board Order No. 86-008 be superseded by this Board Order.

I, Philip A. Gruenberg, Executive Officer, do hereby certify the foregoing is a full, true and correct copy of an Order adopted by the California Regional Water Quality Control Board, Colorado River Basin Region, on June 26, 1991.

  
\_\_\_\_\_  
Executive Officer

CALIFORNIA REGIONAL WATER QUALITY CONTROL BOARD  
COLORADO RIVER BASIN REGION

MONITORING AND REPORTING PROGRAM NO. 91-037  
FOR  
CITY OF COACHELLA  
Riverside County

Location of Discharge: N $\frac{1}{2}$ , N $\frac{1}{2}$ , Section 9, T6S, R8E, SBB&M

MONITORING

City of Coachella (discharger) shall submit to the Regional Board an annual report containing the following:

- A. Total number of gallons of wastewater discharged in the previous 12 month period.
- B. An estimation of the number of gallons of wastewater that will be discharged in the next 12 month period.

REPORTING

Annual reports shall be submitted to the Regional Board by January 15th of each year to:

California Regional Water Quality Control Board  
Colorado River Basin Region  
73-271 Highway 111, Suite 21  
Palm Desert, CA 92260

ORDERED BY:

Philip A. Guenberg  
Executive Officer

June 26, 1991

Date

CALIFORNIA REGIONAL WATER QUALITY CONTROL BOARD -7

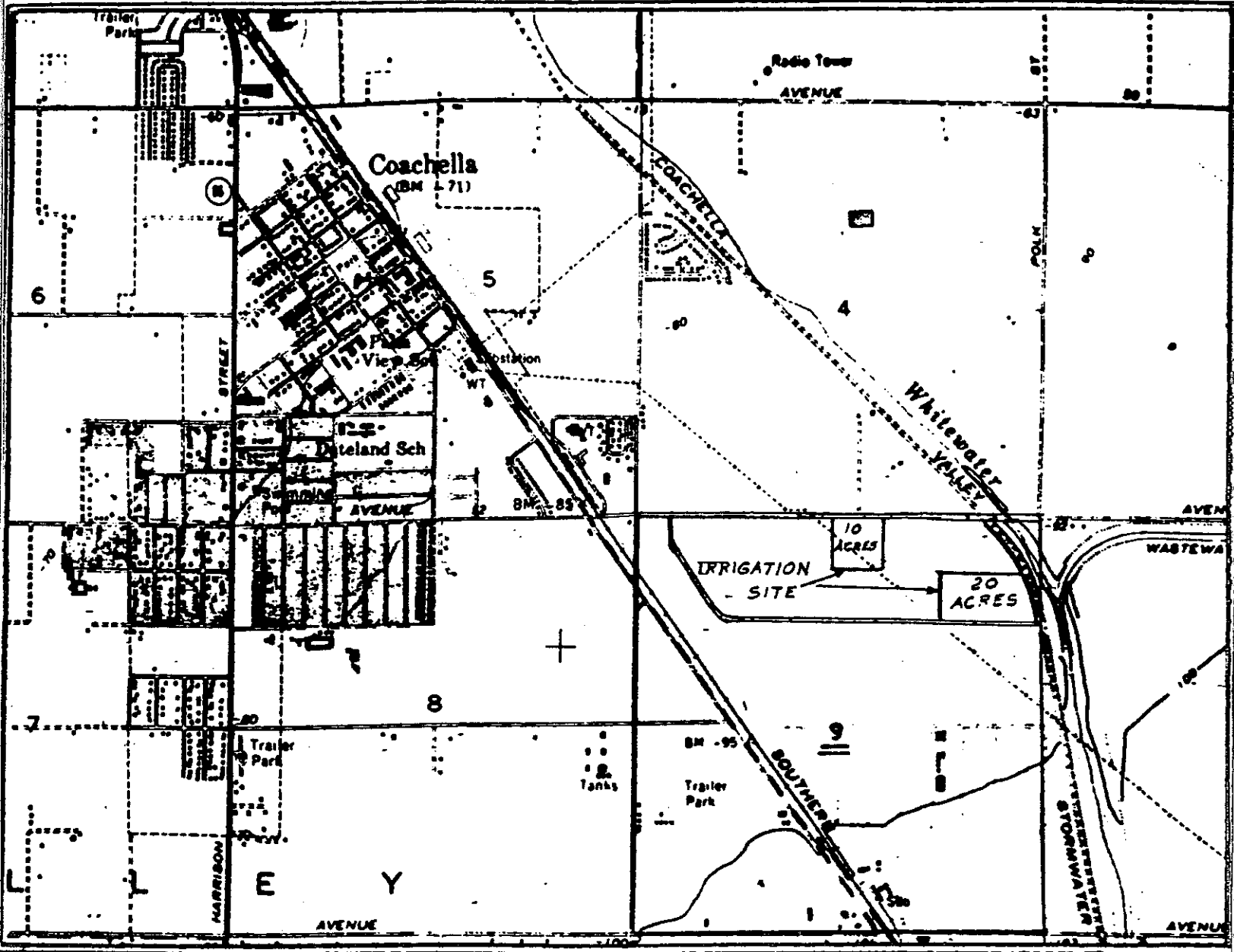

SITE MAP  
CITY OF COACHELLA

IRRIGATION OF PASTURE  
USING  
WASTEWATER FROM PACKING PLANTS  
N $\frac{1}{2}$ , N $\frac{1}{2}$ , Section 9, T8S, R8E, SBB&M  
Indio 7 $\frac{1}{2}$ ' Topographic Map



Scale:  
1"=2,000'