

CALIFORNIA REGIONAL WATER QUALITY CONTROL BOARD
COLORADO RIVER BASIN REGION

ORDER NO. 91-045

WASTE DISCHARGE REQUIREMENTS
FOR
COACHELLA VALLEY WATER DISTRICT
PALM DESERT COUNTRY CLUB
WASTEWATER RECLAMATION FACILITY
Riverside County

The California Regional Water Quality Control Board, Colorado River Basin Region, finds that:

1. Coachella Valley Water District, (hereinafter also referred to as the discharger), 85-820 Coachella Heights, P.O. Box 1058, Coachella, California, 92236, verified as accurate the updated information given below on July 22, 1991.
2. The discharger operates an activated sludge treatment plant that provides secondary level of treatment of wastewater originating from Palm Desert Country Club. This plant has a design treatment capacity of 0.4 million gallons-per-day of wastewater and consists essentially of the following units: a grit chamber, two aeration basins, two secondary clarifiers, one chlorine contact chamber and one aerobic sludge digester. The facility has two holding basins on site (one is lined) for the storage and occasional disposal by infiltration of treated effluent from the plant.
3. The discharger presently discharges an annual average daily flow of 300,000 gallons-per-day (gpd) of treated and chlorinated effluent to the lined storage basin from where the effluent is pumped to the Palm Desert Country Club where it is mixed with well water and used for golf course irrigation. The treatment plant, storage/infiltration basins, and the wastewater reuse area are located in the SW $\frac{1}{4}$ of Section 13, T5S, R6E, SBB&M, as indicated on the attached site map.
4. The discharger reports that no industrial wastewaters are being discharged to the wastewater treatment plant.
5. This discharge has been subject to waste discharge requirements adopted in Board Order No. 88-062.
6. Treated sludge from the aerobic sludge digester is pumped to the discharger's Mid-Valley Wastewater Reclamation Facility for disposal.
7. The Water Quality Control Plan for the Colorado River Basin Region of California was adopted May 15, 1991 and designates the beneficial uses of ground and surface waters in this Region.

*Superseded by:
Board Ord. # 97-0484
5/28/97*

8. The beneficial uses of ground waters in the Coachella Hydrologic Subunit are:
 - a. Municipal supply (MUN)
 - b. Industrial supply (IND)
 - c. Agricultural supply (AGR)
9. There are no domestic wells within 500 feet of the discharge facilities described in Finding No. 2, above.
10. The Board has notified the discharger, and all known interested agencies and persons of its intent to update waste discharge requirements for said discharge and has provided them with an opportunity for a public meeting and an opportunity to submit comments.
11. The Board in a public meeting heard and considered all comments pertaining to this discharge.
12. In accordance with Section 15301, Chapter 3, Title 14 of the California Code of Regulations, the issuance of these waste discharge requirements, which govern the operation of an existing facility involving negligible or no expansion of use beyond that previously existing, is exempt from the provisions of the California Environmental Quality Act (Public Resources Code, Section 21000 et seq.).

IT IS HEREBY ORDERED, that the discharger shall comply with the following:

A. Discharge Specifications

1. The treatment or disposal of wastes at this facility shall not cause pollution or nuisance as defined in Sections 13050(1) and 13050(m) of Division 7 of the California Water Code.
2. Representative samples of wastewater effluent discharged to any holding and/or infiltration basins from treatment facilities shall not contain constituents in excess of the following limits:

<u>Constituent</u>	<u>Unit</u>	30-Day Arithmetic Mean <u>Discharge Rate</u>	7-Day Arithmetic Mean <u>Discharge Rate</u>
20°C BOD ₅	mg/l	30	45
Suspended Solids	mg/l	30	45
Settleable Matter	ml/l	0.3	0.5

3. Reclaimed water used for the irrigation of the Palm Desert Country Club's golf courses where the public has access or exposure shall be at all times an adequately disinfected and oxidized wastewater. The wastewater shall be considered adequately disinfected if the median number of coliform organisms in the effluent does not exceed 23 per 100 milliliters, as determined from the bacteriological results of the last 7 days for which analyses have been completed, and the number of coliform organisms does not exceed 240 per 100 milliliters in any two consecutive samples. Oxidized wastewater means wastewater in which the organic matter has been stabilized, is nonputrescible, and contains dissolved oxygen.
4. There shall be no discharge of reclaimed wastewater into any on-site domestic or irrigation supply well as a result of being used for golf course irrigation.
5. The infiltration basin when used shall be maintained and operated so as to maximize infiltration and minimize the increase of salinity.
6. A minimum depth of freeboard of two (2) feet shall be maintained at all times in the infiltration and holding basins.
7. Treated sludge or similar solid waste materials shall be disposed as described in Finding No. 6 of this Board Order, or at locations approved by the Executive Officer.
8. Wastes, including windblown spray, shall be strictly confined to the lands specifically designated for the disposal operation; and irrigation practice shall be so managed that runoff of effluent from the irrigated areas does not occur at any time.

B. Provisions

1. The discharger shall not deliver reclaimed wastewater to any user who, by reason of the user's operating practices causes nuisance associated with the wastewater or contributes to the violation of the requirements of this Board Order.
2. The discharger shall assure that written notification of the use of reclaimed wastewater is provided annually to people who reside adjacent to irrigation areas. A sign notifying the public of the use of reclaimed wastewater shall be posted at a conspicuous location on the golf course. Notification of the public shall commence at least 30 days prior to resumption of golf course irrigation.
3. The discharger shall provide the following information regarding use of reclaimed wastewater:
 - a. Name and location of the golf courses/landscape areas being irrigated.
 - b. Name of person, company, or agency responsible for the operation and maintenance of the irrigation system.
 - c. Quantity and quality of the plant effluent being provided to individual customers.

4. Facilities shall be available to keep the plant in operation in the event of commercial power failure.
5. The discharger's plant shall be supervised and operated by persons possessing certification of an appropriate grade pursuant to Chapter 3, Subchapter 14, Title 23, California Code of Regulations.
6. The discharger shall not accept waste in excess of the design capacity of the secondary treatment plant.
7. The discharger shall comply with "Monitoring and Reporting Program No. 91-045", and future revisions thereto, as specified by the Regional Board's Executive Officer.

IT IS FURTHER ORDERED that Board Order No. 88-062 be superseded by this Board Order.

I, Philip A. Gruenberg, Executive Officer, do hereby certify the foregoing is a full, true and correct copy of an Order adopted by the California Regional Water Quality Control Board, Colorado River Basin Region, on September 18, 1991.

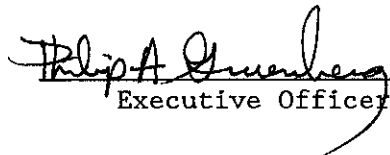
Executive Officer

CALIFORNIA REGIONAL WATER QUALITY CONTROL BOARD
COLORADO RIVER BASIN REGION

MONITORING AND REPORTING PROGRAM NO. 91-045
FOR

COACHELLA VALLEY WATER DISTRICT
PALM DESERT COUNTRY CLUB
WASTEWATER RECLAMATION FACILITY
Riverside County

Location of Discharge: SW $\frac{1}{4}$, Section 13, T5S, R6E, SBB&M

A. EFFLUENT MONITORING

Wastewater treatment plant effluent discharged to any holding and/or infiltration basin shall be monitored for the following:

<u>Constituents</u>	<u>Unit</u>	<u>Type of Sample</u>	<u>Sampling Frequency</u>
20°C BOD ₅	mg/l	24-Hr. Composite	Weekly
Suspended Solids	mg/l	24-Hr. Composite	Weekly
Settleable Matter	ml/l	Grab at Peak Flow	Weekly
Flow (Total Plant Effluent)	MGD	Flow measurement	Daily ¹

Wastewater contained in holding and/or infiltration basins shall be monitored for the following:

<u>Constituents</u>	<u>Unit</u>	<u>Type of Sample</u>	<u>Sampling Frequency</u>
Total Dissolved Solids	mg/l	Grab	Quarterly
Total Nitrogen (N) ²	mg/l	Grab	Quarterly

¹Reported for each day with average monthly flow calculated

²Total Nitrogen as the summation of nitrate, nitrite, ammonia and organic nitrogen

RECLAIMED WASTEWATER MONITORING

Coachella Valley Water District shall monitor the wastewater treatment plant effluent³ being supplied for golf courses/landscape irrigation as follows:

<u>Item</u>	<u>Unit</u>	<u>Type of Sample</u>	<u>Sampling Frequency</u>
Coliform Organism	MPN/100 ml	Grab	Daily ⁴
Volume of waste-water used for irrigation at each location	Gallons/day	Flow Measurement	Daily ⁵
Turbidity	-	24-hour composite	Weekly
Chlorine Residual	mg/l	Grab at Peak Flow	Daily

SLUDGE MONITORING

The discharger shall report quarterly on the quantity, location, and method of disposal of all sludge and similar solid materials being handled at the wastewater treatment plant facility.

REPORTING

Monthly monitoring reports shall be submitted to the Regional Board by the 15th day of the following month. Quarterly monitoring reports shall be submitted to the Regional Board by January 15, April 15, July 15, and October 15 of each year.

Submit monitoring reports to:

California Regional Water Quality Control Board
Colorado River Basin Region
73-271 Highway 111, Suite 21
Palm Desert, CA 92260

ORDERED BY:

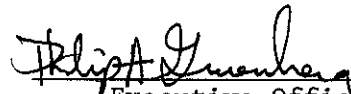
Executive Officer

September 18, 1991

Date

³Effluent from treatment plant after chlorination

⁴To be taken when wastewater flow and characteristics are most demanding on the treatment and chlorination facilities. The sample may be taken at any point in the treatment process

⁵Reported for each day with average monthly flow calculated

CALIFORNIA REGIONAL WATER QUALITY CONTROL BOARD - 7

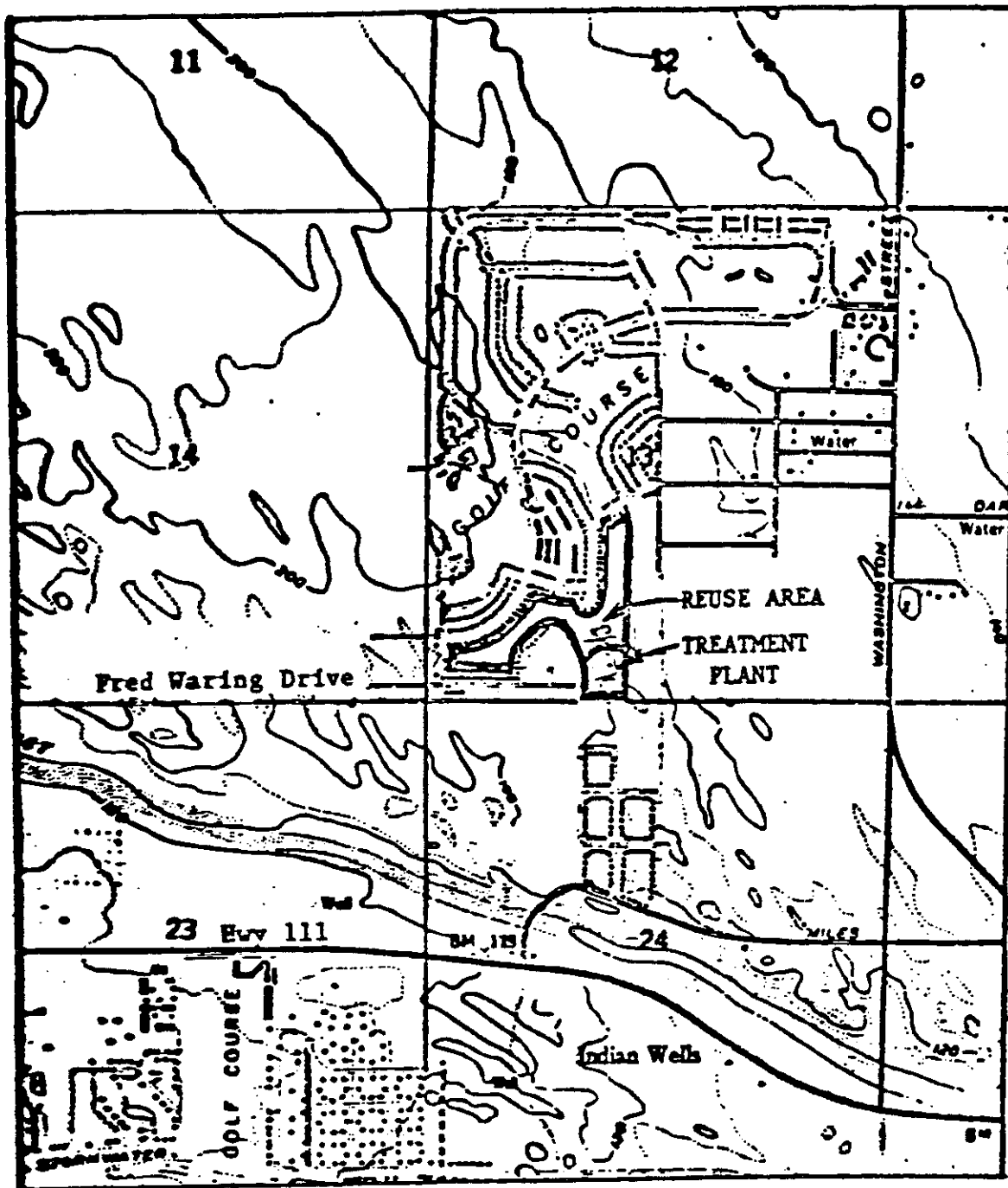

Scale:
1" = 2,000'

SITE MAP

COACHELLA VALLEY WATER DISTRICT
PALM DESERT COUNTRY CLUB
WASTEWATER RECLAMATION FACILITY
Riverside County
SW $\frac{1}{4}$ of Section 13, T5S, R6E, SBB&M
USGS La Quinta 7.5 min. Topographic Map