

**STATE OF CALIFORNIA  
CALIFORNIA REGIONAL WATER QUALITY CONTROL BOARD  
LOS ANGELES REGION**

**REVISED MONITORING AND REPORTING PROGRAM NO. CI-10229  
FOR  
FORMER MOVING SOLUTIONS  
45 WEST EASY STREET, SIMI VALLEY, CALIFORNIA**

**ENROLLMENT UNDER REGIONAL WATER BOARD  
ORDER NO. R4-2014-0187 (SERIES NO. 068)  
FILE NO. 16-045**

**I. MONITORING AND REPORTING REQUIREMENTS**

- A. Mr. Gary Blackwell (hereinafter Discharger) shall implement this Monitoring and Reporting Program (MRP) on the effective date (May 18, 2020) under Regional Water Board Order No. R4-2014-0187. The next monitoring report shall be received at the Regional Water Board by **July 30, 2020**. Subsequent monitoring reports shall be received at the Regional Water Board according to the following schedule:

<u>Monitoring Period</u>	<u>Report Due</u>
January – March	April 30
April – June	July 30
July – September	October 30
October – December	January 30

- B. If there is no discharge or injection, during any reporting period, the report shall so state. By March 1 of each year, the Discharger shall submit an annual summary report to the Regional Water Board. The report shall contain both tabular and graphical summaries of the monitoring data obtained during the previous calendar year. In addition, the Discharger shall discuss the compliance record and the corrective actions taken or planned, which may be needed to bring the discharge into full compliance with the waste discharge requirements.
- C. The Discharger shall comply with requirements contained in Section G of Regional Water Board Order No. R4-2014-0187 "*Monitoring and Reporting Requirements*".

## II. DISCHARGE MONITORING PROGRAM

The monitoring reports shall contain the following information for the injection activities:

1. Location map showing injection points used for 3-D Microemulsion solution, Hydrogen Release Compound Primer, Chemical Reducing Solution, and bioaugmentation culture.
2. Written and tabular summary defining depth of injection points, quantity and concentration of 3-D Microemulsion solution, Hydrogen Release Compound Primer, Chemical Reducing Solution, and bioaugmentation culture injected at each injection point, and total amount of 3-D Microemulsion solution, Hydrogen Release Compound Primer, Chemical Reducing Solution, and bioaugmentation culture injected at the Site.
3. Visual inspection at each injection point shall be conducted and recorded during the injection.

## III. GROUNDWATER MONITORING PROGRAM

A groundwater monitoring program shall be implemented to evaluate impacts associated with the injection activity. Groundwater samples shall be collected from monitoring wells MW-2R, MW-4R, MW-6, MW-7, MW-9, MW-12, MW-13, and MW-14 (Figure 1). The Discharger shall conduct baseline sampling prior to the proposed injection, followed by a monitoring frequency specified in the schedule below for all eight monitoring wells for the following groundwater parameters:

CONSTITUENT	UNITS	TYPE OF SAMPLE	MINIMUM FREQUENCY OF ANALYSIS
Dissolved Oxygen	mg/L	grab	Baseline and quarterly after injection
Oxidation-Reduction Potential	millivolts	grab	Baseline and quarterly after injection
pH	pH units	grab	Baseline and quarterly after injection
Specific Conductivity	mS/cm	grab	Baseline and quarterly after injection

CONSTITUENT	UNITS	TYPE OF SAMPLE	MINIMUM FREQUENCY OF ANALYSIS
Temperature	°C	grab	Baseline and quarterly after injection
Turbidity	NTU	grab	Baseline and quarterly after injection
Total Organic Carbon	mg/L	grab	Baseline and quarterly after injection
Total Dissolved Solids	mg/L	grab	Baseline and quarterly after injection
Sulfate	mg/L	grab	Baseline and quarterly after injection
Chloride	mg/L	grab	Baseline and quarterly after injection
Boron	mg/L	grab	Baseline and quarterly after injection
Nitrate and Nitrite	mg/L	grab	Baseline and quarterly after injection
Volatile Organic Compounds	µg/L	grab	Baseline and quarterly after injection
Dissolved Gases (methane, ethane, and ethene)	µg/L	grab	Baseline and quarterly after injection
<i>Dehalococcoides</i> species	cells/mL	grab	Baseline and quarterly after injection

All groundwater monitoring reports must include, at a minimum, the following:

- a. Well identification, date and time of sampling;
- b. Sampler identification, and laboratory identification;
- c. Observation of groundwater levels, recorded to 0.01 feet mean sea level and groundwater flow direction.

**IV. MONITORING FREQUENCIES**

Specifications in this monitoring program are subject to periodic revisions. Monitoring requirements may be modified or revised by the Executive Officer based on review of monitoring data submitted pursuant to this Order. Monitoring frequencies may be adjusted to a less frequent basis or parameters and locations dropped by the Executive Officer if the Discharger makes a request and the request is backed by statistical trends of monitoring data submitted.

**V. CERTIFICATION STATEMENT**

Each report shall contain the following completed declaration:

"I certify under penalty of law that this document, including all attachments and supplemental information, was prepared under my direction or supervision in accordance with a system designed to assure that qualified personnel properly gathered and evaluated the information submitted. Based on my inquiry of the person or persons who manage the system, or those persons directly responsible for gathering the information, the information submitted is, to the best of my knowledge and belief, true, accurate, and complete. I am aware that there are significant penalties for submitting false information, including the possibility of a fine and imprisonment.

Executed on the \_\_\_\_\_ day of \_\_\_\_\_ at \_\_\_\_\_

\_\_\_\_\_  
(Signature)

\_\_\_\_\_  
(Title)"

**VI. PUBLIC DOCUMENTS**

All records and reports submitted in compliance with Regional Water Board Order No. R4-2014-0187 and Monitoring and Reporting Program No. CI-10229 are public documents and will be made available for inspection during business hours at the office of the California Regional Water Quality Control Board, Los Angeles Region, upon request by interested parties. Only proprietary information, and only at the request of the Discharger will be treated as confidential.

Former Moving Solutions  
WDR Order No. R4-2014-0187  
Revised Monitoring and Reporting Program No. CI-10229

## **VII. ELECTRONIC SUBMITTAL OF INFORMATION**

The Discharger shall comply with the Electronic Submittal of Information (ESI) requirements by submitting all reports required under the MRP, including groundwater monitoring data and discharge location data, and searchable Portable Document Format (pdf) digital copies of monitoring reports to the State Water Resources Control Board GeoTracker database under Global ID WDR100039429.

Ordered by:

Renee Purdy  
Executive Officer

Date: May 18, 2020

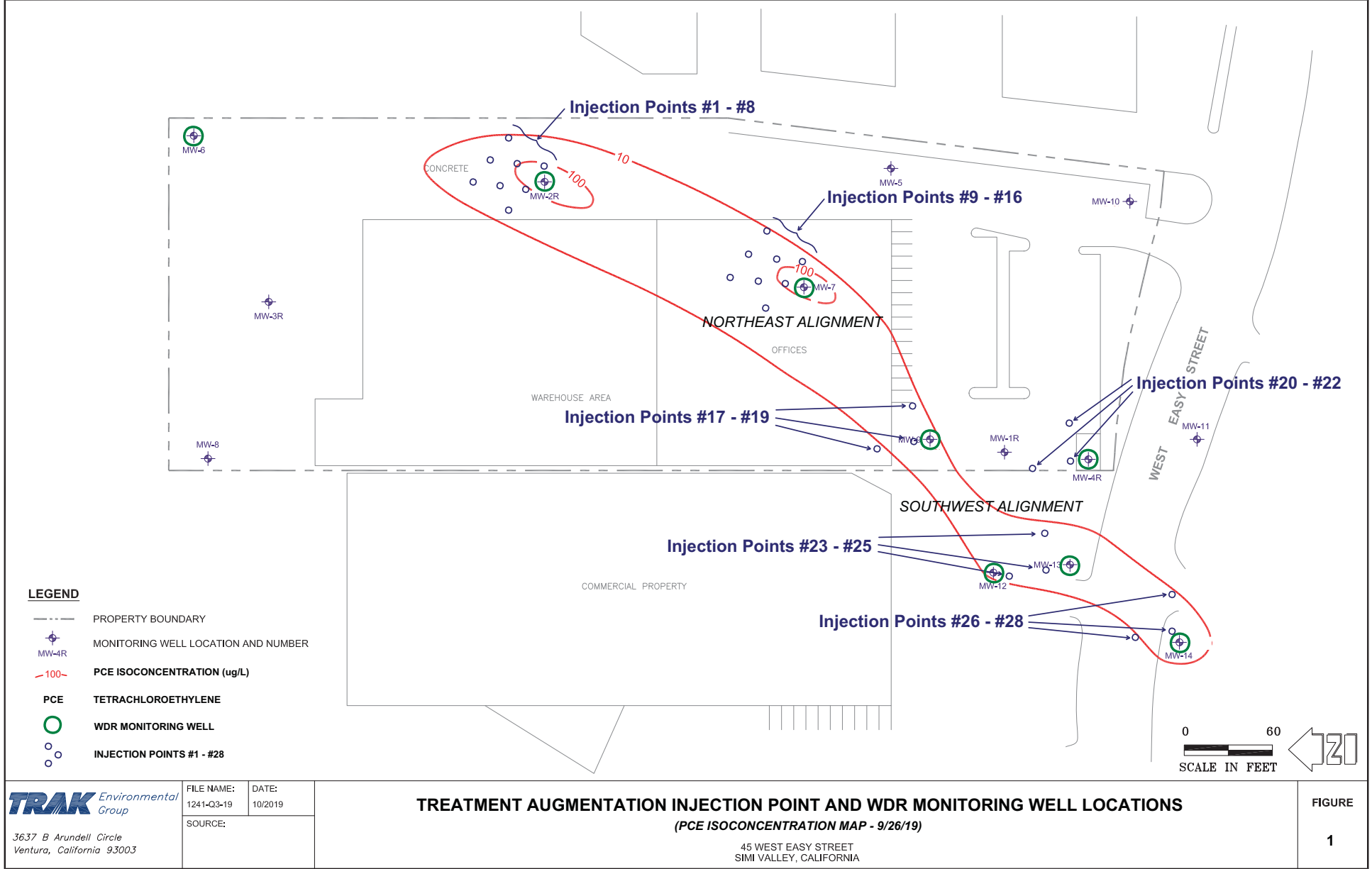

- LEGEND**
- PROPERTY BOUNDARY
  - MW-4R MONITORING WELL LOCATION AND NUMBER
  - 100- PCE ISOCONCENTRATION (ug/L)
  - PCE TETRACHLOROETHYLENE
  - WDR MONITORING WELL
  - INJECTION POINTS #1 - #28

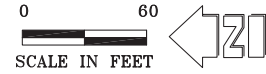

**TRAK** Environmental Group  
 3637 B Arundell Circle  
 Ventura, California 93003

FILE NAME: 1241-Q3-19	DATE: 10/2019
SOURCE:	

**TREATMENT AUGMENTATION INJECTION POINT AND WDR MONITORING WELL LOCATIONS**  
 (PCE ISOCONCENTRATION MAP - 9/26/19)

45 WEST EASY STREET  
 SIMI VALLEY, CALIFORNIA

FIGURE  
 1