

---

## Los Angeles Regional Water Quality Control Board

August 13, 2021

Mr. John Havel  
9941 McBroom Street  
Shadow Hills, CA 91040  
[jhavel7@yahoo.com](mailto:jhavel7@yahoo.com)

**GENERAL WASTE DISCHARGE REQUIREMENTS FOR AN ADVANCED ONSITE WASTEWATER TREATMENT SYSTEM AT JOHN HAVEL RESIDENCE, 9941 MCBROOM STREET, SHADOW HILLS, CALIFORNIA 91040 (FILE NO. 20-117, WDR ORDER NO. R4-2019-0024, SERIES NO. 020, CI-10601, GLOBAL ID WDR100053164)**

Dear Mr. Havel:

The Los Angeles Regional Water Quality Control Board (Regional Water Board) is the public agency with primary responsibility for the protection of ground and surface water quality for all beneficial uses of water within major portions of Los Angeles and Ventura Counties. The subject property is within the Regional Water Board jurisdiction.

### SUMMARY OF TECHNICAL REPORTS

On October 26, 2020, the Regional Water Board received an application for Waste Discharge Requirements (WDRs) submitted by Mr. John Havel (Discharger). The Discharger proposes to install an advanced onsite wastewater treatment system (OWTS) to treat wastewater at the John Havel Residence (Site) located at 9941 McBroom Street in Shadow Hills, California 91040 (Figure 1).

The existing onsite wastewater treatment system (OWTS) and former house were burnt down due to a brush fire in early December 2017. The Site is currently vacant and a new house is currently under construction. The Site is a 22,218-square foot lot with a dwelling footage of 3,827 square feet. The Site will have three bedrooms with three bathrooms as shown in Figure 2.

The proposed advanced OWTS is certified under NSF/ANSI Standard 245 and consists of a 751-gallon chamber, a 424-gallon pretreatment tank, a 520-gallon aeration tank, a 188-gallon clarifier, one existing seepage pit (5-foot diameter and 28-foot effective depth), and one new seepage pit (5-foot diameter and 28-foot effective depth) as shown in Figures 3 and 4. The design capacity of the advanced OWTS is 600 gallons per day (gpd).

The subject Site is a developed hillside parcel situated along the north side of McBroom Street at the northeast corner of its intersection with Johanna Avenue.

The estimated maximum discharge volume to the proposed new advanced treatment system is 450 gpd (3 bedrooms x 150 gpd per bedroom). The maximum daily discharge volume shall not exceed 600 gpd based on the treatment capacity.

Results of the percolation test performed on February 1, 2020 indicated that the percolation rate at the subject site is 20.53 gallons per square feet per day (gal/sq.ft./day). The City of Los Angeles requires that any OWTS cases that have a percolation rate greater than 5.12 gal/sq.ft./day shall be referred to the Los Angeles Regional Water Quality Control Board for WDRs.

### **Summary of Regional Water Board Review and Requirements**

You are required to obtain WDRs because the geological conditions at the Site cannot be covered by the Conditional Waiver of Waste Discharge Requirements in the Water Quality Control Policy for Siting, Design, Operation, and Maintenance of Onsite Wastewater Treatment Systems (OWTS Policy), adopted by the State Water Resources Control Board on June 19, 2012 and amended on April 17, 2018.

Regional Water Board staff has reviewed the information provided and has determined that the proposed discharge meets the conditions specified in General WDRs Order No. R4-2019-0024, *General Waste Discharge Requirements for Advanced Wastewater Treatment Systems*, adopted by the Regional Water Board on February 14, 2019.

Enclosed are your General WDRs, consisting of Order No. R4-2019-0024, Monitoring and Reporting Program (MRP) No. CI-10601, and Standard Provisions Applicable to WDRs I (Attachment E of the Order). Based on the location of the Site and anticipated performance of the proposed advanced treatment system, the requirements specified in Order No. R4-2019-0024, including effluent quality limitations specified in Section III and numeric limitations in Table 2, are applicable to your discharge. At this time, the groundwater limitations specified in Section IV.B (Table 4) are not applicable to your discharge and groundwater monitoring is not required.

The Site discharges to the San Fernando Valley Groundwater Basin-Sunland-Tujunga area subbasin (Basin). Consistent with Table 2 of the Order, the effluent limitation for total dissolved solids is 400 milligrams per liter (mg/L), for sulfate is 50 mg/L, for chloride is 50 mg/L, for boron is 0.5 mg/L, and for nitrogen is 10 mg/L as nitrate-nitrogen plus nitrite-nitrogen based on the groundwater quality objectives for the Basin. The advanced OWTS at the Site is defined as a secondary treatment system. Therefore, total coliform in the effluent shall not exceed 23 and 240 MPN/100 mL for monthly average and weekly average, respectively. Since there is no filtration system, turbidity limitations in Section III.B are not applicable. In addition, chlorination by-product limitations specified in Section III.C.3 are not applicable.

Should changes affecting the operation of the wastewater treatment system at the Site be needed, revised engineering drawings showing the change must be filed with the Regional Water Board a minimum of thirty days prior to the change. You must receive approval from the Regional Water Board prior to making any changes to the Site.

The MRP requires you to implement the monitoring program on the effective date of coverage under this permit. When submitting monitoring or technical reports to the Regional Water Board per these requirements, please include a reference to "Compliance File No. CI-10601", which will assure that the reports are directed to the appropriate file and staff. Also, please do not combine other reports with your monitoring reports. Submit each type of report as a separate document.

You shall comply with the Electronic Submittal of Information (ESI) requirements by submitting all reports required under the MRP, including monthly water usage, and pdf format monitoring reports to the State Water Resources Control Board GeoTracker database under Global ID WDR100053164.

Please see Paperless Office Notice for GeoTracker Users, dated December 21, 2011 for further details at: [Paperless Office for GT Users.pdf \(ca.gov\)](http://www.waterboards.ca.gov/losangeles/resources/Paperless/Paperless%20Office%20for%20GT%20Users.pdf) (<http://www.waterboards.ca.gov/losangeles/resources/Paperless/Paperless%20Office%20for%20GT%20Users.pdf>)

Should you sell or transfer this property, you are required to disclose the terms of the waste discharge requirements to the new property owner and submit the enclosed Board Order Transfer Request Form signed by the new owner with your written request for termination of enrollment under the General WDRs.

To avoid paying future annual fees, please submit a written request for termination of your enrollment under the General WDRs in a separate letter if your Site is connected to a sewer system and the permit is no longer needed. Be aware that the annual fee covers the fiscal year billing period beginning July 1 and ending June 30, the following year. You will pay the full annual fee if your request for termination is made after the beginning of the new fiscal year beginning July 1.

If you have any additional questions, please contact the Project Manager, Dr. Woonhoe Kim, at (213) 620-2264 ([woonhoe.kim@waterboards.ca.gov](mailto:woonhoe.kim@waterboards.ca.gov)) or the Chief of Groundwater Permitting Unit, Dr. James Kang, at (213) 576-6684 ([jim.kang@waterboards.ca.gov](mailto:jim.kang@waterboards.ca.gov)).

Sincerely,

Renee Purdy  
Executive Officer

Enclosures:

1. General WDR [Order No. R4-2019-0024](#)
2. Monitoring and Reporting Program No. CI-10601
3. Board Order Transfer Request Form

Mr. John Havel  
John Havel Residence

4

August 13, 2021

cc (via email): Mr. Lyndon You, The Friday Group, [gazebo35@yahoo.com](mailto:gazebo35@yahoo.com)  
Mr. Dan Ryan Evangelista, City of Los Angeles Department of Building  
and Safety, [dan.evangelista@lacity.org](mailto:dan.evangelista@lacity.org)  
Mr. Fahrudin (Dean) Zulcic, Los Angeles County Department of Public  
Health, [fzulcic@ph.lacounty.gov](mailto:fzulcic@ph.lacounty.gov)

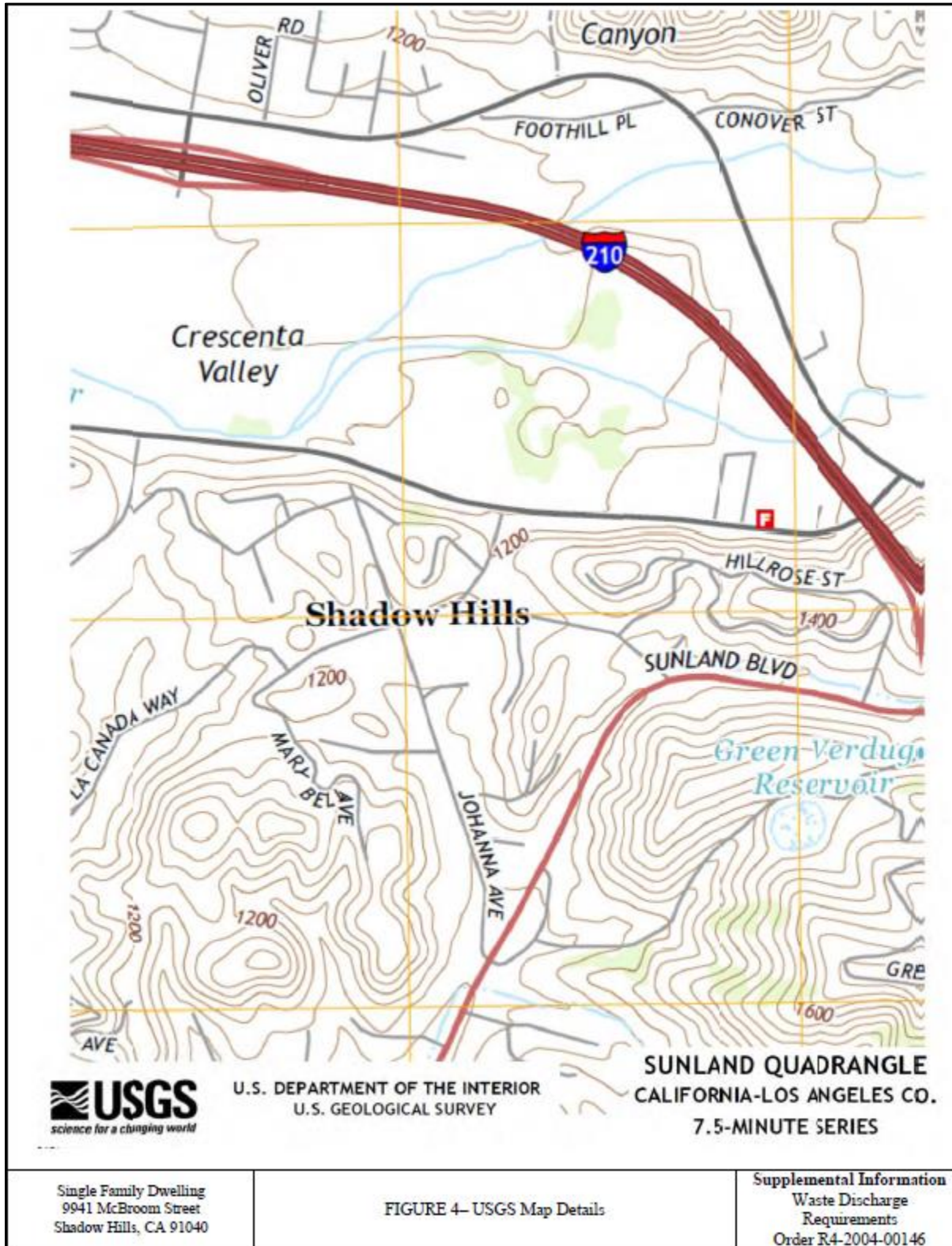

Figure 1. Location of the John Havel Residence

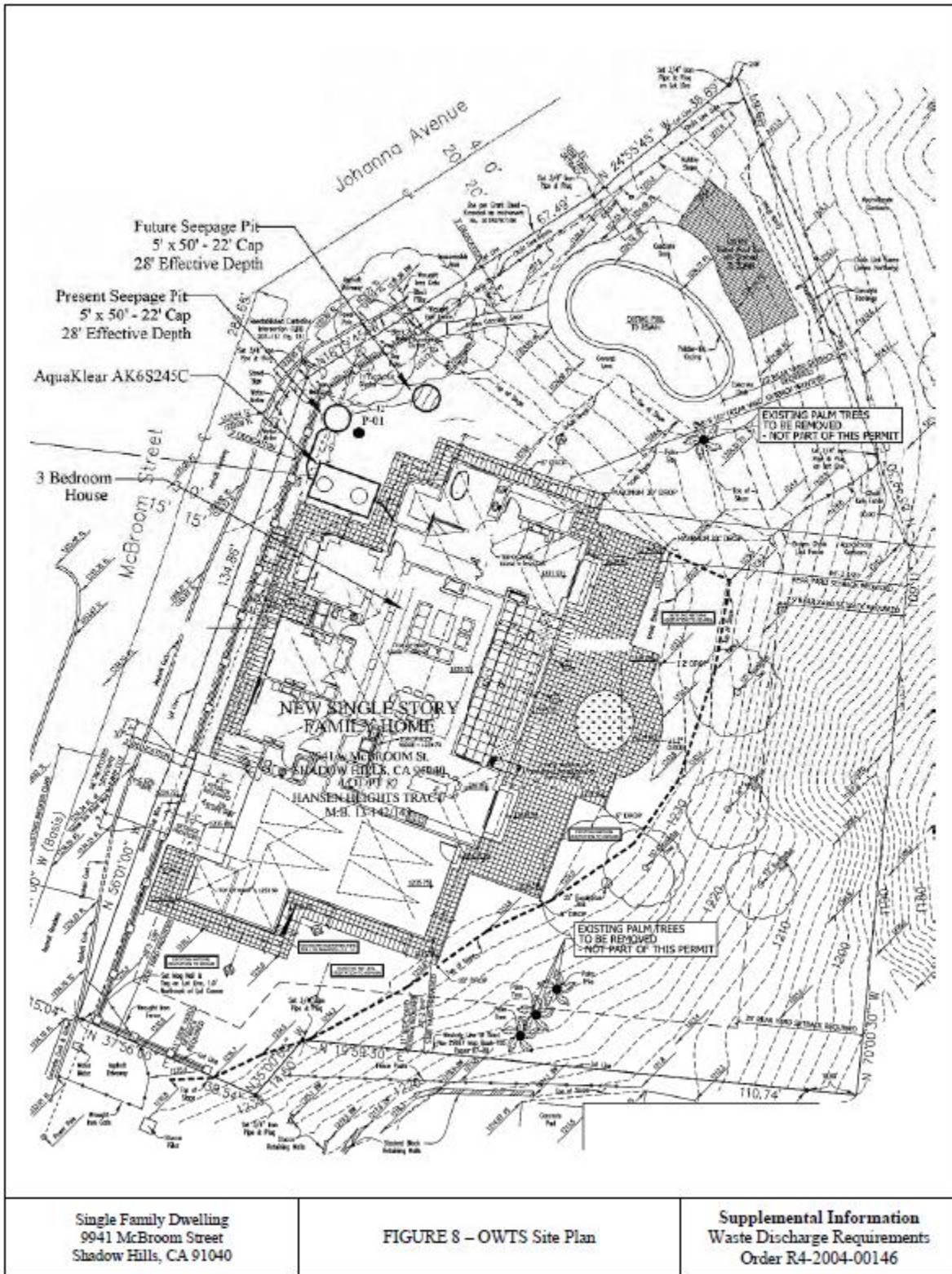

Figure 2. Site Plan of the New House and the Advanced Onsite Wastewater Treatment System



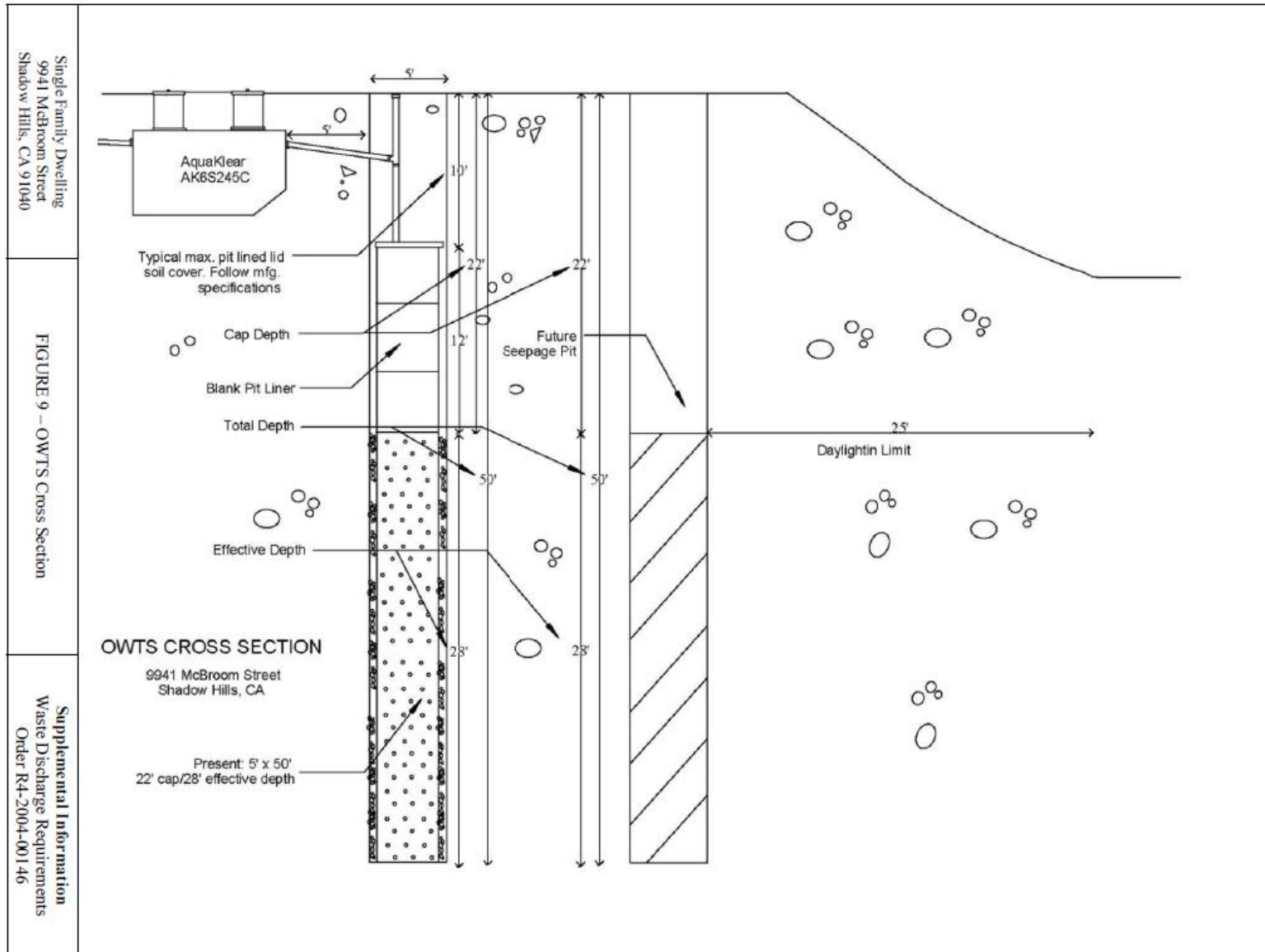

Figure 4. Cross-section View of Seepage Pit



**STATE OF CALIFORNIA  
LOS ANGELES REGIONAL WATER QUALITY CONTROL BOARD**

**MONITORING AND REPORTING PROGRAM NO. CI-10601  
FOR  
ADVANCED ONSITE WASTEWATER TREATMENT SYSTEM  
ORDER NO. R4-2019-0024 (SERIES NO. 020)  
FILE NO. 20-117**

**I. REPORTING REQUIREMENTS**

A. The effective date of this Monitoring and Reporting Program (MRP) No. CI-10601 is August 13, 2021. Mr. John Havel (hereinafter Permittee) shall implement this MRP immediately for the discharge from the Permittee's Advanced Onsite Wastewater Treatment System (Advanced OWTS). The first quarterly monitoring report is due October 30, 2021.

Quarterly monitoring reports shall be received by the dates specified in Table 1.

**Table 1. Quarterly Monitoring Reporting Period and Due Date**

<b>Reporting Period</b>	<b>Reporting Due</b>
January – March	April 30
April – June	July 30
July – September	October 30
October – December	January 30

B. In reporting the monitoring data, the Permittee shall arrange the data in tabular form so that the date, the constituents, and the concentrations are readily discernible. The data shall be summarized to demonstrate compliance with the requirements and, where applicable, shall include results of receiving water observations.

C. Any mitigation/remedial activity including any pre-discharge treatment conducted at the site must be reported in the quarterly monitoring report.

D. If there is no discharge during any reporting period, the report shall so state.

E. Each quarterly monitoring report shall contain a separate section titled "Summary of Non-Compliance" located at the front of the report. This section shall clearly list all non-compliance with the Waste Discharge Requirements (WDRs), including any excursion(s) of effluent and receiving groundwater limitations. For every item

where the requirements were not met, the Permittee shall include a statement of the cause(s) of non-compliance and the corrective actions undertaken or proposed that will bring the discharge into full compliance with the WDRs at the earliest possible time, including a timetable for implementation of those actions.

- F. By January 30<sup>th</sup> of each year, beginning January 30, 2022, the Permittee shall submit an annual summary report to the Los Angeles Regional Water Quality Control Board (Regional Water Board). The report shall contain both tabular and graphical summaries of the monitoring data obtained during the previous calendar year. In addition, the Permittee shall explain the compliance record and the corrective actions taken or planned, which may be needed to bring the discharge into full compliance with the WDRs.
- G. Laboratory analyses – all chemical, bacteriological, and/or toxicity analyses shall be conducted at a laboratory certified for such analyses by the State Water Resources Control Board, Division of Drinking Water (SWRCB-DDW) Environmental Laboratory Accreditation Program (ELAP). A copy of the laboratory certifications shall be provided each time a new analysis is used and/or renewal is obtained from ELAP.
- H. The method limits (MLs) employed for effluent analyses shall be lower than the permit limits established for a given parameter, unless the Permittee can demonstrate that a particular ML is not attainable and obtains approval for a higher ML from the Executive Officer. At least once a year, the Permittee shall submit a list of the analytical methods employed for each test and the associated laboratory quality assurance/quality control (QA/QC) procedures.
- I. Water/wastewater samples must be analyzed within allowable holding time limits as specified in 40 CFR Part 136.3. All QA/QC samples must be run on the same dates when samples were actually analyzed. The Permittee shall make available for inspection and/or submit the QA/QC documentation upon request by Regional Water Board staff. Proper chain of custody procedures must be followed and a copy of the chain of custody documentation shall be submitted with the report.
- J. Each monitoring report must affirm in writing that “All analyses were conducted at a laboratory certified for such analyses by the SWRCB-DDW ELAP, and in accordance with current United States Environmental Protection Agency (USEPA) guideline procedures or as specified in this Monitoring Program.” Proper chain of custody procedures must be followed and a copy of the completed chain of custody form shall be submitted with the report.
- K. The Permittee shall maintain all sampling and analytical results, including strip charts, date, exact place, and time of sampling, dates analyses were performed, analyst’s name, analytical techniques used, and results of all analyses. Such

records shall be retained for a minimum of three years. This period of retention shall be extended during the course of any unresolved litigation regarding this discharge, or when requested by the Regional Water Board.

L. All monitoring reports must include, at minimum, the following:

1. Well or location identification, date and time of sampling; and
2. Sampler identification, laboratory identification; and chain of custody.

M. The Permittee shall include the start-up date of the Advanced OWTS in the quarterly monitoring report when the first effluent samples are collected.

## **II. ADVANCED ONSITE WASTEWATER TREATMENT AND DISPOSAL SYSTEM MONITORING REQUIREMENTS**

A. Maintenance reporting: The Permittee shall annually submit an operation and maintenance report for the Advanced OWTS. The information to be contained in the report shall include, at a minimum, the following:

1. The name and address of the person or company responsible for the operation and maintenance of the Advanced OWTS;
2. Type of maintenance (preventive or corrective action performed);
3. Frequency of maintenance, if preventive;
4. Any pumping required for the Advanced OWTS, including date(s) and volume(s); and
5. Maintenance records for the Advanced OWTS.

B. Influent monitoring reports shall measure the monthly average and daily maximum wastewater flow from the collection system to the Advanced OWTS.

C. An effluent sampling station shall be established at a location where representative samples of treated effluent can be obtained prior to discharge to the seepage pit and/or leach field disposal/subsurface drip irrigation system. Monitoring shall be conducted as described in the table below. The following shall constitute the effluent monitoring program, as specified in Table 2.

D. A grab sample is an individual sample collected in a short period of time not exceeding 15 minutes. Grab samples shall be collected during normal peak loading conditions for the parameter of interest, which may or may not be during hydraulic peaks.

E. Frequency of Analysis – The effluent shall be sampled monthly for the first 3 months after start-up of the Advanced OWTS and quarterly thereafter except for the total flow in Table 2 below.

**Table 2. Effluent Monitoring Requirements for the Advanced OWTS**

<b>Constituent</b>	<b>Unit</b>	<b>Type of Sample</b>	<b>Frequency of Analysis</b>
Total flow	gallons per day	Recorder	Continuous
pH	standard unit	Grab	Monthly/Quarterly
Biochemical oxygen demand (5-day BOD)	mg/L	Grab	Monthly/Quarterly
Oil and grease	mg/L	Grab	Monthly/Quarterly
Total dissolved solids	mg/L	Grab	Monthly/Quarterly
Sulfate	mg/L	Grab	Monthly/Quarterly
Chloride	mg/L	Grab	Monthly/Quarterly
Boron	mg/L	Grab	Monthly/Quarterly
Ammonia as nitrogen	mg/L	Grab	Monthly/Quarterly
Nitrate as nitrogen	mg/L	Grab	Monthly/Quarterly
Nitrite as nitrogen	mg/L	Grab	Monthly/Quarterly
Total nitrogen	mg/L	Grab	Monthly/Quarterly
Total coliform	MPN/100mL	Grab	Monthly/Quarterly
Fecal coliform	MPN/100mL	Grab	Monthly/Quarterly

Notes: mg/L = milligrams per liter; MPN/100 mL = most probable number per 100 mL

### **III. GROUNDWATER MONITORING PROGRAM**

Groundwater monitoring program is not required at this time. In the future, the Executive Officer may determine that a groundwater monitoring program is needed to fully evaluate the impact from your wastewater discharge in groundwater.

### **IV. WASTE HAULING REPORTING**

In the event that waste sludge or other wastes are hauled offsite, the name and address of the hauler shall be reported, along with types and quantities hauled during the reporting period and the location of the final point of disposal. In the event that no wastes are hauled during the reporting period, a statement to that effect shall be submitted.

**V. MONITORING FREQUENCIES**

Specifications in this monitoring program are subject to periodic revision. Monitoring requirements may be modified or revised by the Executive Officer based on review of monitoring data submitted pursuant to this MRP. Monitoring frequencies may be adjusted to a less frequent basis or parameters and locations dropped from the MRP by the Executive Officer if the Permittee makes a request and the request is backed by statistical trends of monitoring data submitted.

**VI. ELECTRONIC SUBMITTAL OF INFORMATION**

The Permittee shall comply with the Electronic Submittal of Information (ESI) requirements by submitting all reports required under the MRP, discharge location coordinate data, and monitoring reports in Portable Document Format (pdf) to the State Water Resource Control Board GeoTracker database under Global ID WDR100053164.

**VII. CERTIFICATION STATEMENT**

Each report shall contain the following completed declaration:

“I certify under penalty of law that this document, including all attachments and supplemental information, was prepared under my direction or supervision in accordance with a system designed to assure that qualified personnel properly gathered and evaluated the information submitted. Based on my inquiry of the person or persons who manage the system, or those persons directly responsible for gathering the information, the information submitted is, to the best of my knowledge and belief, true, accurate, and complete. I am aware that there are significant penalties for submitting false information, including the possibility of a fine and imprisonment.

Executed on the \_\_\_\_\_ day of \_\_\_\_\_ at \_\_\_\_\_

\_\_\_\_\_ (Signature)

\_\_\_\_\_ (Title)”

These records and reports are public documents and shall be made available for inspection during normal business hours at the office of the California Regional Water Quality Control Board, Los Angeles Region.

Ordered by

Date: August 13, 2021

Renee Purdy  
Executive Officer



# Los Angeles Regional Water Quality Control Board

## BOARD ORDER TRANSFER REQUEST FORM

Boar Order No. \_\_\_\_\_

CI No. \_\_\_\_\_

Facility Location: \_\_\_\_\_  
Street Address City Zip

I request the transfer of the existing waste discharge requirements (WDRs) on \_\_\_\_\_ (effective date), contained in the above-referenced Board Order in accordance with the following:

### TRANSFER FROM:

### TRANSFER TO:

\_\_\_\_\_  
Former Facility Name

\_\_\_\_\_  
New Facility Name

\_\_\_\_\_  
Former Property Owner

\_\_\_\_\_  
New Property Owner

\_\_\_\_\_  
Former Operator

\_\_\_\_\_  
New Operator

I understand that I am responsible for compliance with the Board Order and will be billed an annual fee for the waste discharge from this facility. I certify that:

1. I have reviewed the Report of Waste Discharge and the Board Order;
2. The facility construction and discharges from the site have not substantially changed; and
3. I will notify the Board of any material change in this facility, any change in the amount, type or manner of waste discharge or any future change in the facility owner or operator.

\_\_\_\_\_  
Signature (New Owner/Authorized Representative)

\_\_\_\_\_  
Company name, if appropriate

\_\_\_\_\_  
Print Name (New Owner/Authorized Representative)

\_\_\_\_\_  
Telephone No.

\_\_\_\_\_  
Date

\_\_\_\_\_  
Title

\_\_\_\_\_  
Email

Mailing Address: \_\_\_\_\_  
Street Address City Zip

\_\_\_\_\_  
Facility Contact Person

\_\_\_\_\_  
Telephone No.

\_\_\_\_\_  
Email

Facility Contact Mailing Address: \_\_\_\_\_  
Street Address City Zip

LAWRENCE YEE, CHAIR | RENEE PURDY, EXECUTIVE OFFICER