



Los Angeles Regional Water Quality Control Board

December 21, 2021

Mr. George Bartecek
4051 Rosemond Avenue
Montrose, CA 91220
georgebartecek@yahoo.com

Via Email Only

GENERAL WASTE DISCHARGE REQUIREMENTS FOR AN ADVANCED ONSITE WASTEWATER TREATMENT SYSTEM AT GEORGE BARTECEK RESIDENCE LOCATED AT 9464 HILLHAVEN AVENUE, TUJUNGA, CALIFORNIA 91042 (FILE NO. 21-057, WDR ORDER NO. R4-2019-0024, SERIES NO. 027, CI-10628, GLOBAL ID WDR100053942)

Dear Mr. Bartecek:

The Los Angeles Regional Water Quality Control Board (Regional Water Board) is the public agency with primary responsibility for the protection of ground and surface water quality for all beneficial uses of water within major portions of Los Angeles and Ventura Counties. The subject property is within the Regional Water Board jurisdiction.

SUMMARY OF TECHNICAL REPORTS

On June 10, 2021, the Los Angeles Regional Water Quality Control Board (Regional Water Board) received an application for Waste Discharge Requirements (WDRs) submitted by Mr. George Bartecek (Discharger). The Discharger proposes to install an advanced onsite wastewater treatment system (AOWTS) to treat domestic wastewater at the Bartecek Residence (Site) located at 9464 Hillhaven Avenue, Tujunga, California 91042 (Figure 1).

The Site is on a 0.11-acre lot. It is currently vacant and within the Tujunga suburb and the City of Los Angeles. The proposed project includes construction of a single-family residence with three bedrooms, 3.5 bathrooms, a laundry room, and a kitchen. The domestic wastewater from the Site will be discharged to the proposed AOWTS and two seepage pits (Figure 2).

The proposed AOWTS (Model No. AK6S245C) is certified to meet NSF/ANSI Standard 245. The AOWTS consists of an 1,883-gallon packaged system with a pretreatment tank, an aeration basin, two clarifiers, two seepage pits, and two future expansion seepage pits. All seepage pits are 5 feet in diameter and 18 feet deep with a 14-foot effective depth (Figures 3 and 4). The design capacity for the AOWTS is 600 gallons per day (gpd). The

LAWRENCE YEE, CHAIR | RENEE PURDY, EXECUTIVE OFFICER

estimated wastewater flowrate from the Site is 450 gpd (3 bedrooms x 150 gpd per bedroom). The maximum discharge flowrate shall not exceed 600 gpd.

Results of the percolation test performed at the Site in April 2021 indicated that the percolation rate at the Site is between 11.54 and 22.77 gallons per square feet per day (gal/sq.ft./day). The City of Los Angeles requires any OWTS cases that have a percolation greater than 5.12 gal/sq.ft./day install an AOWTS and shall be referred to the Los Angeles Regional Water Quality Control Board for WDRs.

SUMMARY OF REGIONAL WATER BOARD REVIEW AND REQUIREMENTS

You are required to obtain WDRs because the geological conditions at the Site cannot be covered by the Conditional Waiver of Waste Discharge Requirements in the Water Quality Control Policy for Siting, Design, Operation, and Maintenance of Onsite Wastewater Treatment Systems (OWTS Policy), adopted by the State Water Resources Control Board on June 19, 2012 and amended on April 17, 2018.

Regional Water Board staff has reviewed the information provided and determined that the proposed discharge meets the conditions specified in General WDRs Order No. R4-2019-0024, *General Waste Discharge Requirements for Advanced Wastewater Treatment Systems*, adopted by the Regional Water Board on February 14, 2019.

Enclosed are your General WDRs, consisting of Order No. R4-2019-0024, Monitoring and Reporting Program (MRP) No. CI-10628, and Standard Provisions Applicable to WDRs (Attachment E of the Order). Based on the location of the Site and anticipated performance of the proposed AOWTS, the requirements specified in Order No. R4-2019-0024, including effluent quality limitations specified in Section III and numeric limitations in Table 2, are applicable to your discharge. At this time, the groundwater limitations specified in Section IV.B (Table 4) are not applicable to your discharge and groundwater monitoring is not required.

The Site discharges to the San Fernando Valley Groundwater Basin-Sunland-Tujunga area subbasin (Basin). Consistent with Table 2 of the Order, the effluent limitation for total dissolved solids is 400 milligrams per liter (mg/L), for sulfate is 50 mg/L, for chloride is 50 mg/L, for boron is 0.5 mg/L, and for nitrogen is 10 mg/L as nitrate-nitrogen plus nitrite-nitrogen based on the groundwater quality objectives for the Basin. The AOWTS at the Site is performed as a secondary treatment system. Therefore, total coliform in the effluent shall not exceed 23 and 240 MPN/100 mL as a monthly average and weekly average, respectively. In addition, since there is no chlorination, effluent limitations for total residual chlorine and chlorination by-product limitations specified in Section III.C.3 are not applicable.

Should changes affecting the operation of the wastewater treatment system at the Site be needed, revised engineering drawings showing the change must be filed with the Regional Water Board a minimum of thirty days prior to the change. You must receive approval from the Regional Water Board prior to making any changes to the Site.

The MRP requires you to implement the monitoring program on the effective date of coverage under this permit. When submitting monitoring or technical reports to the Regional Water Board per these requirements, please include a reference to "Compliance File No. CI-10628", which will assure that the reports are directed to the appropriate file and staff. Also, please do not combine other reports with your monitoring reports. Submit each type of report as a separate document.

You shall comply with the Electronic Submittal of Information (ESI) requirements by submitting all reports required under the MRP, including monthly water usage, and pdf format monitoring reports to the State Water Resources Control Board GeoTracker database under Global ID WDR100053942.

Please see Paperless Office Notice for GeoTracker Users, dated December 21, 2011 for further details at:

<http://www.waterboards.ca.gov/losangeles/resources/Paperless/Paperless%20Office%20for%20GT%20Users.pdf>

You must discontinue use of the AOWTS and connect to the sanitary sewer service within 12 months of sewer availability within 200 feet of the property served by the AOWTS.

Should you sell or transfer this property, you are required to disclose the terms of the waste discharge requirements to the new property owner and submit the enclosed Board Order Transfer Request Form signed by the new owner with your written request for termination of enrollment under the General WDRs.

To avoid paying future annual fees, please submit a written request for termination of your enrollment under the General WDRs in a separate letter if your Site is connected to a sewer system and the permit is no longer needed. Be aware that the annual fee covers the fiscal year billing period beginning July 1 and ending June 30, the following year. You will pay the full annual fee if your request for termination is made after the beginning of the new fiscal year beginning July 1.

If you have any additional questions, please contact the Project Manager, Dr. Woonhoe Kim, at woonhoe.kim@waterboards.ca.gov or the Chief of Groundwater Permitting Unit, Dr. James Kang, at jim.kang@waterboards.ca.gov.

Sincerely,

Renee Purdy
Executive Officer

Enclosures:

1. General WDR Waste Discharge Requirements Order No. R4-2019-0024 with the Standard Provisions Applicable to WDRs are available at the Regional Water Board website:
https://www.waterboards.ca.gov/losangeles/board_decisions/adopted_orders/index.html#2
2. Monitoring and Reporting Program No. CI-10628
3. Board Order Transfer Request Form
4. Figure 1. Location of the Bartecek Residence at 9464 Hillhaven Avenue, Tujunga, California 91042
5. Figure 2. Site Plan of the Bartecek Residence and Advanced Onsite Wastewater Treatment System
6. Figure 3. Configuration of the Advanced Onsite Wastewater Treatment System
7. Figure 4. Cross-section of the Seepage Pits

cc (via email): Mr. Lyndon Ong Yiu, The Friday Group, gazebo35@yahoo.com
Mr. Dan Ryan Evangelista, City of Los Angeles Department of Building and Safety, dan.evangelista@lacity.org
Ms. Isabella Kwok, Los Angeles County Department of Public Health, ikwok@ph.lacounty.gov

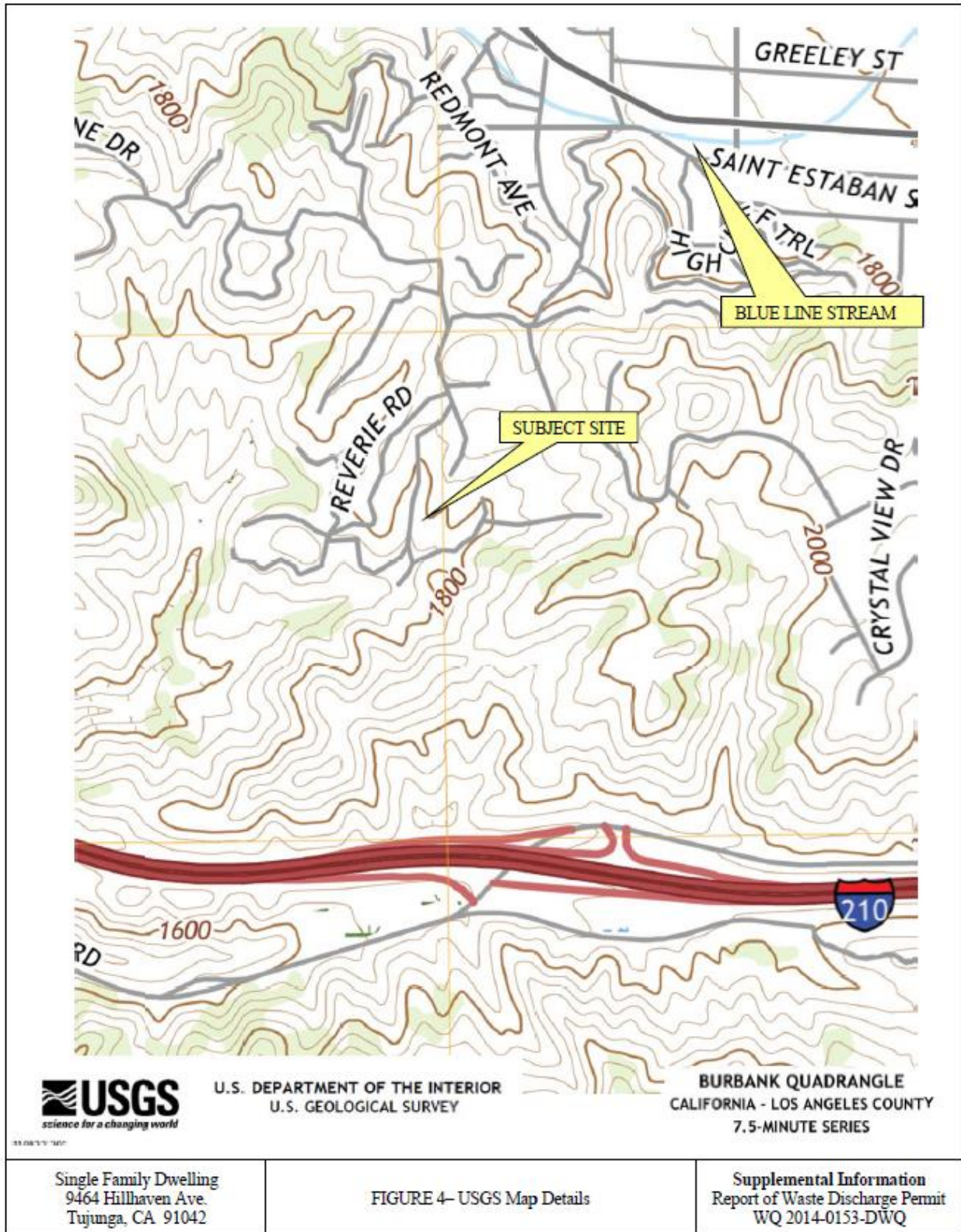

Figure 1. Location of the Bartecek Residence at 9464 Hillhaven Avenue, Tujunga, California 91042

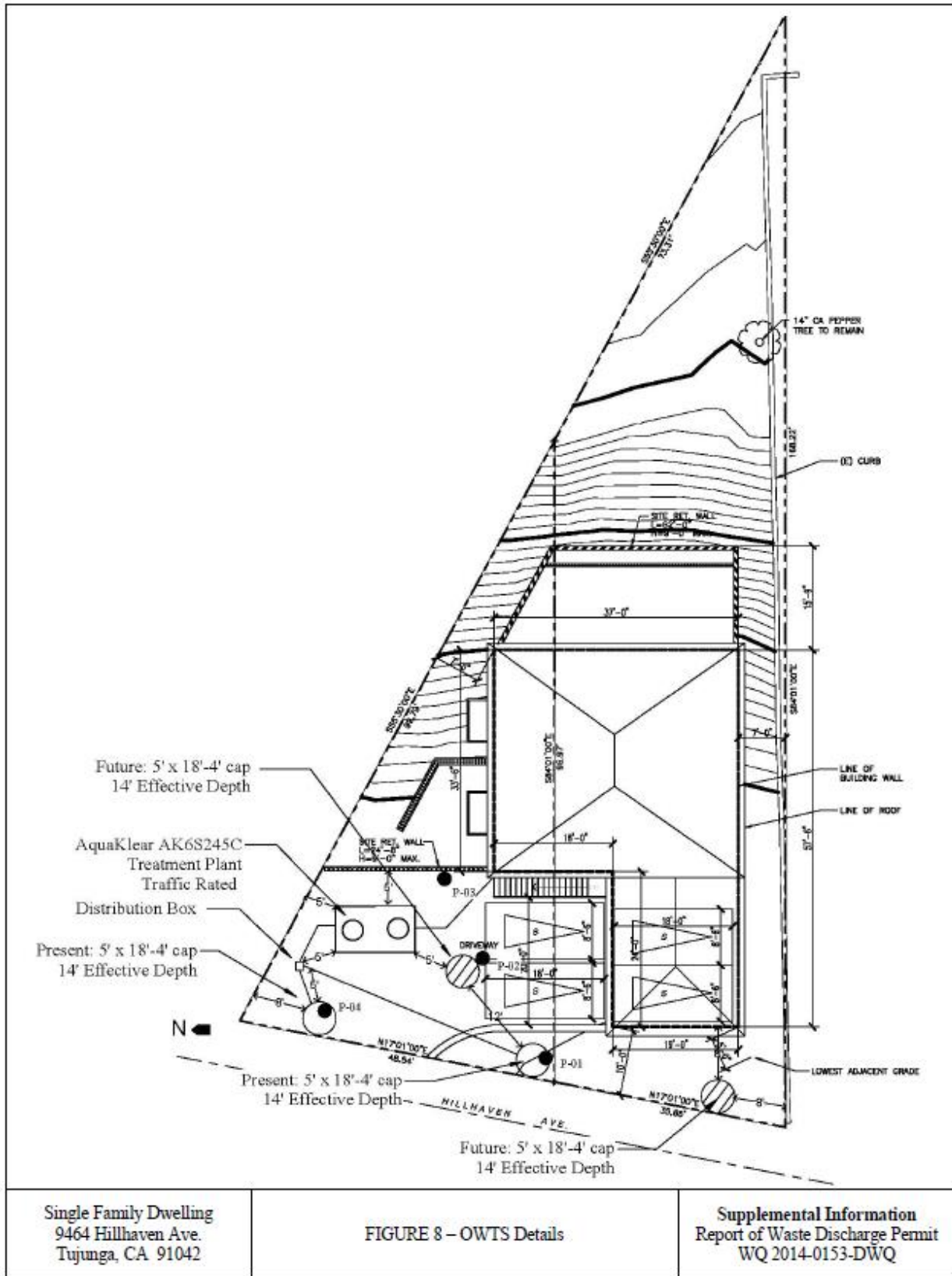

Figure 2. Site Plan of the Bartecek Residence and Advanced Onsite Wastewater Treatment System

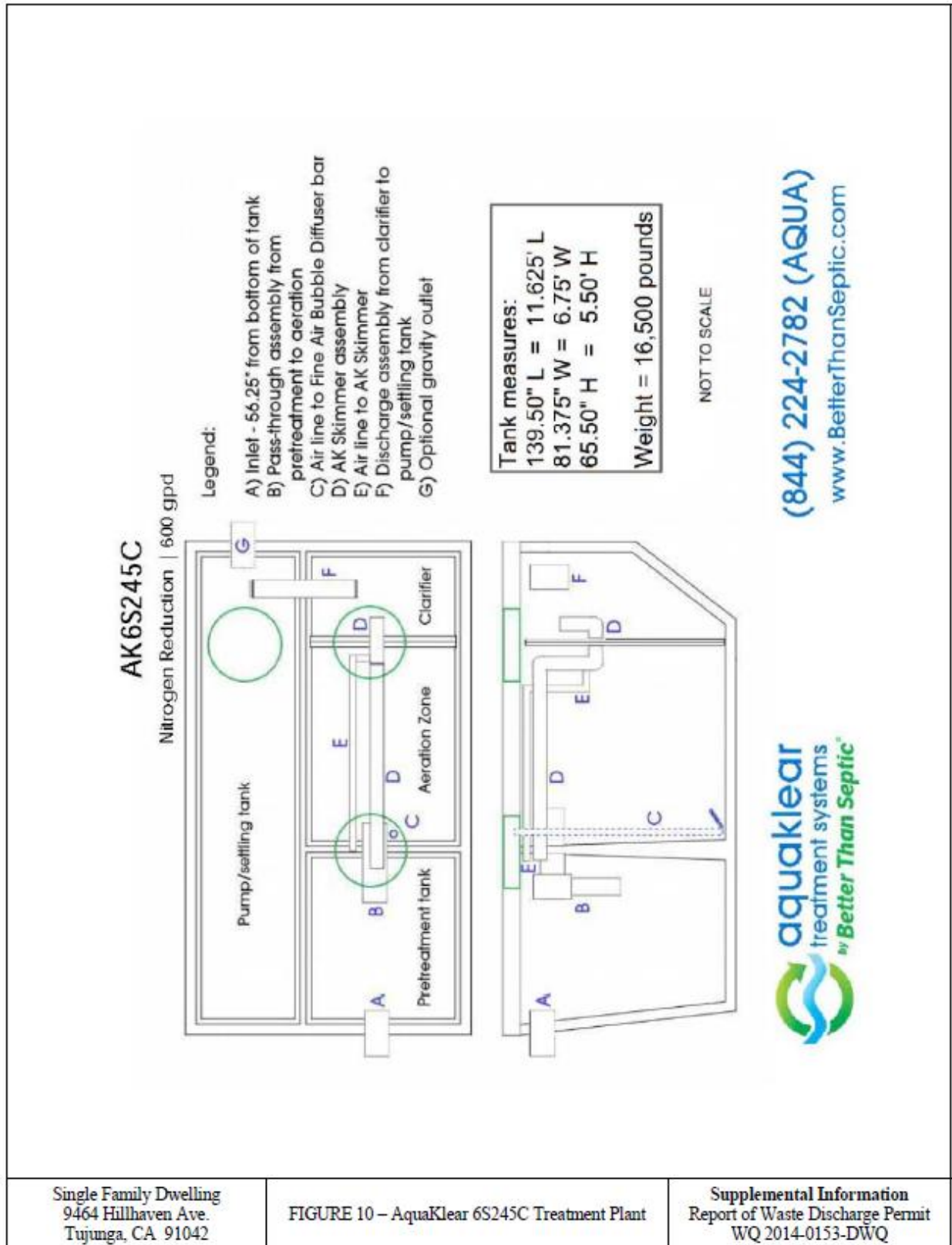

Figure 3. Configuration of the Advanced Onsite Wastewater Treatment System

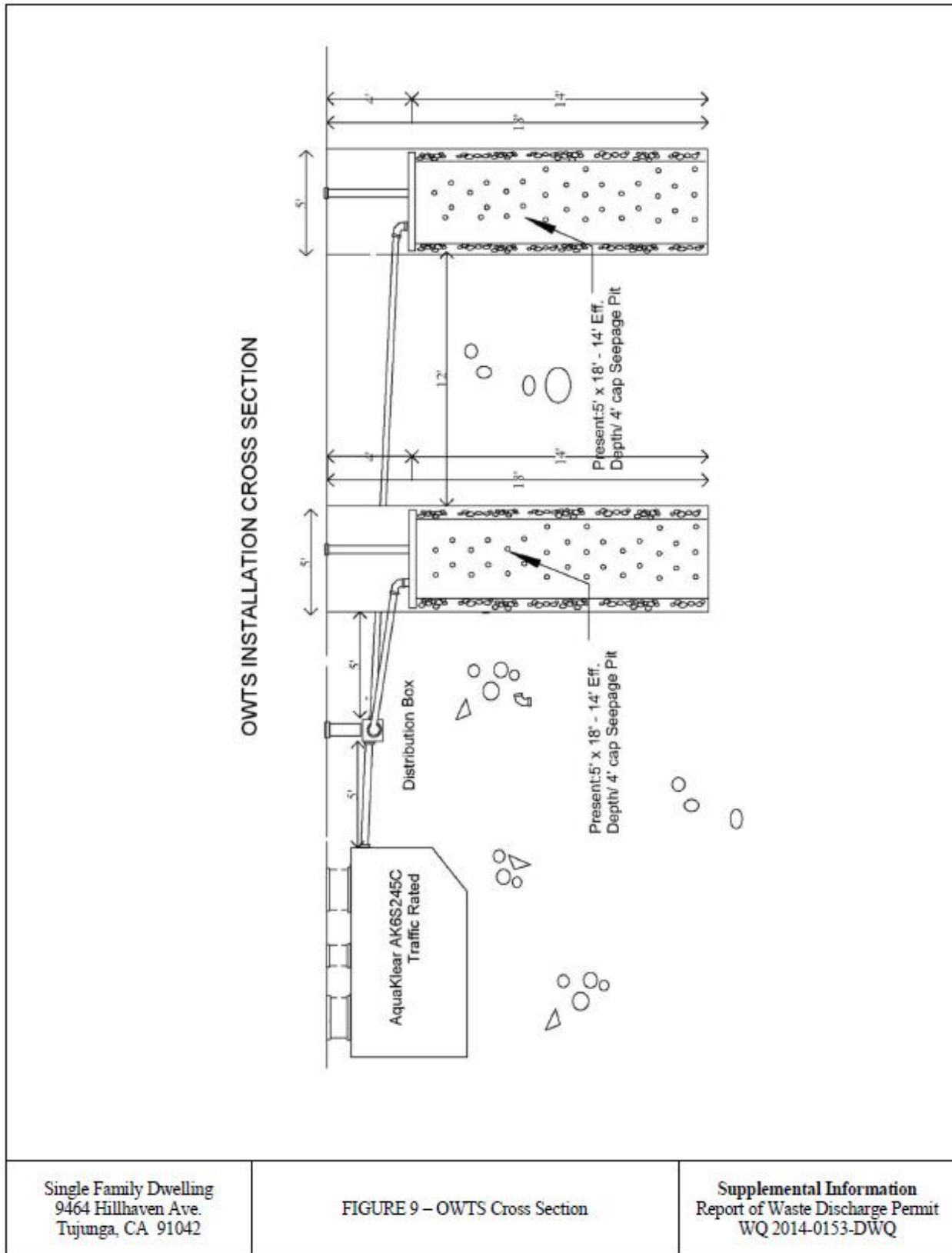

Figure 4. Cross-section of the Seepage Pits