

State of California
CALIFORNIA REGIONAL WATER QUALITY CONTROL BOARD, LOS ANGELES REGION

ORDER NO. 87-93

WASTE DISCHARGE REQUIREMENTS
FOR

W. ATLEE BURPEE COMPANY

(File No. 62-76)

The California Regional Water Quality Control Board, Los Angeles Region, finds:

1. W. Atlee Burpee Company, a corporation, (hereinafter called the discharger) discharges wastewater under the requirements contained in Resolution No. 62-68, adopted by this Board on October 24, 1962.
2. A review of the current requirements has been conducted by Board staff in accordance with regulations contained in the California Administrative Code, Title 23, Chapter 3, Subchapter 9, Article 2, Section 2232.2.
3. W. Atlee Burpee Company operates a seed washing and conditioning plant for flower and vegetable seed recovery at 335 South Briggs Road, Santa Paula. The wastewater from this process, which is seasonal, is used for surface irrigation of seed crops on an 8-acre plot onsite. The washwater from harvested seed crops is drained to a concrete-lined sump, then pumped to a SWECO separator for primary sedimentation using a high speed vibration process. The effluent, approximately 10,000 gallons per day, from this separator then gravity flows to the field as seed crop irrigation water. The wastewater from this process is disposed of by spreading over the seed crop growing plots land surrounding the washing facilities. The discharge of effluent is rotated to different plots of ground to avoid concentration of wastewater on any given area.
4. The disposal site is located in the NW 1/4 of the NE 1/4 of Section 29, T3N, R21W, S.B.B.&M and overlies the Santa Paula Subarea within the Santa Paula Subunit.
6. The Board adopted a revised Water Quality Control Plan for Santa Clara River Basin on April 27, 1978. The Water Quality Control Plan contains water quality objectives for ground water of the Santa Paula Subarea of the Santa Paula Subunit. The requirements contained in this Order, as they are met, will be in conformance with the goals of the Water Quality Control Plan.

44562/5001

7. The beneficial uses of the ground water within the Santa Paula Subarea are municipal and domestic supply, agricultural supply, industrial service supply, and industrial process supply.
8. Water samples previously obtained from the on-site wells indicate sulfate concentrations of 820 to 872 ppm and TDS concentrations of 2,240 to 2,283 ppm. This well water is used for both the washing plant water and for field irrigation of seed crops.
9. This project involves an existing facility and as such is exempt from the provisions of the California Environmental Quality Act in accordance with California Administrative Code, Title 14, Chapter 3, Section 15301.

The Board has notified the discharger and interested agencies and persons of its intent to prescribe waste discharge requirements for this discharge and has provided them with an opportunity to submit their written views and recommendations.

The Board in a public meeting heard and considered all comments pertaining to the discharge and to the tentative requirements

IT IS HEREBY ORDERED, that W. Atlee Burpee Company, shall comply with the following:

A. Waste discharge requirements

1. Wastes discharged shall be limited to washwater resulting from the washing of flower and vegetable seeds only, as proposed.
2. Wastes discharged to the ground at this site shall not contain constituents in concentrations greater than those listed below:

<u>Constituent</u>	<u>Unit</u>	<u>Maximum Limitation</u>
Total dissolved solid	mg/l	2,500
Chloride	mg/l	200
Sulfate	mg/l	900
Boron	mg/l	1.5
pH	pH unit	6.0 - 9.0

2. Neither the treatment nor discharge of wastes shall cause a condition of pollution or nuisance, or problems due to breeding of mosquitos, midges, flies, or other pests.

3. Wastes shall be discharged only on property owned or controlled by the discharger.
4. Odors of waste origin shall not be perceivable beyond the limits of the property owned or controlled by the discharger.
5. Wastes discharged shall be retained at all times on the site and shall be prevented from reaching any natural watercourse or drainage channel.
6. All wastes which do not meet each of the foregoing requirements shall be held in impervious containers. If transferred elsewhere, the final destination shall be to a legal point of disposal, and the transfer shall be in accordance with the provisions of Division 7.5 of the Water Code. For the purpose of these requirements, a legal point of disposal is defined as one for which waste discharge requirements have been established by a California Regional Water Quality Control Board, and which is in full compliance therewith.
8. Wastes discharged shall at no time contain any substance in concentrations toxic to human, animal, plant, or aquatic life.
9. Neither the treatment nor discharge of wastes shall cause pollution or nuisance.

B. Provisions

1. A copy of this Order shall be maintained where it will be available at all times to operating personnel.
2. In the event of any change of ownership of the land or waste discharge facilities presently owned or controlled by the discharger, the discharger shall notify this Board of such change and shall notify the succeeding owner or operator of the existence of this Order by letter, a copy of which shall be forwarded to this Board.
3. In accordance with Section 13260(b) of the Water Code, the discharger shall file a report of any material change or proposed change in the character, location or volume of the discharge prior to initiation of the change.
4. The discharger shall notify this Board immediately by

telephone of any adverse condition resulting from this discharge, such notification to be affirmed in writing within two weeks.

5. In accordance with Section 13267 of the Water Code, the discharger shall furnish, under penalty of perjury, technical monitoring program reports. These reports shall be submitted in accordance with specifications prepared by the Executive Officer, which specifications are subject to periodic revisions as may be warranted.
6. These waste discharge requirements do not exempt the operator of these waste disposal facilities from compliance with any other laws, regulations, or ordinances which may be applicable, they do not legalize these waste disposal facilities, and they leave unaffected any further restraints on these facilities which may be contained in other statutes or required by other agencies.
7. In accordance with Section 13263(e) of the Water Code, these waste discharge requirements are subject to periodic review and revision by this Regional Board.
8. Resolution No. 62-68, adopted by this Board on October 24, 1962, is hereby rescinded.

I, Robert P. Ghirelli, Executive Officer, do hereby certify that the foregoing is a full, true, and correct copy of an Order adopted by the California Regional Water Quality Control Board, Los Angeles Region, on June 22, 1987.

Robert P. Ghirelli

ROBERT P. GHIRELLI, D.Env.
Executive Officer

GK/

State of California
CALIFORNIA REGIONAL WATER QUALITY CONTROL BOARD, LOS ANGELES REGION

MONITORING AND REPORTING PROGRAM NO. 4246
FOR

W. ATLEE BURPEE COMPANY
(File No. 62-76)

The discharger shall implement this monitoring program within 60 days of the effective date of this Order.

Monitoring reports shall be submitted by the dates in the following schedule:

<u>Reporting Period</u>	<u>Report Due</u>
January - March	April 15
April - June	July 15
July - September	October 15
October - December	January 15

*Monitoring reports
due quarterly*

The first monitoring report under this program shall be submitted by October 15, 1987.

By January 30 of each year, beginning in 1988, the discharger shall submit an annual report to the board. The report shall contain both tabular and graphical summaries of the monitoring data obtained during the previous year. In addition, the discharger shall discuss the compliance record and the corrective actions taken or planned which may be needed to bring the discharge into full compliance with the Waste Discharge Requirements.

Effluent Monitoring

A sampling station shall be established for each point of discharge and shall be located where representative samples of that effluent can be obtained. The following shall constitute the effluent monitoring program:

<u>Constituent</u>	<u>Units</u>	<u>Type of Sample</u>	<u>Minimum Frequency of Analysis</u>
Total waste flow	gal/day	-----	monthly
Total dissolved solids	mg/l	grab	quarterly
Sulfates	mg/l	grab	quarterly
Chloride	mg/l	grab	quarterly
Boron	mg/l	grab	quarterly
pH	pH unit	grab	quarterly

A grab sample is defined as an individual sample collected in fewer than 15 minutes.

If no flow occurred during the quarter the report shall so state.

In the event wastes are hauled to a different disposal site, the name and address of the hauler of the wastes shall be reported, along with types and quantities hauled during the reporting period and the location of the final point of disposal. If no wastes are hauled during the reporting period a statement to that effect shall be submitted.

General Provisions for Sampling and Analysis

All sampling, sample preservation, and analyses shall be performed in accordance with the latest edition of "Guidelines Establishing Test Procedures for Analysis of Pollutants", promulgated by the United States Environmental Protection Agency.

All chemical, bacteriological, and bioassay analyses shall be conducted at a laboratory certified for such analyses by the State Water Resources Control Board in accordance with Section 13176 of the Water Code.

General Provisions for Reporting

For every item where the requirements are not met, the discharger shall submit a statement of the actions undertaken or proposed which will bring the discharge into full compliance with requirements at the earliest time and submit a timetable for correction.

The discharger shall maintain all sampling and analytical results, including strip charts; date, exact place, and time of sampling; date analyses were performed; analyst's name; analytical techniques used; and results of all analyses. Such records shall be retained for a minimum of three years. This period of retention shall be extended during the course of any-unresolved litigation regarding this discharge or when requested by the Board.

In reporting the monitoring data, the discharger shall arrange the data in tabular form so that the date, the constituents, and the concentrations are readily discernible. The data shall be summarized to demonstrate compliance with waste discharge requirements and, where applicable, shall include results of receiving water observations.

Monitoring reports shall be signed by:

- a. In the case of corporations, by a principal executive officer at least of the level of vice-president or his duly

authorized representative, if such representative is responsible for the overall operation of the facility from which discharge originates;

- b. In the case of a partnership, by a general partner;
- c. In the case of a sole proprietorship, by the proprietor;
- d. In the case of municipal, state or other public facility, by either a principal executive officer, ranking elected official, or other duly authorized employee.

Each report shall contain the following completed declaration:

"I declare under penalty of perjury that the foregoing is true and correct.

Executed on the _____ day of _____ at _____.

_____ (Signature)

_____ (Title)"

Operation and Maintenance Report

The discharger shall file a technical report with this Board not later than 30 days after receipt of this permit, relative to the operation and maintenance program for this waste disposal facility. The information to be contained in that report shall include, as a minimum, the following:

W. Atlee Burpee Company

File No. 62-76

- a. The name and address of the person or company responsible for operation and maintenance of the facility.
- b. Type of maintenance (preventive or corrective).
- c. Frequency of maintenance, if preventive.

Ordered by

Robert P. Ghirelli

Executive Officer

June 22, 1987

Date

GK/

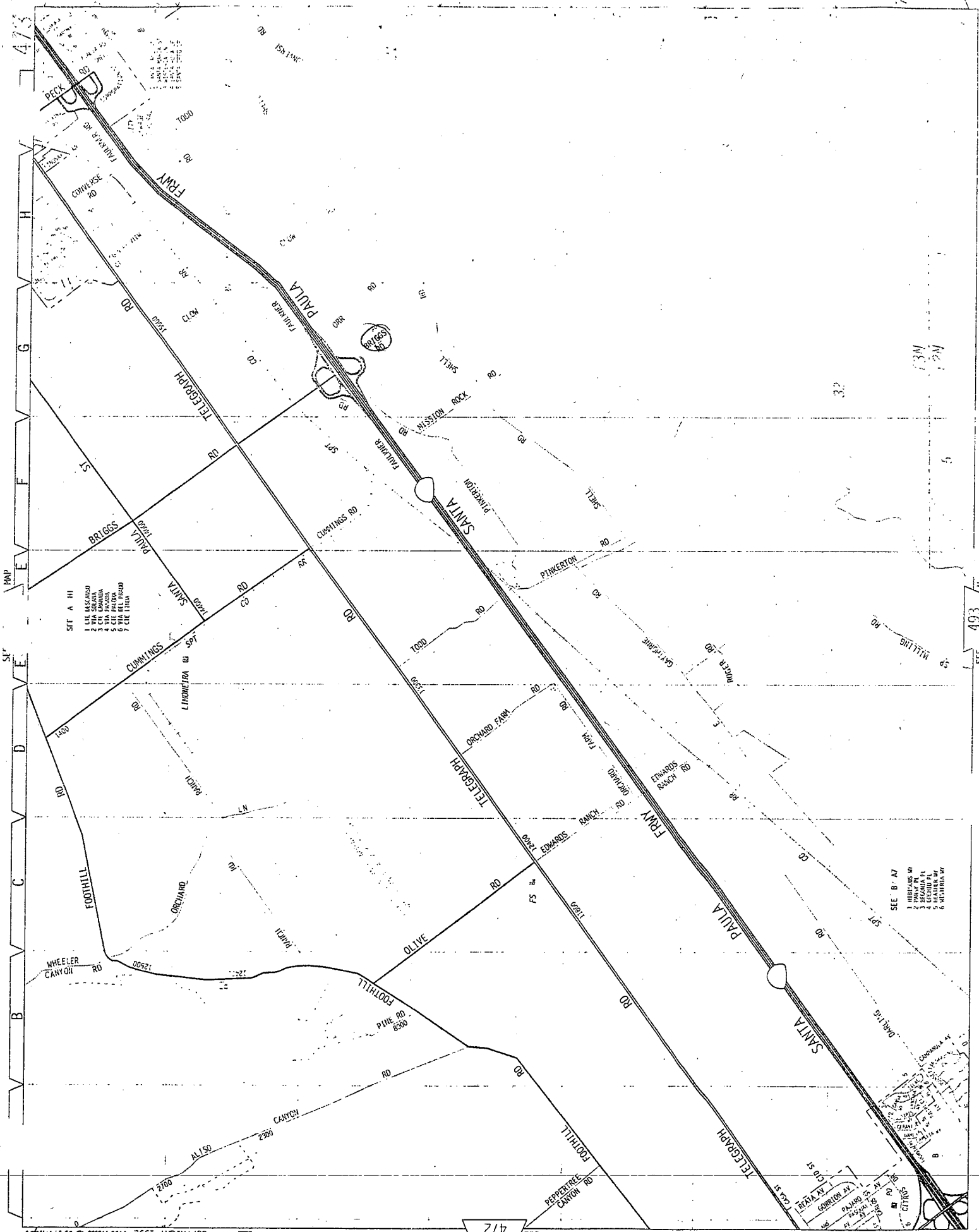

- SEE A III
1. CIL BILSARD
 2. VIA SHAWA
 3. VIA SHAWA
 4. VIA SHAWA
 5. CIL PATEA
 6. CIL PATEA
 7. CIL PATEA

- SEE B IV
1. BILSARD
 2. SHAWA
 3. SHAWA
 4. SHAWA
 5. PATEA
 6. PATEA