



---

## Los Angeles Regional Water Quality Control Board

December 7, 2018

Lee Harrison  
Western Los Angeles County Council, BSA  
16525 Sherman Way, Unit C-8  
Van Nuys, CA 91406

VIA CERTIFIED MAIL  
RETURN RECEIPT REQUESTED  
No. 7008 1140 0002 8671 9691

### **NOTICE OF APPLICABILITY FOR STATE WATER RESOURCES CONTROL BOARD WATER QUALITY ORDER NO. 2004-0004-DWQ FOR THE CAMP JOSEPHO - CABINS AND OUTBUILDINGS PROJECT (4WQC40118084)**

Dear Mr. Harrison:

The Los Angeles Regional Water Quality Control Board (Los Angeles Water Board) received your application for a Clean Water Act section 401 Water Quality Certification for the Camp Josepho - Cabins and Outbuildings Project (Project) on July 23, 2018. The Los Angeles Water Board is now in receipt of your Notice of Intent (NOI) to enroll the Project under Water Quality Order No. 2004-0004-DWQ dated November 12, 2018. Los Angeles Water Board staff has reviewed the NOI for the proposed activities.

The Army Corps of Engineers' Clean Water Act Regulatory Section determined the Project and activities were not subject to the Clean Water Act (not 'jurisdictional') on September 11, 2018. The Los Angeles Water Board is authorizing the Project pursuant to Water Quality Order No. 2004-0004-DWQ, Statewide General Waste Discharge Requirements for Dredge or Fill Discharges to Waters Deemed by the U.S. Army Corps of Engineers to be Outside of Federal Jurisdiction (General WDRs). We are therefore issuing this Notice of Applicability (NOA).

The purpose of the Project is to add and improve facilities at the Camp Josepho Boy Scout Camp located next to Rustic Canyon Creek including a new lodge and stormwater drainage collectors and infiltration areas. The Project will also create pads for foundation construction for 14 relocated cabins near an unnamed tributary to Rustic Canyon Creek. Upland retaining walls adjacent to the relocated cabins will be constructed to direct roof runoff to energy dissipaters located on the bank of the tributary. Three energy dissipaters will be located in the unnamed tributary and will be constructed out of "Drivable Grass," a permeable concrete pavement system with a single row of ungrouted rocks at the base. These three energy dissipaters will be seeded with a native erosion control seed mix. A fourth energy dissipater will be located in Rustic Canyon Creek and will be constructed out of grouted riprap with a concrete or block headwall.

You may proceed with your Project according to the terms and conditions of the General WDRs, enclosed, and this NOA including Attachments A through C. This NOA is valid until December 7, 2023.

Reporting requirements are detailed in Attachment C. Required reports include *Annual Reports*, *Commencement of Construction*, *Request for Notice of Completion of Discharges Letter* and *Request for Notice of Project Complete Letter*.

If you require further assistance, please contact Dana Cole by phone at (213) 576-5733 or by email at [Dana.Cole@waterboards.ca.gov](mailto:Dana.Cole@waterboards.ca.gov).

You may also contact LB Nye, Senior Environmental Scientist, by phone at (213) 576-6785 or by email at [LB.Nye@waterboards.ca.gov](mailto:LB.Nye@waterboards.ca.gov).

Sincerely,



Deborah J. Smith  
Executive Officer

Los Angeles Water Quality Control Board

Enclosures:

General Order 2004-0004-DWQ

Attachment A, Location Maps

Attachment B, Signatory Requirements

Attachment C, Reporting Requirements

cc: [Via email only] (w/ enclosure):

David Hughes  
Psomas

CWA Section 401 WQC Program  
Division of Water Quality  
State Water Resources Control Board

Gerry Hidalgo  
Regulatory Division, Los Angeles District

Matt Chirdon  
California Department of Fish and Wildlife  
Streambed Alteration Team

Melissa Scianni  
US EPA, Region 9

G. Mendel Stewart  
Johnathan Snyder  
U.S. Fish and Wildlife Service



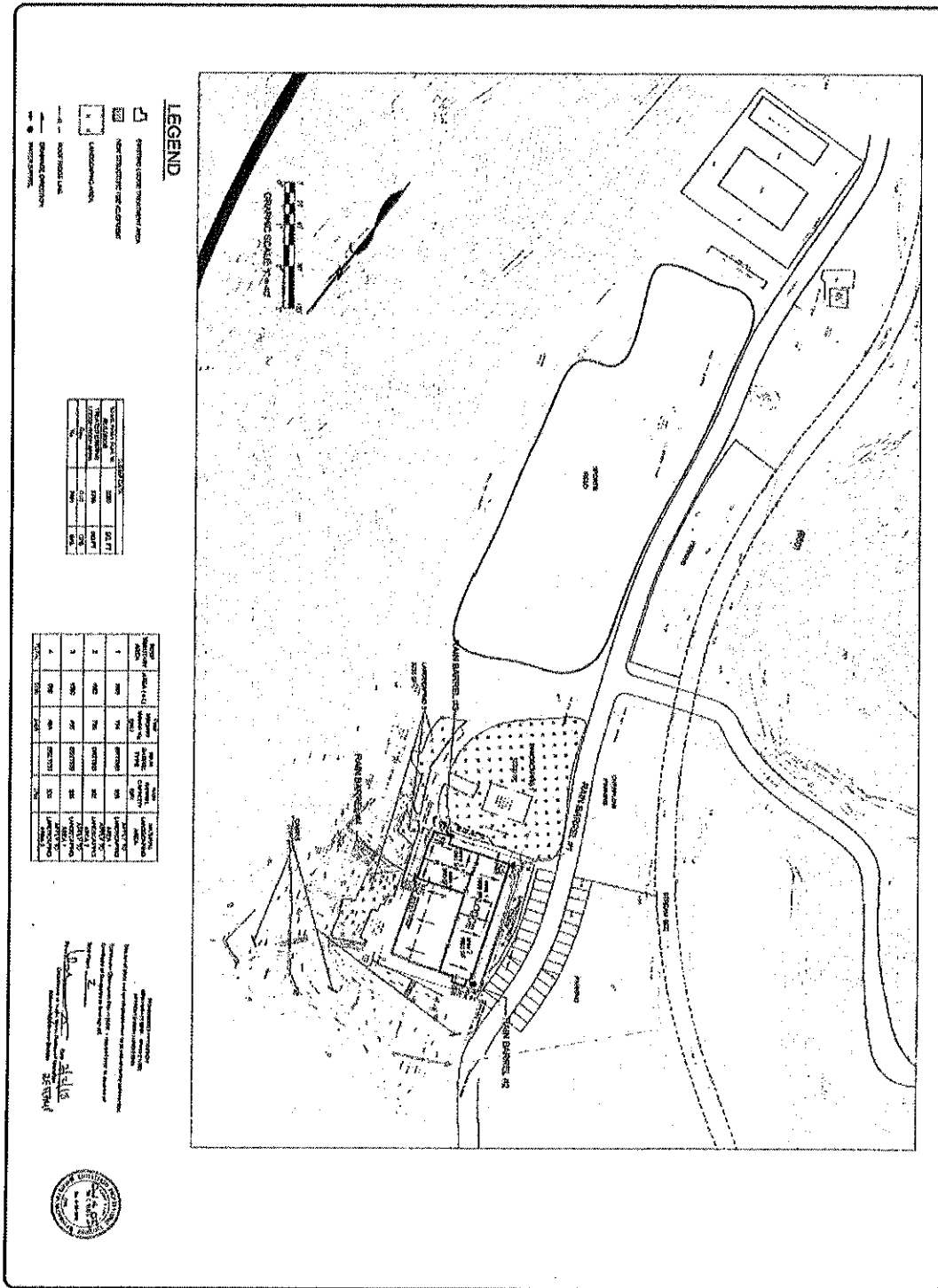

**LEGEND**

- EXISTING BUILDING FOOTPRINT
- NEW BUILDING FOOTPRINT
- LANDSCAPE AREA
- EASEMENT BOUNDARY
- PROPOSED DRIVEWAY
- PROPOSED PARKING AREA

| NO. | DESCRIPTION                 | AREA (SQ. FT.) | PERCENT |
|-----|-----------------------------|----------------|---------|
| 1   | EXISTING BUILDING FOOTPRINT | 1,200          | 100%    |
| 2   | NEW BUILDING FOOTPRINT      | 1,200          | 100%    |
| 3   | LANDSCAPE AREA              | 1,200          | 100%    |
| 4   | EASEMENT BOUNDARY           | 1,200          | 100%    |
| 5   | PROPOSED DRIVEWAY           | 1,200          | 100%    |
| 6   | PROPOSED PARKING AREA       | 1,200          | 100%    |

| NO. | DESCRIPTION                 | AREA (SQ. FT.) | PERCENT |
|-----|-----------------------------|----------------|---------|
| 1   | EXISTING BUILDING FOOTPRINT | 1,200          | 100%    |
| 2   | NEW BUILDING FOOTPRINT      | 1,200          | 100%    |
| 3   | LANDSCAPE AREA              | 1,200          | 100%    |
| 4   | EASEMENT BOUNDARY           | 1,200          | 100%    |
| 5   | PROPOSED DRIVEWAY           | 1,200          | 100%    |
| 6   | PROPOSED PARKING AREA       | 1,200          | 100%    |

APPROVED BY: [Signature]  
DATE: 12/15/18



|          |  |  |   |      |             |    |          |                   |    |          |            |    |          |            |    |
|----------|--|--|---|------|-------------|----|----------|-------------------|----|----------|------------|----|----------|------------|----|
| A.10     | <p><b>CAMP JOSEPHO</b><br/>BOY SCOUTS OF AMERICA<br/>WESTERN LOS ANGELES COUNTY COUNCIL, INC.<br/>1055 CASALE ROAD, PACIFIC PAISADES, CALIFORNIA 90272</p> | <p><b>Arthur J. Bannick</b><br/>Architects<br/>7141 Virginia Ave., Suite 100, Van Nuys, California 91410<br/>Tel: (818) 228-2212 Fax: (818) 963-0213</p> | <table border="1"> <tr> <td>DATE</td> <td>DESCRIPTION</td> <td>BY</td> </tr> <tr> <td>12/15/18</td> <td>ISSUED FOR PERMIT</td> <td>AB</td> </tr> <tr> <td>12/15/18</td> <td>FOR REVIEW</td> <td>AB</td> </tr> <tr> <td>12/15/18</td> <td>FOR REVIEW</td> <td>AB</td> </tr> </table> | DATE | DESCRIPTION | BY | 12/15/18 | ISSUED FOR PERMIT | AB | 12/15/18 | FOR REVIEW | AB | 12/15/18 | FOR REVIEW | AB |
| DATE     | DESCRIPTION  | BY   |   |      |             |    |          |                   |    |          |            |    |          |            |    |
| 12/15/18 | ISSUED FOR PERMIT  | AB   |   |      |             |    |          |                   |    |          |            |    |          |            |    |
| 12/15/18 | FOR REVIEW   | AB   |   |      |             |    |          |                   |    |          |            |    |          |            |    |
| 12/15/18 | FOR REVIEW   | AB   |   |      |             |    |          |                   |    |          |            |    |          |            |    |

Attachment B  
Signatory Requirements

---

## SIGNATORY REQUIREMENTS

*All Documents Submitted In Compliance With This Order  
Shall Meet The Following Signatory Requirements:*

1. All applications, reports, or information submitted to the Los Angeles Water Quality Control Board (Los Angeles Water Board) must be signed and certified as follows:
  - a) For a corporation, by a responsible corporate officer of at least the level of vice-president.
  - b) For a partnership or sole proprietorship, by a general partner or proprietor, respectively.
  - c) For a municipality, or a state, federal, or other public agency, by either a principal executive officer or ranking elected official.
2. A duly authorized representative of a person designated in items 1.a through 1.c above may sign documents if:
  - a) The authorization is made in writing by a person described in items 1.a through 1.c above.
  - b) The authorization specifies either an individual or position having responsibility for the overall operation of the regulated activity.
  - c) The written authorization is submitted to the Los Angeles Water Board Staff Contact prior to submitting any documents listed in item 1 above.
3. Any person signing a document under this section shall make the following certification:

"I certify under penalty of law that I have personally examined and am familiar with the information submitted in this document and all attachments and that, based on my inquiry of those individuals immediately responsible for obtaining the information, I believe that the information is true, accurate, and complete. I am aware that there are significant penalties for submitting false information, including the possibility of fine and imprisonment."

Attachment C  
Report and Notification Requirements

---



## Failure to Submit Required Reports Is a Violation of The Conditions of This Order

### Report Submittal Instructions

1. Check the box on the Report and Notification Cover Sheet next to the report or notification you are submitting.
  - **Part A (Annual Report):** This report will be submitted annually from the anniversary of Project effective date until a Notice of Project Complete Letter is issued.
  - **Part B (Project Status Notifications):** Used to notify the Los Angeles Water Board of the status of the Project schedule that may affect Project billing.
  - **Part C (Conditional Notifications and Reports):** Required on a case by case basis for accidental discharges of hazardous materials, violation of compliance with water quality standards, notification of in-water work, or other reports.
2. Sign the Report and Notification Cover Sheet and attach all information requested for the Report Type.
3. **Electronic Report Submittal Instructions:**
  - Submit signed Report and Notification Cover Sheet and required information via email to:  
[Dana.Cole@waterboards.ca.gov](mailto:Dana.Cole@waterboards.ca.gov)
  - Include in the subject line of the email:  
Subject: ATTN: Dana Cole; File No: 18-084, Reg. Measure ID: 425388 Report

### Definition of Reporting Terms

1. **Active Discharge Period:** The active discharge period begins with the effective date of this Order and ends on the date that the Permittee receives a Notice of Completion of Discharges Letter or, if no post-construction monitoring is required, a Notice of Project Complete Letter. The Active Discharge Period includes all elements of the Project including site construction and restoration, and any Permittee responsible compensatory mitigation construction.
2. **Request for Notice of Completion of Discharges Letter:** This request by the Permittee to the Los Angeles Water Board staff pertains to projects that have post construction monitoring requirements, e.g. if site restoration was required to be monitored for 5 years following construction. Los Angeles Water Board staff will review the request and send a Completion of Discharges Letter to the Permittee

upon approval. This letter will initiate the post-discharge monitoring period and a change in fees from the annual active discharge fee to the annual post-discharge monitoring fee.

3. **Request for Notice of Project Complete Letter:** This request by the Permittee to the Los Angeles Water Board staff pertains to projects that either have completed post-construction monitoring and achieved performance standards or have no post-construction monitoring requirements, and no further Project activities are planned. Los Angeles Water Board staff will review the request and send a Project Complete Letter to the Permittee upon approval. Termination of annual invoicing of fees will correspond with the date of this letter.
4. **Post-Discharge Monitoring Period:** The post-discharge monitoring period begins on the date of the Notice of Completion of Discharges Letter and ends on the date of the Notice of Project Complete Letter issued by the Los Angeles Water Board staff. The Post-Discharge Monitoring Period includes continued water quality monitoring or compensatory mitigation monitoring.
5. **Effective Date:** Date of Order issuance.

### Map/Photo Documentation Information

When submitting maps or photos, please use the following formats.

#### 1. **Map Format Information:**

Preferred map formats of at least 1:24000 (1" = 2000') detail (listed in order of preference):

- **GIS shapefiles:** The shapefiles must depict the boundaries of all project areas and extent of aquatic resources impacted. Each shape should be attributed with the extent/type of aquatic resources impacted. Features and boundaries should be accurate to within 33 feet (10 meters). Identify datum/projection used and if possible, provide map with a North American Datum of 1983 (NAD38) in the California Teale Albers projection in feet.
- **Google KML files** saved from Google Maps: My Maps or Google Earth Pro. Maps must show the boundaries of all project areas and extent/type of aquatic resources impacted. Include URL(s) of maps. If this format is used include a spreadsheet with the object ID and attributed with the extent/type of aquatic resources impacted.
- **Other electronic format** (CAD or illustration format) that provides a context for location (inclusion of landmarks, known structures, geographic coordinates, or USGS DRG or DOQQ). Maps must show the boundaries of all project areas and extent/type of aquatic resources impacted. If this format is used include a spreadsheet with the object ID and attributed with the extent/type of aquatic resources impacted.
- Aquatic resource maps marked on paper **USGS 7.5 minute topographic maps** or **Digital Orthophoto Quarter Quads (DOQQ)** printouts. Maps must show the boundaries of all project areas and extent/type of aquatic resources impacted. If this format is used include a spreadsheet with the object ID and attributed with the extent/type of aquatic resources impacted.

2. **Photo-Documentation:** Include a unique identifier, date stamp, written description of photo details, and latitude/longitude (in decimal degrees) or map indicating location of photo. Successive photos should be taken from the same vantage point to compare pre/post construction conditions.

Attachment C  
Report and Notification Requirements

---

## Failure to Submit Required Reports Is a Violation of The Conditions of This Order

### Report Submittal Instructions

1. Check the box on the Report and Notification Cover Sheet next to the report or notification you are submitting.
  - **Part A (Annual Report):** This report will be submitted annually from the anniversary of Project effective date until a Notice of Project Complete Letter is issued.
  - **Part B (Project Status Notifications):** Used to notify the Los Angeles Water Board of the status of the Project schedule that may affect Project billing.
  - **Part C (Conditional Notifications and Reports):** Required on a case by case basis for accidental discharges of hazardous materials, violation of compliance with water quality standards, notification of in-water work, or other reports.
2. Sign the Report and Notification Cover Sheet and attach all information requested for the Report Type.
3. **Electronic Report Submittal Instructions:**
  - Submit signed Report and Notification Cover Sheet and required information via email to:  
[Dana.Cole@waterboards.ca.gov](mailto:Dana.Cole@waterboards.ca.gov)
  - Include in the subject line of the email:  
Subject: ATTN: Dana Cole; File No: 18-084, Reg. Measure ID: 425388 Report

### Definition of Reporting Terms

1. **Active Discharge Period:** The active discharge period begins with the effective date of this Order and ends on the date that the Permittee receives a Notice of Completion of Discharges Letter or, if no post-construction monitoring is required, a Notice of Project Complete Letter. The Active Discharge Period includes all elements of the Project including site construction and restoration, and any Permittee responsible compensatory mitigation construction.
2. **Request for Notice of Completion of Discharges Letter:** This request by the Permittee to the Los Angeles Water Board staff pertains to projects that have post construction monitoring requirements, e.g. if site restoration was required to be monitored for 5 years following construction. Los Angeles Water Board staff will review the request and send a Completion of Discharges Letter to the Permittee upon approval. This letter will initiate the post-discharge monitoring period and a change in fees from the annual active discharge fee to the annual post-discharge monitoring fee.

3. **Request for Notice of Project Complete Letter:** This request by the Permittee to the Los Angeles Water Board staff pertains to projects that either have completed post-construction monitoring and achieved performance standards or have no post-construction monitoring requirements, and no further Project activities are planned. Los Angeles Water Board staff will review the request and send a Project Complete Letter to the Permittee upon approval.
4. **Post-Discharge Monitoring Period:** The post-discharge monitoring period begins on the date of the Notice of Completion of Discharges Letter and ends on the date of the Notice of Project Complete Letter issued by the Los Angeles Water Board staff. The Post-Discharge Monitoring Period includes continued water quality monitoring or compensatory mitigation monitoring.
5. **Effective Date:** Date of Order issuance.

### Map/Photo Documentation Information

When submitting maps or photos, please use the following formats.

1. **Map Format Information:**

Preferred map formats of at least 1:24000 (1" = 2000') detail (listed in order of preference):

- **GIS shapefiles:** The shapefiles must depict the boundaries of all project areas and extent of aquatic resources impacted. Each shape should be attributed with the extent/type of aquatic resources impacted. Features and boundaries should be accurate to within 33 feet (10 meters). Identify datum/projection used and if possible, provide map with a North American Datum of 1983 (NAD38) in the California Teale Albers projection in feet.
  - **Google KML files** saved from Google Maps: My Maps or Google Earth Pro. Maps must show the boundaries of all project areas and extent/type of aquatic resources impacted. Include URL(s) of maps. If this format is used include a spreadsheet with the object ID and attributed with the extent/type of aquatic resources impacted.
  - **Other electronic format** (CAD or illustration format) that provides a context for location (inclusion of landmarks, known structures, geographic coordinates, or USGS DRG or DOQQ). Maps must show the boundaries of all project areas and extent/type of aquatic resources impacted. If this format is used include a spreadsheet with the object ID and attributed with the extent/type of aquatic resources impacted.
  - Aquatic resource maps marked on paper **USGS 7.5 minute topographic maps** or **Digital Orthophoto Quarter Quads (DOQQ)** printouts. Maps must show the boundaries of all project areas and extent/type of aquatic resources impacted. If this format is used include a spreadsheet with the object ID and attributed with the extent/type of aquatic resources impacted.
2. **Photo-Documentation:** Include a unique identifier, date stamp, written description of photo details, and latitude/longitude (in decimal degrees) or map indicating location of photo. Successive photos should be taken from the same vantage point to compare pre/post construction conditions.

| <b>REPORT AND NOTIFICATION COVER SHEET</b> |  |                  |        |
|--|--|------------------|--------|
| <b>Project:</b>                            | Camp Josepho – Cabins and Outbuildings |                  |        |
| <b>Permittee:</b>                          | Western LA County Council, BSA         |                  |        |
| <b>Reg. Meas. ID:</b>                      | 425388                                 | <b>Place ID:</b> | 851203 |
|  |  | <b>File No:</b>  | 18-084 |

| <b>Report Type Submitted</b>                          |  |
|---|--|
| <b>Part A – Project Reporting</b>                     |  |
| Report Type   | <input type="checkbox"/> Annual Report   |
| <b>Part B – Project Status Notifications</b>          |  |
| Report Type   | <input type="checkbox"/> Commencement of Construction                                |
| Report Type   | <input type="checkbox"/> Request for Notice of Completion of Discharges Letter       |
| Report Type   | <input type="checkbox"/> Request for Notice of Project Complete Letter               |
| <b>Part C - Conditional Notifications and Reports</b> |  |
| Report Type   | <input type="checkbox"/> Accidental Discharge of Hazardous Material Report           |
| Report Type   | <input type="checkbox"/> Violation of Compliance with Water Quality Standards Report |
| Report Type   | <input type="checkbox"/> In-Water Work/Diversions Water Quality Monitoring Report    |
| Report Type   | <input type="checkbox"/> Modifications to Project Report                             |
| Report Type   | <input type="checkbox"/> Transfer of Property Ownership Report                       |

"I certify under penalty of law that I have personally examined and am familiar with the information submitted in this document and all attachments and that, based on my inquiry of those individuals immediately responsible for obtaining the information, I believe that the information is true, accurate, and complete. I am aware that there are significant penalties for submitting false information, including the possibility of fine and imprisonment."

Print Name <sup>1</sup>

Affiliation and Job Title

Signature

Date

**<sup>1</sup>STATEMENT OF AUTHORIZATION (include if authorization has changed since application was submitted)**

I hereby authorize \_\_\_\_\_ to act in my behalf as my representative in the submittal of this report, and to furnish upon request, supplemental information in support of this submittal.

\_\_\_\_\_  
Permittee's Signature

\_\_\_\_\_  
Date

**\*This Report and Notification Cover Sheet must be signed by the Permittee or a duly authorized representative and included with all written submittals.**



**Part A – Project Reporting**

|                                   |  |
|-----------------------------------|--|
| <b>Report Type</b>                | <b>Annual Report</b>   |
| <b>Report Purpose</b>             | Notify the Los Angeles Water Board staff of Project status during both the active discharge and post-discharge monitoring periods.   |
| <b>When to Submit</b>             | Annual reports shall be submitted each year on the anniversary of Project effective date. Annual reports shall continue until a Notice of Project Complete Letter is issued to the Permittee.  |
| <b>Report Contents</b>            | <p>The contents of the annual report shall include the topics indicated below for each project period. Report contents are outlined in Annual Report Topics below.</p> <p><b>During the Active Discharge Period</b></p> <ul style="list-style-type: none"> <li>• <b>Topic 1: Construction Summary</b></li> <li>• <b>Topic 2: Mitigation for Temporary Impacts Status</b></li> <li>• <b>Topic 3: Compensatory Mitigation for Permanent Impacts Status</b></li> </ul> <p><b>During the Post-Discharge Monitoring Period</b></p> <ul style="list-style-type: none"> <li>• <b>Topic 2: Mitigation for Temporary Impacts Status</b></li> <li>• <b>Topic 3: Compensatory Mitigation for Permanent Impacts Status</b></li> </ul>  |
| <b>Annual Report Topics (1-3)</b> |  |
| <b>Annual Report Topic 1</b>      | <b>Construction Summary</b>  |
| <b>When to Submit</b>             | With the annual report during the Active Discharge Period.   |
| <b>Report Contents</b>            | <ol style="list-style-type: none"> <li>1. Project progress and schedule including initial ground disturbance, site clearing and grubbing, road construction, site construction, and the implementation status of construction storm water best management practices (BMPs). If construction has not started, provide estimated start date and reasons for delay.</li> <li>2. Color photos, pre-project and current.</li> <li>3. Map showing general Project progress.</li> <li>4. If applicable: <ol style="list-style-type: none"> <li>a. Summary of any conditional reports sent during the year such as "Accidental Discharge of Hazardous Material Report" or "Accidental Discharge of Hazardous Material Report"</li> <li>b. Copies of revised permits from other agencies</li> <li>c. Compilation of all water quality monitoring results for the year in a spreadsheet format.</li> </ol> </li> </ol> |
| <b>Annual Report Topic 2</b>      | <b>Mitigation for Temporary Impacts Status</b>   |
| <b>When to Submit</b>             | With the annual report during both the Active Discharge Period and Post-Discharge Monitoring Period.   |

|                              |   |
|------------------------------|---|
| <b>Report Contents</b>       | <p><b>*If not applicable report N/A.</b></p> <ol style="list-style-type: none"> <li>1. Planned date of initiation and map showing locations of mitigation for temporary impacts to waters of the state and all upland areas of temporary disturbance which could result in a discharge to waters of the state.</li> <li>2. If mitigation for temporary impacts has already commenced, provide a map and information concerning attainment of mitigation success.</li> </ol>   |
| <b>Annual Report Topic 3</b> | <b>Compensatory Mitigation for Permanent Impacts Status</b>   |
| <b>When to Submit</b>        | With the annual report during both the Active Discharge Period and Post-Discharge Monitoring Period.  |
| <b>Report Contents</b>       | <p><b>*If not applicable report N/A.</b></p> <p><b>Part A. Permittee Responsible</b></p> <ol style="list-style-type: none"> <li>1. Planned date of initiation of compensatory mitigation site installation.</li> <li>2. If installation is in progress, a map of what has been completed to date.</li> <li>3. If the compensatory mitigation site has been installed, provide a final map and information concerning attainment of performance standards contained in the compensatory mitigation plan.</li> </ol> <p><b>Part B. Mitigation Bank or In-Lieu Fee</b></p> <ol style="list-style-type: none"> <li>1. Status or proof of purchase of credit types and quantities.</li> <li>2. Include the name of bank/ILF Program and contact information.</li> <li>3. If ILF, location of project and type if known.</li> </ol> |

**Part B – Project Status Notifications**

|                        |  |
|------------------------|--|
| <b>Report Type</b>     | <b>Request for Notice of Completion of Discharges Letter</b>   |
| <b>Report Purpose</b>  | Notify Los Angeles Water Board staff that post-construction monitoring is required and that active Project construction, including any mitigation and permittee responsible compensatory mitigation, is complete.  |
| <b>When to Submit</b>  | Must be received by Los Angeles Water Board staff within thirty (30) days following completion of all Project construction activities.   |
| <b>Report Contents</b> | <ol style="list-style-type: none"> <li>1. Pre- and post-photo documentation of all Project activity sites where the discharge of dredge and/or fill/excavation was authorized.</li> <li>2. An updated monitoring schedule for mitigation for temporary impacts to waters of the state and permittee responsible compensatory mitigation during the post-discharge monitoring period, if applicable.</li> </ol> |

|                    |  |
|--------------------|--|
| <b>Report Type</b> | <b>Request for Notice of Project Complete Letter</b> |
|--------------------|--|

|                        |  |
|------------------------|--|
| <b>Report Purpose</b>  | Notify Los Angeles Water Board staff that construction and/or any post-construction monitoring is complete, or is not required, and no further Project activity is planned.  |
| <b>When to Submit</b>  | Must be received by Los Angeles Water Board staff within thirty (30) days following completion of all Project activities.  |
| <b>Report Contents</b> | <p><b>Part A: Mitigation for Temporary Impacts</b></p> <ol style="list-style-type: none"><li>1. A report establishing that areas of temporary impacts to waters of the state, and upland areas of temporary disturbance which could result in a discharge to waters of the state, have been successfully restored and all identified success criteria have been met. Pre- and post-photo documentation of all restoration sites.</li></ol> <p><b>Part B: Permittee Responsible Compensatory Mitigation</b></p> <ol style="list-style-type: none"><li>2. A report establishing that the performance standards outlined in the compensatory mitigation plan have been met.</li><li>3. Status on the implementation of the long-term maintenance and management plan and funding of endowment.</li><li>4. Pre- and post-photo documentation of all compensatory mitigation sites.</li><li>5. Final maps of all compensatory mitigation areas (including buffers).</li></ol> <p><b>Part C: Post-Construction Storm Water BMPs</b></p> <ol style="list-style-type: none"><li>6. Date of storm water permit Notice of Termination(s), if applicable.</li><li>7. Report status and functionality of all post-construction BMPs.</li></ol> |

**Part C – Conditional Notifications and Reports**

| <b>Report Type</b>     | <b>Accidental Discharge of Hazardous Material Report</b>  |
|------------------------|---|
| <b>Report Purpose</b>  | Notifies Los Angeles Water Board staff that an accidental discharge of hazardous material has occurred.   |
| <b>When to Submit</b>  | Within five (5) working days following the date of an accidental discharge. Continue reporting as required by Los Angeles Water Board staff.  |
| <b>Report Contents</b> | <ol style="list-style-type: none"> <li>1. The report shall include the OES Incident/Assessment Form, a full description and map of the accidental discharge incident (i.e. location, time and date, source, discharge constituent and quantity, aerial extent, and photo documentation). If applicable, the OES Written Follow-Up Report may be substituted.</li> <li>2. If applicable, any required sampling data, a full description of the sampling methods including frequency/dates and times of sampling, equipment, locations of sampling sites.</li> <li>3. Locations and construction specifications of any barriers, including silt curtains or diverting structures, and any associated trenching or anchoring.</li> </ol> |

| <b>Report Type</b>     | <b>Violation of Compliance with Water Quality Standards Report</b>   |
|------------------------|--|
| <b>Report Purpose</b>  | Notifies Los Angeles Water Board staff that a violation of compliance with water quality standards has occurred.   |
| <b>When to Submit</b>  | The Permittee shall report any event that causes a violation of water quality standards within three (3) working days of the noncompliance event notification to Los Angeles Water Board staff.  |
| <b>Report Contents</b> | The report shall include: the cause; the location shown on a map; and the period of the noncompliance including exact dates and times. If the noncompliance has not been corrected, include: the anticipated time it is expected to continue; the steps taken or planned to reduce, eliminate, and prevent reoccurrence of the noncompliance; and any monitoring results if required by Los Angeles Water Board staff. |

| <b>Report Type</b>     | <b>In-Water Work and Diversions Water Quality Monitoring Report</b>  |
|------------------------|--|
| <b>Report Purpose</b>  | Notifies Los Angeles Water Board staff of the completion of in-water work.   |
| <b>When to Submit</b>  | Within three (3) working days following the completion of in-water work. Continue reporting in accordance with the approved water quality monitoring plan. |
| <b>Report Contents</b> | As required by the approved water quality monitoring plan.   |

|                        |   |
|------------------------|---|
| <b>Report Type</b>     | <b>Modifications to Project Report</b>  |
| <b>Report Purpose</b>  | Notifies Los Angeles Water Board staff if the Project, as described in the application materials, is altered in any way or by the imposition of subsequent permit conditions by any local, state or federal regulatory authority.                                       |
| <b>When to Submit</b>  | Prior to any alteration or modification of Project activities.  |
| <b>Report Contents</b> | A description and location of any alterations of Project activities. Identify any Project modifications that will interfere with the Permittee's compliance with the Order. Any alteration may require an Amendment, to be determined by Los Angeles Water Board staff. |

|                        |   |
|------------------------|---|
| <b>Report Type</b>     | <b>Transfer of Property Ownership Report</b>  |
| <b>Report Purpose</b>  | Notifies Los Angeles Water Board staff of change in ownership of the Project or Permittee-responsible mitigation area.  |
| <b>When to Submit</b>  | At least 10 working days prior to the transfer of ownership.  |
| <b>Report Contents</b> | <ol style="list-style-type: none"> <li>1. A statement that the Permittee has provided the purchaser with a copy of this Order and that the purchaser understands and accepts:             <ol style="list-style-type: none"> <li>a. the Order's requirements and the obligation to implement them or be subject to administrative and/or civil liability for failure to do so; and</li> <li>b. responsibility for compliance with any long-term BMP<sup>1</sup> maintenance plan requirements in this Order.</li> </ol> </li> <li>2. A statement that the Permittee has informed the purchaser to submit a written request to the Los Angeles Water Board to be named as the permittee in a revised order.</li> </ol> |

|                        |   |
|------------------------|---|
| <b>Report Type</b>     | <b>Transfer of Long-Term BMP Maintenance Report</b>   |
| <b>Report Purpose</b>  | Notifies Los Angeles Water Board staff of transfer of long-term BMP maintenance responsibility. |
| <b>When to Submit</b>  | At least 10 working days prior to the transfer of BMP maintenance responsibility.               |
| <b>Report Contents</b> | A copy of the legal document transferring maintenance responsibility of post-construction BMPs. |

---

<sup>1</sup> Best Management Practices (BMPs) is a term used to describe a type of water pollution or environmental control.