

REVISIONS	DATE	BY
ORIGINAL	07/29/08	KEJ

This drawing is the property of Adams Engineering. It is to be used only for the project and location specified on the title block. No part of this drawing may be reproduced or transmitted in any form or by any means, electronic, mechanical, photocopying, recording, or by any information storage and retrieval system, without the prior written permission of Adams Engineering. © Adams Engineering 2008, AZ

Adams
ENGINEERING
5975 Torres Avenue, Ste. 200 • Calabasas, California 91301 • (805) 796-8100

**STORM WATER MANAGEMENT
SITE PLANS
AERIAL MAP**

SAM'S CLUB REMODEL
STORE No. 6614-01
4901 SANTA ANITA AVE.
EL MONTE, CALIFORNIA



PROJECT MGR.
KEJ
PROJECT TECH
EMT
JOB NO.
2002-018
SHEET NO.
SWQ-1

LEGEND	
EXISTING CONTOUR	315
EXISTING ONSITE CURB	—
EXISTING RIBBON GUTTER	—
EXISTING STORM DRAIN	← SD — SD ← SD — SD ←
EXISTING FENCE LINE	- x - x - x - x - x - x -
PROPERTY LINE	— · — · — · — · — · — · —
DRAINAGE AREAS	—
DIRECTION OF OVERLAND FLOW	←
EXISTING LANDSCAPED AREAS	▨
RIBBON GTR/OPEN CHANNEL FLOW DIRECTION	← ○ ← ○ ← ○ ← ○ ←
CHANNEL FLOW	↑
ROOF DRAIN	↑

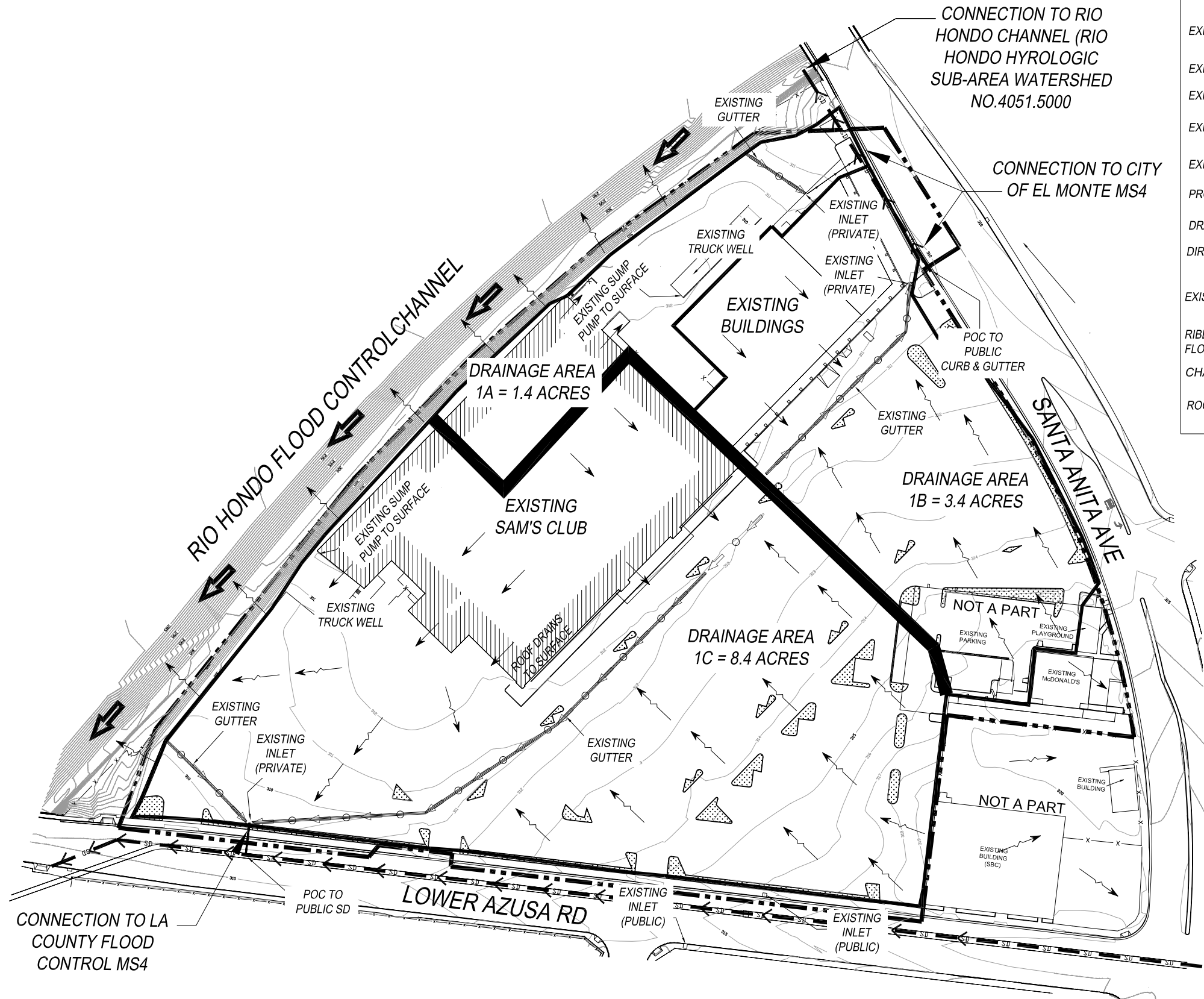

REVISIONS	DATE	BY
ORIGINAL	02/20/08	KEJ

Adams Engineering
 8770 Overland Avenue, Ste. 300 • Oakland, California 94628 • (781) 796-9150
 © Copyright 2008, KEJ



**STORM WATER MANAGEMENT
 SITE PLANS
 EXISTING SITE RUNOFF
 PATTERN & DRAINAGE**

**SAM'S CLUB REMODEL
 STORE No. 6614-01
 4901 SANTA ANITA AVE.
 EL MONTE, CALIFORNIA**



PROJECT MGR. KEJ
 PROJECT TECH. EMT
 JOB NO. 2002-018
 SHEET NO. SWQ-2

LEGEND

EXISTING PUBLIC STORM DRAIN (CITY OF EL MONTE MS4)	
EXISTING PROPERTY LINE	
EXISTING CONTOUR LINE	
PROPOSED UNDERGROUND INFILTRATION SYSTEM (REFER TO SUSMP DETAIL SHEET)	
OVERLAND SURFACE FLOW ARROWS	
PROPOSED PRIVATE STORM DRAIN (WITH FLOW DIRECTION)	
PROPOSED ONSITE CURB	
PROPOSED CONTOUR LINE	
EXISTING CHAIN LINK FENCE	
PROPOSED LANDSCAPE PLANTERS	
PROPOSED STORM DRAIN INLET EQUIPPED WITH GRATE INLET SKIMMER BOX (MANUFACTURED BY BIO CLEAN ENVIRONMENTAL SERVICES INC)	
PROPOSED SUB-BASIN DRAINAGE AREA	
PROPOSED BASIN DRAINAGE AREA	
PROPOSED BIORETENTION	
CHANNEL FLOW	
AREA OUTSIDE LIMITS OF DISTURBANCE CONTRIBUTING DRAINAGE	
LIMIT OF DISTURBANCE	
ROOF RUN-OFF	

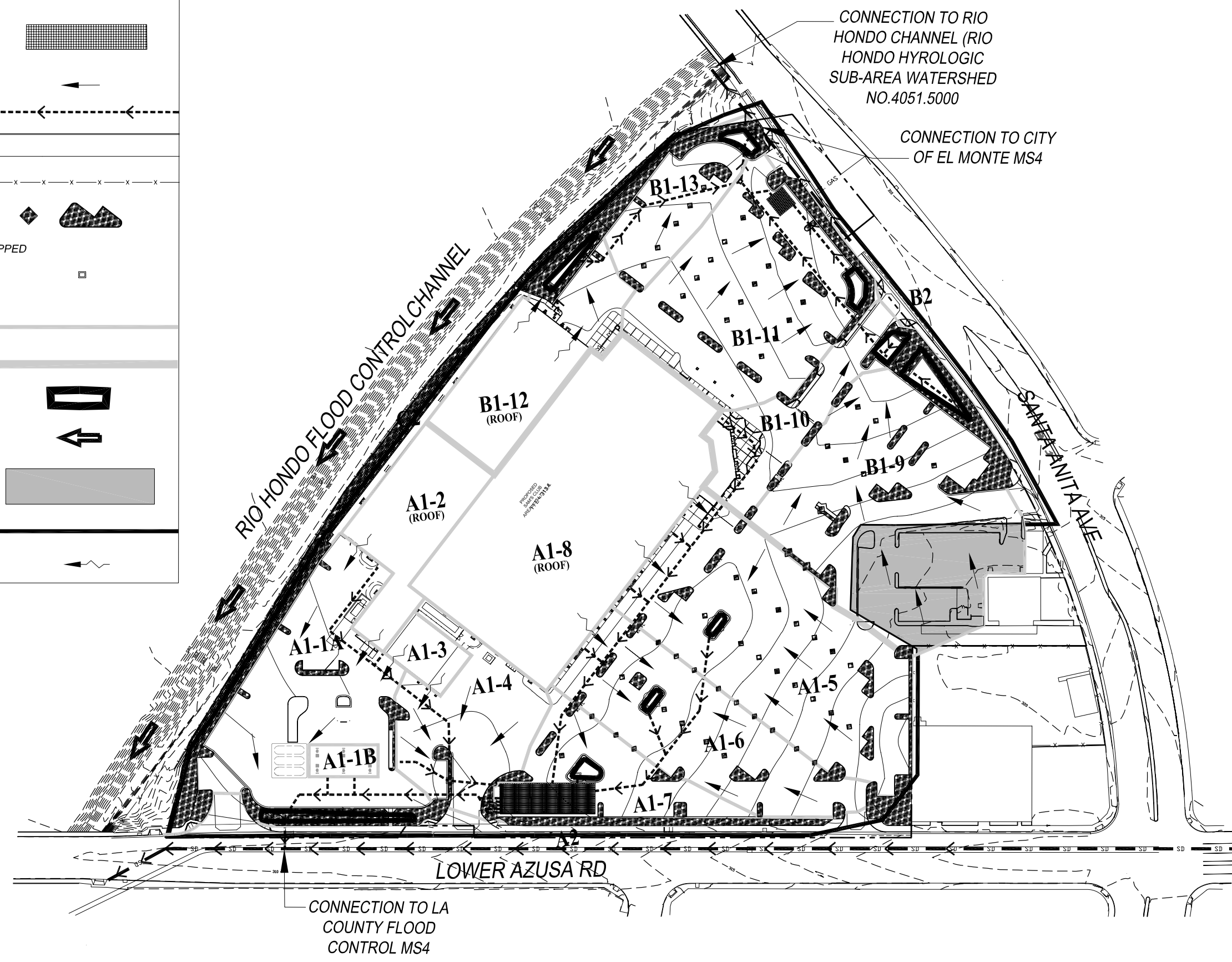
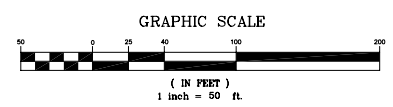

DATE	BY
02/20/08	KEJ
REVISIONS	
ORIGINAL	

Professional Engineer
 License No. 44567
 State of California
 Civil
 Adams Engineering
 8770 Owens Avenue, Ste. 200 • Carlsbad, California 92008 • (760) 796-1150
 © Copyright 2008, KEJ



**STORM WATER MANAGEMENT
 SITE PLANS
 PROPOSED DEVELOPMENT
 AND RUNOFF PATTERN**

Sam's
SAM'S CLUB REMODEL
 STORE No. 6614-01
 4901 SANTA ANITA AVE.
 EL MONTE, CALIFORNIA



PROJECT MGR.
 KEJ
 PROJECT TECH
 EMT
 JOB NO.
 2002-0118
 SHEET NO.
SWQ-3

LEGEND

EXISTING PUBLIC STORM DRAIN (CITY OF EL MONTE MS4)	
UNDERGROUND INFILTRATION BASIN (REFER TO SUSMP DETAIL SHEET)	
RUNOFF FLOW ARROWS & SLOPE %	
PROPOSED PRIVATE STORM DRAIN (WITH FLOW DIRECTION)	
PROPOSED ONSITE CURB	
PROPOSED CONTOUR LINE 1' INTERVAL	
PROPOSED CONTOUR LINE 5' INTERVAL	
EXISTING CHAIN LINK FENCE	
PROPOSED LANDSCAPE PLANTERS	
PROPOSED STORM DRAIN INLET	
PROPERTY LINE	
BASIN DRAINAGE AREA BOUNDARY LINES	
BIO-RETENTION CELL (REFER TO SUSMP DETAIL SHEET)	
PROPOSED STORM DRAIN INLET EQUIPPED WITH GRATE INLET SKIMMER BOX (GISB) 36-36-25 (REFER TO SUSMP DETAIL SHEET)	
OIL STOP VALVE MODEL #OSV148 (REFER TO SUSMP DETAIL SHEET)	
ROOF FLOW DIRECTION	

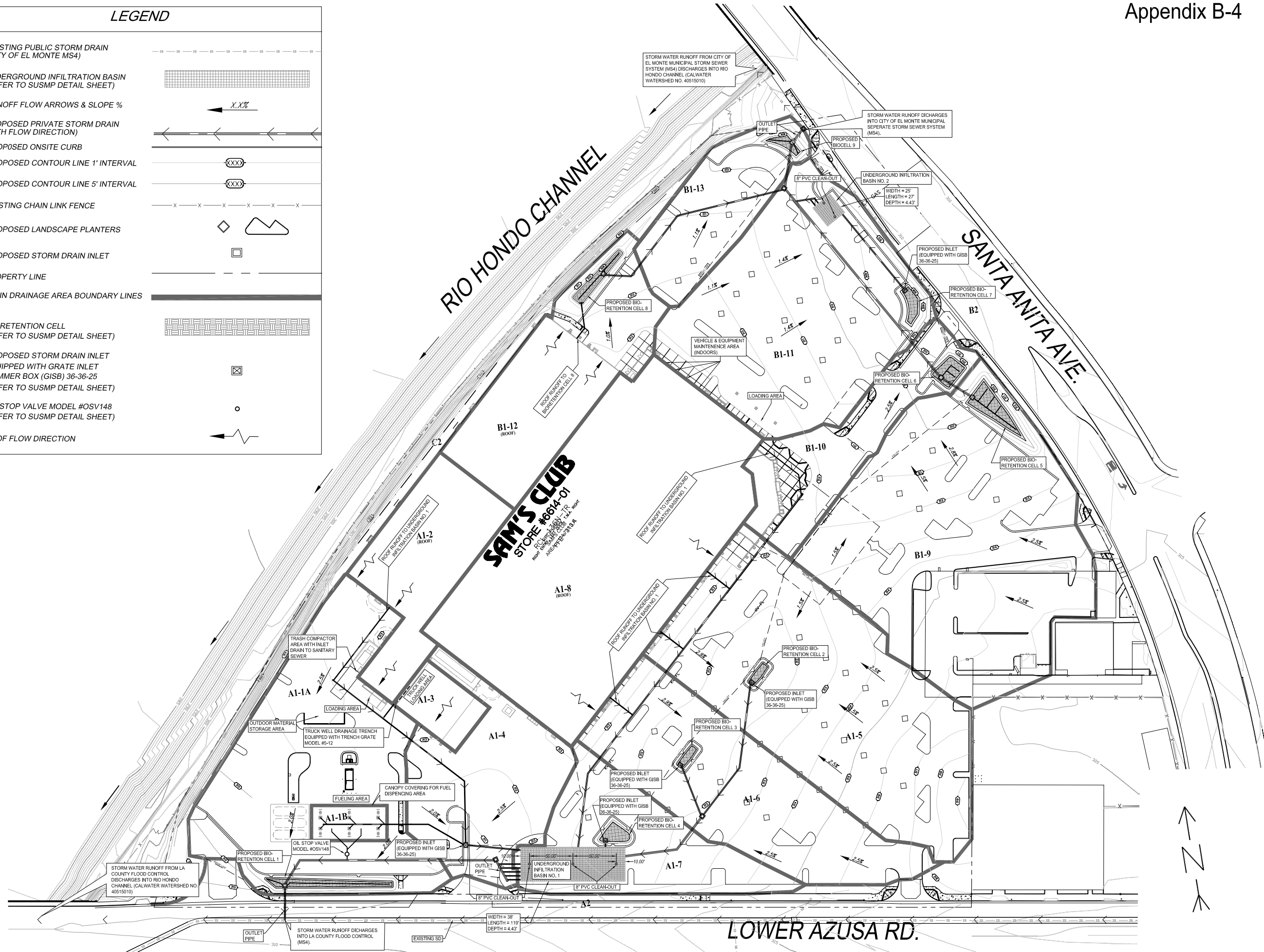

DATE	BY
02/20/08	KEJ

REVISIONS
ORIGINAL

Adams
ENGINEERING

8780 Ormeau Avenue, Ste. 300 • Calabasas, California 91304 • (760) 706-0150

**STORM WATER MANAGEMENT
SITE PLANS
PROPOSED TREATMENT
CONTROL BMP'S**

SAM'S

**SAM'S CLUB REMODEL
STORE No. 6614-01
4901 SANTA ANITA AVE.
EL MONTE, CALIFORNIA**

SEAL-DESIGN ENGINEER

REGISTERED PROFESSIONAL ENGINEER
No. 68491
Exp. 01/30/08
CIVIL
STATE OF CALIFORNIA

PROJECT MGR.
KEJ
PROJECT TECH
EMT
JOB NO.
2002-018
SHEET NO.
SWQ-4

