

REVISED ITINERARY

February 20, 2019
Rockaway and the Vineyard of Kendall
Jackson Wine Estates & Gardens Tour Itinerary
(Times are approximate)

1:00 p.m. – Meet at the parking lot in front of the North Coast Regional Water Quality Control Board at 5550 Skylane Blvd., Suite A, Santa Rosa.

1:10 p.m. – 1:25 p.m. Drive to Rockaway Vineyard, 1666 State Highway 128, Geyserville, CA. 95441. Please use first paved driveway at 1670 Hwy 128 on left; then park just off the road along the vineyard on the right.

1:30 p.m. – 3:00 p.m. Tour of Rodney Strong Rockaway Vineyard. Discussions of best management practices (BMPs) and water quality protections.

3:00 p.m. – 3:30 p.m. Drive to the Vineyard gate entrance of Kendall Jackson Wine Estates & Gardens located at 3600 Road, Fulton, CA 95439. From U.S-101, take Airport Blvd exit, turn left onto Airport Blvd., turn right onto Fulton, continue for 0.6 miles, turn right into driveway at 3600 Fulton Road and follow road until directed to park.

3:30 p.m. – 5:00 p.m. Kendall Jackson Wine Estates & Gardens Vineyard. Discussions of best management practices (BMPs) and water quality protections.

**** Rain is in the forecast so plan on bringing wet weather gear ****



5550 Skylane Boulevard, Santa Rosa, CA to Drive 18.0 miles, 20 min
1670 CA-128, Geyserville, CA 95441

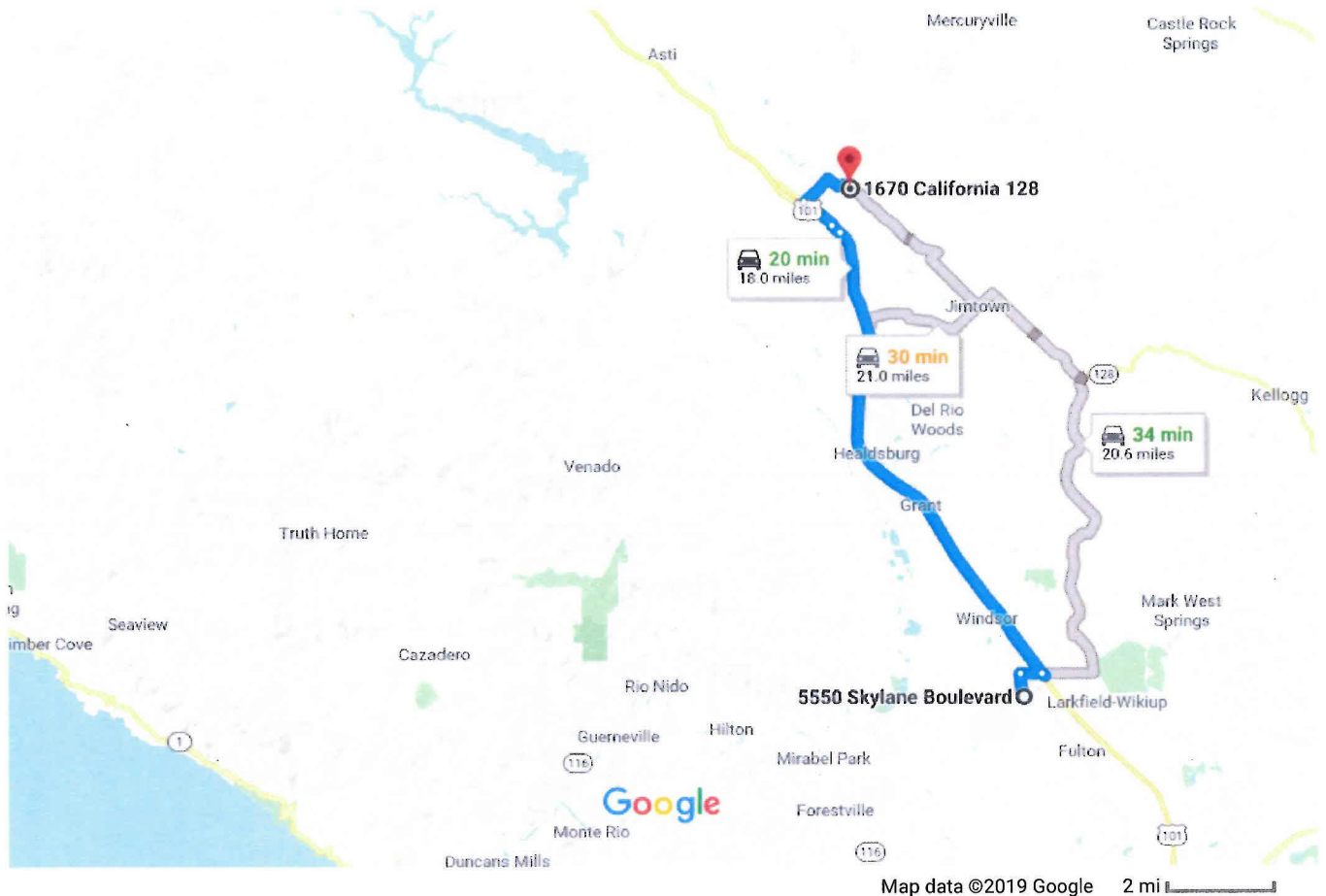

5550 Skylane Blvd

Santa Rosa, CA 95403

- ↑ 1. Head north on Skylane Blvd toward Kittyhawk Blvd
0.6 mi
- 2. Turn right onto Shiloh Rd
0.6 mi
- ⤴ 3. Merge onto US-101 N via the ramp to Eureka
13.9 mi
- 4. Take exit 510 toward CA-128 E/Geyserville/Dry Creek/Rancheria
0.3 mi
- 5. Turn right onto Geyserville Ave
- 6. Turn right onto CA-128 E (signs for State Route 128 E/Calistoga)
1.6 mi
i Destination will be on the left









1670 CA-128, Geyserville, CA 95441 to
3600 Fulton Rd, Fulton, CA 95439

Drive 18.8 miles, 21 min

1670 CA-128

Geyserville, CA 95441

-  1. Head northwest on CA-128 toward Moody Ln
1.6 mi
-  2. Turn left onto Geyserville Ave
1.1 mi
-  3. Turn left to merge onto US-101 S toward San Francisco
14.9 mi
-  4. Take exit 495B for Airport Blvd
0.2 mi
-  5. Turn left onto Airport Blvd (signs for Larkfield-Wikiup)
0.5 mi
-  6. Turn right onto Fulton Rd
0.6 mi

3600 Fulton Rd

Fulton, CA 95439

These directions are for planning purposes only. You may find that construction projects, traffic, weather, or other events may cause conditions to differ from the map results, and you should plan your route accordingly. You must obey all signs or notices regarding your route.

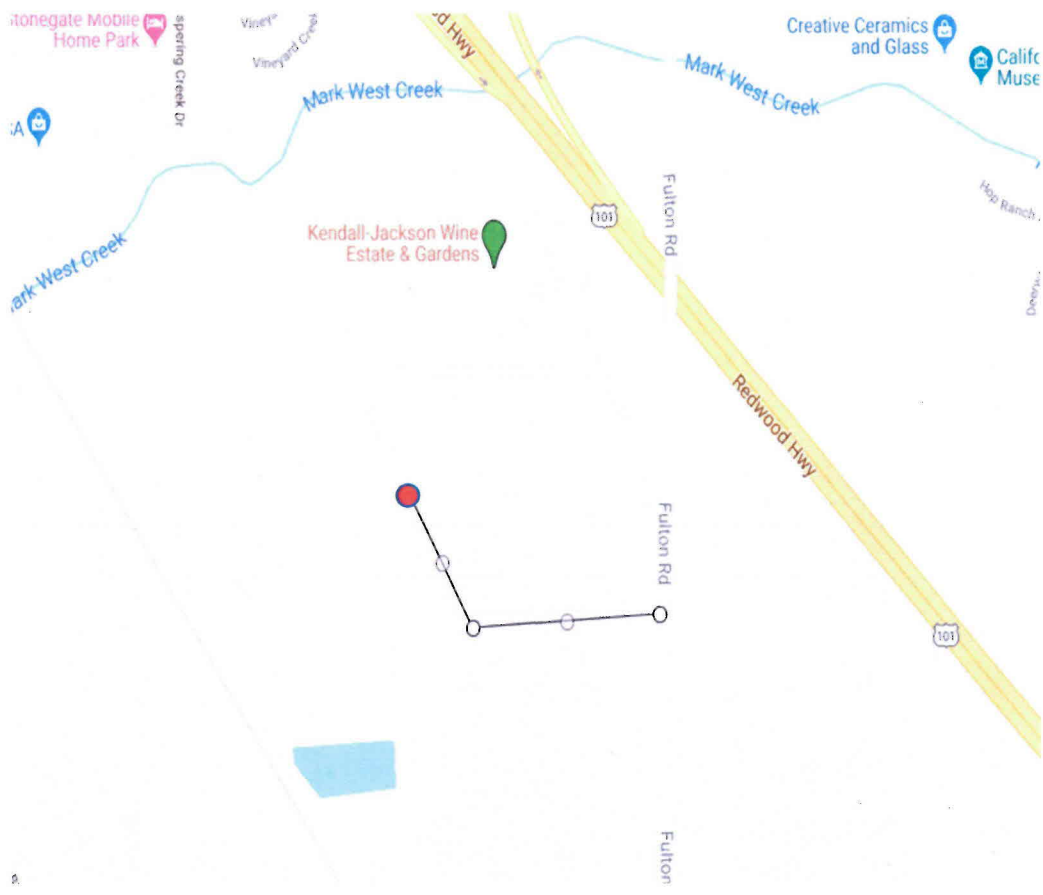

3600 Fulton Road

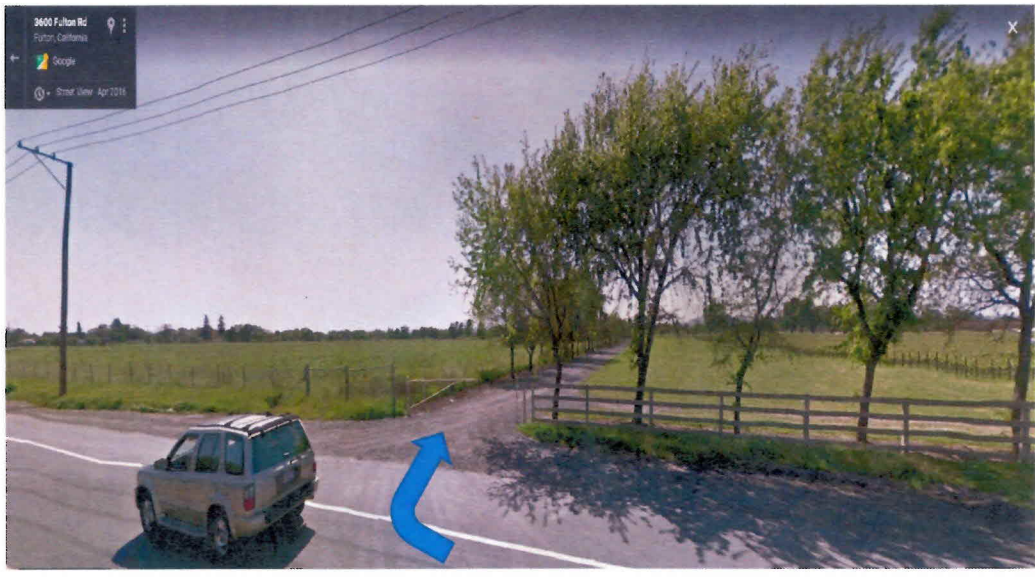

Turn Right at 3600 Fulton Road and follow until directed to park