



California Regional Water Quality Control Board Los Angeles Region



320 W. 4th Street, Suite 200, Los Angeles, California 90013
(213) 576-6600 • FAX (213) 576-6640
<http://www.waterboards.ca.gov/losangeles>

Matthew Rodriguez
Secretary for
Environmental Protection

Edmund G. Brown Jr.
Governor

January 27, 2012

Mr. Charles Evans
Assistant City Manager
City of Compton
205 South Willowbrook Avenue
Compton, CA 90220

REVISED MONITORING AND REPORTING PROGRAM NO. CI-9460 – FORMER COMPTON TAMARIND TRANSIT PROPERTY, 509 NORTH TAMARIND AVENUE, COMPTON, CALIFORNIA (ORDER NO. R4-2007-0019, SERIES NO. 082, CI-9460, GLOBAL ID. WDR100001381)

Dear Mr. Evans:

On December 12, 2008, Los Angeles Region Regional Water Quality Control Board (Regional Board) issued you general Waste Discharge Requirements (WDR) Order No. R4-2007-0019 and a Monitoring and Reporting Program (MRP) No. CI-9460 for a pilot test to inject potassium permanganate for groundwater remediation of chlorinated solvents, including tetrachloroethylene (PCE), trichloroethylene (TCE), and cis-1,2-dichloroethene (c-DCE).

On behalf of Olson Urban Housing, LLC, Stantec Consulting Corporation (Stantec) prepared and submitted the *Results of In-Situ Chemical Oxidation Pilot Study and Localized Groundwater Treatment Plan* (Treatment Plan), dated February 25, 2011. The Treatment Plan indicated that there was only limited effectiveness to introduce potassium permanganate solution into the aquifer to treat chlorinated volatile organic compounds using the high pressure delivery method. Therefore, Stantec proposed the groundwater remedial approach by injecting potassium permanganate solution using an alternate low flow delivery method in order to allow the oxidizing reagent to slowly disperse into the groundwater horizon in the identified source area.

On August 23, 2011, the Regional Board approved the Treatment Plan. Approximately 5,000 gallons of 3% potassium permanganate solution will be injected into the subsurface at depths approximately from 28.5 to 33.5 feet below ground surface (bgs) through 13 injection wells with injection pressure at approximately 15-20 pound per square inch (psi).

The revised MRP, which reflects the modification to the injection process, is enclosed. When submitting monitoring or technical reports to the Regional Board per these requirements, please include a reference to "Compliance File CI No. 9460" which assure that the reports are directed to the appropriate file and staff. Also, please do not combine other reports with your monitoring reports. Submit each type of report as a separate document.

California Environmental Protection Agency

Mr. Charles Evans
City of Compton

- 2 -

January 27, 2012

The Discharger shall comply with the Electronic Submittal of Information (ESI) requirements by submitting all reports required under the MRP, including groundwater monitoring data, discharge location data, and pdf monitoring reports to the State Water Resources Control Board GeoTracker database under Global ID WDR100001381. ESI training video is available at:

<https://waterboards.webex.com/waterboards/ldr.php?AT=pb&SP=MC&rID=44145287&rKey=7dad4352c990334b>

For all parties who upload electronic documents to State Database GeoTracker, it is no longer necessary to email a copy of these documents to losangeles@waterboards.ca.gov or submit hard copies to our office. The Regional Board will no longer accept documents (submitted by either hard copy or email) already uploaded to GeoTracker. Please see the attached announcement (Electronic Submittal to the Los Angeles Regional Board for GeoTracker User dated December 12, 2011) for further details.

To avoid paying future annual fees, please submit a written request for termination of your enrollment under the general WDR in a separate letter when the project is completed and the WDR is no longer needed. Be aware that the annual fee covers the fiscal year billing period beginning July 1 and ending June 30, the following year. You will pay the full annual fee if your request for termination is made after the beginning of the new fiscal year beginning July 1.

If you have any questions, please contact the Project Manager, Dr. Ann Chang at (213) 620-6122 (achang@waterboards.ca.gov), or the Chief of Groundwater Permitting Unit, Dr. Eric Wu at (213) 576-6683 (ewu@waterboards.ca.gov).

Sincerely,

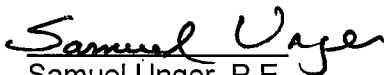

Samuel Unger, P.E.
Executive Officer

Enclosures:

Revised Monitoring and Reporting Program No. CI-9460 dated January 27, 2012
Electronic Submittal to the Los Angeles Regional Board for GeoTracker User
dated December 12, 2011

cc: Mr. Thomas Moore, The Olson Company
Mr. Michael Ugar, The Olson Company
Mr. Kofi Sefa-Boakyé, City of Compton
Mr. John Strickland, City of Compton
Mr. Michael Harvey, City of Compton
Mr. Kyle Emerson, Stantec
Mr. Dion Monge, Stantec

California Environmental Protection Agency

STATE OF CALIFORNIA
CALIFORNIA REGIONAL WATER QUALITY CONTROL BOARD
LOS ANGELES REGION

REVISED MONITORING AND REPORTING PROGRAM NO. CI-9460
FOR
FORMER COMPTON TAMARIND TRANSIT PROPERTY
509 NORTH TAMARIND AVENUE, COMPTON, CALIFORNIA

ENROLLMENT UNDER REGIONAL BOARD
ORDER NO. R4-2007-0019 (SERIES NO. 082)
FILE NO. 08-143

I. MONITORING AND REPORTING REQUIREMENTS

- A. The City of Compton (hereinafter Discharger) shall implement this revised Monitoring and Reporting Program on the effective date (January 27, 2012) under Regional Board Order No. R4-2007-0019. The next monitoring report under this program shall be received at the Regional Board by **April 15, 2012**. Subsequent monitoring reports shall be received at the Regional Board according to the following schedule:

<u>Monitoring Period</u>	<u>Report Due</u>
January – March	April 15
April – June	July 15
July – September	October 15
October – December	January 15

- B. If there is no discharge or injection, during any reporting period, the report shall so state. By March 1 of each year, the Discharger shall submit an annual summary report to the Regional Board. The report shall contain both tabular and graphical summaries of the monitoring data obtained during the previous calendar year. In addition, the Discharger shall discuss the compliance record and the corrective actions taken or planned, which may be needed to bring the discharge into full compliance with the waste discharge requirements.
- C. The Discharger shall comply with requirements contained in Section G of Order No. R4-2007-0019 "*Monitoring and Reporting Requirements*" in addition to the aforementioned requirements.

II. DISCHARGE MONITORING PROGRAM

The monitoring reports shall contain the following information regarding the injection activities:

1. Location map showing injection points used for the potassium permanganate solution.
2. Written and tabular summary defining depth of injection points, quantity of the potassium permanganate solution injected at each injection point, and total amount of the potassium permanganate solution injected at the Site.
3. Visual inspection at each injection point shall be conducted and recorded during the injection.

III. GROUNDWATER MONITORING PROGRAM

A groundwater monitoring program shall be implemented to evaluate impacts associated with the injection activity. Groundwater samples shall be collected from monitoring wells W-1, W-2R, W-3, W-4, W-7, and W-10 (Figures 2 and 3). The Discharger shall conduct a baseline sampling prior to the proposed injection, followed by months 1, 2, 3, and quarterly sampling events after the injections from all six monitoring wells for the following groundwater parameters:

CONSTITUENT	UNITS	TYPE OF SAMPLE	MINIMUM FREQUENCY OF ANALYSIS
Dissolved Oxygen	mg/L	grab	Baseline, months 1, 2, 3 after injection, and quarterly thereafter
Oxidation-Reduction Potential	millivolts	grab	Same as specified above
pH	pH units	grab	Same as specified above
Specific Conductivity	mS/cm	grab	Same as specified above
Temperature	°C	grab	Same as specified above
Turbidity	NTU	grab	Same as specified above
Total Organic Carbon	mg/L	grab	Same as specified above

CONSTITUENT	UNITS	TYPE OF SAMPLE	MINIMUM FREQUENCY OF ANALYSIS
Total Dissolved Solids	mg/L	grab	Same as specified above
Sulfate	mg/L	grab	Same as specified above
Chloride	mg/L	grab	Same as specified above
Boron	mg/L	grab	Same as specified above
Nitrate and Nitrite	mg/L	grab	Same as specified above
Permanganate	mg/L	grab	Same as specified above
Volatile Organic Compounds	µg/L	grab	Same as specified above
Color	color unit	grab	Same as specified above

All groundwater monitoring reports must include, at minimum, the following:

- a. Well identification, date and time of sampling;
- b. Sampler identification, and laboratory identification;
- c. Quarterly observation of groundwater levels, recorded to 0.01 feet mean sea level and groundwater flow direction.

IV. MONITORING FREQUENCIES

Specifications in this monitoring program are subject to periodic revisions. Monitoring requirements may be modified or revised by the Executive Officer based on review of monitoring data submitted pursuant to this Order. Monitoring frequencies may be adjusted to a less frequent basis or parameters and locations dropped by the Executive Officer if the Discharger makes a request and the request is backed by statistical trends of monitoring data submitted.

V. CERTIFICATION STATEMENT

Each report shall contain the following completed declaration:

"I certify under penalty of law that this document, including all attachments and supplemental information, was prepared under my direction or supervision in accordance with a system designed to assure that qualified personnel properly gathered and evaluated the information submitted. Based on my inquiry of the person or persons who manage the system, or those persons directly responsible for gathering the information, the information submitted is, to the best of my knowledge and belief, true, accurate, and complete. I am aware that there are significant penalties for submitting false information, including the possibility of a fine and imprisonment.

Executed on the _____ day of _____ at _____

_____ (Signature)

_____ (Title)"

VI. PUBLIC DOCUMENTS

All records and reports submitted in compliance with Order No.R4-2007-0019 and Monitoring and Reporting Program No. CI-9460 are public documents and will be made available for inspection during business hours at the office of the California Regional Water Quality Control Board, Los Angeles Region, upon request by interested parties. Only proprietary information, and only at the request of the Discharger will be treated as confidential.

VII. ELECTRONIC SUBMITTAL OF INFORMATION

The Discharger shall comply with the Electronic Submittal of Information (ESI) requirements by submitting all reports required under the MRP, including groundwater monitoring data, discharge location data, and pdf monitoring reports to the State Water Resources Control Board GeoTracker database under Global ID WDR100001381.

Ordered by: Samuel Unger
Samuel Unger, P.E.
Executive Officer

Date: January 27, 2012

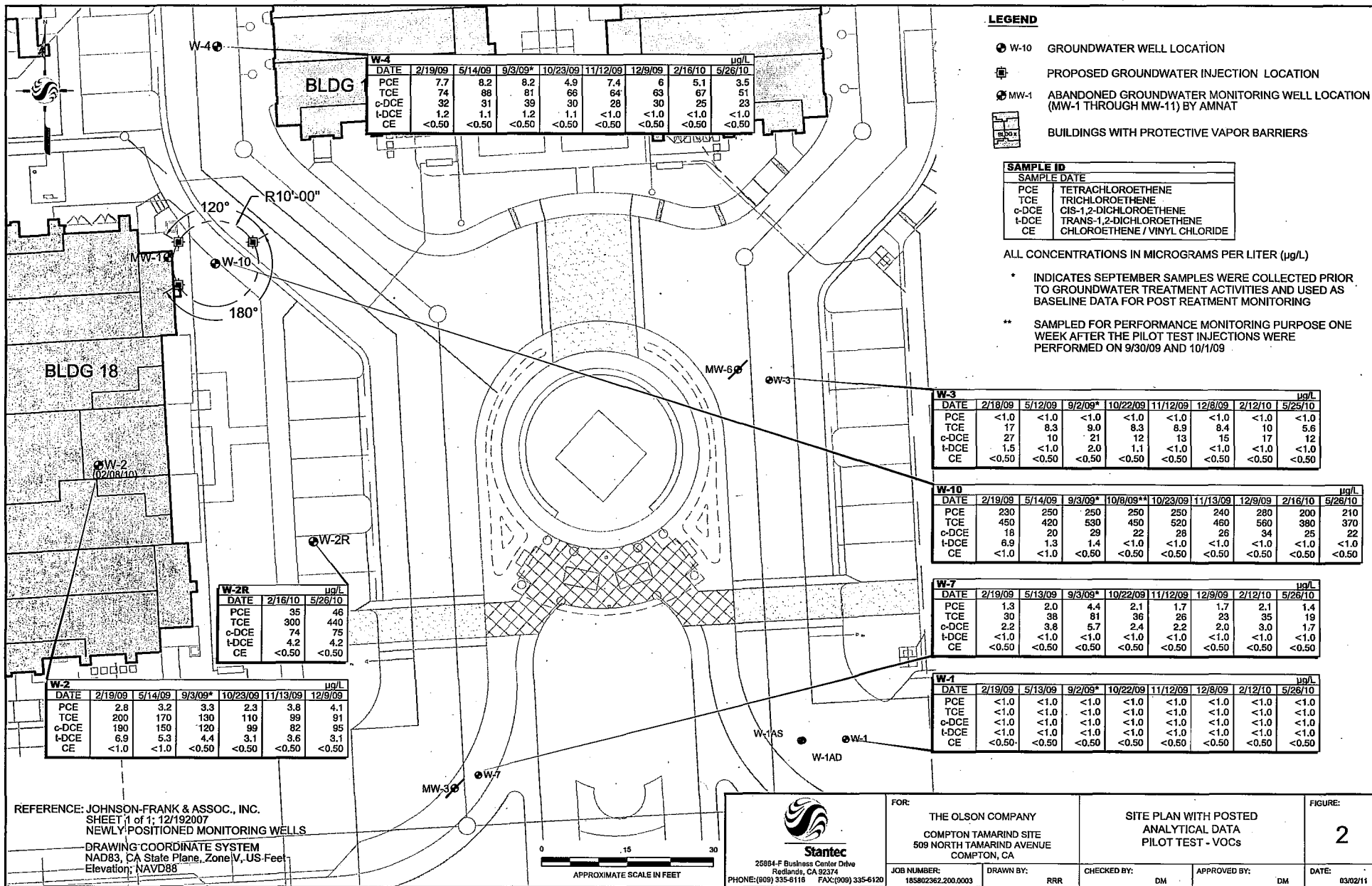

DATE	2/19/09	5/14/09	9/3/09*	10/23/09	11/12/09	12/9/09	2/16/10	5/26/10
PCE	7.7	8.2	8.2	4.9	7.4	6	5.1	3.5
TCE	74	88	81	66	64	63	67	51
c-DCE	32	31	39	30	28	30	25	23
t-DCE	1.2	1.1	1.2	1.1	<1.0	<1.0	<1.0	<1.0
CE	<0.50	<0.50	<0.50	<0.50	<0.50	<0.50	<0.50	<0.50

LEGEND

- W-10 GROUNDWATER WELL LOCATION
- PROPOSED GROUNDWATER INJECTION LOCATION
- MW-1 ABANDONED GROUNDWATER MONITORING WELL LOCATION (MW-1 THROUGH MW-11) BY AMNAT
- ▨ BUILDINGS WITH PROTECTIVE VAPOR BARRIERS

SAMPLE ID	
SAMPLE DATE	
PCE	TETRACHLOROETHENE
TCE	TRICHLOROETHENE
c-DCE	CIS-1,2-DICHLOROETHENE
t-DCE	TRANS-1,2-DICHLOROETHENE
CE	CHLOROETHENE / VINYL CHLORIDE

ALL CONCENTRATIONS IN MICROGRAMS PER LITER (µg/L)

- * INDICATES SEPTEMBER SAMPLES WERE COLLECTED PRIOR TO GROUNDWATER TREATMENT ACTIVITIES AND USED AS BASELINE DATA FOR POST TREATMENT MONITORING
- ** SAMPLED FOR PERFORMANCE MONITORING PURPOSE ONE WEEK AFTER THE PILOT TEST INJECTIONS WERE PERFORMED ON 9/30/09 AND 10/1/09

DATE	2/18/09	5/12/09	9/2/09*	10/22/09	11/12/09	12/8/09	2/12/10	5/25/10
PCE	<1.0	<1.0	<1.0	<1.0	<1.0	<1.0	<1.0	<1.0
TCE	17	8.3	9.0	8.3	8.9	8.4	10	5.6
c-DCE	27	10	21	12	13	15	17	12
t-DCE	1.5	<1.0	2.0	1.1	<1.0	<1.0	<1.0	<1.0
CE	<0.50	<0.50	<0.50	<0.50	<0.50	<0.50	<0.50	<0.50

DATE	2/19/09	5/14/09	9/3/09*	10/8/09**	10/23/09	11/13/09	12/9/09	2/16/10	5/26/10
PCE	230	250	250	250	250	240	280	200	210
TCE	450	420	530	450	520	460	560	380	370
c-DCE	18	20	29	22	28	26	34	25	22
t-DCE	6.9	1.3	1.4	<1.0	<1.0	<1.0	<1.0	<1.0	<1.0
CE	<1.0	<1.0	<0.50	<0.50	<0.50	<0.50	<0.50	<0.50	<0.50

DATE	2/19/09	5/13/09	9/3/09*	10/22/09	11/12/09	12/9/09	2/12/10	5/26/10
PCE	1.3	2.0	4.4	2.1	1.7	1.7	2.1	1.4
TCE	30	38	81	36	26	23	35	19
c-DCE	2.2	3.8	5.7	2.4	2.2	2.0	3.0	1.7
t-DCE	<1.0	<1.0	<1.0	<1.0	<1.0	<1.0	<1.0	<1.0
CE	<0.50	<0.50	<0.50	<0.50	<0.50	<0.50	<0.50	<0.50

DATE	2/19/09	5/13/09	9/2/09*	10/22/09	11/12/09	12/8/09	2/12/10	5/26/10
PCE	<1.0	<1.0	<1.0	<1.0	<1.0	<1.0	<1.0	<1.0
TCE	<1.0	<1.0	<1.0	<1.0	<1.0	<1.0	<1.0	<1.0
c-DCE	<1.0	<1.0	<1.0	<1.0	<1.0	<1.0	<1.0	<1.0
t-DCE	<1.0	<1.0	<1.0	<1.0	<1.0	<1.0	<1.0	<1.0
CE	<0.50	<0.50	<0.50	<0.50	<0.50	<0.50	<0.50	<0.50

DATE	2/19/09	5/14/09	9/3/09*	10/23/09	11/13/09	12/9/09
PCE	2.8	3.2	3.3	2.3	3.8	4.1
TCE	200	170	130	110	99	91
c-DCE	190	150	120	99	82	95
t-DCE	6.9	5.3	4.4	3.1	3.6	3.1
CE	<1.0	<1.0	<0.50	<0.50	<0.50	<0.50

DATE	2/16/10	5/26/10
PCE	35	46
TCE	300	440
c-DCE	74	75
t-DCE	4.2	4.2
CE	<0.50	<0.50

REFERENCE: JOHNSON-FRANK & ASSOC., INC.
 SHEET 1 of 1; 12/192007
 NEWLY POSITIONED MONITORING WELLS
 DRAWING COORDINATE SYSTEM
 NAD83, CA State Plane, Zone V, US Feet
 Elevation: NAVD88

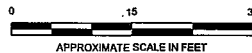

26884-F Business Center Drive
 Redlands, CA 92374
 PHONE: (909) 335-6116 FAX: (909) 335-6120

FOR: THE OLSON COMPANY
 COMPTON TAMARIND SITE
 509 NORTH TAMARIND AVENUE
 COMPTON, CA

SITE PLAN WITH POSTED
 ANALYTICAL DATA
 PILOT TEST - VOCs

FIGURE:

2

JOB NUMBER: 185802362.200.0003 DRAWN BY: RRR CHECKED BY: DM APPROVED BY: DM DATE: 03/02/11

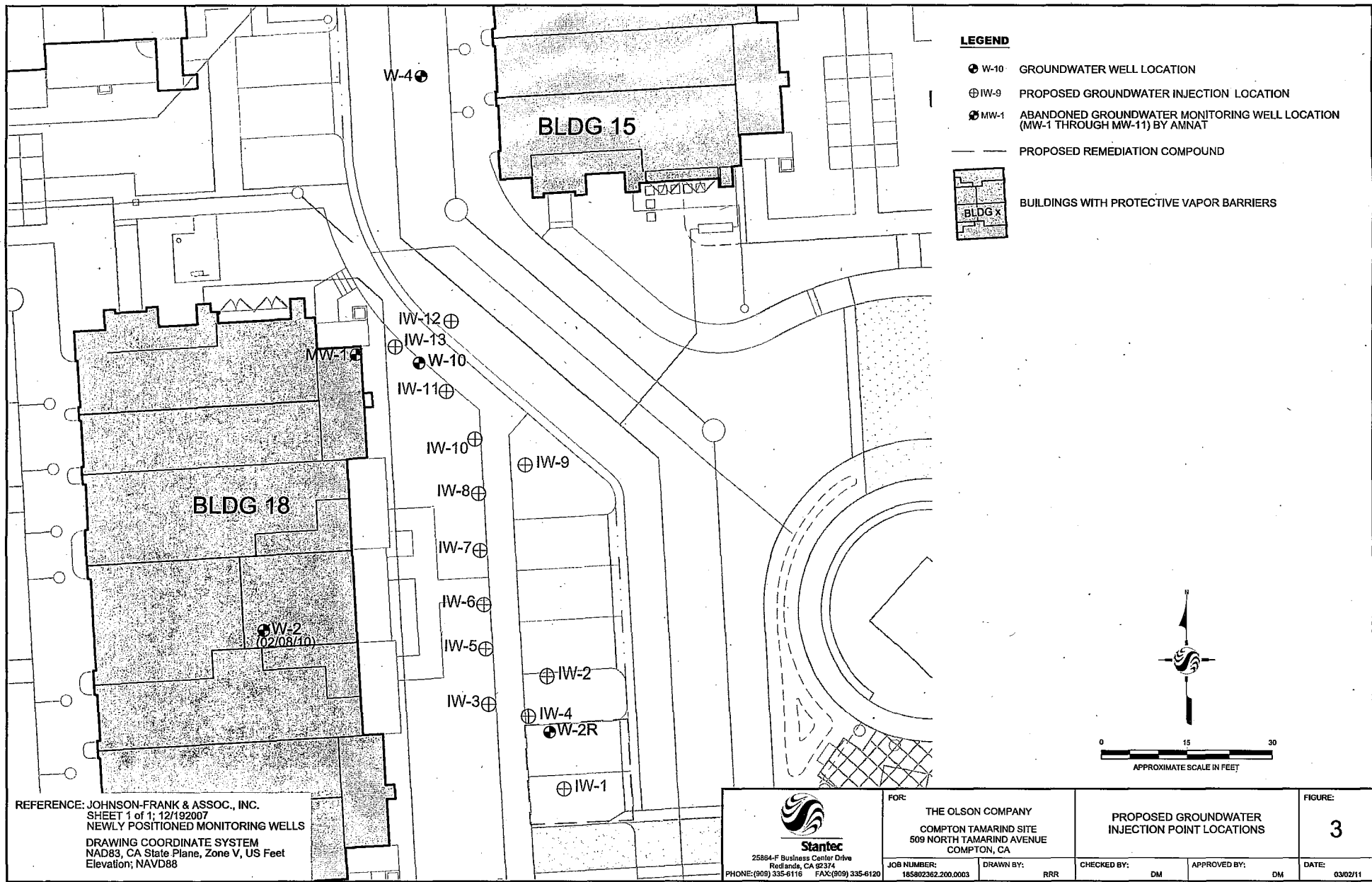



California Regional Water Quality Control Board Los Angeles Region



Matthew Rodriguez
Secretary for
Environmental Protection

320 W. 4th Street, Suite 200, Los Angeles, California 90013
(213) 576-6600 • FAX (213) 576-6640
<http://www.waterboards.ca.gov/losangeles>

Edmund G. Brown Jr.
Governor

December 12, 2011

Electronic Submittal to the Los Angeles Regional Board for GeoTracker Users

To Interested Parties:

Effective November 1, 2011, the Los Angeles Regional Water Quality Control Board (Regional Board) implemented a Paperless Office system. Interested parties were notified of this intent in a letter dated October 20, 2011 (the announcement can be seen at <http://www.waterboards.ca.gov/losangeles/resources/Paperless/>).

This letter is intended to clarify the electronic submittal process for all **GeoTracker** users in accordance with the October 20, 2011 Paperless Office announcement.

For all parties who upload electronic documents to State Database GeoTracker, it is no longer necessary to email a copy of these documents to losangeles@waterboards.ca.gov or submit hard copies to our office.

The Regional Board will no longer accept documents (submitted by either hard copy or email) already uploaded to GeoTracker. In special circumstances where GeoTracker may not be the best place to submit correspondence, such as oversized or confidential documents, please contact case staff directly to arrange a submittal method.

If you have questions regarding this matter, please contact the appropriate staff assigned to your program or project. You may refer to the Regional Boards' Departmental Listing for contact information.

Sincerely,

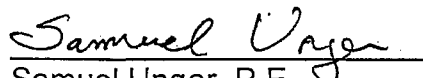
Samuel Unger, P.E.
Executive Officer