



# California Regional Water Quality Control Board Central Valley Region

Katherine Hart, Chair



Linda S. Adams  
Secretary for  
Environmental  
Protection

11020 Sun Center Drive #200, Rancho Cordova, California 95670-6114  
Phone (916) 464-3291 • FAX (916) 464-4645  
<http://www.waterboards.ca.gov/centralvalley>

Arnold  
Schwarzenegger  
Governor

11 February 2010

Mr. Carl Bertram  
Vineyard RV Resort, LLC  
4985 Midway Road  
Vacaville, CA, 95688

**CERTIFIED MAIL**  
**7009 0960 0000 4241 8880**

## **NOTICE OF APPLICABILITY (NOA): WATER QUALITY ORDER NO. 97-10-DWQ-R5060 VINEYARD RV RESORT, LLC, VINEYARD RV RESORT, SOLANO COUNTY**

Central Valley Regional Water Quality Control Board (Central Valley Water Board) staff received a Report of Waste Discharge (RWD) dated 17 July 2009 and supplemental material from the Vineyard Recreational Vehicle (RV) Resort, LLC (Discharger) for discharge of domestic wastewater. The Discharger plans a phased project that will expand the RV Resort and improve the treatment and disposal of the collected domestic wastewater. Additional improvements involve retrofitting the surface water drainage ravine that passes through the site. Phase I consists of installing the drainage ravine improvements and developing the vacant land east of a drainage ravine. Phase II involves retrofitting the existing wastewater treatment and disposal facilities, which are currently regulated by Solano County, on the west side of the drainage ravine.

Based on the information provided in the RWD, the proposed expansion of Phase I and the associated discharge of treated domestic wastewater satisfy the general and specific conditions of State Water Resources Control Board (State Water Board) Water Quality Order No. 97-10-DWQ General Waste Discharge Requirements for Discharges to Land by Small Domestic Wastewater Treatment Systems. Therefore, this letter serves as formal notice that Water Quality Order No. 97-10-DWQ is applicable to the site and discharge described below. You are hereby assigned General Order No. 97-10-DWQ-R5060 (General Order) for Phase I of the expansion.

Phase II is not covered by this NOA. Prior to Phase II development, the Discharger will either apply for individual Waste Discharge Requirements (WDRs), or if applicable, apply for general order regulatory coverage for the entire facility.

A copy of the General Order is enclosed. You can also find the General Order on the State Board's website at [http://www.waterboards.ca.gov/board\\_decisions/adopted\\_orders/water\\_quality/wqo97.shtml](http://www.waterboards.ca.gov/board_decisions/adopted_orders/water_quality/wqo97.shtml) You are urged to familiarize yourself with the contents of the entire General Order. The facility must be operated in accordance with the requirements contained in the General Order, Standard Provisions and Reporting Requirements for WDRs, and with the information submitted in the RWD.

## **FACILITY AND DISCHARGE DESCRIPTION**

***California Environmental Protection Agency***

The Vineyard RV Resort is located at 4985 Midway Road, Vacaville in Section 26, T7N, R1W, MDB&M (Assessor's Parcel Number (APN) 0106210470) and is shown on Attachment A of this NOA.

The Vineyard RV Resort is owned and operated by the Discharger as a day use and camping facility for RVs. Phase I of the Vineyard RV Resort upgrade and expansion involves developing vacant land with 159 RV lots as shown on Attachment B of this NOA. Phase I may span several years and will occur in three sub-phases sequentially adding 50 lots in the first sub-phase, 59 in the second sub-phase and 50 lots in the third sub-phase.

RVs at each lot will be directly connected to the domestic wastewater collection system. Based on historic flows of the existing facility and other RV facilities owned by the Discharger, each lot is estimated to produce 29.5 gallons per day (gpd) of domestic wastewater. The wastewater treatment system has been designed for 50 gpd per lot (a safety factor of 1.7). The design capacity of the treatment plant after build-out is 7,950 gpd.

Collected wastewater will be conveyed to the treatment system, which will provide primary settling, secondary treatment, and UV disinfection. After full build-out of Phase I, primary settling will consist of three 10,000 gallon settling tanks arranged in series, which will be pumped annually. Secondary treatment will involve primary treated wastewater flowing to an 8,000 gallon processing tank with recirculation through three to four package treatment units arranged in parallel. Each package treatment unit is capable of handling an average daily flow of 2,500 gpd and a peak flow of 5,000 gpd. Three or four treatment units are planned to be installed depending on site specific treatment requirements. Package treatment units provide filtration of secondary treated wastewater prior to UV disinfection in a 10,000 gallon dosing tank.

Disinfected wastewater is reused for subsurface irrigation at the common area and at individual RV lots. There is roughly 59,250 square feet of total land available for disposal. The disposal area design requirement is 53,000 square feet, which includes the primary disposal area and a 100 percent reserve disposal area. The reserve disposal area will be fitted with subsurface disposal lines on an as needed basis in case of primary disposal field failure. The wastewater treatment facility will be operated, maintained, and monitored by a certified wastewater treatment plant operator.

Subsurface irrigation lines will be installed 12 inches below grade. Shallow groundwater monitoring wells were installed to a depth of 8 feet. The wells were monitored from the first week in January through the middle of March in 2007 and groundwater was not detected. Based on three local Department of Water Resources groundwater monitoring wells, groundwater in the area is expected to be approximately 20 feet below ground surface. Additionally, to avoid groundwater contamination due to RV wastewater chemical additives (e.g. formaldehyde), each RV that enters the site will be required to drain the vehicle's blackwater tank into the holding tank located in the service island at the resort's entrance. After discharging the tank's contents, each vehicle operator will be instructed to only use owner approved chemical additives (i.e. additives not containing formaldehyde or similar compounds) while at the resort. Therefore, based on the treatment design and the site information provided by the discharger, the discharge poses little or no threat to the quality of groundwater.

### **MONITORING AND REPORTING PROGRAM**

The Discharger shall comply with the monitoring and reporting requirements prescribed in Monitoring and Reporting Program No. R5-2010-0801 included as Attachment C of this NOA, which replaces Monitoring and Reporting Program No. 97-10-DWQ.

### **GENERAL INFORMATION AND REQUIREMENTS**

The Discharger shall comply with the Prohibitions, Requirements, Groundwater and Surface Water Limitations, and Provisions of Water Quality Order No. 97-10-DWQ. However, Requirements B.3, B.4, and B.6 and Provision D.3 do not apply to the regulation of the sewer and subsurface disposal system.

Please review this Notice of Applicability carefully to ensure that it completely and accurately reflects the proposed project of Phase I. If the Discharger violates the terms or conditions above, the Central Valley Water Board may take enforcement action, including assessment of administrative civil liability.

Vineyard RV Resort, LLC will generate the waste subject to the terms and conditions of the General Order and will maintain exclusive control over the discharge. As such, Vineyard RV Resort, LLC is primarily responsible for compliance with the General Order.

Failure to comply with the requirements in the Order could result in an enforcement action as authorized by provisions of the California Water Code. Discharge of wastes other than those described in the RWD is prohibited.

The required annual fee specified in the annual billing from the State Water Board shall be paid until this NOA is officially terminated. You must notify this office in writing if the discharge regulated by this Order ceases so that coverage under the General Order can be terminated and to avoid unnecessary billing.

All monitoring reports, submittals, discharge notifications, and questions regarding compliance and enforcement should be directed to Mr. Guy Childs at (916) 464-4648 or [gchilds@waterboards.ca.gov](mailto:gchilds@waterboards.ca.gov). Questions regarding the General Order should be directed to Mr. Robin Merod at (916) 464 4697 or [rmerod@waterboards.ca.gov](mailto:rmerod@waterboards.ca.gov).

Original Signed by Kenneth D. Landau for

Pamela C. Creedon  
Executive Officer

Enclosure(s): Standard Provisions and Reporting Requirements for WDRs  
General Order No. 97-10-DWQ

cc w/out enc.: Gordon Innes, Division of Water Quality, State Water Board, Sacramento  
Jeffrey Bell, Solano County Environmental Health Department, Fairfield  
Jim Campi, Campi Engineering, Fairfield

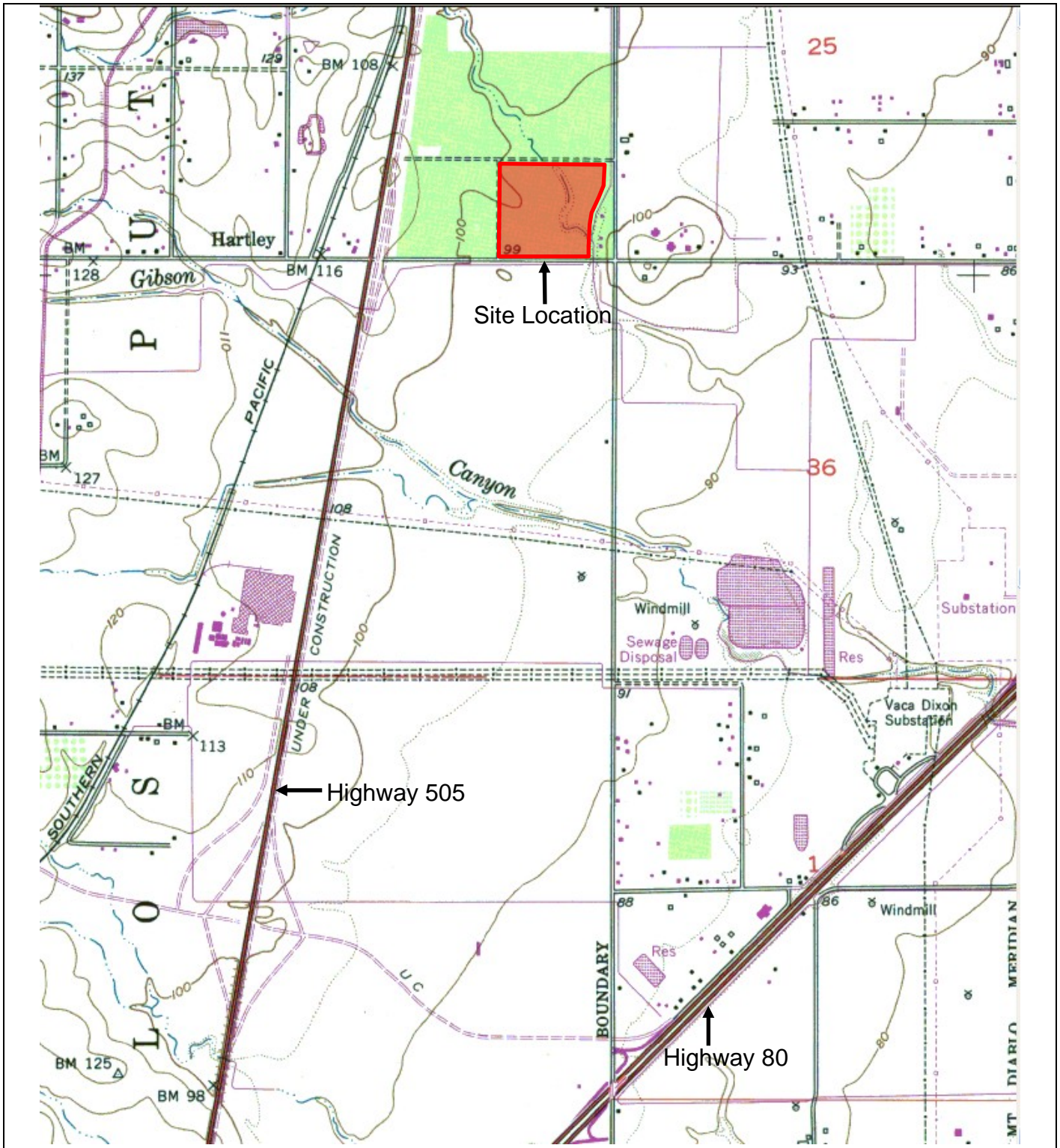

Drawing Reference:  
U.S.G.S  
Allendale  
TOPOGRAPHIC MAP  
7.5 MINUTE QUAD

SITE LOCATION MAP  
VINEYARD RV RESORT  
SOLANO COUNTY

approx. scale  
1 in. = 1,845 ft.

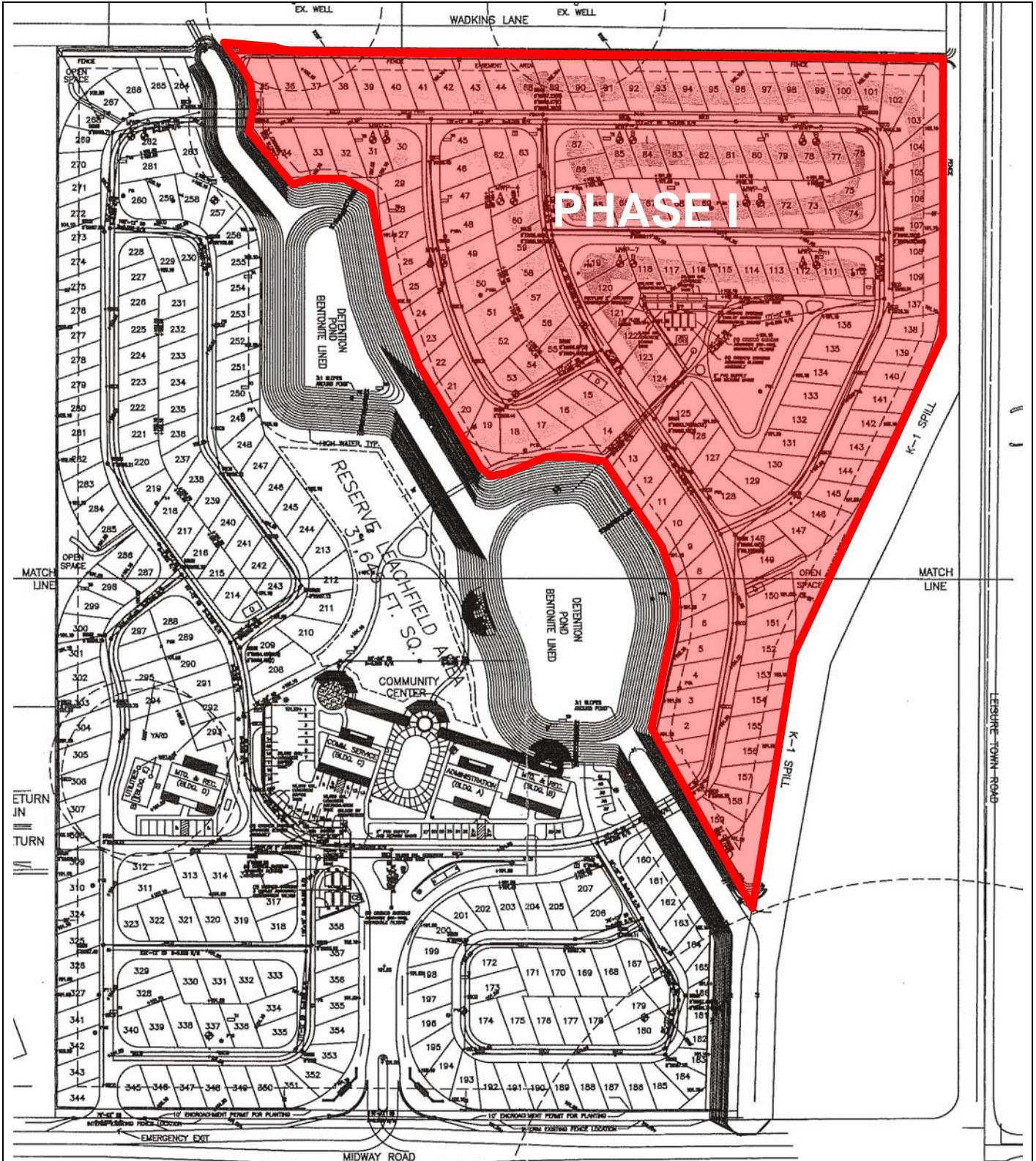

Drawing Reference:  
Campi Engineering

FACILITY MAP  
VINEYARD RV RESORT  
SOLANO COUNTY

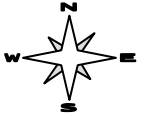
  
 approx. scale  
 1 in. = 160 ft.