



California Regional Water Quality Control Board Central Valley Region



Linda S. Adams
Secretary for
Environmental Protection

Katherine Hart, Chair

Arnold Schwarzenegger
Governor

415 Knollcrest Drive, Suite 100, Redding, California 96002
(530) 224-4845 • Fax (530) 224-4857
<http://www.waterboards.ca.gov/centralvalley>

16 September 2010

CERTIFIED MAIL

7009 2250 0002 9885 2579

Phil Mackey
Mt. Lassen Trout Farms, Inc.
20560 Lanes Valley Road
Paynes Creek, CA 96075

CERTIFIED MAIL

7009 2250 0002 9885 2586

David Wiens
Lands Department
Pacific Gas and Electric
3600 Meadowview Drive
Redding, CA 96002

NOTICE OF APPLICABILITY; WASTE DISCHARGE REQUIREMENTS FOR COLD WATER CONCENTRATED AQUATIC ANIMAL PRODUCTION FACILITY DISCHARGES TO SURFACE WATERS; MT. LASSEN TROUT FARMS, INC., AND PACIFIC GAS AND ELECTRIC COMPANY, MT. LASSEN TROUT FARMS' VOLTA FACILITY, SHASTA COUNTY

Mt. Lassen Trout Farms, Inc., owns and operates the Volta Fish Hatchery (hereafter Facility), located on land leased from the Pacific Gas and Electric Company. Mt. Lassen Trout Farms and Pacific Gas and Electric Company are hereafter designated as the Discharger. The California Regional Water Quality Control Board, Central Valley Region (Central Valley Water Board) has reviewed the Report of Waste Discharge (ROWD) dated 14 May 2009 for renewal of existing Order No. R5-2004-0146 (NPDES No. CA0083879) for the Facility. The ROWD was deemed complete on 9 June 2009.

On 29 January 2010, General Order No. R5-2010-0018, (NPDES No. CAG135001), Waste Discharge Requirements for Cold Water Concentrated Aquatic Animal Production Facility Discharges to Surface Waters (General Order) was adopted by the Central Valley Water Board. The General Order regulates the discharge of pollutants from Cold Water Concentrated Aquatic Animal Production facilities (CAAP facilities) to surface waters in the Central Valley Region. The Facility discharge meets the conditions for coverage under the General Order. The Central Valley Water Board has determined that discharges from your CAAP facility are more appropriately regulated under the General Order than by the existing individual permit. Therefore, the existing Order No. R5-2004-0146 (NPDES No. CA0083879) is scheduled for rescission by a separate action of the Central Valley Water Board at a future regularly scheduled Board meeting.

The Discharger has been assigned an enrollee number of R5-2010-0018-005. Administrative information for the Facility is provided in Attachment A, a part of this Notice of Applicability (NOA).

The CAAP facility operations and discharge shall be managed in accordance with the requirements contained in the General Order, this NOA, and with the information submitted by



the Discharger. The General Order (enclosed) may also be viewed at the following web address:

http://www.waterboards.ca.gov/centralvalley/board_decisions/adopted_orders/general_orders/r5-2010-0018_npdes.pdf

You are urged to familiarize yourself with the contents of the entire document. Attachment C of the General Order prescribes mandatory monitoring requirements.

FACILITY INFORMATION/DISCHARGE DESCRIPTION

The Facility is located approximately 2 miles north of Manton, Shasta County, in Section 16, T30N, R1E, MDB&M, as shown on Attachment A, a part of this NOA. The property is owned by the Pacific Gas and Electric Company and is on Assessor's Parcel No. 999-019-41. Based on information submitted by the Discharger in the ROWD, the maximum annual production of the Facility is approximately 60,000 pounds (lbs) of cold water species (rainbow trout).

The Facility utilizes water diverted from Brush Creek which flows through a concrete raceway and seven earthen in-series rearing ponds. Single pass flow-through water from the rearing ponds enters a settling basin before discharging to PG&E's Cross Country Canal (Discharge Point 001), as shown in the Facility schematic (Attachment C), a part of this NOA. The Cross Country Canal is tributary to the South Fork of Battle Creek. The Facility has a maximum design operational flow limit of 6.5 million gallons per day (mgd).

The Discharger reports that no chemicals have been used at the Facility since 2002.

Solids are removed using a vacuum pump from the setting basin and one of the in-series rearing ponds. The pumped solids are discharged to one of two evaporation ponds, one located adjacent to the settling basin and one located adjacent to one of the of the in-series rearing ponds. The dried solids are used by local farmers as a soil amendment.

There is no permanent residence on-site. A seasonal travel trailer with a self-contained tank for domestic wastewater serves as an employee residence and office. Domestic wastewater from the self-contained trailer is disposed off-site.

MONITORING REQUIREMENTS

The General Order requires that dischargers comply with the Monitoring and Reporting Program that is incorporated as Attachment C to the General Order. Influent, effluent, and receiving water monitoring requirements are based on the pounds of fish produced. This Facility is in the category of production less than 100,000 lbs of fish.

The Discharger conducted priority pollutant metals monitoring on 2 June 2008. The data show that there is no reasonable potential for priority pollutant metals to cause or contribute to an exceedance of water quality objectives. The Discharger reports that the Facility does not use copper sulfate or chelated copper compounds. The receiving waters are not listed under the

Clean Water Act 303(d) List of impaired water bodies; therefore, no additional monitoring requirements will be required.

Site-specific monitoring locations for influent, effluent and receiving water monitoring shown in Attachment C to this NOA (Facility schematic) and as described in the following table:

Monitoring Location Descriptions

Point Name	Monitoring Location Name	Monitoring Location Description
Influent	INF-001	At the diversion box where source water is diverted from Brush Creek.
Discharge 001	EFF-001	At a location where a representative sample can be obtained of the discharge from Discharge Point 001 prior to entering the PG&E Cross Country Canal.
Receiving Water Upstream	RSW-001	The wastewater discharge when it leaves the Facility under control of the Discharger enters the PG&E Cross Country Canal penstock discharge where, because of safety concerns, the Discharger is unable to sample the receiving stream above and below Discharge Point 001. In lieu of receiving water monitoring the parameters required to be sampled in the receiving water shall be monitored at Monitoring Locations INF-001 and EFF-001.
Receiving Water Downstream	RSW-002	

NOTICE OF APPLICABILITY REQUIREMENTS

Based on the information provided in the ROWD, the Discharger is hereby authorized to discharge to the PG&E Cross Country Canal under the terms and conditions of General Order No. R5-2010-0018. In addition to the requirements contained in the General Order, the following shall also apply:

1. The discharge from the Facility shall not exceed 6.5 mgd during the effective period of the General Order.
2. The Discharger is required to comply with all the Monitoring and Reporting Requirements contained in Attachment C to the General Order for facilities with production less than 100,000 pounds of fish.
3. The Discharger shall electronically submit Self-Monitoring Reports (SMRs) using the State Water Board's California Integrated Water Quality System (CIWQS) Program website (<http://www.waterboards.ca.gov/ciwqs/index.html>). The CIWQS website will provide additional directions for SMR submittal in the event there will be service interruption for electronic submittal.
4. The State Water Resources Control Board (State Water Board) has determined that individual or general permits for aquaculture activities defined in 40 CFR 122.25(b) will be subject to the same annual fee, which currently is \$1,000 (State Water Board Resolution 2002-0150), but may be subject to change.
5. The General Order expires on 1 January 2015, and enrollees will continue to be authorized to discharge until coverage becomes effective under a reissued Order or

until Central Valley Water Board staff formally terminates your coverage. Only those CAAP facilities authorized to discharge and who submit a Notice of Intent at least 180-days prior to the expiration date of General Order No. R5-2010-0018 will remain authorized to discharge under administratively continued permit conditions.

6. Pacific Gas and Electric Company, as owner of the real property at which the discharge will occur, is ultimately responsible for ensuring compliance with the General Order. Mt. Lassen Trout Farms, Inc. retains primary responsibility for compliance with the General Order, including day-to-day operations and monitoring. Enforcement actions will be taken against Pacific Gas and Electric Company only in the event that enforcement actions against Mt. Lassen Trout Farms, Inc. are ineffective or would be futile.

Failure to comply with the General Order and this NOA may result in enforcement actions, which could include administrative civil liability. Effluent limitation violations and some late reporting violations are subject to a Mandatory Minimum Penalty (MMP) of \$3,000 per violation [California Water Code Sections 13385(h) and (i)]. If you have no discharge during a monitoring period, you must submit a report indicating that no discharge occurred. You must notify the Central Valley Water Board staff within 24 hours of noncompliance or anticipated noncompliance.

Please reference your enrollee number, R5-2010-0018-005, in all your correspondence and submitted documents.

If you have any questions regarding monitoring reports submittals, discharge notifications, compliance or enforcement, or questions on the General Order or NOA, please contact, Jacqueline Matthews at (530) 224-3249, or jmathews@waterboards.ca.gov.

Original Signed By Robert A. Crandall

for PAMELA C. CREEDON
Executive Officer

JM: lm

NOA Attachments: Attachment A - Administrative Information
Attachment B – Location Map
Attachment C – Facility Schematic

Enclosure: General Order No. R5-2010-0018 (Discharger only)

Distribution List: Mr. David Smith, U.S. EPA, Region IX, San Francisco
Mr. Phil Isorena, State Water Resources Control Board, Sacramento

ATTACHMENT A – FACILITY ADMINISTRATIVE INFORMATION

Name of Facility	Mt. Lassen Trout Farms Volta Facility
Type of Facility	Cold Water Aquaculture Facility, SIC Code 0921
WDID	5A452037003
General Order NOA Enrollee Number	R5-2010-0018-005
Discharger	Mt. Lassen Trout Farms, Inc.(Facility Owner/Operator) and Pacific Gas and Electric Company (Site Owner)
Facility Address	0.5 Miles west of PG&E Volta Powerhouse
Land Owner (Address)	Pacific Gas and Electric 3600 Meadowview Drive Redding, CA 96002
Facility Contact, Title and Phone	Phil Mackey, (530) 597-2222
Authorized Person to Sign and Submit Reports	Phil Mackey, President Daniel R. Brown, Vice President
Mailing Address	20560 Lanes Valley Road Paynes Creek, CA 96075
Billing Address	20560 Lanes Valley Road Paynes Creek, CA 96075
Total Weight Produced (Annual)	60,000 lbs
Major or Minor Facility	Minor
Threat to Water Quality	2
Complexity	B
Facility Permitted Flow	6.5 mgd
Watershed	Sacramento River Basin
Receiving Water	PG&E Cross Country Canal, a Tributary to South Fork Battle Creek
Receiving Water Type	Inland surface water

ATTACHMENT B – LOCATION MAP

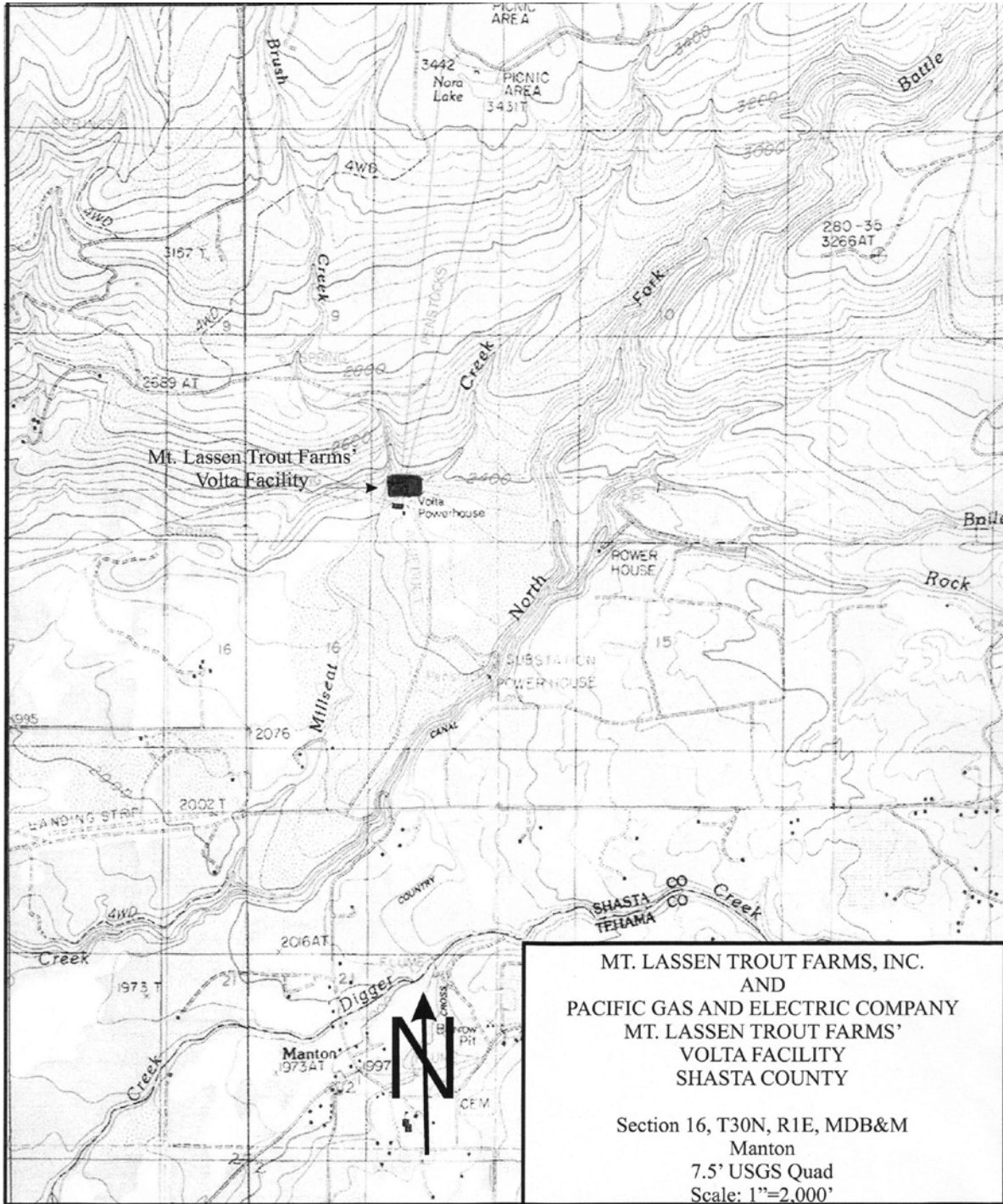

ATTACHMENT C – FACILITY SCHEMATIC

