

---

## Central Valley Regional Water Quality Control Board

24 October 2019

Clifton Taylor  
JEN California 6, LLC  
508 Gibson Drive, Suite 260  
Roseville, CA 95678

**CERTIFIED MAIL**  
7017 2620 0001 1359 3148

### **NOTICE OF APPLICABILITY**

#### **WAIVER OF REPORTS OF WASTE DISCHARGE AND WASTE DISCHARGE REQUIREMENTS FOR SPECIFIC TYPES OF DISCHARGE WITHIN THE CENTRAL VALLEY REGION, JEN CALIFORNIA 6, LLC, SOUTHWEST DIXON SPECIFIC PLAN, SOLANO COUNTY**

On 27 September 2019 a letter documenting the unpermitted groundwater dewatering at 7659 Pitt School Road was sent to JEN California 6, LLC as Taylor Builders (Discharger) by the Central Valley Water Boards WDRs and Title 27 Compliance and Enforcement Unit requiring the submission of a notice of intent (NOI) or report of waste discharge (RWD) to the Waste Discharge to Land Permitting Unit. On 1 October 2019 the Discharger submitted a Form 200, with supporting information submitted shortly thereafter, to obtain coverage under the *Waiver of Report of Waste Discharge and Waste Discharge Requirements for Specific Types of Discharge within the Central Valley Region*, Resolution R5-2018-0085 (Specific Low Threat Waiver). Based on the information submitted, the Southwest Dixon Specific Plan (Project) discharge to land qualifies for coverage under Category 7 for discharges of dewatering operations during construction. The discharge is hereby covered under the Waiver and assigned enrollee number R5-2018-0085-0031. Please include this number on all correspondence related to this discharge. A copy of the Waiver is enclosed and is also available at the [State Water Boards' Adopted Orders: Waivers webpage](https://www.waterboards.ca.gov/centralvalley/board_decisions/adopted_orders/waivers/r5-2018-0085.pdf) ([https://www.waterboards.ca.gov/centralvalley/board\\_decisions/adopted\\_orders/waivers/r5-2018-0085.pdf](https://www.waterboards.ca.gov/centralvalley/board_decisions/adopted_orders/waivers/r5-2018-0085.pdf)).

Coverage under the Specific Low Threat Waiver R5-2018-0085-0031 is valid until **30 November 2019**. Prior to this date, if dewatering activities are still ongoing, the Discharger shall contact the Central Valley Water Board and either cease the discharge or submit a new RWD to continue coverage under a renewed waiver or obtain site-specific waste discharge requirements.

### **PROJECT DESCRIPTION**

The Southwest Dixon Specific Plan is a project to construct multiple dwelling units and associated infrastructure (roads, utilities, sewers) southeast of the intersection of Interstate 80 and West A Street, Dixon, in Solano County. Location of the construction activities, generally at 7707 Pitt School Road, is shown on Attachment A. In mid-

August, in an area of sewer pipeline construction, the trenching construction crews discovered groundwater that was unusually shallow due to adjacent irrigation activities. On 15 August 2019 the encountered groundwater was pumped from the trench at a rate of about 600 gallons per minute over to an impoundment area to the west, as shown on Attachment B. The pump-out was completed on 30 September 2019, with an approximate total of 36 million gallons collected. The collected water is evaporating and is being used on the construction site for dust suppression. The construction area covers several acres of land, but the dewatering work was on one small parcel as shown on Attachment B. It is expected that the dewatering wastewater will be used or evaporated from the impoundment area before the end of November 2019.

### **FACILITY-SPECIFIC REQUIREMENTS**

1. Application of construction dewatering discharges at a location or in a manner different from that described in this Notice of Applicability (NOA) is prohibited.
2. The application shall not cause or threaten to cause conditions of contamination, nuisance, or pollution as defined in California Water Code section 13050.
3. Application of construction dewatering discharges or runoff from the application areas to adjacent lands, surface waters, or surface water drainage courses is prohibited.
4. Failure to abide by the conditions of the Low Threat Waiver R5-2018-0085, and this NOA could result in enforcement actions, as authorized by provisions of the California Water Code.
5. Coverage under the Specific Low Threat Waiver R5-2018-0085-0031 is valid until **30 November 2019**.

### **DOCUMENT SUBMITTALS**

All monitoring reports and other correspondence should be converted to searchable portable document format (PDF) and submitted electronically. Documents that are less than 50 MB should be emailed to: [centralvalleysacramento@waterboards.ca.gov](mailto:centralvalleysacramento@waterboards.ca.gov).

To ensure that your submittal is routed to the appropriate staff person, the following information should be included in the body of the email or any documentation submitted to the mailing address for this office:

**Program:** Non-15  
**Facility Name:** Southwest Dixon Specific Plan Project, Solano County  
**Place ID:** 852824  
**Order:** R5-2018-0085-0031

Documents that are 50 MB or larger should be transferred to a CD, DVD, or flash drive and mailed to:

Central Valley Regional Water Quality Control Board  
ECM Mailroom  
11020 Sun Center Drive, Suite 200  
Rancho Cordova, CA 95670

Now that the NOA has been issued, the Board's Compliance and Enforcement section will take over management of your case. Kenny Croyle is your point of contact for any questions about compliance with the Waiver. If you find it necessary to make a change to your permitted operations, Kenny will direct you to the appropriate permitting staff. You may contact Kenny at (916) 464-4676 or at [kenny.croyle@waterboards.ca.gov](mailto:kenny.croyle@waterboards.ca.gov).

*Original signed by Robert Busby for*

PATRICK PULUPA  
Executive Officer

Enc: Resolution No. R5-2018-0085

cc w/o enc: Solano County Environmental Health Department  
Kenny Croyle, CVRWQCB, Rancho Cordova

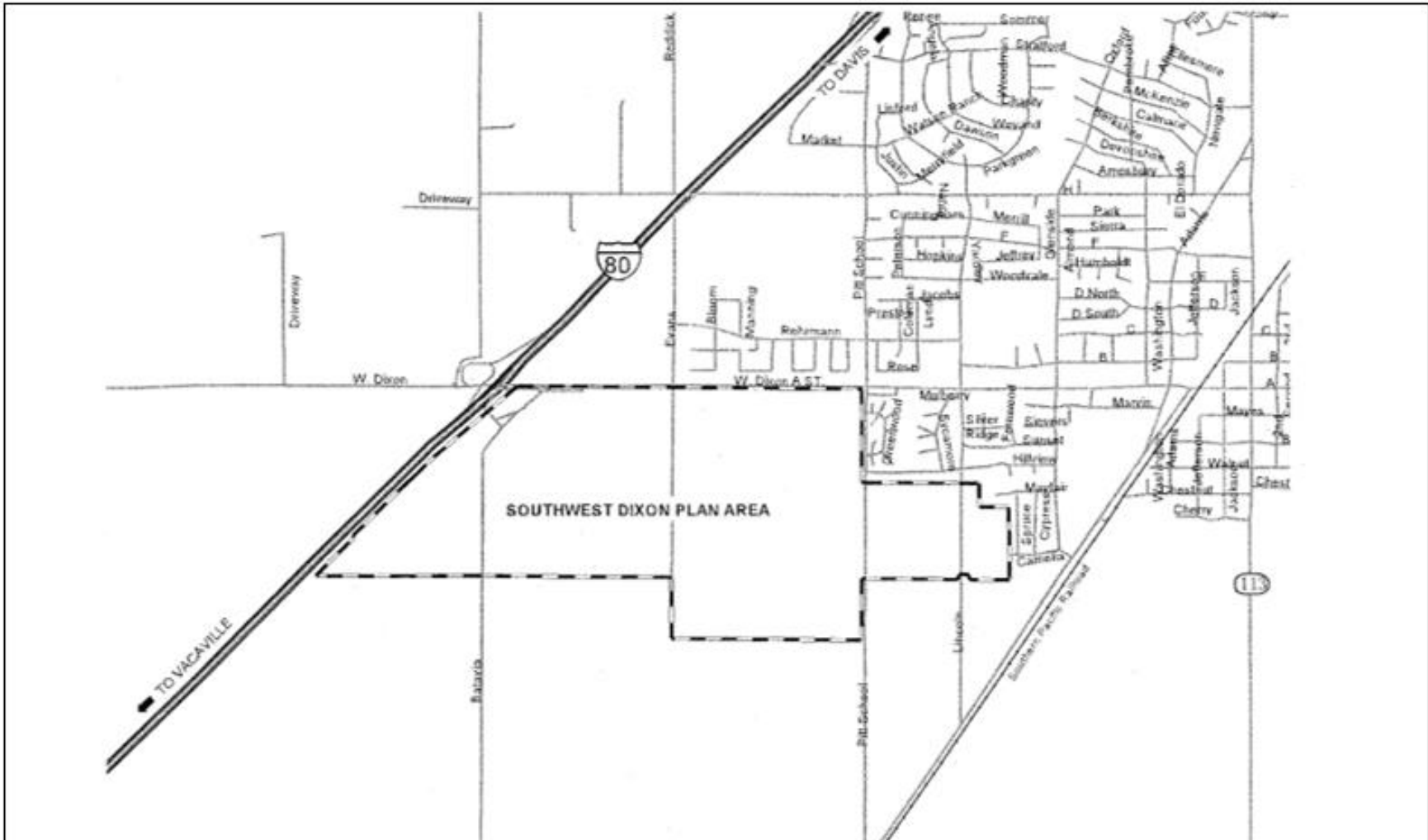

**Source:**  
Conceptual Land Use Plan  
From Taylor Builders – JEN California

Not to Scale

A compass rose with a central star-like design and four points labeled N, S, E, and W.

**SITE LOCATION MAP**  
Southwest Dixon Plan Area  
SOLANO COUNTY

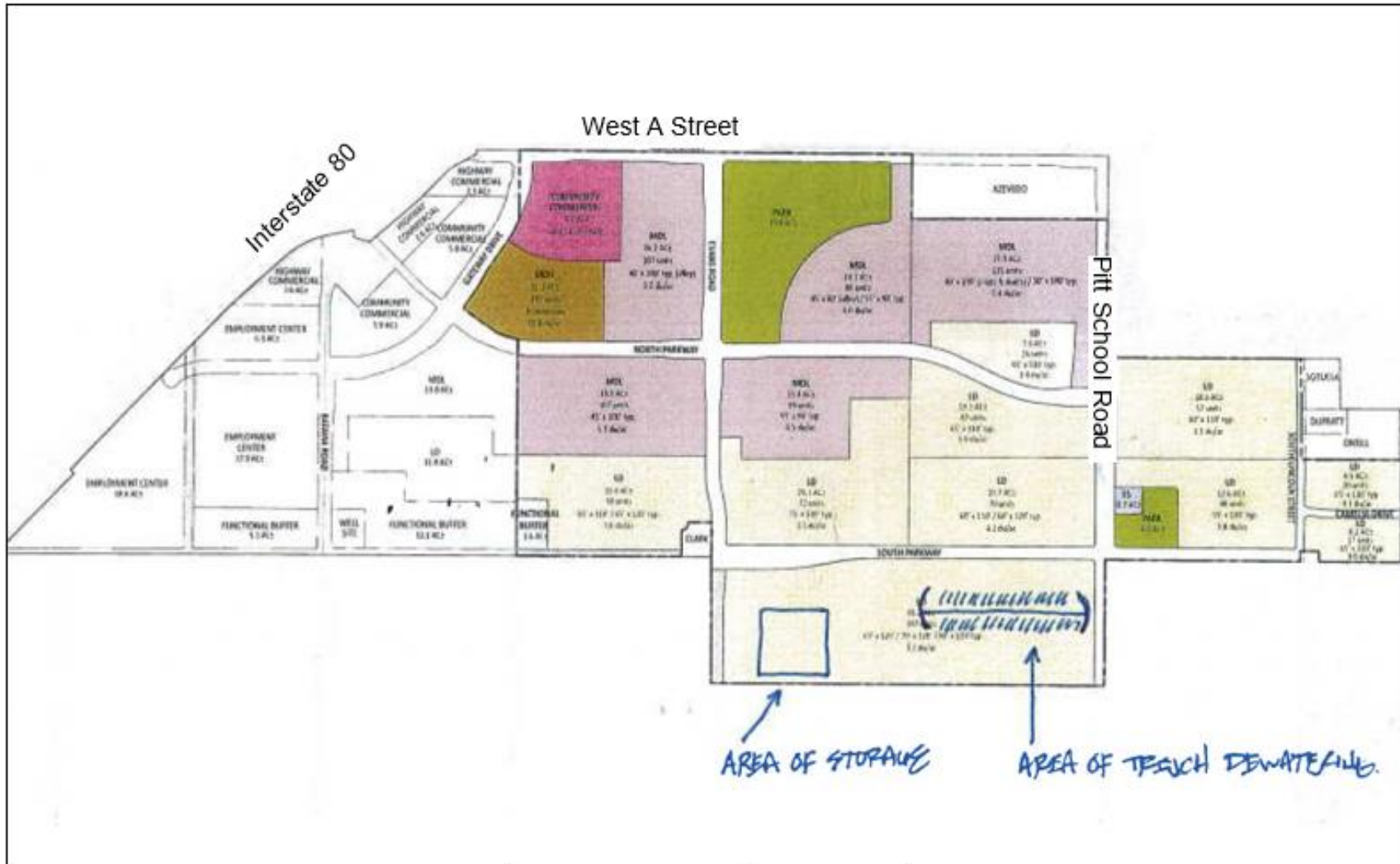

Source:  
Taylor Builders – JEN California

Not to Scale

A standard compass rose with a central star-like design, indicating the cardinal directions: North (N), South (S), East (E), and West (W).

**SITE PLAN**  
Dewatering on Southwest Dixon Plan Area  
SOLANO COUNTY