

FACT SHEET

Los Alamitos Race Course
4961 Katella Avenue, Cypress, California 90720
(January 2020)

This fact sheet has been prepared by Los Alamitos Race Course (LARC) located at 4961 Katella Avenue, Cypress, California (Site), to inform community members and other interested parties about the Cleanup and Abatement Order No. R8-2019-0037 (CAO). The CAO requires LARC to assess, clean up, and abate discharge of waste to waters of the State of California pursuant to California Water Code Sections 13267 and 13304. The fact sheet has been reviewed by Santa Ana Regional Water Quality Control Board (SARWQCB), a state agency that is part of the California Environmental Protection Agency (CalEPA).

Site Description

LARC is a 138-acre horse stabling, training, and racing facility and has been a part of the community since 1947. The site includes a racetrack, a grandstand, landscaped areas, horse stables, a maintenance area, and parking lots. The horse stables occupy approximately 32.3 acres of the Site and confines an estimated 1660 horses within 40 barns (Production Area). In 2016, the Site was enrolled in Order No. R8-2015-0002, NPDES No. CA0106348 Waste Discharge Requirements (Permit). The Permit prohibits direct or indirect discharge of process wastewater from the Production Area into waters of the United States except when rainfall events exceed the capacity of the

detention basin installed at the Site. The detention basin is designed to collect and detain the storm water runoff volume associated with a 25-year, 24-hour storm event. While the detention basin is in place and other improvements have been made as summarized below, prohibited process wastewater was observed entering the storm drain system during the March 6, 2019 storm event.

Site Investigation and Cleanup Activities

An extensive storm water conveyance and collection system designed to capture storm water runoff from the Production Area is maintained at the Site. In addition, a Storm Water Pollution Prevention Plan (SWPPP) is required by the Permit and has been prepared by the Site.

Since 2018, housekeeping and structural improvements have been made in response to SARWQCB inspections. Those improvements included repair and replacement of asphalt berms to prevent process water flowing from production area perimeter, catch basin inlet observations and cleaning before and during storm events, use of an automated sweeper on access roads, additional erosion control in the drainage channel, and enhanced employee training on Best Management Practice (BMP) implementation.



Figure 1. Site Location and Surrounding Activities

The CAO for LARC was adopted on October 25, 2019. On November 25, 2019, LARC submitted an Investigative Report identifying the cause, length of time, and amount of prohibited discharge from the March 6, 2019 event. Upset conditions were primarily caused by a clogged drain and a damaged pipe.

In addition, LARC submitted a proposed storm water conveyance system improvement plan (Work Plan) on October 14, 2019, supplemented by a revised schedule submitted to SARWQCB on December 3, 2019. The Investigative Report and the Work Plan were approved by SARWQCB on December 5, 2019.

Site Improvements

In accordance with the Work Plan and as shown on Figure 2 below, LARC completed the following improvements in December 2019:

- Installed a 6-inch asphalt berm along the access road at the Southern perimeter of the Site to provide additional containment capacity and direct storm water to the detention basin.

- Installed a new storm drain inlet and overflow pump to increase containment and pumping capacity to the detention basin.
- Resurfaced portions of the access road to promote surface flow to the new storm drain inlet.
- Installed geotextile fabric, rock, and gravel bags check dams in the drainage channel immediately upstream of the discharge location.
- Installed gravel bag check dams every 300 feet in channel to enhance sediment capture and reduce channel erosion.
- Installed straw wattles and gravel along the southern portion of the drainage channel.

For more Information, please contact:

Michelle Beckwith
Michelle.Beckwith@Waterboards.ca.gov

The adopted CAO can be found at the following link:
https://www.waterboards.ca.gov/santaana/board_decisions/adopted_orders/orders/2019/R8-2019-0037.pdf

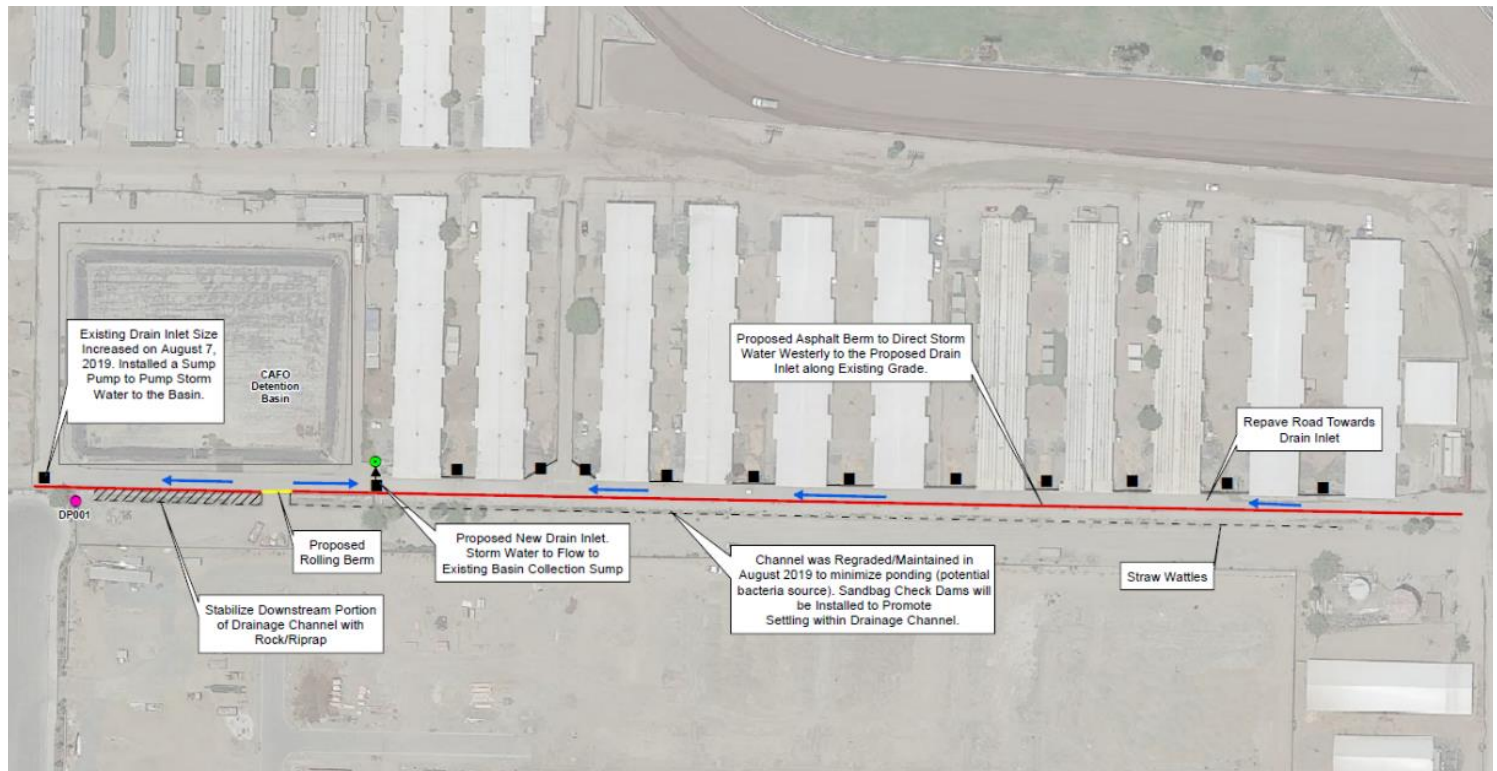

Figure 2. Site Improvements

Legend	
● Wastewater/Stormwater Collection Sump	 Existing CAFO Wastewater/Stormwater Drain Inlet and Berms
● LARC Discharge Point	→ Direction of Flow