



California Regional Water Quality Control Board

Colorado River Basin Region



Gray Davis
Governor

Winston H. Hickox
Secretary for
Environmental
Protection

Internet Address: <http://www.swrcb.ca.gov/~rwqcb7>
73-720 Fred Waring Drive, Suite 100, Palm Desert, California 92260
Phone (760) 346-7491 • FAX (760) 341-6820

7-58

June 25, 2002

204

Roger Henning, Chief Engineer
Palo Verde Irrigation District
180 West 14th Avenue
Blythe, CA 92225
Ph: (760) 922-3144
Fax: (760) 922-8294

SUBJECT: REQUEST FOR ADDITIONAL DATA ON THE PALO VERDE OUTFALL DRAIN

Dear Mr. Henning:

This letter is in regards to our phone conversation held on June 20, 2002. Our previous letter provided you with the Palo Verde Outfall Drain sampling results summary for 1993 and 1994. Imperial and Riverside Counties conducted these sampling activities. The map and data from our original letter are attached.

Per your request, attached are the following:

- Department of Health Services – Imperial County – Data for Palo Verde Outfall Drain; and
- Colorado River Basin Regional Water Quality Control Board – 2000 to 2001 data and map

In regard to your question on the difference between total coliform and fecal coliform bacteria, the following paragraph should provide clarification:

"The Basin Plan prescribes quantitative bacteria water quality objectives applicable to surface waters for public protection. The standards are specified in terms of Escheria Coli (E. Coli), enterococci, and fecal coliform bacteria. E. Coli is a particular genus and species of fecal coliform bacteria, which are subgroup of total coliform bacteria. Enterococci are a subgroup of the fecal streptococci. Total coliform bacteria are found in the feces of man and animal and in soil. Therefore, they may not necessarily be pathogenic. Fecal coliform bacteria are typically associated with the presence of fecal wastes from humans and other mammals, which can pose a significant threat to public health. They are also more representative of the sanitary quality of surface waters than total coliform organisms. Similarly, fecal streptococci are associated with human wastes".

The data collected by us indicates that the Palo Verde Outfall Drain is still in violation of pathogen water quality objectives identified in the 2002 Colorado River Basin Water Quality Control Plan.

If you have any further questions or requests regarding the data please contact the appropriate county. For any other concerns and comments regarding the 303 (d) listing, please contact Doug Wylie or Nadim Zeywar.

Sincerely,

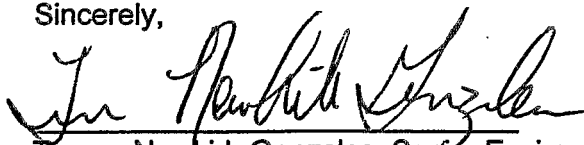

Teresa Newkirk Gonzales, Senior Environmental Specialist
TMDL Development Unit Chief

Cc: DOUG WYLIE, NPS/TMDL IMPLEMENTATION UNIT

File: 303 (D) LIST



SAMPLING REPORT:
CHARACTERIZATION OF BACTERIOLOGICAL
WATER QUALITY IMPACTS
FROM SEPTIC SYSTEMS
ON THE PALO VERDE LAGOON

California Regional Water Quality Control Board
Border Environment Cooperation Commission
United States Environmental Protection Agency

Prepared by

California Regional Water Quality Control Board
Colorado River Basin Region
FEBRUARY 28, 2002

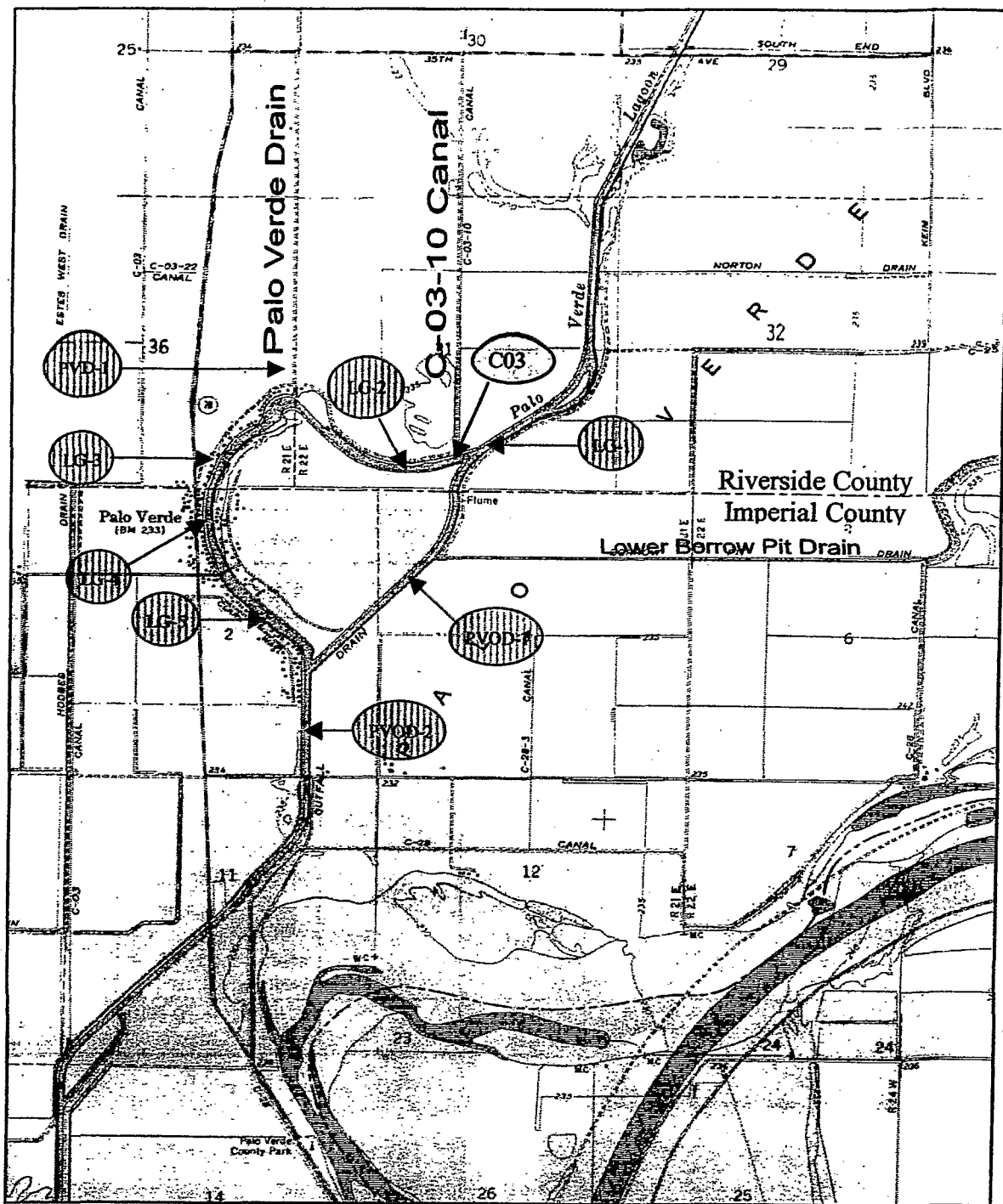

Figure No. 1
Sampling Stations
Palo Verde Lagoon
 Section 36, R21E, T8S; Section 31, R22E, T8S;
 and Sections 1 and 2, R21E, T9S, SBB&M
 Palo Verde USGS Quadrangle
 Scale 1" = 2000'

Fecal coliform

Station	Oct-00	Jan-01	Jun-01
LG1	333	190	193
CO3	200	240	22
LG2	200	207	130
PVD1	0	23	73
LG3	200	150	83
LG4	133	233	93
LG5	67	80	107
PVOD1	267	97	123
PVOD2	67	120	157

E. coli

Station	Oct-00	Jan-01	Jun-01
LG1	133	190	87
CO3	0	130	9
LG2	200	143	130
PVD1	0	17	45
LG3	200	83	51
LG4	67	83	60
LG5	0	67	73
PVOD1	67	97	77
PVOD2	67	110	90

Streptococci

Station	Oct-00	Jan-01	Jun-01
LG1	4133	3400	6000
CO3	300	3000	1700
LG2	4567	3433	8000
PVD1	833	213	833
LG3	2600	5667	4333
LG4	3100	2567	10833
LG5	4800	3100	2533
PVOD1	7800	3133	2367
PVOD2	3467	3200	2300

Enterococci

Station	Oct-00	Jan-01	Jun-01
LG1	4133	2733	6000
CO3	300	3000	1700
LG2	3667	3000	8000
PVD1	833	213	567
LG3	2600	5000	4333
LG4	2433	2567	10833
LG5	2900	2667	2367
PVOD1	7133	3133	2367
PVOD2	3467	2000	2300



PALO VERDE IRRIGATION DISTRICT

180 WEST 14TH AVENUE - BLYTHE, CALIFORNIA 92225

TELEPHONE (760) 922-3144 - FAX (760) 922-8294

May 28, 2002



Ms. Teresa Newkirk
73-720 Fred Waring Drive, Suite 100
Palm Desert, Ca. 92260

Re: Copy of Data for PVID's Outfall Drain

Dear Ms. Newkirk:

On February 28, 2001, the California Regional Water Quality Control Board (RWQCB) solicited the public for data and information on the water quality conditions in surface waters in the Region.

I am requesting a copy of all data you received that pertains to the Palo Verde Valley - PVID's canals and drains, and to that stretch of the Colorado River from 5 miles above to 50 miles below the Palo Verde Diversion Dam.

I am requesting a copy of the data from January 1, 1990 to the present that the RWQCB used to establish the proposed values that will be talked about during the July 16, 2002 scoping meeting on TMDL's for PVID's Outfall Drain. Comparable data for the Colorado River from 5 miles above to 50 miles below PVID's Diversion Dam would also be desired.

Thank you for your help and time.

Sincerely,

Roger Henning
Chief Engineer

REH:bmm

120,500 ACRES LOCATED ALONG THE COLORADO RIVER

RECEIVED

JUN 03 2002

REGION 7



California Regional Water Quality Control Board

Colorado River Basin Region



Winston H. Hickox
Secretary for
Environmental
Protection

Internet Address: <http://www.swrcb.ca.gov/~rwqcb7>
73-720 Fred Waring Drive, Suite 100, Palm Desert, California 92260
Phone (760) 346-7491 • FAX (760) 341-6820

Gray Davis
Governor

June 17, 2002

Roger Henning, Chief Engineer
Palo Verde Irrigation District
180 West 14th Avenue
Blythe, CA 92225
Ph: (760) 922-3144
Fax: (760) 922-8294

SUBJECT: YOUR REQUEST FOR DATA ON THE PVOD

Dear Mr. Henning:

Thank you for your letter dated May 28, 2002 regarding your request for data on the Palo Verde Outfall Drain (PVOD). Attached please find a copy of the data that was submitted to the Regional Board by Imperial and Riverside counties. This data show that the levels of bacteria in the Palo Verde Outfall Drain exceeded water quality objectives identified in the region's Basin Plan and was the basis for listing the PVOD for bacteria in the 1996 303 (d) List.

If you have any further questions or requests regarding the data please contact the appropriate county. For any other concerns and comments regarding the 303 (d) listing, please contact Doug Wylie or Nadim Zeywar.

Sincerely,

Teresa Newkirk Gonzales
TMDL Development Unit Chief

Cc: DOUG WYLIE, NPS/TMDL IMPLEMENTATION UNIT

File: 303 (D) LIST

California Environmental Protection Agency

**CALIFORNIA REGIONAL WATER QUALITY CONTROL BOARD
COLORADO RIVER BASIN • REGION 7**

73-720 FRED WARING DR., SUITE 100
PALM DESERT, CA 92260
Phone (619) 346-7491
FAX (619) 341-6820



JUL 13 1993

Thomas L. Wolf
Imperial County
Env. Quality Control
El Centro CA 92243

Subject: Coliform Testing of the Palo Verde Lagoon.

The following information is a result from the meeting we had at the Palo Verde Irrigation District on May 12, 1993 and subsequent discussions with the parties involved in that meeting. At the end of the said meeting a tentative sampling plan was developed. However, several items needed to be clarified prior the initiation of sampling. Such items included a statement of basis, a sampling and analysis protocol, and the effect which the drag line could have on the sampling and analysis.

Statement of Basis

Both total coliform and fecal coliform tests performed earlier in the year indicated that the Palo Verde Irrigation Drainage System was continually violating the Water Quality Control Plan, adopted by the California Regional Water Quality Control Board, Colorado River Basin Region on May 15, 1991. Since this violation has also been a potential health hazard, at this time, it is in the interest of the Regional Board staff and the local agencies to begin a coordinated effort which will take steps toward the identification of the problem(s) associated with this drainage system.

Tentative Role of involved Agencies

Tentatively, the Department of Environmental Health Services from both Imperial and Riverside Counties will sample the Palo Verde Lagoon and other drainage ways as shown in the attached map. The sampling will be done on a monthly basis. Regional Board staff will continue to evaluate the effect of sewage sludge applications to agricultural land, possible septic tank contributions, and other items (Ripley Wastewater Treatment Plant, septage dumping, etc.). The proposed investigation will occur for one year, sampling once per month.

Sampling Techniques

The method of sampling should be uniform; since all parties will be performing similar types of analysis. With regard to sampling a stream

or river, one reference¹ states:

"When samples are collected from a river or stream, the analytical values may vary with depth, stream flow, and distance from shore and from one shore to the other. If equipment is available, it is best to take an integrated sample from top to bottom in the middle of the stream in such a way that the sample is made composite according to the flow. If only a grab sample can be collected, it is best taken in the middle of the stream at mid-depth."

Therefore, it is suggested by the Regional Board staff that all samples be taken in the middle of the lagoon at approximately mid-depth. Please note that one (1) inch of air should be left at the top of each sample bottle¹.

Analysis

With regard to analysis protocol, it seems that the membrane filter technique is not an applicable test for the waters of the Palo Verde Lagoon. Another reference² states, "Turbidity caused by the presence of algae and other interfering material may not permit testing of a sample volume sufficient to yield significant results." For this reason, the method which should be used is the Multiple Tube Fermentation Technique for both total and fecal coliform.

The Effect of the Drag line

The drag line could have an effect on the total coliform counts. However, the Palo Verde Irrigation District has agreed to not use the drag line on the day the sampling would occur. In order to yield the best result, the sampling must occur on a Monday. Mondays are good because the system will have time to flush during the weekend.

It is the hope of Regional Board staff that the above mentioned items will make the proposed sampling protocol clearer and yield more comparable results. The Regional Board staff anticipates that the testing will begin in August and last

¹Sanitation and Radiation Laboratory, State Department of Public Health, (1971), Collection, Storage, Transportation and Pretreatment of Water and Wastewater Samples; pg 2.

²Standard Methods for the Examination of Water and Wastewater, 18th ed., American Public Health Association, 1993.

Page 3

for a year. Meanwhile, more work will be done by Regional Board staff to address the problem of the Palo Verde Lagoon. Should you have any further questions concerning this matter, please contact me at (619)776-8941.



TODD THOMPSON
WRC ENGINEER

TT/jj

File: Working File: Palo Verde Lagoon

IMPERIAL COUNTY HEALTH DEPARTMENT
Division of Environmental Health Services
COURTHOUSE * 939 W Main Street
El Centro, CA 92243

PHONE:
339-4203

July 30, 1993

MEMORANDUM

TO: Yvonne Smith, Director, Health Department

FROM:  Thomas L. Wolf, Director, EHS

SUBJECT: Special Project (Proposed) - One Year Sampling of Palo Verde Lagoon and Agricultural Drain

As you are aware, the EHS Division has been involved in determining the extent of sources for pollution of the Colorado River from the Palo Verde Lagoon, as well as identifying reasons for existence of coliform bacteria in the drainage that discharges to the Colorado River. The purpose is to identify sources, and if correctable, provide the incentive for correction.

To date, the study (see also staff reports recently provided) has involved the Regional Water Quality Control Board and Riverside Environmental Health, and the support of the Imperial County Sheriff's Office and California Fish & Game. Information evaluated by Riverside EHS, Imperial EHS, and RWQCB indicates that a one-year sampling program be coordinated between the three agencies. The sampling will be done monthly for one (1) year, and the results will be examined by the staffs of the three agencies to determine conclusions and recommendations regarding additional regulatory work.

The responsibility and expense for sampling in each county will be respectively Riverside and Imperial County's. Coordination of sampling between each county is necessary to assure uniformity of sampling and analysis so that the results will be meaningful to the final comparison. Imperial County's expense is estimated at around \$3,500.00. This is mainly in salary and lab costs to do 72 samples in Imperial County.

EHS staff has contacted Bob Freeman to discuss the analysis method and feasibility from the lab's perspective. Bob is supportive, and indicates that his lab can assist us with the analyses.

Logistically, there may be a need for overtime due to the time it takes to sample the Lagoon using the methods suggested and agreed upon. The lab may need to accommodate late arrival of the samples, as well as the incubation time of the test method.

We will also have to request assistance from other State or County agencies that have a boat available.

The shallow depth of the Lagoon will be a consideration in the type of boat, as will availability of both the boat and a person to operate it. As stated initially, so far we have had very good cooperation from supportive agencies in getting a boat and operator for previous samplings.

Attached is Paul Nichol's proposal, as well as a memo from RWQCB staff on their recommendations. Unless something changes, Paul would begin September 13. I am requesting your review and approval of the project and expense. We await your reply.

07/93 ldc

IMPERIAL COUNTY HEALTH DEPARTMENT
Division of Environmental Health Services
COURTHOUSE * 939 W Main Street
El Centro, CA 92243

PHONE:
339-4203

July 30, 1993

MEMORANDUM

TO: Palo Verde Raw Surface Water File
FROM: ^{PV}₂ Paul Nichols, REHS II, EHS
SUBJECT: Protocol for water sampling of the Palo Verde Lagoon

The following proposal is for establishing a coordinated water sampling program of the Palo Verde Lagoon and portions of the Outfall Drain for the testing of coliforms. The parties involved will be Riverside EHS, Regional Water Quality Control Board, this Department, and possibly California Fish and Game and Palo Verde Irrigation District.

Sampling Dates

It is proposed that the sampling activities be conducted once a month over a 1 year period commencing on September 13, 1993. The sampling dates would be as follows:

1. September 13, 1993
2. October 4, 1993
3. November 1, 1993
4. December 6, 1993
5. January 3, 1994
6. February 7, 1994
7. March 7, 1994
8. April 4, 1994
9. May 2, 1994
10. June 6, 1994
11. July 11, 1994
12. August 1, 1994

Sampling Sites

There will be a total of 13 sampling sites as depicted on the attached map. Riverside EHS will obtain 7 samples from the portions of the waterway that is within their County and Imperial County will obtain 6 samples from the portions of the waterway that is within their County. Water samples will be obtained from the center of the stream at mid water depth by using a boat(s) tentatively provided by Palo Verde Irrigation District or California Fish and Game. Roger Henning of PVID believes the waterway, including the Lagoon, will be navigable during the months of lowest flow which is January and February. All samples

would be obtained in the morning hours thereby allowing for delivery to the laboratories in the afternoon. 2 samples from each site or station will be obtained and all samples will be transported to the laboratory under refrigeration such as thermo-insulated coolers. In the event that boat(s) can't be procured or provided then samples will be obtained from the banks of the waterway but all samples during the 1 year time frame will be obtained from either the banks of the center of the stream and will not be intermingled.

Analysis

All samples will be analyzed for total coliforms present and fecal coliforms present by using multiple tube fermentation technique. Riverside County will analyze samples obtained within their own county; Imperial County will analyze samples obtained within their own Country. Copies of the results will be provided to the Regional Board as well as to the perspective other county EHS.

Unforeseen Conditions

In the event of rain or other conditions the sampling date(s) will be changed so as to insure that both Counties obtain the samples on the same date. Hopefully this will not occur but all parties must be able to be flexible in accommodating a change in a sampling date and associated analysis.

PVID Participation

PVID has agreed to cease the dredging activities the Friday before the proposed sampling dates. This will allow for the waterway to flush for two days. Additionally, as earlier said PVID may be able to supply boat(s) to both counties for obtaining samples.

Conclusion of Sampling Activities in August 1994

Upon the conclusion of the sampling program all Agencies involved will meet to review the data and to coordinate any further actions if necessary.

COUNTY OF IMPERIAL

COURTHOUSE
939 W. MAIN ST.
EL CENTRO, CA 92243



TELEPHONE:
(619) 339-4203
(619) 339-4204
(619) 339-4205
FAX:
(619) 352-1309

DEPARTMENT OF HEALTH SERVICES DIVISION OF ENVIRONMENTAL HEALTH

November 10, 1993

Todd Thompson
California Regional Water Quality Control Board
73-720 Fred Waring Drive, Suite 100
Palm Desert, CA 92260

Dear Mr. Thompson:

Enclosed are the copies of the water analysis done on 11/1/93 for the Palo Verde lagoon and the Palo Verde Drain within Imperial County. Samples were obtained from the levee banks by using a pole that holds the sampling bottle. All samples were obtained from free flowing sections of the respective waterway sampling points. Samples were analyzed for total coliforms present and fecal coliforms present by using multiple tube fermentation technique.

Refer to attached map depicting the sampling locations as agreed to during our meeting of 5/12/93 at PVID in Blythe. The next scheduled sampling date is 12/6/93; please advise me if this date is not suitable for you.

Sincerely,

Yvonne Smith, MPA, Director
Imperial County Health Department

By: Paul Nichols, REHS II
Division of Environmental Health Services

PN/ldc

COUNTY OF IMPERIAL

COURTHOUSE
939 W. MAIN ST.
EL CENTRO, CA 92243



TELEPHONE:
(619) 339-4203
(619) 339-4204
(619) 339-4205

FAX:
(619) 352-1309

DEPARTMENT OF HEALTH SERVICES DIVISION OF ENVIRONMENTAL HEALTH

November 10, 1993

Don Park
Riverside County Department of EHS
79733 Country Club Drive, Suite D
Bermuda Dunes, CA 92201

Dear Mr. Park:

Enclosed are the copies of the water analysis done on 11/1/93 for the Palo Verde lagoon and the Palo Verde Drain within Imperial County. Samples were obtained from the levee banks by using a pole that holds the sampling bottle. All samples were obtained from free flowing sections of the respective waterway sampling points. Samples were analyzed for total coliforms present and fecal coliforms present by using multiple tube fermentation technique.

Refer to attached map depicting the sampling locations as agreed to during our meeting of 5/12/93 at PVID in Blythe. The next scheduled sampling date is 12/6/93; please advise me if this date is not suitable for you.

Sincerely,

Yvonne Smith, MPA, Director
Imperial County Health Department

Paul F. Nichols

By: Paul Nichols, REHS II
Division of Environmental Health Services

PN/lde

COUNTY OF IMPERIAL

COURTHOUSE
939 W. MAIN ST.
EL CENTRO, CA 92243



TELEPHONE:
(619) 339-4203
(619) 339-4204
(619) 339-4205
FAX:
(619) 352-1309

DEPARTMENT OF HEALTH SERVICES DIVISION OF ENVIRONMENTAL HEALTH

November 10, 1993

Roger Henning
Palo Verde Irrigation District
180 W 14th Avenue
Blythe, CA 92225

Dear Mr. Henning:

Enclosed are the copies of the water analysis done on 11/1/93 for the Palo Verde lagoon and the Palo Verde Drain within Imperial County. Samples were obtained from the levee banks by using a pole that holds the sampling bottle. All samples were obtained from free flowing sections of the respective waterway sampling points. Samples were analyzed for total coliforms present and fecal coliforms present by using multiple tube fermentation technique.

Refer to attached map depicting the sampling locations as agreed to during our meeting of 5/12/93 at PVID in Blythe. The next scheduled sampling date is 12/6/93; please advise me if this date is not suitable for you.

Sincerely,

Yvonne Smith, MPA, Director
Imperial County Health Department

Paul F. Nichols
By: Paul Nichols, REHS II
Division of Environmental Health Services

PN/ldc

Bacteriological Analysis of Water LAB # 7,317

Tested at Imperial County Laboratory

Date Received 11/01/1993 Analyst: Bob/S

Sampled from CLIENT # 3	SAMPLED BY Nichols
Environmental Health	DATE / TIME 11/01/1993 / 11:10
939 Main Street	TYPE OF SAMPLE: Raw Surface Water
El Centro CA 92243	CHLORINE RESIDUE 0 ppm
ATTENTION:	SAMPLE SITE: PaloVerdeDrain#11

11/05/1993 | MPN= 2,400.0 MPN/100ml water [10 Pos/ 5 Neg] + Coliforms PRESENT
| Fecal Coli = 2400

Environmental Health	
939 Main Street	
El Centro CA 92243	
ATTENTION:	

(c) BtB Software, 1992 Imperial County Laboratory 935 Broadway El Centro California 92243 ELAP # 1773
Print Date 11-05-1993/ 9:52 am Director: Bob Freeman PHONE: (619) 339-4437 MediCare # 55-L0008850 CLIA # 05D0670166

Bacteriological Analysis of Water LAB # 7,318

Tested at Imperial County Laboratory

Date Received 11/01/1993 Analyst: Bob/S

Sampled from CLIENT # 3	SAMPLED BY Nichols
Environmental Health	DATE / TIME 11/01/1993 / 12:35
939 Main Street	TYPE OF SAMPLE: Raw Surface Water
El Centro CA 92243	CHLORINE RESIDUE 0 ppm
ATTENTION:	SAMPLE SITE: PaloVerdeDrain #12

11/05/1993 | MPN= 3,000.0 MPN/100ml water [11 Pos/ 4 Neg] + Coliforms PRESENT
| Fecal Coli = 2400

Environmental Health	
939 Main Street	
El Centro CA 92243	
ATTENTION:	

(c) BtB Software, 1992 Imperial County Laboratory 935 Broadway El Centro California 92243 ELAP # 1773
Print Date 11-05-1993/ 9:52 am Director: Bob Freeman PHONE: (619) 339-4437 MediCare # 55-L0008850 CLIA # 05D0670166

Bacteriological Analysis of Water LAB # 7,315
 Tested at Imperial County Laboratory
 Date Received 11/01/1993 Analyst: *Bob/S*
 Sampled from CLIENT # 3
 Environmental Health
 939 Main Street
 El Centro CA 92243
 ATTENTION :
 11/05/1993 | MPN= 2,400.0 MPN/100ml water [10 Pos/ 5 Neg] + Coliforms PRESENT
 | Fecal Coli = 1600

Environmental Health 939 Main Street El Centro CA 92243 ATTENTION:
--

(c) BtB Software, 1992 Imperial County Laboratory 935 Broadway El Centro California 92243 ELAP # 1773
 Print Date 11-05-1993/ 9:52 am Director: Bob Freeman PHONE: (619) 339-4437 MediCare # 55-L0008850 CLIA # 05D0670166

Bacteriological Analysis of Water LAB # 7,316
 Tested at Imperial County Laboratory
 Date Received 11/01/1993 Analyst: *Bob/S*
 Sampled from CLIENT # 3
 Environmental Health
 939 Main Street
 El Centro CA 92243
 ATTENTION :
 11/05/1993 | MPN= 2,400.0 MPN/100ml water [10 Pos/ 5 Neg] + Coliforms PRESENT
 | Fecal Coli = 2400

Environmental Health 939 Main Street El Centro CA 92243 ATTENTION:
--

(c) BtB Software, 1992 Imperial County Laboratory 935 Broadway El Centro California 92243 ELAP # 1773
 Print Date 11-05-1993/ 9:52 am Director: Bob Freeman PHONE: (619) 339-4437 MediCare # 55-L0008850 CLIA # 05D0670166

Bacteriological Analysis of Water		LAB # 7 313
Tested at Imperial County Laboratory		
Date Received 11/01/1993		Analyst: Bob/S
Sampled from CLIENT # 3		
Environmental Health	SAMPLED BY Nichols	
939 Main Street	DATE / TIME 11/01/1993 / 10:30	
El Centro CA	TYPE OF SAMPLE : Raw Surface Water	
92243	CHLORINE RESIDUE 0 ppm	
ATTENTION :	SAMPLE SITE : PaloVerdeLagoon#7	
11/05/1993	MPN= 2,400.0 MPN/100ml water [10 Pos/ 5 Neg] + Coliforms PRESENT	
Fecal Coli = 1600		
<div> <div>Environmental Health</div> <div>939 Main Street</div> <div>El Centro CA</div> <div>92243</div> </div>		
ATTENTION:		

(c) BtB Software, 1992 Imperial County Laboratory 935 Broadway El Centro California 92243 ELAP # 1773
 Print Date 11-05-1993/ 9:52 am Director: Bob Freeman PHONE: (619) 339-4437 MediCare # 55-L0006850 CLIA # 0500670166

Bacteriological Analysis of Water		LAB # 7 314
Tested at Imperial County Laboratory		
Date Received 11/01/1993		Analyst: Bob/S
Sampled from CLIENT # 3		
Environmental Health	SAMPLED BY Nichols	
939 Main Street	DATE / TIME 11/01/1993 / 10:50	
El Centro CA	TYPE OF SAMPLE : Raw Surface Water	
92243	CHLORINE RESIDUE 0 ppm	
ATTENTION :	SAMPLE SITE : PaloVerdeLagoon#8	
11/05/1993	MPN= 2,400.0 MPN/100ml water [10 Pos/ 5 Neg] + Coliforms PRESENT	
Fecal Coli = 2400		
<div> <div>Environmental Health</div> <div>939 Main Street</div> <div>El Centro CA</div> <div>92243</div> </div>		
ATTENTION:		

(c) BtB Software, 1992 Imperial County Laboratory 935 Broadway El Centro California 92243 ELAP # 1773
 Print Date 11-05-1993/ 9:52 am Director: Bob Freeman PHONE: (619) 339-4437 MediCare # 55-L0006850 CLIA # 0500670166

12 S

11 S

RIVERSIDE
IMPERIAL

13 S

14 S

T. 9 S.
T. 10 S.

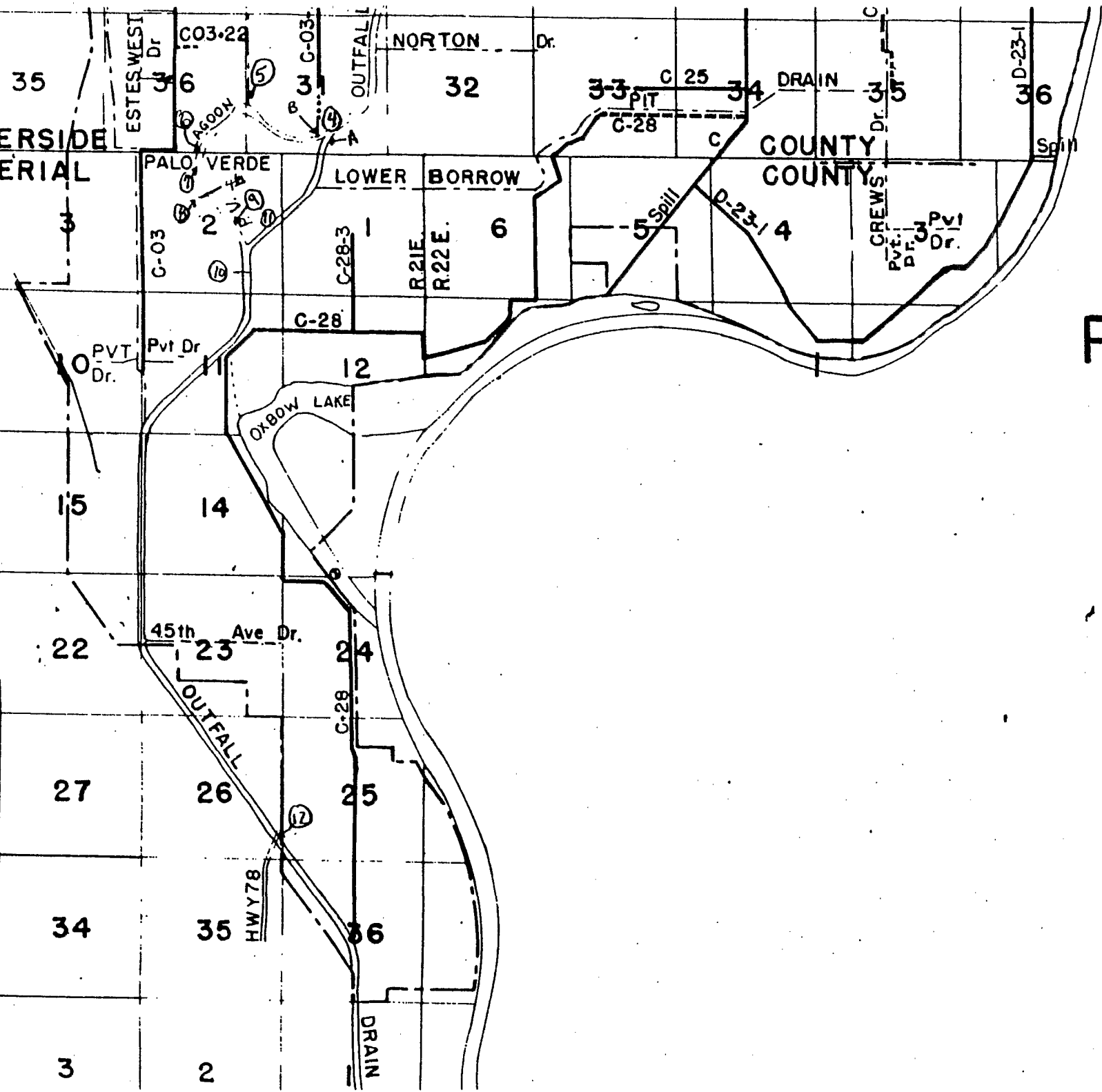

PALC

RI
SA

COUNTY OF IMPERIAL

COURTHOUSE
939 W. MAIN ST.
EL CENTRO, CA 92243



TELEPHONE:
(619) 339-4203
(619) 339-4204
(619) 339-4205
FAX:
(619) 352-1309

DEPARTMENT OF HEALTH SERVICES DIVISION OF ENVIRONMENTAL HEALTH

December 21, 1993

Todd Thompson
California Regional Water Quality Control Board
73-720 Fred Waring Drive, Suite 100
Palm Desert, CA 92260

Dear Mr. Thompson:

Enclosed are the copies of the water analysis done on 12/06/93 for the Palo Verde Lagoon and the Palo Verde Drain within Imperial County. Samples were obtained from the levee banks by using a pole that holds the sampling bottle. All samples were obtained from free flowing sections of the respective waterway sampling points. Samples were analyzed for total coliforms present and fecal coliforms present by using multiple tube fermentation technique. Imperial County lab personnel are using the 5 tube method; the dilutions are 1:1, 1:10, 1:1/10, 1:100, and 1:1000.

Refer to attached map depicting the sampling locations as agreed to during our meeting of 5/12/93 at PVID in Blythe. The next scheduled sampling date is 1/3/94; please advise me if this date is not suitable for you.

Sincerely,

Yvonne Smith, MPA, Director
Imperial County Health Department

Paul F. Nichols

By: Paul Nichols, REHS II
Division of Environmental Health Services

PN/lhc

COUNTY OF IMPERIAL

COURTHOUSE
939 W. MAIN ST.
EL CENTRO, CA 92243



TELEPHONE:
(619) 339-4203
(619) 339-4204
(619) 339-4205

FAX:
(619) 352-1309

DEPARTMENT OF HEALTH SERVICES DIVISION OF ENVIRONMENTAL HEALTH

December 21, 1993

Roger Henning
Palo Verde Irrigation District
180 W 14th Avenue
Blythe, CA 92225

Dear Mr. Henning :

Enclosed are the copies of the water analysis done on 12/06/93 for the Palo Verde Lagoon and the Palo Verde Drain within Imperial County. Samples were obtained from the levee banks by using a pole that holds the sampling bottle. All samples were obtained from free flowing sections of the respective waterway sampling points. Samples were analyzed for total coliforms present and fecal coliforms present by using multiple tube fermentation technique. Imperial County lab personnel are using the 5 tube method; the dilutions are 1:1, 1:10, 1:1/10, 1:100, and 1:1000.

Refer to attached map depicting the sampling locations as agreed to during our meeting of 5/12/93 at PVID in Blythe. The next scheduled sampling date is 1/3/94; please advise me if this date is not suitable for you.

Sincerely,

Yvonne Smith, MPA, Director
Imperial County Health Department

Paul F. Nichols

By: Paul Nichols, REHS II
Division of Environmental Health Services

PN/lcd

COUNTY OF IMPERIAL

COURTHOUSE
939 W. MAIN ST.
EL CENTRO, CA 92243



TELEPHONE:
(619) 339-4203
(619) 339-4204
(619) 339-4205
FAX:
(619) 352-1309

DEPARTMENT OF HEALTH SERVICES DIVISION OF ENVIRONMENTAL HEALTH

December 21, 1993

Don Park
Riverside County Department EHS
79733 Country Club Drive, Suite D
Bermuda Dunes, CA 92201

Dear Mr. Park :

Enclosed are the copies of the water analysis done on 12/06/93 for the Palo Verde Lagoon and the Palo Verde Drain within Imperial County. Samples were obtained from the levee banks by using a pole that holds the sampling bottle. All samples were obtained from free flowing sections of the respective waterway sampling points. Samples were analyzed for total coliforms present and fecal coliforms present by using multiple tube fermentation technique. Imperial County lab personnel are using the 5 tube method; the dilutions are 1:1, 1:10, 1:1/10, 1:100, and 1:1000.

Refer to attached map depicting the sampling locations as agreed to during our meeting of 5/12/93 at PVID in Blythe. The next scheduled sampling date is 1/3/94; please advise me if this date is not suitable for you.

Sincerely,

Yvonne Smith, MPA, Director
Imperial County Health Department

Paul F. Nichols

By: Paul Nichols, REHS II
Division of Environmental Health Services

PN/lcd

Print Date 12-13-1993/ 10:19 am Director: Bob Freeman PHONE: (619) 339-4437 MediCare # 55-L0008800 CLIA # 0500070100

Bacteriological Analysis of Water LAB # 7,361

Tested at Imperial County Laboratory

Date Received 12/06/1993

Analyst: Bob / S

Sampled from CLIENT # 3

Environmental Health

939 Main Street

El Centro CA

92243

SAMPLED BY Nichols

DATE / TIME 12/06/1993 / 12:15

TYPE OF SAMPLE: Raw Surface Water

CHLORINE RESIDUE N/A ppm

SAMPLE SITE: PaloVerde Drain#11

ATTENTION :

12/09/1993 | MPN= 2,400.0 MPN/100ml water [10 Pos/ 5 Neg] + Coliforms PRESENT
| Fecal Coli = 1600 | Paul Notified 12/09/93 |

Environmental Health

939 Main Street

El Centro

CA

92243

ATTENTION:

(c) BtB Software, 1992 Imperial County Laboratory 935 Broadway El Centro California 92243 ELAP # 1773

Print Date 12-13-1993/ 10:19 am Director: Bob Freeman PHONE: (619) 339-4437 MediCare # 55-L0008800 CLIA # 0500070100

Bacteriological Analysis of Water LAB # 7,362

Tested at Imperial County Laboratory

Date Received 12/06/1993

Analyst: Bob / S

Sampled from CLIENT # 3

Environmental Health

939 Main Street

El Centro CA

92243

SAMPLED BY Nichols

DATE / TIME 12/06/1993 / 10:10

TYPE OF SAMPLE: Raw Surface Water

CHLORINE RESIDUE N/A ppm

SAMPLE SITE: PaloVerde Drain #12

ATTENTION :

12/09/1993 | MPN= 2,400.0 MPN/100ml water [10 Pos/ 5 Neg] + Coliforms PRESENT
| Fecal Coli = 2400 |

Environmental Health

939 Main Street

El Centro

CA

92243

ATTENTION:

(c) BtB Software, 1992 Imperial County Laboratory 935 Broadway El Centro California 92243 ELAP # 1773

Print Date 12-13-1993/ 10:19 am Director: Bob Freeman PHONE: (619) 339-4437 MediCare # 55-L0008850 CLIA # 0500670100

Bacteriological Analysis of Water LAB # **7,359**

Tested at Imperial County Laboratory

Date Received 12/06/1993

Analyst: *Bob/S*

Sampled from CLIENT # 3
Environmental Health
939 Main Street
El Centro CA
92243

SAMPLED BY Nichols
DATE / TIME 12/06/1993 / 12:25
TYPE OF SAMPLE: Raw Surface Water
CHLORINE RESIDUE N/A ppm
SAMPLE SITE: PaloVerde Lagoon #9

ATTENTION :

12/09/1993 | MPN= 2,400.0 MPN/100ml water [10 Pos/ 5 Neg] + Coliforms PRESENT
| Fecal Coli = 1600

Environmental Health
939 Main Street
El Centro CA
92243
ATTENTION:

(c) BtB Software, 1992 Imperial County Laboratory 935 Broadway El Centro California 92243 ELAP # 1773

Print Date 12-13-1993/ 10:19 am Director: Bob Freeman PHONE: (619) 339-4437 MediCare # 55-L0008850 CLIA # 0500670100

Bacteriological Analysis of Water LAB # **7,360**

Tested at Imperial County Laboratory

Date Received 12/06/1993

Analyst: *Bob/S*

Sampled from CLIENT # 3
Environmental Health
939 Main Street
El Centro CA
92243

SAMPLED BY Nichols
DATE / TIME 12/06/1993 / 10:35
TYPE OF SAMPLE: Raw Surface Water
CHLORINE RESIDUE N/A ppm
SAMPLE SITE: PaloVerde Drain #10

ATTENTION :

12/09/1993 | MPN= 2,400.0 MPN/100ml water [10 Pos/ 5 Neg] + Coliforms PRESENT
| Fecal Coli = 1600 Paul Notified 12/09/93

Environmental Health
939 Main Street
El Centro CA
92243
ATTENTION:

(c) BtB Software, 1992 Imperial County Laboratory 935 Broadway El Centro California 92243 ELAP # 1773

Print Date 12-13-1993/ 10:19 am Director: Bob Freeman PHONE: (619) 339-4437 MediCare # 55-L0008800 CLIA # 05000570100

Bacteriological Analysis of Water

LAB # 7,357

Tested at Imperial County Laboratory

Date Received 12/06/1993

Analyst: *Bob/S*

Sampled from CLIENT # 3

Environmental Health

939 Main Street

El Centro CA

92243

SAMPLED BY Nichols

DATE / TIME 12/06/1993 / 11:45

TYPE OF SAMPLE: Raw Surface Water

CHLORINE RESIDUE N/A ppm

SAMPLE SITE: PaloVerdeLagoon #7

ATTENTION :

12/09/1993 | MPN= 1,600.0 MPN/100ml water [14 Pos/ 1 Neg] + Coliforms PRESENT
| Fecal Coli =900

Environmental Health

939 Main Street

El Centro

CA

92243

ATTENTION:

(c) BtB Software, 1992 Imperial County Laboratory 935 Broadway El Centro California 92243 ELAP # 1773

Print Date 12-13-1993/ 10:19 am Director: Bob Freeman PHONE: (619) 339-4437 MediCare # 55-L0008800 CLIA # 05000570100

Bacteriological Analysis of Water

LAB # 7,358

Tested at Imperial County Laboratory

Date Received 12/06/1993

Analyst: *Bob/S*

Sampled from CLIENT # 3

Environmental Health

939 Main Street

El Centro CA

92243

SAMPLED BY Nichols

DATE / TIME 12/06/1993 / 12:00

TYPE OF SAMPLE: Raw Surface Water

CHLORINE RESIDUE N/A ppm

SAMPLE SITE: PaloVerde Lagoon #8

ATTENTION :

12/09/1993 | MPN= 2,400.0 MPN/100ml water [10 Pos/ 5 Neg] + Coliforms PRESENT
| Fecal Coli =1600

Environmental Health

939 Main Street

El Centro

CA

92243

ATTENTION:

(c) BtB Software, 1992 Imperial County Laboratory 935 Broadway El Centro California 92243 ELAP # 1773

COUNTY OF IMPERIAL

COURTHOUSE
939 W. MAIN ST.
EL CENTRO, CA 92243



TELEPHONE:
(619) 339-4203
(619) 339-4204
(619) 339-4205
FAX:
(619) 352-1309

DEPARTMENT OF HEALTH SERVICES DIVISION OF ENVIRONMENTAL HEALTH

January 13, 1994

Don Park
Riverside County Department EHS
79733 Country Club Drive, Suite D
Bermuda Dunes, CA 92201

Dear Mr. Park:

Enclosed are the copies of the water analysis done on 01/03/94 for the Palo Verde Lagoon and the Palo Verde Drain within Imperial County. Samples were obtained from the levee banks by using a pole that holds the sampling bottle. All samples were obtained from free flowing sections of the respective waterway sampling points. Samples were analyzed for total coliforms present and fecal coliforms present by using multiple tube fermentation technique. Imperial County lab personnel are using the 5 tube method; the dilutions are 1:1, 1:10, 1:1/10, 1:100, and 1:1000.

Refer to attached map depicting the sampling locations as agreed to during our meeting of 5/12/93 at PVID in Blythe. The next scheduled sampling date is 2/7/94; please advise me if this date is not suitable for you. Riverside and Imperial County are planning to perform a "split sample" as part of the 2/7/94 sampling; the sample location will be site number 7 within Imperial County.

Sincerely,

Yvonne Smith, MPA, Director
Imperial County Health Department

Paul F. Nichols

By: Paul Nichols, REHS II
Division of Environmental Health Services

CC: Bob Freeman, Lab Director, Imp. Co. Public Health Laboratory

COUNTY OF IMPERIAL

COURTHOUSE
939 W. MAIN ST.
EL CENTRO, CA 92243



TELEPHONE:
(619) 339-4203
(619) 339-4204
(619) 339-4205
FAX:
(619) 352-1309

DEPARTMENT OF HEALTH SERVICES DIVISION OF ENVIRONMENTAL HEALTH

January 13, 1994

Roger Henning
Palo Verde Irrigation District
180 W 14th Avenue
Blythe, CA 92225

Dear Mr. Henning:

Enclosed are the copies of the water analysis done on 01/03/94 for the Palo Verde Lagoon and the Palo Verde Drain within Imperial County. Samples were obtained from the levee banks by using a pole that holds the sampling bottle. All samples were obtained from free flowing sections of the respective waterway sampling points. Samples were analyzed for total coliforms present and fecal coliforms present by using multiple tube fermentation technique. Imperial County lab personnel are using the 5 tube method; the dilutions are 1:1, 1:10, 1:1/10, 1:100, and 1:1000.

Refer to attached map depicting the sampling locations as agreed to during our meeting of 5/12/93 at PVID in Blythe. The next scheduled sampling date is 2/7/94; please advise me if this date is not suitable for you. Riverside and Imperial County are planning to perform a "split sample" as part of the 2/7/94 sampling; the sample location will be site number 7 within Imperial County.

Sincerely,

Yvonne Smith, MPA, Director
Imperial County Health Department

Paul F. Nichols

By: Paul Nichols, REHS II
Division of Environmental Health Services

cc: Bob Freeman, Lab Director, Imp. Co. Public Health Laboratory

COUNTY OF IMPERIAL

COURTHOUSE
939 W. MAIN ST.
EL CENTRO, CA 92243



TELEPHONE:
(619) 339-4203
(619) 339-4204
(619) 339-4205
FAX:
(619) 352-1309

DEPARTMENT OF HEALTH SERVICES DIVISION OF ENVIRONMENTAL HEALTH

January 13, 1994

Todd Thompson
California Regional Water Quality Control Board
73-720 Fred Waring Drive, Suite 100
Palm Desert, CA 92260

Dear Mr. Thompson:

Enclosed are the copies of the water analysis done on 01/03/94 for the Palo Verde Lagoon and the Palo Verde Drain within Imperial County. Samples were obtained from the levee banks by using a pole that holds the sampling bottle. All samples were obtained from free flowing sections of the respective waterway sampling points. Samples were analyzed for total coliforms present and fecal coliforms present by using multiple tube fermentation technique. Imperial County lab personnel are using the 5 tube method; the dilutions are 1:1, 1:10, 1:1/10, 1:100, and 1:1000.

Refer to attached map depicting the sampling locations as agreed to during our meeting of 5/12/93 at PVID in Blythe. The next scheduled sampling date is 2/7/94; please advise me if this date is not suitable for you. Riverside and Imperial County are planning to perform a "split sample" as part of the 2/7/94 sampling; the sample location will be site number 7 within Imperial County.

Sincerely,

Yvonne Smith, MPA, Director
Imperial County Health Department

Paul F. Nichols
By: Paul Nichols, REHS II
Division of Environmental Health Services

cc: Bob Freeman, Lab Director, Imp. Co. Public Health Laboratory

Bacteriological Analysis of Water LAB # 7,410

Tested at Imperial County Laboratory

Date Received 01/03/1994 Analyst: Bob/S

Sampled from CLIENT # 3	SAMPLED BY Nichols
Environmental Health	DATE / TIME 01/03/1994 / 11:10
939 Main Street	TYPE OF SAMPLE: Raw Surface Water
EI Centro CA	CHLORINE RESIDUE 0 ppm
92243	SAMPLE SITE: PaloVerdeDrain#11

ATTENTION :
01/07/1994 | MPN= 3,000.0 MPN/100ml water [11 Pos/ 4 Neg] + Coliforms PRESENT
Fecal Coli = 2400

Special

Environmental Health	
939 Main Street	
EI Centro CA	
92243	

ATTENTION:

(c) BtB Software, 1992 Imperial County Laboratory 935 Broadway EI Centro California 92243 ELAP # 1773
Print Date 01-11-1994/ 12:33 pm Director: Bob Freeman PHONE: (619) 339-4437 MediCare # 55-L0008850 CLIA # 0500670166

Bacteriological Analysis of Water LAB # 7,411

Tested at Imperial County Laboratory

Date Received 01/03/1994 Analyst: Bob/S

Sampled from CLIENT # 3	SAMPLED BY Nichols
Environmental Health	DATE / TIME 01/03/1994 / 10:10
939 Main Street	TYPE OF SAMPLE: Raw Surface Water
EI Centro CA	CHLORINE RESIDUE 0 ppm
92243	SAMPLE SITE: PaloVerdeDrain#12

ATTENTION :
01/07/1994 | MPN= 3,000.0 MPN/100ml water [11 Pos/ 4 Neg] + Coliforms PRESENT
Fecal Coli = 3000

Special

Environmental Health	
939 Main Street	
EI Centro CA	
92243	

ATTENTION:

(c) BtB Software, 1992 Imperial County Laboratory 935 Broadway EI Centro California 92243 ELAP # 1773
Print Date 01-11-1994/ 12:33 pm Director: Bob Freeman PHONE: (619) 339-4437 MediCare # 55-L0008850 CLIA # 0500670166

Bacteriological Analysis of Water LAB # 7,408

Tested at Imperial County Laboratory

Date Received 01/03/1994 Analyst: Bob [Signature]

Sampled from CLIENT # 3	SAMPLED BY Nichols
Environmental Health	DATE / TIME 01/03/1994 / 10:55
939 Main Street	TYPE OF SAMPLE: Raw Surface Water
El Centro CA 92243	CHLORINE RESIDUE 0 ppm
ATTENTION :	SAMPLE SITE: PaloVerdeLagoon#9

01/07/1994 | MPN= 2,400.0 MPN/100ml water [10 Pos/ 5 Neg] + Coliforms PRESENT
| Fecal Coli = 2400

Special

Environmental Health 939 Main Street El Centro CA 92243 ATTENTION:	
---	--

(c) BtB Software, 1992 Imperial County Laboratory 935 Broadway El Centro California 92243 ELAP # 1773
Print Date 01-11-1994/ 12:33 pm Director: Bob Freeman PHONE: (619) 339-4437 MediCare # 55-L0008850 CLIA # 05D0670166

Bacteriological Analysis of Water LAB # 7,409

Tested at Imperial County Laboratory

Date Received 01/03/1994 Analyst: Bob [Signature]

Sampled from CLIENT # 3	SAMPLED BY Nichols
Environmental Health	DATE / TIME 01/03/1994 / 10:25
939 Main Street	TYPE OF SAMPLE: Raw Surface Water
El Centro CA 92243	CHLORINE RESIDUE 0 ppm
ATTENTION :	SAMPLE SITE: PaloVerdeDrain #10

01/07/1994 | MPN= 2,400.0 MPN/100ml water [10 Pos/ 5 Neg] + Coliforms PRESENT
| Fecal Coli = 2400

Special

Environmental Health 939 Main Street El Centro CA 92243 ATTENTION:	
---	--

(c) BtB Software, 1992 Imperial County Laboratory 935 Broadway El Centro California 92243 ELAP # 1773
Print Date 01-11-1994/ 12:33 pm Director: Bob Freeman PHONE: (619) 339-4437 MediCare # 55-L0008850 CLIA # 05D0670166

Bacteriological Analysis of Water		LAB # 7.406
Tested at Imperial County Laboratory		
Date Received 01/03/1994		Analyst: Bob/S
Sampled from CLIENT # 3	SAMPLED BY Nichols	
Environmental Health	DATE / TIME 01/03/1994 / 11:25	
939 Main Street	TYPE OF SAMPLE: Raw Surface Water	
El Centro CA 92243	CHLORINE RESIDUE 0 ppm	
ATTENTION :	SAMPLE SITE: PaloVerdeLagoon#7	
01/07/1994	MPN= 3,000.0 MPN/100ml water [11 Pos/ 4 Neg]	+ Coliforms PRESENT
Fecal Coli = 1600		
<i>Special</i>		
Environmental Health		
939 Main Street		
El Centro	CA	
	92243	
ATTENTION:		

(c) BtB Software, 1992 Imperial County Laboratory 935 Broadway El Centro California 92243 ELAP # 1773
 Print Date 01-11-1994/ 12:33 pm Director: Bob Freeman PHONE: (619) 339-4437 MediCare # 55-L0008850 CLIA # 0500670166

Bacteriological Analysis of Water		LAB # 7.407
Tested at Imperial County Laboratory		
Date Received 01/03/1994		Analyst: Bob/S
Sampled from CLIENT # 3	SAMPLED BY Nichols	
Environmental Health	DATE / TIME 01/03/1994 / 10:40	
939 Main Street	TYPE OF SAMPLE: Raw Surface Water	
El Centro CA 92243	CHLORINE RESIDUE 0 ppm	
ATTENTION :	SAMPLE SITE: PaloVerdeLagoon #8	
01/07/1994	MPN= 3,000.0 MPN/100ml water [11 Pos/ 4 Neg]	+ Coliforms PRESENT
Fecal Coli = 2400		
<i>Special</i>		
Environmental Health		
939 Main Street		
El Centro	CA	
	92243	
ATTENTION:		

(c) BtB Software, 1992 Imperial County Laboratory 935 Broadway El Centro California 92243 ELAP # 1773
 Print Date 01-11-1994/ 12:33 pm Director: Bob Freeman PHONE: (619) 339-4437 MediCare # 55-L0008850 CLIA # 0500670166

COUNTY OF IMPERIAL

COURTHOUSE
939 W. MAIN ST.
EL CENTRO, CA 92243



TELEPHONE:
(619) 339-4203
(619) 339-4204
(619) 339-4205
FAX:
(619) 352-1309

DEPARTMENT OF HEALTH SERVICES DIVISION OF ENVIRONMENTAL HEALTH

February 25, 1994

Don Park
Riverside County Department EHS
79733 Country Club Drive, Suite D
Bermuda Dunes, CA 92201

Dear Mr. Park:

Enclosed are the copies of the water analysis done on 2/7/94 for the Palo Verde Lagoon and the Palo Verde Drain within Imperial County. Samples were analyzed for total coliforms present and fecal coliforms present by using multiple tube fermentation technique.

Refer to attached map depicting the sampling locations as previously agreed to. The next scheduled sampling date is 3/7/94; please advise me if this date is not suitable for you. Riverside and Imperial County are planning another "split sample" as part of the 3/7/94 sampling; the sample location will probably be site number 7 within Imperial County.

Sincerely,

Yvonne Smith, MPA, Director
Imperial County Health Department

Paul F. Nichols

By: Paul Nichols, REHS II
Div. of Environmental Health Services

PN/lde

COUNTY OF IMPERIAL

COURTHOUSE
939 W. MAIN ST.
EL CENTRO, CA 92243



TELEPHONE:
(619) 339-4203
(619) 339-4204
(619) 339-4205
FAX:
(619) 352-1309

DEPARTMENT OF HEALTH SERVICES DIVISION OF ENVIRONMENTAL HEALTH

February 25, 1994

Todd Thompson
California Regional Water Quality
73-720 Fred Waring Dr., Suite 100
Palm Desert, CA 92260

Dear Mr. Thompson:

Enclosed are the copies of the water analysis done on 2/7/94 for the Palo Verde Lagoon and the Palo Verde Drain within Imperial County. Samples were analyzed for total coliforms present and fecal coliforms present by using multiple tube fermentation technique.

Refer to attached map depicting the sampling locations as previously agreed to. The next scheduled sampling date is 3/7/94; please advise me if this date is not suitable for you. Riverside and Imperial County are planning another "split sample" as part of the 3/7/94 sampling; the sample location will probably be site number 7 within Imperial County.

Sincerely,

Yvonne Smith, MPA, Director
Imperial County Health Department

Paul F. Nichols

By: Paul Nichols, REHS II
Div. of Environmental Health Services

PN/ldc

COUNTY OF IMPERIAL

COURTHOUSE
939 W. MAIN ST.
EL CENTRO, CA 92243



TELEPHONE:
(619) 339-4203
(619) 339-4204
(619) 339-4205
FAX:
(619) 352-1309

DEPARTMENT OF HEALTH SERVICES DIVISION OF ENVIRONMENTAL HEALTH

February 25, 1994

Roger Henning
Palo Verde Irrigation District
180 W 14th Ave
Blythe, CA 92225

Dear Mr. Henning:

Enclosed are the copies of the water analysis done on 2/7/94 for the Palo Verde Lagoon and the Palo Verde Drain within Imperial County. Samples were analyzed for total coliforms present and fecal coliforms present by using multiple tube fermentation technique.

Refer to attached map depicting the sampling locations as previously agreed to. The next scheduled sampling date is 3/7/94; please advise me if this date is not suitable for you. Riverside and Imperial County are planning another "split sample" as part of the 3/7/94 sampling; the sample location will probably be site number 7 within Imperial County.

Sincerely,

Yvonne Smith, MPA, Director
Imperial County Health Department

Paul Nichols

By: Paul Nichols, REHS II
Div. of Environmental Health Services

PN/ldc

NAME: Paul Nichols NO.: 13 IMPERI
 EMPLOYEE: Paul Nichols
 DATE(S): February 7, 1994 DAIL

TIME IN	TIME OUT	SITE NAME OR ADDRESS	TA C	COMP # or LC	SUP DIST	PRGM ELMT	SERVICE CODE	#
0800	0830	office	2	18	105	48.45	11	1
0950	0955	Palo Verde Drain #12	2	18	105	48.45	303	1
1000	1005	Palo Verde Drain #10	2	18	105	48.45	303	1
1010	1015	Palo Verde Lagoon #8	2	18	105	48.45	303	1
1020	1030	Palo Verde Lagoon #9	2	18	105	48.45	303	1
1030	1040	Palo Verde Drain #11	2	18	105	48.45	303	1

 Bacteriological Analysis of Water LAB # 7,452
 Tested at Imperial County Laboratory
 Date Received 02/07/1994 Analyst: Bob D
 Sampled from CLIENT # 3
 Environmental Health
 939 Main Street
 El Centro CA 92243
 ATTENTION :
 02/11/1994 MPN= 3,000.0 MPN/100ml water [11 Pos/ 4 Neg] + Coliforms PRESENT
 Fecal Coli = 1600
 Environmental Health
 939 Main Street
 El Centro CA 92243
 ATTENTION :

 Bacteriological Analysis of Water LAB # 7,452
 Tested at Imperial County Laboratory
 Date Received 02/07/1994 Analyst: Bob D
 Sampled from CLIENT # 3
 Environmental Health
 939 Main Street
 El Centro CA 92243
 ATTENTION :
 02/11/1994 MPN= 3,000.0 MPN/100ml water [11 Pos/ 4 Neg] + Coliforms PRESENT
 Fecal Coli = 1600
 Environmental Health
 939 Main Street
 El Centro CA 92243
 ATTENTION :

94 FEB 23 PM 2:50

Bacteriological Analysis of Water

LAB # 7,449

Tested at Imperial County Laboratory

Date Received 02/07/1994

Analyst:

Bob D

Sampled from CLIENT # 3

Environmental Health

939 Main Street

El Centro CA

92243

SAMPLED BY Nichols

DATE / TIME 02/07/1994 / 11:15

TYPE OF SAMPLE: Raw Surface Water

CHLORINE RESIDUE 0 ppm

SAMPLE SITE: PaloVerdeLagoon#7

ATTENTION:

02/11/1994

MPN=

3,000.0 MPN/100ml water [11 Pos/ 4 Neg] + Coliforms PRESENT

Fecal Coli = 2400

Split Sample H/Riverside EHS

Special

Environmental Health

939 Main Street

El Centro CA

92243

ATTENTION:

(c) BtB Software, 1992 Imperial County Laboratory 835 Broadway El Centro California 92243 ELAP # 1773

Print Date 02-17-1994/ 7:16 am Director: Bob Freeman PHONE: (619) 339-4437 MediCare # 55-L0008850 CLIA # 05D0670166

Bacteriological Analysis of Water		LAB # 7,454
Tested at Imperial County Laboratory		
Date Received 02/07/1994		Analyst: <i>Bob D</i>
Sampled from CLIENT # 3	Environmental Health	SAMPLED BY Nichols
939 Main Street	El Centro CA	DATE / TIME 02/07/1994 / 10:30
92243		TYPE OF SAMPLE: Raw Surface Water
		CHLORINE RESIDUE 0 ppm
ATTENTION :		SAMPLE SITE: Palo Verde Drain #11
02/11/1994	MPN= 2,400.0 MPN/100ml water [10 Pos/ 5 Neg]	+ Coliforms PRESENT
Fecal Coli = 2400		
<i>Special</i>		
Environmental Health		
939 Main Street		
El Centro CA		
92243		
ATTENTION:		

(c) BtB Software, 1992 Imperial County Laboratory 935 Broadway El Centro California 92243 ELAP # 1773
 Print Date 02-17-1994/ 7:16 am Director: Bob Freeman PHONE: (619) 339-4437 MediCare # 55-L0008850 CLIA # 05D0670166

Bacteriological Analysis of Water		LAB # 7,455
Tested at Imperial County Laboratory		
Date Received 02/07/1994		Analyst: <i>Bob D</i>
Sampled from CLIENT # 3	Environmental Health	SAMPLED BY Nichols
939 Main Street	El Centro CA	DATE / TIME 02/07/1994 / 09:50
92243		TYPE OF SAMPLE: Raw Surface Water
		CHLORINE RESIDUE 0 ppm
ATTENTION :		SAMPLE SITE: Palo Verde Drain #12
02/11/1994	MPN= 5,000.0 MPN/100ml water [12 Pos/ 3 Neg]	+ Coliforms PRESENT
Fecal Coli = 2400		
<i>Special</i>		
Environmental Health		
939 Main Street		
El Centro CA		
92243		
ATTENTION:		

(c) BtB Software, 1992 Imperial County Laboratory 935 Broadway El Centro California 92243 ELAP # 1773
 Print Date 02-17-1994/ 7:16 am Director: Bob Freeman PHONE: (619) 339-4437 MediCare # 55-L0008850 CLIA # 05D0670166

Bacteriological Analysis of Water		LAB # 7,452
Tested at Imperial County Laboratory		
Date Received 02/07/1994		Analyst: <i>Bob D</i>
Sampled from CLIENT # 3	SAMPLED BY Nichols	
Environmental Health	DATE / TIME 02/07/1994 / 10:20	
939 Main Street	TYPE OF SAMPLE: Raw Surface Water	
El Centro CA	CHLORINE RESIDUE 0 ppm	
92243	SAMPLE SITE: Palo Verde Lagoon #9	
ATTENTION :		
02/11/1994 MPN= 3,000.0 MPN/100ml water [11 Pos/ 4 Neg] + Coliforms PRESENT		
Fecal Coli = 1600		
<i>Special</i>		
Environmental Health		
939 Main Street		
El Centro CA		
92243		
ATTENTION:		
(c) BtB Software, 1992 Imperial County Laboratory 935 Broadway El Centro California 92243 ELAP # 1773		
Print Date 02-24-1994/ 8:56 am Director: Bob Freeman PHONE: (619) 339-4437 MediCare # 55-L0008850 CLIA # 05D0670166		

Bacteriological Analysis of Water		LAB # 7,453
Tested at Imperial County Laboratory		
Date Received 02/07/1994		Analyst: <i>Bob D</i>
Sampled from CLIENT # 3	SAMPLED BY Nichols	
Environmental Health	DATE / TIME 02/07/1994 / 10:00	
939 Main Street	TYPE OF SAMPLE: Raw Surface Water	
El Centro CA	CHLORINE RESIDUE 0 ppm	
92243	SAMPLE SITE: Palo Verde Drain #10	
ATTENTION :		
02/11/1994 MPN= 9,000.0 MPN/100ml water [13 Pos/ 2 Neg] + Coliforms PRESENT		
Fecal Coli = 3000		
<i>Special</i>		
Environmental Health		
939 Main Street		
El Centro CA		
92243		
ATTENTION:		
(c) BtB Software, 1992 Imperial County Laboratory 935 Broadway El Centro California 92243 ELAP # 1773		
Print Date 02-17-1994/ 7:16 am Director: Bob Freeman PHONE: (619) 339-4437 MediCare # 55-L0008850 CLIA # 05D0670166		

Bacteriological Analysis of Water

LAB # 7,450

Tested at Imperial County Laboratory

Date Received 02/07/1994

Analyst: Bob/S

Sampled from CLIENT # 3

Environmental Health

939 Main Street

El Centro CA

92243

SAMPLED BY Nichols

DATE / TIME 02/07/1994 / 10:45

TYPE OF SAMPLE: Raw Surface Water

CHLORINE RESIDUE 0 ppm

SAMPLE SITE: PaloVerde #7

ATTENTION:

02/11/1994 | MPN= 2,400.0 MPN/100ml water [10 Pos/ 5 Neg] + Coliforms PRESENT
| Fecal Coli = 1600

Special

Environmental Health

939 Main Street

El Centro CA

92243

ATTENTION:

(c) BtB Software, 1992 Imperial County Laboratory 935 Broadway El Centro California 92243 ELAP # 1773

Print Date 02-17-1994/ 7:16 am Director: Bob Freeman PHONE: (619) 339-4437 MediCare # 55-L0008850 CLIA # 05D0670166

Bacteriological Analysis of Water

LAB # 7,451

Tested at Imperial County Laboratory

Date Received 02/07/1994

Analyst: Bob/S

Sampled from CLIENT # 3

Environmental Health

939 Main Street

El Centro CA

92243

SAMPLED BY Nichols

DATE / TIME 02/07/1994 / 10:10

TYPE OF SAMPLE: Raw Surface Water

CHLORINE RESIDUE 0 ppm

SAMPLE SITE: PaloVerde Lagoon #8

ATTENTION:

02/11/1994 | MPN= 9,000.0 MPN/100ml water [13 Pos/ 2 Neg] + Coliforms PRESENT
| Fecal Coli = 5000

Special

Environmental Health

939 Main Street

El Centro CA

92243

ATTENTION:

(c) BtB Software, 1992 Imperial County Laboratory 935 Broadway El Centro California 92243 ELAP # 1773

Print Date 02-17-1994/ 7:16 am Director: Bob Freeman PHONE: (619) 339-4437 MediCare # 55-L0008850 CLIA # 05D0670166

COUNTY OF IMPERIAL

COURTHOUSE
939 W. MAIN ST.
EL CENTRO, CA 92243



TELEPHONE:
(619) 339-4203
(619) 339-4204
(619) 339-4205
FAX:
(619) 352-1309

DEPARTMENT OF HEALTH SERVICES DIVISION OF ENVIRONMENTAL HEALTH

March 24, 1994

Don Park
Riverside County Department EHS
79733 Country Club Drive, Suite D
Bermuda Dunes, CA 92201

Dear Mr. Park:

Enclosed are the copies of the water analysis done on 3/7/94 for the Palo Verde Lagoon and the Palo Verde Drain within Imperial County. Samples were analyzed for total coliforms present and fecal coliforms present by using multiple tube fermentation technique.

Refer to attached map depicting the sampling locations as previously agreed to. The next scheduled sampling date is 4/4/94; please advise me if this date is not suitable for you.

Sincerely,

Yvonne Smith, MPA, Director
Imperial County Health Department

Paul Nichols

By: Paul Nichols, REHS II
Div. of Environmental Health Services

PN/lcd

COUNTY OF IMPERIAL

COURTHOUSE
939 W. MAIN ST.
EL CENTRO, CA 92243



TELEPHONE:
(619) 339-4203
(619) 339-4204
(619) 339-4205
FAX:
(619) 352-1309

DEPARTMENT OF HEALTH SERVICES DIVISION OF ENVIRONMENTAL HEALTH

March 24, 1994

Roger Henning
Palo Verde Irrigation District
180 W 14th Ave.
Blythe, CA 92225

Dear Mr. Henning:

Enclosed are the copies of the water analysis done on 3/7/94 for the Palo Verde Lagoon and the Palo Verde Drain within Imperial County. Samples were analyzed for total coliforms present and fecal coliforms present by using multiple tube fermentation technique.

Refer to attached map depicting the sampling locations as previously agreed to. The next scheduled sampling date is 4/4/94; please advise me if this date is not suitable for you.

Sincerely,

Yvonne Smith, MPA, Director
Imperial County Health Department

Paul F. Nichols
By: Paul Nichols, REHS II
Div. of Environmental Health Services

PN/lcd

COUNTY OF IMPERIAL

COURTHOUSE
939 W. MAIN ST.
EL CENTRO, CA 92243



TELEPHONE:
(619) 339-4203
(619) 339-4204
(619) 339-4205
FAX:
(619) 352-1309

DEPARTMENT OF HEALTH SERVICES DIVISION OF ENVIRONMENTAL HEALTH

March 24, 1994

Todd Thompson
Ca. Regional Water Quality Control Board
73-720 Fred Waring Drive, Suite 100
Palm Desert, CA 92260

Dear Mr. Thompson:

Enclosed are the copies of the water analysis done on 3/7/94 for the Palo Verde Lagoon and the Palo Verde Drain within Imperial County. Samples were analyzed for total coliforms present and fecal coliforms present by using multiple tube fermentation technique.

Refer to attached map depicting the sampling locations as previously agreed to. The next scheduled sampling date is 4/4/94; please advise me if this date is not suitable for you.

Sincerely,

Yvonne Smith, MPA, Director
Imperial County Health Department

Paul F. Nichols

By: Paul Nichols, REHS II
Div. of Environmental Health Services

PN/lde

Bacteriological Analysis of Water LAB # 7,492

Tested at Imperial County Laboratory

Date Received 03/07/1994 Analyst: *Bob/S*

Sampled from CLIENT # 3

Environmental Health

939 Main Street

El Centro CA 92243

ATTENTION :

03/10/1994 MPN= 3,000.0 MPN/100ml water [11 Pos/ 4 Neg] + Coliforms PRESENT

Fecal Coli =3000

SAMPLED BY Nichols

DATE / TIME 03/07/1994 / 11:25

TYPE OF SAMPLE : Raw Surface Water

CHLORINE RESIDUE 0 ppm

SAMPLE SITE : PaloVerdeLagoon #7

Environmental Health

939 Main Street

El Centro CA 92243

ATTENTION:

(c) BtB Software, 1992 Imperial County Laboratory 935 Broadway El Centro California 92243 ELAP # 1773

Print Date 03-16-1994/ 9:02 am Director: Bob Freeman PHONE: (619) 339-4437 MediCare # 55-L0008850 CLIA # 05D0670166

Special

Bacteriological Analysis of Water LAB # 7,493

Tested at Imperial County Laboratory

Date Received 03/07/1994 Analyst: *Bob/S*

Sampled from CLIENT # 3

Environmental Health

939 Main Street

El Centro CA 92243

ATTENTION :

03/10/1994 MPN= 1,700.0 MPN/100ml water [10 Pos/ 5 Neg] + Coliforms PRESENT

Fecal Coli =1100

SAMPLED BY Nichols

DATE / TIME 03/07/1994 / 10:50

TYPE OF SAMPLE : Raw Surface Water

CHLORINE RESIDUE 0 ppm

SAMPLE SITE : PaloVerdeLagoon #8

Environmental Health

939 Main Street

El Centro CA 92243

ATTENTION:

(c) BtB Software, 1992 Imperial County Laboratory 935 Broadway El Centro California 92243 ELAP # 1773

Print Date 03-16-1994/ 9:02 am Director: Bob Freeman PHONE: (619) 339-4437 MediCare # 55-L0008850 CLIA # 05D0670166

Special

Bacteriological Analysis of Water LAB # 7,499
 Tested at Imperial County Laboratory
 Date Received 03/07/1994 Analyst: Brb/LS
 Sampled from CLIENT # 3
 Environmental Health
 939 Main Street
 El Centro CA 92243
 ATTENTION :
 03/10/1994 | MPN= 900.0 MPN/100ml water [13 Pos/ 2 Neg] + Coliforms PRESENT
 | Fecal Coli = 110

Special

Environmental Health
 939 Main Street
 El Centro CA 92243
 ATTENTION:

(c) BtB Software, 1992 Imperial County Laboratory 935 Broadway El Centro California 92243 ELAP # 1773
 Print Date 03-16-1994/ 9:02 am Director: Bob Freeman PHONE: (619) 339-4437 MediCare # 55-L0008850 CLIA # 05D0670166

Bacteriological Analysis of Water LAB # 7,498
 Tested at Imperial County Laboratory
 Date Received 03/07/1994 Analyst: Brb/LS
 Sampled from CLIENT # 3
 Environmental Health
 939 Main Street
 El Centro CA 92243
 ATTENTION :
 03/10/1994 | MPN= 1,600.0 MPN/100ml water [14 Pos/ 1 Neg] + Coliforms PRESENT
 | Split Sample W/Riverside EHS Fecal Coli = 1800

Special

Environmental Health
 939 Main Street
 El Centro CA 92243
 ATTENTION:

(c) BtB Software, 1992 Imperial County Laboratory 935 Broadway El Centro California 92243 ELAP # 1773
 Print Date 03-16-1994/ 3:02 am Director: Bob Freeman PHONE: (619) 339-4437 MediCare # 55-L0008850 CLIA # 05D0670166

Bacteriological Analysis of Water		LAB # 7,496
Tested at Imperial County Laboratory		
Date Received 03/07/1994		Analyst: <i>Bob/S</i>
Sampled from CLIENT # 3	SAMPLED BY Nichols	
Environmental Health	DATE / TIME 03/07/1994 / 10:40	
939 Main Street	TYPE OF SAMPLE: Raw Surface Water	
El Centro CA	CHLORINE RESIDUE 0 ppm	
92243	SAMPLE SITE: PaloVerdeDrain #11	
ATTENTION :		
03/10/1994	MPN= 2,200.0 MPN/100ml water [11 Pos/ 4 Neg] + Coliforms PRESENT	
Fecal Coli =900		
<i>special</i>		
Environmental Health		
939 Main Street		
El Centro	CA	
	92243	
ATTENTION:		
(c) BtB Software, 1992 Imperial County Laboratory 935 Broadway El Centro California 92243 ELAP # 1773		
Print Date 03-16-1994/ 9:02 am Director: Bob Freeman PHONE: (619) 339-4437 MediCare # 55-L0008850 CLIA # 05D0670166		

Bacteriological Analysis of Water		LAB # 7,497
Tested at Imperial County Laboratory		
Date Received 03/07/1994		Analyst: <i>Bob/S</i>
Sampled from CLIENT # 3	SAMPLED BY Nichols	
Environmental Health	DATE / TIME 03/07/1994 / 10:00	
939 Main Street	TYPE OF SAMPLE: Raw Surface Water	
El Centro CA	CHLORINE RESIDUE 0 ppm	
92243	SAMPLE SITE: PaloVerdeDrain#12	
ATTENTION :		
03/10/1994	MPN= 1,600.0 MPN/100ml water [14 Pos/ 1 Neg] + Coliforms PRESENT	
Fecal Coli = 500		
<i>special</i>		
Environmental Health		
939 Main Street		
El Centro	CA	
	92243	
ATTENTION:		
(c) BtB Software, 1992 Imperial County Laboratory 935 Broadway El Centro California 92243 ELAP # 1773		
Print Date 03-16-1994/ 9:02 am Director: Bob Freeman PHONE: (619) 339-4437 MediCare # 55-L0008850 CLIA # 05D0670166		

Bacteriological Analysis of Water		LAB # 7,494
Tested at Imperial County Laboratory		
Date Received 03/07/1994		Analyst: <i>Bob</i>
Sampled from CLIENT # 3	Environmental Health	SAMPLED BY Nichols
939 Main Street	CA	DATE / TIME 03/07/1994 / 10:45
El Centro 92243		TYPE OF SAMPLE: Raw Surface Water
		CHLORINE RESIDUE 0 ppm
ATTENTION :		SAMPLE SITE: PaloVerdeLagoon#9
03/10/1994 MPN= 500.0 MPN/100ml water [12 Pos/ 3 Neg] + Coliforms PRESENT		
Fecal Coli =240		
		<i>Special</i>
Environmental Health		
939 Main Street		
El Centro	CA	
	92243	
ATTENTION:		
(c) BtB Software, 1992 Imperial County Laboratory 935 Broadway El Centro California 92243 ELAP # 1773		
Print Date 03-16-1994/ 9:02 am Director: Bob Freeman PHONE: (619) 339-4437 MediCare # 55-L0008850 CLIA # 0500670166		

Bacteriological Analysis of Water		LAB # 7,495
Tested at Imperial County Laboratory		
Date Received 03/07/1994		Analyst: <i>Bob</i>
Sampled from CLIENT # 3	Environmental Health	SAMPLED BY Nichols
939 Main Street	CA	DATE / TIME 03/07/1994 / 10:25
El Centro 92243		TYPE OF SAMPLE: Raw Surface Water
		CHLORINE RESIDUE 0 ppm
ATTENTION :		SAMPLE SITE: PaloVerdeDrain#10
03/10/1994 MPN= 900.0 MPN/100ml water [13 Pos/ 2 Neg] + Coliforms PRESENT		
Fecal Coli =500		
		<i>Special</i>
Environmental Health		
939 Main Street		
El Centro	CA	
	92243	
ATTENTION:		
(c) BtB Software, 1992 Imperial County Laboratory 935 Broadway El Centro California 92243 ELAP # 1773		
Print Date 03-16-1994/ 9:02 am Director: Bob Freeman PHONE: (619) 339-4437 MediCare # 55-L0008850 CLIA # 0500670166		

Bacteriological Analysis of Water		LAB # 7,492
Tested at Imperial County Laboratory		
Date Received 03/07/1994	Analyst: <i>Bob/S</i>	
Sampled from CLIENT # 3	SAMPLED BY Nichols	
Environmental Health	DATE / TIME 03/07/1994 / 11:25	
939 Main Street	TYPE OF SAMPLE: Raw Surface Water	
El Centro CA	CHLORINE RESIDUE 0 ppm	
92243	SAMPLE SITE: PaloVerdeLagoon #7	
ATTENTION :		
03/10/1994	MPN= 3,000.0 MPN/100ml water [11 Pos/ 4 Neg] + Coliforms PRESENT	
Fecal Coli =3000		

Special

Environmental Health	
939 Main Street	
El Centro CA	
92243	
ATTENTION:	

(c) BtB Software, 1992 Imperial County Laboratory 935 Broadway El Centro California 92243 ELAP # 1773
 Print Date 03-16-1994/ 9:02 am Director: Bob Freeman PHONE: (619) 339-4437 MediCare # 55-L0008650 CLIA # 0500670166

Bacteriological Analysis of Water		LAB # 7,493
Tested at Imperial County Laboratory		
Date Received 03/07/1994	Analyst: <i>Bob/S</i>	
Sampled from CLIENT # 3	SAMPLED BY Nichols	
Environmental Health	DATE / TIME 03/07/1994 / 10:50	
939 Main Street	TYPE OF SAMPLE: Raw Surface Water	
El Centro CA	CHLORINE RESIDUE 0 ppm	
92243	SAMPLE SITE: PaloVerdeLagoon #8	
ATTENTION :		
03/10/1994	MPN= 1,700.0 MPN/100ml water [10 Pos/ 5 Neg] + Coliforms PRESENT	
Fecal Coli =1100		

Special

Environmental Health	
939 Main Street	
El Centro CA	
92243	
ATTENTION:	

(c) BtB Software, 1992 Imperial County Laboratory 935 Broadway El Centro California 92243 ELAP # 1773
 Print Date 03-16-1994/ 9:02 am Director: Bob Freeman PHONE: (619) 339-4437 MediCare # 55-L0008650 CLIA # 0500670166

COUNTY OF IMPERIAL

COURTHOUSE
939 W. MAIN ST.
EL CENTRO, CA 92243



TELEPHONE:
(619) 339-4203
(619) 339-4204
(619) 339-4205
FAX:
(619) 352-1309

DEPARTMENT OF HEALTH SERVICES DIVISION OF ENVIRONMENTAL HEALTH

May 26, 1994

Don Park
Riverside County Department EHS
79733 Country Club Drive, Suite D
Bermuda Dunes, CA 92201

Dear Mr. Park:

Enclosed are the copies of the water analysis done on 05/02/94 for the Palo Verde Lagoon and the Palo Verde Drain within Imperial County. Samples were analyzed for total coliforms present and fecal coliforms present by using multiple tube fermentation technique.

Refer to attached map depicting the sampling locations as previously agreed to. The next scheduled sampling date is 06/06/94; please advise me if this date is not suitable for you.

Sincerely,

Yvonne Smith, MPA, Director
Imperial County Health Department

Paul F. Nichols

By: Paul Nichols, REHS II
Division of Environmental Health Services

PN/lhc

COUNTY OF IMPERIAL

COURTHOUSE
939 W. MAIN ST.
EL CENTRO, CA 92243



TELEPHONE:
(619) 339-4203
(619) 339-4204
(619) 339-4205
FAX:
(619) 352-1309

DEPARTMENT OF HEALTH SERVICES DIVISION OF ENVIRONMENTAL HEALTH

May 26, 1994

Roger Henning
Palo Verde Irrigation District
180 W 14th Ave
Blythe, CA 92225

Dear Mr. Henning:

Enclosed are the copies of the water analysis done on 05/02/94 for the Palo Verde Lagoon and the Palo Verde Drain within Imperial County. Samples were analyzed for total coliforms present and fecal coliforms present by using multiple tube fermentation technique.

Refer to attached map depicting the sampling locations as previously agreed to. The next scheduled sampling date is 06/06/94; please advise me if this date is not suitable for you.

Sincerely,

Yvonne Smith, MPA, Director
Imperial County Health Department

Paul Nichols

By: Paul Nichols, REHS II
Division of Environmental Health Services

PN/lcd

COUNTY OF IMPERIAL

COURTHOUSE
939 W. MAIN ST.
EL CENTRO, CA 92243



TELEPHONE:
(619) 339-4203
(619) 339-4204
(619) 339-4205

FAX:
(619) 352-1309

DEPARTMENT OF HEALTH SERVICES DIVISION OF ENVIRONMENTAL HEALTH

May 26, 1994

Todd Thompson
Ca. Regional Water Quality Control Board
73-720 Fred Waring Drive, Suite 100
Palm Desert, CA 92260

Dear Mr. Thompson:

Enclosed are the copies of the water analysis done on 05/02/94 for the Palo Verde Lagoon and the Palo Verde Drain within Imperial County. Samples were analyzed for total coliforms present and fecal coliforms present by using multiple tube fermentation technique.

Refer to attached map depicting the sampling locations as previously agreed to. The next scheduled sampling date is 06/06/94; please advise me if this date is not suitable for you.

Sincerely,

Yvonne Smith, MPA, Director
Imperial County Health Department

Paul F. Nichols

By: Paul Nichols, REHS II
Division of Environmental Health Services

PN/lde

Bacteriological Analysis of Water		LAB # 7,585
Tested at Imperial County Laboratory		
Date Received 05/02/1994		Analyst: <i>Bob/S</i>
Sampled from CLIENT # 3	Environmental Health	SAMPLED BY Nichols
939 Main Street	CA	DATE / TIME 05/02/1994 / 10:10
El Centro 92243		TYPE OF SAMPLE: Raw Surface Water
		CHLORINE RESIDUE 0 ppm
ATTENTION :		SAMPLE SITE: Pal Verde Drain # 1
05/06/1994 MPN= 2,400.0 MPN/100ml water [10 Pos/ 5 Neg] + Coliforms PRESENT		
Fecal Coli = 280		
		<i>Special</i>
Environmental Health		
939 Main Street		
El Centro	CA	
	92243	
ATTENTION:		
(c) BtB Software, 1992 Imperial County Laboratory 935 Broadway El Centro California 92243 ELAP # 1773		
Print Date 05-09-1994/ 11:48 am Director: Bob Freeman PHONE: (619) 339-4437 MediCare # 55-L0008850 CLIA # 05D0670168		

Bacteriological Analysis of Water		LAB # 7,586
Tested at Imperial County Laboratory		
Date Received 05/02/1994		Analyst: <i>Bob/S</i>
Sampled from CLIENT # 3	Environmental Health	SAMPLED BY Nichols
939 Main Street	CA	DATE / TIME 05/02/1994 / 09:45
El Centro 92243		TYPE OF SAMPLE: Raw Surface Water
		CHLORINE RESIDUE 0 ppm
ATTENTION :		SAMPLE SITE: Palo Verde Drain # 1
05/06/1994 MPN= 1,600.0 MPN/100ml water [14 Pos/ 1 Neg] + Coliforms PRESENT		
Fecal Coli = 1600		
		<i>Special</i>
Environmental Health		
939 Main Street		
El Centro	CA	
	92243	
ATTENTION:		
(c) BtB Software, 1992 Imperial County Laboratory 935 Broadway El Centro California 92243 ELAP # 1773		
Print Date 05-09-1994/ 11:48 am Director: Bob Freeman PHONE: (619) 339-4437 MediCare # 55-L0008850 CLIA # 05D0670168		

Bacteriological Analysis of Water		LAB # 7,583
Tested at Imperial County Laboratory		
Date Received 05/02/1994	Analyst: <i>Bob/S</i>	
Sampled from CLIENT # 3	SAMPLED BY Nichols	
Environmental Health	DATE / TIME 05/02/1994 / 10:15	
939 Main Street	TYPE OF SAMPLE: Raw Surface Water	
El Centro CA	CHLORINE RESIDUE 0 ppm	
92243	SAMPLE SITE: PaloVerdeLagoon#9	
ATTENTION :		
05/06/1994 MPN= 9,000.0 MPN/100ml water [13 Pos/ 2 Neg] + Coliforms PRESENT		
FecalColi =3000		
<i>Special</i>		
Environmental Health		
939 Main Street		
El Centro	CA	
	92243	
ATTENTION:		
(c) BtB Software, 1992 Imperial County Laboratory 935 Broadway El Centro California 92243 ELAP # 1773		
Print Date 05-09-1994/ 11:47 am Director: Bob Freeman PHONE: (619) 339-4437 MediCare # 55-L0008850 CLIA # 05D0670166		

Bacteriological Analysis of Water		LAB # 7,584
Tested at Imperial County Laboratory		
Date Received 05/02/1994	Analyst: <i>Bob/S</i>	
Sampled from CLIENT # 3	SAMPLED BY Nichols	
Environmental Health	DATE / TIME 05/02/1994 / 10:00	
939 Main Street	TYPE OF SAMPLE: Raw Surface Water	
El Centro CA	CHLORINE RESIDUE 0 ppm	
92243	SAMPLE SITE: Palo Verde Drain #1	
ATTENTION :		
05/06/1994 MPN= 2,400.0 MPN/100ml water [10 Pos/ 5 Neg] + Coliforms PRESENT		
FecalColi =2400		
<i>Special</i>		
Environmental Health		
939 Main Street		
El Centro	CA	
	92243	
ATTENTION:		
(c) BtB Software, 1992 Imperial County Laboratory 935 Broadway El Centro California 92243 ELAP # 1773		
Print Date 05-09-1994/ 11:47 am Director: Bob Freeman PHONE: (619) 339-4437 MediCare # 55-L0008850 CLIA # 05D0670166		

Bacteriological Analysis of Water		LAB #
Tested at Imperial County Laboratory		7,581
Date Received 05/02/1994		Analyst: <i>Bob/S</i>
Sampled from CLIENT # 3	SAMPLED BY Nichols	
Environmental Health	DATE / TIME 05/02/1994 / 11:35	
939 Main Street	TYPE OF SAMPLE: Raw Surface Water	
El Centro CA 92243	CHLORINE RESIDUE 0 ppm	
ATTENTION :	SAMPLE SITE: PaloVerde Lagoon #7	
05/06/1994	MPN= 5,000.0 MPN/100ml water [12 Pos/ 3 Neg] + Coliforms PRESENT	
Fecal Coli = 3000		
<i>Special</i>		
Environmental Health		
939 Main Street		
El Centro CA 92243		
ATTENTION:		
(c) BtB Software, 1992 Imperial County Laboratory 935 Broadway El Centro California 92243 ELAP # 1773		
Print Date 05-09-1994/ 11:47 am Director: Bob Freeman PHONE: (619) 339-4437 MediCare # 55-L0008850 CLIA # 0500670166		

Bacteriological Analysis of Water		LAB #
Tested at Imperial County Laboratory		7,582
Date Received 05/02/1994		Analyst: <i>Bob/S</i>
Sampled from CLIENT # 3	SAMPLED BY Nichols	
Environmental Health	DATE / TIME 05/02/1994 / 10:20	
939 Main Street	TYPE OF SAMPLE: Raw Surface Water	
El Centro CA 92243	CHLORINE RESIDUE 0 ppm	
ATTENTION :	SAMPLE SITE: PaloVerde Lagoon #6	
05/06/1994	MPN= 2,400.0 MPN/100ml water [10 Pos/ 5 Neg] + Coliforms PRESENT	
Fecal Coli = 1600		
<i>Special</i>		
Environmental Health		
939 Main Street		
El Centro CA 92243		
ATTENTION:		
(c) BtB Software, 1992 Imperial County Laboratory 935 Broadway El Centro California 92243 ELAP # 1773		
Print Date 05-09-1994/ 11:47 am Director: Bob Freeman PHONE: (619) 339-4437 MediCare # 55-L0008850 CLIA # 0500670166		

COUNTY OF IMPERIAL

COURTHOUSE
939 W. MAIN ST.
EL CENTRO, CA 92243



TELEPHONE:
(619) 339-4203
(619) 339-4204
(619) 339-4205
FAX:
(619) 352-1309

DEPARTMENT OF HEALTH SERVICES DIVISION OF ENVIRONMENTAL HEALTH

June 16, 1994

Roger Henning
Palo Verde Irrigation District
180 W 14th Ave.
Blythe, CA 92225

Dear Mr. Henning:

Enclosed are the copies of the water analysis done on 06/06/94 for the Palo Verde Lagoon and the Palo Verde Drain within Imperial County. Samples were analyzed for total coliforms present and fecal coliforms present by using multiple tube fermentation technique.

Refer to attached map depicting the sampling locations as previously agreed to. The next scheduled sampling date is 07/11/94; please advise me if this date is not suitable for you.

Sincerely,

Yvonne Smith, MPA, Director
Imperial County Health Department

Paul F. Nichols

By: Paul Nichols, REHS II
Division of Environmental Health Services

PN/lcd

COUNTY OF IMPERIAL

COURTHOUSE
939 W. MAIN ST.
EL CENTRO, CA 92243



TELEPHONE:
(619) 339-4203
(619) 339-4204
(619) 339-4205
FAX:
(619) 352-1309

DEPARTMENT OF HEALTH SERVICES DIVISION OF ENVIRONMENTAL HEALTH

June 16, 1994

Don Park
Riverside County Department EHS
79733 Country Club Drive, Suite D
Bermuda Dunes, CA 92201

Dear Mr. Park:

Enclosed are the copies of the water analysis done on 06/06/94 for the Palo Verde Lagoon and the Palo Verde Drain within Imperial County. Samples were analyzed for total coliforms present and fecal coliforms present by using multiple tube fermentation technique.

Refer to attached map depicting the sampling locations as previously agreed to. The next scheduled sampling date is 07/11/94; please advise me if this date is not suitable for you.

Sincerely,

Yvonne Smith, MPA, Director
Imperial County Health Department

By: Paul Nichols, REHS II
Division of Environmental Health Services

PN/lde

COUNTY OF IMPERIAL

COURTHOUSE
939 W. MAIN ST.
EL CENTRO, CA 92243



TELEPHONE:
(619) 339-4203
(619) 339-4204
(619) 339-4205
FAX:
(619) 352-1309

DEPARTMENT OF HEALTH SERVICES DIVISION OF ENVIRONMENTAL HEALTH

June 16, 1994

Todd Thompson
Ca. Regional Water Quality Control Board
73-720 Fred Waring Drive, Suite 100
Palm Desert, CA 92260

Dear Mr. Thompson:

Enclosed are the copies of the water analysis done on 06/06/94 for the Palo Verde Lagoon and the Palo Verde Drain within Imperial County. Samples were analyzed for total coliforms present and fecal coliforms present by using multiple tube fermentation technique.

Refer to attached map depicting the sampling locations as previously agreed to. The next scheduled sampling date is 07/11/94; please advise me if this date is not suitable for you.

Sincerely,

Yvonne Smith, MPA, Director
Imperial County Health Department

A handwritten signature in cursive script that reads "Paul Nichols".

By: Paul Nichols, REHS II
Division of Environmental Health Services

PN/lde

Bacteriological Analysis of Water LAB # 7,663

Tested at Imperial County Laboratory

Date Received 06/06/1994 Analyst: Bob / S

Sampled from CLIENT # 3	SAMPLED BY P. Nichols
Environmental Health	DATE / TIME 06/06/1994 / 10:25
939 Main Street	TYPE OF SAMPLE: Raw Surface Water
El Centro CA 92243	CHLORINE RESIDUE 0.0 ppm
ATTENTION :	SAMPLE SITE: PaloVerde Drain #11

06/07/1994 | MPN= 1,400.0 MPN/100ml water [10 Pos/ 5 Neg] + Coliforms PRESENT
 | Fecal Coli= 900

Environmental Health
 939 Main Street
 El Centro CA 92243
 ATTENTION:

Special

(c) BtB Software, 1992 Imperial County Laboratory 935 Broadway El Centro California 92243 ELAP # 1773
 Print Date 06-09-1994/ 9:48 am Director: Bob Freeman PHONE: (619) 339-4437 MediCare # 55-L0008850 CLIA # 05D0670166

Bacteriological Analysis of Water LAB # 7,664

Tested at Imperial County Laboratory

Date Received 06/06/1994 Analyst: Bob / S

Sampled from CLIENT # 3	SAMPLED BY P. Nichols
Environmental Health	DATE / TIME 06/06/1994 / 09:50
939 Main Street	TYPE OF SAMPLE: Raw Surface Water
El Centro CA 92243	CHLORINE RESIDUE 0.0 ppm
ATTENTION :	SAMPLE SITE: PaloVerde Drain #12

06/07/1994 | MPN= 1,600.0 MPN/100ml water [14 Pos/ 1 Neg] + Coliforms PRESENT
 | Fecal Coli =1800

Environmental Health
 939 Main Street
 El Centro CA 92243
 ATTENTION:

Special

(c) BtB Software, 1992 Imperial County Laboratory 935 Broadway El Centro California 92243 ELAP # 1773
 Print Date 06-09-1994/ 9:48 am Director: Bob Freeman PHONE: (619) 339-4437 MediCare # 55-L0008850 CLIA # 05D0670166

Bacteriological Analysis of Water		LAB #
Tested at Imperial County Laboratory		7,661
Date Received 06/06/1994		Analyst: <i>Bob/S</i>
Sampled from CLIENT # 3	Environmental Health	SAMPLED BY P. Nichols
939 Main Street	El Centro CA	DATE / TIME 06/06/1994 / 10:20
92243		TYPE OF SAMPLE: Raw Surface Water
ATTENTION:		CHLORINE RESIDUE 0.0 ppm
06/07/1994	MPN= 3,000.0 MPN/100ml water [11 Pos/ 4 Neg] + Coliforms PRESENT	SAMPLE SITE: PaloVerde Lagoon #9
	Fecal Coli = 1600	
Environmental Health		<i>Special</i>
939 Main Street		
El Centro CA		
92243		
ATTENTION:		
(c) BtB Software, 1992 Imperial County Laboratory 935 Broadway El Centro California 92243 ELAP # 1773		
Print Date 06-09-1994/ 9:47 am Director: Bob Freeman PHONE: (619) 339-4437 MediCare # 55-L0008850 CLIA # 05D0670166		

Bacteriological Analysis of Water		LAB #
Tested at Imperial County Laboratory		7,662
Date Received 06/06/1994		Analyst: <i>Bob/S</i>
Sampled from CLIENT # 3	Environmental Health	SAMPLED BY P. Nichols
939 Main Street	El Centro CA	DATE / TIME 06/06/1994 / 10:00
92243		TYPE OF SAMPLE: Raw Surface Water
ATTENTION:		CHLORINE RESIDUE 0.0 ppm
06/07/1994	MPN= 2,400.0 MPN/100ml water [10 Pos/ 5 Neg] + Coliforms PRESENT	SAMPLE SITE: PaloVerde Lagoon #1
	Fecal Coli = 2400	<i>#10</i>
Environmental Health		<i>Special</i>
939 Main Street		
El Centro CA		
92243		
ATTENTION:		
(c) BtB Software, 1992 Imperial County Laboratory 935 Broadway El Centro California 92243 ELAP # 1773		
Print Date 06-09-1994/ 9:48 am Director: Bob Freeman PHONE: (619) 339-4437 MediCare # 55-L0008850 CLIA # 05D0670166		

Bacteriological Analysis of Water		LAB # 7,659
Tested at Imperial County Laboratory		
Date Received 06/06/1994		Analyst: <i>Bob D</i>
Sampled from CLIENT # 3	Environmental Health	SAMPLED BY P. Nichols
939 Main Street	CA	DATE / TIME 06/06/1994 / 10:45
El Centro 92243		TYPE OF SAMPLE: Raw Surface Water
ATTENTION :		CHLORINE RESIDUE 0.0 ppm
06/07/1994	MPN= 1,400.0 MPN/100ml water [10 Pos/ 5 Neg] + Coliforms PRESENT	SAMPLE SITE: PaloVerde Lagoon #7
	Fecal Coli =500	
<div style="text-align: right;"><i>Special</i></div>		
Environmental Health 939 Main Street El Centro CA 92243 ATTENTION:		
(c) BtB Software, 1992 Imperial County Laboratory 935 Broadway El Centro California 92243 ELAP # 1773 Print Date 06-09-1994/ 9:47 am Director: Bob Freeman PHONE: (619) 339-4437 MediCare # 55-L0008850 CLIA # 05D0670166		

Bacteriological Analysis of Water		LAB # 7,660
Tested at Imperial County Laboratory		
Date Received 06/06/1994		Analyst: <i>Bob D</i>
Sampled from CLIENT # 3	Environmental Health	SAMPLED BY P. Nichols
939 Main Street	CA	DATE / TIME 06/06/1994 / 10:35
El Centro 92243		TYPE OF SAMPLE: Raw Surface Water
ATTENTION :		CHLORINE RESIDUE 0.0 ppm
06/07/1994	MPN= 3,000.0 MPN/100ml water [11 Pos/ 4 Neg] + Coliforms PRESENT	SAMPLE SITE: PaloVerde Lagoon #8
	Fecal Coli = 2400	
<div style="text-align: right;"><i>Special</i></div>		
Environmental Health 939 Main Street El Centro CA 92243 ATTENTION:		
(c) BtB Software, 1992 Imperial County Laboratory 935 Broadway El Centro California 92243 ELAP # 1773 Print Date 06-09-1994/ 9:47 am Director: Bob Freeman PHONE: (619) 339-4437 MediCare # 55-L0008850 CLIA # 05D0670166		

COUNTY OF IMPERIAL

COURTHOUSE
939 W. MAIN ST.
EL CENTRO, CA 92243



TELEPHONE:
(619) 339-4203
(619) 339-4204
(619) 339-4205
FAX:
(619) 352-1309

DEPARTMENT OF HEALTH SERVICES DIVISION OF ENVIRONMENTAL HEALTH

July 29, 1994

Don Park
Riverside County Department EHS
79733 Country Club Drive, Suite D
Bermuda Dunes, CA 92201

Dear Mr. Park:

Enclosed are the copies of the water analysis done on 07/12/94 for the Palo Verde Lagoon and the Palo Verde Drain within Imperial County. Samples were analyzed for total coliforms present and fecal coliforms present by using multiple tube fermentation technique.

Refer to attached map depicting the sampling locations as previously agreed to. The next scheduled sampling date is 08/01/94; please advise me if this date is not suitable for you.

Sincerely,

Yvonne Smith, MPA, Director
Imperial County Health Department



By: Paul Nichols, REHS II
Division of Environmental Health Services

PN/lcd

COURTHOUSE
939 W. MAIN ST.
EL CENTRO, CA 92243

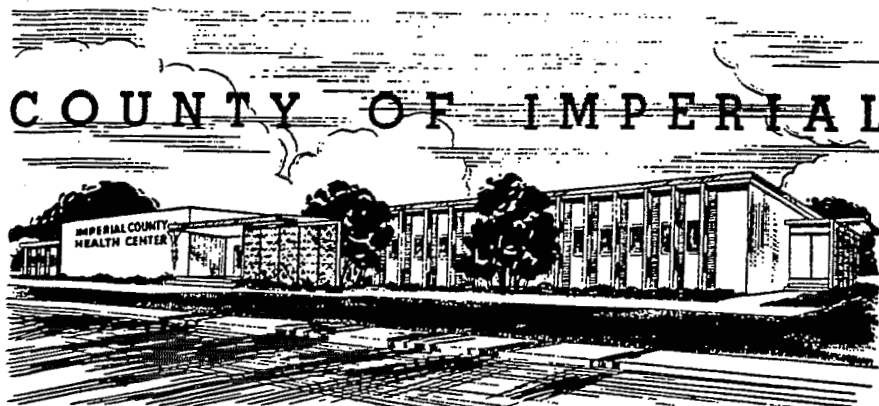

TELEPHONE:
(619) 339-4203
(619) 339-4204
(619) 339-4205
FAX:
(619) 352-1309

DEPARTMENT OF HEALTH SERVICES
DIVISION OF ENVIRONMENTAL HEALTH

July 29, 1994

Roger Henning
Palo Verde Irrigation District
180 W 14th Ave.
Blythe, CA 92225

Dear Mr. Henning:

Enclosed are the copies of the water analysis done on 07/12/94 for the Palo Verde Lagoon and the Palo Verde Drain within Imperial County. Samples were analyzed for total coliforms present and fecal coliforms present by using multiple tube fermentation technique.

Refer to attached map depicting the sampling locations as previously agreed to. The next scheduled sampling date is 08/01/94; please advise me if this date is not suitable for you.

Sincerely,

Yvonne Smith, MPA, Director
Imperial County Health Department

Paul F. Nichols

By: Paul Nichols, REHS II
Division of Environmental Health Services

PN/lcd

Bacteriological Analysis of Water **LAB # 7,802**

Tested at Imperial County Laboratory

Date Received 07/12/1994

Analyst:

Sampled from CLIENT # 3

Environmental Health

939 Main Street

El Centro CA

92243

SAMPLED BY P.Nicholas

DATE / TIME 07/12/1994 / 10:00

TYPE OF SAMPLE: Raw Surface Water

CHLORINE RESIDUE ppm

SAMPLE SITE: Palo Verde Drain #10

ATTENTION:

07/16/1994 | MPN= 50,000.0 MPN/100ml water [12 Pos/ 3 Neg] + Coliforms PRESENT
| Fecal Coli = 50,000

Environmental Health

939 Main Street

El Centro CA

92243

ATTENTION:

(c) BtS Software, 1992 Imperial County Laboratory 935 Broadway El Centro California 92243 ELAP # 1773

Print Date 07-29-1994/ 1:22 pm Director: Bob Freeman PHONE: (619) 339-4437 MediCare # 55-L0008850 CLIA # 05D0670156

07/16/1994 | MPN= 90,000.0 MPN/100ml water [13 Pos/ 2 Neg] + Coliforms PRESENT
| Fecal Coli = 90,000

Environmental Health

939 Main Street

El Centro CA

92243

ATTENTION:

(c) BtS Software, 1992 Imperial County Laboratory 935 Broadway El Centro California 92243 ELAP # 1773

Print Date 07-29-1994/ 1:22 pm Director: Bob Freeman PHONE: (619) 339-4437 MediCare # 55-L0008850 CLIA # 05D0670156

07/16/1994 | MPN= 3,000.0 MPN/100ml water [11 Pos/ 4 Neg] + Coliforms PRESENT
| Fecal Coli = 5000

Environmental Health

939 Main Street

El Centro CA

92243

ATTENTION:

(c) BtS Software, 1992 Imperial County Laboratory 935 Broadway El Centro California 92243 ELAP # 1773

Print Date 07-29-1994/ 1:21 pm Director: Bob Freeman PHONE: (619) 339-4437 MediCare # 55-L0008850 CLIA # 05D0670156

Bacteriological Analysis of Water		LAR # 7,800
Tested at Imperial County Laboratory		
Date Received 07/12/1994		Analyst: <i>Bob</i>
Sampled from CLIENT # 3	Environmental Health	SAMPLED BY P. Nicholas
939 Main Street	El Centro CA 92243	DATE / TIME 07/12/1994 / 10:25
ATTENTION :		TYPE OF SAMPLE : Raw Surface Water
07/16/1994	MPN= 90,000.0 MPN/100ml water [13 Pos/ 2 Neg] + Coliforms PRESENT	CHLORINE RESIDUE ppm
	Fecal Coli = 90,000	SAMPLE SITE : Palo Verde Lagoon #

Special

Environmental Health	
939 Main Street	
El Centro CA 92243	
ATTENTION:	

(c) 3t8 Software, 1992 Imperial County Laboratory 935 Broadway El Centro California 92243 ELAP # 1773
Print Date 07-15-1994/ 5:44 pm Director: Bob Freeman PHONE: (619) 339-4437 MediCare # 55-10008850 CLIA # 0500670166

Sampled from CLIENT # 3	SAMPLED BY P. Nicholas
Environmental Health	DATE / TIME 07/12/1994 / 10:15
939 Main Street	TYPE OF SAMPLE : Raw Surface Water
El Centro CA 92243	CHLORINE RESIDUE ppm
ATTENTION :	SAMPLE SITE : Palo Verde Lagoon #
07/15/1994	MPN= 90,000.0 MPN/100ml water [13 Pos/ 2 Neg] + Coliforms PRESENT
	Fecal Coli = 90,000

Special

Environmental Health	
939 Main Street	
El Centro CA 92243	
ATTENTION:	

(c) 3t8 Software, 1992 Imperial County Laboratory 935 Broadway El Centro California 92243 ELAP # 1773
Print Date 07-15-1994/ 5:45 pm Director: Bob Freeman PHONE: (619) 339-4437 MediCare # 55-10008850 CLIA # 0500670166

Bacteriological Analysis of Water		LAB # 7,804
Tested at Imperial County Laboratory		
Date Received 07/12/1994		Analyst: <i>S Bob</i>
Sampled from CLIENT # 3	Environmental Health	SAMPLED BY P. Nicholas
939 Main Street	El Centro CA	DATE / TIME 07/12/1994 / 09:45
92243		TYPE OF SAMPLE: Raw Surface Water
		CHLORINE RESIDUE ppm
ATTENTION :		SAMPLE SITE: Palo Verde Drain #1
07/16/1994 MPN= 3,000.0 MPN/100ml water [11 Pos/ 4 Neg] + Coliforms PRESENT		
Fecal Coli = 3000		
<i>Special</i>		
	Environmental Health	
	939 Main Street	
	El Centro CA	
	92243	
	ATTENTION:	

(c) BtB Software, 1992 Imperial County Laboratory 935 Broadway El Centro California 92243 ELAP # 1773
 Print Date 08-05-1994/ 3:41 pm Director: Bob Freeman PHONE: (619) 339-4437 MediCare # 55-L0008850 CLIA # 05D0670166

Bacteriological Analysis of Water		LAB # 7,799
Tested at Imperial County Laboratory		
Date Received 07/12/1994		Analyst: <i>S Bob</i>
Sampled from CLIENT # 3	Environmental Health	SAMPLED BY P. Nicholas
939 Main Street	El Centro CA	DATE / TIME 07/12/1994 / 10:40
92243		TYPE OF SAMPLE: Raw Surface Water
		CHLORINE RESIDUE ppm
ATTENTION :		SAMPLE SITE: Palo Verde Lagoon #
07/15/1994 MPN= 24,000.0 MPN/100ml water [10 Pos/ 5 Neg] + Coliforms PRESENT		
Fecal Coli = 24,000		
<i>Special</i>		
	Environmental Health	
	939 Main Street	
	El Centro CA	
	92243	
	ATTENTION:	

(c) BtB Software, 1992 Imperial County Laboratory 935 Broadway El Centro California 92243 ELAP # 1773
 Print Date 07-15-1994/ 5:44 pm Director: Bob Freeman PHONE: (619) 339-4437 MediCare # 55-L0008850 CLIA # 05D0670166

Bacteriological Analysis of Water		LAB # 7,803
Tested at Imperial County Laboratory		
Date Received 07/12/1994		Analyst:
Sampled from CLIENT # 3	Environmental Health	SAMPLED BY P.Nicholas
939 Main Street	El Centro CA	DATE / TIME 07/12/1994 / 10:10
92243		TYPE OF SAMPLE: Raw Surface Water
ATTENTION :		CHLORINE RESIDUE ppm #11
07/16/1994	MPN= 90,000.0 MPN/100ml water [13 Pos/ 2 Neg] + Coliforms PRESENT	SAMPLE SITE : Palo Verde Drain #1
Fecal Coli = 90,000		

Environmental Health	
939 Main Street	
El Centro CA	
92243	
ATTENTION:	

(c) BtB Software, 1992 Imperial County Laboratory 935 Broadway El Centro California 92243 ELAP # 1773
 Print Date 07-29-1994/ 1:22 pm Director: Bob Freeman PHONE: (619) 339-4437 MediCare # 55-L0008850 CLIA # 05D0670166

Bacteriological Analysis of Water		LAB # 7,804
Tested at Imperial County Laboratory		
Date Received 07/12/1994		Analyst:
Sampled from CLIENT # 3	Environmental Health	SAMPLED BY P.Nicholas
939 Main Street	El Centro CA	DATE / TIME 07/12/1994 / 09:45
92243		TYPE OF SAMPLE: Raw Surface Water
ATTENTION :		CHLORINE RESIDUE ppm
07/16/1994	MPN= 3,000.0 MPN/100ml water [11 Pos/ 4 Neg] + Coliforms PRESENT	SAMPLE SITE : Palo Verde Drain #1
Fecal Coli = 3000		

Environmental Health	
939 Main Street	
El Centro CA	
92243	
ATTENTION:	

(c) BtB Software, 1992 Imperial County Laboratory 935 Broadway El Centro California 92243 ELAP # 1773
 Print Date 08-05-1994/ 3:41 pm Director: Bob Freeman PHONE: (619) 339-4437 MediCare # 55-L0008850 CLIA # 05D0670166

Bacteriological Analysis of Water LAB # 7,801

Tested at Imperial County Laboratory

Date Received 07/12/1994 Analyst: *SPrb*

Sampled from CLIENT # 3	SAMPLED BY P. Nicholas
Environmental Health	DATE / TIME 07/12/1994 / 10:15
939 Main Street	TYPE OF SAMPLE: Raw Surface Water
El Centro CA 92243	CHLORINE RESIDUE ppm
ATTENTION :	SAMPLE SITE: Palo Verde Lagoon #9

07/16/1994 MPN= 90,000.0 MPN/100ml water [13 Pos/ 2 Neg] + Coliforms PRESENT
Fecal Coli = 90,000

Special

Environmental Health	
939 Main Street	
El Centro CA 92243	
ATTENTION:	

(c) BtB Software, 1992 Imperial County Laboratory 935 Broadway El Centro California 92243 ELAP # 1773
Print Date 07-15-1994/ 5:45 pm Director: Bob Freeman PHONE: (619) 339-4437 MediCare # 55-L0006850 CLIA # 05D0670166

Bacteriological Analysis of Water LAB # 7,802

Tested at Imperial County Laboratory

Date Received 07/12/1994 Analyst:

Sampled from CLIENT # 3	SAMPLED BY P. Nicholas
Environmental Health	DATE / TIME 07/12/1994 / 10:00
939 Main Street	TYPE OF SAMPLE: Raw Surface Water
El Centro CA 92243	CHLORINE RESIDUE ppm
ATTENTION :	SAMPLE SITE: Palo Verde Drain #10

07/16/1994 MPN= 50,000.0 MPN/100ml water [12 Pos/ 3 Neg] + Coliforms PRESENT
Fecal Coli = 50,000

Environmental Health	
939 Main Street	
El Centro CA 92243	
ATTENTION:	

(c) BtB Software, 1992 Imperial County Laboratory 935 Broadway El Centro California 92243 ELAP # 1773
Print Date 07-29-1994/ 1:22 pm Director: Bob Freeman PHONE: (619) 339-4437 MediCare # 55-L0006850 CLIA # 05D0670166

Bacteriological Analysis of Water LAB # 7,799

Tested at Imperial County Laboratory

Date Received 07/12/1994 Analyst: *Bob*

Sampled from CLIENT # 3	SAMPLED BY P. Nicholas
Environmental Health	DATE / TIME 07/12/1994 / 10:40
939 Main Street	TYPE OF SAMPLE: Raw Surface Water
El Centro CA 92243	CHLORINE RESIDUE ppm #7
ATTENTION :	SAMPLE SITE: Palo Verde Lagoon #

07/16/1994 MFN= 24,000.0 MPN/100ml water [10 Pos/ 5 Neg] + Coliforms PRESENT
Fecal Coli = 24,000

Special

Environmental Health 939 Main Street El Centro CA 92243	ATTENTION:
---	------------

(c) BtB Software, 1992 Imperial County Laboratory 935 Broadway El Centro California 92243 ELAP # 1773
Print Date 07-15-1994/ 5:44 pm Director: Bob Freeman PHONE: (619) 339-4437 MediCare # 55-L0008850 CLIA # 05D0670166

Bacteriological Analysis of Water LAB # 7,800

Tested at Imperial County Laboratory

Date Received 07/12/1994 Analyst: *Bob*

Sampled from CLIENT # 3	SAMPLED BY P. Nicholas
Environmental Health	DATE / TIME 07/12/1994 / 10:25
939 Main Street	TYPE OF SAMPLE: Raw Surface Water
El Centro CA 92243	CHLORINE RESIDUE ppm #8
ATTENTION :	SAMPLE SITE: Palo Verde Lagoon #

07/16/1994 MFN= 90,000.0 MPN/100ml water [13 Pos/ 2 Neg] + Coliforms PRESENT
Fecal Coli = 90,000

Special

Environmental Health 939 Main Street El Centro CA 92243	ATTENTION:
---	------------

(c) BtB Software, 1992 Imperial County Laboratory 935 Broadway El Centro California 92243 ELAP # 1773
Print Date 07-15-1994/ 5:44 pm Director: Bob Freeman PHONE: (619) 339-4437 MediCare # 55-L0008850 CLIA # 05D0670166

COURTHOUSE
939 W. MAIN ST.
EL CENTRO, CA 92243

COUNTY OF IMPERIAL



TELEPHONE:
(619) 339-4203
(619) 339-4204
(619) 339-4205
FAX:
(619) 352-1309

DEPARTMENT OF HEALTH SERVICES DIVISION OF ENVIRONMENTAL HEALTH

August 22, 1994

Todd Thompson
CA. Regional Water Quality Control Board
73-720 Fred Waring Drive, Suite 100
Palm Desert, CA 92260

Dear Mr. Thompson:

Enclosed are the copies of the water analysis done on August 1, 1994 of the Palo Verde Lagoon and the Palo Verde Drain within Imperial County. Samples were analyzed for total coliforms present and fecal coliforms present by using multiple tube fermentation technique.

Refer to attached map depicting the sampling locations as previously agreed to. The next scheduled sampling date is September 12, 1994; please advise me if this date is not suitable for you.

Sincerely,

Yvonne Smith, M.P.A, Director
Imperial County Health Department

Paul Nichols
by: Paul Nichols, REHS II
Division of Environmental Health

PN/tb

COUNTY OF IMPERIAL

COURTHOUSE
939 W. MAIN ST.
EL CENTRO, CA 92243



TELEPHONE:
(619) 339-4203
(619) 339-4204
(619) 339-4205
FAX:
(619) 352-1309

DEPARTMENT OF HEALTH SERVICES DIVISION OF ENVIRONMENTAL HEALTH

August 22, 1994

Roger Henning
Palo Verde Irrigation District
180 W. 14th Avenue
Blythe, CA 92225

Dear Mr. Henning:

Enclosed are the copies of the water analysis done on August 1, 1994 of the Palo Verde Lagoon and the Palo Verde Drain within Imperial County. Samples were analyzed for total coliforms present and fecal coliforms present by using multiple tube fermentation technique.

Refer to attached map depicting the sampling locations as previously agreed to. The next scheduled sampling date is September 12, 1994; please advise me if this date is not suitable for you.

Sincerely,

Yvonne Smith, M.P.A, Director
Imperial County Health Department

Paul F. Nichols

by: Paul Nichols, REHS II
Division of Environmental Health

PN/tb

COUNTY OF IMPERIAL

COURTHOUSE
939 W. MAIN ST.
EL CENTRO, CA 92243



TELEPHONE:
(619) 339-4203
(619) 339-4204
(619) 339-4205
FAX:
(619) 352-1309

DEPARTMENT OF HEALTH SERVICES DIVISION OF ENVIRONMENTAL HEALTH

August 22, 1994

Don Park
Riverside County Department EHS
79733 Country Club Drive, Suite D
Bermuda Dunes, CA 92201

Dear Mr. Park:

Enclosed are the copies of the water analysis done on August 1, 1994 of the Palo Verde Lagoon and the Palo Verde Drain within Imperial County. Samples were analyzed for total coliforms present and fecal coliforms present by using multiple tube fermentation technique.

Refer to attached map depicting the sampling locations as previously agreed to. The next scheduled sampling date is September 12, 1994; please advise me if this date is not suitable for you.

Sincerely,

Yvonne Smith, M.P.A., Director
Imperial County Health Department

Paul F. Nichols

by: Paul Nichols, REHS II
Division of Environmental Health

PN/tb

Bacteriological Analysis of Water		LGB # 7,871
Tested at Imperial County Laboratory		
Date Received 08/01/1994		Analyst: <i>DBB</i>
Sampled from CLIENT # 3	Environmental Health	SAMPLED BY Nichols
939 Main Street	EI Centro CA	DATE / TIME 08/01/1994 / 09:30
92243		TYPE OF SAMPLE: Raw Surface Water
		CHLORINE RESIDUE 0 ppm #7
ATTENTION :		SAMPLE SITE: Palo Verde Lagoon #
08/03/1994	MPN= 24,000.0 MPN/100ml water [10 Pos/ 5 Neg] + Coliforms PRESENT	
	Fecal Coli = 18000	

Environmental Health	
939 Main Street	
EI Centro CA	
92243	
ATTENTION:	

(c) BtS Software, 1992 Imperial County Laboratory 935 Broadway EI Centro California 92243 ELAP # 1773
 Print Date 08-04-1994/ 4:59 pm Director: Bob Freeman PHONE: (619) 339-4437 MediCare # 55-L0008850 CLIA # 05D0670166

08/03/1994	MPN= 16,000.0 MPN/100ml water [14 Pos/ 1 Neg] + Coliforms PRESENT
	Fecal Coli = 18000

Environmental Health	
939 Main Street	
EI Centro CA	
92243	
ATTENTION:	

(c) BtS Software, 1992 Imperial County Laboratory 935 Broadway EI Centro California 92243 ELAP # 1773
 Print Date 08-04-1994/ 4:59 pm Director: Bob Freeman PHONE: (619) 339-4437 MediCare # 55-L0008850 CLIA # 05D0670166

08/04/1994	MPN= 16,000.0 MPN/100ml water [14 Pos/ 1 Neg] - Coliforms PRESENT
	Fecal coli = 18000

Environmental Health	
939 Main Street	
EI Centro CA	
92243	
ATTENTION:	

(c) BtS Software, 1992 Imperial County Laboratory 935 Broadway EI Centro California 92243 ELAP # 1773
 Print Date 08-04-1994/ 4:59 pm Director: Bob Freeman PHONE: (619) 339-4437 MediCare # 55-L0008850 CLIA # 05D0670166

Bacteriological Analysis of Water		LAB # 7,874
Tested at Imperial County Laboratory		
Date Received 08/01/1994		Analyst: <i>D. Bob</i>
Sampled from CLIENT # 3	Environmental Health	SAMPLED BY Nichols
939 Main Street	EI Centro CA	DATE / TIME 08/01/1994 / 09:00
92243		TYPE OF SAMPLE: Raw Surface Water
ATTENTION:		CHLORINE RESIDUE 0 ppm #10
08/04/1994	MPN= 5,000.0 MPN/100ml water [12 Pos/ 3 Neg] + Coliforms PRESENT	SAMPLE SITE: Palo Verde Drain #1
	Fecal Coli = 3000	
<i>Special</i>		
Environmental Health		
939 Main Street		
EI Centro	CA	
	92243	
ATTENTION:		
(c) BtS Software, 1992 Imperial County Laboratory 935 Broadway EI Centro California 92243 ELAP # 1773		
Print Date 08-04-1994/ 4:59 pm Director: Bob Freeman PHONE: (619) 339-4437 MediCare # 55-L0008650 CLIA # 0500670166		

08/04/1994	MPN= 5,000.0 MPN/100ml water [12 Pos/ 3 Neg] + Coliforms PRESENT	
	Fecal Coli = 3000	
<i>Special</i>		
Environmental Health		
939 Main Street		
EI Centro	CA	
	92243	
ATTENTION:		
(c) BtS Software, 1992 Imperial County Laboratory 935 Broadway EI Centro California 92243 ELAP # 1773		
Print Date 08-04-1994/ 4:59 pm Director: Bob Freeman PHONE: (619) 339-4437 MediCare # 55-L0008650 CLIA # 0500670166		

08/04/1994	MPN= 2,000.0 MPN/100ml water [11 Pos/ 4 Neg] - Coliforms PRESENT	
	Fecal Coli = 3000	
<i>Special</i>		
Environmental Health		
939 Main Street		
EI Centro	CA	
	92243	
ATTENTION:		
(c) BtS Software, 1992 Imperial County Laboratory 935 Broadway EI Centro California 92243 ELAP # 1773		
Print Date 08-04-1994/ 4:59 pm Director: Bob Freeman PHONE: (619) 339-4437 MediCare # 55-L0008650 CLIA # 0500670166		

Bacteriological Analysis of Water		LAB #
Tested at Imperial County Laboratory		7,875
Date Received 08/01/1994		Analyst: <i>Bob</i>
Sampled from CLIENT #	3	
Environmental Health		SAMPLED BY Nichols
939 Main Street		DATE / TIME 08/01/1994 / 09:15
El Centro CA		TYPE OF SAMPLE: Raw Surface Water
92243		CHLORINE RESIDUE 0 ppm # 11
ATTENTION:		SAMPLE SITE: Palo Verde Drain #1
08/04/1994 MPN= 5,000.0 MPN/100ml water [12 Pos/ 3 Neg] + Coliforms PRESENT		
Fecal Coli = 3000		
<i>Special</i>		
Environmental Health		
939 Main Street		
El Centro CA		
92243		
ATTENTION:		
(c) BtB Software, 1992 Imperial County Laboratory 935 Broadway El Centro California 92243 ELAP # 1773		
Print Date 08-04-1994/ 4:59 pm Director: Bob Freeman PHONE: (619) 339-4437 MediCare # 55-L0008850 CLIA # 05D0670166		

Bacteriological Analysis of Water		LAB #
Tested at Imperial County Laboratory		7,876
Date Received 08/01/1994		Analyst: <i>Bob</i>
Sampled from CLIENT #	3	
Environmental Health		SAMPLED BY Nichols
939 Main Street		DATE / TIME 08/01/1994 / 08:50
El Centro CA		TYPE OF SAMPLE: Raw Surface Water
92243		CHLORINE RESIDUE 0 ppm # 12
ATTENTION:		SAMPLE SITE: Palo Verde Drain #1
08/04/1994 MPN= 3,000.0 MPN/100ml water [11 Pos/ 4 Neg] + Coliforms PRESENT		
Fecal Coli = 3000		
<i>Special</i>		
Environmental Health		
939 Main Street		
El Centro CA		
92243		
ATTENTION:		
(c) BtB Software, 1992 Imperial County Laboratory 935 Broadway El Centro California 92243 ELAP # 1773		
Print Date 08-04-1994/ 4:59 pm Director: Bob Freeman PHONE: (619) 339-4437 MediCare # 55-L0008850 CLIA # 05D0670166		

Bacteriological Analysis of Water		LAB #
Tested at Imperial County Laboratory		7,873
Date Received 08/01/1994		Analyst: <i>JBB</i>
Sampled from CLIENT #	3	
Environmental Health		SAMPLED BY Nichols
939 Main Street		DATE / TIME 08/01/1994 / 09:20
El Centro CA		TYPE OF SAMPLE: Raw Surface Water
92243		CHLORINE RESIDUE 0 ppm #9
ATTENTION :		SAMPLE SITE: Palo Verde Lagoon #
08/04/1994 MPN= 16,000.0 MPN/100ml water [14 Pos/1 Neg] + Coliforms PRESENT		
Fecal coli = 16000		
<i>Special</i>		
Environmental Health		
939 Main Street		
El Centro CA		
92243		
ATTENTION:		
(c) BtB Software, 1992 Imperial County Laboratory 935 Broadway El Centro California 92243 ELAP # 1773		
Print Date 08-04-1994/ 4:59 pm Director: Bob Freeman PHONE: (619) 339-4437 MediCare # 55-L0008850 CLIA # 0500670166		

Bacteriological Analysis of Water		LAB #
Tested at Imperial County Laboratory		7,874
Date Received 08/01/1994		Analyst: <i>JBB</i>
Sampled from CLIENT #	3	
Environmental Health		SAMPLED BY Nichols
939 Main Street		DATE / TIME 08/01/1994 / 09:00
El Centro CA		TYPE OF SAMPLE: Raw Surface Water
92243		CHLORINE RESIDUE 0 ppm #10
ATTENTION :		SAMPLE SITE: Palo Verde Drain #1
08/04/1994 MPN= 5,000.0 MPN/100ml water [12 Pos/3 Neg] + Coliforms PRESENT		
Fecal Coli = 3000		
<i>Special</i>		
Environmental Health		
939 Main Street		
El Centro CA		
92243		
ATTENTION:		
(c) BtB Software, 1992 Imperial County Laboratory 935 Broadway El Centro California 92243 ELAP # 1773		
Print Date 08-04-1994/ 4:59 pm Director: Bob Freeman PHONE: (619) 339-4437 MediCare # 55-L0008850 CLIA # 0500670166		

Bacteriological Analysis of Water		LAB #
Tested at Imperial County Laboratory		7,871
Date Received 08/01/1994		Analyst: <i>BtB</i>
Sampled from CLIENT # 3	SAMPLED BY Nichols	
Environmental Health	DATE / TIME 08/01/1994 / 09:30	
939 Main Street	TYPE OF SAMPLE: Raw Surface Water	
El Centro CA 92243	CHLORINE RESIDUE 0 ppm #7	
ATTENTION :	SAMPLE SITE: Palo Verde Lagoon #	
08/03/1994 MPN= 24,000.0 MPN/100ml water [10 Pos/ 5 Neg] + Coliforms PRESENT		
Fecal Coli = 16000		
<i>Special</i>		
Environmental Health		
939 Main Street		
El Centro CA 92243		
ATTENTION:		

(c) BtB Software, 1992 Imperial County Laboratory 935 Broadway El Centro California 92243 ELAP # 1773
 Print Date 08-04-1994/ 4:59 pm Director: Bob Freeman PHONE: (619) 339-4437 MediCare # 55-L0008850 CLIA # 05D0670166

Bacteriological Analysis of Water		LAB #
Tested at Imperial County Laboratory		7,872
Date Received 08/01/1994		Analyst: <i>BtB</i>
Sampled from CLIENT # 3	SAMPLED BY Nichols	
Environmental Health	DATE / TIME 08/01/1994 / 09:25	
939 Main Street	TYPE OF SAMPLE: Raw Surface Water	
El Centro CA 92243	CHLORINE RESIDUE 0 ppm #8	
ATTENTION :	SAMPLE SITE: Palo Verde Lagoon #	
08/03/1994 MPN= 16,000.0 MPN/100ml water [14 Pos/ 1 Neg] + Coliforms PRESENT		
Fecal Coli = 18000		
<i>Special</i>		
Environmental Health		
939 Main Street		
El Centro CA 92243		
ATTENTION:		

(c) BtB Software, 1992 Imperial County Laboratory 935 Broadway El Centro California 92243 ELAP # 1773
 Print Date 08-04-1994/ 4:59 pm Director: Bob Freeman PHONE: (619) 339-4437 MediCare # 55-L0008850 CLIA # 05D0670166

Bacteriological Analysis of Water		LAB #	8,073
Tested at Imperial County Laboratory			
Date Received 10/03/1994		Analyst: <i>J. Brb</i>	
Sampled from CLIENT #	3	SAMPLED BY	Nichols
Environmental Health		DATE / TIME	10/03/1994 / 10:1
939 Main Street		TYPE OF SAMPLE:	Raw Surface Water
El Centro CA	92243	CHLORINE RESIDUE	0 ppm #11
ATTENTION :		SAMPLE SITE:	Palo Verde Drain
10/06/1994	MPN=	2,400.0 MPN/100ml water [10 Pos/ 5 Neg] + Coliforms PRESE	
	Fecal Coli =	2400	
<i>Special</i>			
Environmental Health			
939 Main Street			
El Centro CA			
92243			
ATTENTION:			
(c) BtB Software, 1992 Imperial County Laboratory 935 Broadway El Centro California 92243 ELAP # 1773			
Print Date 10-06-1994/ 11:00 am Director: Bob Freeman PHONE: (619) 339-4437 MediCare # 55-L0008850 CLIA # 05D067015			

Bacteriological Analysis of Water		LAB #	8,074
Tested at Imperial County Laboratory			
Date Received 10/03/1994		Analyst: <i>J. Brb</i>	
Sampled from CLIENT #	3	SAMPLED BY	Nichols
Environmental Health		DATE / TIME	10/03/1994 / 9:58
939 Main Street		TYPE OF SAMPLE:	Raw Surface Water
El Centro CA	92243	CHLORINE RESIDUE	0 ppm #12
ATTENTION :		SAMPLE SITE:	Palo Verde Drain
10/06/1994	MPN=	3,000.0 MPN/100ml water [11 Pos/ 4 Neg] + Coliforms PRESE	
	Fecal Coli =	900	
<i>Special</i>			
Environmental Health			
939 Main Street			
El Centro CA			
92243			
ATTENTION:			
(c) BtB Software, 1992 Imperial County Laboratory 935 Broadway El Centro California 92243 ELAP # 1773			
Print Date 10-06-1994/ 11:00 am Director: Bob Freeman PHONE: (619) 339-4437 MediCare # 55-L0008850 CLIA # 05D067015			

Date Received 10/03/1994 Analyst: *S. Bob*
Sampled from CLIENT # 3
Environmental Health
939 Main Street
El Centro CA 92243
ATTENTION :
10/06/1994 MPN= 5,000.0 MPN/100ml water [12 Pos/ 3 Neg] + Coliforms PRESE
Fecal Coli = 2400

Speed

Environmental Health
939 Main Street
El Centro CA 92243
ATTENTION:

(c) BtB Software, 1992 Imperial County Laboratory 935 Broadway El Centro California 92243 ELAP # 1773
Print Date 10-06-1994/ 11:00 am Director: Bob Freeman PHONE: (619) 339-4437 MediCare # 55-L0006850 CLIA # 050067015

Bacteriological Analysis of Water LAB # 8,071
Tested at Imperial County Laboratory
Date Received 10/03/1994 Analyst: *S. Bob*
Sampled from CLIENT # 3
Environmental Health
939 Main Street
El Centro CA 92243
ATTENTION :
10/06/1994 MPN= 9,000.0 MPN/100ml water [13 Pos/ 2 Neg] + Coliforms PRESE
Fecal Coli = 5000

Speed

Environmental Health
939 Main Street
El Centro CA 92243
ATTENTION:

(c) BtB Software, 1992 Imperial County Laboratory 935 Broadway El Centro California 92243 ELAP # 1773
Print Date 10-06-1994/ 11:00 am Director: Bob Freeman PHONE: (619) 339-4437 MediCare # 55-L0006850 CLIA # 050067015

Bacteriological Analysis of Water LAB # 8,072
Tested at Imperial County Laboratory
Date Received 10/03/1994 Analyst: *S. Bob*
Sampled from CLIENT # 3
Environmental Health
939 Main Street
El Centro CA 92243
ATTENTION :
10/06/1994 MPN= 15,000.0 MPN/100ml water [14 Pos/ 1 Neg] + Coliforms PRESE
Fecal Coli = 5000

Speed

Environmental Health
939 Main Street
El Centro CA 92243
ATTENTION:

(c) BtB Software, 1992 Imperial County Laboratory 935 Broadway El Centro California 92243 ELAP # 1773
Print Date 10-06-1994/ 11:00 am Director: Bob Freeman PHONE: (619) 339-4437 MediCare # 55-L0006850 CLIA # 050067015

Bacteriological Analysis of Water		LAB #	8,069
Tested at Imperial County Laboratory			
Date Received 10/03/1994		Analyst: <i>J. B. B.</i>	
Sampled from CLIENT #	3	SAMPLED BY	Nichols
Environmental Health		DATE / TIME	10/03/1994 / 10:45
939 Main Street		TYPE OF SAMPLE:	Raw Surface Water
El Centro CA	92243	CHLORINE RESIDUE	0 ppm #7
ATTENTION :		SAMPLE SITE:	Palo Verde Lagoon #
10/06/1994	MPN=	3,000.0 MPN/100ml water [11 Pos/ 4 Neg] + Coliforms PRESENT	
	Fecal Coli =	2400	
<i>Specimen</i>			
	Environmental Health		
	939 Main Street		
	El Centro CA		
	92243		
	ATTENTION:		
(c) BtB Software, 1992 Imperial County Laboratory 935 Broadway El Centro California 92243 ELAP # 1773			
Print Date 10-06-1994/ 11:00 am Director: Bob Freeman PHONE: (619) 339-4437 MediCare # 55-L0008850 CLIA # 05D0670166			

Bacteriological Analysis of Water		LAB #	8,073
Tested at Imperial County Laboratory			
Date Received 10/03/1994		Analyst: <i>JBB</i>	
Sampled from CLIENT #	3	SAMPLED BY	Nichols
Environmental Health		DATE / TIME	10/03/1994 / 10:20
939 Main Street		TYPE OF SAMPLE	Raw Surface Water
El Centro CA		CHLORINE RESIDUE	0 ppm #11
92243		SAMPLE SITE	Palo Verde Drain #1
ATTENTION :			
10/06/1994	MPN=	2,400.0 MPN/100ml water [10 Pos/ 5 Neg] + Coliforms PRESENT	
	Fecal Coli =	2400	
<i>Special</i>			
Environmental Health			
939 Main Street			
El Centro CA			
92243			
ATTENTION:			
(c) BtS Software, 1992 Imperial County Laboratory 935 Broadway El Centro California 92243 ELAP # 1773			
Print Date 10-06-1994/ 11:00 am Director: Bob Freeman. PHONE: (619) 339-4437 MediCare # 55-L0008850 CLIA # 05D0670166			

Bacteriological Analysis of Water		LAB #	8,074
Tested at Imperial County Laboratory			
Date Received 10/03/1994		Analyst: <i>JBB</i>	
Sampled from CLIENT #	3	SAMPLED BY	Nichols
Environmental Health		DATE / TIME	10/03/1994 / 9:55
939 Main Street		TYPE OF SAMPLE	Raw Surface Water
El Centro CA		CHLORINE RESIDUE	0 ppm #12
92243		SAMPLE SITE	Palo Verde Drain #1
ATTENTION :			
10/06/1994	MPN=	3,000.0 MPN/100ml water [11 Pos/ 4 Neg] + Coliforms PRESENT	
	Fecal Coli =	900	
<i>Special</i>			
Environmental Health			
939 Main Street			
El Centro CA			
92243			
ATTENTION:			
(c) BtS Software, 1992 Imperial County Laboratory 935 Broadway El Centro California 92243 ELAP # 1773			
Print Date 10-06-1994/ 11:00 am Director: Bob Freeman. PHONE: (619) 339-4437 MediCare # 55-L0008850 CLIA # 05D0670166			

Bacteriological Analysis of Water		LAB #	8,071
Tested at Imperial County Laboratory			
Date Received 10/03/1994		Analyst: <i>J.B.B.</i>	
Sampled from CLIENT #	3	SAMPLED BY	Nichols
Environmental Health		DATE / TIME	10/03/1994 / 10:30
939 Main Street		TYPE OF SAMPLE :	Raw Surface Water
El Centro CA		CHLORINE RESIDUE	0 ppm #9
92243		SAMPLE SITE :	Palo Verde Lagoon #
ATTENTION :			
10/06/1994	MPN=	9,000.0 MPN/100ml water [13 Pos/ 2 Neg] + Coliforms PRESENT	
	Fecal Coli =	5000	
<i>Special</i>			
Environmental Health			
939 Main Street			
El Centro	CA		
	92243		
ATTENTION:			
(c) BtB Software, 1992 Imperial County Laboratory 935 Broadway El Centro California 92243 ELAP # 1773			
Print Date 10-06-1994/ 11:00 am Director: Bob Freeman PHONE: (619) 339-4437 MediCare # 55-L0008850 CLIA # 05D0670166			

Bacteriological Analysis of Water		LAB #	8,072
Tested at Imperial County Laboratory			
Date Received 10/03/1994		Analyst: <i>J.B.B.</i>	
Sampled from CLIENT #	3	SAMPLED BY	Nichols
Environmental Health		DATE / TIME	10/03/1994 / 10:05
939 Main Street		TYPE OF SAMPLE :	Raw Surface Water
El Centro CA		CHLORINE RESIDUE	0 ppm #10
92243		SAMPLE SITE :	Palo Verde Drain #1
ATTENTION :			
10/06/1994	MPN=	16,000.0 MPN/100ml water [14 Pos/ 1 Neg] + Coliforms PRESENT	
	Fecal Coli =	9000	
<i>Special</i>			
Environmental Health			
939 Main Street			
El Centro	CA		
	92243		
ATTENTION:			
(c) BtB Software, 1992 Imperial County Laboratory 935 Broadway El Centro California 92243 ELAP # 1773			
Print Date 10-06-1994/ 11:00 am Director: Bob Freeman PHONE: (619) 339-4437 MediCare # 55-L0008850 CLIA # 05D0670166			

Print Date 10-06-1994 / 11:00 am Director: Bob Freeman PHONE: (619) 339-4437 MediCare # 55-L0008850 CLIA # 0500670166

(c) B1B Software, 1992 Imperial County Laboratory 935 Broadway El Centro California 92243 ELP # 1773

Environmental Health	939 Main Street	El Centro	CA	92243	ATTENTION:
----------------------	-----------------	-----------	----	-------	------------

Tested at Imperial County Laboratory

LAB # 8.070

Analyst: *[Signature]*

Sampled from CLIENT # 3

Date Received 10/03/1994

Environment Health

939 Main Street

El Centro

CA

92243

ATTENTION:

MPN= 5,000.0 MPN/100ml water [12 Pos/3 Neg] + Coliforms PRESENT

Fecal Coli = 2400

10/06/1994

SAMPLED BY Nichols

DATE / TIME 10/03/1994 / 10:35

TYPE OF SAMPLE: Raw Surface Water

CHLORINE RESIDUE 0 ppm

SAMPLE SITE: Palo Verde Lagoon #

#8

Print Date 10-06-1994 / 11:00 am Director: Bob Freeman PHONE: (619) 339-4437 MediCare # 55-L0008850 CLIA # 0500670166

(c) B1B Software, 1992 Imperial County Laboratory 935 Broadway El Centro California 92243 ELP # 1773

Environmental Health	939 Main Street	El Centro	CA	92243	ATTENTION:
----------------------	-----------------	-----------	----	-------	------------

Tested at Imperial County Laboratory

LAB # 8.069

Analyst: *[Signature]*

Sampled from CLIENT # 3

Date Received 10/03/1994

Environment Health

939 Main Street

El Centro

CA

92243

ATTENTION:

MPN= 3,000.0 MPN/100ml water [11 Pos/4 Neg] + Coliforms PRESENT

Fecal Coli = 2400

10/06/1994

SAMPLED BY Nichols

DATE / TIME 10/03/1994 / 10:45

TYPE OF SAMPLE: Raw Surface Water

CHLORINE RESIDUE 0 ppm

SAMPLE SITE: Palo Verde Lagoon #

#7